

## Photo of Non-Shielded Light Fixture

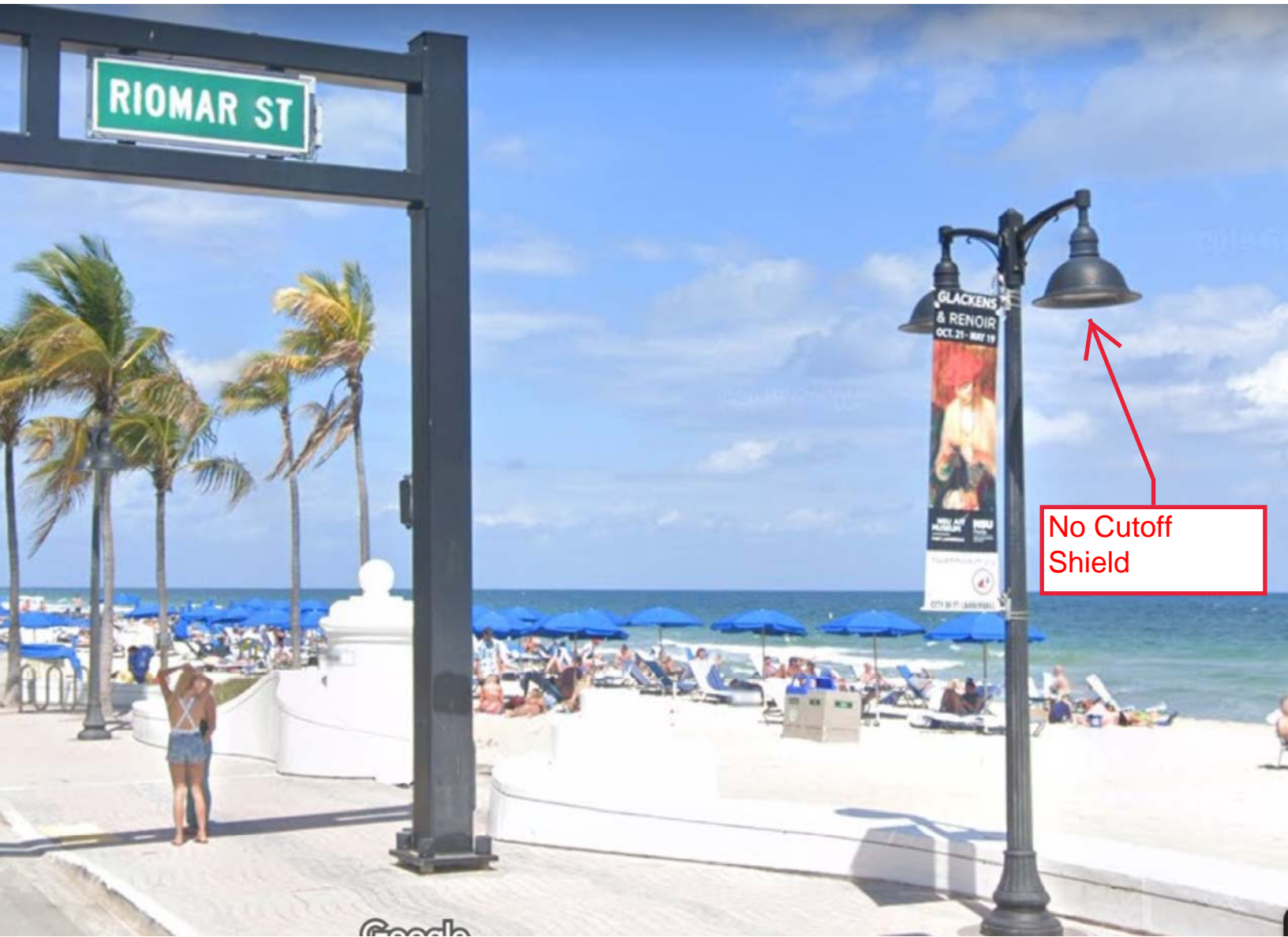

## Photo of Shielded Light Fixture

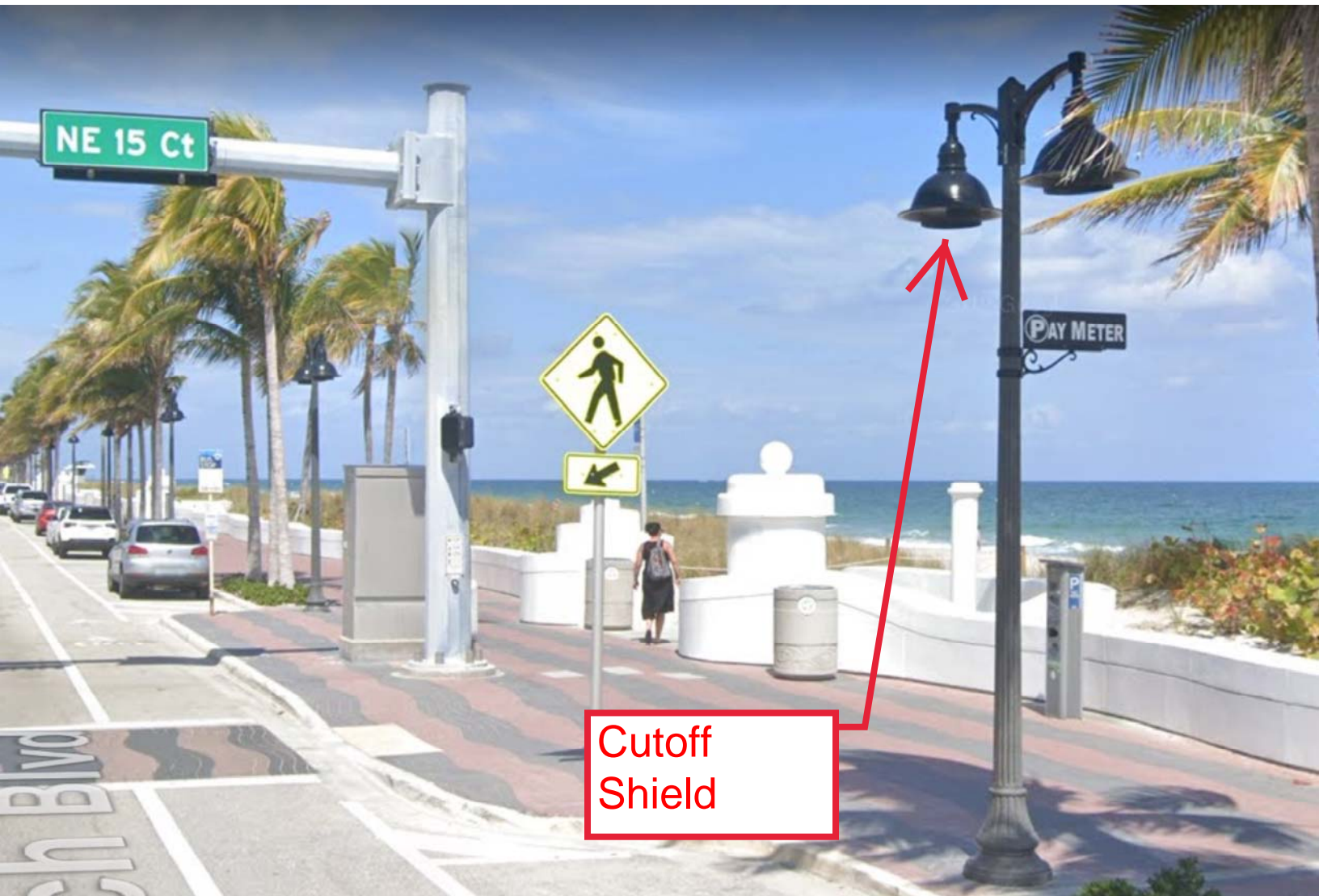



COMPONENTS OF CONTRACT PLANS SET

ROADWAY PLANS  
SIGNING AND PAVEMENT MARKING PLANS  
SIGNALIZATION PLANS  
LIGHTING PLANS  
LANDSCAPE PLANS  
STRUCTURES PLANS

A DETAILED INDEX APPEARS ON THE  
KEY SHEET OF EACH COMPONENT

INDEX OF ROADWAY PLANS

SHEET NO.	SHEET DESCRIPTION
1	KEY SHEET
2-4	SUMMARY OF PAY ITEMS
5-7	DRAINAGE MAP
8-9	TYPICAL SECTION
10-11	SUMMARY OF QUANTITIES
12-13	SUMMARY OF DRAINAGE STRUCTURES
14	OPTIONAL MATERIALS TABULATION
15	GENERAL NOTES AND PAY ITEM NOTES
16-28	PLAN
29-30	GRADING DETAILS
31-36	PROFILE
37-56	DRAINAGE STRUCTURES
57	DRAINAGE DETAILS
58-108	CROSS SECTIONS
109-111	STORMWATER POLLUTION PREVENTION PLAN
112	TRAFFIC CONTROL PLAN GENERAL NOTES
113-190	TRAFFIC CONTROL PLAN
191-202	UTILITY ADJUSTMENTS
203	CRITICAL TEMPORARY WALL
GR-1	ROADWAY SOIL SURVEY
GR-2 - GR-3	REPORT OF CORE BORINGS
GR-4 - GR-6	REPORT OF SPT BORINGS
GR-7 - GR-11	REPORT OF CORE BORINGS
CTL-1 - CTL-3	PROJECT SURVEY CONTROL
UTV-1 - UTV-3	VERIFIED UTILITY LOCATE
UTV-4	SUMMARY OF VERIFIED UTILITIES

GOVERNING STANDARDS AND SPECIFICATIONS:

Florida Department of Transportation, 2014 Design Standards and revised Index Drawings as appended herein, and 2014 Standard Specifications for Road and Bridge Construction, as amended by Contract Documents.

For Design Standards click on the "Design Standards" link at the following web site:  
<http://www.dot.state.fl.us/rddesign/>

For the Standard Specifications for Road and Bridge Construction click on the "Specifications" link at the following web site:  
<http://www.dot.state.fl.us/specificationsoffice/>

REVISIONS

- △ Roadway Sheets 1, 3-4, 12-13, 15, 19-20, 22-25, 28, 43, 46-56, 112, 114-116, 122-129, 131-139, 143-145, 153, 156-158, 161-164, 167, 169, 174, 182, 187, 191-196, 200 (Revised 4/17/14)  
203 (Revised 4/21/14)  
Report of Core Borings Sheets GR-7 to GR- 11 (Revised 4/16/14)  
Utility Verification Sheet UTV-3 (Revised 2/24/14)  
Signing and Pavement Marking Sheets S-2, S-3, S-6, S-8, S-9, S-11, S-13 to S-14, S-38 (Revised 4/16/14)  
Signalization Sheets T-2 to T-3, T-6 to T-10 (Revised 4/18/14)  
Signalization Sheet T-13 (Revised 3/31/14)  
Lighting Sheets L-3, L-9, L-14 (Revised 3/31/14)  
Landscape Sheets LD-4 to LD-5, LD-13 to LD-20, 22 (Revised 3/18/14)  
Structural Sheets BW-2 to BW-11, BW-17, BW-21 to BW-22 (Revised 4/14/14)

Excerpt from 2015 Plans which Installed  
Shielded Light Fixtures from Sunrise Boulevard  
north to NE 18th Street on State Road (SR) A1A

BROWARD COUNTY (86050)

STATE ROAD A1A

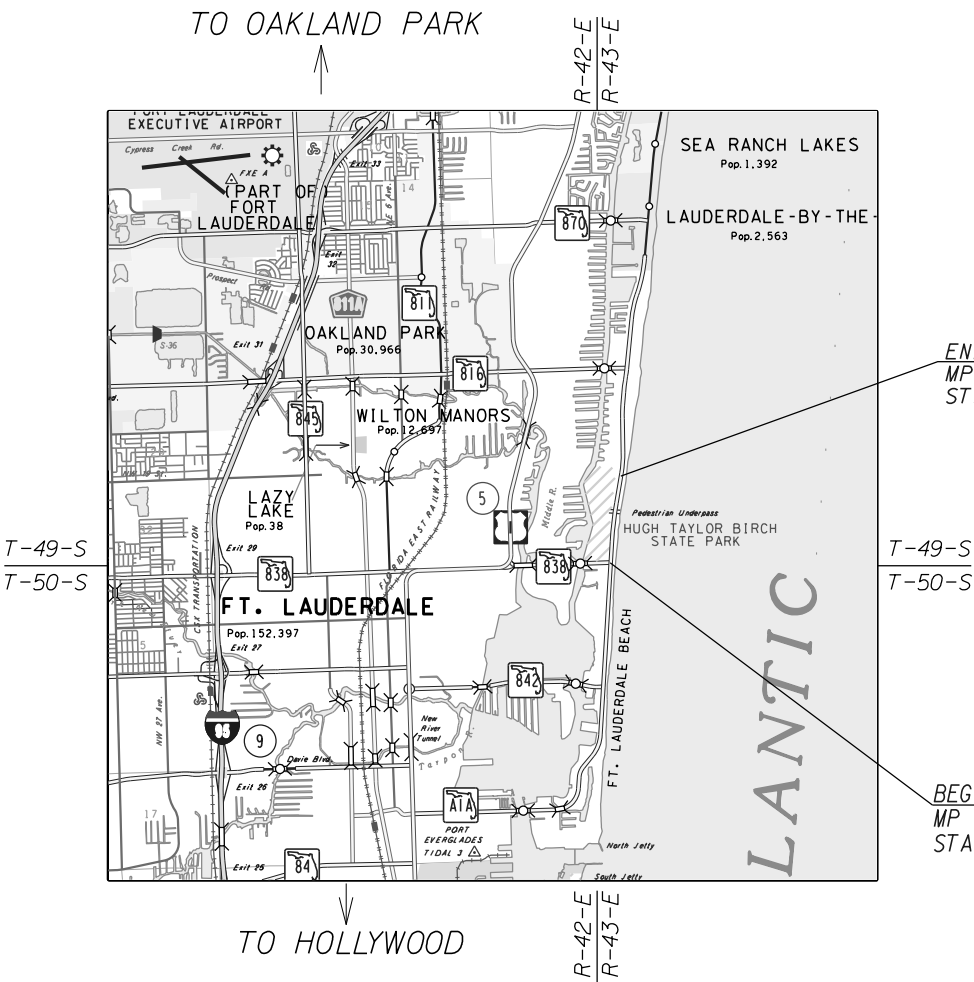

PROJECT LOCATION

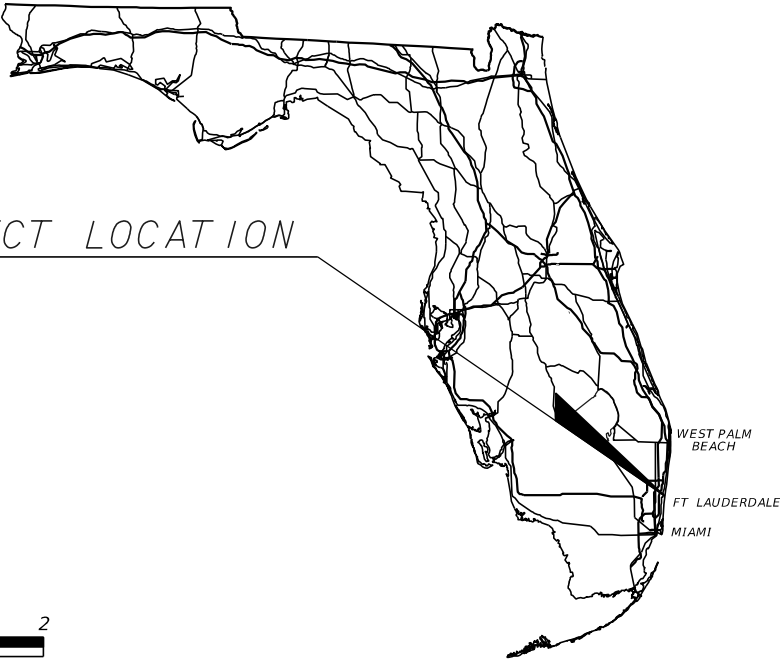

ROADWAY SHOP DRAWINGS  
TO BE SUBMITTED TO:  
MORAYMA OCHOA  
DISTRICT IV STRUCTURES OFFICE  
3400 WEST COMMERCIAL BLVD.  
FORT LAUDERDALE, FL 33309

PLANS PREPARED BY:  
DESIGN SECTION 2  
3400 WEST COMMERCIAL BLVD.  
FT. LAUDERDALE, FL 33309

NOTE: THE SCALE OF THESE PLANS MAY  
HAVE CHANGED DUE TO REPRODUCTION.

LENGTH OF PROJECT

	LINEAR FEET	MILES
ROADWAY	5,217.31	0.988
BRIDGES	N/A	N/A
NET LENGTH OF PROJECT	5,217.31	0.988
EXCEPTIONS	N/A	N/A
GROSS LENGTH OF PROJECT	5,217.31	0.988

KEY SHEET REVISIONS

DATE	DESCRIPTION
4/17/14	△ SHEETS 203 AND GR-7 TO GR-11 ADDED

ROADWAY PLANS  
ENGINEER OF RECORD: \_\_\_\_\_

P.E. NO.: 52740

FISCAL YEAR	SHEET NO.
CAM 21-0935 14 Exhibit 3 1	Page 3 of 4

Light Shield Detail from 2015 Plans

NOTE: FIXTURE AND ARM SHALL BE PRE-ASSEMBLED AND PRE-WIRED BY MANUFACTURE FOR SINGLE POINT CONNECTION BY CONTRACTOR

CAVITY WITH PRE GFCI RECEPTACLE W/WHILE IN USE COVER (BY BRACKET/FIXTURE VENDOR)

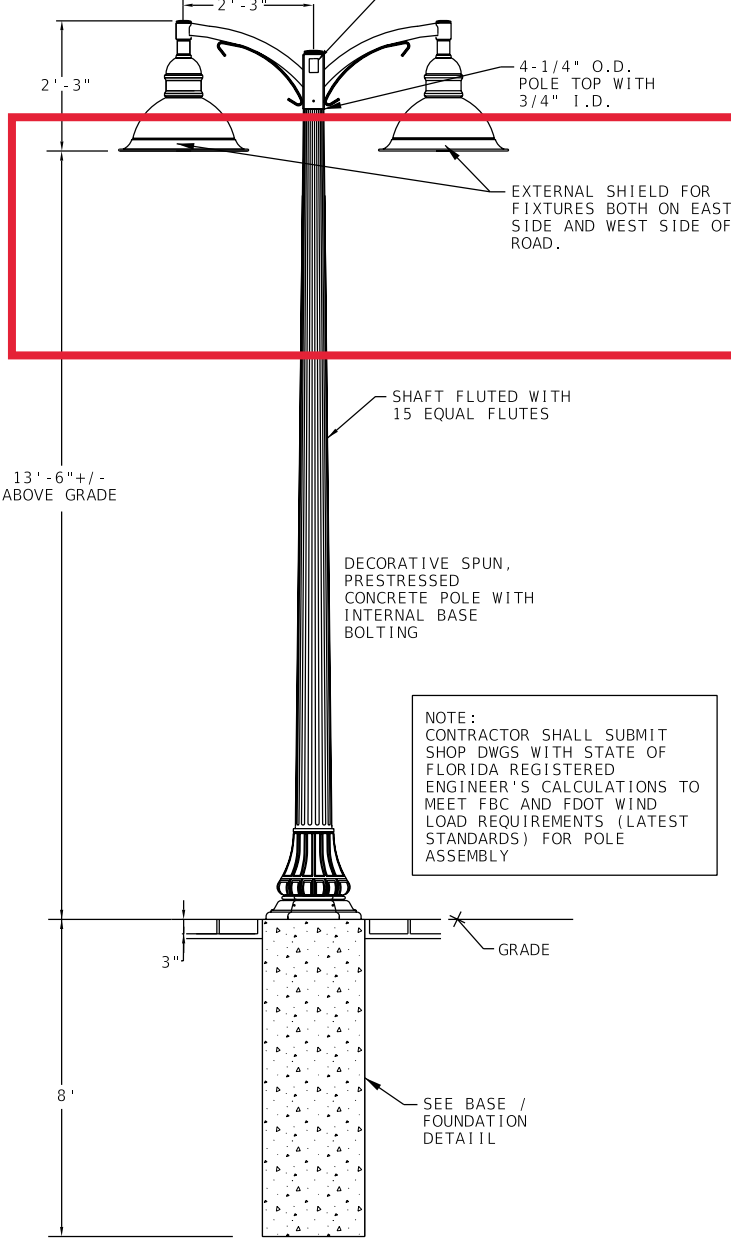

NOTE: CONTRACTOR SHALL SUBMIT SHOP DWGS WITH STATE OF FLORIDA REGISTERED ENGINEER'S CALCULATIONS TO MEET FBC AND FDOT WIND LOAD REQUIREMENTS (LATEST STANDARDS) FOR POLE ASSEMBLY

SPUNCAST PRESTRESSED WASHINGTON STYLE INTERNAL BASE PLATE CONCRETE POLE BY AMERON POLE PRODUCTS

POLES SHALL BE FORMED AS SINGLE PIECE POLE CONSISTING OF A TAPERED 4-1/4" TO 7" FIFTEEN FLUTE SHAFT AND A 21" DIAMETER BY 24" HIGH DECORATIVE BASE TO AN OVERALL LENGTH OF 14'-6". THE POLE SHALL BE MOUNTED TO A CONCRETE FOUNDATION WITH (4) STAINLESS STEEL BOLTS ON A 9" BOLT PATTERN TO A STAINLESS STEEL INTERNAL POLE ADJUSTER PLATE. THE POLE BASE ACCESSIBLE BY A CONCRETE HAND HOLE COVER. THE POLE SHALL BE FORMED WITH BLACK EXPOSED AGGREGATES WITH AMERSHIELD ANTI-GRAFFITI COATING APPLIED.

POLE DESIGNATION: 26ST14(1231)SPECIAL (WITH TENON)  
POLE WEIGHT: 480 LBS

LIGHT POLE DETAIL  
N.T.S.

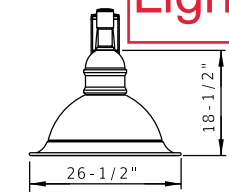

FRONT VIEW

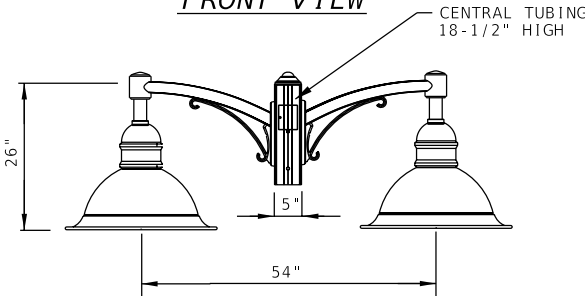

TWIN FIXTURE/BRACKET

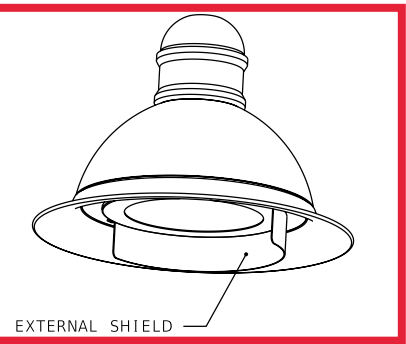

EXTERNAL SHIELD  
26" X 4" HEIGHT  
(LIGHT FIXTURES ON BOTH EAST AND WEST SIDE OF ROAD)

LEGEND:

- 1 CENTRAL TUBING TOP COVER CAST ALUMINUM WITH (2) 1/4 -20 SS SET SCREWS
- 2 CAST ALUMINUM SQUARE CENTRAL TUBING TO FIT POLE TOP TENON 4" DIA. X 8" (4) 3/8-16 SS SET SCREWS & (1) 1/2"-13 X 5" SS MACHINE SCREW THREADED TO CENTRAL TUBING FOR TORSTON ROTATION- CONTRACTOR SHALL DRILL TENON PER TEMPLATE PROVIDED BY VERTEX ILLUMINATION OF AMERICA
- 3 CAST ALUMINUM ARM WITH DECORATIVE SCROLL BOLTED TO CAST CENTRAL TUBING & 1-1/4" SS NIPPLE THREADED INTO ARM AND SECURED WITH LOCKNUT INSIDE FIXTURE HOUSING
- 4 LED DRIVERS MOUNT INSIDE ELECTRICAL COMPARTMENT INDEPENDENT FROM LED LIGHT ENGINE CAN BE REPLACED OR UPGRADED; VOLTAGE 120-277 V
- 5 FORMED ALUMINUM HOUSING-HOUSES TWO TIER LED ARRAYS, VERTICAL AND HORIZONTAL AIMING ANGLES, ASSYMMETRICAL DISTRIBUTION WITH NO LIGHT DIRECTED TOWARDS THE HOUSE SIDE - LED ARRAY CREE XP-E-AMBER COLOR
- 6 TEMPERED FLAT FROSTED GLASS LENS
- 7 CAST ALUMINUM LOWER FRAME
- 8 CAST ALUMINUM IN-USE DOOR FOR GFCI WITH FULL NYLON HINGE AND HEX HEAD NYLON SCREW AND RUBBER GASKET
- 9 DUPLEX GFCI RECEPTACLE-125VA-15A
- 10 JUNCTION BOX FOR GFCI
- 11 PROVIDE AND INSTALL A 3A IN-LINE FUSE AND FUSE HOLDER WITHIN THE JUNCTION BOX FOR THE GFCI RECEPTACLE.

POLARIZED LOUVERS COVER FULL APERTURE, ONLY FOR SOME FIXTURES, ONLY FOR EAST SIDE OF THE ROAD, SEE SHEET L-4 FOR LOCATIONS

Cutoff  
Shield

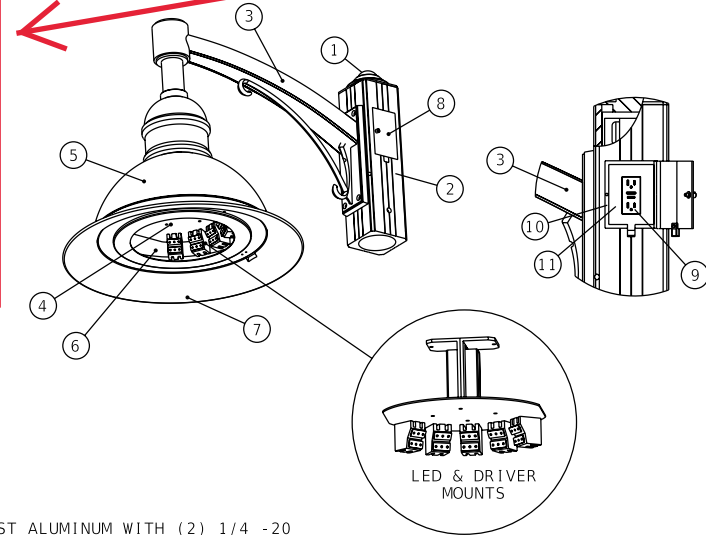

FIXTURE NOTES:

FIXTURES/BRACKETS BY VERTEX ILLUMINATIONS OF AMERICA (VIA) UTILIZING GLOSS BLACK FINISH, DARK SKY/TURTLE FRIENDLY FULL CUTOFF OPTICS

THE ENTIRE BRACKET/FIXTURE ASSEMBLY IS PRE-WIRED FOR EASY ONE POINT CONNECTION AT BOTTOM OF CENTRAL TUBING

WEST SIDE  
TWIN FIXTURE AND TWIN BRACKET ASSEMBLY:  
FIXTURE: CITTA-FLL-72W LED AMBER-TRLE-240V-GLOSS-BLACK  
BRACKET: FCL-FLL-BR2-27-BKTX  
EXTERNAL 270 DEGREE SHIELD: CAT. #CITTA 270S-4-GLOSS-BLACK  
EPA ASSEMBLY: 5.25 SQ FT; WEIGHT ASSEMBLY: 164 LBS

EAST SIDE  
TWIN FIXTURE AND TWIN BRACKET ASSEMBLY:  
FIXTURE: CITTA-FLL-100W LED AMBER-TRLE-240V-GLOSS-BLACK  
BRACKET: FCL-FLL-BR2-27-BKTX  
EXTERNAL 270 DEGREE SHIELD: CAT. #CITTA 270S-4-GLOSS-BLACK  
EPA ASSEMBLY: 5.25 SQ FT; WEIGHT ASSEMBLY: 164 LBS

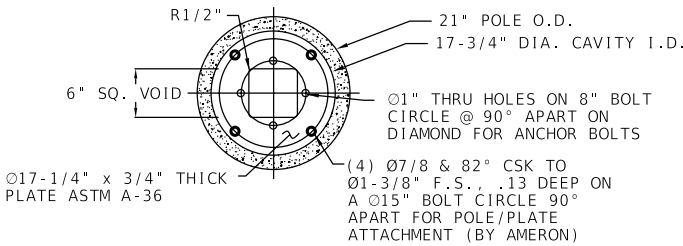

BOTTOM VIEW WITH SPECIAL  
ADJUSTER PLATE

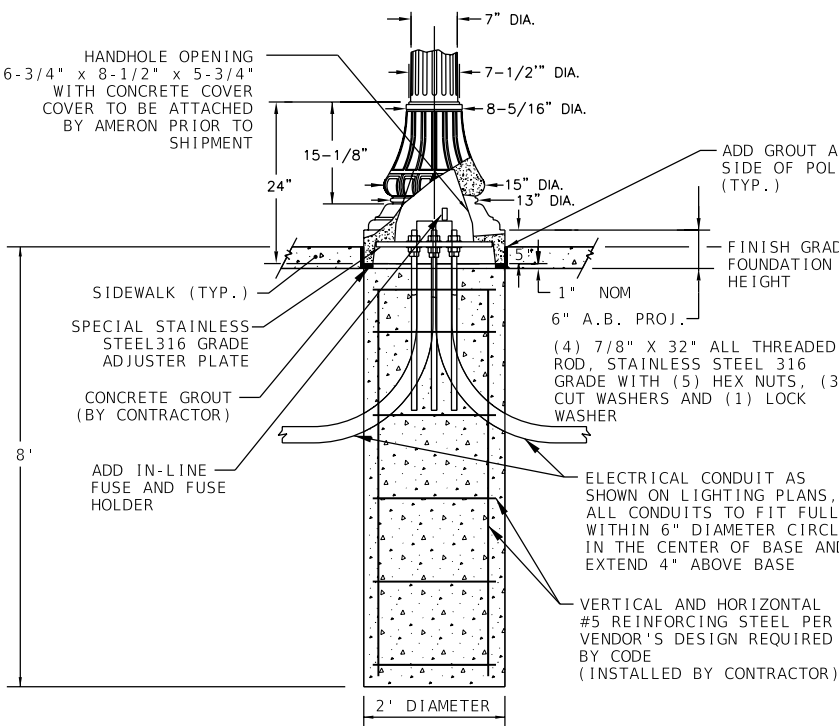

BASE / FOUNDATION DETAIL  
N.T.S.

REVISIONS			
DATE	DESCRIPTION	DATE	DESCRIPTION

STATE OF FLORIDA DEPARTMENT OF TRANSPORTATION		
ROAD NO.	COUNTY	FINANCIAL PROJECT ID
A1A	BROWARD	

LIGHT POLE DETAILS

SHEET  
NO.

L-17  
CA 121-0935

NOTICE: THE OFFICIAL RECORD OF THIS SHEET IS THE ELECTRONIC FILE SIGNED AND SEALED UNDER RULE 61G15-23.003, F.A.C.