

The Tri-Party RLA/AARLA for this project includes improvements to County right-of-way including driveway paving with header curbs, paver crosswalk, sidewalks, curb & gutter, landscaping including structural soil, and irrigation for approximately 600 LF abutting the west property line of the project on the east side of SW 27<sup>th</sup> Avenue (Riverland Road). The improvement area is approximately 7,836 SF.

These improvements will be installed under County Permit #190719001, a copy of which is on file with DSD and that can be made available upon request.

## LICENSE AREA

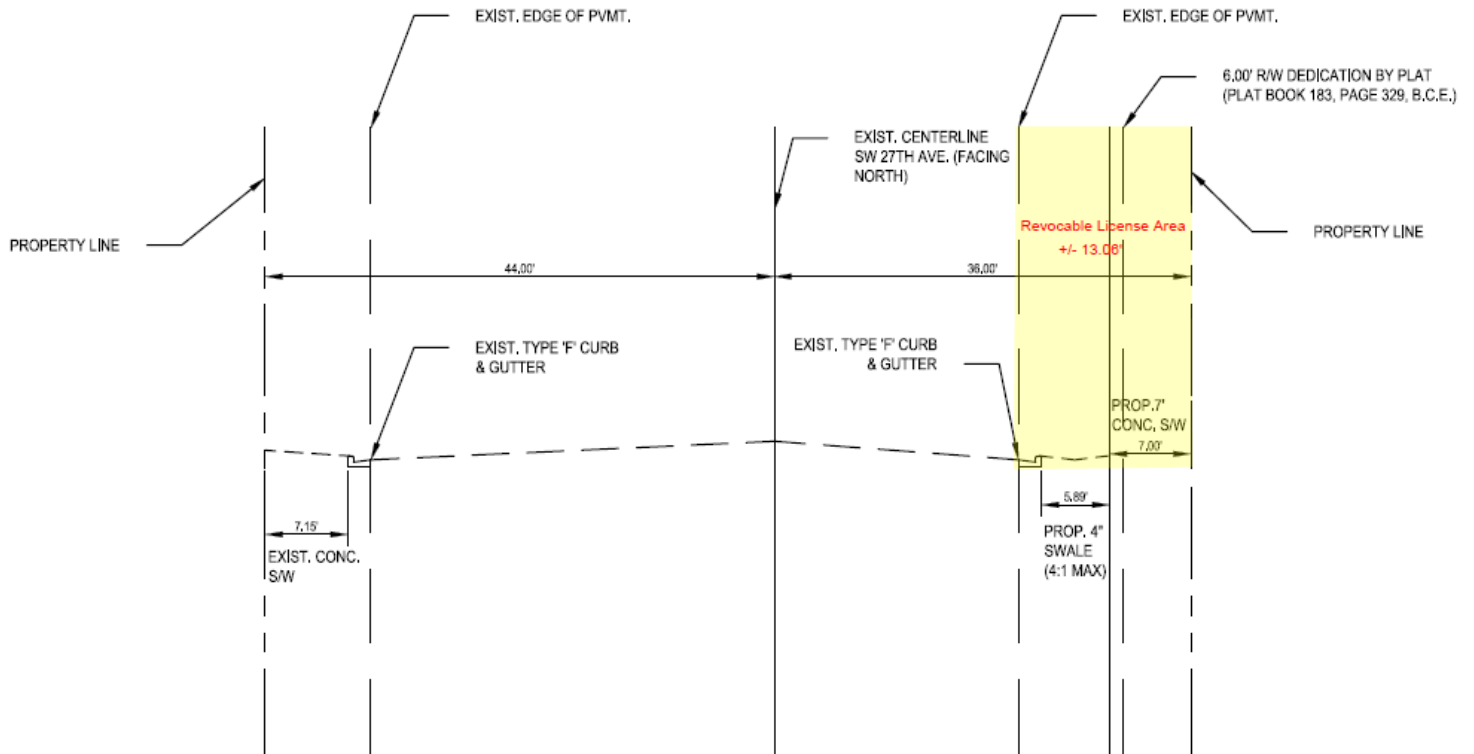

# TYPICAL SECTION

SW 27<sup>th</sup> Avenue (Looking North)