



2937 W. Cypress Creek Rd. | Suite 200 | Fort Lauderdale, FL 33309

May 24, 2021

MR. COREY RITCHIE, PROJECT MANAGER
City of Fort Lauderdale
COMMUNITY REDEVELOPMENT AGENCY
914 NW 6th Street, Suite 200
Fort Lauderdale fl 33311

Via Email: CRitchie@fortlauderdale.gov

RE: **IMPROVEMENTS TO PROVIDENT PARK - NW 6TH STREET**
Design and Post Design Services
ACAI Project No. 19-023 G02

Dear Mr. Ritchie:

As requested, ACAI Associates, Inc. (ACAI) is pleased to provide you with the following proposal for Design and Post Design Services related to improvements to Provident Park, located on N.W. 6th Street (Sistrunk Boulevard) in Fort Lauderdale, Florida – the Project.

It is our understanding the of Scope of Work for this project includes the development of plans and specifications for permitting and bidding along with bidding and contract administration services based on the attached conceptual site plan design. Submittals to be provided to the City include Design Development and 100% Construction Documents.

Services include Architectural, Landscape /Irrigation, Civil, Structural, Electrical and Plumbing Engineering as further outlined in the Consultants proposals attached.

Our hourly not to exceed fee for the above services is One Hundred Sixty Two Thousand Eight Hundred Seventy Dollars **(\$162,870.00)** plus a reimbursable expense allowance of **\$1,000.00** for any printing and other direct project expenses. This fee does not include any unidentified scope including renderings. Any unnamed work or work beyond the scope of services as referenced herein, will require a separate written authorization.

This proposal is based on the following being provided by the City.

1. Geotechnical Testing

We look forward to the opportunity to work with you on this project and are prepared to proceed upon receipt of an Authorization to Proceed. If you have any questions please let us know.

Sincerely,
ACAI ASSOCIATES, INC.

A handwritten signature in black ink, appearing to read "D. Wilkin", is placed over a light gray rectangular background.

Donald Wilkin, RA
Sr Principal

DMW/dmw

Encl: Fee Breakdown and Consultant Proposals

Cc: File – ACAI Associates, Inc.



Monument Pedestal



Entrance Features



Entrance Features



Monument Pedestal



Splash Pad Features



Bandstand Features

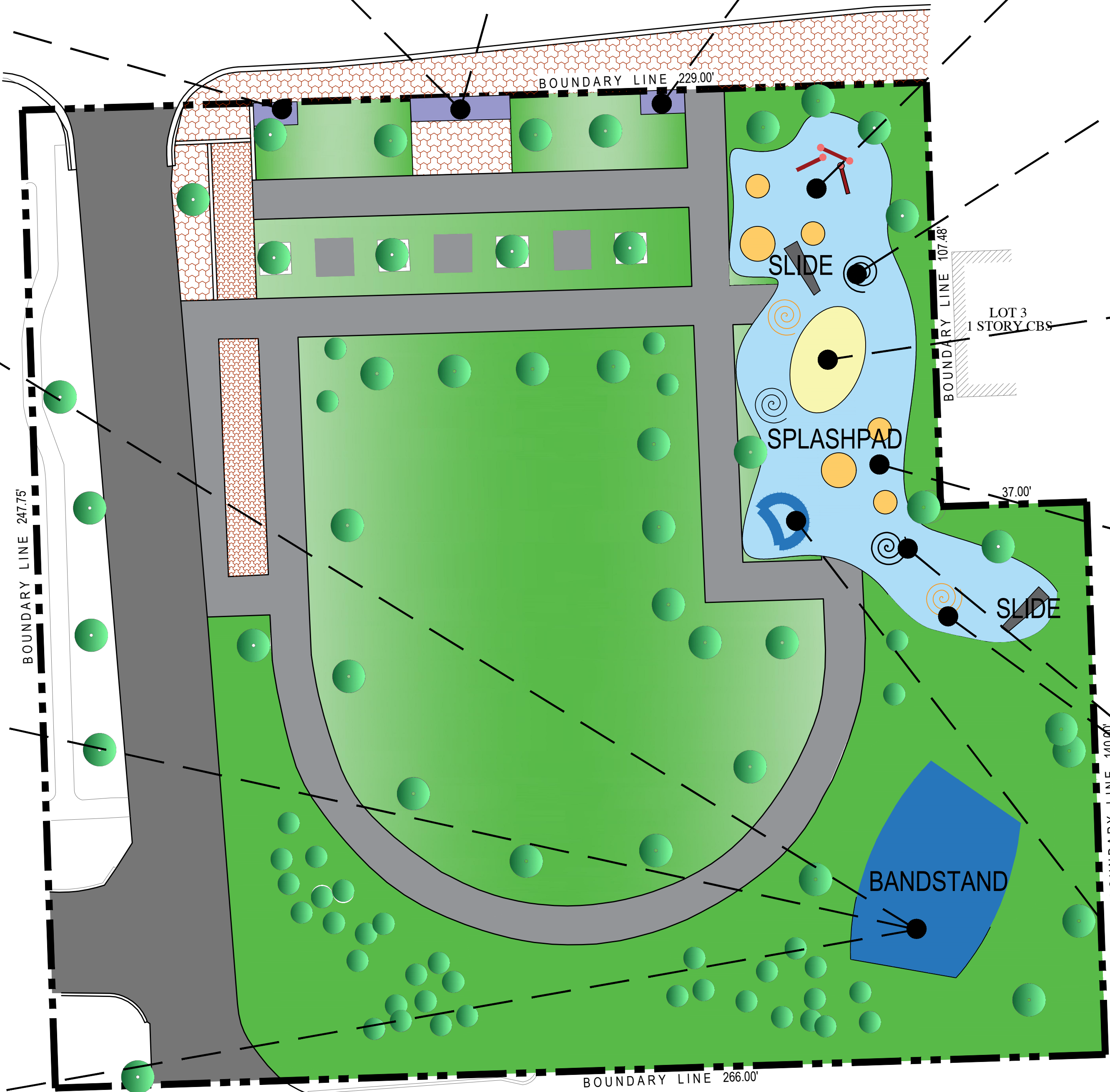

SITE PLAN
SCALE: 1"=20'-0"



SUBMITTALS:		
PHASE	DATE	
REVISIONS:		
NO.	DESCRIPTION	DATE
PROJECT TEAM		
PROFESSIONAL IN CHARGE		
DONALD M. WILKIN		
REGISTRATION		
NUMBER AR-0011619		
APPROVED BY		
DMW		
DESIGNED BY		
ACAI		
DRAWN BY		
NAP		
CHECKED BY		
WRS		

DESIGN CONSULTANT



PROVIDENT
PARK

1412 NW 6TH STREET
FORT LAUDERDALE,
FLORIDA 33311

PROJECT NAME

SITE PLAN

SHEET TITLE

ACAI
associates, inc.
architecture, engineering
roofing, consulting
construction management

AAC001323-EB0004379-CGC010769
2937 W. Cypress Creek Rd., Suite 200
Fort Lauderdale, Florida 33309
Tel. 954.484.4000 • Fax. 954.484.5588
www.acaiarchitects.com

ARCHITECT OF RECORD

19-023 G01

PROJECT NUMBER

SP-100

SHEET NUMBER

TO THE BEST OF MY KNOWLEDGE
AND ABILITY THESE PLANS ARE
COMPLETE AND COMPLY WITH THE
APPLICABLE BUILDING CODES.
COPYRIGHT 2019 BY ACAI ASSOC., INC.

	A	B	C	D	E	F	G	H	I	J	K	L	M	N	O	P	Q	R	S
1																			
2	Provident Park- Ft Lauderdale	ACAI ASSOCIATES												SUBCONSULTANTS					
3	Proj # 19-023 G01. 4.28.21	\$217.00	\$138.00	\$160.00	\$165.00	\$127.00	\$127.00	\$165.00	\$95.00	\$90.00	\$80.00	\$95.00	\$55.00						
4		Principal	Sr Architect	Lead Architect	Project Manager	Architect	BIM Coordinattor	BIM Project Manager	BIM Modeler	Job Captain	Cadd Technician	Spec Writer	Staff Support	MUE Structural Engineer	CES MEP Engineer	Craven Thompson Civil Engineer	CTA Thompson Landscape Arch	SUB- TOTAL HOURS	SUB-TOTAL FEES
5	Design Development (30%)	0	0	0	8	40	0	0	0	0	0	0	0					48	\$6,400.00
6	Construction Documents (60%-90%)	0	0	0	40	120	0	0	0	0	0	32	24					216	\$26,200.00
7	Permitting & Bidding	0	0	0	8	8	0	0	0	0	0	0	0					16	\$2,336.00
8	Construction Administration	0	0	0	16	40	0	0	0	80	0	0	24					160	\$16,240.00
9	Structural Engineering Services													\$20,170.00				0	\$20,170.00
10	MEP Engineering Services														\$24,964.00			0	\$24,964.00
11	Civil Engineering Services															\$34,900.00		0	\$34,900.00
12	Landscape / Irrigation Services															\$29,500.00		0	<u>\$29,500.00</u>
13	Total Services																		\$160,710.00
14	Total Hours																	440	
15																			
16	OPTIONAL SERVICES																		
17	Special / Threshold Inspections (NTE)													\$0.00				0	\$0.00
18	Photodocumentation (NIC)																		\$0.00
19	Site Survey (NIC)															\$0.00			\$0.00
20	Geotech & Ph 1 Environmental (NIC)																		\$0.00
21	Reimbursables																		\$1,000.00
22	Total Optional Services																		\$1,000.00
23																			
24																			

Proposal

April 18, 2021

ACAI Associates, Inc.
2937 W. Cypress Creek Road
Suite 200
Fort Lauderdale, FL 33309
Attention: Mr. Donald Wilkin

Via E-Mail: dwilkin@aecmworld.com

Reference	Project Name:	Provident Park-Sistrunk
	Project Address:	1412 NW 6 th Street, Fort Lauderdale, FL
	MUE PN:	MUE21041501

Dear Mr. Wilkin,

We are pleased to propose the following agreement for providing structural engineering services on this project. This proposal will remain open for acceptance for 30 days from the date above.

MUEngineer's project scope

Our scope and involvement in this project will be limited to the following structural consulting services:

- Design of a monument pedestal and foundation
- Design of an entrance Feature and foundations
- Design of a covered band stand building structure
- Design of foundations for pre-engineered water and playground features as needed.

Engineering Compensation

The fee for these services will be broken down as follows:

- | | |
|--|---------------------------------|
| • Structural Design and Construction Documents (CDs) | |
| ▪ Schematic Design | Fixed fee of \$5,000.00 |
| ▪ Design Development | Fixed fee of \$4,000.00 |
| ▪ Permit Documents | Fixed fee of \$5,750.00 |
| Total Design Fee | Fixed fee of \$14,750.00 |
-

THOROUGH, DETAILED AND COST-EFFICIENT ENGINEERING DELIVERED IN A TIMELY MANNER

• Permit Phase Assistance (limited to response to structural related permit comments)	Fixed fee of \$680,00
• Bidding Assistance (responding to bidders RFIs and attending up to one bidding phase conference call)	Fixed fee of \$680,00
• Construction Administration Services (CA)	
1. Basic CA services (Review and responses to structural related RFIs and shop drawings up to two (X) reviews per submittal and (X) construction administration site visits during construction)	On an as needed and hourly rate basis per our standard rate schedule with an estimated maximum fee of \$4,060.00
2. Extended CA Services (3rd and more resubmittal reviews, addressing construction deficiencies, addressing unforeseen field conditions, review of RFIs not related to the structural design (e.g. RFIs related to unforeseen conditions, mean and methods, design alternates, etc.), owner or contractor requested design changes during construction, attending site meetings)	On an as needed and hourly rate basis per our standard rate schedule
• Time related to value engineering tasks	Not included in our fee and scope
• Time related to private peer reviews and peer reviews demanded by any authorities such as the local building department.	Not included in our fee and scope
• Site visits and attending meetings during construction.	On an as needed and hourly rate basis per our standard rate schedule
• Reimbursable printing and shipping expenses	Fixed fee of \$200.00
• Special Inspections and additional site visits during construction	Not included in our scope and fee; Available as additional service or separate contract with ownership.

Any revisions to the scope of work, additional services, any changes to a portion of the structure for which the structural design has been completed more than 25% or additional services will be done at the prevailing hourly rates for the personnel involved.

Initial: _____





April 26, 2021

Mr. Donald Wilkin
Associate Principal
Acai Architects
2937 W. Cypress Creek Rd. Suite 201
Fort Lauderdale, Florida 33309

Re: City of Fort Lauderdale – Provident Park Renovations and Additions

Dear Don,

We are very pleased to have this opportunity to provide to you this proposal for professional engineering services. It is our understanding that the project is best described as the design of electrical systems to support the renovations at the park including a band shell, splash pad pumps, site lighting and electrical equipment relocations as per your office's email of April 16, 2021. To complete this work, the following items shall be considered as our "Scope of Services" (hereinafter called the "Project") and will be provided by our firm.

SCOPE OF SERVICES -- INCLUDED

1. Contract Documents: We will prepare Contract Documents that shall illustrate the installation of the following systems. These documents will be completed so that the owner can present them to contractors for bidding purposes.
 - A. Plumbing Systems
 - 1) We will coordinate with the project splash pad consultants and design for new water supply to serve the recreational equipment. We will coordinate with the project civil engineer for this work.
 - B. HVAC Systems
 - 1) No Scope.
 - C. Electrical Systems
 - 1) We will prepare plans and specifications for the installation of a new electrical service to provide power to the redesigned park loads including the band shell, splash pad equipment and re-connections to the existing site lighting.
 - 2) We have assumed the band shell will be designed with minimal fixed permanent lighting but will include a company switch for performances, which we will design.
 - 3) We have assumed that we will relocate the existing service equipment, as it is presently in the location of the planned splash pad.
 - 4) We have assumed that we will revise site lighting as needed to accommodate the new park layout.

- D. We will attend periodic progress job meetings with the design professionals and owner's representative, on an as-needed basis, for coordination and progress review
 - E. We will expect REVIT or ACAD compatible drawing files, from your office, for the work within our Scope of Work.
 - F. We will expect equipment cut sheets for ALL of the Owner furnished equipment including the splash pad. The equipment cut sheets must at a minimum indicate size and location of all required utility connections (ie, gas, water, waste and electricity).
2. Bid Period and Construction Administration Services: We will provide the following bid period and construction administration services:
- A. Answer questions during the bid period and issue necessary addenda.
 - B. Attend a Pre-bid conference and walk through with the contractors.
 - C. Shop Drawing review and comment.
 - D. Attend periodic job site visits to observe the progress of construction. We have included seven (7) visits to the site during construction as requested.

SCOPE OF SERVICES -- EXCLUDED

It is our understanding that the following items, in general, are not required by us and have therefore been excluded from our "Scope of Services". Any of these items can be added to our Scope of Services if you so desire.

- 1. We will not be providing engineering services or contract documents for structural, civil or environmental engineering or architectural services for the project.
- 2. We are not providing sprinkler design services.
- 3. We will not be providing engineering services or contract documents for a kitchen exhaust system, grease interceptor, controls or associated equipment.
- 4. We will not be providing multiple sets of review documents for coordination, milestone reviews, inspection agency reviews, submission set reviews, etc. At each review stage we will be providing a single reproducible set of our contract documents. We will not be providing the final printing of the bid documents. Only internal in-house progress printing is included within our fees. Any additional sets of documents will be considered to be a reimbursable expense.
- 5. We will not be providing a life cycle cost analysis.
- 6. We will not be providing a whole building energy model.
- 7. We will not be providing an order of magnitude construction cost estimate for our work.
- 8. We will not be providing consulting services or attending meetings for public forums such as public hearings, planning and zoning, environmental impact assessment, etc.

SCHEDULE FOR COMPLETION OF SCOPE OF SERVICES

We should be able to meet any reasonable schedule you may have at this time. The actual completion dates will be established based on the receipt date by this office of your acceptance of this proposal.

FEES FOR SCOPE OF SERVICES

To complete the Professional Services required for the Project, we propose the following lump sum fees:

Fees for the Portable Classroom Project:

1. Design Development Phase	\$9,976.00
2. 100% Construction Documents Phase	\$8,702.00
3. Permit Comment Phase	\$1,740.00
4. <u>Construction Administration Phase</u>	<u>\$4,546.00</u>
Total Lump Sum Fees	\$24,964.00

April 28, 2021

Mr. Adolfo J. Cotilla, Jr., AIA
ACAI Associates, Inc.
2937 West Cypress Creek Road, Suite 200
Fort Lauderdale, Florida 33309

**RE: PROVIDENT COMMUNITY PARK
FORT LAUDERDALE
CTA PROPOSAL NO. 2021.R04.122 (REVISED)**

Dear Adolfo,

The firm of Craven Thompson & Associates, Inc. (CTA) is pleased to provide you with the following proposal for professional Civil Engineering, Planning, and Landscape Architecture Services for the proposed community park for the City of Fort Lauderdale, located at 1412 NW 6th Street. The site enhancements to the existing Provident community park will include, but not be limited to; a new splash pad, a band shell, entrance and monument features, site lighting, and landscape improvements. This scope of services is for design as well as construction administration of the improvements:

CRAVEN THOMPSON



& ASSOCIATES INC.

Engineers
Planners
Surveyors
Landscape Architects

I. DESIGN DEVELOPMENT (30%)

LANDSCAPE ARCHITECTURAL SERVICES

- 1.1 **Tree Survey Verification (IF REQUIRED)** (CTA Task No. 21070)
Verify that tree survey has accurate up-to-date information necessary to complete tree disposition and landscape plan. Budget includes one (1) site visit at four (4) hours per visit to confirm size, caliper and overall condition of trees. This information will then be updated in the tree survey.

Hourly, Not-to-Exceed.....\$1,200.00

- 1.2 **Design Development Landscape Architecture Plans**
(CTA Task No. 24010)
CTA will prepare a set of Design Development landscape, hardscape, and tree disposition plans. Plans to identify exact plant material and locations. Below is the scope:
- Design Development Tree removal / relocation plan - Task considers relocation of approximately 2-3 trees.
 - Hardscape and site furnishing plan - Task considers furniture, fencing, waste receptacles, and other site furnishings not including monument gateways, splash pad, or site lighting.

Hourly, Not-to-Exceed.....\$3,000.00

3563 NW 53rd Street
Fort Lauderdale, FL 33309-6311
Phone: (954) 739-6400
Fax: (954) 739-6409

- 1.3 Design Development Irrigation Plan (CTA Task No. 21030)
CTA will prepare a set of Design Development irrigation plans. Plans to identify the POC, main line location and size and head layout.
Hourly, Not-to-Exceed..... \$800.00
- 1.4 Meetings with Client, Architect and Agencies (CTA Task No. 24000)
Prepare for and attend coordination meetings and conference calls regarding the proposed project. This task shall include meetings with the Client, site planners, environmentalists, local permitting agencies, and the public. Budget is estimated at five (5) meetings at two (2) hours per meeting including travel time.
Hourly, Not-to-Exceed..... \$1,500.00

CIVIL ENGINEERING SERVICES

- 1.5 Design Development Engineering Plans (CTA Task No. 31020)
Prepare Design Development Engineering plans. The Design Development engineering plans shall include grading, storm drainage, water, sanitary sewer layout.
Hourly, Not-to-Exceed..... \$3,500.00
- 1.6 Meetings with Client, Architect and Agencies (CTA Task No. 31100)
Prepare for and attend coordination meetings and conference calls regarding the proposed project. This task shall include meetings with the Client, site planners, environmentalists, local permitting agencies, and the public.
Hourly, Not-to-Exceed..... \$1,500.00

II. CONSTRUCTION DOCUMENTS

LANDSCAPE ARCHITECTURAL SERVICES

- 2.1 Final Landscape Architecture Plans (CTA Task No. 24030)
Following approval of the design development landscape design, CTA will prepare a set of DRC-required signed and sealed drawings for submittal to the City. The package will include a comprehensive plant list that will supply quantity and plant specifications for all trees and shrubs. Below is the scope:
- Construction Document level Tree removal / relocation plan - Task considers relocation of approximately 2-3 trees.
 - Hardscape and site furnishing plan - Task considers furniture, fencing, waste receptacles, and other site furnishings not including monument gateways, splash pad, or site lighting.
- Hourly, Not-to-Exceed..... \$3,600.00*

- 2.2 Final Irrigation Plans (CTA Task No. 21035)
Prepare Final irrigation plans including details and specifications suitable for bidding and construction.
Hourly, Not-to-Exceed.....\$2,400.00
- 2.3 Prepare Written Specifications (CTA Task No. 24031)
Prepare written specifications for the landscape architectural aspects of the project. Front end documents to be provided by others.
Hourly, Not-to-Exceed.....\$1,200.00
- 2.4 Meetings with Client, Architect and Agencies (CTA Task No. 24000)
Prepare for and attend coordination meetings and conference calls regarding the proposed project. This task shall include meetings with the Client, site planners, environmentalists, local permitting agencies, and the public. Task estimates up to five (5) meetings at two (2) hours per meeting including travel time. Anything additional beyond what is stated above will be considered additional services.
Hourly, Not-to-Exceed.....\$1,500.00

CIVIL ENGINEERING SERVICES

- 2.5 Civil Engineering Plans (CTA Task No. 31011)
Prepare civil engineering drawing and details for the site improvements. The construction drawings shall consist of the following:
- Demolition Plans
 - Final Paving, Grading and Drainage Plans
 - Final Water and Sanitary Sewer Plans
 - Pavement Marking and Signage Plan
 - Fire Access Plan
 - Erosion Control
- Hourly, Not-to-Exceed \$5,500.00*
- 2.6 Meetings with Client, Architect and Agencies (CTA Task No. 31100)
Prepare for and attend coordination meetings and conference calls regarding the proposed project. This task shall include meetings with the Client, site planners, environmentalists, local permitting agencies, and the public.
Hourly, Not-to-Exceed.....\$3,750.00
- 2.7 Prepare Written Specifications (CTA Task No. 31130)
Prepare written specifications for the civil engineering aspects of the project. Front end documents to be provided by others.
Hourly, Not-to-Exceed.....\$2,500.00

III. PERMITTING AND BIDDING

LANDSCAPE ARCHITECTURAL SERVICES

- 3.1 Tree Removal Permit (CTA Task No. 21045)
Prepare and process a tree removal license permit with the City of Fort Lauderdale.
- Hourly, Not-to-Exceed..... \$900.00*
- 3.2 Landscape and Irrigation Permit Assistance (CTA Task No. 21034)
CTA will assist the Client in resolving any landscape or irrigation comments throughout the City permitting process. Task includes providing one (1) comment/response letter addressing the DRC comments and minor plan revisions, if needed. Task includes review of irrigation shop drawings and review of RFI's not to exceed eight (8) hours. Task assumes one (1) meeting at two (2) hours.
- Hourly, Not-to-Exceed..... \$2,400.00*
- 3.3 Landscape Architectural Bidding Assistance (CTA Task No. 31072)
Assist Client with bidding process as needed. This includes addressing comments and attending a pre-bid meeting as necessary or requested by the Client.
- Hourly, Not-to-Exceed..... \$1,200.00*

CIVIL ENGINEERING SERVICES

- 3.4 Prepare and Process Permit Applications (CTA Task No. 31080)
Prepare and process permit applications and supporting documents through state and local agencies including:
- City of Fort Lauderdale Engineering Permit
 - Broward County Traffic Engineering Division
 - South Florida Water Management District - Surface Water
 - Broward County Environmental Protection Department - Surface Water
 - Florida Department of Environmental Protection - Water
- Hourly, Not to Exceed \$5,500.00*
- 3.5 Civil Engineering Bidding Assistance (CTA Task No. 31072)
Assist Client with bidding process as needed. This includes addressing comments and attending a pre-bid meeting as necessary or requested by the Client.
- Hourly, Not-to-Exceed..... \$1,500.00*

IV. **CONSTRUCTION ADMINISTRATION SERVICES**

LANDSCAPE ARCHITECTURAL SERVICES

- 4.1 **Shop Drawing Review** (CTA Task No. 21060)
 Review shop drawing for the landscape, hardscape and irrigation portions of the project.
Hourly, Not-to-Exceed..... \$900.00
- 4.2 **Landscape Construction Observation** (CTA Task No. 21065)
 Perform periodic construction observation for the tree relocation, landscape and hardscape portions of the project. Task assumes one (1) pre-construction meeting at two (2) hours, four (4) progress inspections at two (2) hours each, one (1) final inspection and one (1) punch list inspection at two (2) hours each (including travel time). Anything over the above will be additional services. Any additional site visits over the above will be considered additional service.
Hourly, Not-to-Exceed..... \$2,400.00
- 4.3 **Attend Construction Bi-Weekly Meetings** (CTA Task No. 24000)
 Prepare for and attend coordination meetings and conference calls during the landscape and irrigation construction phase of the project. This task assumes ten (10) meetings with an estimated duration of two (2) hours (includes travel time). Any additional meetings over ten (10) will be considered an additional service.
Hourly, Not-to-Exceed..... \$3,000.00
- 4.4 **Irrigation Construction Observation** (CTA Task No. 21065)
 Perform periodic construction observation for the irrigation installation. Task assumes one (1) preconstruction meeting, two (2) progress meetings, one (1) punch list visit, and one (1) final inspection.
Hourly, Not-to-Exceed..... \$3,500.00

CIVIL ENGINEERING SERVICES

- 4.5 **Construction Observation** (CTA Task No. 31120)
 Provide construction observation for the on-site proposed improvements as required during the course of construction of the project. This includes inspections required by regulatory agencies and principal Governments, observation of testing and reporting of results and final inspection. Inspections will be part-time, approximately two (2) hours per day, two (2) days per week for an anticipated construction schedule of four (4) months to complete construction of all utilities, and roadways. In addition to site inspections, construction services will also include attendance at pre-construction conferences and site meetings, and determination if the improvements are in substantial conformance with the contract plans. Provide project partial and/or final certifications, final close out documents, and submit as-built drawings to appropriate agencies. This does not include preparation of survey information for as-builts. Additional time above and beyond the above stated timeframe will be considered an additional service.
Hourly, Not-to-Exceed..... \$6,950.00

CRANEN-THOMPSON & ASSOCIATES INC.

- 4.6 Attend Construction Bi-Weekly Meetings (CTA Task No. 31100)
Prepare for and attend coordination meetings and conference calls during the construction phase of the project. This task assumes twelve (12) meetings with an estimated duration of two (2) hours (includes travel time). Any additional meetings over twelve (12) will be considered an additional service.

Hourly, Not-to-Exceed..... \$4,200.00

V. MISCELLANEOUS

- 5.1 Reimbursable (CTA Task No. 31140)
Reimbursable expenses such as courier services, mailing of public participation notices, progress prints, permit prints, set of reproducible Mylar, etc.

Estimated Budget..... \$4,000.00

SUMMARY OF FEES

I. DESIGN DEVELOPMENT (30%)

- LANDSCAPE ARCHITECTURAL SERVICES..... \$6,500.00
- CIVIL ENGINEERING SERVICES \$5,000.00

SUBTOTAL - DESIGN DEVELOPMENT..... \$11,500.00

II. CONSTRUCTION DOCUMENTS

- LANDSCAPE ARCHITECTURAL SERVICES..... \$8,700.00
- CIVIL ENGINEERING SERVICES \$11,750.00

SUBTOTAL - CONSTRUCTION DOCUMENTS..... \$20,450.00

III. PERMITTING AND BIDDING

- LANDSCAPE ARCHITECTURAL SERVICES..... \$4,500.00
- CIVIL ENGINEERING SERVICES \$7,000.00

SUBTOTAL - PERMITTING AND BIDDING..... \$11,500.00

IV. CONSTRUCTION ADMINISTRATIVE SERVICES

- LANDSCAPE ARCHITECTURAL SERVICES..... \$9,800.00
- CIVIL ENGINEERING SERVICES \$11,150.00

SUBTOTAL - CONSTRUCTION ADMINISTRATIVE SERVICES..... \$20,950.00

SUB-TOTALS

- LANDSCAPE ARCHITECTURAL SERVICES \$29,500.00
- CIVIL ENGINEERING SERVICES..... \$34,900.00

GRAND TOTAL (not including Reimbursable Expenses)\$64,400.00

CRANEN-THOMPSON & ASSOCIATES INC.