

# Corporate Run 5k Ft. Lauderdale, FL.

5k

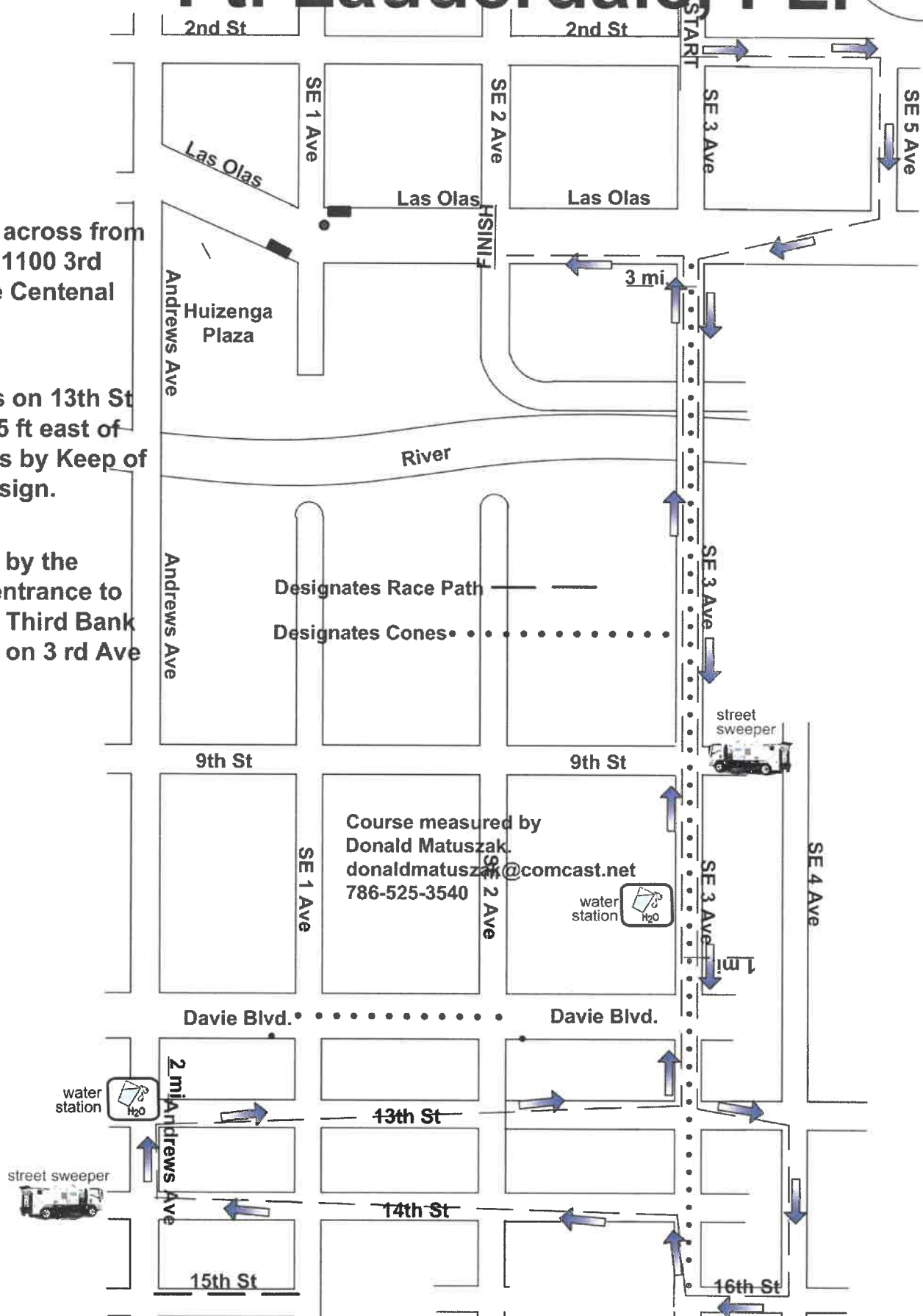

1 mile is across from address 1100 3rd Ave. The Centenal Bank

2 mile is on 13th St about 35 ft east of Andrews by Keep of Median sign.

3 mile is by the garage entrance to the Fifth Third Bank Building on 3 rd Ave

Designates Race Path

Designates Cones

Course measured by  
Donald Matuszak  
donaldmatuszak@comcast.net  
786-525-3540



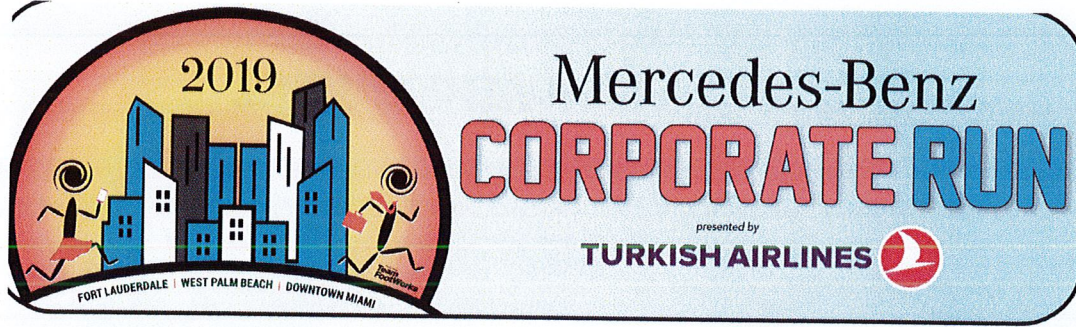

## EAM CAPTAINS: CHECKLIST

do you remember to:

order your custom team shirts from Headsweats?

order any additional tables / chairs / tablecovers / lanterns for your tent?

order food catering for your tent from Game Plan?

register all your participants before the deadline?

organize transportation for your team or determine where to park?

give the fastest 10% of your team members Seeded Wristbands?

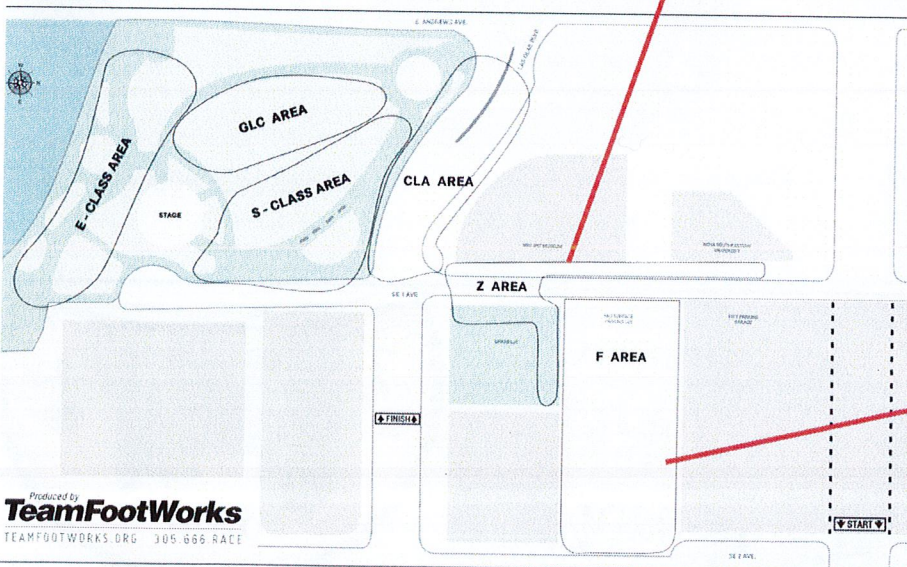

Produced by  
**TeamFootWorks**  
TEAMFOOTWORKS.ORG 305.666.RACE

17	18	19	20a	20b	20c	21	21a	22	23	24	25	26	27	29	30a	30b	31	32	33	34	35a	35b	36	37
WILD FORK FOODS	REES SCHILLER FLOWERS	BYN CONTRA LECTON	UPM/ALDO FOODS	PRINCIPAL SERVICE	AD. SCARPA OF F. INC.	INTERNATIONAL LIGHT	CREATIVE ENDS	GRAT. HENCKENS	ASSOC. ARTS. INC.	SUN. PAPER	BRONKHORST MANAGEMENT	MILLER LOG.	TRIANGLE	HAWES BOOKS	TECH. HEALTH	SHUTTE & BOKAN	PAWESSTAD	REITHMAN GRADES	KAPLAN HEARTH EDUCATION	TFL PARTNERS	HARRIS CHART	TECH. INTL.	MECH. SECURITY	CITY OF MIAMI

### Z AREA

16	15	14	13	12
BRUNARD COLLEGE	TEAM TRIMBLE HEALTH	FLORIDA ATLANTIC UNIVERSITY	FLORIDA ATLANTIC UNIVERSITY	COLE, SCOTT AND ASSOCIATES, PA
11	10	9	8	7
BASS, BRADY & WATERS	INTERNATIONAL POLITICAL CONSULTANTS	RELAND & KNIGHT	BURTON ZIMING	ADREN. TEAM

GRASS LOT

- 6
- 5
- 4
- 3
- 2

33	34	35	36	37	38	39
WILLIS TOWERS WATSON	CONTR. SWANSON	WIC. LEADERS	RETHA	LOTTERY COMMUNICATIONS	AMERICAN COUNCIL	PARADE PRODUCTIONS
21	22	23	24	25	26	27
CHILDS & GIBSON	REUTERS	LEAD PRODUCERS	LEAD PRODUCERS & PARTNERS	TRIP. SCOTT	LEAD PRODUCERS	LEAD PRODUCERS
28	29	20	21	22	23	24
CLARKSON	NEW. INC.	CLARKSON	CLARKSON	CLARKSON	CLARKSON	CLARKSON

### F AREA

CATERING	VALET PARKING
----------	---------------

kindly provided by FAU

SE 2 AVE.



SE 1 AVE

Tent Areas Z and F are located on SE 1st Avenue, just northeast of E Las Olas Blvd and Huizenga Plaza.

Both of these tent areas offer a convenient location near both the start and finish lines.

Area F is located in the FAU surface lot, added in 2017 – due to the overwhelming requests for company team tents, the event needed to reach out to the nearby businesses to secure more tent spaces.





# Mercedes-Benz CORPORATE RUN

presented by  
**TURKISH AIRLINES**

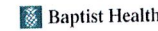

## FORT LAUDERDALE TENT VILLAGE LAYOUT HUIZENGA PLAZA ◦

S. ANDREWS AVE.

LAS OLAS BLVD.

= SPONSOR TENT SPACES

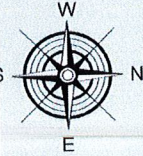

E - CLASS AREA

GLC AREA

S - CLASS AREA

CLA AREA

SE 1 AVE.

Tent Areas Z and F  
can be seen on next page

Produced by  
**TeamFootWorks**  
TEAMFOOTWORKS.ORG 305.666.RACE