

STATE OF FLORIDA  
DEPARTMENT OF TRANSPORTATION

TYPICAL SECTION PACKAGE

FINANCIAL PROJECT ID 435925-1-52-01  
BROWARD COUNTY (86518501 AND 8658502)

PROSPECT ROAD  
FROM SR 870/COMMERCIAL BLVD TO SR 811/ N. DIXIE HWY

APPROVED BY:

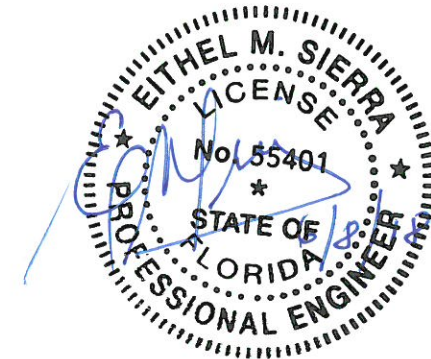

ENGINEER OF RECORD:  
EITHEL M. SIERRA, P.E. NO. 55401

A&P CONSULTING TRANSPORTATION ENGINEERS CORP.  
10305 N.W. 41 STREET, SUITE 115  
DORAL, FL 33178  
VENDOR NO: 65-0770583  
CERTIFICATE OF AUTHORIZATION NO. : EB-0007797

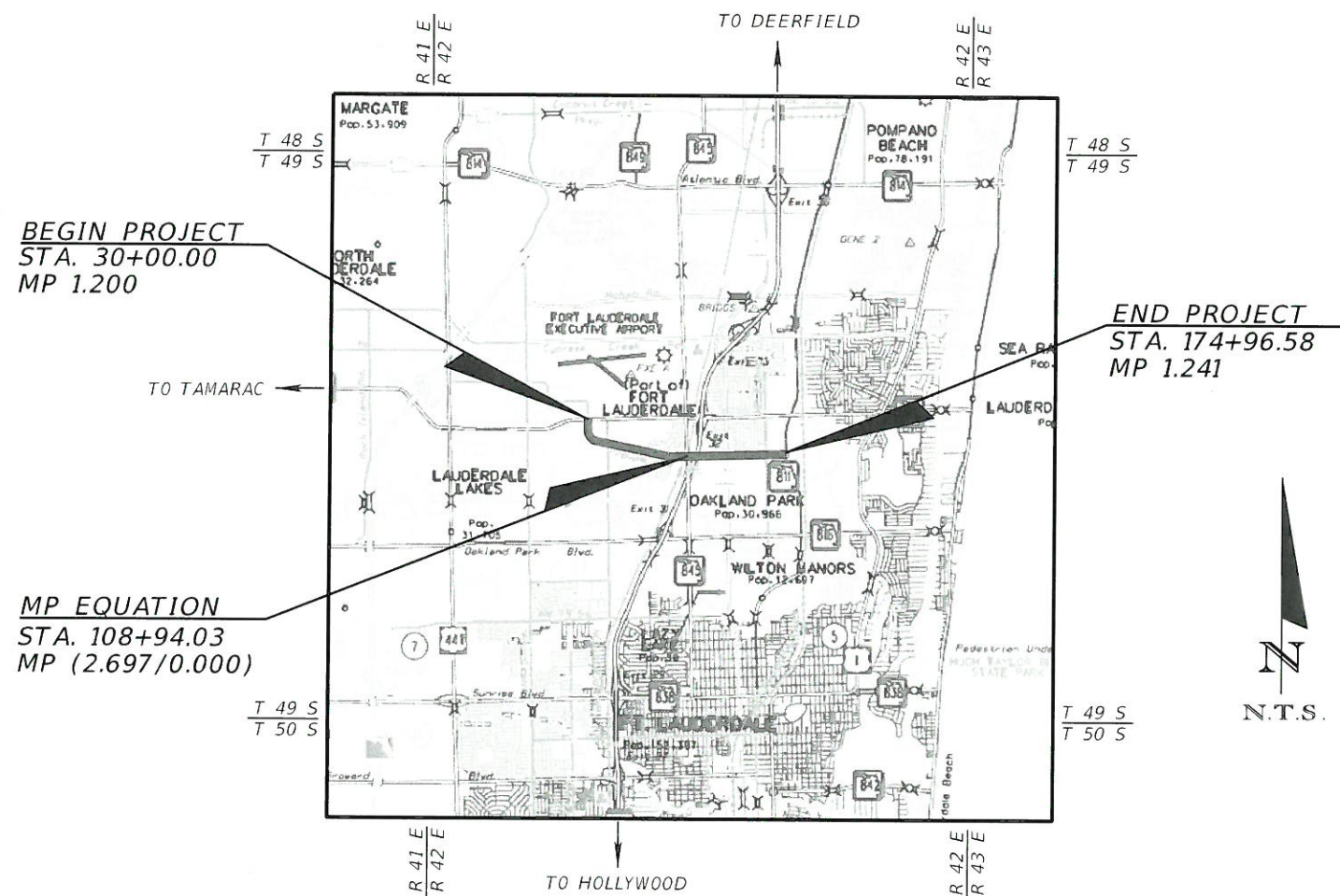

TYPICAL SECTION PACKAGE

SHEET NO	SHEET DESCRIPTION
1	COVER SHEET
2	TYPICAL SECTION NO. 1
3	TYPICAL SECTION NO. 2
4	TYPICAL SECTION NO. 3
5	TYPICAL SECTION NO. 4
6	TYPICAL SECTION NO. 5A
7	TYPICAL SECTION NO. 5B

TYPICAL SECTION CONCURRENCE

_____ RICHARD TORNESE, P.E. BROWARD COUNTY HIGHWAY CONSTRUCTION AND ENGINEERING DIRECTOR	_____ DATE	_____ STEVEN C. BRAUN, P.E. FDOT DISTRICT IV DISTRICT DESIGN ENGINEER	_____ DATE
--	---------------	--	---------------

DESIGN SPEED AND POSTED SPEED CONCURRENCE:

_____ RICHARD TORNESE, P.E. BROWARD COUNTY HIGHWAY CONSTRUCTION AND ENGINEERING DIRECTOR	_____ DATE	_____ STEVEN C. BRAUN, P.E. FDOT DISTRICT IV DISTRICT DESIGN ENGINEER	_____ DATE
--	---------------	--	---------------

SHEET NO.

1



**PROJECT CONTROLS**

**CONTEXT CLASSIFICATION**

- ( ) C1 : NATURAL            ( ) C3C : SUBURBAN COMM.
- ( ) C2 : RURAL             ( ) C4 : URBAN GENERAL
- ( ) C2T : RURAL TOWN    ( ) C5 : URBAN CENTER
- ( ) C3R : SUBURBAN RES. ( ) C6 : URBAN CORE
- ( ) N/A : L.A. FACILITY   (X) N/A : OFF-STATE HIGHWAY SYS.

**FUNCTIONAL CLASSIFICATION**

- ( ) INTERSTATE            ( ) MAJOR COLLECTOR
- ( ) FREEWAY/EXPWY.    ( ) MINOR COLLECTOR
- ( ) PRINCIPAL ARTERIAL ( ) LOCAL
- (X) MINOR ARTERIAL

**HIGHWAY SYSTEM**

- ( ) NATIONAL HIGHWAY SYSTEM
- ( ) STRATEGIC INTERMODAL SYSTEM
- ( ) STATE HIGHWAY SYSTEM
- (X) OFF-STATE HIGHWAY SYSTEM

**ACCESS CLASSIFICATION**

- ( ) 1 - FREEWAY
- ( ) 2 - RESTRICTIVE w/Service Roads
- (X) 3 - RESTRICTIVE w/660 ft. Connection Spacing
- ( ) 4 - NON-RESTRICTIVE w/2640 ft. Signal Spacing
- ( ) 5 - RESTRICTIVE w/440 ft. Connection Spacing
- ( ) 6 - NON-RESTRICTIVE w/1320 ft. Signal Spacing
- ( ) 7 - BOTH MEDIAN TYPES

**CRITERIA**

- ( ) NEW CONSTRUCTION / RECONSTRUCTION
- ( ) RESURFACING (LA FACILITIES)
- ( ) RRR (ARTERIALS & COLLECTORS)
- (X) FLORIDA GREENBOOK

**POTENTIAL EXCEPTIONS AND VARIATIONS RELATED TO TYPICAL SECTION:**

DESIGN VARIATION FOR LANE WIDTH  
DESIGN EXCEPTION FOR CLEAR ZONE

**TYPICAL SECTION No. 1**

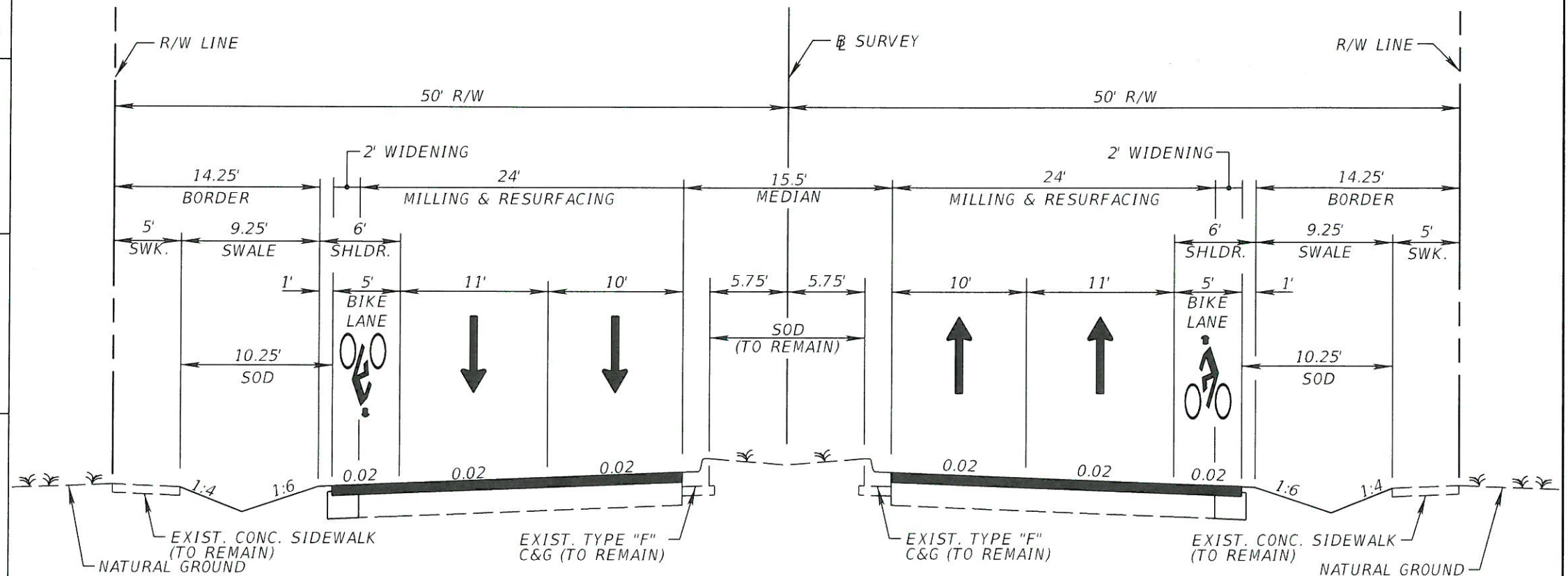

**PROSPECT ROAD**  
STA. 30+00.00 TO STA. 91+00.00

APPROVED BY: EITHEL M. SIERRA, P.E. NO. 55401

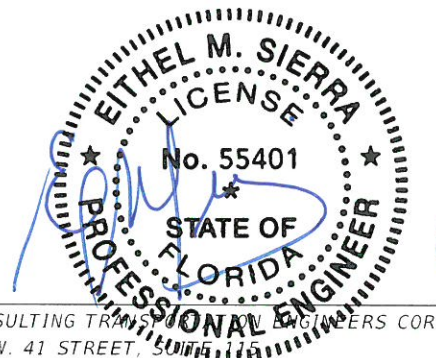

A&P CONSULTING TRAFFIC ENGINEERS CORP. DATE  
10305 N.W. 41 STREET, SUITE 115  
DORAL, FL 33178  
CERTIFICATE OF AUTHORIZATION NO. : EB-0007797

6/8/18

FDOT CONCURRENCE

STEVEN C. BRAUN, P.E. DATE  
FDOT DISTRICT IV  
DISTRICT DESIGN ENGINEER

BROWARD COUNTY CONCURRENCE

RICHARD TORNESE, P.E. DATE  
BROWARD COUNTY HIGHWAY CONSTRUCTION  
AND ENGINEERING  
DIRECTOR

**TRAFFIC DATA**

CURRENT YEAR = 2018 AADT = 16,500  
ESTIMATED OPENING YEAR = 2020 AADT = N/A  
ESTIMATED DESIGN YEAR = 2040 AADT = N/A  
K = 9% D = 51.9% T = 6.2% (24 HOUR)  
DESIGN HOUR T = N/A  
DESIGN SPEED = 45 MPH  
POSTED SPEED = 35 MPH

NOT TO SCALE

FINANCIAL PROJECT ID	SHEET NO.
435925-1-52-01	2

**PROJECT CONTROLS**

**CONTEXT CLASSIFICATION**

- ( ) C1 : NATURAL            ( ) C3C : SUBURBAN COMM.
- ( ) C2 : RURAL             ( ) C4 : URBAN GENERAL
- ( ) C2T : RURAL TOWN    ( ) C5 : URBAN CENTER
- ( ) C3R : SUBURBAN RES. ( ) C6 : URBAN CORE
- ( ) N/A : L.A. FACILITY    (X) N/A : OFF-STATE HIGHWAY SYS.

**FUNCTIONAL CLASSIFICATION**

- ( ) INTERSTATE            ( ) MAJOR COLLECTOR
- ( ) FREEWAY/EXPWY.    ( ) MINOR COLLECTOR
- ( ) PRINCIPAL ARTERIAL ( ) LOCAL
- (X) MINOR ARTERIAL

**HIGHWAY SYSTEM**

- ( ) NATIONAL HIGHWAY SYSTEM
- ( ) STRATEGIC INTERMODAL SYSTEM
- ( ) STATE HIGHWAY SYSTEM
- (X) OFF-STATE HIGHWAY SYSTEM

**ACCESS CLASSIFICATION**

- ( ) 1 - FREEWAY
- ( ) 2 - RESTRICTIVE w/Service Roads
- (X) 3 - RESTRICTIVE w/660 ft. Connection Spacing
- ( ) 4 - NON-RESTRICTIVE w/2640 ft. Signal Spacing
- ( ) 5 - RESTRICTIVE w/440 ft. Connection Spacing
- ( ) 6 - NON-RESTRICTIVE w/1320 ft. Signal Spacing
- ( ) 7 - BOTH MEDIAN TYPES

**CRITERIA**

- ( ) NEW CONSTRUCTION / RECONSTRUCTION
- ( ) RESURFACING (LA FACILITIES)
- ( ) RRR (ARTERIALS & COLLECTORS)
- (X) FLORIDA GREENBOOK

**TYPICAL SECTION No. 2**

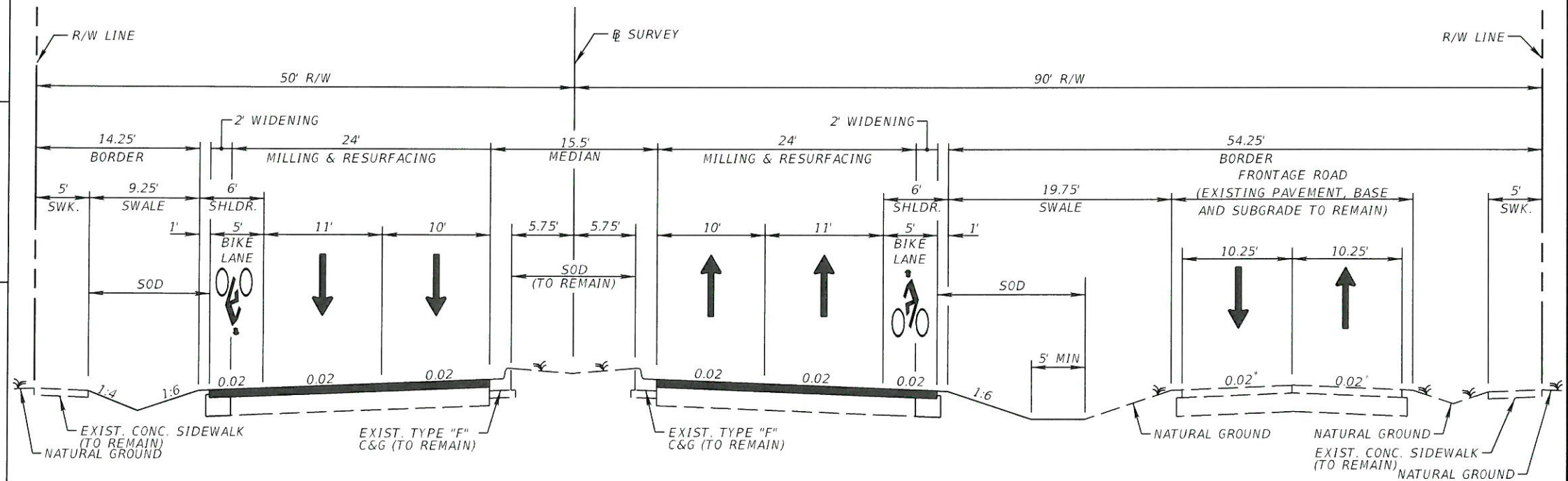

\* MATCH EXISTING PAVEMENT CROSS SLOPE.

**PROSPECT ROAD  
STA. 91+00.00 TO STA. 99+25.00**

**POTENTIAL EXCEPTIONS AND VARIATIONS RELATED TO TYPICAL SECTION:**

DESIGN VARIATION FOR LANE WIDTH  
DESIGN EXCEPTION FOR CLEAR ZONE

APPROVED BY: EITHEL M. SIERRA, P.E. NO. 55401

FDOT CONCURRENCE

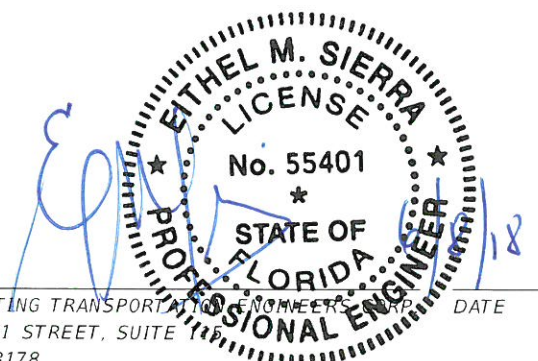

A&P CONSULTING TRANSPORTATION ENGINEERS, INC. DATE  
10305 N.W. 41 STREET, SUITE 100  
DORAL, FL 33178  
CERTIFICATE OF AUTHORIZATION NO. : EB-0007797

STEVEN C. BRAUN, P.E. DATE  
FDOT DISTRICT IV  
DISTRICT DESIGN ENGINEER

BROWARD COUNTY CONCURRENCE

RICHARD TORNESE, P.E. DATE  
BROWARD COUNTY HIGHWAY CONSTRUCTION  
AND ENGINEERING  
DIRECTOR

**TRAFFIC DATA**

CURRENT YEAR = 2018 ADT = 16,500  
ESTIMATED OPENING YEAR = 2020 ADT = N/A  
ESTIMATED DESIGN YEAR = 2040 ADT = N/A  
K = 9% D = 51.9% T = 6.2% (24 HOUR)  
DESIGN HOUR T = N/A  
DESIGN SPEED = 45 MPH  
POSTED SPEED = 35 MPH

NOT TO SCALE

FINANCIAL PROJECT ID	SHEET NO.
435925-1-52-01	3