

SECTION No.: 86050000  
S.R. No.: A1A  
PERMIT No: 2017-L-491-010  
COUNTY: BROWARD

**DISTRICT FOUR (4) AMENDMENT NUMBER ELEVEN (11) TO STATE OF FLORIDA  
DEPARTMENT OF TRANSPORTATION LANDSCAPE INCLUSIVE  
MEMORANDUM OF AGREEMENT**

**THIS AMENDMENT** Number Eleven (11) to the Agreement dated January 31, 2008, made and entered into this \_\_\_\_\_ day of \_\_\_\_\_ 20\_\_\_\_ by and between the State of Florida Department of Transportation hereinafter called the DEPARTMENT and the **CITY OF FORT LAUDERDALE**, a municipal corporation of the State of Florida, hereinafter called the AGENCY.

**W I T N E S S E T H**

**WHEREAS**, the parties entered into the Landscape Inclusive Maintenance of Agreement dated, January 31, 2008 for the purpose of maintaining the landscape improvements by the AGENCY on State Road A1A; and,

**WHEREAS**, the DEPARTMENT and the AGENCY have agreed to add additional landscape improvements to be installed on State Road A1A in accordance with the above referenced Agreement; and,

**WHEREAS**, the AGENCY by Resolution No. \_\_\_\_\_ dated \_\_\_\_\_, attached hereto and by this reference made a part hereof, desires to enter into this Agreement and authorized its officers to do so; and,

**NOW THEREFORE**, for and in consideration of mutual benefits that flow each to the other, the parties covenant and agree as follows:

1. The DEPARTMENT shall modify the Inclusive Landscape Maintenance Memorandum of Agreement for State Road A1A dated January 31, 2008 by adding the following provision:

**ADJACENT PROPERTY OWNER IMPROVEMENTS**

The DEPARTMENT may allow an adjacent property owner to construct additional landscape improvements within the limits of the right of way identified in **Exhibit "A"** of this Agreement that the AGENCY shall be responsible for maintaining under this Agreement, subject to the following conditions:

- (a) Plans for any new landscape improvements shall be subject to approval by the DEPARTMENT and shall require a valid permit attached with a letter of consent to said plans by the AGENCY. The plans shall not be changed or deviated from without written approval by the DEPARTMENT and the AGENCY.
  - (b) All landscape improvements shall be developed and implemented in accordance with appropriate state safety and roadway design standards.
  - (c) The AGENCY agrees to comply with the requirements of this Agreement with regard to any additional landscape improvements installed by an adjacent owner.
2. Pursuant to the provision added in Section of this amendment the AGENCY has agreed to allow the adjacent property owner with the AGENCY'S approval to construct additional landscape improvements or to modify an improvement located as indicated in **Exhibit "A"**, State Road A1A (North Ocean Boulevard from (M.P. 4.619) to (M.P. 4.726), in accordance with the plans attached as **Exhibit "B"**.
- 3 The AGENCY shall agree to maintain the additional landscape improvements in the original Inclusive Agreement described above in accordance with the Maintenance Plan, **Exhibit "C"** of the original agreement and,

Except as modified by this Amendment, all terms and conditions of the original Agreement and all Amendments thereto shall remain in full force and effect.

#### LIST OF EXHIBITS

- Exhibit A - Landscape Improvements Limits and Maintenance Boundaries and Location Map
- Exhibit B - Landscape Improvement Plans

IN WITNESS WHEREOF, the parties hereto have executed this Agreement on the day and year provided below.

AGENCY

CITY OF FORT LAUDERDALE, through its  
CITY COMMISSIONERS

ATTEST:

\_\_\_\_\_  
Jeffrey A. Modarelli, City Clerk

By: \_\_\_\_\_

Dean J. Trantalis, Mayor

\_\_\_\_\_ day of \_\_\_\_\_, 2018

(SEAL)

\_\_\_\_\_  
Lee R. Feldman, City Manager

Approved as to form by Office of City Attorney

By: \_\_\_\_\_

Shari C. Wallen, Assistant City Attorney

STATE OF FLORIDA  
DEPARTMENT OF TRANSPORTATION

By: \_\_\_\_\_

Director of Transportation Development

\_\_\_\_\_ day of \_\_\_\_\_, 2018

Approval:

\_\_\_\_\_  
Office of the General Counsel (Date)

**SECTION No.: 86050000**  
**S.R. No.: A1A**  
**PERMIT No: 2017-L-491-010**  
**COUNTY: BROWARD**

**EXHIBIT A**

**LANDSCAPE IMPROVEMENTS PROJECT LIMITS**

**MAINTENANCE BOUNDARIES LIMITS AND LOCATION MAP**

- I. INCLUSIVE LANDSCAPE MAINTENANCE AGREEMENT LIMITS FOR STATE ROAD A1A:  
State Road A1A from State Road 5 (US 1) (M.P. 0.000) Section 86180000) (US 1) to Flamingo Avenue (M.P. 6.410) (Section 86050000)

By Individual Sections:

Southbound One Way (Section 86050100)

M.P. 0.0000 (Seville Street) to M.P. 0.926 (Bahia Mar Hotel Entrance)

Northbound One Way / Seabreeze Boulevard / 17<sup>th</sup> Street Causeway (Section 86180000):  
M.P. 0.000 (State Road 5) (US 1) to M.P. 2.964 (State Road 842) (Las Olas Boulevard)

North Fort Lauderdale Beach Area (Section 86050000):

M.P. 2.039 (south of Poinsettia Street) to M.P. 6.410 (Flamingo Drive)

- II. PERMIT PROJECT LANDSCAPE PROJECT MAINTENANCE LIMITS FOR THIS PROJECT:

State Road A1A (North Ocean Boulevard from (M.P. 4.619) to (M.P. 4.726)

- III. PERMIT PROJECT LANDSCAPE MAINTENANCE BOUNDARY LIMITS MAP:

\*All limits of the original agreement and amendments shall apply

Please See Attached



**SECTION No.: 86050000**  
**S.R. No.: A1A**  
**PERMIT No: 2017-L-491-010**  
**COUNTY: BROWARD**

**EXHIBIT B**  
**LANDSCAPE IMPROVEMENT PLANS**

The AGENCY agrees to install the landscape improvements in accordance with the plans and specifications attached hereto and incorporated herein.

Please see attached plans prepared by: Nichols Brosch Wurst Wolfe  
Gerardo Javier Delgado, RLA  
Sheets – 1 - 6  
Date: May 31, 2018

And

Nichols Brosch Wurst Wolfe  
Diego Jose Vanderbiest, RLA  
Sheets 7 – 9  
Date: May 30, 2018

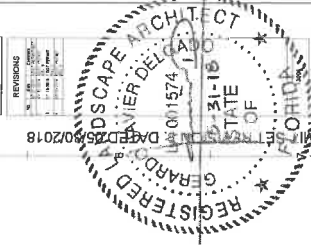

DATE: 02/25/2018

FOOT PERMIT NUMBER 2017-46150

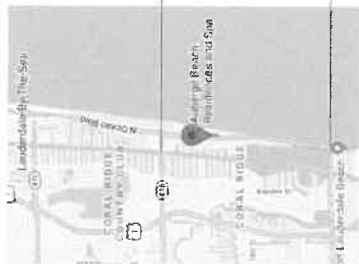
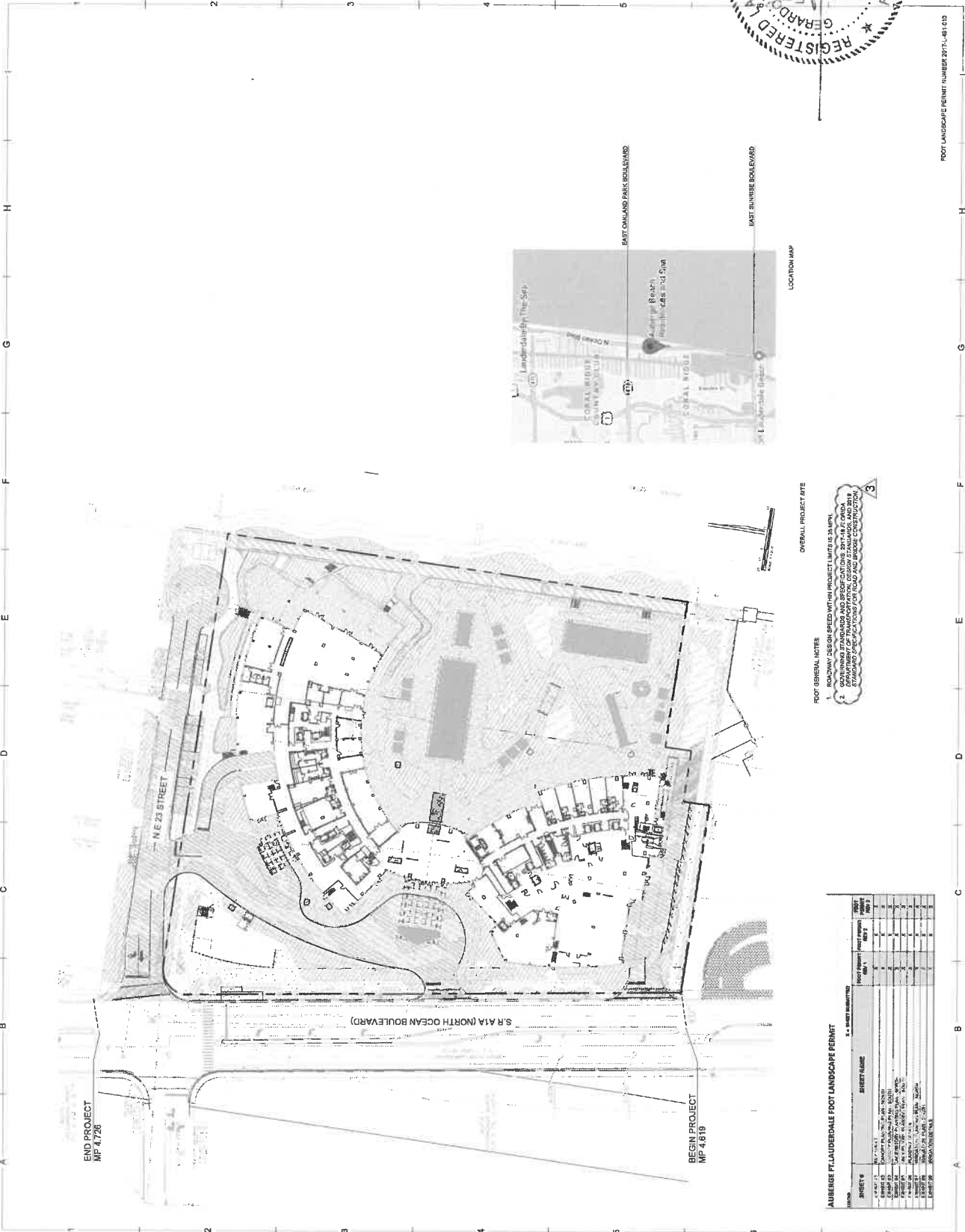

LOCATION MAP

FOOT GENERAL NOTES:  
 1. ROADWAY DESIGN SPEED WITHIN PROJECT LIMITS IS 34 MPH.  
 2. ALL DISTANCES ARE IN FEET.  
 3. ALL DISTANCES ARE IN FEET.  
 4. ALL DISTANCES ARE IN FEET.  
 5. ALL DISTANCES ARE IN FEET.

OVERALL PROJECT SITE

**AUBERGE FT LAUDERDALE FOOT LANDSCAPE PERMIT**

SHEET #	SHEET NAME	FOOT PERMIT	DATE
1	GENERAL NOTES	2017	02/25/2018
2	GENERAL NOTES	2017	02/25/2018
3	GENERAL NOTES	2017	02/25/2018
4	GENERAL NOTES	2017	02/25/2018
5	GENERAL NOTES	2017	02/25/2018
6	GENERAL NOTES	2017	02/25/2018
7	GENERAL NOTES	2017	02/25/2018
8	GENERAL NOTES	2017	02/25/2018
9	GENERAL NOTES	2017	02/25/2018
10	GENERAL NOTES	2017	02/25/2018
11	GENERAL NOTES	2017	02/25/2018
12	GENERAL NOTES	2017	02/25/2018
13	GENERAL NOTES	2017	02/25/2018
14	GENERAL NOTES	2017	02/25/2018
15	GENERAL NOTES	2017	02/25/2018
16	GENERAL NOTES	2017	02/25/2018
17	GENERAL NOTES	2017	02/25/2018
18	GENERAL NOTES	2017	02/25/2018
19	GENERAL NOTES	2017	02/25/2018
20	GENERAL NOTES	2017	02/25/2018
21	GENERAL NOTES	2017	02/25/2018
22	GENERAL NOTES	2017	02/25/2018
23	GENERAL NOTES	2017	02/25/2018
24	GENERAL NOTES	2017	02/25/2018
25	GENERAL NOTES	2017	02/25/2018
26	GENERAL NOTES	2017	02/25/2018
27	GENERAL NOTES	2017	02/25/2018
28	GENERAL NOTES	2017	02/25/2018
29	GENERAL NOTES	2017	02/25/2018
30	GENERAL NOTES	2017	02/25/2018
31	GENERAL NOTES	2017	02/25/2018
32	GENERAL NOTES	2017	02/25/2018
33	GENERAL NOTES	2017	02/25/2018
34	GENERAL NOTES	2017	02/25/2018
35	GENERAL NOTES	2017	02/25/2018
36	GENERAL NOTES	2017	02/25/2018
37	GENERAL NOTES	2017	02/25/2018
38	GENERAL NOTES	2017	02/25/2018
39	GENERAL NOTES	2017	02/25/2018
40	GENERAL NOTES	2017	02/25/2018
41	GENERAL NOTES	2017	02/25/2018
42	GENERAL NOTES	2017	02/25/2018
43	GENERAL NOTES	2017	02/25/2018
44	GENERAL NOTES	2017	02/25/2018
45	GENERAL NOTES	2017	02/25/2018
46	GENERAL NOTES	2017	02/25/2018
47	GENERAL NOTES	2017	02/25/2018
48	GENERAL NOTES	2017	02/25/2018
49	GENERAL NOTES	2017	02/25/2018
50	GENERAL NOTES	2017	02/25/2018
51	GENERAL NOTES	2017	02/25/2018
52	GENERAL NOTES	2017	02/25/2018
53	GENERAL NOTES	2017	02/25/2018
54	GENERAL NOTES	2017	02/25/2018
55	GENERAL NOTES	2017	02/25/2018
56	GENERAL NOTES	2017	02/25/2018
57	GENERAL NOTES	2017	02/25/2018
58	GENERAL NOTES	2017	02/25/2018
59	GENERAL NOTES	2017	02/25/2018
60	GENERAL NOTES	2017	02/25/2018
61	GENERAL NOTES	2017	02/25/2018
62	GENERAL NOTES	2017	02/25/2018
63	GENERAL NOTES	2017	02/25/2018
64	GENERAL NOTES	2017	02/25/2018
65	GENERAL NOTES	2017	02/25/2018
66	GENERAL NOTES	2017	02/25/2018
67	GENERAL NOTES	2017	02/25/2018
68	GENERAL NOTES	2017	02/25/2018
69	GENERAL NOTES	2017	02/25/2018
70	GENERAL NOTES	2017	02/25/2018
71	GENERAL NOTES	2017	02/25/2018
72	GENERAL NOTES	2017	02/25/2018
73	GENERAL NOTES	2017	02/25/2018
74	GENERAL NOTES	2017	02/25/2018
75	GENERAL NOTES	2017	02/25/2018
76	GENERAL NOTES	2017	02/25/2018
77	GENERAL NOTES	2017	02/25/2018
78	GENERAL NOTES	2017	02/25/2018
79	GENERAL NOTES	2017	02/25/2018
80	GENERAL NOTES	2017	02/25/2018
81	GENERAL NOTES	2017	02/25/2018
82	GENERAL NOTES	2017	02/25/2018
83	GENERAL NOTES	2017	02/25/2018
84	GENERAL NOTES	2017	02/25/2018
85	GENERAL NOTES	2017	02/25/2018
86	GENERAL NOTES	2017	02/25/2018
87	GENERAL NOTES	2017	02/25/2018
88	GENERAL NOTES	2017	02/25/2018
89	GENERAL NOTES	2017	02/25/2018
90	GENERAL NOTES	2017	02/25/2018
91	GENERAL NOTES	2017	02/25/2018
92	GENERAL NOTES	2017	02/25/2018
93	GENERAL NOTES	2017	02/25/2018
94	GENERAL NOTES	2017	02/25/2018
95	GENERAL NOTES	2017	02/25/2018
96	GENERAL NOTES	2017	02/25/2018
97	GENERAL NOTES	2017	02/25/2018
98	GENERAL NOTES	2017	02/25/2018
99	GENERAL NOTES	2017	02/25/2018
100	GENERAL NOTES	2017	02/25/2018

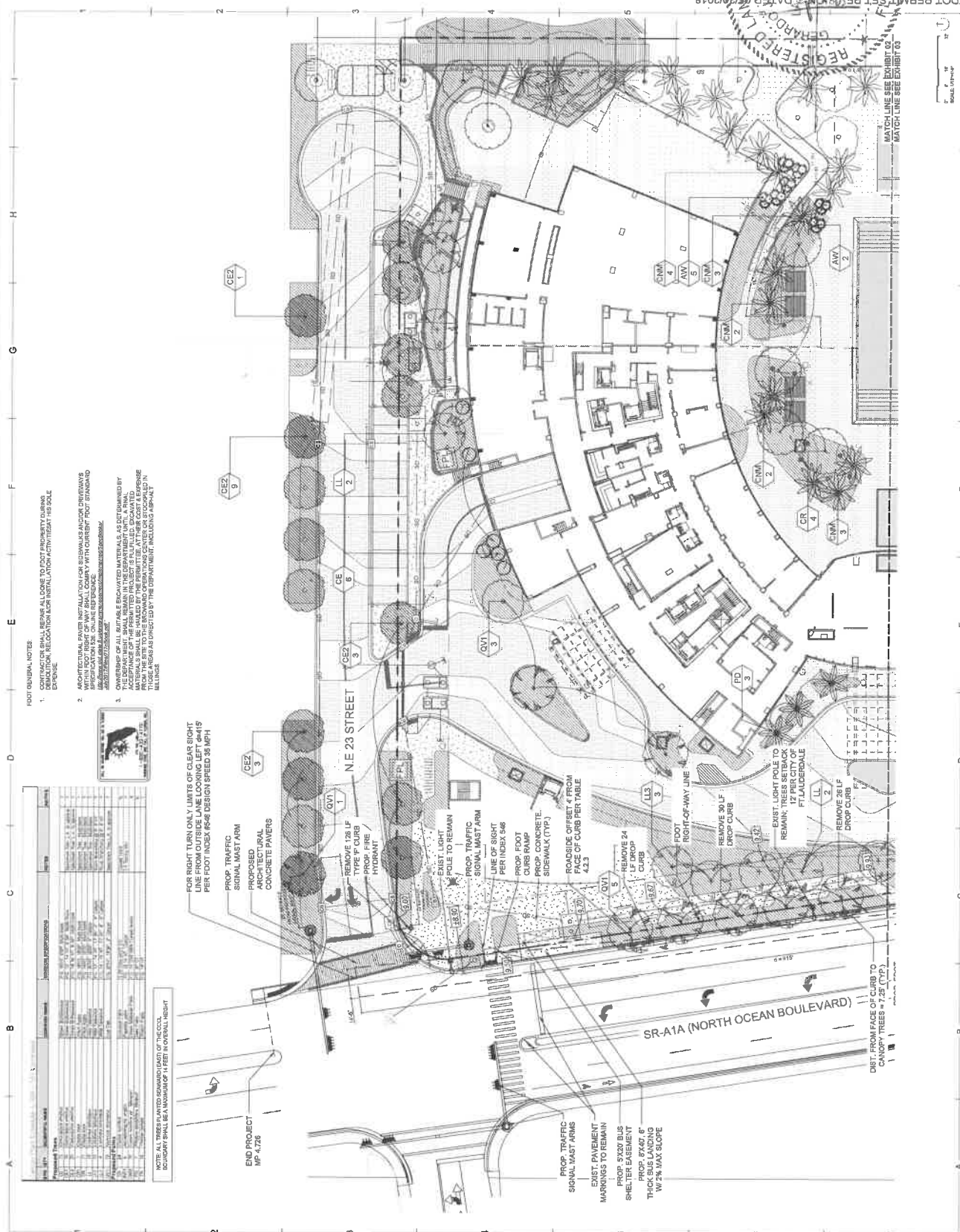

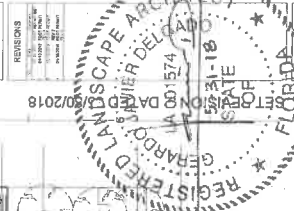

**FOOT GENERAL NOTES**

1. CONTRACTOR SHALL REPAIR ALL DONE TO FOOT PROPERTY DURING CONSTRUCTION. RELOCATION AND INSTALLATION ACTIVITIES ARE SOLE RESPONSIBILITY.
2. ARCHITECTURAL PAVEMENT INSTALLATION FOR SIDEWALKS AND/OR DRIVEWAYS WITHIN FOOT RIGHT OF WAY SHALL COMPLY WITH CURRENT FOOT STANDARD SPECIFICATIONS. ALL MATERIALS AND METHODS SHALL BE APPROVED BY THE DEPARTMENT OF TRANSPORTATION. MATERIALS SHALL BE MAINTAINED IN THOSE AREAS AS DIRECTED BY THE DEPARTMENT OF TRANSPORTATION. ALL MATERIALS SHALL BE MAINTAINED IN THOSE AREAS AS DIRECTED BY THE DEPARTMENT OF TRANSPORTATION.

NO.	REV.	DATE	DESCRIPTION	BY	CHKD.
1	0	01/18/2018	ISSUED FOR PERMITS	GM	GM
2	1	02/15/2018	REVISED PER COMMENTS	GM	GM
3	2	03/15/2018	REVISED PER COMMENTS	GM	GM
4	3	04/15/2018	REVISED PER COMMENTS	GM	GM
5	4	05/15/2018	REVISED PER COMMENTS	GM	GM
6	5	06/15/2018	REVISED PER COMMENTS	GM	GM
7	6	07/15/2018	REVISED PER COMMENTS	GM	GM
8	7	08/15/2018	REVISED PER COMMENTS	GM	GM
9	8	09/15/2018	REVISED PER COMMENTS	GM	GM
10	9	10/15/2018	REVISED PER COMMENTS	GM	GM
11	10	11/15/2018	REVISED PER COMMENTS	GM	GM
12	11	12/15/2018	REVISED PER COMMENTS	GM	GM
13	12	01/15/2019	REVISED PER COMMENTS	GM	GM
14	13	02/15/2019	REVISED PER COMMENTS	GM	GM
15	14	03/15/2019	REVISED PER COMMENTS	GM	GM
16	15	04/15/2019	REVISED PER COMMENTS	GM	GM
17	16	05/15/2019	REVISED PER COMMENTS	GM	GM
18	17	06/15/2019	REVISED PER COMMENTS	GM	GM
19	18	07/15/2019	REVISED PER COMMENTS	GM	GM
20	19	08/15/2019	REVISED PER COMMENTS	GM	GM
21	20	09/15/2019	REVISED PER COMMENTS	GM	GM
22	21	10/15/2019	REVISED PER COMMENTS	GM	GM
23	22	11/15/2019	REVISED PER COMMENTS	GM	GM
24	23	12/15/2019	REVISED PER COMMENTS	GM	GM
25	24	01/15/2020	REVISED PER COMMENTS	GM	GM
26	25	02/15/2020	REVISED PER COMMENTS	GM	GM
27	26	03/15/2020	REVISED PER COMMENTS	GM	GM
28	27	04/15/2020	REVISED PER COMMENTS	GM	GM
29	28	05/15/2020	REVISED PER COMMENTS	GM	GM
30	29	06/15/2020	REVISED PER COMMENTS	GM	GM
31	30	07/15/2020	REVISED PER COMMENTS	GM	GM
32	31	08/15/2020	REVISED PER COMMENTS	GM	GM
33	32	09/15/2020	REVISED PER COMMENTS	GM	GM
34	33	10/15/2020	REVISED PER COMMENTS	GM	GM
35	34	11/15/2020	REVISED PER COMMENTS	GM	GM
36	35	12/15/2020	REVISED PER COMMENTS	GM	GM
37	36	01/15/2021	REVISED PER COMMENTS	GM	GM
38	37	02/15/2021	REVISED PER COMMENTS	GM	GM
39	38	03/15/2021	REVISED PER COMMENTS	GM	GM
40	39	04/15/2021	REVISED PER COMMENTS	GM	GM
41	40	05/15/2021	REVISED PER COMMENTS	GM	GM
42	41	06/15/2021	REVISED PER COMMENTS	GM	GM
43	42	07/15/2021	REVISED PER COMMENTS	GM	GM
44	43	08/15/2021	REVISED PER COMMENTS	GM	GM
45	44	09/15/2021	REVISED PER COMMENTS	GM	GM
46	45	10/15/2021	REVISED PER COMMENTS	GM	GM
47	46	11/15/2021	REVISED PER COMMENTS	GM	GM
48	47	12/15/2021	REVISED PER COMMENTS	GM	GM
49	48	01/15/2022	REVISED PER COMMENTS	GM	GM
50	49	02/15/2022	REVISED PER COMMENTS	GM	GM
51	50	03/15/2022	REVISED PER COMMENTS	GM	GM
52	51	04/15/2022	REVISED PER COMMENTS	GM	GM
53	52	05/15/2022	REVISED PER COMMENTS	GM	GM
54	53	06/15/2022	REVISED PER COMMENTS	GM	GM
55	54	07/15/2022	REVISED PER COMMENTS	GM	GM
56	55	08/15/2022	REVISED PER COMMENTS	GM	GM
57	56	09/15/2022	REVISED PER COMMENTS	GM	GM
58	57	10/15/2022	REVISED PER COMMENTS	GM	GM
59	58	11/15/2022	REVISED PER COMMENTS	GM	GM
60	59	12/15/2022	REVISED PER COMMENTS	GM	GM
61	60	01/15/2023	REVISED PER COMMENTS	GM	GM
62	61	02/15/2023	REVISED PER COMMENTS	GM	GM
63	62	03/15/2023	REVISED PER COMMENTS	GM	GM
64	63	04/15/2023	REVISED PER COMMENTS	GM	GM
65	64	05/15/2023	REVISED PER COMMENTS	GM	GM
66	65	06/15/2023	REVISED PER COMMENTS	GM	GM
67	66	07/15/2023	REVISED PER COMMENTS	GM	GM
68	67	08/15/2023	REVISED PER COMMENTS	GM	GM
69	68	09/15/2023	REVISED PER COMMENTS	GM	GM
70	69	10/15/2023	REVISED PER COMMENTS	GM	GM
71	70	11/15/2023	REVISED PER COMMENTS	GM	GM
72	71	12/15/2023	REVISED PER COMMENTS	GM	GM
73	72	01/15/2024	REVISED PER COMMENTS	GM	GM
74	73	02/15/2024	REVISED PER COMMENTS	GM	GM
75	74	03/15/2024	REVISED PER COMMENTS	GM	GM
76	75	04/15/2024	REVISED PER COMMENTS	GM	GM
77	76	05/15/2024	REVISED PER COMMENTS	GM	GM
78	77	06/15/2024	REVISED PER COMMENTS	GM	GM
79	78	07/15/2024	REVISED PER COMMENTS	GM	GM
80	79	08/15/2024	REVISED PER COMMENTS	GM	GM
81	80	09/15/2024	REVISED PER COMMENTS	GM	GM
82	81	10/15/2024	REVISED PER COMMENTS	GM	GM
83	82	11/15/2024	REVISED PER COMMENTS	GM	GM
84	83	12/15/2024	REVISED PER COMMENTS	GM	GM
85	84	01/15/2025	REVISED PER COMMENTS	GM	GM
86	85	02/15/2025	REVISED PER COMMENTS	GM	GM
87	86	03/15/2025	REVISED PER COMMENTS	GM	GM
88	87	04/15/2025	REVISED PER COMMENTS	GM	GM
89	88	05/15/2025	REVISED PER COMMENTS	GM	GM
90	89	06/15/2025	REVISED PER COMMENTS	GM	GM
91	90	07/15/2025	REVISED PER COMMENTS	GM	GM
92	91	08/15/2025	REVISED PER COMMENTS	GM	GM
93	92	09/15/2025	REVISED PER COMMENTS	GM	GM
94	93	10/15/2025	REVISED PER COMMENTS	GM	GM
95	94	11/15/2025	REVISED PER COMMENTS	GM	GM
96	95	12/15/2025	REVISED PER COMMENTS	GM	GM
97	96	01/15/2026	REVISED PER COMMENTS	GM	GM
98	97	02/15/2026	REVISED PER COMMENTS	GM	GM
99	98	03/15/2026	REVISED PER COMMENTS	GM	GM
100	99	04/15/2026	REVISED PER COMMENTS	GM	GM

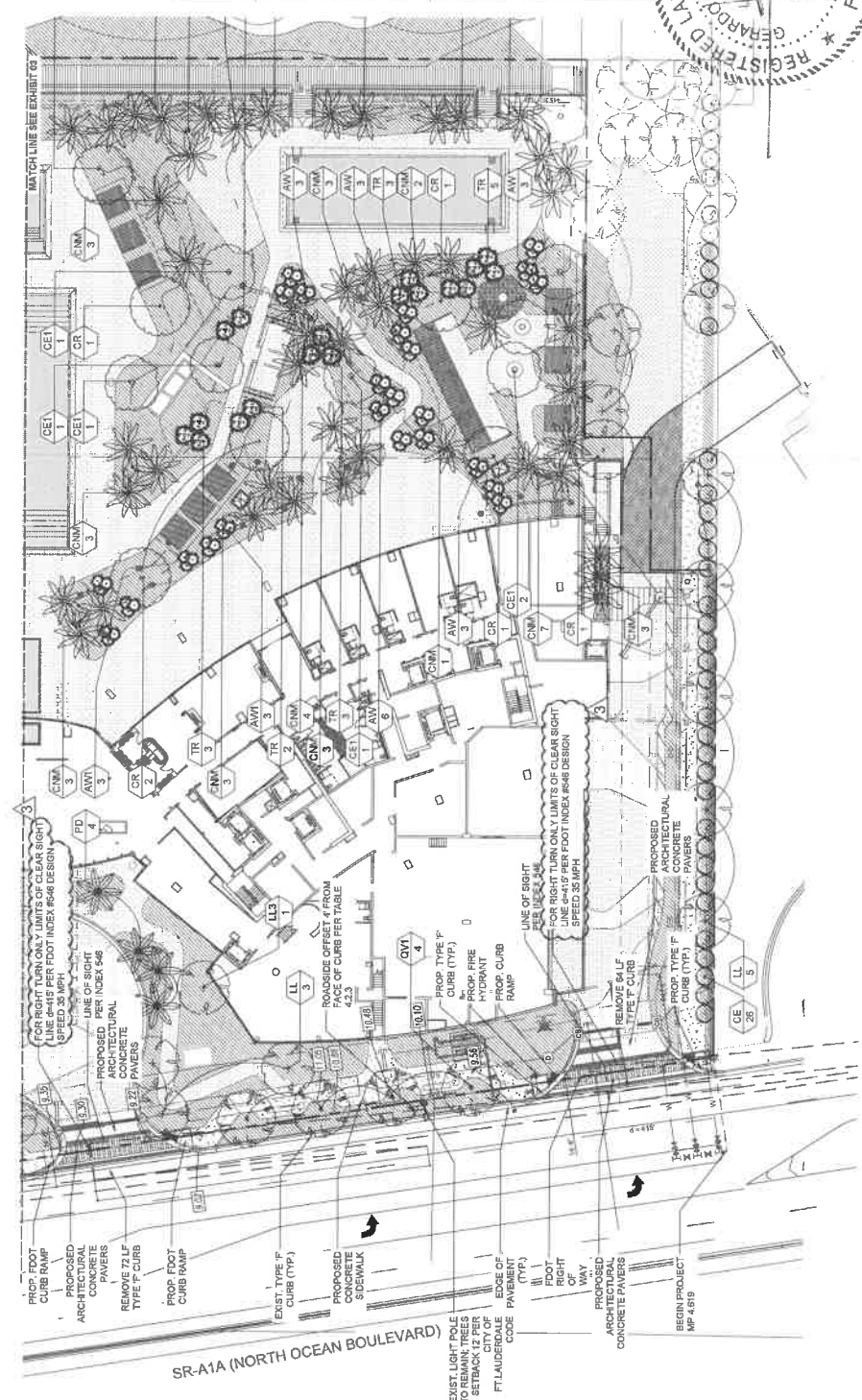



**FOOT GENERAL NOTE**

1. ALL MATERIALS SHALL BE SUBJECT TO FDOT PROPERTY DAMAGE AND CONSTRUCTION DELAY PENALTIES FOR DELAYED COMPLETION. EXPIRATION DATE: 02/20/2018.
2. ARCHITECTURAL PAVES INSTALLATION FOR SIDEWALKS AND CURBS SHALL BE IN ACCORDANCE WITH THE LATEST EDITION OF THE FDOT STANDARD SPECIFICATION FOR CONCRETE AND ASPHALT PAVEMENTS. SPECIFICATION FOR CONCRETE PAVEMENTS SHALL BE USED FOR ALL CONCRETE PAVEMENTS. SPECIFICATION FOR ASPHALT PAVEMENTS SHALL BE USED FOR ALL ASPHALT PAVEMENTS.
3. OWNERSHIP OF ALL MATERIALS EXCAVATED MATERIALS AS DETERMINED BY THE FDOT SHALL BE THE PROPERTY OF THE FDOT. THE FDOT SHALL BE RESPONSIBLE FOR THE REMOVAL OF ALL EXCAVATED MATERIALS. THE FDOT SHALL BE RESPONSIBLE FOR THE REMOVAL OF ALL EXCAVATED MATERIALS. THE FDOT SHALL BE RESPONSIBLE FOR THE REMOVAL OF ALL EXCAVATED MATERIALS.

ITEM NO.	DESCRIPTION	QUANTITY	UNIT	PRICE	TOTAL
1	REMOVE 30 LF DROP CURB	30	LF	150.00	4500.00
2	REMOVE 26 LF DROP CURB	26	LF	150.00	3900.00
3	REMOVE 138 LF TYPE 'F' CURB	138	LF	150.00	20700.00
4	REMOVE 138 LF TYPE 'F' CURB	138	LF	150.00	20700.00
5	REMOVE 138 LF TYPE 'F' CURB	138	LF	150.00	20700.00
6	REMOVE 138 LF TYPE 'F' CURB	138	LF	150.00	20700.00
7	REMOVE 138 LF TYPE 'F' CURB	138	LF	150.00	20700.00
8	REMOVE 138 LF TYPE 'F' CURB	138	LF	150.00	20700.00
9	REMOVE 138 LF TYPE 'F' CURB	138	LF	150.00	20700.00
10	REMOVE 138 LF TYPE 'F' CURB	138	LF	150.00	20700.00
11	REMOVE 138 LF TYPE 'F' CURB	138	LF	150.00	20700.00
12	REMOVE 138 LF TYPE 'F' CURB	138	LF	150.00	20700.00
13	REMOVE 138 LF TYPE 'F' CURB	138	LF	150.00	20700.00
14	REMOVE 138 LF TYPE 'F' CURB	138	LF	150.00	20700.00
15	REMOVE 138 LF TYPE 'F' CURB	138	LF	150.00	20700.00
16	REMOVE 138 LF TYPE 'F' CURB	138	LF	150.00	20700.00
17	REMOVE 138 LF TYPE 'F' CURB	138	LF	150.00	20700.00
18	REMOVE 138 LF TYPE 'F' CURB	138	LF	150.00	20700.00
19	REMOVE 138 LF TYPE 'F' CURB	138	LF	150.00	20700.00
20	REMOVE 138 LF TYPE 'F' CURB	138	LF	150.00	20700.00
21	REMOVE 138 LF TYPE 'F' CURB	138	LF	150.00	20700.00
22	REMOVE 138 LF TYPE 'F' CURB	138	LF	150.00	20700.00
23	REMOVE 138 LF TYPE 'F' CURB	138	LF	150.00	20700.00
24	REMOVE 138 LF TYPE 'F' CURB	138	LF	150.00	20700.00
25	REMOVE 138 LF TYPE 'F' CURB	138	LF	150.00	20700.00
26	REMOVE 138 LF TYPE 'F' CURB	138	LF	150.00	20700.00
27	REMOVE 138 LF TYPE 'F' CURB	138	LF	150.00	20700.00
28	REMOVE 138 LF TYPE 'F' CURB	138	LF	150.00	20700.00
29	REMOVE 138 LF TYPE 'F' CURB	138	LF	150.00	20700.00
30	REMOVE 138 LF TYPE 'F' CURB	138	LF	150.00	20700.00
31	REMOVE 138 LF TYPE 'F' CURB	138	LF	150.00	20700.00
32	REMOVE 138 LF TYPE 'F' CURB	138	LF	150.00	20700.00
33	REMOVE 138 LF TYPE 'F' CURB	138	LF	150.00	20700.00
34	REMOVE 138 LF TYPE 'F' CURB	138	LF	150.00	20700.00
35	REMOVE 138 LF TYPE 'F' CURB	138	LF	150.00	20700.00
36	REMOVE 138 LF TYPE 'F' CURB	138	LF	150.00	20700.00
37	REMOVE 138 LF TYPE 'F' CURB	138	LF	150.00	20700.00
38	REMOVE 138 LF TYPE 'F' CURB	138	LF	150.00	20700.00
39	REMOVE 138 LF TYPE 'F' CURB	138	LF	150.00	20700.00
40	REMOVE 138 LF TYPE 'F' CURB	138	LF	150.00	20700.00
41	REMOVE 138 LF TYPE 'F' CURB	138	LF	150.00	20700.00
42	REMOVE 138 LF TYPE 'F' CURB	138	LF	150.00	20700.00
43	REMOVE 138 LF TYPE 'F' CURB	138	LF	150.00	20700.00
44	REMOVE 138 LF TYPE 'F' CURB	138	LF	150.00	20700.00
45	REMOVE 138 LF TYPE 'F' CURB	138	LF	150.00	20700.00
46	REMOVE 138 LF TYPE 'F' CURB	138	LF	150.00	20700.00
47	REMOVE 138 LF TYPE 'F' CURB	138	LF	150.00	20700.00
48	REMOVE 138 LF TYPE 'F' CURB	138	LF	150.00	20700.00
49	REMOVE 138 LF TYPE 'F' CURB	138	LF	150.00	20700.00
50	REMOVE 138 LF TYPE 'F' CURB	138	LF	150.00	20700.00
51	REMOVE 138 LF TYPE 'F' CURB	138	LF	150.00	20700.00
52	REMOVE 138 LF TYPE 'F' CURB	138	LF	150.00	20700.00
53	REMOVE 138 LF TYPE 'F' CURB	138	LF	150.00	20700.00
54	REMOVE 138 LF TYPE 'F' CURB	138	LF	150.00	20700.00
55	REMOVE 138 LF TYPE 'F' CURB	138	LF	150.00	20700.00
56	REMOVE 138 LF TYPE 'F' CURB	138	LF	150.00	20700.00
57	REMOVE 138 LF TYPE 'F' CURB	138	LF	150.00	20700.00
58	REMOVE 138 LF TYPE 'F' CURB	138	LF	150.00	20700.00
59	REMOVE 138 LF TYPE 'F' CURB	138	LF	150.00	20700.00
60	REMOVE 138 LF TYPE 'F' CURB	138	LF	150.00	20700.00
61	REMOVE 138 LF TYPE 'F' CURB	138	LF	150.00	20700.00
62	REMOVE 138 LF TYPE 'F' CURB	138	LF	150.00	20700.00
63	REMOVE 138 LF TYPE 'F' CURB	138	LF	150.00	20700.00
64	REMOVE 138 LF TYPE 'F' CURB	138	LF	150.00	20700.00
65	REMOVE 138 LF TYPE 'F' CURB	138	LF	150.00	20700.00
66	REMOVE 138 LF TYPE 'F' CURB	138	LF	150.00	20700.00
67	REMOVE 138 LF TYPE 'F' CURB	138	LF	150.00	20700.00
68	REMOVE 138 LF TYPE 'F' CURB	138	LF	150.00	20700.00
69	REMOVE 138 LF TYPE 'F' CURB	138	LF	150.00	20700.00
70	REMOVE 138 LF TYPE 'F' CURB	138	LF	150.00	20700.00
71	REMOVE 138 LF TYPE 'F' CURB	138	LF	150.00	20700.00
72	REMOVE 138 LF TYPE 'F' CURB	138	LF	150.00	20700.00
73	REMOVE 138 LF TYPE 'F' CURB	138	LF	150.00	20700.00
74	REMOVE 138 LF TYPE 'F' CURB	138	LF	150.00	20700.00
75	REMOVE 138 LF TYPE 'F' CURB	138	LF	150.00	20700.00
76	REMOVE 138 LF TYPE 'F' CURB	138	LF	150.00	20700.00
77	REMOVE 138 LF TYPE 'F' CURB	138	LF	150.00	20700.00
78	REMOVE 138 LF TYPE 'F' CURB	138	LF	150.00	20700.00
79	REMOVE 138 LF TYPE 'F' CURB	138	LF	150.00	20700.00
80	REMOVE 138 LF TYPE 'F' CURB	138	LF	150.00	20700.00
81	REMOVE 138 LF TYPE 'F' CURB	138	LF	150.00	20700.00
82	REMOVE 138 LF TYPE 'F' CURB	138	LF	150.00	20700.00
83	REMOVE 138 LF TYPE 'F' CURB	138	LF	150.00	20700.00
84	REMOVE 138 LF TYPE 'F' CURB	138	LF	150.00	20700.00
85	REMOVE 138 LF TYPE 'F' CURB	138	LF	150.00	20700.00
86	REMOVE 138 LF TYPE 'F' CURB	138	LF	150.00	20700.00
87	REMOVE 138 LF TYPE 'F' CURB	138	LF	150.00	20700.00
88	REMOVE 138 LF TYPE 'F' CURB	138	LF	150.00	20700.00
89	REMOVE 138 LF TYPE 'F' CURB	138	LF	150.00	20700.00
90	REMOVE 138 LF TYPE 'F' CURB	138	LF	150.00	20700.00
91	REMOVE 138 LF TYPE 'F' CURB	138	LF	150.00	20700.00
92	REMOVE 138 LF TYPE 'F' CURB	138	LF	150.00	20700.00
93	REMOVE 138 LF TYPE 'F' CURB	138	LF	150.00	20700.00
94	REMOVE 138 LF TYPE 'F' CURB	138	LF	150.00	20700.00
95	REMOVE 138 LF TYPE 'F' CURB	138	LF	150.00	20700.00
96	REMOVE 138 LF TYPE 'F' CURB	138	LF	150.00	20700.00
97	REMOVE 138 LF TYPE 'F' CURB	138	LF	150.00	20700.00
98	REMOVE 138 LF TYPE 'F' CURB	138	LF	150.00	20700.00
99	REMOVE 138 LF TYPE 'F' CURB	138	LF	150.00	20700.00
100	REMOVE 138 LF TYPE 'F' CURB	138	LF	150.00	20700.00

FOR RIGHT TURN ONLY LIMITS OF CLEAR SIGHT LINE FROM OUTSIDE LANE LOOKING LEFT 8-415 PER FOOT INDEX #546 DESIGN SPEED 35 MPH

PROP. TRAFFIC SIGNAL MAST ARM  
PROPOSED ARCHITECTURAL CONCRETE PAVERS

END PROJECT  
MP 4.726

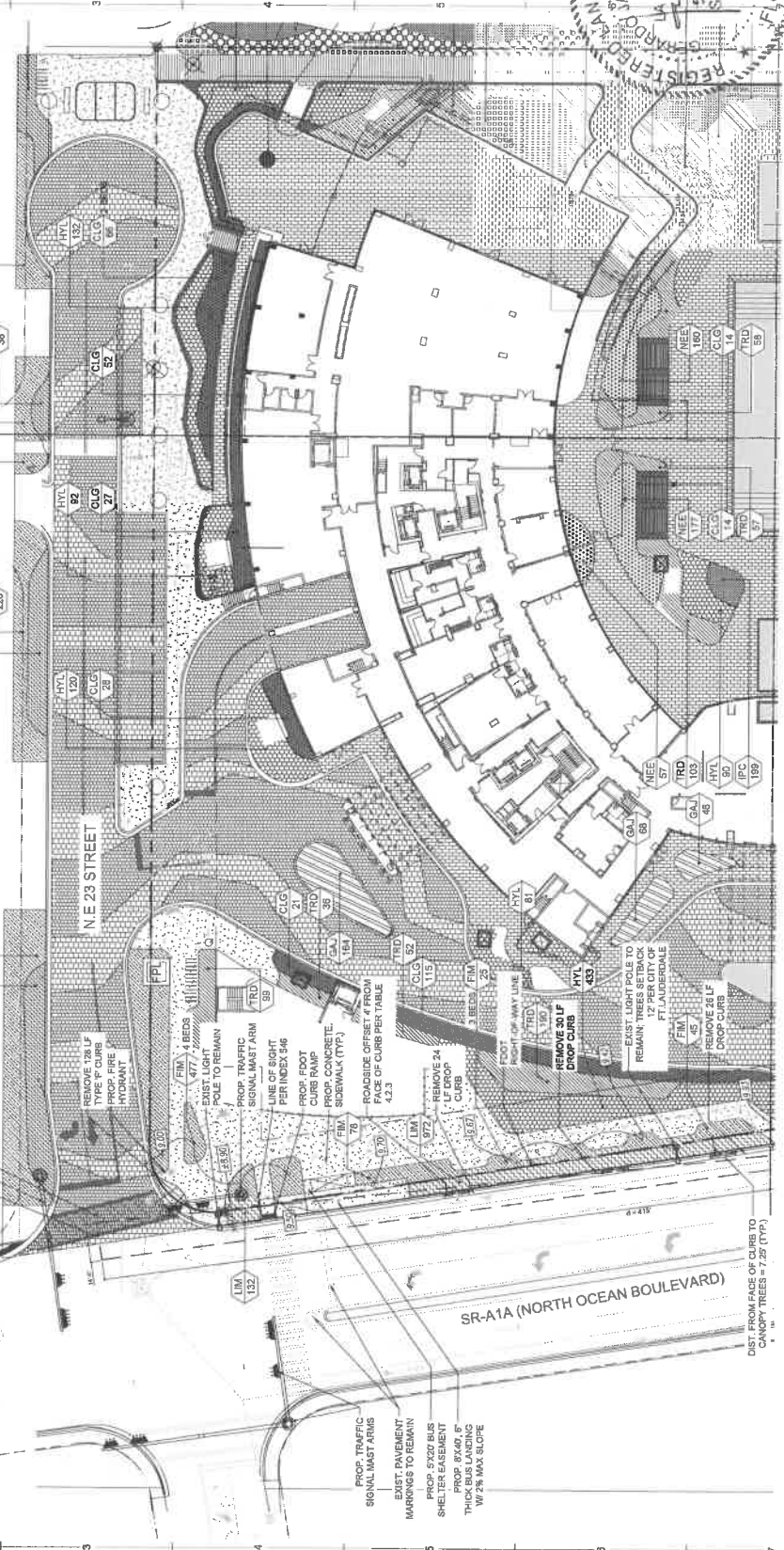

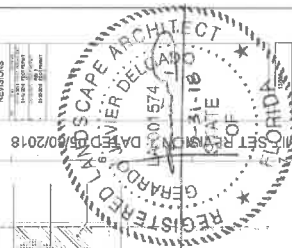

- FOOT GENERAL NOTES**
- CONTRACTOR SHALL REPAIR ALL DAMAGE TO FOOT PROPERTY DURING DEMOLITION, RELOCATION AND INSTALLATION ACTIVITIES AT THE SOLE RISK OF THE CONTRACTOR.
  - ARCHITECTURAL PAVED INSTALLATION FOR SIDEWALKS AND DRIVEWAYS WITHIN FOOT RIGHT OF WAY SHALL COMPLY WITH CURRENT FOOT STANDARD SPECIFICATIONS AND SHALL BE INSTALLED TO THE STANDARD SPECIFICATIONS. SEE: [www.flroads.com/standardspec/](http://www.flroads.com/standardspec/)
  - DEMOLITION OF ALL EXISTING EXCAVATED MATERIALS, AS DETERMINED BY THE CONTRACTOR, SHALL BE THE RESPONSIBILITY OF THE CONTRACTOR. ACCEPTANCE OF THE PROPOSED PROJECT IS FULLY EXCAVATED FROM THE SITE TO THE BROWARD OPERATIONS CENTER OR STOCKPILE IN THE VICINITY OF THE PROJECT, INCLUDING ASPHALT PAVEMENTS.



Item No.	Description	Quantity	Unit
1	DEMOLITION OF EXISTING ASPHALT PAVEMENT	1,200	SQ. YD.
2	DEMOLITION OF EXISTING CONCRETE PAVEMENT	1,200	SQ. YD.
3	DEMOLITION OF EXISTING CURB	1,200	LF
4	DEMOLITION OF EXISTING SIDEWALK	1,200	LF
5	DEMOLITION OF EXISTING DRIVEWAY	1,200	SQ. YD.
6	DEMOLITION OF EXISTING FENCE	1,200	LF
7	DEMOLITION OF EXISTING LIGHT POLE	1,200	EA.
8	DEMOLITION OF EXISTING SIGN	1,200	EA.
9	DEMOLITION OF EXISTING UTILITY	1,200	EA.
10	DEMOLITION OF EXISTING TREE	1,200	EA.
11	DEMOLITION OF EXISTING BUSH	1,200	EA.
12	DEMOLITION OF EXISTING FOLIAGE	1,200	EA.
13	DEMOLITION OF EXISTING FENCE	1,200	EA.
14	DEMOLITION OF EXISTING SIGN	1,200	EA.
15	DEMOLITION OF EXISTING UTILITY	1,200	EA.
16	DEMOLITION OF EXISTING TREE	1,200	EA.
17	DEMOLITION OF EXISTING BUSH	1,200	EA.
18	DEMOLITION OF EXISTING FOLIAGE	1,200	EA.
19	DEMOLITION OF EXISTING FENCE	1,200	EA.
20	DEMOLITION OF EXISTING SIGN	1,200	EA.
21	DEMOLITION OF EXISTING UTILITY	1,200	EA.
22	DEMOLITION OF EXISTING TREE	1,200	EA.
23	DEMOLITION OF EXISTING BUSH	1,200	EA.
24	DEMOLITION OF EXISTING FOLIAGE	1,200	EA.
25	DEMOLITION OF EXISTING FENCE	1,200	EA.
26	DEMOLITION OF EXISTING SIGN	1,200	EA.
27	DEMOLITION OF EXISTING UTILITY	1,200	EA.
28	DEMOLITION OF EXISTING TREE	1,200	EA.
29	DEMOLITION OF EXISTING BUSH	1,200	EA.
30	DEMOLITION OF EXISTING FOLIAGE	1,200	EA.
31	DEMOLITION OF EXISTING FENCE	1,200	EA.
32	DEMOLITION OF EXISTING SIGN	1,200	EA.
33	DEMOLITION OF EXISTING UTILITY	1,200	EA.
34	DEMOLITION OF EXISTING TREE	1,200	EA.
35	DEMOLITION OF EXISTING BUSH	1,200	EA.
36	DEMOLITION OF EXISTING FOLIAGE	1,200	EA.
37	DEMOLITION OF EXISTING FENCE	1,200	EA.
38	DEMOLITION OF EXISTING SIGN	1,200	EA.
39	DEMOLITION OF EXISTING UTILITY	1,200	EA.
40	DEMOLITION OF EXISTING TREE	1,200	EA.
41	DEMOLITION OF EXISTING BUSH	1,200	EA.
42	DEMOLITION OF EXISTING FOLIAGE	1,200	EA.
43	DEMOLITION OF EXISTING FENCE	1,200	EA.
44	DEMOLITION OF EXISTING SIGN	1,200	EA.
45	DEMOLITION OF EXISTING UTILITY	1,200	EA.
46	DEMOLITION OF EXISTING TREE	1,200	EA.
47	DEMOLITION OF EXISTING BUSH	1,200	EA.
48	DEMOLITION OF EXISTING FOLIAGE	1,200	EA.
49	DEMOLITION OF EXISTING FENCE	1,200	EA.
50	DEMOLITION OF EXISTING SIGN	1,200	EA.
51	DEMOLITION OF EXISTING UTILITY	1,200	EA.
52	DEMOLITION OF EXISTING TREE	1,200	EA.
53	DEMOLITION OF EXISTING BUSH	1,200	EA.
54	DEMOLITION OF EXISTING FOLIAGE	1,200	EA.
55	DEMOLITION OF EXISTING FENCE	1,200	EA.
56	DEMOLITION OF EXISTING SIGN	1,200	EA.
57	DEMOLITION OF EXISTING UTILITY	1,200	EA.
58	DEMOLITION OF EXISTING TREE	1,200	EA.
59	DEMOLITION OF EXISTING BUSH	1,200	EA.
60	DEMOLITION OF EXISTING FOLIAGE	1,200	EA.
61	DEMOLITION OF EXISTING FENCE	1,200	EA.
62	DEMOLITION OF EXISTING SIGN	1,200	EA.
63	DEMOLITION OF EXISTING UTILITY	1,200	EA.
64	DEMOLITION OF EXISTING TREE	1,200	EA.
65	DEMOLITION OF EXISTING BUSH	1,200	EA.
66	DEMOLITION OF EXISTING FOLIAGE	1,200	EA.
67	DEMOLITION OF EXISTING FENCE	1,200	EA.
68	DEMOLITION OF EXISTING SIGN	1,200	EA.
69	DEMOLITION OF EXISTING UTILITY	1,200	EA.
70	DEMOLITION OF EXISTING TREE	1,200	EA.
71	DEMOLITION OF EXISTING BUSH	1,200	EA.
72	DEMOLITION OF EXISTING FOLIAGE	1,200	EA.
73	DEMOLITION OF EXISTING FENCE	1,200	EA.
74	DEMOLITION OF EXISTING SIGN	1,200	EA.
75	DEMOLITION OF EXISTING UTILITY	1,200	EA.
76	DEMOLITION OF EXISTING TREE	1,200	EA.
77	DEMOLITION OF EXISTING BUSH	1,200	EA.
78	DEMOLITION OF EXISTING FOLIAGE	1,200	EA.
79	DEMOLITION OF EXISTING FENCE	1,200	EA.
80	DEMOLITION OF EXISTING SIGN	1,200	EA.
81	DEMOLITION OF EXISTING UTILITY	1,200	EA.
82	DEMOLITION OF EXISTING TREE	1,200	EA.
83	DEMOLITION OF EXISTING BUSH	1,200	EA.
84	DEMOLITION OF EXISTING FOLIAGE	1,200	EA.
85	DEMOLITION OF EXISTING FENCE	1,200	EA.
86	DEMOLITION OF EXISTING SIGN	1,200	EA.
87	DEMOLITION OF EXISTING UTILITY	1,200	EA.
88	DEMOLITION OF EXISTING TREE	1,200	EA.
89	DEMOLITION OF EXISTING BUSH	1,200	EA.
90	DEMOLITION OF EXISTING FOLIAGE	1,200	EA.
91	DEMOLITION OF EXISTING FENCE	1,200	EA.
92	DEMOLITION OF EXISTING SIGN	1,200	EA.
93	DEMOLITION OF EXISTING UTILITY	1,200	EA.
94	DEMOLITION OF EXISTING TREE	1,200	EA.
95	DEMOLITION OF EXISTING BUSH	1,200	EA.
96	DEMOLITION OF EXISTING FOLIAGE	1,200	EA.
97	DEMOLITION OF EXISTING FENCE	1,200	EA.
98	DEMOLITION OF EXISTING SIGN	1,200	EA.
99	DEMOLITION OF EXISTING UTILITY	1,200	EA.
100	DEMOLITION OF EXISTING TREE	1,200	EA.

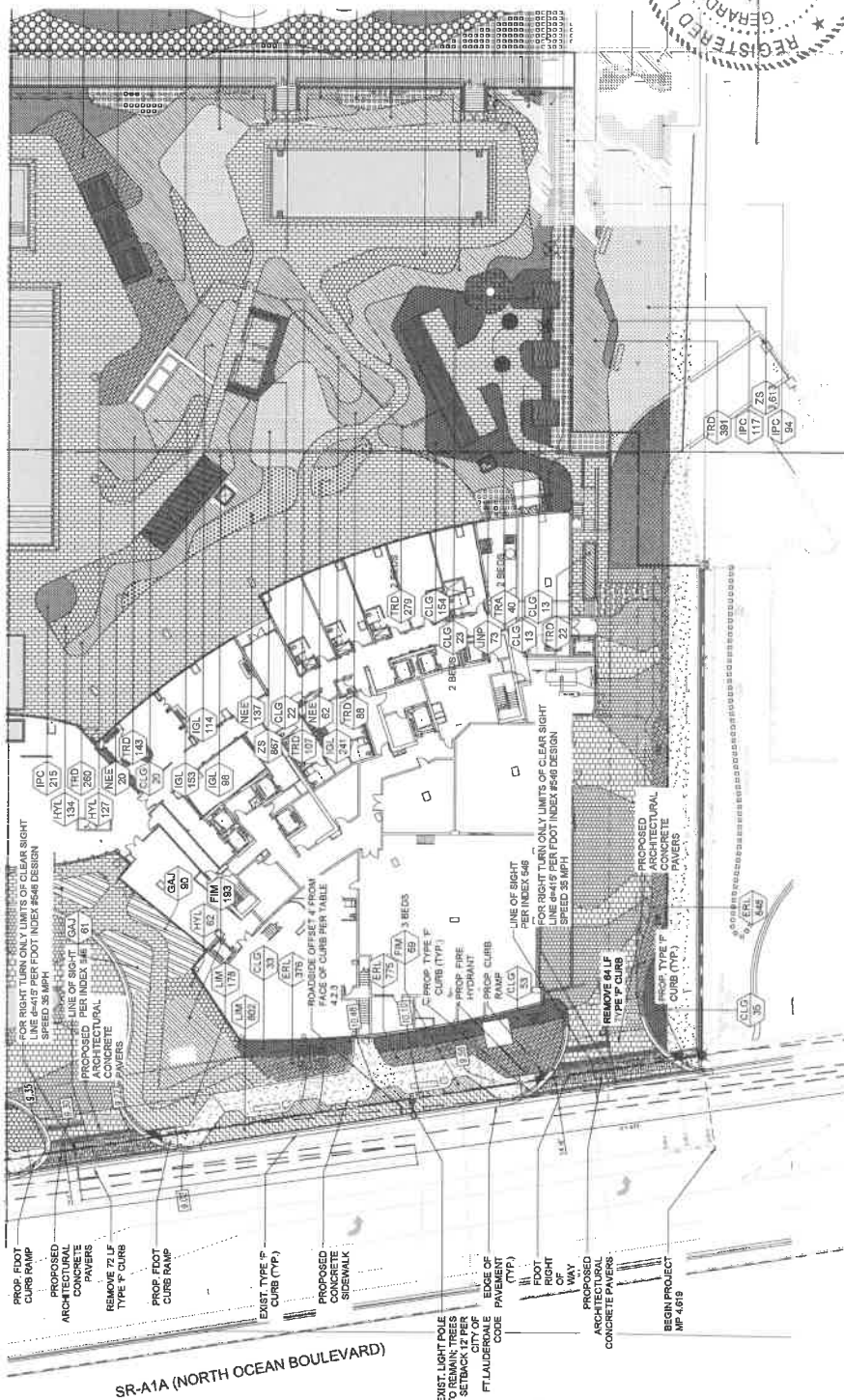





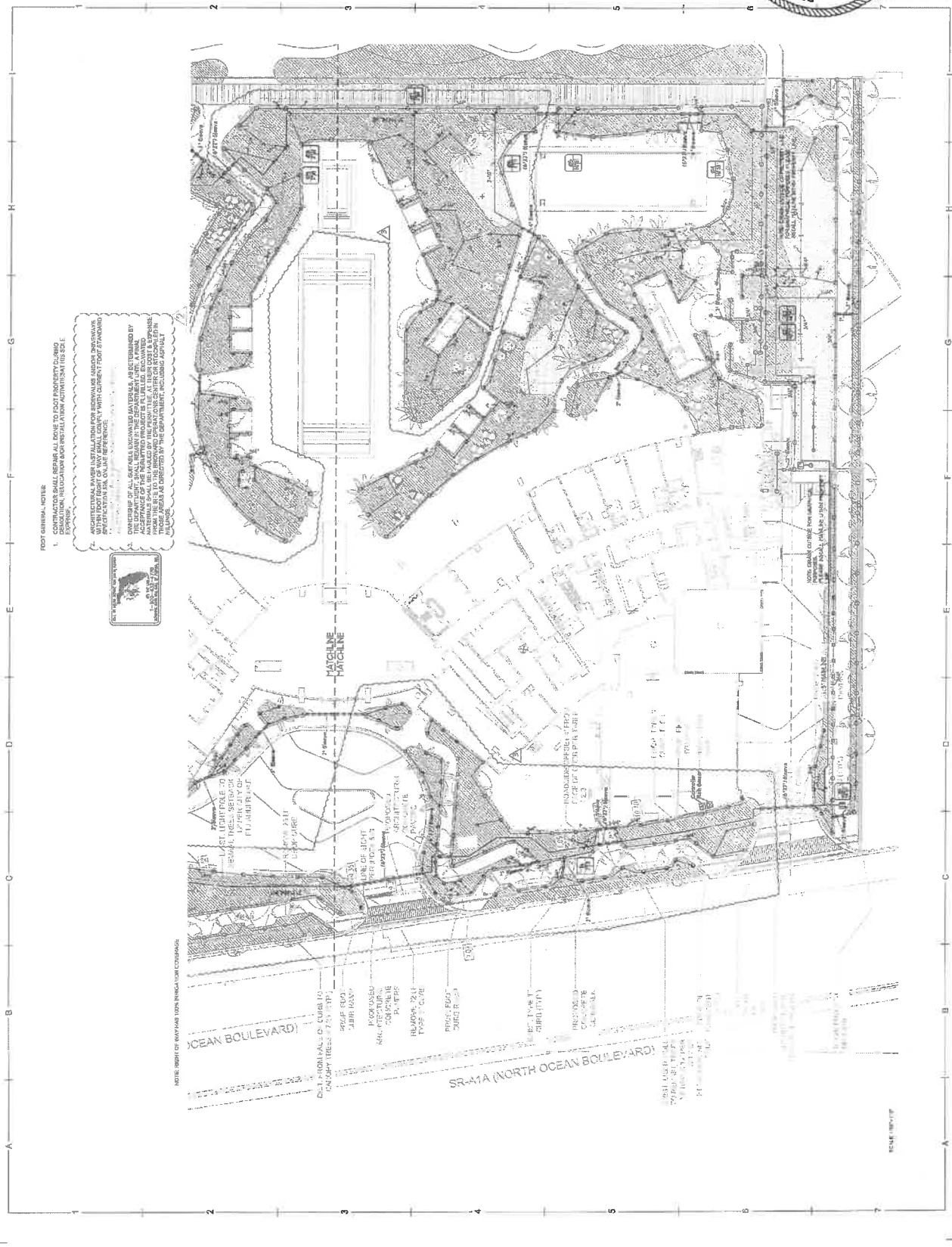
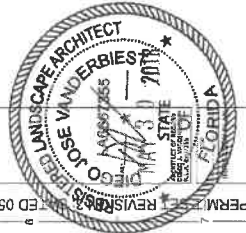

**FOOT CANTILEVER, NOTES:**

1. THE CITY OF FORT LAUDERDALE HAS REVIEWED THE SUBMITTALS FOR THE PROPOSED PROJECT AND HAS ISSUED A PERMIT FOR THE PROJECT. THE PERMIT IS VALID FOR THE PROJECT AND THE PROJECT IS SUBJECT TO THE CITY OF FORT LAUDERDALE'S ORDINANCES AND REGULATIONS. THE PERMIT IS VALID FOR THE PROJECT AND THE PROJECT IS SUBJECT TO THE CITY OF FORT LAUDERDALE'S ORDINANCES AND REGULATIONS.

