

General Traffic Plan (MOT) Notes:

1. Copy of approved 11 x 17 (TCP) MOT drawing to be maintained onsite by contractor at all times.
2. No changes to TCP/MOT drawing without prior consent of the approving government agency and All American Barricades.
3. Access shall be given to local residents, public transportation and emergency response vehicles.
4. Accommodations to be made for Pedestrian traffic should the work be in conflict with pathway(s). Refer to the FY 2017-18 FDOT Design Standards Index 660 for specifications.
5. All MOT equipment to conform to the latest Manual On Uniform Traffic Control Devices (MUTCD), FDOT, APL and permit approving agency.
6. Field conditions to be considered when placing MOT devices.
7. TCP/MOT Plan NOT TO SCALE. Refer to FDOT Index 600 Series Distance Charts for device spacing and placement information.
8. Posted Regulatory Speed Limit to be considered for device placement and distances.
9. MOT device(s) placement on plans are an approximate.
10. PLANS NOT TO SCALE.



Date: 4/26/2017 Author: Erwin Mosqueda Project: American Social
Address: SE 8th Ave btwn E Las Olas & NE 2nd Ct City: Ft. Lauderdale
Comments:
ATSSA # 22524

NOTE:
Typical drawing as per the latest edition of the MUTCD and FY2017 FDOT Index 600 Series Design Standards.
Drawing no to scale.
All American Barricades does not warrant the traffic control setup by others.
The setup must be handled by personnel certified and licensed to handle traffic control.

Legend



-  Event
-  Type III Barricade

Figure 6H-20. Detour for a Closed Street (TA-20)



Note: See Tables 6H-2 and 6H-3 for the meaning of the symbols and/or letter codes used in this figure.

Typical Application 20

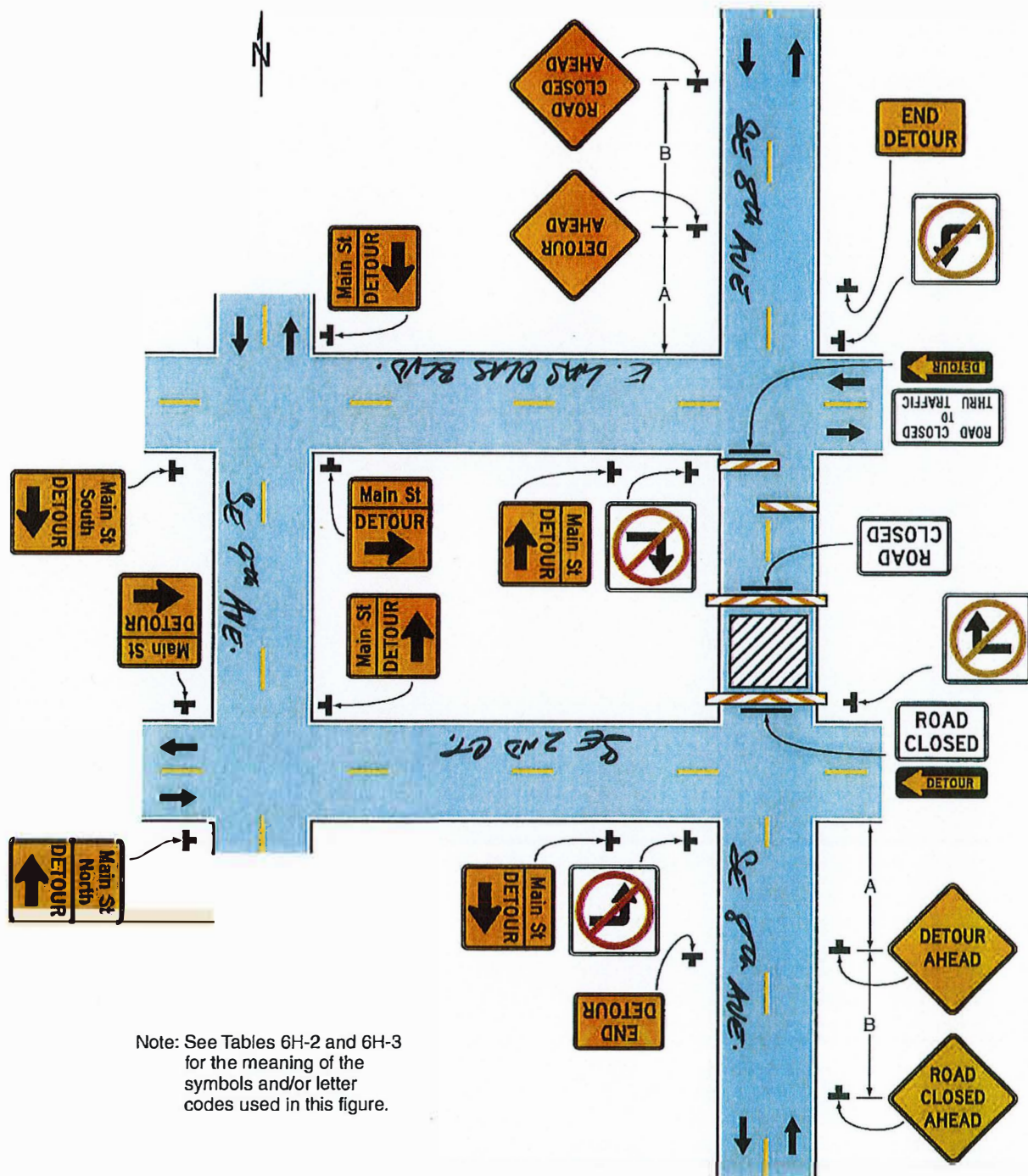
Ariel Garces
All American Barricades, Corp
ATSSA Certificate #16752

Sect. 6H.01

**Notes for Figure 6H-19—Typical Application 19
Detour for One Travel Direction**

Guidance:

1. *This plan should be used for streets without posted route numbers.*
2. *On multi-lane streets, Detour signs with an Advance Turn Arrow should be used in advance of a turn.*

Option:

3. The STREET CLOSED legend may be used in place of ROAD CLOSED.
4. Additional DO NOT ENTER signs may be used at intersections with intervening streets.
5. Warning lights may be used on Type 3 Barricades.
6. Detour signs may be located on the far side of intersections.
7. A Street Name sign may be mounted with the Detour sign. The Street Name sign may be either white on green or black on orange.

Standard:

8. When used, the Street Name sign shall be placed above the Detour sign.

Ariel Garces
All American Barricades, Corp
ATSSA Certificate #16752

