



Legend

- Cone
- Type II Barricade
- Lane Identification + Direction of Traffic
- LEO (Law Enforcement Officer)
- Island

SW 1 AVENUE

W. LAS OLAS BLVD.



S. ANDREWS AVE

E. LAS OLAS BLVD.

SE 1 AVENUE

START/FINISH



S. ANDREWS AVE

Huizenga Plaza



Date: 03/29/2016 **Author:** Ariel Garces **Project:** MADD
LOC: E. Las Olas & S. Andrews Ave. **EXH:** 1
Comments: ATSSA CERT. # 240741
Note:
 Typical drawing as per the latest edition of the MUTCD and 2016 FDOT Index 600 Series Design Standards.
 Drawing not to scale.
 All American Barricades does not warrant the traffic control setup by others. The setup should be handled personnel that have been certified to handle this type of traffic control setup.

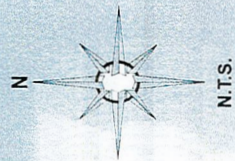

| Legend | |
|--------|--|
| ↑ | Lane Identification + Direction of Traffic |
| LEO | LEO (Law Enforcement Officer) |
| Cone | Cone |

SE 2nd Street

E Las Olas Blvd.

SE 3rd Ave

MOT Under
Police Control.NB Traffic allowed once
run clears SE 6 Street
Eastbound direction

Run Route

SE 3rd Ave

Run Route

MOT Under
Police Control.

E Las Olas Blvd.

General Traffic Plan (MOT) Notes:

1. Copy of approved 11 x 17 MOT drawing to be maintained onsite by contractor at all times.
2. No changes to MOT drawing without prior consent of the approving government agency.
3. Access shall be given to local residents and emergency response vehicles.
4. Accommodations to be made for Pedestrian traffic should the work be in conflict with pathway(s). Refer to the 2016 FDOT Design Standards Index 660 for specifications.
5. All MOT equipment to conform to the latest Manual On Uniform Traffic Control Devices (MUTCD).

Table I
Device Spacing

| Speed (mph) | Max. Distance Between Devices (ft.) | | | |
|----------------|-------------------------------------|---------|--|---------|
| | Cones or Tubular Markers | | Type I or Type II Barricades or Vertical Panels or Drums | |
| | Taper | Tangent | Taper | Tangent |
| 25 | 25 | 50 | 25 | 50 |
| 30 to 45 | 25 | 50 | 30 | 50 |
| 50 to 75 | 25 | 50 | 50 | 100 |



Date: 03/29/2016 **Author:** Ariel Garces **Project:** MADD
Address: SE 3 Ave, SE 2 Street & E Las Olas Blvd **EXH:** 2
Comments: ATSSA CERT. # 240741

Note:
 Typical drawing as per the latest edition of the MUTCD and 2016 FDOT Index 600 Series Design Standards.
 Drawing not to scale.
 All American Barricades does not warrant the traffic control setup by others. The setup should be handled personnel that have been certified to handle this type of traffic control setup.



NORTHBOUND INSIDE
LANE TO RE-OPEN ONCE
LAST RUNNER CROSSES
SE 3 AVE IN EB DIRECTION.

SE 6 STREET



SE 3 AVE

NORTHBOUND LANES
TO RE-OPEN ONCE
LAST RUNNER CROSSES
SE 3 AVE IN EB DIRECTION.

SE 6 CT

SE 7 STREET

General Traffic Plan (MOT) Notes:

1. Copy of approved 11 x 17 MOT drawing to be maintained onsite by contractor at all times.
2. No changes to MOT drawing without prior consent of the approving government agency.
3. Access shall be given to local residents and emergency response vehicles.
4. Accommodations to be made for Pedestrian traffic should the work be in conflict with pathway(s). Refer to the 2016 FDOT Design Standards Index 660 for specifications.
5. All MOT equipment to conform to the latest Manual On Uniform Traffic Control Devices (MUTCD).

| Table I Device Spacing | | | | | |
|---------------------------|-------------------------------------|---------|--|---------|--|
| Speed (mph) | Max. Distance Between Devices (ft.) | | | | |
| | Cones or Tubular Markers | | Type I or Type II Barricades or Vertical Panels or Drums | | |
| | Taper | Tangent | Taper | Tangent | |
| 25 | 25 | 50 | 25 | 50 | |
| 30 to 45 | 25 | 50 | 30 | 50 | |
| 50 to 75 | 25 | 50 | 50 | 100 | |

| Table II Buffer Space and Taper Length | | | | | |
|---|-----------------|------------|---|--|-----------------------|
| Speed (mph) | Buffer Space | | Taper Length (12' Lateral Transition) | | Notes (Merge) |
| | Dist. (ft.) | L (ft.) | | | |
| 25 | 155 | 125 | | | $L = \frac{WS^2}{60}$ |
| 30 | 200 | 180 | | | |
| 35 | 250 | 245 | | | |
| 40 | 305 | 320 | | | |
| 45 | 360 | 540 | | | |
| 50 | 425 | 600 | | | $L = WS$ |
| 55 | 495 | 660 | | | |
| 60 | 570 | 720 | | | |
| 65 | 645 | 780 | | | |
| 70 | 730 | 840 | | | |

| DISTANCE BETWEEN SIGNS | | | | |
|------------------------|---------------|------|------|--|
| Speed | Spacing (ft.) | | | |
| | A | B | C | |
| 40 mph or less | 200 | 200 | 200 | |
| 45 mph | 350 | 350 | 350 | |
| 50 mph | 500 | 500 | 500 | |
| *55 mph or greater | 2640 | 1640 | 1000 | |

| Legend | |
|--------|--|
| | Cone |
| | Traffic Signal |
| | Lane Identification + Direction of Traffic |
| | Run Route |



Date: 03/29/2016 Author: Ariel Garces Project: MADD
Address: SE 6 Street & SE 3 Ave
Comments: ATSSA CERT. # 240741
Note:
Typical drawing as per the latest edition of the MUTCD and 2016 FDOT Index 600 Series Design Standards.
Drawing not to scale.
All American Barricades does not warrant the traffic control setup by others. The setup should be handled personnel that have been certified to handle this type of traffic control setup.



General Traffic Plan (MOT) Notes:

1. Copy of approved 11 x 17 MOT drawing to be maintained onsite by contractor at all times.
2. No changes to MOT drawing without prior consent of the approving government agency.
3. Access shall be given to local residents and emergency response vehicles.
4. Accommodations to be made for Pedestrian traffic should the work be in conflict with pathway(s). Refer to the 2016 FDOT Design Standards Index 660 for specifications.
5. All MOT equipment to conform to the latest Manual On Uniform Traffic Control Devices (MUTCD).

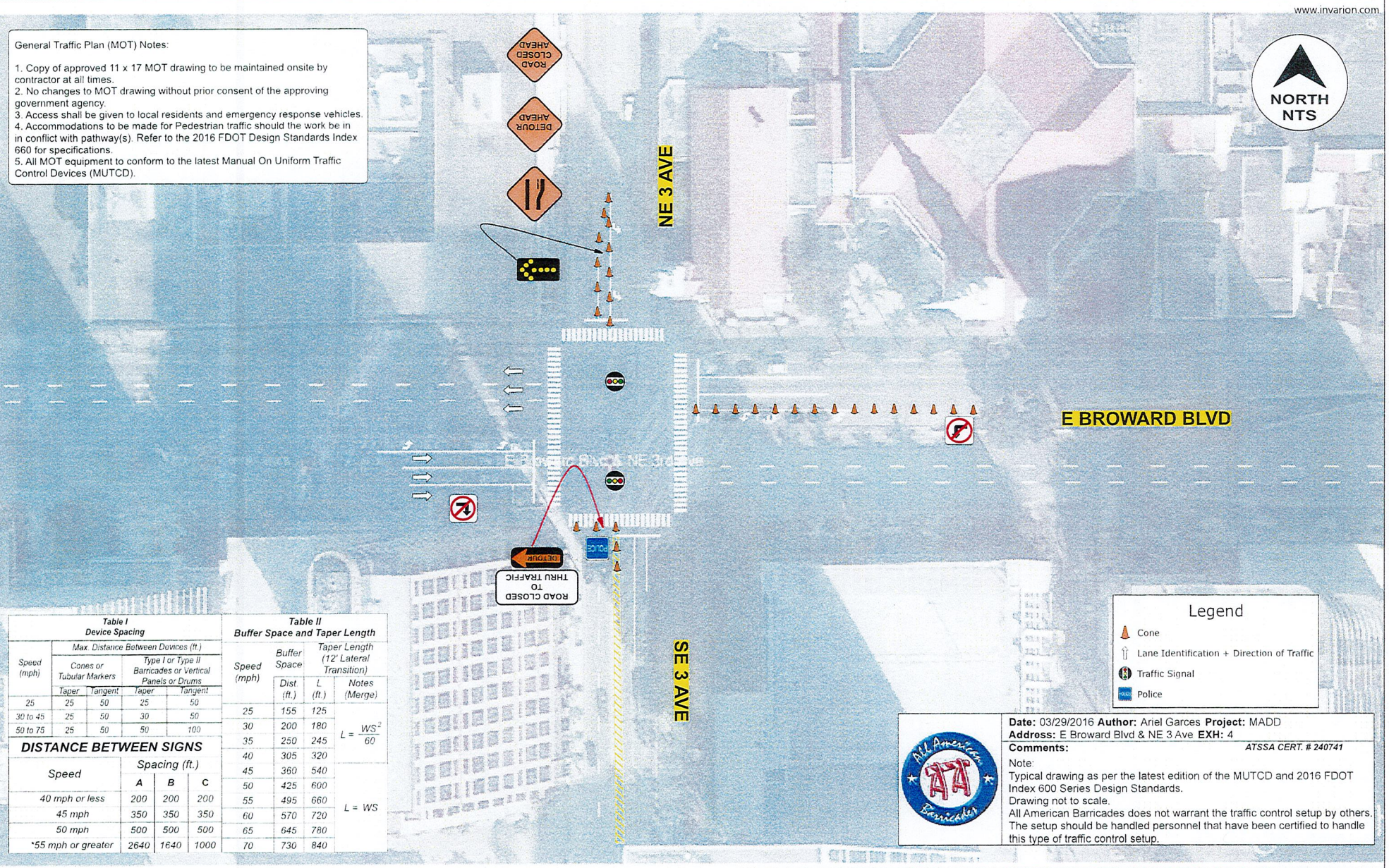





TEMPORARY STREET CLOSURES DETOUR MOT PLAN

- General Traffic Plan (MOT) Notes:
1. Copy of approved 11 x 17 MOT drawing to be maintained onsite by contractor at all times.
 2. No changes to MOT drawing without prior consent of the approving government agency.
 3. Access shall be given to local residents and emergency response vehicles.
 4. Accommodations to be made for Pedestrian traffic should the work be in conflict with pathway(s). Refer to the 2016 FDOT Design Standards Index 660 for specifications.
 5. All MOT equipment to conform to the latest Manual On Uniform Traffic Control Devices (MUTCD).

| Speed | DISTANCE BETWEEN SIGNS | | |
|--------------------|------------------------|------|------|
| | Spacing (ft.) | | |
| | A | B | C |
| 40 mph or less | 200 | 200 | 200 |
| 45 mph | 350 | 350 | 350 |
| 50 mph | 500 | 500 | 500 |
| *55 mph or greater | 2640 | 1640 | 1000 |

 Law Enforcement Officer (LEO)
 MOT UNDER POLICE CONTROL
 LEO Posts to be coordinated by
 Governing Law Enforcement Agency

Legend

-  Body of Water
-  Race Route
-  North Arrow
-  PCMS (Portable Changeable Message Sign)

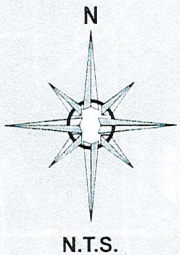

Date: 03/29/2016 **Author:** Ariel Garces **Project:** MADD
Address: Andrews Ave/SE 3 Ave from Broward Blvd to SE 6 St EXH: 5
Comments: ATSSA CERT. # 240741
 Note:
 Typical drawing as per the latest edition of the MUTCD and 2016 FDOT
 Index 600 Series Design Standards.
 Drawing not to scale.
 All American Barricades does not warrant the traffic control setup by others.
 The setup should be handled personnel that have been certified to handle
 this type of traffic control setup.

