

# FXE

## Master Drainage/Conceptual Environmental Resources Permit RFQ 276-11831





October 28, 2016

**Kimley»Horn**

Mr. Jim Hemphill  
Sr. Procurement Specialist  
City of Fort Lauderdale  
Procurement Services Division  
100 N. Andrews Avenue, Room 619  
Fort Lauderdale, Florida 33301

**Re: Engineering Services – Master Drainage/Conceptual Environmental Resources Permit –  
Solicitation 276-11831**

Dear Mr. Hemphill and Members of the Evaluation Committee:

**Kimley-Horn** is pleased to submit our qualifications and technical proposal to provide professional consulting services for development of the City's Master Drainage Plan and Environmental Resources Permit for the Fort Lauderdale Executive Airport.

Our current and previous experience working with the City on the FXE Sheltair Northside design and Taxiway Foxtrot Westend are examples of the high quality service we provide. As part of our involvement with the FXE Sheltair Northside project, we were able to identify the need for the airport's overall master drainage plan and conceptual ERP. Additionally, our Fort Lauderdale-based water resources professionals recently teamed with the Margate CRA to develop a stormwater master plan and obtain a conceptual ERP for the City's 43.7-acre downtown area. We have also recently developed stormwater master plans for the City of Palmetto Bay and the Town of Miami Lakes. As one of the largest consulting firms in Florida with a strong water resources, stormwater, and drainage design specialty practice, we believe we are the most qualified team to perform this project.

**The Kimley-Horn team has a successful history of working together on similar projects. We offer the City the broad range of expertise needed for this important project:**

**Program and project understanding.** We understand the purpose of this project is to review and revise the FXE Airport stormwater master plan. Once the master plan is finalized, it would be submitted to Broward County for a conceptual ERP. In addition to creating a level of service for the City, our project team will identify areas where drainage and water quality improvements can be implemented economically and help the City meet future clean water standards. The Kimley-Horn team will provide services that meet your needs while staying mindful of the City's budget.

**Depth of resources, experience, and knowledge.** *We have more than enough staff availability to begin work on this project immediately.* Our team contains more than 10 professionals experienced in creating stormwater master plans and developing water quality improvement strategies in Florida to meet FDEP future rules and regulations. Our team includes a responsive group of civil engineers, biologists, hydrologists, water quality specialists, and scientists with a long history of working together in the Fort Lauderdale area. For this contract, all of our local professionals are available to you and are supported by regional and national experts throughout the firm. Our team members are currently working on local stormwater projects that give us the edge of knowing what you want without the need to "get up to speed." We can have a stormwater model ready for use to identify problems within the project area a few months after receiving notice to proceed.

**Dedicated project team.** Our team offers you different perspectives within each discipline, which will allow for ongoing peer review. As your project manager, I will serve as the City's point of contact for this project. Our team's past experience in the area has given me a keen perspective of the needs and importance of this master drainage plan and ERP. We are excited to have the opportunity to partner with the City on this exciting project. I am personally dedicated to working with City staff to meet all the goals of this project.

**Innovative ideas for meeting project schedule.** We recognize that meeting a strict project schedule is vital to the development of the City's master drainage and obtaining an ERP. One way our team can help the City is to streamline the review process with both your staff and agency reviewers through the use of a secure ShareFile website. We will also manage the project schedule using Primavera CPM software.

**Summary.** This project will provide a true benefit to the City of Fort Lauderdale FXE Airport through refinements to your level of service, identifications of flooding and water quality improvement areas, and project recommendations to help meet future regulatory requirements and to promote future development within the airport. Additionally, obtaining a conceptual ERP will help streamline future stormwater permitting. Our team members take great pride in the stormwater design and master planning work we have performed throughout South Florida and look forward to serving you on this project.

Very truly yours,

**KIMLEY-HORN**

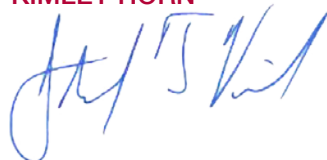

Stefano Viola, P.E.  
Project Manager

Phone: (954) 535-5133

Fax: (561) 863-8175

[stefano.viola@kimley-horn.com](mailto:stefano.viola@kimley-horn.com)



Gary Ratay, P.E.  
Vice President

Phone: (954) 535-5112

Fax: (561) 863-8175

[gary.ratay@kimley-horn.com](mailto:gary.ratay@kimley-horn.com)

**Note:** As a vice president with Kimley-Horn, Gary Ratay has full signing authority and is authorized to bind the Firm.



# FXE

## Master Drainage/Conceptual Environmental Resources Permit RFQ 276-11831

### 1. TABLE OF CONTENTS

<i>Section</i>	<i>Page</i>
1. Table of Contents. . . . .	3
2. Executive Summary . . . . .	5
3. Firm Qualifications and Experience. . . . .	9
■ Kimley-Horn's Licenses.....	13
■ Kimley-Horn's SF 330 .....	15
4. Organizational Profile and Project Team . . . . .	57
5. Approach to Scope of Work . . . . .	59
■ Workload .....	59
6. References. . . . .	65
7. Minority (DBE) Participation. . . . .	67
8. Subconsultants . . . . .	69
9. Required Forms . . . . .	73
■ Statement of Qualification Certification.....	75
■ Non-Collusion Statement .....	76
■ Local Business Preference Certification Statement.....	77
■ Contract Payment Method.....	78
■ Sample Insurance Certificate.....	79
■ Certificate of Secretary Signing Authority .....	80



## 2. EXECUTIVE SUMMARY

**Kimley-Horn** was founded in 1967 in Raleigh, North Carolina by Bob Kimley and John Horn—two senior engineering professors at North Carolina State University. The expertise of the firm was initially focused on traffic planning and public transportation projects. In the ensuing 49 years, the firm has expanded both geographically and in the variety of planning, engineering, and environmental services that it provides. We have been providing engineering and planning services at airports for more than 38 of those years.

Today, Kimley-Horn is a full-service, multidisciplinary consulting firm with more than 2,800 employees offering a full range of consulting services to local, regional, national, and international clients. In Florida alone, there are more than 530 employees in 14 offices, with more than 25 staff devoted full time to serving our aviation clients. Whether it's runways, roadways, or parking; landside access or environmental studies; operations or technology; the firm's experienced professionals can develop innovative solutions you can rely on. Kimley-Horn offers comprehensive airside and landside services to meet wide-ranging needs at airports large and small. Our staff also has extensive experience and is very familiar with the procedures and requirements of the Federal Aviation Administration (FAA), and the Florida Department of Transportation. Our Florida based aviation personnel include former FAA Orlando Area District Office (ADO) personnel who maintain strong personnel relationships with the ADO staff. We currently serve as an on-call consultant for the FDOT Central Aviation Office, as well as their prime consultant for the Statewide Aviation Pavement Management Program. **In 2016, Kimley-Horn was ranked 7th for airport consulting firms in the nation by *Engineering News-Record*.**

We are recognized for the outstanding work of our consulting staff, the quality of our work environment, and our stature as a business enterprise. In 2016, Kimley-Horn was recognized as one of *Fortune* magazine's "**100 Best Companies to Work For**," marking our ninth appearance in the last 10 years; **this year, we ranked #7**. Also *Fortune* ranked us **#1** among the "**20 Best Workplaces in Consulting & Professional Services**" (#1), we were listed on the "**Best Places for Millennials**," "**Best Places for Diversity**," and "**Best Places for Camaderie**." We were also named **Southeast Design Firm of the Year** by *Engineering News-Record (ENR)*. Much of our growth extends from the confidence and trust that clients have in us.

Kimley-Horn has continuously had an office in the Fort Lauderdale area for the past 33 years. We are proud to have worked on projects in Fort Lauderdale and the surrounding communities for many years, and our knowledge and understanding of the area has grown significantly with our decades of service in the community. We are confident that our local presence and sensitivity to the community's concerns will benefit the City by providing you with unmatched accountability, responsiveness, and value.

We pride ourselves in our ability to tailor comprehensive airside and landside services to our clients' needs. Kimley-Horn's approach gives our clients the best of both worlds—the resources of a large, nationally-ranked firm and the personal attention and response of a small dedicated professional team. With both aviation specific engineering and planning services in-house and in Florida, you get the responsiveness, expertise, and experience you need for the Fort Lauderdale Executive Airport.

*Engineering News-Record (ENR)* annually compiles and publishes the rankings of the 500 largest U.S. design firms (architectural and engineering firms), measured by gross revenues. Kimley-Horn's growth over the years is reflected in its steady rise on *ENR*'s top 500 list. **The firm first appeared on the list in 1981, when it ranked 421st.**

Today, Kimley-Horn ranks **28th overall and 12th among the top 100 "pure design firms."**



## POINT OF CONTACT

Our project manager, **Stefano Viola, P.E.**, will serve as the City of Fort Lauderdale's personal point of contact. He will be personally responsible and accountable for the success of your project and has access to the full range of technical resources available within Kimley-Horn. In addition, our project team has the experience required to develop appropriate targets, tailor suitable courses of action, and provide timely decision making for any unexpected challenges that may arise.

**Kimley-Horn (Fort Lauderdale Office)**

600 North Pine Island Road, Suite 450

Plantation, FL 33324

**Phone:** (954) 535-5100**Fax:** (561) 863-8175**Email:** [stefano.viola@kimley-horn.com](mailto:stefano.viola@kimley-horn.com)**Website:** [www.kimley-horn.com](http://www.kimley-horn.com)

## OFFICE LOCATIONS

Kimley-Horn has been in Florida for more than 48 years and understands the importance of timely service, availability, and flexibility. Our philosophy for providing professional services is based on a commitment to effective management and personal service. The ultimate goal of the Kimley-Horn team is to respond to the distinct needs of each locale we serve. We are also very sensitive to the needs and opinions of local businesses and residents, and routinely work with our clients to establish cost-effective and tangible priorities that result in constructible and implementable plans and designs.

Kimley-Horn's West Palm Beach office will serve as the primary office responsible for overseeing the work related to this project in order to maximize our local staff and provide a strong presence from an office located in short proximity to the City. The West Palm Beach office will be assisted by experts in our Fort Lauderdale office. From these locations, we will work diligently; encouraging open communication to keep you informed about project activity and primary schedule achievements. We are committed to working as your partner, offering you the most effective level of communication to relay project issues, progress, and results that best serve your needs in a timely manner. We will work with the City to establish the schedule and scope of work, and serve in close proximity as the direct contact with the City for the duration of the assignment. Additionally, our experts throughout the state are available for technical support to ensure timely completion and fulfillment of project goals.

**Corporate Headquarters**

421 Fayetteville Street, Suite 600

Raleigh, NC 27601

**Phone:** (919) 677-2000**Fax:** (919) 677-2050

## BUSINESS STRUCTURE

Kimley-Horn and Associates, Inc. was incorporated on February 10, 1967 in North Carolina.

Kimley-Horn and Associates, Inc. is wholly owned by Associates Group Services, Inc. which is wholly owned by APHC, Inc.

APHC, Inc. is owned by individuals who are Kimley-Horn employees. There are nearly 400 APHC, Inc. shareholders.

**Principal Officers:**

Brooks H. Peed, Chairman

John C. Atz, CEO, President

Richard N. Cook, Senior Vice President, Secretary

David L. McEntee, Vice President, Treasurer, Assistant Secretary



**Directors:**

John C. Atz, CEO, President  
Barry L. Barber, Senior Vice President  
Derrick B. Cave, Senior Vice President  
Nicole Kerry, Principal  
Steve Lefton, Senior Vice President/Principal  
Terence T. Murphy, Senior Vice President  
Brooks H. Peed, Executive Vice President

H. Dean Penny, Senior Vice President  
Michael G. Schiller, Executive Vice President  
Christopher A. Squires, Senior Vice President  
G. Bradbury Tribble, Senior Vice President  
Deborah L. Wilson, Senior Vice President  
Mark S. Wilson, CFO

## KEY STAFF

As illustrated in our organizational chart, our team includes Kimley-Horn individuals and subconsultants who have recently teamed with the City of Fort Lauderdale on several successful projects, including (but not limited to):

**Stefano Viola, P.E.** – *Project Manager*  
**Michael Carey, P.E.** – *Principal-in-Charge*  
**Gary Ratay, P.E.** – *Quality Assurance/Quality Control*  
**EG Solutions**  
**Keith and Associates**  
**Tierra South Florida**

These individuals and firms will provide FXE with the continuity and consistency that will lead to a successful project.

**With the Kimley-Horn team, you get a consultant that can help you meet any challenge you face at Fort Lauderdale Executive Airport, one that listens to your needs and delivers solutions to meet those needs.**



### 3. FIRM QUALIFICATIONS AND EXPERIENCE

#### FIRM QUALIFICATIONS IN REQUESTED SERVICES

Details of our past projects of similar size and scope can be found in the attached SF330.

##### Stormwater Services

Our work for various Florida municipalities has helped solve some of their most complex stormwater runoff, retention, and treatment issues, as well as designing specialized drainage systems to protect sensitive ecosystems. We can handle all of your permitting, design, and construction needs, from start to finish. Our stormwater related services include, but are not limited to:

- Stormwater management and design
- Drainage design
- Stormwater modeling
- FEMA permitting
- Drainage system retrofitting
- Permitting
- Wetland assessment and restoration
- Hydrogeology
- Flood controls system design
- BMP and Low Impact Development design
- NPDES monitoring and compliance programs
- Surface water quality monitoring
- Erosion and sediment control plans
- Geographic Information Systems (GIS)
- Visioning/public involvement programs
- Regulatory agency planning, coordination, and liaison



- Financing sources, including grants and stormwater utility fee planning
- Opinion of Probable Construction Costs
- Public involvement
- Feasibility analysis
- Project specifications
- Construction phase services

Our team's background in stormwater management includes projects ranging in size from individual parcels to citywide and regional projects. We have demonstrated our ability to develop common-sense solutions during master planning, design, and construction of stormwater projects of all sizes, as well as an ability to secure permits from multiple regulatory agencies and water management districts on many complex projects. We have served as consultants to the South Florida Water Management District, which gives us important insight as to the main issues they face and how they are best resolved.

##### Environmental

Florida's natural environment is unique and diverse and environmental regulations are some of the most complex in the nation. Knowing how to successfully navigate the regulatory maze and providing the appropriate level of documentation is critical to successful project implementation. Kimley-Horn has that knowledge through extensive experience working on complex projects throughout Florida. Our approach is to understand our client's business, the regulatory requirements, and build relationships with the regulatory personnel. Our environmental staff knows Florida—they have provided their services from Pensacola to the Florida Keys. Our environmental staff also knows issues specifically associated with aviation projects and the National Environmental Policy Act (NEPA) process. We know the regional issues, and we interact with federal, state, and local government agencies daily. We stay abreast of current environmental regulations and regularly participate in rule making decisions.

Kimley-Horn maintains an experienced team of environmental scientists, geologists, hydrogeologists, biologists, planners, and field technicians with expertise in a wide range of ecological planning and problem-solving services. The firm's in-house capabilities include, but are not limited to:

- NEPA Compliance
- Mitigation plan design, implementation and monitoring
- Listed species survey, permitting, biological assessments, biological opinions and habitat management
- Environmental Resource Permitting
- U.S. Army Corps of Engineers (404) Permitting
- Phase I and Phase II Environmental Site Assessments

While it is not anticipated that the relocation of Taxiway Foxtrot will require extensive environmental services with the Kimley-Horn team you get a staff that has a thorough understanding of federal and state environmental regulations.



### Sustainable Design and Green Building Principles for Aviation



We are committed to assisting our clients with sustainable design and green building principles and applying them to projects whenever practicable and in our client's best interest. Kimley-Horn is nationally recognized for our leadership in the realm of sustainable design—we are ranked #41 on the *Engineering News-Record* 2016 rankings of **Top 100 Green Design Firms**. We have proven that commitment with the construction of our own Vero Beach, Florida office that received the Silver LEED certification. As for our commitment in applying sustainability to airports, we have been an active participant with the formation of the Sustainable Aviation Guidance Alliance (SAGA)

formed by ACI, ACC, and AAEE. The SAGA group was formed to assist airport operators of all sizes in planning, implementing, and maintaining a sustainability program. A searchable database has been compiled by SAGA and provides ideas for hundreds of sustainable practices at airports in areas such as stormwater management, water efficiency, landscape and exterior design, materials and resources, and construction practices.

An example of services being applied to a project can be exemplified by Kimley-Horn's work in Tallahassee. As a general consultant to Tallahassee Regional Airport, we have worked with their staff to handle a wide variety of issues ranging from airfield pavements to pavement management to traffic and development of regional impact (DRI) issues. When they asked Kimley-Horn to prepare construction plans for rehabilitating the north and old terminal aprons, they gave us a project that had some very different pavements to deal with. Of the 14.65-acre apron, almost half was old 16-inch-thick concrete overlaid with 3 inches of asphalt. Rather than remove it and start over, Kimley-Horn's plans called for the concrete to be rubblized in place and reused it as a new base course. Rubblization minimizes delays for airport tenants and operations, and is a very cost-effective technique compared to typical reconstruction options. It also reuses a material that would otherwise end up in the landfill and avoid the environmental impacts of removing the concrete and replacing it with virgin material. The project was completed on time and within budget and in August 2010, Ken Austin, the former Airport Director, accepted the first Florida Airport Council Environmental Award for Air Carrier Airports for the project.





## Quality Assurance/Quality Control

**A key component of quality control is quality people.** We offer you a team of experienced and technically proficient professionals who know how to implement these types of projects. The Kimley-Horn team provides the ideal combination of relevant experience, expert engineering, and proven cost control management techniques.

We achieve quality through rigorous planning, coordination, supervision, technical direction, and the use of appropriately skilled professionals. The following steps summarize our formal in-house program for complete quality management:

- **Develop Detailed Work Plan.** The work plan establishes the major tasks, identifies staff members who will complete the tasks, determines how much time the tasks will take, designates the quality control review staff, and details the schedule for accomplishment.
- **Assign QA/QC Responsibility.** We have identified **Gary Ratay, P.E.** as our QA/QC manager. He has extensive experience with drainage and permitting projects, but will not be involved in the day-to-day development — this enables him to bring in a fresh perspective and critical eye to each review.
- **Conduct Peer Reviews.** We design peer reviews to check, review, and provide oversight of work activities. Individuals who are not directly responsible for performing the task conduct peer reviews offering an unbiased technical evaluation at every step of the project.
- **Perform Meticulous Project Documentation.** Appropriate data and work papers that detail the choices that were evaluated and the basis for recommendations will support all documents.
- **Final Project Manager Endorsement.** **Stefano Viola, P.E.**, our project manager, will evaluate each project for clarity, accuracy, completeness, and scope compliance.

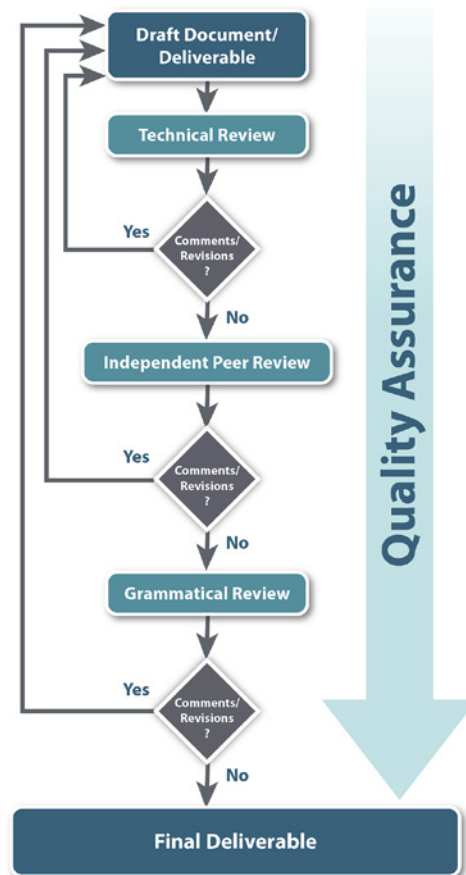

## Why Team with Kimley-Horn?

Kimley-Horn is a full-service consulting firm with 78 offices located across the nation. Our professionals provide local knowledge backed by the comprehensive resources and talented staff only a national firm can offer. Listed below are just some of the reasons to team with Kimley-Horn:

- ❖ The continuity of 13 years' worth of design experience at your airport. Our team consists of professionals which have served your airport during the entire duration of our previous contracts.
- ❖ You will continue to have an experienced, client-oriented project manager to serve you. **Stefano Viola, P.E.**, will be accessible and accountable to you throughout this contract.
- ❖ You will be served by a team of drainage and environmental experts who perform this type of work every day. Furthermore, we have been trusted by the various local municipalities to develop drainage plans and obtain permits.
- ❖ Your budget is important to us. We consistently complete projects on time and on budget.
- ❖ We are a small enough firm to provide you with the individual attention you deserve, yet large enough to tackle even the most complex project.

**Honesty, integrity, ethics, and exceptional client service are more than just our core values; they are a way of life at Kimley-Horn.**

---

## Budget and Cost Control

---

The team members we have assembled for our core team, including subconsultants, are all located in South Florida. We are available by phone at any time, and can be in Fort Lauderdale Executive Airport within a matter of minutes. Kimley-Horn maintains an effective and accurate accounting of projected staff hours for up to a six-month time period. We know at any given moment what our availability is, and because we have access to the resources of 14 offices in Florida, we can assure you that we have the required resources for any task at any time.

We recognize that budget and schedule control are critical to the success of your program. Meeting your schedule for deliverables is not just a goal to us—it is a requirement. Both cost and schedule control are inherently tied to people. Their experiences, vision, management styles, and philosophies all affect significant components of a project approach and its execution. Our approach will include identifying realistic goals, developing a focused action plan that addresses only those items necessary to accomplish the goals, anticipating the implications of decisions made in early phases to future phases, and preparing a mechanism for addressing unexpected challenges. This approach builds the framework for completing successful projects within budget and on schedule.

The first step to controlling cost and schedule is to understand your vision and develop realistic budgets and schedule to make that vision a reality. This requires clear communication and is a critical step in the partnering required for a successful project. We endeavor to define the project requirements, understand potential obstacles to success, identify potential opportunities to achieve more within the same project, and create a project work plan that allows us to accomplish your goals efficiently. Paramount to the success of any project is a continued partnering throughout the project to adapt as necessary to unforeseen circumstances. We will include critical decision-making points in our work plans so that the project team and FXE staff can agree upon the best course of action to keep the project on track. We know there always will be unexpected challenges unique to any given project, so it is critical that an approach be developed and followed that controls what can be controlled and builds in mechanisms for dealing with the unexpected.

Our best cost and schedule control resource—our staff—has several tools for helping to control cost and schedule. The team members selected for this proposal have the experience to develop appropriate targets, tailor a suitable course of action, and provide timely decision-making for any unexpected challenges that may arise.

Kimley-Horn is well suited to manage and administer projects. We are prepared to commit the necessary resources to ensure the success of your efforts. And with our tremendous stable of diverse local resources, we have unequalled ability to staff efficiently for any assignment. We are committed to provide a correct mix of administrative, professional, and technical review staff on each project to ensure that you are served at a high level by staff with the necessary background and experience. And our local presence makes access to these resources simple. Moreover, we have the tools that tell us exactly how and when to implement these resources. While this can be perceived as an internal issue to the firm, the tools we use to manage and administer a project are really for the clients' benefit because a firm basis is established for on-time, within-budget delivery of all services. Your schedule and budget are extremely important to us, and our resources will allow us to meet the goals established for your projects.

## LICENSES/CERTIFICATIONS – KIMLEY-HORN AND ASSOCIATES, INC.

**State of Florida**  
Board of Professional Engineers  
Attests that  
**Kimley-Horn & Associates, Inc.**

is authorized under the provisions of Section 471.023, Florida Statutes, to offer engineering services to the public through a Professional Engineer, duly licensed under Chapter 471, Florida Statutes.

Expiration: 2/28/2017  
Audit No: 228201702724

CA Lic. No: 696

RICK SCOTT, GOVERNOR KEN LAWSON, SECRETARY

STATE OF FLORIDA  
DEPARTMENT OF BUSINESS AND PROFESSIONAL REGULATION  
BOARD OF LANDSCAPE ARCHITECTURE

LICENSE NUMBER  
LCC000219

The LANDSCAPE ARCHITECT BUSINESS  
Named below HAS REGISTERED  
Under the provisions of Chapter 481 FS.  
Expiration date: NOV 30, 2017

KIMLEY-HORN AND ASSOCIATES INC  
P O BOX 33068  
RALEIGH NC 276363068

ISSUED: 11/04/2015 DISPLAY AS REQUIRED BY LAW SEQ # L1511040001291

Florida Department of Agriculture and Consumer Services  
Division of Consumer Services  
Board of Professional Surveyors and Mappers  
2805 Apalachee Pkwy Tallahassee, Florida 32399-6590

License No: LB696  
Expiration Date February 28, 2017

**Professional Surveyor and Mapper Business License**  
Under the provisions of Chapter 472, Florida Statutes

KIMLEY-HORN AND ASSOCIATES, INC.  
3001 WESTON PKWY  
CARY, NC 27513-2301

ADAM H. PUTNAM  
COMMISSIONER OF AGRICULTURE

This is to certify that the professional surveyor and mapper whose name and address are shown above is licensed as required by Chapter 472, Florida Statutes.

RICK SCOTT, GOVERNOR KEN LAWSON, SECRETARY

STATE OF FLORIDA  
DEPARTMENT OF BUSINESS AND PROFESSIONAL REGULATION  
BOARD OF PROFESSIONAL GEOLOGISTS

LICENSE NUMBER  
GB175

The GEOLOGY BUSINESS  
Named below IS CERTIFIED  
Under the provisions of Chapter 492 FS.  
Expiration date: JUL 31, 2018

KIMLEY-HORN AND ASSOCIATES INC  
5302 FAYETTEVILLE STREET  
SUITE 600  
RALEIGH NC 27601

ISSUED: 07/25/2016 DISPLAY AS REQUIRED BY LAW SEQ # L1607250001560

**BROWARD COUNTY LOCAL BUSINESS TAX RECEIPT**  
115 S. Andrews Ave., Rm. A-100 Ft. Lauderdale, FL 33301-1895 - 954-831-4000  
VALID OCTOBER 1, 2015 THROUGH SEPTEMBER 30, 2016

DBA: KIMLEY-HORN & ASSOCIATES INC  
Business Name: KIMLEY-HORN & ASSOCIATES INC  
Owner Name: KIMLEY-HORN & ASSOCIATES INC  
Business Location: 600 N PINE ISLAND RD #450  
Business Phone: 954-733-2233

Receipt #: 377-32519  
Business Type: (2000 OFFICE)  
Business Opened: 02/01/1984  
State/County/Cert/Reg: FL/DADE/REG  
Exemption Code:

Tax Amount	Transfer Fee	NDF Fee	Penalty	Prior Years	Collection Cost	Total Paid
45.00	0.00	0.00	0.00	0.00	0.00	45.00

THIS RECEIPT MUST BE POSTED CONSPICUOUSLY IN YOUR PLACE OF BUSINESS

THIS BECOMES A TAX RECEIPT  
WHEN VALIDATED

Mailing Address:  
KIMLEY-HORN & ASSOCIATES INC  
PO BOX 33068  
RALEIGH, NC 27636

Receipt #: 8999-14-00128433  
Paid: 09/09/2015 45.00

2015 - 2016

**State of Florida**  
**Department of State**

I certify from the records of this office that KIMLEY-HORN AND ASSOCIATES, INC. is a North Carolina corporation authorized to transact business in the State of Florida, qualified on April 24, 1968.

The document number of this corporation is 821359.

I further certify that said corporation has paid all fees due this office through December 31, 2016, that its most recent annual report/uniform business report was filed on January 28, 2016, and that its status is active.

I further certify that said corporation has not filed a Certificate of Withdrawal.

Given under my hand and the Great Seal of the State of Florida at Tallahassee, the Capital, this the Eighteenth day of May, 2016

*Ken Detjen*  
Secretary of State

Tracking Number: CU4949004970

To authenticate this certificate, visit the following site, enter this number, and then follow the instructions displayed.  
<https://services.sunbiz.org/Filings/CertificateOfStatus/CertificateAuthentication>

Detach and display the Local Business Tax Certificate below. Renew and display current certificate annually.

City of Plantation  
**LOCAL BUSINESS TAX CERTIFICATE**

Certificate # 153297  
Account # OC14-0075

Valid from 10/01/2015 to 09/30/2016

Classification: (26) Administration/Management Office

Business Name & Address:  
KIMLEY-HORN AND ASSOCIATES, INC  
600 N PINE ISLAND RD #450  
PLANTATION FL 33324

THIS CERTIFICATE MUST BE CONSPICUOUSLY DISPLAYED

*Susan K. Slattery*  
CITY CLERK SIGNATURE

NOTICE: If Business is sold this Certificate must be transferred within 10 days or it becomes null and void.

**U.S. Green Building Council**  
**Kimley-Horn and Associates, Inc.**  
Member Since 2006

THE U.S. GREEN BUILDING COUNCIL IS THE NATION'S FOREMOST COALITION OF LEADERS WORKING TO TRANSFORM THE WAY BUILDINGS AND COMMUNITIES ARE DESIGNED, BUILT AND OPERATED, ENABLING AN ENVIRONMENTALLY AND SOCIALLY RESPONSIBLE, HEALTHY, AND PROSPEROUS ENVIRONMENT THAT IMPROVES THE QUALITY OF LIFE.

*Robert D. Horn*  
Chairman

*R.*  
President



## Kimley-Horn's Staff Licenses

**State of Florida**  
Board of Professional Engineers  
Attests that  
**Stefano F. Viola, P.E.**

Is licensed as a Professional Engineer under Chapter 471, Florida Statutes  
Expiration: 2/28/2017  
Audit No: 228201717007

**FBPE**  
FLORIDA BOARD OF PROFESSIONAL ENGINEERS  
P.E. Lic. No: 74655

**State of Florida**  
Board of Professional Engineers  
Attests that  
**Lyndon Michael Carey, P.E.**

Is licensed as a Professional Engineer under Chapter 471, Florida Statutes  
Expiration: 2/28/2017  
Audit No: 228201724809

**FBPE**  
FLORIDA BOARD OF PROFESSIONAL ENGINEERS  
P.E. Lic. No: 35487

**State of Florida**  
Board of Professional Engineers  
Attests that  
**Gary R. Ratay, P.E.**

Is licensed as a Professional Engineer under Chapter 471, Florida Statutes  
Expiration: 2/28/2017  
Audit No: 228201715306

**FBPE**  
FLORIDA BOARD OF PROFESSIONAL ENGINEERS  
P.E. Lic. No: 46682

**State of Florida**  
Board of Professional Engineers  
Attests that  
**Carlos H. Florian, P.E.**

Is licensed as a Professional Engineer under Chapter 471, Florida Statutes  
Expiration: 2/28/2017  
Audit No: 228201735126 ID

**FBPE**  
FLORIDA BOARD OF PROFESSIONAL ENGINEERS  
P.E. Lic. No: 80500

**State of Florida**  
Board of Professional Engineers  
Attests that  
**Britt Lindsey Stephens, P.E.**

Is licensed as a Professional Engineer under Chapter 471, Florida Statutes  
Expiration: 2/28/2017  
Audit No: 228201716771

**FBPE**  
FLORIDA BOARD OF PROFESSIONAL ENGINEERS  
P.E. Lic. No: 71465

**State of Florida**  
Board of Professional Engineers  
Attests that  
**Jonathan Allen Martin, P.E.**

Is licensed as a Professional Engineer under Chapter 471, Florida Statutes  
Expiration: 2/28/2017  
Audit No: 228201726801

**FBPE**  
FLORIDA BOARD OF PROFESSIONAL ENGINEERS  
P.E. Lic. No: 54055

**State of Florida**  
Board of Professional Engineers  
Attests that  
**Brian Scott Ashby, P.E.**

Is licensed as a Professional Engineer under Chapter 471, Florida Statutes  
Expiration: 2/28/2017  
Audit No: 228201734984 I

**FBPE**  
FLORIDA BOARD OF PROFESSIONAL ENGINEERS  
P.E. Lic. No: 80456

**State of Florida**  
Board of Professional Engineers  
Attests that  
**Barton Junior Fye, P.E.**

Is licensed as a Professional Engineer under Chapter 471, Florida Statutes  
Expiration: 2/28/2017  
Audit No: 228201705505

**FBPE**  
FLORIDA BOARD OF PROFESSIONAL ENGINEERS  
P.E. Lic. No: 73898





# Master Drainage/Conceptual Environmental Resources Permit RFQ 276-11831

Kimley»Horn  
CAM 17-0337  
EXHIBIT 2



# ARCHITECT – ENGINEER QUALIFICATIONS

## PART I – CONTRACT SPECIFIC QUALIFICATIONS

### A. CONTRACT INFORMATION

1. TITLE AND LOCATION <i>(City and State)</i> City of Fort Lauderdale FXE Master Drainage/Conceptual Environmental Resources Permit, Fort Lauderdale	
2. PUBLIC NOTICE DATE 9/21/2016	3. SOLICITATION OR PROJECT NUMBER 276-11831

### B. ARCHITECT – ENGINEER POINT OF CONTACT

4. NAME AND TITLE Stefano F. Viola, P.E., Engineer		
5. NAME OF FIRM Kimley-Horn and Associates, Inc.		
6. TELEPHONE NUMBER (954) 535-5133	7. FAX NUMBER (561) 863-8175	8. E-MAIL ADDRESS <a href="mailto:Stefano.Viola@kimley-horn.com">Stefano.Viola@kimley-horn.com</a>

### C. PROPOSED TEAM

*(Complete this section for the prime contractor and all key subcontractors.)*

<i>(Check)</i>				9. FIRM NAME	10. ADDRESS	11. ROLE IN THIS CONTRACT
PRIME	J-V	PARTNER	SUBCON-SULTANT			
a.	X			Kimley-Horn and Associates, Inc.  <input checked="" type="checkbox"/> CHECK IF BRANCH OFFICE	600 North Pine Island Road Suite 450 Plantation 33324	Prime consultant
b.	X			Kimley-Horn and Associates, Inc.  <input checked="" type="checkbox"/> CHECK IF BRANCH OFFICE	445 24 <sup>th</sup> Street Suite 200 Vero Beach 32960	Prime consultant
c.	X			Kimley-Horn and Associates, Inc.  <input checked="" type="checkbox"/> CHECK IF BRANCH OFFICE	1615 South Congress Avenue Suite 201 Delray Beach 33445	Prime consultant
d.	X			Kimley-Horn and Associates, Inc.  <input checked="" type="checkbox"/> CHECK IF BRANCH OFFICE	3660 Maguire Boulevard Suite 200 Orlando 32803	Prime consultant
e.	X			Kimley-Horn and Associates, Inc.  <input checked="" type="checkbox"/> CHECK IF BRANCH OFFICE	1221 Brickell Avenue Suite 400 Miami 33131	Prime consultant
f.			X	EG Solutions, Inc.  <input checked="" type="checkbox"/> CHECK IF BRANCH OFFICE	9015 Town Center Parkway Suite 106 Lakewood Ranch 34202	Quality Assurance/Quality Control Assistance

### D. ORGANIZATIONAL CHART OF PROPOSED TEAM

☒ *(Attached)*

**C. PROPOSED TEAM**  
*(Complete this section for the prime contractor and all key subcontractors.)*

	(Check)			9. FIRM NAME	10. ADDRESS	11. ROLE IN THIS CONTRACT
	PRIME	J-V PARTNER	SUBCON-SULTANT			
g.			<b>X</b>	Keith and Associates, Inc.  <input checked="" type="checkbox"/> CHECK IF BRANCH OFFICE	301 East Atlantic Boulevard Pompano Beach 33060	Surveying services
h.			<b>X</b>	Tierra South Florida, Inc.  <input checked="" type="checkbox"/> CHECK IF BRANCH OFFICE	2765 Vista Parkway Suite 10 West Palm Beach 33411	Geotechnical services
i.				<input type="checkbox"/> CHECK IF BRANCH OFFICE		
j.				<input type="checkbox"/> CHECK IF BRANCH OFFICE		
k.				<input type="checkbox"/> CHECK IF BRANCH OFFICE		
l.				<input type="checkbox"/> CHECK IF BRANCH OFFICE		
m.				<input type="checkbox"/> CHECK IF BRANCH OFFICE		
n.				<input type="checkbox"/> CHECK IF BRANCH OFFICE		
o.				<input type="checkbox"/> CHECK IF BRANCH OFFICE		
p.				<input type="checkbox"/> CHECK IF BRANCH OFFICE		





# E. RESUMES OF KEY PERSONNEL PROPOSED FOR THIS CONTRACT

(Complete one Section E for each key person.)

12. NAME <b>Stefano F. Viola, P.E.</b>	13. ROLE IN THIS CONTRACT <b>Project Manager</b>	14. YEARS EXPERIENCE	
		a. TOTAL 10	b. WITH CURRENT FIRM 10

15. FIRM NAME AND LOCATION (City and State)  
Kimley-Horn and Associates, Inc., Plantation

16. EDUCATION (DEGREE AND SPECIALIZATION)  
Bachelor of Science / Civil Engineering / Florida International Univ.

17. CURRENT PROFESSIONAL REGISTRATION (STATE AND DISCIPLINE)  
FL / Professional Engineer / 74655

18. OTHER PROFESSIONAL QUALIFICATIONS (Publications, Organizations, Training, Awards, etc.)

## 19. RELEVANT PROJECTS

(1) TITLE AND LOCATION (City and State)	(2) YEAR COMPLETED	
	PROFESSIONAL SERVICES	CONSTRUCTION (If Applicable)
a. (1) TITLE AND LOCATION (City and State) <b>Margate City Center Stormwater Master Permit, Margate</b>  (3) BRIEF DESCRIPTION (Brief scope, size, cost, etc.) AND SPECIFIC ROLE Served as project manager. The Margate CRA selected Kimley-Horn to prepare a conceptual stormwater master plan for their 43.7-acre downtown area. The project area included a complete stormwater system re-design to incorporate the proposed development, which will include garden style apartments, townhomes, mid-rise condominiums, civic uses, and commercial developments. The project also included the preparation of a master drainage model (created using the ICPR software), an evaluation of the existing drainage system within this area, the creation of drainage basin delineations and maps, a complete hydraulic/hydrologic analysis of the area, and the proposed master conceptual drainage improvement plans. Kimley-Horn was successful in obtaining a new conceptual permit through the Broward County Surface Water Management Section, as well as a new conceptual ERP permit through the South Florida Water Management District.	2016  <input checked="" type="checkbox"/> Check if project performed with current firm	 
b. (1) TITLE AND LOCATION (City and State) <b>Broward Center for the Performing Arts Renovation and Expansion, Fort Lauderdale</b>  (3) BRIEF DESCRIPTION (Brief scope, size, cost, etc.) AND SPECIFIC ROLE Served as project engineer, providing permitting assistance and utility coordination. The Broward Center of the Performing Arts is a public-private partnership which was originally constructed in 1989 and is located in the heart of the Fort Lauderdale Arts and Science District. Kimley-Horn provided the traffic access, circulation, and parking studies for the original facility. The expansion included a production wing, an educational wing, and a pavilion along the river walk. The six-acre site required extensive drainage modeling for an Environmental Resource Permit (ERP)/ Broward County Stormwater Permit modification.	2014  <input checked="" type="checkbox"/> Check if project performed with current firm	2014 
c. (1) TITLE AND LOCATION (City and State) <b>Miami Lakes Stormwater Master Plan, Miami Lakes</b>  (3) BRIEF DESCRIPTION (Brief scope, size, cost, etc.) AND SPECIFIC ROLE Served as project engineer. Kimley-Horn prepared a stormwater master plan that outlined the deficiencies of the current stormwater system to develop Miami Lakes' own stormwater utility. The stormwater master plan included an evaluation for the existing drainage system, drainage basin map, hydraulic/hydrologic analysis, proposed drainage improvement projects, and proposed operation and maintenance plan. Additionally, we developed the stormwater utility fee methodology and established the range of rates for the utility to implement improvements. Kimley-Horn also prepared a five-year Capital Improvements Plan for the stormwater improvements.	2012  <input checked="" type="checkbox"/> Check if project performed with current firm	 
d. (1) TITLE AND LOCATION (City and State) <b>Lloyd Estates Streetscape and Drainage Improvements, Oakland Park</b>  (3) BRIEF DESCRIPTION (Brief scope, size, cost, etc.) AND SPECIFIC ROLE Project engineer, provided permitting elements and utility coordination. Kimley-Horn provided professional engineering services for the design and construction of the Lloyd Estates Residential and Industrial Area Drainage Project. The project involved phased drainage and water distribution system improvements consisting of the construction of a stormwater collection system with water quality treatment measures and possible upgraded outfalls. The professional services include surveying, stormwater analysis, civil and electrical engineering design, landscaping and irrigation, permitting, coordinating with utility providers for adjustments and or relocations, preparing quantity calculations, and engineer's estimates of probable costs.	2012  <input checked="" type="checkbox"/> Check if project performed with current firm	2013 
e. (1) TITLE AND LOCATION (City and State) <b>Palmetto Bay Stormwater Master Plan, Palmetto Bay</b>  (3) BRIEF DESCRIPTION (Brief scope, size, cost, etc.) AND SPECIFIC ROLE Served as project engineer. The stormwater master plan required extensive research of the community's roadways, utilities, and drainage patterns to understand the condition of the infrastructure and stormwater management needs. As part of the stormwater master plan, Kimley-Horn assisted the Village in developing a capital improvement program to prioritize improvements based on flood management needs and associated costs. In addition, Kimley-Horn helped the Village evaluate properties throughout the Village and developed associated utility rates to generate a dedicated revenue stream for the Village improvements.	2015  <input checked="" type="checkbox"/> Check if project performed with current firm	 

# **E. RESUMES OF KEY PERSONNEL PROPOSED FOR THIS CONTRACT**

(Complete one Section E for each key person.)

12. NAME <b>L. Michael Carey, P.E.</b>	13. ROLE IN THIS CONTRACT <b>Principal-in-Charge</b>	14. YEARS EXPERIENCE <table border="1"> <tr> <td>a. TOTAL 37</td> <td>b. WITH CURRENT FIRM 14</td> </tr> </table>		a. TOTAL 37	b. WITH CURRENT FIRM 14
a. TOTAL 37	b. WITH CURRENT FIRM 14				
15. FIRM NAME AND LOCATION (City and State) <b>Kimley-Horn and Associates, Inc., Plantation</b>					
16. EDUCATION (DEGREE AND SPECIALIZATION) <b>Bachelor of Science / Civil Engineering / Clemson University</b>		17. CURRENT PROFESSIONAL REGISTRATION (STATE AND DISCIPLINE) <b>FL / Professional Engineer / 35487</b>			
18. OTHER PROFESSIONAL QUALIFICATIONS (Publications, Organizations, Training, Awards, etc.)					

## **19. RELEVANT PROJECTS**

(1) TITLE AND LOCATION (City and State)	(2) YEAR COMPLETED	
<b>Fort Lauderdale Executive Airport (FXE) Runway 8-26 Rehabilitation and Taxiway Hotel Relocation, Fort Lauderdale</b>	PROFESSIONAL SERVICES 2003	CONSTRUCTION (If Applicable) 2004
(3) BRIEF DESCRIPTION (Brief scope, size, cost, etc.) AND SPECIFIC ROLE <b>a.</b> Project engineer for the design and construction phase services for the rehabilitation of Runway 8-26 and the relocation of Taxiway Hotel. The project was initiated with a stakeholder meeting to determine the preferred sequence of construction. The decision was made to shut down the runway for a 10-day period to allow construction to be completed in the shortest amount of time possible. The project included the rehabilitation of the entire runway, construction of new blast pads at both ends, and relocation of portions of Taxiway Hotel to straighten the alignment.	<input checked="" type="checkbox"/> Check if project performed with current firm	
(1) TITLE AND LOCATION (City and State)	(2) YEAR COMPLETED	
<b>Terminal 4 Expansion, Fort Lauderdale-Hollywood International Airport (FLL), Fort Lauderdale</b>	PROFESSIONAL SERVICES Ongoing	CONSTRUCTION (If Applicable)
(3) BRIEF DESCRIPTION (Brief scope, size, cost, etc.) AND SPECIFIC ROLE <b>b.</b> Serving as project manager for the Kimley-Horn team for the replacement of Terminal 4 at Fort Lauderdale-Hollywood International Airport (FLL), which is a phased program to replace the existing Concourse H. The existing Concourse aircraft parking configuration has significant conflicts with the new Runway 9R-27L and the new program will resolve these issues. The program, when complete, will consist of 14 gates that replace the existing 10 gate Concourse H. The new facilities will provide more concessions, passenger amenities, and be a more environmentally-friendly facility than the existing Concourse. Once completed, the project will be the most modern building at the airport.	<input checked="" type="checkbox"/> Check if project performed with current firm	
(1) TITLE AND LOCATION (City and State)	(2) YEAR COMPLETED	
<b>General Engineering Consulting Services for St. Petersburg-Clearwater International Airport (PIE), Clearwater</b>	PROFESSIONAL SERVICES 2011	CONSTRUCTION (If Applicable)
(3) BRIEF DESCRIPTION (Brief scope, size, cost, etc.) AND SPECIFIC ROLE <b>c.</b> Served as principal-in-charge. Kimley-Horn has served as general engineering consultant for PIE since 2008. Services provided have included project management and coordination, design services, field investigation, pavement inspection, Florida Aviation Administration (FAA) coordination, construction plans and specifications, bidding assistance, grant preparation, and cost estimating. Projects under this contract have included the rehabilitation of Taxiways A and B, the rehabilitation of a service road drainage structure, tree clearing of Runway 4, and grant application assistance.	<input checked="" type="checkbox"/> Check if project performed with current firm	
(1) TITLE AND LOCATION (City and State)	(2) YEAR COMPLETED	
<b>Orlando International Airport, Airfield Pavement Improvements Orlando</b>	PROFESSIONAL SERVICES 2008	CONSTRUCTION (If Applicable) 2008
(3) BRIEF DESCRIPTION (Brief scope, size, cost, etc.) AND SPECIFIC ROLE <b>d.</b> Project manager for the Kimley-Horn team selected for multiple airfield rehabilitation tasks at OIA. The first task included the rehabilitation of the Airsides 2 and 4 ramp and was completed in 2008 at a cost of \$4.2 million. The project involved the rehabilitation of the existing concrete ramps surrounding Airsides 2 and 4. Other components of the project included the rejuvenation of the existing asphalt shoulder and the replacement of damaged electrical pedestals on Airside 4. The work was expanded to include the remarking of portions of Airside 4 due to the relocation of Airtran from Airside 2 to Airside 4.	<input checked="" type="checkbox"/> Check if project performed with current firm	
(1) TITLE AND LOCATION (City and State)	(2) YEAR COMPLETED	
<b>Sheltair Northside Fixed Base Operator (FBO) at Fort Lauderdale Executive Airport (FXE)</b>	PROFESSIONAL SERVICES Ongoing	CONSTRUCTION (If Applicable)
(3) BRIEF DESCRIPTION (Brief scope, size, cost, etc.) AND SPECIFIC ROLE <b>e.</b> Principal in charge for this civil engineering consultant contract to design, permit, bid, and administer construction phase services for its new FBO at FXE. The project consists of a combination of offices, hangars, and a fixed base operator (FBO) with associated drive aisles, parking, aprons, and site utilities located adjacent to primary Runway 9-27 at FXE. The facility is anticipated to be 29,651 square feet of office and FBO building area, 11,300 square feet of workshops, 157,976 square feet of hangar area and 20.15 acres of site work.	<input checked="" type="checkbox"/> Check if project performed with current firm	

# **E. RESUMES OF KEY PERSONNEL PROPOSED FOR THIS CONTRACT**

*(Complete one Section E for each key person.)*

12. NAME <b>Gary R. Ratay, P.E.</b>	13. ROLE IN THIS CONTRACT <b>Quality Assurance/Quality Control</b>	14. YEARS EXPERIENCE <table border="1"> <tr> <td>a. TOTAL 31</td> <td>b. WITH CURRENT FIRM 20</td> </tr> </table>		a. TOTAL 31	b. WITH CURRENT FIRM 20
a. TOTAL 31	b. WITH CURRENT FIRM 20				
15. FIRM NAME AND LOCATION <i>(City and State)</i> <b>Kimley-Horn and Associates, Inc., Plantation</b>					
16. EDUCATION <i>(DEGREE AND SPECIALIZATION)</i> <b>Bachelor of Science / Mechanical Engineering / Univ. of Florida</b>		17. CURRENT PROFESSIONAL REGISTRATION <i>(STATE AND DISCIPLINE)</i> <b>FL / Professional Engineer / 0046682</b>			
18. OTHER PROFESSIONAL QUALIFICATIONS <i>(Publications, Organizations, Training, Awards, etc.)</i>					

## **19. RELEVANT PROJECTS**

(1) TITLE AND LOCATION <i>(City and State)</i>	(2) YEAR COMPLETED	
<b>Miami Lakes Stormwater Master Plan Miami Lakes</b>	PROFESSIONAL SERVICES 2012	CONSTRUCTION <i>(If Applicable)</i> 
(3) BRIEF DESCRIPTION <i>(Brief scope, size, cost, etc.)</i> AND SPECIFIC ROLE  <b>a.</b> Served as project manager. Kimley-Horn prepared a stormwater master plan that outlined the deficiencies of the current stormwater system to develop Miami Lakes' own stormwater utility. The stormwater master plan included an evaluation for the existing drainage system, drainage basin map, hydraulic/hydrologic analysis, proposed drainage improvement projects, and proposed operation and maintenance plan. Additionally, we developed the stormwater utility fee methodology and established the range of rates for the utility to implement improvements. Kimley-Horn also prepared a five-year Capital Improvements Plan for the stormwater improvements.	<input checked="" type="checkbox"/> Check if project performed with current firm	
<b>(1) TITLE AND LOCATION <i>(City and State)</i></b> <b>Broward Center for the Performing Arts Renovation and Expansion, Fort Lauderdale</b>	PROFESSIONAL SERVICES 2014	CONSTRUCTION <i>(If Applicable)</i> 2014
(3) BRIEF DESCRIPTION <i>(Brief scope, size, cost, etc.)</i> AND SPECIFIC ROLE  <b>b.</b> Served as project engineer. Also provided utility coordination. The Broward Center of the Performing Arts is a public-private partnership which was originally constructed in 1989 and is located in the heart of the Fort Lauderdale Arts and Science District. Kimley-Horn provided the traffic access, circulation, and parking studies for the original facility. In 2012, Kimley-Horn provided traffic studies and site civil engineering for the expansion and renovation of the facility. The expansion included a production wing, an educational wing, and a pavilion along the river walk. The expansion construction started in 2013 and was completed in 2014. The six-acre site required extensive drainage modeling for an Environmental Resource Permit (ERP)/ Broward County Stormwater Permit modification.	<input checked="" type="checkbox"/> Check if project performed with current firm	
<b>(1) TITLE AND LOCATION <i>(City and State)</i></b> <b>Lloyd Estates Streetscape and Drainage Improvements, Oakland Park</b>	PROFESSIONAL SERVICES 2012	CONSTRUCTION <i>(If Applicable)</i> 2013
(3) BRIEF DESCRIPTION <i>(Brief scope, size, cost, etc.)</i> AND SPECIFIC ROLE  <b>c.</b> Principal-in-charge for the design and construction of the Lloyd Estates Residential and Industrial Area Drainage Project. The project involved phased drainage and water distribution system improvements consisting of the construction of a stormwater collection system with water quality treatment measures and possible upgraded outfalls, as well as replacement of select existing water mains within the project area. The professional services included surveying, stormwater analysis, civil and electrical engineering design, landscaping and irrigation, permitting, coordinating with utility providers for adjustments and or relocations, preparing quantity calculations, and engineer's estimates of probable costs.	<input checked="" type="checkbox"/> Check if project performed with current firm	
<b>(1) TITLE AND LOCATION <i>(City and State)</i></b> <b>Palmetto Bay Stormwater Master Plan Palmetto Bay</b>	PROFESSIONAL SERVICES 2015	CONSTRUCTION <i>(If Applicable)</i> 
(3) BRIEF DESCRIPTION <i>(Brief scope, size, cost, etc.)</i> AND SPECIFIC ROLE  <b>d.</b> Served as project engineer. The stormwater master plan required extensive research of the community's roadways, utilities, and drainage patterns to understand the condition of the infrastructure and stormwater management needs. As part of the stormwater master plan, Kimley-Horn assisted the Village in developing a capital improvement program to prioritize improvements based on flood management needs and associated costs. In addition, Kimley-Horn helped the Village evaluate properties throughout the Village and developed associated utility rates to generate a dedicated revenue stream for the Village improvements.	<input checked="" type="checkbox"/> Check if project performed with current firm	
<b>(1) TITLE AND LOCATION <i>(City and State)</i></b> <b>Miami Lakes Downtown Phase I and II, and Lake Patricia Roadway/Drainage Improvement Projects, Miami Lakes</b>	PROFESSIONAL SERVICES 2012	CONSTRUCTION <i>(If Applicable)</i> 2014
(3) BRIEF DESCRIPTION <i>(Brief scope, size, cost, etc.)</i> AND SPECIFIC ROLE  <b>e.</b> Served as project manager. Kimley-Horn was involved with the design and permitting services to implement a large roadway and drainage improvement project located in Downtown Miami Lakes. The capital project included approximately one mile of roadway restoration/resurfacing and drainage improvements in residential/business areas, curbing and sidewalk improvements, a new outfall pipe, swale restoration, signing and pavement markings, and site restoration. The drainage improvements consisted of approximately 3,000 linear feet of exfiltration trench, approximately 2,500 linear feet of HDPE piping, approximately 40 drainage structures and one outfall structure and headwall.	<input checked="" type="checkbox"/> Check if project performed with current firm	

CAM 17-0337

# **E. RESUMES OF KEY PERSONNEL PROPOSED FOR THIS CONTRACT**

(Complete one Section E for each key person.)

12. NAME <b>Carlos H. Florian, P.E.</b>	13. ROLE IN THIS CONTRACT <b>Project Engineer</b>	14. YEARS EXPERIENCE	
		a. TOTAL <b>5</b>	b. WITH CURRENT FIRM <b>2</b>
15. FIRM NAME AND LOCATION (City and State) <b>Kimley-Horn and Associates, Inc., Plantation</b>			
16. EDUCATION (DEGREE AND SPECIALIZATION) <b>Bachelor of Science / Civil Engineering / Florida International Univ.</b>		17. CURRENT PROFESSIONAL REGISTRATION (STATE AND DISCIPLINE) <b>FL / Professional Engineer / 80500</b>	
18. OTHER PROFESSIONAL QUALIFICATIONS (Publications, Organizations, Training, Awards, etc.)			

## **19. RELEVANT PROJECTS**

	(1) TITLE AND LOCATION (City and State)	(2) YEAR COMPLETED	
		PROFESSIONAL SERVICES	CONSTRUCTION (If Applicable)
a.	<b>Margate City Center Stormwater Master Permit, Margate</b>	<b>2016</b>	
	(3) BRIEF DESCRIPTION (Brief scope, size, cost, etc.) AND SPECIFIC ROLE <p><b>[X]</b> Check if project performed with current firm</p> <p>Served as project engineer. The Margate CRA selected Kimley-Horn to prepare a conceptual stormwater master plan for their 43.7-acre downtown area. The project area included a complete stormwater system re-design to incorporate the proposed development, which will include garden style apartments, townhomes, mid-rise condominiums, civic uses, and commercial developments. The project also included the preparation of a master drainage model (created using the ICPR software), an evaluation of the existing drainage system within this area, the creation of drainage basin delineations and maps, a complete hydraulic/hydrologic analysis of the area, and the proposed master conceptual drainage improvement plans. Kimley-Horn was successful in obtaining a new conceptual permit through the Broward County Surface Water Management Section, as well as a new conceptual ERP permit through the South Florida Water Management District.</p>		
b.	<b>OB Johnson Park, Hallandale Beach</b>	<b>2016</b>	<b>2016</b>
	(3) BRIEF DESCRIPTION (Brief scope, size, cost, etc.) AND SPECIFIC ROLE <p><b>[X]</b> Check if project performed with current firm</p> <p>Project engineer for master planning, landscape architecture, engineering design and permitting services, as well as construction observation and administration for this 6.4-acre park. The park included a 42,000 SF multigenerational facility that included a teen center, indoor basketball courts, after school and senior programming, exercise room, administrative offices, and other accessory uses for computer and dance classes, food distribution, and other programming for all ages. The exterior park amenities included a walking trail, playground, tennis courts, a field house, and a football/soccer field. Additionally, the park improvements included a centrally located surface parking lot, site infrastructure and landscaping.</p>		
c.	<b>SW 67th Avenue, Davie</b>	<b>Ongoing</b>	
	(3) BRIEF DESCRIPTION (Brief scope, size, cost, etc.) AND SPECIFIC ROLE <p><b>[X]</b> Check if project performed with current firm</p> <p>Project engineer. The Town of Davie's SW 67th Avenue project is an extension of the Town's existing roadway from NW 41st Court south to Orange Drive. The expansion provides approximately 1,400 linear feet of a new two-lane roadway that includes roadway swales and exfiltration trench for drainage. Along with the roadway and drainage improvements, the project includes an 8' wide sidewalk addition to improve pedestrian and equestrian traffic through the Town. Once completed the project will provide additional access to the area schools and help alleviate the traffic on Davie Road extension.</p>		
d.	<b>Franklin Academy Charter School, Pembroke Pines</b>	<b>2016</b>	<b>2016</b>
	(3) BRIEF DESCRIPTION (Brief scope, size, cost, etc.) AND SPECIFIC ROLE <p><b>[X]</b> Check if project performed with current firm</p> <p>Project engineer for the charter school located on a 43 acre parcel in Pembroke Pines. Services include due diligence, all civil design plans, specifications and calculations in order to permit the project. Specific requirements of this project were the design of an on-site lift station and 2000 LF of force main within the property and Broward County's right of way.</p>		
e.	<b>Westside Blueway Trail Phase II, Miami Gardens</b>	<b>Ongoing</b>	
	(3) BRIEF DESCRIPTION (Brief scope, size, cost, etc.) AND SPECIFIC ROLE <p><b>[X]</b> Check if project performed with current firm</p> <p>Project engineer. Kimley-Horn is currently performing all of the necessary planning and design services for the development of the Westside Blueway Trail inclusive of the site amenities and furnishings. The firm was also tasked with providing full construction documents and specifications as required for the bidding, construction observations, and administration of the project.</p>		



# **E. RESUMES OF KEY PERSONNEL PROPOSED FOR THIS CONTRACT**

(Complete one Section E for each key person.)

12. NAME <b>Alexander F. Lopez, E.I.</b>	13. ROLE IN THIS CONTRACT <b>Project Analyst</b>	14. YEARS EXPERIENCE	
		a. TOTAL <b>7</b>	b. WITH CURRENT FIRM <b>1</b>
15. FIRM NAME AND LOCATION (City and State) <b>Kimley-Horn and Associates, Inc., Plantation</b>			
16. EDUCATION (DEGREE AND SPECIALIZATION) <b>Bachelor of Science / Environ. Engineering / Florida Int'l Univ.</b>		17. CURRENT PROFESSIONAL REGISTRATION (STATE AND DISCIPLINE) <b>FL / Engineering Intern / 1100016005</b>	
18. OTHER PROFESSIONAL QUALIFICATIONS (Publications, Organizations, Training, Awards, etc.)			

## **19. RELEVANT PROJECTS**

	(1) TITLE AND LOCATION (City and State)	(2) YEAR COMPLETED	
		PROFESSIONAL SERVICES	CONSTRUCTION (If Applicable)
a.	<b>Margate City Center Stormwater Master Permit, Margate</b>	<b>2016</b>	
	(3) BRIEF DESCRIPTION (Brief scope, size, cost, etc.) AND SPECIFIC ROLE <p>Served as project analyst. The Margate CRA selected Kimley-Horn to prepare a conceptual stormwater master plan for their 43.7-acre downtown area. The project area included a complete stormwater system re-design to incorporate the proposed development, which will include garden style apartments, townhomes, mid-rise condominiums, civic uses, and commercial developments. The project also included the preparation of a master drainage model (created using the ICPR software), an evaluation of the existing drainage system within this area, the creation of drainage basin delineations and maps, a complete hydraulic/hydrologic analysis of the area, and the proposed master conceptual drainage improvement plans. Kimley-Horn was successful in obtaining a new conceptual permit through the Broward County Surface Water Management Section, as well as a new conceptual ERP permit through the South Florida Water Management District.</p>		
b.	<b>Fort Lauderdale-Hollywood International Airport (FLL) Jetscape FBO Development, Fort Lauderdale</b>	<b>Ongoing</b>	
	(3) BRIEF DESCRIPTION (Brief scope, size, cost, etc.) AND SPECIFIC ROLE <p>Project analyst. Kimley-Horn is teaming with a local architect for the development of a fixed base operator facility (FBO) on the west side of FLL. We are preparing construction drawings for Phase I site improvements and will assist the architect for processing the site plan by providing conceptual engineering drawings identified in the scope of work.</p>		
c.	<b>Pompano Beach Airpark, Taxiway D Relocation, Pompano Beach</b>	<b>Ongoing</b>	
	(3) BRIEF DESCRIPTION (Brief scope, size, cost, etc.) AND SPECIFIC ROLE <p>Project analyst. Kimley-Horn was retained by Pompano Beach to provide design, bidding, site development, and construction phase services for the relocation of Taxiway Delta. Tasks will include burrowing owl and gopher tortoise site surveys, development of plans, permitting assistance, and bid assistance.</p>		
d.	<b>SW 67th Avenue, Davie</b>	<b>Ongoing</b>	
	(3) BRIEF DESCRIPTION (Brief scope, size, cost, etc.) AND SPECIFIC ROLE <p>Project analyst. The Town of Davie's SW 67th Avenue project is an extension of the Town's existing roadway from NW 41st Court south to Orange Drive. The expansion provides approximately 1,400 linear feet of a new two-lane roadway that includes roadway swales and exfiltration trench for drainage. Along with the roadway and drainage improvements, the project includes an 8' wide sidewalk addition to improve pedestrian and equestrian traffic through the Town. Once completed the project will provide additional access to the area schools and help alleviate the traffic on Davie Road extension.</p>		
e.	<b>City of Miramar Continuing Engineering Services, Miramar</b>	<b>Ongoing</b>	
	(3) BRIEF DESCRIPTION (Brief scope, size, cost, etc.) AND SPECIFIC ROLE <p>Serves as analyst for Kimley-Horn's general civil engineering, traffic engineering, landscape architecture and park design consulting services to the City of Miramar on an ongoing basis. Areas of assistance include review of traffic impact analyses and parking studies specific to development applications, park design services for the Police Benevolent Association Civic Center Park Expansion, reclaimed water line design, water main design, and site civil engineering. Additional services include involvement as a member of the City of Miramar's land development staff to provide traffic and transportation input to the Planning and Zoning Board and the City Commission for traffic operation issues and proposed development site plans.</p>		

# E. RESUMES OF KEY PERSONNEL PROPOSED FOR THIS CONTRACT

(Complete one Section E for each key person.)

12. NAME <b>Britt L. Stephens, P.E.</b>	13. ROLE IN THIS CONTRACT <b>Project Engineer</b>	14. YEARS EXPERIENCE	
		a. TOTAL <b>11</b>	b. WITH CURRENT FIRM <b>11</b>
15. FIRM NAME AND LOCATION (City and State) <b>Kimley-Horn and Associates, Inc., Vero Beach</b>			
16. EDUCATION (DEGREE AND SPECIALIZATION) <b>Bachelor of Science / Civil Engineering / U.S. Air Force Academy</b>		17. CURRENT PROFESSIONAL REGISTRATION (STATE AND DISCIPLINE) <b>FL / Professional Engineer / 71465</b>	
18. OTHER PROFESSIONAL QUALIFICATIONS (Publications, Organizations, Training, Awards, etc.)			

## 19. RELEVANT PROJECTS

	(1) TITLE AND LOCATION (City and State)	(2) YEAR COMPLETED	
		PROFESSIONAL SERVICES	CONSTRUCTION (If Applicable)
a.	<b>Naples Municipal Airport Pavement Analysis and Rehabilitation, Naples</b>	<b>2010</b>	<b>2010</b>
	(3) BRIEF DESCRIPTION (Brief scope, size, cost, etc.) AND SPECIFIC ROLE <b>[X]</b> Check if project performed with current firm Project engineer. Provided drainage design and ICPR stormwater modeling for roughly 480 acres of the 740 acre airport facility to accommodate runway extensions (displaced thresholds) on Runway 5-23. Provided drainage design, ICPR modeling for 480 acres of the airport drainage system and StormCAD hydraulic modeling for the new pipes and structures to serve the runway extensions. Responsible for the environmental resource permitting for the project with South Florida Water Management District.		
b.	<b>Naples Airport Runway 5-23 Displaced Thresholds, Naples FL</b>	<b>2010</b>	<b>2010</b>
	(3) BRIEF DESCRIPTION (Brief scope, size, cost, etc.) AND SPECIFIC ROLE <b>[X]</b> Check if project performed with current firm Served as project engineer. Kimley-Horn provided design and construction-phase services for the Naples Municipal Airport Runway 5-23 Threshold Improvements project. This project included improving the existing 290-foot threshold displacement on the Runway 5 end by 510 feet and creating an 800-foot displaced threshold on the Runway 23 end of the runway. Additional work included 50-foot-wide extensions of Taxiway A and Taxilane D to provide access to the improved displaced thresholds. Specific elements associated with threshold improvements project included: clearing, grubbing, and earthwork; new bituminous asphalt pavement construction; runway grooving; pavement markings; drainage improvements including the creation of new on-site stormwater areas and the installation of culverts; erosion control; and installation of runway lighting and signage for the displaced thresholds and taxiways.		
c.	<b>Palm Beach Gardens Medical Center ERP, Palm Beach Gardens</b>	<b>2009</b>	<b>2010</b>
	(3) BRIEF DESCRIPTION (Brief scope, size, cost, etc.) AND SPECIFIC ROLE <b>[X]</b> Check if project performed with current firm Served as project manager providing analysis and design services. The project included an Emergency Room expansion and minor parking area reconfiguration. Kimley-Horn was retained to assist the hospital in obtaining an Environmental Resource Permit modification (ERP) through South Florida Water Management District and preparing construction documents and construction observation for the drainage improvements required in the ERP. Kimley-Horn was responsible for analyzing the existing drainage system for compliance with the permitted conditions and then designing stormwater system improvements to accommodate the hospital expansion and remedy the existing stormwater system deficiencies.		
d.	<b>City of Kissimmee Regional Stormwater Management Facility (RSMF) Stormwater Mitigation Bank Siting Analysis, Kissimmee</b>	<b>2014</b>	
	(3) BRIEF DESCRIPTION (Brief scope, size, cost, etc.) AND SPECIFIC ROLE <b>[X]</b> Check if project performed with current firm Project engineer on Kimley-Horn team providing drainage analysis and design for the City of Kissimmee for the purpose of creating a regional stormwater management facility and stormwater mitigation bank. Scope of services includes drainage analysis, drainage design, economic cost/benefit sighting analysis, and environmental resource permitting with South Florida Water Management District.		
e.	<b>Aviation Boulevard Improvements (43rd Avenue to US 1), Vero Beach</b>	<b>2014</b>	<b>2014</b>
	(3) BRIEF DESCRIPTION (Brief scope, size, cost, etc.) AND SPECIFIC ROLE <b>[X]</b> Check if project performed with current firm Project engineer for this 3.1-mile streetscape and roadway improvements project. Our services included topographic survey, right-of-way mapping, roadway design, signal design, public involvement, and stormwater design. This project required extensive permitting with FEC railroad, SJRWMD, IRFWCD, ACOA, FAA, IRCO, the City, and property owners along the corridor.		

# **E. RESUMES OF KEY PERSONNEL PROPOSED FOR THIS CONTRACT**

*(Complete one Section E for each key person.)*

12. NAME <b>Jonathan A. Martin, P.E.</b>		13. ROLE IN THIS CONTRACT <b>Project Engineer</b>		14. YEARS EXPERIENCE	
				a. TOTAL <b>22</b>	b. WITH CURRENT FIRM <b>17</b>
15. FIRM NAME AND LOCATION <i>(City and State)</i> <b>Kimley-Horn and Associates, Inc., Orlando</b>					
16. EDUCATION <i>(DEGREE AND SPECIALIZATION)</i> <b>Bachelor of Science / Civil Engineering / Univ. of Central Florida</b>			17. CURRENT PROFESSIONAL REGISTRATION <i>(STATE AND DISCIPLINE)</i> <b>FL / Professional Engineer / 54055</b>		
18. OTHER PROFESSIONAL QUALIFICATIONS <i>(Publications, Organizations, Training, Awards, etc.)</i>					

## **19. RELEVANT PROJECTS**

(1) TITLE AND LOCATION <i>(City and State)</i>		(2) YEAR COMPLETED	
		PROFESSIONAL SERVICES	CONSTRUCTION <i>(If Applicable)</i>
a.	<b>GOAA Comprehensive Conceptual Stormwater Permit/Environmental Resource Permit Update, Orlando</b>  (3) BRIEF DESCRIPTION <i>(Brief scope, size, cost, etc.)</i> AND SPECIFIC ROLE Project manager. Kimley-Horn is tasked with designing modifications to the Orlando International Airport conceptual permit for the changes proposed to its master stormwater management system. The intent of change is an update the existing master conceptual permit for OIA with existing permitted conditions and future buildout conditions in each sub-basin. Water quality treatment will be provided in 488 acres of storm water management areas. Consistent with the previous conceptual approval, individual tracts will provide one half inch of dry pretreatment prior to connecting to the OIA master system help ensure that hazardous materials do not enter the storm water management system.	Ongoing	
b.	<b>Orlando International Airport (OIA) Continuing Civil Engineering Services, Orlando</b>  (3) BRIEF DESCRIPTION <i>(Brief scope, size, cost, etc.)</i> AND SPECIFIC ROLE Stormwater engineer for the Kimley-Horn team serving the Greater Orlando Aviation Authority (GOAA) since 1992 on a variety of contracts. Projects have ranged from FEMA floodplain analysis and master stormwater conceptual permitting, automated people mover planning and design, airfield pavement improvements, remote baggage screening facility, runway joint rehabilitation, master drainage analysis of the entire airport; stormwater; sanitary sewer and lift station improvements; and AOA security fence upgrades.	Ongoing	
c.	<b>Orlando International Airport, South Airport Terminal Complex Phase I, Orlando</b>  (3) BRIEF DESCRIPTION <i>(Brief scope, size, cost, etc.)</i> AND SPECIFIC ROLE Stormwater engineer. The Kimley-Horn team was selected as airfield design engineer, as well as a subconsultant on the landside portion of the same effort. The first stage of Phase I of the South Terminal Complex consists of 16 gates. We are currently providing engineering design and coordination of utility, fueling, roadway, and drainage projects, in addition to a mass grading plan for the apron and taxiways, paving, and electrical design.	Ongoing	
d.	<b>Daytona Beach International Airport (DAB) Tree Mitigation Project, Daytona Beach</b>  (3) BRIEF DESCRIPTION <i>(Brief scope, size, cost, etc.)</i> AND SPECIFIC ROLE Stormwater engineer. Kimley-Horn assisted DBIA in implementing the recommendation in their Wildlife Hazard Management Plan to remove the trees and wetland areas on parcels immediately adjacent Runway 16/34. This included wetland delineation, permitting and mitigation coordination; gopher tortoise survey, permitting and relocation; evaluation of the existing closed landfill and preparation of a plan to avoid disturbance to the landfill; preparation of clearing and grading plans, stormwater modeling and design, access and safety plans; preparation of the Construction Safety and Phasing Plan per FAA AC 150/5370-2F; permitting; assistance with the bidding the project and preparation of the documented Categorical Exclusion for submittal to FAA.	2015	2015
e.	<b>Mills Park - Retail South Block Design, Orlando</b>  (3) BRIEF DESCRIPTION <i>(Brief scope, size, cost, etc.)</i> AND SPECIFIC ROLE Project manager for the Kimley-Horn team that provided civil engineering services for the design of the Mills Park (South Block Retail) site in Orlando. The project is a 65,000-square-foot multi-use development located on 14.2± acres at the northwest corner of US 17/92 and Virginia Avenue. Our services consisted of preparation of a master stormwater plan; permitting through the St. Johns River Water Management District (environmental resource permit); utility engineering; final engineering plans preparation; retail permitting through the City of Orlando (plan review), Florida Department of Environmental Protection (sanitary sewer collection/transmission, water distribution, NPDES), and Florida Department of Transportation (drainage, driveway, utility); and construction administration.	2016	2016

# **E. RESUMES OF KEY PERSONNEL PROPOSED FOR THIS CONTRACT**

*(Complete one Section E for each key person.)*

12. NAME <b>Brian S. Ashby, Jr., P.E.</b>	13. ROLE IN THIS CONTRACT <b>Project Engineer</b>	14. YEARS EXPERIENCE	
		a. TOTAL <b>6</b>	b. WITH CURRENT FIRM <b>6</b>
15. FIRM NAME AND LOCATION <i>(City and State)</i> <b>Kimley-Horn and Associates, Inc., Orlando</b>			
16. EDUCATION <i>(DEGREE AND SPECIALIZATION)</i> <b>Bachelor of Science / Civil Engineering / Florida State University</b>		17. CURRENT PROFESSIONAL REGISTRATION <i>(STATE AND DISCIPLINE)</i> <b>FL / Professional Engineer / 80456</b>	
18. OTHER PROFESSIONAL QUALIFICATIONS <i>(Publications, Organizations, Training, Awards, etc.)</i>			

## **19. RELEVANT PROJECTS**

	(1) TITLE AND LOCATION <i>(City and State)</i>	(2) YEAR COMPLETED	
		PROFESSIONAL SERVICES	CONSTRUCTION <i>(If Applicable)</i>
a.	<b>GOAA Comprehensive Conceptual Stormwater Permit/Environmental Resource Permit Update, Orlando</b>	Ongoing	
	(3) BRIEF DESCRIPTION <i>(Brief scope, size, cost, etc.)</i> AND SPECIFIC ROLE Project engineer. Kimley-Horn is tasked with designing modifications to the Orlando International Airport conceptual permit for the changes proposed to its master stormwater management system. The intent of change is an update the existing master conceptual permit for OIA with existing permitted conditions and future buildout conditions in each sub-basin. Water quality treatment will be provided in 488 acres of storm water management areas. Consistent with the previous conceptual approval, individual tracts will provide one half inch of dry pretreatment prior to connecting to the OIA master system help ensure that hazardous materials do not enter the storm water management system.		
b.	<b>Orlando International Airport, BP-433: Runway 17L/35R Joint Repairs, Orlando</b>	2012	2013
	(3) BRIEF DESCRIPTION <i>(Brief scope, size, cost, etc.)</i> AND SPECIFIC ROLE Project engineer for the Kimley-Horn team that provided pavement distress survey and rehabilitation design for the rehabilitation of all joints (from preformed to silicone) on the 9,000-foot-long Runway 17L-35R. The repairs consisted of re-sealing concrete pavement joints, removing and replacing full-strength runway concrete pavement, and airfield lights as necessary. Kimley-Horn also worked with GOAA Airfield Operations staff to replace pavement markings on OIA's 17R complex.		
c.	<b>Mills Park - Retail South Block Design Orlando</b>	2016	2016
	(3) BRIEF DESCRIPTION <i>(Brief scope, size, cost, etc.)</i> AND SPECIFIC ROLE Project engineer for the Kimley-Horn team that provided civil engineering services for the design of the Mills Park (South Block Retail) site in Orlando. The project is a 65,000-square-foot multi-use development located on 14.2± acres at the northwest corner of US 17/92 and Virginia Avenue. Our services consisted of preparation of a master stormwater plan; permitting through the St. Johns River Water Management District (environmental resource permit); utility engineering; final engineering plans preparation; retail permitting through the City of Orlando (plan review), Florida Department of Environmental Protection (sanitary sewer collection/transmission, water distribution, NPDES), and Florida Department of Transportation (drainage, driveway, utility); and construction administration.		
d.	<b>St. Petersburg-Clearwater International Airport Runway 4-22 Rehabilitation, Clearwater</b>	2012	2013
	(3) BRIEF DESCRIPTION <i>(Brief scope, size, cost, etc.)</i> AND SPECIFIC ROLE Served as project engineer. This project involved the design of the rehabilitation of Runway 4-22, including paving, drainage, and electrical systems. As part of the project, Kimley-Horn prepared a cost-benefit analysis to determine final runway width and length, as well as correct off-site drainage issues affecting the outfall for the runway drainage system.		
e.	<b>Orlando International Airport, BP-430: Runway 18L/36R Joint Rehabilitation, Orlando</b>	2011	2011
	(3) BRIEF DESCRIPTION <i>(Brief scope, size, cost, etc.)</i> AND SPECIFIC ROLE Project engineer for the Kimley-Horn team that provided engineering services for joint and slab repair within the 200-foot-wide by 12,005-foot-long boundaries of Runway 18L-36R and associated shoulder pavement at Orlando International Airport. Responsibilities included assistance in the production of a pavement repair plan.		

STANDARD FORM 330 (REV. 3/2013) PAGE 2

# **E. RESUMES OF KEY PERSONNEL PROPOSED FOR THIS CONTRACT**

(Complete one Section E for each key person.)

12. NAME <b>Brady J. Walker</b>	13. ROLE IN THIS CONTRACT <b>Environmental Scientist</b>	14. YEARS EXPERIENCE <table border="1"> <tr> <td>a. TOTAL 12</td> <td>b. WITH CURRENT FIRM 11</td> </tr> </table>		a. TOTAL 12	b. WITH CURRENT FIRM 11
a. TOTAL 12	b. WITH CURRENT FIRM 11				
15. FIRM NAME AND LOCATION (City and State) <b>Kimley-Horn and Associates, Inc., Boca-Delray</b>					
16. EDUCATION (DEGREE AND SPECIALIZATION) <b>Bachelor of Science / Biology / Denison University</b>		17. CURRENT PROFESSIONAL REGISTRATION (STATE AND DISCIPLINE)			
18. OTHER PROFESSIONAL QUALIFICATIONS (Publications, Organizations, Training, Awards, etc.)					

## **19. RELEVANT PROJECTS**

(1) TITLE AND LOCATION (City and State)	(2) YEAR COMPLETED	
<b>Pompano Beach Airpark Environmental Assessment for the Extension of Runway 15/33, Pompano Beach</b>	PROFESSIONAL SERVICES 2010	CONSTRUCTION (If Applicable)
a. (3) BRIEF DESCRIPTION (Brief scope, size, cost, etc.) AND SPECIFIC ROLE Served as environmental analyst and assisted with the permitting and successful relocation of 21 gopher tortoises as part of a runway expansion project. Also conducted surveys for burrowing owls throughout the airport and permitted and conducted the "take" of several burrowing owl nests in conjunction with runway expansion projects. Set up starter burrows and T-perches for the owls to relocate to. Other issues that had to be addressed with this project included an evaluation of other alternatives, preparation of a runway length analysis to support the Purpose and Need, Section 4(f) evaluations, and air quality analysis. The FAA approved a Finding of No Significant Impact (FONSI) in October 2010.	<input checked="" type="checkbox"/> Check if project performed with current firm	
<b>Southwest Florida International Airport, Mitigation Park Fort Myers</b>	PROFESSIONAL SERVICES 2012	CONSTRUCTION (If Applicable) 2014
b. (3) BRIEF DESCRIPTION (Brief scope, size, cost, etc.) AND SPECIFIC ROLE Ecologist. Kimley-Horn assisted Lee County Port Authority (LCPA) in mapping and assessing the 7,000-acre mitigation park that was created to compensate for impacts with the development of a new terminal. GIS mapping and ground truthing were conducted to identify and map the exotic and nuisance species to determine if the mitigation park was in compliance with the existing state and federal permits, to assess the site conditions, and to make recommendations regarding future maintenance. Kimley-Horn prepared a detailed mitigation assessment report and provided short- and long-term maintenance recommendations for consideration by LCPA. Following completion of the assessments, Kimley-Horn prepared technical specifications package for bidding. Kimley-Horn also provided construction phase services for the first phase of treatment.	<input checked="" type="checkbox"/> Check if project performed with current firm	
<b>Paris Air Hangar Facilities at Vero Beach Municipal Airport Vero Beach</b>	PROFESSIONAL SERVICES 2006	CONSTRUCTION (If Applicable)
c. (3) BRIEF DESCRIPTION (Brief scope, size, cost, etc.) AND SPECIFIC ROLE Served as environmental analyst. Kimley-Horn designed three hangars for Paris Air airplane storage at the Vero Beach Municipal Airport. Our services included site planning, design, engineering, civil permitting, and agency coordination (City of Vero Beach Utility Department, City of Vero Beach Airport, and the FAA). Paris Air currently has under lease approximately 7.4 acres along the west end of the main runway at the Vero Beach Airport. The property was previously undeveloped and contained a small wetland area that had to be permitted for impact through the St. Johns River Water Management District (SJRWMD). The project was permitted through the City of Vero Beach, St. Johns River Water Management District, and the Florida Department of Environmental Protection.	<input checked="" type="checkbox"/> Check if project performed with current firm	
<b>Florida's Turnpike Mainline Widening PD&amp;E Study and Design, Boynton Beach to Lake Worth, Florida's Turnpike Enterprise</b>	PROFESSIONAL SERVICES 2006	CONSTRUCTION (If Applicable) 2006
d. (3) BRIEF DESCRIPTION (Brief scope, size, cost, etc.) AND SPECIFIC ROLE Environmental scientist for the preparation of an environmental resource permit and Section 404 dredge and fill permit for the proposed widening of this segment of Florida's Turnpike and a new interchange at Lake Worth Road. Services included wetland delineation, mitigation coordination, listed species evaluations, USACE Rapanos data preparation, and coordination with the South Florida Water Management District and the U.S. Army Corps of Engineers. Aided in the preparation of the environmental assessment and contamination reports.	<input checked="" type="checkbox"/> Check if project performed with current firm	
<b>Lloyd Estates Streetscape and Drainage Improvements, Oakland Park</b>	PROFESSIONAL SERVICES 2012	CONSTRUCTION (If Applicable) 2013
e. (3) BRIEF DESCRIPTION (Brief scope, size, cost, etc.) AND SPECIFIC ROLE Analyst for the Kimley-Horn team that provided professional engineering services for the design and construction of the Lloyd Estates Residential and Industrial Area Drainage Project. The project involves phased drainage and water distribution system improvements consisting of the construction of a stormwater collection system with water quality treatment measures and possible upgraded outfalls, as well as replacement of select existing water mains within the project area. The professional services include surveying, stormwater analysis, civil and electrical engineering design, landscaping and irrigation, permitting, coordinating with utility providers for adjustments and or relocations, preparing quantity calculations, and engineer's estimates of probable costs.	<input checked="" type="checkbox"/> Check if project performed with current firm	



# E. RESUMES OF KEY PERSONNEL PROPOSED FOR THIS CONTRACT

(Complete one Section E for each key person.)

12. NAME <b>Meredith Aiken, CWD</b>	13. ROLE IN THIS CONTRACT <b>Environmental Scientist</b>	14. YEARS EXPERIENCE <table border="1"> <tr> <td>a. TOTAL 6</td> <td>b. WITH CURRENT FIRM 1</td> </tr> </table>		a. TOTAL 6	b. WITH CURRENT FIRM 1
a. TOTAL 6	b. WITH CURRENT FIRM 1				
15. FIRM NAME AND LOCATION (City and State) <b>Kimley-Horn and Associates, Inc., Boca-Delray</b>					
16. EDUCATION (DEGREE AND SPECIALIZATION) <b>Master of Science / Wildlife Ecology / Texas State University</b>		17. CURRENT PROFESSIONAL REGISTRATION (STATE AND DISCIPLINE) <b>United States / Certified Wetland Delineator</b>			
18. OTHER PROFESSIONAL QUALIFICATIONS (Publications, Organizations, Training, Awards, etc.)					

## 19. RELEVANT PROJECTS

(1) TITLE AND LOCATION (City and State) <b>Miami Beach Light Rail/Modern Streetcar, Miami-Dade County</b>	(2) YEAR COMPLETED	
	PROFESSIONAL SERVICES Ongoing	CONSTRUCTION (If Applicable)
a. (3) BRIEF DESCRIPTION (Brief scope, size, cost, etc.) AND SPECIFIC ROLE Environmental analyst responsible for the initial field reviews to evaluate the natural resources along the corridor. Conducted field evaluations of the wetlands and surface waters, as well as field reviews to identify potential listed species along the corridor. Kimley-Horn is responsible for the design of the new Light Rail in Miami Beach and environmental (socio-cultural, wetland and endangered species) evaluations.	<input checked="" type="checkbox"/> Check if project performed with current firm	
(1) TITLE AND LOCATION (City and State) <b>City of Coconut Creek Continuing Engineering and Environmental Services, Coconut Creek</b>	(2) YEAR COMPLETED	
	PROFESSIONAL SERVICES 2016	CONSTRUCTION (If Applicable)
b. (3) BRIEF DESCRIPTION (Brief scope, size, cost, etc.) AND SPECIFIC ROLE Served as lead environmental analyst. Kimley-Horn has been serving the City of Coconut Creek on various projects for more than 10 years. Performed field reconnaissance, created GIS figures, and assisted in the preparation of the Phase I Environmental Site Assessments (ESAs).	<input checked="" type="checkbox"/> Check if project performed with current firm	
(1) TITLE AND LOCATION (City and State) <b>Midway Road (CR 712) from Glades Cutoff Road (CR 709) to Selvitz Road (CR 615) PD&amp;E Study, St. Lucie</b>	(2) YEAR COMPLETED	
	PROFESSIONAL SERVICES Ongoing	CONSTRUCTION (If Applicable)
c. (3) BRIEF DESCRIPTION (Brief scope, size, cost, etc.) AND SPECIFIC ROLE Serving as environmental analyst assisting with endangered species surveys for Kimley-Horn's services as a major subconsultant on this 1.6-mile segment of Midway Road. The project includes evaluating the widening of Midway Road from 2 to 4 lanes as well as a concept study for a new interchange with the Florida's Turnpike. Kimley-Horn is responsible for all traffic analyses, structures evaluations, and environmental (socio-cultural, wetland and endangered species – including extensive Audubon's crested caracara surveys) evaluations. In addition, Kimley-Horn is responsible for preparing the interchange concept report and coordinating the results with Florida's Turnpike Enterprise.	<input checked="" type="checkbox"/> Check if project performed with current firm	
(1) TITLE AND LOCATION (City and State) <b>PD&amp;E Study for Florida's Turnpike Spur and the HEFT from NW 57th Avenue to Turnpike Mainline, Broward/Miami-Dade Counties</b>	(2) YEAR COMPLETED	
	PROFESSIONAL SERVICES Ongoing	CONSTRUCTION (If Applicable)
d. (3) BRIEF DESCRIPTION (Brief scope, size, cost, etc.) AND SPECIFIC ROLE Serving as environmental analyst for the Kimley-Horn team that is serving as a subconsultant to another firm to provide engineering services for a PD&E study for the widening of the Florida's Turnpike Spur and the HEFT from East of NW 57th Avenue to Mainline in Broward and Miami-Dade counties. Kimley-Horn's role is to provide environmental and public involvement support, as well as to assist with roadway design, structural elements, drainage (including preparation of a Location Hydraulics Technical Memorandum and a Pond Siting Report), permitting, and lighting.	<input checked="" type="checkbox"/> Check if project performed with current firm	
(1) TITLE AND LOCATION (City and State) <b>Community Development Block Grant (CDBG) Water Main Extension, City of Dunnellon</b>	(2) YEAR COMPLETED	
	PROFESSIONAL SERVICES 2016	CONSTRUCTION (If Applicable)
e. (3) BRIEF DESCRIPTION (Brief scope, size, cost, etc.) AND SPECIFIC ROLE Served as environmental analyst for endangered species surveys and relocation. Assisted with gopher tortoise excavation and relocation along the proposed alignment. Kimley-Horn provided design, permitting, grant assistance, and construction stage services for an extension of a water main. The project included coordination with Marion County Utilities to interconnect the City and County water systems. Kimley-Horn also provided interlocal agreement coordination services, along with CDBG coordination services.	<input checked="" type="checkbox"/> Check if project performed with current firm	

# **E. RESUMES OF KEY PERSONNEL PROPOSED FOR THIS CONTRACT**

(Complete one Section E for each key person.)

<b>12. NAME</b> <b>Barton J. Fye, P.E., CFM</b>	<b>13. ROLE IN THIS CONTRACT</b> <b>Project Engineer</b>	<b>14. YEARS EXPERIENCE</b> <table border="1"> <tr> <td>a. TOTAL</td> <td>b. WITH CURRENT FIRM</td> </tr> <tr> <td>10</td> <td>2</td> </tr> </table>		a. TOTAL	b. WITH CURRENT FIRM	10	2
a. TOTAL	b. WITH CURRENT FIRM						
10	2						
<b>15. FIRM NAME AND LOCATION (City and State)</b> <b>Kimley-Horn and Associates, Inc., Miami</b>							
<b>16. EDUCATION (DEGREE AND SPECIALIZATION)</b> <b>Bachelor of Science / Civil Engineering / University of Miami</b>		<b>17. CURRENT PROFESSIONAL REGISTRATION (STATE AND DISCIPLINE)</b> <b>FL / Professional Engineer / 73898</b>					
<b>18. OTHER PROFESSIONAL QUALIFICATIONS (Publications, Organizations, Training, Awards, etc.)</b>							

## **19. RELEVANT PROJECTS**

(1) TITLE AND LOCATION (City and State)	(2) YEAR COMPLETED	
	PROFESSIONAL SERVICES	CONSTRUCTION (If Applicable)
<b>a. (1) TITLE AND LOCATION (City and State)</b> <b>Town of Medley Flood Mitigation Area, South, Medley</b>  <b>(3) BRIEF DESCRIPTION (Brief scope, size, cost, etc.) AND SPECIFIC ROLE</b> Project manager for roadway and drainage improvements for over 4,000 linear feet of roadway within the Flood Mitigation Area in the Town of Medley. The Town seeks to alleviate frequent flooding within the basin known as the Flood Mitigation Area as well as upgrade the existing roadway, which has deteriorated in part due to the absence of adequate stormwater management facilities. As one of the largest public infrastructure undertakings in the Town's history, this project is expected to alleviate flooding in the area and increase roadway capacity in the area. The combination of improvements in conjunction with ongoing private land development in the area is revitalizing the industrial Town of Medley.	<b>(2) YEAR COMPLETED</b> PROFESSIONAL SERVICES Ongoing	<b>(2) YEAR COMPLETED</b> CONSTRUCTION (If Applicable) 
<b>b. (1) TITLE AND LOCATION (City and State)</b> <b>North District Wastewater Treatment Plant (NDWWTP) Stormwater Basis of Design Report (BODR), Miami-Dade County</b>  <b>(3) BRIEF DESCRIPTION (Brief scope, size, cost, etc.) AND SPECIFIC ROLE</b> Project engineer for the preparation of a BODR that will guide the design of the stormwater management system upgrades at the NDWWTP. The NDWWTP, owned by the Miami-Dade County Water and Sewer Department, sits on an 84 acre site, of which over 50 acres have been developed for treatment facilities. The previous stormwater management system is disjointed and did not sufficiently protect the facilities from stormwater and flood. The BODR studies the impacts of these deficiencies and recommends solutions that are cost-effective and provide real value over the life of the project. In addition, the long life of the intended system, critical nature of the facilities it impacts, and the highly-developed nature of the site the study must also account for the expected effects of sea level rise on the ultimate solution.	<b>(2) YEAR COMPLETED</b> PROFESSIONAL SERVICES 2016	<b>(2) YEAR COMPLETED</b> CONSTRUCTION (If Applicable) 
<b>c. (1) TITLE AND LOCATION (City and State)</b> <b>Miami-Dade County South Dade Landfill (SDLF) Cell 3 and Cell 5, Miami</b>  <b>(3) BRIEF DESCRIPTION (Brief scope, size, cost, etc.) AND SPECIFIC ROLE</b> Project engineer. The Cell 3 closure construction project consisted of the installation of a final cover system that contained both geosynthetic materials and soil layers on both the top and side slopes of this 40-acre area. The SDL Cell 5 project involves a new 50-acre cell for the disposal of solid waste collected by the Miami-Dade County Department of Solid Waste Management, the largest government-owned solid waste authority in the southeastern United States.	<b>(2) YEAR COMPLETED</b> PROFESSIONAL SERVICES Ongoing	<b>(2) YEAR COMPLETED</b> CONSTRUCTION (If Applicable) 
<b>d. (1) TITLE AND LOCATION (City and State)</b> <b>NW 121st Way Water Distribution Loop, Medley</b>  <b>(3) BRIEF DESCRIPTION (Brief scope, size, cost, etc.) AND SPECIFIC ROLE</b> Project engineer during the design, bid, and construction phase services for a 16-inch ductile iron pipe water main serving a developed portion of the Town of Medley. The water main is designed to loop two existing dead-end water mains in the industrial area, provide system redundancy, and increase system capacity.	<b>(2) YEAR COMPLETED</b> PROFESSIONAL SERVICES 2015	<b>(2) YEAR COMPLETED</b> CONSTRUCTION (If Applicable) 2015
<b>e. (1) TITLE AND LOCATION (City and State)</b> <b>Virginia Key Landfill Closure, Miami</b>  <b>(3) BRIEF DESCRIPTION (Brief scope, size, cost, etc.) AND SPECIFIC ROLE</b> Project engineer for the grading and drainage portion of the closure of this 124-acre parcel on an island in the environmentally sensitive waters of Biscayne Bay. The Miami-Dade County Board of County Commissioners approved funding for the enhanced closure of the landfill in 2004, which included the preparation of a site assessment report to evaluate the extent of known onsite contamination. Due to the presence of contamination, DERM required a remedial action plan which will be coordinated with future plans for developing the site being considered by the City of Miami including, but not limited to park space and recreational activities. Kimley-Horn's scope of work included a basis of design report to address the DERM's requirements for an enhanced landfill closure. We also prepared a 30% closure design, an estimate of probable construction cost, and participated in a formal value engineering workshop.	<b>(2) YEAR COMPLETED</b> PROFESSIONAL SERVICES Ongoing	<b>(2) YEAR COMPLETED</b> CONSTRUCTION (If Applicable) 

CAM 17-0337

# E. RESUMES OF KEY PERSONNEL PROPOSED FOR THIS CONTRACT

(Complete one Section E for each key person.)

12. NAME Scott Brady, P.E.	13. ROLE IN THIS CONTRACT QA/QC	14. YEARS EXPERIENCE	
		a. TOTAL 37	b. WITH CURRENT FIRM 3

15. FIRM NAME AND LOCATION (City and State)



EG Solutions

**EG Solutions, Lakewood Ranch, FL**

16. EDUCATION (DEGREE AND SPECIALIZATION) <b>B.S. / Civil Engineering</b> <b>M.S. / Civil Engineering</b>	17. CURRENT PROFESSIONAL REGISTRATION (STATE AND DISCIPLINE) <b>FL, GA, TN / Professional Engineer</b> <b>Commercial Pilot, single engine, instrument rated</b>
18. OTHER PROFESSIONAL QUALIFICATIONS (Publications, Organizations, Training, Awards, etc.)	

## 19. RELEVANT PROJECTS

(1) TITLE AND LOCATION (City and State)	(2) YEAR COMPLETED	
	PROFESSIONAL SERVICES	CONSTRUCTION (If Applicable)
<b>Florida Department of Transportation, Statewide Airport Stormwater Study, Tallahassee, FL.</b> (3) BRIEF DESCRIPTION (Brief scope, size, cost, etc.) AND SPECIFIC ROLE Project Manager or Technical Manager – phase dependent. The FDOT Statewide Airport Stormwater Study is intended to limit water management features that are more attractive to wildlife, while meeting all state and federal rules for water quality and quantity management. Project Manager for the initial study that included program design; data collection (including stormwater runoff quality and quantity data from the airside of 13 Florida airports); a Technical Report and an initial Best Management Practices Manual for Florida Airports which makes recommendations based on data collected and analyzed for the study, and guidance from the Florida Department of Environmental Protection and Water Management Districts for stormwater systems. Technical Manager for studies illustrating the application of the data; rewrites of the BMP Manual to incorporate model and practice experience; physical and computer models for "FAA/USDA Ponds;" legislation and rulemaking assistance; and post-construction monitoring for the pond modifications at Naples Municipal Airport. The project resulted in legislation and a general permit for airport airside stormwater management FAC 62-341.449. Estimated Final Project cost: \$7,000,000	<b>Ongoing</b> <input checked="" type="checkbox"/> Check if project performed with current firm	<b>2014</b>
<b>Naples Municipal Airport, Taxiway A and Water Management System Improvement Planning, Design and Construction, Naples, FL</b> (3) BRIEF DESCRIPTION (Brief scope, size, cost, etc.) AND SPECIFIC ROLE Program Manager. The project is an extension of Taxiway A to Runway 23 threshold and state-of-the-art water management system modifications and improvements. The project includes master drainage planning, pre-project water quality monitoring, pre-project wildlife monitoring, site specific Computational Fluid Dynamics modeling, system improvement design, permitting with the jurisdictional agencies, construction of crenellations/baffles in existing ponds, design and construction of automated monitoring systems for water quality and quantity, coordination with stakeholders including FAA, FDOT, the FDEP, and the 5 Water Management Districts (WMDs). Ancillary work will include aerial topographical surveys, creating a GIS for the project consistent with FAA guidelines and WMD, and public outreach. The final monitoring will be incorporated into the Florida Statewide Airport Stormwater Study, potentially changing rules for wet ponds on and near airports in the state. Estimated project cost: \$4,500,000.	<b>Ongoing</b> <input checked="" type="checkbox"/> Check if project performed with current firm	<b>2014</b>
<b>West Quad Pond Project, Naples Municipal Airport, Naples, FL.</b> (3) BRIEF DESCRIPTION (Brief scope, size, cost, etc.) AND SPECIFIC ROLE Engineer of Record. The project is the construction of a new water management pond of lesser footprint than existing water management components it replaces. The design objectives are reducing wildlife attractants, providing more efficient water quality management for airport stormwater, and providing features consistent with the Gordon River Greenway. Project involvement has included: surface and ground water computer simulations; wetland mitigation support; Environmental Resource Permit (ERP) assistance; construction dewatering permit assistance; erosion and sedimentation control plans; and construction phase services. \$1,300,000	<b>2015</b> <input checked="" type="checkbox"/> Check if project performed with current firm	<b>2015</b>
<b>Valkaria Airport, Taxiway B, Apron Rehabilitation and Airfield Stormwater Improvements, Valkaria, FL.</b> (3) BRIEF DESCRIPTION (Brief scope, size, cost, etc.) AND SPECIFIC ROLE Project Manager. The terminal apron was originally constructed over 60 years ago. It consisted of concrete with a nominal thickness of 7-inches that varied from 4 to 9-inches in a random pattern. With the reintroduction of air service to PGD, the imposed loads from A320 aircraft exceeded the structural strength of the apron. In order to accommodate a fast-track solution, a design/build approach was used for apron reconstruction. The project included demolition of the existing concrete, crushing waste concrete to provide high quality sub-base course, and placing new, 12-inch thick, fiber reinforced concrete. The reuse of waste concrete with appropriate testing to meet FAA standards was a cost-saving measure. Likewise the selection of fiber reinforcement over traditional wire mesh was a time saving measure. The project was designed and built in four months. Project cost: \$3,000,000.	<b>2013</b> <input checked="" type="checkbox"/> Check if project performed with current firm	<b>2013</b>

STANDARD FORM 330 (6/2004) PAGE 2

# E. RESUMES OF KEY PERSONNEL PROPOSED FOR THIS CONTRACT

(Complete one Section E for each key person.)

12. NAME Gloria Brady, P.E., CPSWQ	13. ROLE IN THIS CONTRACT QA/QC	14. YEARS EXPERIENCE	
		a. TOTAL 37	b. WITH CURRENT FIRM 3

15. FIRM NAME AND LOCATION (City and State)



**EG Solutions, Lakewood Ranch, FL**

16. EDUCATION (DEGREE AND SPECIALIZATION) <b>B.S. / Civil Engineering</b>	17. CURRENT PROFESSIONAL REGISTRATION (STATE AND DISCIPLINE) <b>FL, TN, GA, KY, VA / Professional Engineer  Certified Professional Storm Water Quality</b>
--	---

18. OTHER PROFESSIONAL QUALIFICATIONS (Publications, Organizations, Training, Awards, etc.)

## 19. RELEVANT PROJECTS

(1) TITLE AND LOCATION (City and State)	(2) YEAR COMPLETED	
<b>Sarasota Bradenton International Airport, General Environmental and Stormwater Management Consultant, Sarasota, FL.</b>	PROFESSIONAL SERVICES <b>Ongoing</b>	CONSTRUCTION (If Applicable)
(3) BRIEF DESCRIPTION (Brief scope, size, cost, etc.) AND SPECIFIC ROLE <b>a</b> Project Manager/Consultant. General consultant to airport on environmental, stormwater and permitting issues for projects including commercial development, hangars, aprons, taxiways and runways; reviews and advises on all modeling. Directs updating the master drainage plan and calculations to reflect the changes that have occurred since the date of the original permit as well as reviewing the surface and ground water permits of all airport development projects on behalf of the airport. Tasks include stormwater modeling, establishing criteria with regulatory agencies, reviewing design by other consultants for water management and permitting issues, hydrodynamic modeling of systems, advising airport on maintenance and similar. Project cost: \$349,690.	Check if project performed with current firm	
(1) TITLE AND LOCATION (City and State) <b>Pompano Beach Air Park, Master Drainage Plan Update, Pompano Beach, FL.</b>	PROFESSIONAL SERVICES <b>2011</b>	CONSTRUCTION (If Applicable) <b>2011</b>
(3) BRIEF DESCRIPTION (Brief scope, size, cost, etc.) AND SPECIFIC ROLE <b>b</b> Project Manager. The project included field reconnaissance, surveys and review of existing data, preparation of analyses, design reports, feasibility studies and/or design alternative recommendations, update of the SWMPPP, and meeting and presentations before stakeholder groups, as well as data collection and modeling efforts, with emphasis on SWMM models and water balance with MODFLOW models. It also included evaluating the effects of an existing well field along the western boundary of the airport providing drinking water to the City of Pompano Beach. The project was permitted with Broward County, as a delegated regulatory authority in South Florida Water Management District. Project Cost: \$210,000	Check if project performed with current firm	
(1) TITLE AND LOCATION (City and State) <b>Venice Municipal Airport, Master Drainage Plan, Venice, FL.</b>	PROFESSIONAL SERVICES <b>2009</b>	CONSTRUCTION (If Applicable) <b>2009</b>
(3) BRIEF DESCRIPTION (Brief scope, size, cost, etc.) AND SPECIFIC ROLE <b>c</b> Project Manager. The project consisted of inventory and data collection, National Pollutant Discharge Elimination System (NPDES) permits, Storm Water Pollution Prevention Plans (SWPPPs) and Southwest Florida Water Management District (SWFWMD) conceptual Environmental Resource Permit for airport and commerce park areas. The project used the results of the Florida Statewide airport Stormwater Study in an EPA SWMM, continuous simulation computer model to estimate loads. Overland flow and dry infiltration basins are the primary water quality management approach. This limits wildlife attractants. The same computer models were used for flood and water quantity management on an event basis. Project cost: \$179,178. 2009	Check if project performed with current firm	
(1) TITLE AND LOCATION (City and State) <b>Runway 14-32 Safety Area and Drainage Improvements, Naples Municipal Airport, Naples, FL.</b>	PROFESSIONAL SERVICES <b>2015</b>	CONSTRUCTION (If Applicable) <b>2015</b>
(3) BRIEF DESCRIPTION (Brief scope, size, cost, etc.) AND SPECIFIC ROLE <b>d</b> Lead Technical Engineer. The project consists of changing the conveyance system from open swale to enclosed culvert. This was done to comply with a Part 139 inspection finding that existing headwalls and open swales did not meet current Runway Safety Area criteria. Further the project was done to help alleviate flooding that periodically impacts upstream, fixed base operators. A full length enclosure of the swales was recommended and approved to reduce wildlife attractants adjacent to the runway, in lieu of a combination of swales existing culvert extensions. This design recommendation was consistent with FAA Advisory Circular 150/5320-5c and 150/5200-33b. Project cost: \$3,300,000.	Check if project performed with current firm	
(1) TITLE AND LOCATION (City and State) <b>Punta Gorda Airport, Master Drainage Plan, Punta Gorda, FL.</b>	PROFESSIONAL SERVICES <b>2007</b>	CONSTRUCTION (If Applicable) <b>2007</b>
(3) BRIEF DESCRIPTION (Brief scope, size, cost, etc.) AND SPECIFIC ROLE <b>e</b> Project Manager. The project consisted of an update and extension of the existing Master Drainage Plan for the Punta Gorda Airport and Commerce Park last updated in 1999. Included in the work was an Individual Environmental Resource Permit from the Southwest Florida Water Management District (SWFWMD). The water management plan included wetland areas and plans for their inclusion into the water management system or mitigation as needed. The plan incorporated future airside improvements; redesigned conveyance systems for outlying areas of the landside; and used a combination of water quality management strategies. The project also employed on-site floodplain loss mitigation and landside pre-treatment elements as part of the overall water management system. \$289,115.	Check if project performed with current firm	

STANDARD FORM 330 (6/2004) PAGE 2

12. Name	<b>Lee Powers, P.S.M.</b>				13. Role in this contract	<b>Project Surveyor/GIS Specialist</b>
14. Years Experience	Total	<b>10</b>	With Firm	<b>7</b>	15. Firm Name and Location	<b>Keith and Associates, Inc. 301 East Atlantic Boulevard Pompano Beach, FL 33060</b>
16. Education (Degree and Specialization) <b>BS LSGE, Purdue University, Indiana, 2005</b>					17. Current Professional Registration ( <i>State and Discipline</i> ) <b>Professional Surveyor &amp; Mapper, Florida # 6805</b>	
18. Other Professional Qualifications ( <i>Publications, Organizations, Training, Awards, etc.</i> ) <b>Florida Society of Professional Surveyors &amp; Mappers</b>						
19. Relevant Projects						
	Title and Location ( <i>City &amp; State</i> ) * Year Completed (Eng. / Const.) * Role * Brief Description ( <i>Scope, Size, Cost, etc.</i> )					Performed with current firm <input checked="" type="checkbox"/>
a.	<b>Broward County Water &amp; Wastewater Services (WWS) GPS/GIS Project</b> Professional Services – 2011 Construction Services – N/A Mr. Powers served as the Project Surveyor for this utility location project. Once completed, this project will include sub-meter GPS observations on approximately 17,000 utility locations. This data will be used to populate/update the WWS GIS database.					
	Title and Location ( <i>City &amp; State</i> ) * Year Completed (Eng. / Const.) * Role * Brief Description ( <i>Scope, Size, Cost, etc.</i> )					Performed with current firm <input checked="" type="checkbox"/>
b.	<b>MLK Jr. Boulevard Improvements, Pompano Beach, Florida</b> Professional Services – Ongoing Construction Services – Ongoing Roadway improvements along Martin Luther King Jr. Boulevard (a.k.a. Hammondville Road) between NW 31st Avenue (Turnpike Ramp) and Powerline Rd. (S.R. 845) in accordance with the Phase II “Educational Corridor” improvements. The roadway improvements include incorporating new sidewalks, dedicated bicycle lanes and roadside swales along both sides of the roadway, roadway milling and resurfacing (with some widening), miscellaneous safety improvements and some lane reconfigurations, new landscape medians and other landscape enhancements, decorative street lighting, utility coordination for relocations/adjustments, overall drainage and roadway improvements.					
	Title and Location ( <i>City &amp; State</i> ) * Year Completed (Eng. / Const.) * Role * Brief Description ( <i>Scope, Size, Cost, etc.</i> )					Performed with current firm <input checked="" type="checkbox"/>
c.	<b>The Wave Modern Streetcar, Fort Lauderdale, Florida</b> Professional Services – Ongoing Construction Services – N/A Keith and Associates was tasked with providing Surveying and Subsurface Utility Engineering (SUE) services for this modern streetcar in Downtown Fort Lauderdale between Northwest 6 <sup>th</sup> Street and Southeast 17 <sup>th</sup> Street. The system would operate 5 modern streetcars through 2.7 miles in mixed traffic along existing roadways and would utilize transit signal priority. Surveying services include project control, aerial targets, topography/DTM, aerial clearances, drainage and sanitary details, recovery of property and right-of-way monumentation, boundary surveys, and survey support for the geotechnical operations.					
	Title and Location ( <i>City &amp; State</i> ) * Year Completed (Eng. / Const.) * Role * Brief Description ( <i>Scope, Size, Cost, etc.</i> )					Performed with current firm <input checked="" type="checkbox"/>
d.	<b>Fort Lauderdale-Hollywood International Airport Terminals Modernization (1, 2 and 3) Fort Lauderdale, Florida</b> Professional Services –2015 Construction Services – N/A Keith and Associates, Inc. is currently serving as a Sub-Consultant to Gresham Smith and Partners for this Terminal Modernization project. Mr. Powers completed stakeout and as-builts for the repainting of the striping around Terminals 1, 2 &3.					
	Title and Location ( <i>City &amp; State</i> ) * Year Completed (Eng. / Const.) * Role * Brief Description ( <i>Scope, Size, Cost, etc.</i> )					Performed with current firm <input checked="" type="checkbox"/>
e.	<b>South Florida Water Management District – General Services Contract</b> Professional Services – Completed Construction Services – N/A Mr. Powers served as the Project Manager and Project Surveyor for this contract. Mr. Powers completed over 35 projects for the District ranging from Blue-Booked Vertical Control (both conventional level and GPS methods) surveys, to county-wide GPS control surveys and large boundary surveys.					



## E. RESUMES OF KEY PERSONNEL PROPOSED FOR THIS CONTRACT

(Complete one Section E for each key person.)

<b>12. NAME</b> <b>Raj Krishnasamy, P.E.</b>	<b>13. ROLE IN THIS CONTRACT</b> <b>Principal Geotechnical Engineer</b>	<b>14. YEARS EXPERIENCE</b> <table style="width: 100%; border: none;"> <tr> <td style="width: 50%; border: none;">a. TOTAL</td> <td style="width: 50%; border: none;">b. WITH CURRENT FIRM</td> </tr> <tr> <td style="text-align: center; border: none;"><b>29</b></td> <td style="text-align: center; border: none;"><b>15</b></td> </tr> </table>		a. TOTAL	b. WITH CURRENT FIRM	<b>29</b>	<b>15</b>
a. TOTAL	b. WITH CURRENT FIRM						
<b>29</b>	<b>15</b>						
<b>15. FIRM NAME AND LOCATION (City and State)</b> TIERRA SOUTH FLORIDA, INC., West Palm Beach, Florida							
<b>16. EDUCATION (DEGREE AND SPECIALIZATION)</b> BS Civil Engineering, Christian Brothers University, 1987 MS Civil Engineering, University of Memphis, 1996		<b>17. CURRENT PROFESSIONAL REGISTRATION (STATE AND DISCIPLINE)</b> Professional Engineer, Florida No. 53567					
<b>18. OTHER PROFESSIONAL QUALIFICATIONS (Publications, Organizations, Training, Awards, etc.)</b> American Society of Highway Engineers, Past President, Florida Engineering Society, Past Treasurer Geotechnical Material Engineering Council, Past Chairman							

### 19. RELEVANT PROJECTS

	(1) TITLE AND LOCATION (City and State)	(2) YEAR COMPLETED	
a.	Taxiway Echo Rehabilitation Project - Fort Lauderdale Executive Airport Broward County, Florida	PROFESSIONAL SERVICES 2013	CONSTRUCTION (If applicable)
	<b>(3) BRIEF DESCRIPTION (Brief scope, size, cost, etc.) AND SPECIFIC ROLE</b> <input checked="" type="checkbox"/> Check if project performed with current firm Mr. Krishnasamy was the principal in charge of the geotechnical exploration, pavement cores and laboratory testing for the rehabilitation which included reconstruction or milling and resurfacing of Taxiway Echo and connectors. Field study consisted of Standard Penetration Test (SPT) borings, Borehole Permeability (BHP) tests, field CBR tests - Kessler Method, and pavement cores. Performed limited laboratory testing on selected soil samples, including grain size analysis, organic content, and Modified proctor Tests. Also performed laboratory CBR tests (ASTM D1883). Provided subsurface information, soil profiles, and test results.		
b.	Taxiway Bravo Rehabilitation Project - Fort Lauderdale Executive Airport Broward County, Florida	PROFESSIONAL SERVICES 2008	CONSTRUCTION (If applicable)
	<b>(3) BRIEF DESCRIPTION (Brief scope, size, cost, etc.) AND SPECIFIC ROLE</b> <input checked="" type="checkbox"/> Check if project performed with current firm Mr. Krishnasamy was the principal in charge of the geotechnical study for the rehabilitation of Taxiway Bravo at Ft. Lauderdale Executive Airport (FXE) in Broward County, Florida. The project was approximately 2 miles long. The rehabilitation included widening of Taxiway Charlie, Mike and November and milling and resurfacing Taxiway Bravo. Performed Standard Penetration Test (SPT) borings along Taxiway Bravo and exit ramps as well as pavement cores. Provided geotechnical report summarize findings as well as geotechnical recommendations regarding excavations, ground water control and pavement design.		
c.	Taxiway Delta & Charlie Rehabilitation Project - Fort Lauderdale Executive Airport, Broward County, Florida	PROFESSIONAL SERVICES 2010	CONSTRUCTION (If applicable)
	<b>(3) BRIEF DESCRIPTION (Brief scope, size, cost, etc.) AND SPECIFIC ROLE</b> <input checked="" type="checkbox"/> Check if project performed with current firm Mr. Krishnasamy was the principal in charge of the geotechnical services for the milling and resurfacing of Taxiway Delta & Charlie. Performed Standard Penetration Test (SPT) borings and pavement cores. Provided a geotechnical services report discussing the subsurface conditions found, groundwater conditions at the site, and pavement core test results.		
d.	Western Expansion of Terminal 4 and Connector Bridge to Terminal 3, Fort Lauderdale-Hollywood International Airport, Broward County, Florida	PROFESSIONAL SERVICES 2011	CONSTRUCTION (If applicable)
	<b>(3) BRIEF DESCRIPTION (Brief scope, size, cost, etc.) AND SPECIFIC ROLE</b> <input checked="" type="checkbox"/> Check if project performed with current firm Mr. Krishnasamy was the principal in charge of the geotechnical engineering study for proposed Western Expansion of Terminal 4 and a connector bridge to Terminal 3. Field work consisted Standard Penetration Test (SPT) borings. Provided a geotechnical report summarizing subsurface conditions and groundwater information. TSF provided geotechnical recommendations regarding foundation design, including evaluating the use of Auger Cast-In-Place (ACIP) piles to support the proposed expansion. Provided ACIP pile design criteria and recommendations, site preparation recommendations, floor slab recommendations, and information regarding trench excavations.		
e.	Expansion of Runway 10R-28L, Fort Lauderdale – Hollywood International Airport, Broward County, Florida	PROFESSIONAL SERVICES 2013	CONSTRUCTION (If applicable)
	<b>(3) BRIEF DESCRIPTION (Brief scope, size, cost, etc.) AND SPECIFIC ROLE</b> <input checked="" type="checkbox"/> Check if project performed with current firm Mr. Krishnasamy was the principal in charge of the geotechnical study for the proposed expansion of Runway 9R-27L and associated US-1/FEC railroad structures, high fill embankment, and MSE walls. SPT soil borings and sampling are being performed for US-1/FEC Railroad structures, MSE walls and high embankments. Maximum MSE wall height is expected to be about 65 ft. which is significantly higher than the normal practice in Florida. Performed pile capacity analysis for bridge structures. Provided analysis and recommendations for MSE walls and embankment fill as well as other geotechnical engineering recommendations.		

## E. RESUMES OF KEY PERSONNEL PROPOSED FOR THIS CONTRACT

(Complete one Section E for each key person.)

<b>12. NAME</b> <b>Francois Thomas, P.E., S.I.</b>	<b>13. ROLE IN THIS CONTRACT</b> <b>Principal Materials Engineer / Threshold Inspector</b>	<b>14. YEARS EXPERIENCE</b> <table style="width: 100%; border: none;"> <tr> <td style="width: 50%; border: none;">a. TOTAL</td> <td style="width: 50%; border: none;">b. WITH CURRENT FIRM</td> </tr> <tr> <td style="border: none; text-align: center;"><b>23</b></td> <td style="border: none; text-align: center;"><b>8</b></td> </tr> </table>		a. TOTAL	b. WITH CURRENT FIRM	<b>23</b>	<b>8</b>
a. TOTAL	b. WITH CURRENT FIRM						
<b>23</b>	<b>8</b>						
<b>15. FIRM NAME AND LOCATION (City and State)</b> TIERRA SOUTH FLORIDA, INC., West Palm Beach, Florida							
<b>16. EDUCATION (DEGREE AND SPECIALIZATION)</b> MS in Geotechnical Engineering, 1993 BS in Civil Engineering, 1991		<b>17. CURRENT PROFESSIONAL REGISTRATION (STATE AND DISCIPLINE)</b> Professional Engineer, Florida No. 56381					
<b>18. OTHER PROFESSIONAL QUALIFICATIONS (Publications, Organizations, Training, Awards, etc.)</b> Special Inspector 7021399 Certified Masonry Inspector Radiation Safety Officer							

### 19. RELEVANT PROJECTS

	(1) TITLE AND LOCATION (City and State)	(2) YEAR COMPLETED	
	Taxiway Bravo Rehabilitation Project - Fort Lauderdale Executive Airport Broward County, Florida	PROFESSIONAL SERVICES 2012	CONSTRUCTION (If applicable) 2012
a.	(3) BRIEF DESCRIPTION (Brief scope, size, cost, etc.) AND SPECIFIC ROLE <input checked="" type="checkbox"/> Check if project performed with current firm Mr. Thomas was the principal in charge of the material testing and inspection services for the taxiway rehabilitation. Performed laboratory testing including LBRs, Proctors, and concrete breaks. Provided earthwork and concrete inspections during subgrade and base construction. During asphalt pavement rehabilitation (milling and resurfacing), provided field asphalt inspectors to observe placement of test strip, tack placement, and surface and leveling courses. TSF inspectors were also in charge of tracking all tonnage, waste quantities, tack and prime quantities, and based on those numbers the inspectors verified pay applications. Also provided all asphalt plant inspections prior to and during all asphalt field activities.		
	Taxiway Charlie West Settlement Study- Fort Lauderdale Executive Airport Broward County, Florida	PROFESSIONAL SERVICES 2011	CONSTRUCTION (If applicable)
b.	(3) BRIEF DESCRIPTION (Brief scope, size, cost, etc.) AND SPECIFIC ROLE <input checked="" type="checkbox"/> Check if project performed with current firm Mr. Thomas served as principal geotechnical engineer for the geotechnical engineering study to investigate the subsurface conditions at the project site, and provide site preparation recommendations for the pavement subgrade to minimize the rutting/settlement. Provided geotechnical engineering report discussing potential causes of rutting/settlement along with site preparation recommendations that the soil be densified and the pavement section reinforced to minimize the potential of rutting/settlement. Recommendations included utilizing geogrid as part of the site preparation.		
	Taxiway Echo Rehabilitation Project - Fort Lauderdale Executive Airport Broward County, Florida	PROFESSIONAL SERVICES 2013	CONSTRUCTION (If applicable)
c.	(3) BRIEF DESCRIPTION (Brief scope, size, cost, etc.) AND SPECIFIC ROLE <input checked="" type="checkbox"/> Check if project performed with current firm Mr. Thomas served as principal geotechnical engineer for the geotechnical exploration, pavement cores and laboratory testing for the rehabilitation which included reconstruction or milling and resurfacing of Taxiway Echo and connectors. Field study consisted of Standard Penetration Test (SPT) borings, BoreHole Permeability (BHP) tests, field CBR tests - Kessler Method, and 15 pavement cores. Performed limited laboratory testing on selected soil samples, including grain size analysis, organic content, and Modified proctor Tests. Also performed laboratory CBR tests (ASTM D1883). Provided subsurface information, soil profiles, and test results.		
	Taxiway Delta & Charlie Rehabilitation Project - Fort Lauderdale Executive Airport, Broward County, Florida	PROFESSIONAL SERVICES 2010	CONSTRUCTION (If applicable)
d.	(3) BRIEF DESCRIPTION (Brief scope, size, cost, etc.) AND SPECIFIC ROLE <input checked="" type="checkbox"/> Check if project performed with current firm Mr. Thomas served as the principal geotechnical engineer for the geotechnical services for the milling and resurfacing of Taxiway Delta & Charlie. Performed Standard Penetration Test (SPT) borings and pavement cores. Provided a geotechnical services report discussing the subsurface conditions found, groundwater conditions at the site, and pavement core test results.		
	Runway 15-33 Rehabilitation and Taxiway C Reconstruction, Lantana Airport, Palm Beach County, Florida	PROFESSIONAL SERVICES	CONSTRUCTION (If applicable) 2012
e.	(3) BRIEF DESCRIPTION (Brief scope, size, cost, etc.) AND SPECIFIC ROLE <input checked="" type="checkbox"/> Check if project performed with current firm Mr. Thomas was the principal in charge of the construction material testing and inspection services for the rehabilitation of runway 15-33 and reconstruction of Taxiway C. Services include inspection of asphalt plant supplier, density tests, LBR test, inspection and asphalt testing (during initial test section and production), miscellaneous concrete tests, asphalt cores, mix design reviews, and certification. Project required working night and weekend shifts.		

## E. RESUMES OF KEY PERSONNEL PROPOSED FOR THIS CONTRACT

(Complete one Section E for each key person.)

<b>12. NAME</b> <b>Kumar Vedula, P.E.</b>	<b>13. ROLE IN THIS CONTRACT</b> <b>Principal Geotechnical Engineer</b>	<b>14. YEARS EXPERIENCE</b> <table style="width: 100%; border: none;"> <tr> <td style="width: 50%; border: none;">a. TOTAL</td> <td style="width: 50%; border: none;">b. WITH CURRENT FIRM</td> </tr> <tr> <td style="border: none; text-align: center;"><b>20</b></td> <td style="border: none; text-align: center;"><b>8</b></td> </tr> </table>		a. TOTAL	b. WITH CURRENT FIRM	<b>20</b>	<b>8</b>
a. TOTAL	b. WITH CURRENT FIRM						
<b>20</b>	<b>8</b>						
<b>15. FIRM NAME AND LOCATION (City and State)</b> TIERRA SOUTH FLORIDA, INC. West Palm Beach, Florida							
<b>16. EDUCATION (DEGREE AND SPECIALIZATION)</b> Bachelor of Engineering, Andhra University, India, 1992 MS Civil Engineering, University of Memphis, 1995		<b>17. CURRENT PROFESSIONAL REGISTRATION (STATE AND DISCIPLINE)</b> Professional Engineer, Florida No. 54873					
<b>18. OTHER PROFESSIONAL QUALIFICATIONS (Publications, Organizations, Training, Awards, etc.)</b> American Society of Civil Engineers, Past President <i>Augered Cast-in-Place and Driven Pre-stressed Concrete Pile Field Performance Comparison</i> , Frizzi, R. P., & Vedula, R.V., Published in FHWA Resource Center, 83 <sup>rd</sup> Annual Transportation Research Board Meeting, Washington D.C., January 2004 <i>Improvement of soft clay using high pressure Jet Grout</i> , Chang, T.S., Vedula, R. V., and Chang, K.P., 4 <sup>th</sup> International Conference on Recent Advances in Geotechnical Earthquake Engineering and Soil Dynamics, San Diego, March 2001							
<b>19. RELEVANT PROJECTS</b>							
a.	<b>(1) TITLE AND LOCATION (City and State)</b> Expansion of Runway 10R-28L, Fort Lauderdale – Hollywood International Airport, Broward County, Florida	<b>(2) YEAR COMPLETED</b> <table style="width: 100%; border: none;"> <tr> <td style="width: 50%; border: none;">PROFESSIONAL SERVICES</td> <td style="width: 50%; border: none;">CONSTRUCTION (If applicable)</td> </tr> <tr> <td style="border: none; text-align: center;">2013</td> <td style="border: none;"></td> </tr> </table>		PROFESSIONAL SERVICES	CONSTRUCTION (If applicable)	2013	
	PROFESSIONAL SERVICES	CONSTRUCTION (If applicable)					
	2013						
<b>(3) BRIEF DESCRIPTION (Brief scope, size, cost, etc.) AND SPECIFIC ROLE</b> <input checked="" type="checkbox"/> Check if project performed with current firm Mr. Vedula was the senior geotechnical engineer for the geotechnical study for the proposed expansion of Runway 9R-27L and associated US-1/FEC railroad structures, high fill embankment, and MSE walls. SPT soil borings and sampling are being performed for US-1/FEC Railroad structures, MSE walls and high embankments. Maximum MSE wall height is expected to be about 65 ft. which is significantly higher than the normal practice in Florida. Performed pile capacity analysis for bridge structures. Provided analysis and recommendations for MSE walls and embankment fill as well as other geotechnical engineering recommendations.							
b.	<b>(1) TITLE AND LOCATION (City and State)</b> T4 West Fuel Hydrant System, Fort Lauderdale – Hollywood International Airport, Broward County, Florida	<b>(2) YEAR COMPLETED</b> <table style="width: 100%; border: none;"> <tr> <td style="width: 50%; border: none;">PROFESSIONAL SERVICES</td> <td style="width: 50%; border: none;">CONSTRUCTION (If applicable)</td> </tr> <tr> <td style="border: none; text-align: center;">2011</td> <td style="border: none;"></td> </tr> </table>		PROFESSIONAL SERVICES	CONSTRUCTION (If applicable)	2011	
	PROFESSIONAL SERVICES	CONSTRUCTION (If applicable)					
	2011						
<b>(3) BRIEF DESCRIPTION (Brief scope, size, cost, etc.) AND SPECIFIC ROLE</b> <input checked="" type="checkbox"/> Check if project performed with current firm Mr. Vedula was the senior geotechnical engineer for the geotechnical engineering study to explore the subsurface conditions at the site to enable an evaluation of acceptable foundation for the construction. Provided a geotechnical report summarizing findings as well as geotechnical recommendations regarding foundation design and soil parameters.							
c.	<b>(1) TITLE AND LOCATION (City and State)</b> Northside Renovations at Fort Lauderdale Jet Center, Fort Lauderdale–Hollywood International Airport, Broward County, Florida	<b>(2) YEAR COMPLETED</b> <table style="width: 100%; border: none;"> <tr> <td style="width: 50%; border: none;">PROFESSIONAL SERVICES</td> <td style="width: 50%; border: none;">CONSTRUCTION (If applicable)</td> </tr> <tr> <td style="border: none; text-align: center;">2006</td> <td style="border: none;"></td> </tr> </table>		PROFESSIONAL SERVICES	CONSTRUCTION (If applicable)	2006	
	PROFESSIONAL SERVICES	CONSTRUCTION (If applicable)					
	2006						
<b>(3) BRIEF DESCRIPTION (Brief scope, size, cost, etc.) AND SPECIFIC ROLE</b> <input checked="" type="checkbox"/> Check if project performed with current firm Mr. Vedula was the senior geotechnical engineer for the geotechnical study for the construction of a hangar and office spaces, new pavement areas and resurfacing of existing pavement. Provided recommendations for site preparation, foundation design, floor slab design, lateral earth pressure, pavement design, and other construction considerations.							
d.	<b>(1) TITLE AND LOCATION (City and State)</b> Taxiway Bravo Rehabilitation Project - Fort Lauderdale Executive Airport Broward County, Florida	<b>(2) YEAR COMPLETED</b> <table style="width: 100%; border: none;"> <tr> <td style="width: 50%; border: none;">PROFESSIONAL SERVICES</td> <td style="width: 50%; border: none;">CONSTRUCTION (If applicable)</td> </tr> <tr> <td style="border: none; text-align: center;">2008</td> <td style="border: none;"></td> </tr> </table>		PROFESSIONAL SERVICES	CONSTRUCTION (If applicable)	2008	
	PROFESSIONAL SERVICES	CONSTRUCTION (If applicable)					
	2008						
<b>(3) BRIEF DESCRIPTION (Brief scope, size, cost, etc.) AND SPECIFIC ROLE</b> <input checked="" type="checkbox"/> Check if project performed with current firm Mr. Vedula was the senior geotechnical engineer for the geotechnical study for the rehabilitation of Taxiway Bravo at Fort Lauderdale Executive Airport (FXE) in Broward County, Florida. The project was approximately 2 miles long. The rehabilitation included widening of Taxiway Charlie, Mike and November and milling and resurfacing Taxiway Bravo. Performed Standard Penetration Test (SPT) borings along Taxiway Bravo and exit ramps as well as pavement cores. Provided geotechnical report summarize findings as well as geotechnical recommendations regarding excavations, ground water control and pavement design.							
e.	<b>(1) TITLE AND LOCATION (City and State)</b> Mounting Structures and Travel Lane at Remote Parking, Fort Lauderdale–Hollywood International Airport, Broward County, Florida	<b>(2) YEAR COMPLETED</b> <table style="width: 100%; border: none;"> <tr> <td style="width: 50%; border: none;">PROFESSIONAL SERVICES</td> <td style="width: 50%; border: none;">CONSTRUCTION (If applicable)</td> </tr> <tr> <td style="border: none; text-align: center;">2009</td> <td style="border: none;"></td> </tr> </table>		PROFESSIONAL SERVICES	CONSTRUCTION (If applicable)	2009	
	PROFESSIONAL SERVICES	CONSTRUCTION (If applicable)					
	2009						
<b>(3) BRIEF DESCRIPTION (Brief scope, size, cost, etc.) AND SPECIFIC ROLE</b> <input checked="" type="checkbox"/> Check if project performed with current firm Mr. Vedula was the senior engineer for the geotechnical engineering study to explore the subsurface conditions within or in close proximity to the proposed mounting structures and travel lane. Provided geotechnical engineering report with summary of groundwater and subsurface conditions. Also provided geotechnical recommendations and soil parameters for a drilled shaft foundation design system along with considerations for drilled shaft construction.							

<b>F. EXAMPLE PROJECTS WHICH BEST ILLUSTRATE PROPOSED TEAM'S QUALIFICATIONS FOR THIS CONTRACT</b> <i>(Present as many projects as requested by the agency, or 10 projects, If not specified. Complete one Section F for each project.)</i>		<b>20. EXAMPLE PROJECT KEY NUMBER</b> 1
<b>21. TITLE AND LOCATION (City and State)</b> <b>Margate City Center Stormwater Master Permit</b> <b>Margate</b>	<b>22. YEAR COMPLETED</b>	
	<b>PROFESSIONAL SERVICES</b> 2016	<b>CONSTRUCTION (if Applicable)</b>

<b>23. PROJECT OWNER'S INFORMATION</b>		
<b>a. PROJECT OWNER</b> Margate CRA	<b>b. POINT OF CONTACT NAME</b> Kim Vazquez	<b>c. POINT OF CONTACT TELEPHONE NUMBER</b> (954) 935-5324

<b>24. BRIEF DESCRIPTION OF PROJECT AND RELEVANCE TO THIS CONTRACT</b> <i>(Include scope, size, and cost)</i>
---

In an attempt to revitalize the Margate downtown area, the Margate CRA contracted Kimley-Horn to prepare a conceptual stormwater master plan for their 43.7-acre downtown area. As part of this project, Kimley-Horn was tasked with obtaining a conceptual Environmental Resource Permit, which would serve as the backbone for future development phases within this permitted area. The acquisition of the conceptual permit will ease the permitting process at the time of development, and provide security to both the City and future clientele, ensuring that all parcels included within the permit would be available for future development. The project area included a complete stormwater system redesign to incorporate the proposed conceptual development, which will include garden style apartments, townhomes, mid-rise condominiums, civic uses, and commercial developments. The team prepared a master drainage model using ICPR software, evaluated the existing drainage system, created drainage basin delineations and maps, performed a complete hydraulic/hydrologic analysis of the area, and developed the proposed master conceptual drainage improvement plans.

The project entailed re-routing the flow of stormwater in this area into an existing 56.6-acre lake, which is to be expanded in order to accommodate the added stormwater water runoff. The drainage improvements consisted of approximately 4,000 linear feet of exfiltration trench, a new piping network throughout the area, and a new 48" main trunk line leading to a new outfall structure and headwall within the newly expanded lake. Additionally, water quality treatment measures were implemented. A portion of this 43.7-acre area was previously permitted under an existing South Florida Water Management District Master Environmental Resource Permit, therefore, our re-design had to comply with both current design standards and the original assumptions and conditions stated within the master permit. Kimley-Horn obtained a new conceptual permit through the Broward County Surface Water Management Section, as well as a new conceptual Environmental Resource Permit through the South Florida Water Management District. The project was completed in 2016 at a cost of \$152,000.



<b>25. FIRMS FROM SECTION C INVOLVED WITH THIS PROJECT</b>			
<b>a.</b>	<b>(1) FIRM NAME</b> Kimley-Horn	<b>(2) FIRM LOCATION (City and State)</b> Plantation	<b>(3) ROLE</b> Prime
<b>b.</b>	<b>(1) FIRM NAME</b> Tierra South Florida, Inc.	<b>(2) FIRM LOCATION (City and State)</b> West Palm Beach	<b>(3) ROLE</b> Subconsultant
<b>c.</b>	<b>(1) FIRM NAME</b>	<b>(2) FIRM LOCATION (City and State)</b>	<b>(3) ROLE</b>

**F. EXAMPLE PROJECTS WHICH BEST ILLUSTRATE PROPOSED TEAM'S QUALIFICATIONS FOR THIS CONTRACT**

(Present as many projects as requested by the agency, or 10 projects, If not specified. Complete one Section F for each project.)

20. EXAMPLE PROJECT KEY NUMBER

2

21. TITLE AND LOCATION (City and State)

**Village of Palmetto Bay Stormwater Master Plan**  
**Palmetto Bay**

22. YEAR COMPLETED

PROFESSIONAL SERVICES  
2015

CONSTRUCTION (if Applicable)

**23. PROJECT OWNER'S INFORMATION**

a. PROJECT OWNER

Village of Palmetto Bay

b. POINT OF CONTACT NAME

Corrice E. Patterson

c. POINT OF CONTACT TELEPHONE NUMBER

(305) 969-5011

24. BRIEF DESCRIPTION OF PROJECT AND RELEVANCE TO THIS CONTRACT (Include scope, size, and cost)

The stormwater master plan required extensive research of the community's roadways, utilities, and drainage patterns to understand the condition of the infrastructure and stormwater management needs. As part of the stormwater master plan, Kimley-Horn assisted the Village in developing a capital improvement program to prioritize improvements based on flood management needs and associated costs. In addition, Kimley-Horn helped the Village evaluate properties throughout the Village and developed associated utility rates to generate a dedicated revenue stream for the Village improvements.

In addition to addressing stormwater management issues, Kimley-Horn developed a stormwater management report to assist the Village in creating a stormwater utility. A stormwater utility generates a dedicated stream of revenue to implement capital improvements and maintain an operation and maintenance program associated with the stormwater system. The project tasks primarily consisted of data compilation, development of a stormwater master plan, development of a stormwater management report, and assisting the Village in joining the National Flood Insurance Program (NFIP) so that federally funded flood insurance is available to the community. The project was completed in 2015 at a cost of \$80,000.

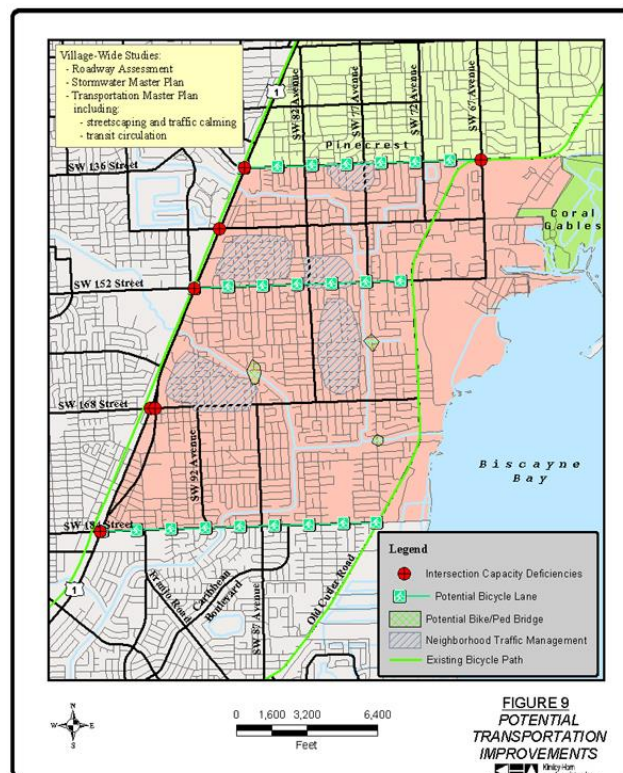

**25. FIRMS FROM SECTION C INVOLVED WITH THIS PROJECT**

a.	(1) FIRM NAME Kimley-Horn	(2) FIRM LOCATION (City and State) Plantation	(3) ROLE Prime
b.	(1) FIRM NAME Tierra South Florida, Inc.	(2) FIRM LOCATION (City and State) West Palm Beach	(3) ROLE Subconsultant
c.	(1) FIRM NAME	(2) FIRM LOCATION (City and State)	(3) ROLE

STANDARD FORM 330 (REV. 3/2013) PAGE 5



<b>F. EXAMPLE PROJECTS WHICH BEST ILLUSTRATE PROPOSED TEAM'S QUALIFICATIONS FOR THIS CONTRACT</b> <i>(Present as many projects as requested by the agency, or 10 projects, If not specified. Complete one Section F for each project.)</i>		<b>20. EXAMPLE PROJECT KEY NUMBER</b> 3
<b>21. TITLE AND LOCATION (City and State)</b> <b>Town of Miami Lakes Stormwater Master Plan</b> <b>Miami Lakes</b>	<b>22. YEAR COMPLETED</b>	
	<b>PROFESSIONAL SERVICES</b> 2012	<b>CONSTRUCTION (if Applicable)</b>

<b>23. PROJECT OWNER'S INFORMATION</b>		
<b>a. PROJECT OWNER</b> Town of Miami Lakes	<b>b. POINT OF CONTACT NAME</b> Alex Rey	<b>c. POINT OF CONTACT TELEPHONE NUMBER</b> (305) 364-6100

<b>24. BRIEF DESCRIPTION OF PROJECT AND RELEVANCE TO THIS CONTRACT</b> <i>(Include scope, size, and cost)</i>
---

Kimley-Horn prepared a stormwater master plan that outlined the deficiencies of the current stormwater system to develop Miami Lakes' own stormwater utility. The stormwater master plan included an evaluation for the existing drainage system, drainage basin map, hydraulic/hydrologic analysis, proposed drainage improvement projects, and proposed operation and maintenance plan. Additionally, we developed the stormwater utility fee methodology and established the range of rates for the utility to implement improvements. Kimley-Horn also prepared a five-year Capital Improvements Plan for the stormwater improvements. Due to successful grant applications, the Town of Miami Lakes was able to accelerate capital projects identified in its original stormwater master plan. The stormwater master plan identified additional priority basins and revised the 10-year capital improvement program. This project also included geographic information system (GIS) mapping of the Town's stormwater management infrastructure.

The Kimley-Horn team also helped the Town prepare their initial National Flood Insurance Program (NFIP) Community Rating System (CRS) application. They received an initial rating of 6, which allows property owners in the Town to receive a 20% discount on their flood insurance. A rating of 6 is one of the best ratings FEMA has ever given to any municipality new to the Community Rating System. Ever since Miami Lakes has been accepted into the CRS program, KHA has prepared their annual CRS report to FEMA to maintain their CRS rating. We are now working with the Town to implement programs that will allow them to lower (improve) their CRS rating to a 5 or a 4 — which will result in an additional 5% to 10% flood insurance discount for Town property owners. The project was completed in 2012 at a cost of \$75,000.

<b>25. FIRMS FROM SECTION C INVOLVED WITH THIS PROJECT</b>			
<b>a.</b>	(1) FIRM NAME Kimley-Horn	(2) FIRM LOCATION <i>(City and State)</i> Plantation	(3) ROLE Prime
	(1) FIRM NAME	(2) FIRM LOCATION <i>(City and State)</i>	(3) ROLE
<b>b.</b>	(1) FIRM NAME	(2) FIRM LOCATION <i>(City and State)</i>	(3) ROLE
	(1) FIRM NAME	(2) FIRM LOCATION <i>(City and State)</i>	(3) ROLE
<b>c.</b>	(1) FIRM NAME	(2) FIRM LOCATION <i>(City and State)</i>	(3) ROLE
	(1) FIRM NAME	(2) FIRM LOCATION <i>(City and State)</i>	(3) ROLE

STANDARD FORM 330 (REV. 3/2013) PAGE 5

**F. EXAMPLE PROJECTS WHICH BEST ILLUSTRATE PROPOSED TEAM'S QUALIFICATIONS FOR THIS CONTRACT**

(Present as many projects as requested by the agency, or 10 projects, If not specified.  
Complete one Section F for each project.)

20. EXAMPLE PROJECT  
KEY NUMBER

4

## 21. TITLE AND LOCATION (City and State)

**Lloyd Estates Streetscape Drainage Improvements  
Oakland Park**

## 22. YEAR COMPLETED

PROFESSIONAL SERVICES

2012

CONSTRUCTION (if Applicable)

2013

**23. PROJECT OWNER'S INFORMATION**

## a. PROJECT OWNER

City of Oakland Park

## b. POINT OF CONTACT NAME

Ronald Desbrunes

## c. POINT OF CONTACT TELEPHONE NUMBER

(954) 630-4256

## 24. BRIEF DESCRIPTION OF PROJECT AND RELEVANCE TO THIS CONTRACT (Include scope, size, and cost)

Kimley-Horn provided professional engineering services for the design and construction of a phased drainage collection system with water quality treatment measures for the residential and industrial portions of Lloyd Estates bounded by Powerline Road and Andrews Avenue for the residential portion and between NW 10th Terrace and Powerline Road for the industrial portion. A section of NW 10th Terrace between Oakland Park Boulevard and NW 35th Court was also included in the project to address drainage to Oakland Park Boulevard.

The project also included landscape architecture enhancement that consisted of palms, new turf, and shrubs in the medians and larger islands. Design challenges included placing and selecting plant material under overhead utilities and providing clear sign and offset clearances for numerous driveways and intersections. The project included a new irrigation system with a well and pump station, as well as paver sidewalks and crosswalk enhancements. The project was part of a FEMA Hazard Mitigation Grant due to the heavy flooding occurring in the area.

Professional services include surveying, stormwater analysis, civil and electrical engineering design, landscaping and irrigation, permitting, coordinating with utility providers, preparing quantity calculations, and engineer's estimates of probable costs. The construction phase services included site visits, pay application review, responding to RFIs, and project closeout/certifications. The project was completed in 2012 at a cost of \$430,000.

**25. FIRMS FROM SECTION C INVOLVED WITH THIS PROJECT**

a.	(1) FIRM NAME	(2) FIRM LOCATION (City and State)	(3) ROLE
	Kimley-Horn	Plantation	Prime
b.	(1) FIRM NAME	(2) FIRM LOCATION (City and State)	(3) ROLE
c.	(1) FIRM NAME	(2) FIRM LOCATION (City and State)	(3) ROLE

STANDARD FORM 330 (REV. 3/2013) PAGE 5

<b>F. EXAMPLE PROJECTS WHICH BEST ILLUSTRATE PROPOSED TEAM'S QUALIFICATIONS FOR THIS CONTRACT</b> <i>(Present as many projects as requested by the agency, or 10 projects, if not specified. Complete one Section F for each project.)</i>		<b>20. EXAMPLE PROJECT KEY NUMBER</b> 5
<b>21. TITLE AND LOCATION (City and State)</b> <b>Floranada Business Development Stormwater Improvements</b> <b>Oakland Park</b>	<b>22. YEAR COMPLETED</b>	
	<b>PROFESSIONAL SERVICES</b> 2012	<b>CONSTRUCTION (if Applicable)</b> 2012

<b>23. PROJECT OWNER'S INFORMATION</b>		
<b>a. PROJECT OWNER</b> City of Oakland Park	<b>b. POINT OF CONTACT NAME</b> Marlon Lobban	<b>c. POINT OF CONTACT TELEPHONE NUMBER</b> (954) 630-4416

<b>24. BRIEF DESCRIPTION OF PROJECT AND RELEVANCE TO THIS CONTRACT</b> <i>(Include scope, size, and cost)</i>
---

The Kimley-Horn team provided the City of Oakland Park with stormwater improvements for the Floranada Business Development. This project involved the installation of new drainage improvements, stormwater analysis, civil and electrical engineering design, pavement renovations, signing and pavement markings, select water main replacements, utility adjustments, maintenance of traffic, permitting, and construction phase services.

The project also included the installation of three 150-foot-deep drainage wells along with three stormwater pump stations. The pump stations will deliver stormwater via drainage force mains to three proposed Biscayne Aquifer Wells. The team also designed the connection and upsizing of antiquated drainage systems and construction of exfiltration trenches. The project was completed in 2012 at a cost of \$194,000.

<b>25. FIRMS FROM SECTION C INVOLVED WITH THIS PROJECT</b>			
<b>a.</b>	<b>(1) FIRM NAME</b> Kimley-Horn	<b>(2) FIRM LOCATION (City and State)</b> Plantation	<b>(3) ROLE</b> Prime
<b>b.</b>	<b>(1) FIRM NAME</b>	<b>(2) FIRM LOCATION (City and State)</b>	<b>(3) ROLE</b>
<b>c.</b>	<b>(1) FIRM NAME</b>	<b>(2) FIRM LOCATION (City and State)</b>	<b>(3) ROLE</b>

STANDARD FORM 330 (REV. 3/2013) PAGE 5

<b>F. EXAMPLE PROJECTS WHICH BEST ILLUSTRATE PROPOSED TEAM'S QUALIFICATIONS FOR THIS CONTRACT</b> <i>(Present as many projects as requested by the agency, or 10 projects, If not specified. Complete one Section F for each project.)</i>		<b>20. EXAMPLE PROJECT KEY NUMBER</b> 6
<b>21. TITLE AND LOCATION (City and State)</b> <b>Broward Center for the Performing Arts Environmental Resource Permit, Fort Lauderdale</b>	<b>22. YEAR COMPLETED</b>	
	<b>PROFESSIONAL SERVICES</b> 2014	<b>CONSTRUCTION (if Applicable)</b> 2014

**23. PROJECT OWNER'S INFORMATION**

<b>a. PROJECT OWNER</b> Performing Arts Center Authority	<b>b. POINT OF CONTACT NAME</b> Doug Tober	<b>c. POINT OF CONTACT TELEPHONE NUMBER</b> (954) 522-5334
---	---	---

**24. BRIEF DESCRIPTION OF PROJECT AND RELEVANCE TO THIS CONTRACT** *(Include scope, size, and cost)*

Kimley-Horn completed a comprehensive analysis to identify the facilities needed to accommodate traffic generated by the Performing Arts Center. The project included the design of traffic signal modifications for two existing signalized intersections and two new signals to serve the Performing Arts Center and its parking garage. Our team coordinated operational improvements and the widening of SW 2nd Street with staff from Broward County and the City of Ft. Lauderdale. The functional design we prepared reconfigured a portion of West Las Olas Boulevard to accommodate on-street parking for adjacent marine-oriented activities.

The six-acre site also required extensive drainage modeling for an Environmental Resource Permit (ERP)/ Broward County Stormwater Permit modification. The existing facility was originally built at raised elevations to ensure that the orchestra pit remained above the water table elevation. Due to these requirements, the site's finished floor elevation was approximately 13 feet above the FEMA flood elevation; this presented additional stormwater modeling challenges to accommodate the facility expansion program while maintaining the existing drainage patterns of the site and adjacent properties. The project was completed in 2014 at a cost of \$120,000.



**25. FIRMS FROM SECTION C INVOLVED WITH THIS PROJECT**

<b>a.</b>	(1) FIRM NAME Kimley-Horn	(2) FIRM LOCATION <i>(City and State)</i> Plantation	(3) ROLE Prime
<b>b.</b>	(1) FIRM NAME	(2) FIRM LOCATION <i>(City and State)</i>	(3) ROLE
<b>c.</b>	(1) FIRM NAME	(2) FIRM LOCATION <i>(City and State)</i>	(3) ROLE

**STANDARD FORM 330 (REV. 3/2013) PAGE 5**

<b>F. EXAMPLE PROJECTS WHICH BEST ILLUSTRATE PROPOSED TEAM'S QUALIFICATIONS FOR THIS CONTRACT</b> <i>(Present as many projects as requested by the agency, or 10 projects, If not specified. Complete one Section F for each project.)</i>		20. EXAMPLE PROJECT KEY NUMBER 7
21. TITLE AND LOCATION <i>(City and State)</i> <b>GOAA Comprehensive Conceptual Stormwater Permit/Environmental Resource Permit Update, Orlando</b>	22. YEAR COMPLETED	
	PROFESSIONAL SERVICES Ongoing	CONSTRUCTION (if Applicable)

<b>23. PROJECT OWNER'S INFORMATION</b>		
a. PROJECT OWNER Greater Orlando Aviation Authority	b. POINT OF CONTACT NAME Tuan Nguyen, P.E.	c. POINT OF CONTACT TELEPHONE NUMBER (407) 825-4662

24. BRIEF DESCRIPTION OF PROJECT AND RELEVANCE TO THIS CONTRACT *(Include scope, size, and cost)*

Kimley-Horn is tasked with designing modifications to the Orlando International Airport conceptual permit for the changes proposed to its master stormwater management system. The intent of change is an update the existing master conceptual permit for OIA with existing permitted conditions and future buildout conditions in each sub-basin. Water quality treatment will be provided in 488 acres of storm water management areas. Consistent with the previous conceptual approval, individual tracts will provide one half inch of dry pretreatment prior to connecting to the OIA master system help ensure that hazardous materials do not enter the storm water management system. The project is ongoing, currently on-schedule and on-budget.

<b>25. FIRMS FROM SECTION C INVOLVED WITH THIS PROJECT</b>			
a.	(1) FIRM NAME	(2) FIRM LOCATION <i>(City and State)</i>	(3) ROLE
	Kimley-Horn	Orlando	Prime
b.	(1) FIRM NAME	(2) FIRM LOCATION <i>(City and State)</i>	(3) ROLE
c.	(1) FIRM NAME	(2) FIRM LOCATION <i>(City and State)</i>	(3) ROLE







<b>F. EXAMPLE PROJECTS WHICH BEST ILLUSTRATE PROPOSED TEAM'S QUALIFICATIONS FOR THIS CONTRACT</b> <i>(Present as many projects as requested by the agency, or 10 projects, If not specified. Complete one Section F for each project.)</i>		<b>20. EXAMPLE PROJECT KEY NUMBER</b>  <b>9</b>
<b>21. TITLE AND LOCATION (City and State)</b> Florida Department of Transportation, Statewide Airport Stormwater Study	<b>22. YEAR COMPLETED</b>	
	PROFESSIONAL SERVICES Ongoing	CONSTRUCTION (if Applicable)
<b>23. PROJECT OWNER'S INFORMATION</b>		
<b>a. PROJECT OWNER</b> Florida Department of Transportation	<b>b. POINT OF CONTACT NAME</b> Harry Downing	<b>c. POINT OF CONTACT TELEPHONE NUMBER</b> 850.386.9527

**24. BRIEF DESCRIPTION OF PROJECT AND RELEVANCE TO THIS CONTRACT** *(Include scope, size, and cost)*

Program Manager and Technical Manager depending on project Phase. Initial program development and federal grant application assistance. Stakeholder committee development with Federal Aviation Administration, Florida Department of Transportation, Florida Department of Environmental Protection, South Florida Water Management District, and St. John's River Water Management District. Runoff hydrology, load and concentration evaluations based on collected data. Author of FDOT Statewide Airport Stormwater Best Management Practices Manual and Technical Report for the Statewide Airport Stormwater Study. Editor for Application Assessment for the Statewide Airport Stormwater Study. Co-author of Rule 62–330.449 Florida Administrative Code (FAC) General Permit for Construction, Operation, Maintenance, Alteration, Abandonment or Removal of Airport Airside Stormwater Management Systems. Education and Training program co-author/presenter. Review, summary and BMP Manual revisions for the FAA Pond performance verification study at Naples Municipal Airport.

Project Cost: \$8.5 Million

25. FIRMS FROM SECTION C INVOLVED WITH THIS PROJECT			
a.	(1) FIRM NAME EG Solutions Inc	(2) FIRM LOCATION <i>(City and State)</i> 9015 Town Center Pkwy 106 Lakewood Ranch, FL 34202	(3) ROLE Program Management
b.	(1) FIRM NAME	(2) FIRM LOCATION <i>(City and State)</i>	(3) ROLE
c.	(1) FIRM NAME	(2) FIRM LOCATION <i>(City and State)</i>	(3) ROLE
d.	(1) FIRM NAME	(2) FIRM LOCATION <i>(City and State)</i>	(3) ROLE
e.	(1) FIRM NAME	(2) FIRM LOCATION <i>(City and State)</i>	(3) ROLE
f.	(1) FIRM NAME	(2) FIRM LOCATION <i>(City and State)</i>	(3) ROLE

<p align="center"><b>F. EXAMPLE PROJECTS WHICH BEST ILLUSTRATE PROPOSED TEAM'S QUALIFICATIONS FOR THIS CONTRACT</b></p> <p align="center"><i>Present as many projects as requested by the agency, or 10 projects, if not specified. Complete one Section F for each project.)</i></p>	<p>20. EXAMPLE PROJECT KEY NUMBER</p>
---	---------------------------------------

<p>21. TITLE AND LOCATION <i>(City and State)</i></p> <p>Utility Atlas Update for South Runway Expansion–Ft. Lauderdale/Hollywood International Airport 10R/28L</p>	<p>22. YEAR COMPLETED</p>	
	<p>PROFESSIONAL SERVICES</p> <p align="center">On-going</p>	<p>CONSTRUCTION <i>(If applicable)</i></p> <p align="center">N/A</p>

23. PROJECT OWNER'S INFORMATION		
<p>a. PROJECT OWNER</p> <p>BCAD</p>	<p>b. POINT OF CONTACT NAME</p> <p>Marc Gambrill Project Manager IV</p>	<p>c. POINT OF CONTACT TELEPHONE NUMBER</p> <p>(954) 359-2343</p>

<p>24. BRIEF DESCRIPTION OF PROJECT AND RELEVANCE TO THIS CONTRACT <i>(Include scope, size, and cost)</i></p> <p><b>Utility Atlas Update for South Runway Expansion – Ft. Lauderdale/Hollywood International Airport 10R/28L</b></p>
--

As Sub-Consultant to RS&H, Keith & Associates, Inc. was tasked with providing the preconstruction design survey, horizontal and vertical utility mapping, geodetic control surveys and aerial photography survey support. Tasks including:

- Research and incorporate existing AS-BUILT set of plans of all the construction projects that have involved installation/relocation/ elimination or any change to any of the existing utilities at FLL since 1997.
- Prepare an upgraded set of plans including all new utilities installed/relocated or changed at FLL since 1997, as provided by BCAD.
- Include all the designs that include utilities relocation/modification and have already been approved.
- Update the Utility Base Map Ensure that all survey, CAD, and GIS services/deliverables conform to standards set forth by the latest versions of FAA Advisory Circulars (AC) 150/5300-16, 150/5300-17, 150/5300-18.
- Include the entire FLL property as deficiencies in one area may affect the whole airport.
- Include potable water, fire protection, sanitary sewer, storm drainage, primary and secondary electric, BCAD communications (SSI), Bell South, natural gas, and aviation fueling.
- Include horizontal locations, vertical locations (inverts, top-of-pipe), sizes (diameter, duct banks) and materials (PVC, DIP, CMP,RCP).
- Ground penetrating radar may complement soft-digs technology.
- Utility survey accuracy of visible utilities and/or test hole verifications should be specified at 0.05-foot vertical and 0.10-foot horizontal or that set forth by Ac 150/5300-16, whichever is of greater accuracy.



- Utility survey accuracy of subsurface utilities identified by designation or ground penetration radar should be specified at 1-foot horizontal or that set forth by Ac 150/5300-16, whichever is of greater accuracy.
- Coordinate meetings with Utility Owners, if necessary, to verify if the plans prepared include all the utilities installation/modification/relocation.
- Coordinate meetings with BCAD, Airport Development, and planning staff to determine utility areas for future developments.
- Field location of potential existing/missing utilities: physical verification including soft dig if necessary.

25. FIRMS FROM SECTION C INVOLVED WITH THIS PROJECT			
a.	<p>(1) Firm Name</p> <p>Keith and Associates, Inc.</p>	<p>(2) FIRM LOCATION <i>(City and State)</i></p> <p>Pompano Beach, Florida</p>	<p>(3) ROLE</p> <p>Surveying Services</p>
b.	<p>(1) Firm Name</p>	<p>(2) FIRM LOCATION <i>(City and State)</i></p>	<p>(3) ROLE</p>

**G. KEY PERSONNEL PARTICIPATION IN EXAMPLE PROJECTS**

26. NAMES OF KEY PERSONNEL (From Section E, Block 12)	27. ROLE IN THIS CONTRACT (From Section E, Block 13)	28. EXAMPLE PROJECTS LISTED IN SECTION F (Fill in "Example Projects Key" section below before completing table. Place "X" under project key number for participation in same or similar role.)									
		1	2	3	4	5	6	7	8	9	10
Stefano Viola, P.E.	Project Manager	X	X	X	X	X	X		X		
L. Michael Carey	Principal-in-Charge					X	X	X	X		
Gary Ratay, P.E.	Quality Assurance/Quality Control	X	X	X	X	X	X				
Carlos Florian, P.E.	Project Engineer	X	X						X		
Alex Lopez, E.I.	Project Analyst	X	X						X		
Britt Stephens, P.E.	Project Engineer	X			X	X			X		
Jonathan Martin, P.E.	Project Engineer							X	X		
Brian Ashby, P.E.	Project Engineer	X						X			
Brady Walker	Project Analyst	X		X	X				X		
Meredith Aiken, CWD	Project Analyst								X		
Barton Fye, P.E., CFM	Project Engineer	X		X							
Gloria Brady, P.E., CPSWQ	QA/QC									X	
Scott Brady, P.E.	QA/QC									X	
Lee Powers, PSM	Surveyor/GIS										X

**29. EXAMPLE PROJECTS KEY**

NO.	TITLE OF EXAMPLE PROJECT (FROM SECTION F)	NO.	TITLE OF EXAMPLE PROJECT (FROM SECTION F)
1	Margate City Center Stormwater Master Permit	6	Broward Center for the Performing Arts ERP
2	Palmetto Bay Stormwater Master Plan	7	GOAA Comprehensive Conceptual Stormwater Permit/ERP Update
3	Miami Lakes Stormwater Master Plan	8	Sheltair Northside Fixed Base Operator (FBO)
4	Lloyd Estates Streetscape Drainage Improvements	9	FDOT Statewide Airport Stormwater Study
5	Floranada Stormwater Improvements	10	FLL Utility Atlas Update for South Runway Expansion

**STANDARD FORM 330 (REV. 3/2013) PAGE 10**

---

#### H. ADDITIONAL INFORMATION

- PROVIDE ANY ADDITIONAL INFORMATION REQUESTED BY THE AGENCY. ATTACH ADDITIONAL SHEETS AS NEEDED.

**Kimley-Horn** was founded in 1967 in Raleigh, North Carolina by Bob Kimley and John Horn—two senior engineering professors at North Carolina State University. The expertise of the firm was initially focused on traffic planning and public transportation projects. In the ensuing 49 years, the firm has expanded both geographically and in the variety of planning, engineering, and environmental services that it provides. We have been providing engineering and planning services at airports for more than 38 of those years.

Today, Kimley-Horn is a full-service, multidisciplinary consulting firm with more than 2,800 employees offering a full range of consulting services to local, regional, national, and international clients. In Florida alone, there are more than 500 employees in 14 offices, with more than 20 staff devoted full time to serving our aviation clients. Whether it's runways, roadways, or parking; landside access or environmental studies; operations or technology; the firm's experienced professionals can develop innovative solutions you can rely on. Kimley-Horn offers comprehensive airside and landside services to meet wide-ranging needs at airports large and small. Our staff also has extensive experience and is very familiar with the procedures and requirements of the Federal Aviation Administration (FAA), and the Florida Department of Transportation. Our Florida based aviation personnel include former FAA Orlando Area District Office (ADO) personnel who maintain strong personnel relationships with the ADO staff. We currently serve as an on-call consultant for the FDOT Central Aviation Office, as well as their prime consultant for the Statewide Aviation Pavement Management Program. In 2016, Kimley-Horn was ranked 7th for airport consulting firms in the nation by *Engineering News-Record*.

We are recognized for the outstanding work of our consulting staff, the quality of our work environment, and our stature as a business enterprise. In 2016, Kimley-Horn was recognized as one of Fortune magazine's "100 Best Companies to Work For," marking our eighth appearance in the last 10 years; this year, we ranked #7. We were also recently named Southeast Design Firm of the Year by Engineering News-Record (ENR). Much of our growth extends from the confidence and trust that clients have in us. Kimley-Horn has continuously had an office in the Fort Lauderdale area for the past 33 years. We are proud to have worked on projects in Fort Lauderdale and the surrounding communities for many years, and our knowledge and understanding of the area has grown significantly with our decades of service in the community. We are confident that our local presence and sensitivity to the community's concerns will benefit the City by providing you with unmatched accountability, responsiveness, and value. We pride ourselves in our ability to tailor comprehensive airside and landside services to our clients' needs. Kimley-Horn's approach gives our clients the best of both worlds—the resources of a large, nationally ranked firm and the personal attention and response of a small dedicated professional team. With both aviation specific engineering and planning services in-house and in Florida, you get the responsiveness, expertise, and experience you need for the Fort Lauderdale Executive Airport.

*With the Kimley-Horn team, you get a consultant that can help you meet any challenge you face at Ft. Lauderdale Executive Airport, one that listens to your needs and delivers solutions to meet those needs.*

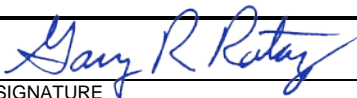

30. SIGNATURE

#### I. AUTHORIZED REPRESENTATIVE

The foregoing is a statement of facts.

31. DATE

10/26/2016

Gary Ratay, P.E., Vice President

33. NAME AND TITLE



1. SOLICITATION NUMBER *(If any)*  
Solicitation 276-11831

2a. FIRM (OR BRANCH OFFICE) NAME Kimley-Horn and Associates, Inc.			3. YEAR ESTABLISHED 2007		5. DUNS NUMBER 061099131	
2b. STREET 1615 S. Congress Ave., Suite 201			5. OWNERSHIP a. TYPE Corporation			
2c. CITY Delray Beach		2d. STATE FL				
6a. POINT OF CONTACT NAME AND TITLE Brady Walker, Analyst / Ecologist			b. SMALL BUSINESS STATUS No			
6b. TELEPHONE NUMBER 561-330-2345		6c. E-MAIL ADDRESS Brady.Walker@kimley-horn.com				
8a. FORMER FIRM NAME(S) (If any)			8b. YR. ESTABLISHED		8c. DUNS NUMBER	

a. Profile Code	b. Experience	c. Revenue Index Number (see below)
B02	Bridge Design	2
C08	Codes; Standards; Ordinances	2
C10	Commercial Building; (low rise); Shopping	6
C11	Community Facilities	4
C12	Communications Systems; TV; Microwave	2
E02	Educational Facilities; Classrooms	6
E09	Environmental Impact Studies, Assessments	4
E11	Environmental Planning	4
H01	Harbors; Jetties; Piers; Ship Terminal	1
H07	Highways; Streets; Airfield Paving; Parking	3
H09	Hospitals & Medical Facilities	6
H10	Hotels; Motels	4
H11	Housing (Residential, Multifamily,	4
I01	Industrial Buildings; Manufacturing Plants	2
L03	Landscape Architecture	1
O01	Office Building; Industrial Parks	4
P12	Power Generation, Transmission,	1
R03	Railroad and Rapid Transit	4
R04	Recreational Facilities (Parks; Marinas; etc.)	5
T03	Traffic & Transportation Engineering	5
U02	Urban Renewals; Community Development	4
W03	Water Supply; Treatment and Distribution	1

## 50





1. SOLICITATION NUMBER *(If any)*  
Solicitation 276-11831

2a. FIRM (OR BRANCH OFFICE) NAME Kimley-Horn and Associates, Inc.			3. YEAR ESTABLISHED 1987		7. DUNS NUMBER 061099131	
2b. STREET 445 24th Street, Suite 200			5. OWNERSHIP			
			a. TYPE Corporation			
2c. CITY Vero Beach		2d. STATE FL	2e. ZIP CODE 32960-5169			
6a. POINT OF CONTACT NAME AND TITLE Britt Stephens, P.E., Engineer			b. SMALL BUSINESS STATUS No			
			7. NAME OF FIRM (If block 2a is a branch office)			
6b. TELEPHONE NUMBER 772-794-4100		6c. E-MAIL ADDRESS Britt.Stephens@kimley-horn.com				
8a. FORMER FIRM NAME(S) (If any)			8b. YR. ESTABLISHED		8c. DUNS NUMBER	

a. Profile Code	b. Experience	c. Revenue Index Number (see below)
A05	Airports; Navajids; Airport Lighting; Aircraft	6
A06	Airports; Terminals; & Hangars; Freight	4
B02	Bridge Design	3
C08	Codes; Standards; Ordinances	3
C10	Commercial Building; (low rise); Shopping	3
C12	Communications Systems; TV; Microwave	5
C15	Construction Management	3
D04	Design-Build - Preparation of Requests for	4
E09	Environmental Impact Studies, Assessments	8
F05	Forensic Engineering	7
H07	Highways; Streets; Airfield Paving; Parking	7
O01	Office Building; Industrial Parks	5
P05	Planning (Community; Regional; Areawide &	6
R04	Recreational Facilities (Parks; Marinas; etc.)	5
R11	Rivers Canals; Waterways; Flood Control	6
S04	Sewage Collection, Treatment & Disposal	5
S07	Solid Wastes; Incineration; Landfill	6
S09	Structural Design; Special Structures	5
T03	Traffic & Transportation Engineering	7
U02	Urban Renewals; Community Development	5
W02	Water Resources; Hydrology; Ground Water	5
W03	Water Supply; Treatment and Distribution	6

## 52



1. SOLICITATION NUMBER (If any)  
266-11831

*(If a firm has branch offices, complete for each specific branch office seeking work.)*

[illegible]

11. ANNUAL AVERAGE PROFESSIONAL SERVICES REVENUES OF FIRM FOR LAST 3 YEARS <i>(Insert revenue index number shown at right)</i>		PROFESSIONAL SERVICES REVENUE INDEX NUMBER	
a. Federal Work		1. Less than \$100,000	6. \$2 million to less than \$5 million
b. Non-Federal Work	4	2. \$100,000 to less than \$250,000	7. \$5 million to less than \$10 million
c. Total Work	4	3. \$250,000 to less than \$500,000	8. \$10 million to less than \$25 million
		4. \$500,000 to less than \$1 million	9. \$25 million to less than \$50 million
		5. \$1 million to less than \$2 million	10. \$50 million or greater

The foregoing is a statement of facts.

<p>a. SIGNATURE</p> 	<p>DATE</p> <p>10/14/16</p>
--	-----------------------------

c. NAME AND TITLE  
**George “Kelly” Rubino, Vice President**



# ARCHITECT – ENGINEER QUALIFICATIONS

1. SOLICITATION NUMBER (if any)  
266-11831

2a. FIRM (OR BRANCH OFFICE) NAME <b>Keith and Associates, Inc.</b>			3. YEAR ESTABLISHED <b>1998</b>		4. DUNS NUMBER <b>N/A</b>	
2b. STREET <b>301 East Atlantic Boulevard</b>			5. OWNERSHIP			
2c. CITY <b>Pompano Beach</b>			a. TYPE <b>Corporation</b>			
2d. STATE <b>FL</b>			b. SMALL BUSINESS STATUS <b>DBE</b>			
2e. ZIP CODE <b>33060</b>			7. NAME OF FIRM (if block 2a is a branch office) <b>N/A</b>			
6a. POINT OF CONTACT NAME AND TITLE <b>Adolphine "Dodie" Keith-Lazowick, PLS, President</b>			6b. TELEPHONE NUMBER <b>954-788-3400</b>			
6c. E-MAIL ADDRESS <b>dkeith@keith-associates.com</b>			8a. FORMER FIRM NAME(S) (if any) <b>N/A</b>			
8b. YR. ESTABLISHED <b>N/A</b>			8c. DUNS NUMBER <b>N/A</b>			

9. EMPLOYEES BY DISCIPLINE				10. PROFILE OF FIRM'S EXPERIENCE AND ANNUAL AVERAGE REVENUE FOR LAST 5 YEARS		
a. Function Code	b. Discipline	c. No. of Employees		a. Profile Code	b. Experience	c. Revenue Index Number (see below)
		(1) Firm	(2) Branch			
02	Administrative	9		A06	Airports; Terminals and Hangars	6
08	CADD Technician	6	1	B02	Bridges	2
12	Civil Engineer, PE	7	1	C07	Coastal Engineering	2
15	Construction Inspector	7		C10	Commercial Building (Low Rise)	5
16	Construction Manager	2		C11	Community Facilities	6
29	G.I.S. Specialist	2		C15	Construction Management	6
38	Land Surveyor, PLS	5	1	C16	Construction Surveying	4
39	Landscape Architect, RLA	2		E02	Educational Facilities	4
47	Planner: Urban/Regional	2		F02	Field Houses; Gyms; Stadiums	3
48	Project Manager	6		G04	G.I.S. Services; Development, Analysis	2
53	Scheduler	1		H07	Highways, Streets, Airfield Paving	4
	Landscape Designer	3		H09	Hospitals & Medical Facilities	3
	Project Surveyor	3		I06	Irrigation; Drainage	3
	Survey Field Crew	22	3	L03	Landscape Architecture	5
	Subsurface Utility Engineer	2		P05	Planning (Community, Regional ...)	3
	Subsurface Utility Field Crew	6		R03	Railroad; Rapid Transit	3
	Utility Coordinator	3		R04	Recreation Facilities (Parks, Marinas, etc)	4
	VDC/BIM	1	1	S10	Surveying; Platting; Mapping; Flood Study	3
				S13	Storm Water handling & Facilities	3
				T04	Topographic Surveying & Mapping	4
				W03	Water Supply; Treatment & Distribution	2
				Z01	Zoning; Land Use Studies	2
Total		89	7			

11. ANNUAL AVERAGE PROFESSIONAL SERVICES REVENUES OF FIRM FOR LAST 3 YEARS (Insert revenue index number shown at right)		PROFESSIONAL SERVICES REVENUE INDEX NUMBER	
a. Federal Work	N/A	1. Less than \$100,000	6. \$2 million to less than \$5 million
b. Non-Federal Work	8	2. \$100,000 to less than \$250,000	7. \$5 million to less than \$10 million
c. Total Work	8	3. \$250,000 to less than \$500,000	8. \$10 million to less than \$25 million
		4. \$500,000 to less than \$1 million	9. \$25 million to less than \$50 million
		5. \$1 million to less than \$2 million	10. \$50 million or greater

12. AUTHORIZED REPRESENTATIVE The foregoing is a statement of facts.	
a. SIGNATURE 	b. DATE <b>10/20/16</b>
c. NAME AND TITLE <b>Eliot Lazowick, Executive Vice President</b>	



**1. SOLICITATION NUMBER (If any)**

*(If a firm has branch offices, complete for each specific branch office seeking work.)*

**12. AUTHORIZED REPRESENTATIVE**  
The foregoing is a statement of facts.

CAM 17-0337  
EXHIBIT 2  
Page 58 of 82



## 4. ORGANIZATIONAL PROFILE AND PROJECT TEAM

The Kimley-Horn team will be led by our project manager, **Stefano Viola, P.E.** He will coordinate our subconsultant partners that include the following firms:

**EG Solutions, Inc.** – *Quality Assurance/Quality Control Assistance*

**Keith and Associates, Inc.** – *Surveying Services*

**Tierra South Florida** – *Geotechnical Services*

More detailed information on our subconsultants can be found in Section 8.

### RESUMES OF THE PROJECT TEAM

Resumes of the project team can be found in the SF 330 located in Section 3. In addition, the roles and responsibilities of each firm and individual team member can be found in the organization chart included in the SF 330.

### EXPERIENCE OF THE PROJECT MANAGER



**Stefano Viola, P.E.** is a project manager with our Fort Lauderdale office. He has more than 10 years of experience providing drainage modeling, water/wastewater utility design, stormwater master planning, permitting and site/plan preparation and review, preparation of engineering drawings, and roadway restoration and resurfacing. Having served the City of Fort Lauderdale and other nearby municipalities throughout the past ten years, Stefano has an extensive familiarity with local rules and regulations. Stefano and his team recently completed a stormwater master plan and obtained a conceptual ERP for the Margate CRA. The project entailed re-routing the flow of stormwater into an existing 56.6-acre lake, which is to be expanded in order to accommodate the added stormwater water runoff from the new re-development plans. His team also obtained a new conceptual permit

through the Broward County Surface Water Management Section, as well as a new conceptual ERP permit through the South Florida Water Management District. Stefano has the knowhow to serve as an extension of your staff throughout all phases of this project. Stefano earned his Bachelor of Science degree in Civil Engineering from Florida International University. He is a Professional Engineer in Florida.

*Please also refer to Stefano's SF 330 Section E resume in Section 3.*

### Organization Chart

An organizational chart of our proposed team is included on the following page.



## 5. APPROACH TO SCOPE OF WORK

### APPROACH TO THE PROJECT

#### Task 1 – Project Initiation and Management

The purpose of this task is to initiate the project, identify project protocols, and establish the necessary coordination between Kimley-Horn and City staff. Kimley-Horn will conduct a project kick-off meeting after receiving notice to proceed from the City. One of the objectives of this meeting is to introduce City staff members to Kimley-Horn's key team members who will be involved during the project. At this meeting, information will be obtained regarding previous stormwater management efforts and experiences, particularly those relative to historic flooding within the project limits. The meeting will address the project schedule, coordination requirements, project goals, and project objectives so that a program management plan can be developed. Kimley-Horn will prepare meeting documents and distribute minutes of the kick-off meeting.

Up to four (4) coordination meetings will be required between the City and Kimley-Horn throughout the duration of the project. During these coordination meetings, we would recommend that a meeting with Broward County be held to discuss their expectations once the conceptual permit is submitted.

##### *Deliverables:*

- Kick-off meeting and four coordination meetings
- Project schedule
- Minutes for each meeting
- Program Management Plan

#### Task 2 – Data Collection/Program Management Plan

Kimley-Horn will collect and evaluate readily available information, such as the existing stormwater master plan study for the development of the new/updated stormwater master plan. Types of data that may be collected by Kimley-Horn include:

- FXE Airport master plan
- Comprehensive Plan
- Previous stormwater management plans
- NPDES permit information and data
- City ordinances, regulations or guidelines for stormwater management
- Stormwater management and land use Geographic Information System (GIS) coverage
- Stormwater management infrastructure data such as canal locations and cross sections, catch basin locations, outfall locations, pipe sizes/inverts, drainage basin boundaries, etc.
- Land use and impervious area data
- Soil characteristics
- Design and record drawings of completed or proposed stormwater management/drainage projects
- Records of stormwater management problem areas
- Existing stormwater infrastructure GIS data

Kimley-Horn will prepare a brief memorandum summarizing the data collected to support the development of the stormwater master plan. This memorandum will also include identification of additional data needs, if any, to complete the plan. This task does not include physically collecting field data such as topographic surveys or geotechnical testing.

##### *Deliverables:*

- Data collection memorandum
- Structure naming convention
- Field inventory of stormwater facilities

- GIS coverage of stormwater facilities (Drainage Atlas)
- Basin/sub-basin delineation on Drainage Map

## Task 3 – Stormwater Master Plan

The result of this task is to develop a stormwater master plan report that utilizes the services performed and information collected in Tasks 1 and 2. Kimley-Horn will meet with the City to identify the content and organization of the stormwater plan report. This task will be conducted in the following three sub-tasks.

### *3.1 Existing Problems/Needs Assessment*

### *3.2 Hydrologic/Hydraulic Modeling*

### *3.3 Summary of Needed Improvements/Capital Improvements Plan (CIP)*

## 3.1 Existing Problems/Needs Assessment

Kimley-Horn will meet with City staff to review stormwater concerns, identify the locations of stormwater problem areas, and collect information relative to problem, nature, and severity. This has already been conducted for the Sheltair Northside Project and the contributing adjacent parcels. Once these areas have been identified, an exhibit will be created depicting the stormwater problem areas within the project limits. This exhibit will be provided to the City for review and will be modified once to incorporate City comments. Some problems will be of routine nature and will lend themselves to straightforward, conceptual solutions. Other problems will be more complex and will require more detailed analyses (including hydrologic/hydraulic modeling.) In general terms, these more complex basins that require modeling include a primary conveyance system and multiple secondary and tertiary systems that are tributary to the primary system.

## 3.2 Hydrologic/Hydraulic Modeling

Kimley-Horn will develop a hydrologic/hydraulic (H/H) stormwater model to evaluate the project area using ICPR or another model acceptable to SFWMD and the City. Typical data required for these models include:

- Stage/storage relationships
- Time of concentration
- Soils infiltration/storage
- Impervious areas
- Curve number/runoff coefficient
- Stormwater facility information
- Rainfall data
- Flow data

Utilizing the H/H model, Kimley-Horn will evaluate multiple alternative solutions for each of the selected problem areas/basins. The recommended improvements may include both structural and nonstructural controls to address the stormwater management problems identified.

## 3.3 Summary of Needed Improvements/Capital Improvements Plan (CIP)

Utilizing the results of the above outlined subtasks, Kimley-Horn will summarize the improvements that are needed to upgrade the level of service for the project's stormwater system. This task will be summarized in a prioritized manner and will address the opinion of probable cost associated with each improvement.

The City's CIP will be presented in a spreadsheet format. Each project will be outlined with a description and corresponding budget outlined for each project. A brief summary of each project will be included in the CIP. In addition to project costs, the CIP will include an annual operation and maintenance budget to establish the necessary levels of funding. The O&M line items and associated costs will be coordinated with the City based on historical data and to address proposed operational improvements.

## Task 4 – Permitting

Upon completion of the stormwater master plan, an overall plan will be prepared to address the problem areas. These plans will be part of the submittal to Broward County for the conceptual ERP. The below sub tasks are the typical scope required to submit for an ERP.

### 4.1 Project Initiation, Survey, Geotechnical, and Schematic Design

Kimley-Horn will obtain, review, and analyze survey and soil testing for the project area. Upon receipt of the survey and geotechnical information, Kimley-Horn will perform a site visit to collect data and note existing conditions. The survey and information collected during the site visits will be utilized to develop a schematic design plan. The schematic design plan will be represented to the City identifying proposed drainage improvements and existing conditions.

As part of this task, two (2) copies of the survey will be forwarded to each utility company known to operate in the vicinity of the project area. Each utility company will be requested to return one redlined survey, identifying the horizontal and vertical location of their facilities and any proposed improvements planned within the next two years. This information will be incorporated into the schematic design plan upon receipt from the utility companies.

### 4.2 Conceptual Design Plans

Utilizing the survey, soil testing results and schematic design plans developed in the previous task, Kimley-Horn shall prepare preliminary conceptual design plans for the implementation of drainage improvements within the project area. These conceptual plans shall show the geometric layout on top of the base survey data. The typical plan sheets would include the following:

- *Key Sheet* – Project title, vicinity map, engineer of record, and other appropriate information.
- *Plan and Profile Sheets* – Containing the geometric, horizontal and vertical alignment within the project area. These sheets shall also contain the horizontal, vertical, and geometric alignments for the proposed drainage improvements.
- *Miscellaneous Construction Details* – These sheets shall provide construction details that are not included in the FDOT Standard Indexes, Broward County Details, or as needed specific City of Fort Lauderdale details.
- *Miscellaneous Drainage Details* – These sheets would provide drainage details that are not included in the FDOT Standard Indexes or Broward County Details.

### 4.3 Drainage Design and Permitting

**Hydraulic Analysis** – The hydraulic analysis shall be completed for the project area based upon the geotechnical and survey information obtained in Task 4.1. During the analysis, the volume of stormwater runoff shall be calculated from the design storm and the capacity of the existing stormwater collection system shall be evaluated. The results of the above noted calculations, along with the incorporation of budget constraints, will be the basis for design of the stormwater system.

**Permitting** – Kimley-Horn shall prepare and submit permit applications to the required regulatory agencies that have jurisdiction over the proposed improvements. These agencies could consist of the following:

- Broward County
- South Florida Water Management District

The package will consist of the permit application form, pre-development and post-development runoff calculations, and the Conceptual Design Plans.

## SCHEDULING METHODOLOGY

Scheduling will be the responsibility of your project manager, **Stefano Viola, P.E.**, and it all begins with a clear understanding of the airport's and project's scope, goals, and milestones. This information is then used to develop three key scheduling tools for Stefano to manage and track the project's progress: 1) a project outline which Kimley-Horn calls a "work plan,"

2) a project Gantt chart style schedule created with Microsoft Project, and 3) Kimley-Horn's "cast-ahead" system which coordinates our staff's availability.

The work plan and schedule are then monitored for progress against the milestones on a weekly basis. Manpower is assigned based on the elements using our "cast-ahead" system. This is a monthly look at workload by individual throughout the firm. We project the effort needed for a six-month window to meet client commitments and evaluate that against personnel assigned to the projects. Should we find that we are falling behind schedule, or are overloading assigned personnel; the system allows us to identify additional qualified personnel that have availability to work on the project to get us back on schedule.

## WORKLOAD SUMMARY

Kimley-Horn is very progressive when it comes to understanding its current workload and has a long history of achieving successful project completion through a combination of effective project management and technical expertise. Consequently, Kimley-Horn is committed to providing the City of Fort Lauderdale with the highest quality staff and service to meet your project schedule and budget requirements.

The members of our project team were selected using two criteria: (1) their experience with similar projects and (2) their availability to assume major technical responsibilities within your project schedule. Kimley-Horn's proactive management system, known as "cast-aheads," is used to detail every project's personnel needs, as well as to determine each staff person's availability. By continuously matching project needs with staff availability, our cast-aheads system is an accurate tool for keeping our projects on schedule.

Based on a review of our cast-aheads, we can assure you that the staff members selected for this team are available immediately to serve you, and are in an excellent position to handle the workload of any assignment you wish to give us. In addition, we have strategically selected subconsultant partners with the technical capability and available resources to meet your needs.

The professionals included on our organization chart have worked extensively together throughout Florida and will be scheduled as needed to work on any assignment requested by the City.

The following table identifies the years of experience and availability of our team members, who have unparalleled qualifications and are eager to work for the City of Fort Lauderdale.

Team Member	Project Role	Years of Experience	Current Percent Available	Planned Percent Available
Stefano Viola, P.E.	Project Manager	10	60	70
L. Michael Carey, P.E.	Principal-in-Charge	37	35	50
Gary Ratay, P.E.	Quality Assurance/ Quality Control	31	25	40
Scott Brady, P.E.	Quality Assurance/ Quality Control	37	25	35
Gloria Brady, P.E., CPSWQ	Quality Assurance/ Quality Control	37	35	45
Carlos Florian, P.E.	Project Engineer	5	50	65
Alex Lopez, E.I.	Project Analyst	7	50	65
Britt Stephens, P.E.	Project Engineer	11	30	40
Jonathan Martin, P.E.	Project Engineer	22	25	35
Brian Ashby, P.E.	Project Engineer	6	45	60
Brady Walker	Environmental Scientist	12	40	55



Team Member	Project Role	Years of Experience	Current Percent Available	Planned Percent Available
Meredith Aiken, CWD	Environmental Scientist	6	50	60
Barton Fye, P.E., CFM	Project Engineer	10	45	55
Lee Powers, P.S.M.	Project Surveyor	10	45	55
Raj Krishnasamy, P.E.	Project Geotechnical Engineer	29	40	50
Francois Thomas, P.E., S.I.	Project Geotechnical Engineer	23	50	60
Kumar Vedula, P.E.	Project Geotechnical Engineer	20	50	60

## VOLUME OF WORK PREVIOUSLY AWARDED BY THE CITY OF FORT LAUDERDALE

We are proud of our long standing and successful relationship with the City of Fort Lauderdale. In the interest of clarity and brevity of this submission, we have listed our active contracts with the City below:

- Intersection Analyses
- Fire State SAR
- FXE Taxiway Foxtrot Rehabilitation
- Sistrunk Parking
- FLL Visioning
- New River Central Traffic Impact Study
- SE 15th Avenue Improvements
- Las Olas Boulevard Safety and Traffic Calming Improvements

## AVAILABLE FACILITIES, TECHNOLOGICAL CAPABILITIES AND OTHER RESOURCES

Our staff is equipped with the latest commercial available design tools including Civil 3D, Microstation and GIS. We are a full production office. Additionally, our graphics arts software capabilities include SketchUp, Adobe InDesign, Adobe Photoshop, Adobe Illustrator, and Microsoft Office. Our presentation systems include high resolution digital projection of PowerPoint slide shows, interactive Smart Board displays, and DVD video. In-house production capabilities also include foam-core presentation boards and multi-media displays. Kimley-Horn also maintains digital photography equipment, digital video recording and video editing/production hardware and software.

Kimley-Horn employs more than 530 employees in Florida and just over 2,800 firmwide. We have more than 100 full-time aviation personnel around the County.



## 6. REFERENCES

**Kimley-Horn** is extremely proud of the relationships we develop with our clients and feel that their view of our work is the highest measure of our services. Below are several client references that represent a variety of government agencies we serve. Our project manager, **Stefano Viola, P.E.**, and our senior project team have or are currently working with these clients and we invite you to contact them about the quality services we provide to them.

### Greater Orlando Aviation Authority (GOAA)

**Client:** Tuan Nguyen, P.E., Sr. Project Manager  
Greater Orlando Aviation Authority  
5855 Cargo Road  
Orlando, FL 32827  
*Phone:* (407) 825-4662, *E-mail:* [tnguyen@goaa.org](mailto:tnguyen@goaa.org)

**GOAA Comprehensive Conceptual Stormwater Permit/Environmental Resource Permit Update.** Kimley-Horn is tasked with designing modifications to the Orlando International Airport conceptual permit for the changes proposed to its master stormwater management system. The intent of change is an update the existing master conceptual permit for OIA with existing permitted conditions and future buildout conditions in each sub-basin. Water quality treatment will be provided in 488 acres of stormwater management areas. Consistent with the previous conceptual approval, individual tracts will provide one-half-inch of dry pretreatment prior to connecting to the OIA master system help ensure that hazardous materials do not enter the stormwater management system. The project is ongoing, currently on-schedule and on-budget.

**Completion Date:** Ongoing

**Construction Cost:** N/A

### Village of Palmetto Bay

**Client:** Corrice E. Patterson, Director  
9495 SW 180th Street  
Palmetto Bay, FL 33157  
*Phone:* (305) 969-5011, *E-mail:* [cpatterson@palemettobay-fl.gov](mailto:cpatterson@palemettobay-fl.gov)

**Village of Palmetto Bay Stormwater Master Plan.** The stormwater master plan required extensive research of the community's roadways, utilities, and drainage patterns to understand the condition of the infrastructure and stormwater management needs. As part of the stormwater master plan, Kimley-Horn assisted the Village in developing a capital improvement program to prioritize improvements based on flood management needs and associated costs. In addition, Kimley-Horn helped the Village evaluate properties throughout the Village and developed associated utility rates to generate a dedicated revenue stream for the Village improvements.

**Completion Date:** 2015

**Construction Cost:** \$80,000

## Town of Miami Lakes

**Client:** Alex Rey, Town Manager  
6601 Main Street  
Miami Lakes, FL 33014  
*Phone:* (305)364-6100, *E-mail:* [reya@miamilakes-fl.gov](mailto:reya@miamilakes-fl.gov)

**Town of Miami Lakes Stormwater Master Plan.** Kimley-Horn prepared a stormwater master plan that outlined the deficiencies of the current stormwater system to develop Miami Lakes' own stormwater utility. The stormwater master plan included an evaluation for the existing drainage system, drainage basin map, hydraulic/hydrologic analysis, proposed drainage improvement projects, and proposed operation and maintenance plan. Additionally, we developed the stormwater utility fee methodology and established the range of rates for the utility to implement improvements. Kimley-Horn also prepared a five-year Capital Improvements Plan for the stormwater improvements. Due to successful grant applications, the Town of Miami Lakes was able to accelerate capital projects identified in its original stormwater master plan. The stormwater master plan identified additional priority basins and revised the 10-year capital improvement program. This project also included geographic information system (GIS) mapping of the Town's stormwater management infrastructure.

**Completion Dates:** 2012

**Construction Cost:** \$75,000

## Margate Community Redevelopment Agency

**Client:** Kim Vazquez, Project Manager  
5790 Margate Boulevard  
Margate, FL 33063  
*Phone:* (954) 935-5324, *E-mail:* [kvazquez@margatefl.com](mailto:kvazquez@margatefl.com)

**Margate City Center Stormwater Master Permit.** The Kimley-Horn team prepared a conceptual stormwater master plan for their 43.7-acre downtown area. The project area included a complete stormwater system re-design to incorporate the proposed development, which will include garden style apartments, townhomes, mid-rise condominiums, civic uses, and commercial developments. The project also included the preparation of a master drainage model (created using the ICPR software), an evaluation of the existing drainage system within this area, the creation of drainage basin delineations and maps, a complete hydraulic/hydrologic analysis of the area, and the proposed master conceptual drainage improvement plans. Kimley-Horn was successful in obtaining a new conceptual permit through the Broward County Surface Water Management Section, as well as a new conceptual ERP permit through the South Florida Water Management District.

**Completion Date:** 2016

**Total Cost:** \$151,000

## 7. MINORITY (MBE) PARTICIPATION

**Kimley-Horn** is committed to engaging the services of minority business enterprises (MBE) and disadvantaged business enterprises (DBEs) whenever possible on a project. We believe that it is important to select M/W/DBEs who are not only qualified, but also have the ability to meet your specific needs on this project. Through corporate policy and philosophy, our firm actively seeks to encourage and promote the use of M/W/DBE firms. We provide interested firms with the opportunity to serve as a subconsultant on our teams and throughout the year, actively seeking to increase and update our large database of qualified M/W/DBE firms to use on future projects. Our aggressive M/W/DBE utilization policy ensures that Kimley-Horn is furthering the positive economic development momentum that the state of Florida advocates through the use of minority, woman, and disadvantaged businesses by its contractors.

### PROJECT PLAN

Kimley-Horn's commitment to engaging the services of M/WBE and DBE firms whenever possible is clearly illustrated by our inclusion of three M/WBE and DBE firms on our team to serve Fort Lauderdale Executive Airport. We believe that it is important to select M/WBE and DBE firms who are not only qualified but also have the ability to meet the specific needs of a project.

Given our on-going commitment to exceeding goals, the implementation process remains the same on a project-to-project basis firmwide. We continually pledge to provide an honest effort to meet the M/WBE and DBE goal for each project. We identify meaningful roles for each M/WBE and DBE subconsultant chosen for each project. We offer our continued commitment to M/WBE and DBE participation for this project as well.

No more telling proof can be offered than a review of the projects Kimley-Horn has worked for FXE on over the past five years. This analysis shows that our utilization of our M/WBE or DBE firms was more than 16%—therefore we exceeded FXE's participation goals by more than 3%.

### M/WBE and DBE Participation Record

Qualified M/W/DBE firms receive priority consideration when Kimley-Horn looks for suppliers to support its business operations. Our commitment to retaining disadvantaged firms to assist on projects is demonstrated by the amounts Kimley-Horn has paid to M/W/DBE firms during the past decade.

Year	Total Amount Paid	Kimley-Horn Annual Goal
2015	\$14.3 million	\$9 million
2014	\$12.2 million	\$9 million
2013	\$10.87 million	\$9 million
2012	\$11.17 million	\$8 million
2011	\$9 million	\$8 million
2010	\$11.15 million	\$8 million
2009	\$13.6 million	\$8 million
2008	15.6 million	\$8 million
2007	14.3 million	\$8 million
2006	13.48 million	\$6.5 million



## Disadvantaged Business Enterprise Certificate of Eligibility

Granted to

### EG SOLUTIONS INC

*It has been determined that the firm listed above has met the federal requirements in accordance with the Code of Federal Regulations (49 CFR Part 26) and is thereby eligible to participate in the Disadvantaged Business Enterprise Program in the State of Florida.*

NAICS CODES:  
541330 541620

Issue Date: March 31, 2014



VICTORIA V. SMITH  
Disadvantaged Business Enterprise Certification Manager  
Florida Department of Transportation

5/2/2016

### Florida UCP DBE Directory

Number of Records Returned: 1  
Selection Criteria:  
Vendor: KEITH AND ASSOCIATES INC

Vendor Name: KEITH AND ASSOCIATES INC  
DBE Certification: CERTIFIED MBE Certification:  
DBA: Former Name:  
Business Description: SURVEYING SUE LANDSCAPE ARCHITECTURE PLANNING CIVIL ENGINEERING

Mailing Address: 301 EAST ATLANTIC BLVD  
POMPANO, FL 33060-

Contact Name: DODIE KEITH LAZOWICK Phone: (954) 788-3400 Fax: (954) 788-3500  
Email: [MAIL@KEITH-ASSOCIATES.COM](mailto:MAIL@KEITH-ASSOCIATES.COM)

Statewide Availability: Y

#### Certified NAICS

541320 Landscape Architectural Services  
541330 Engineering Services  
541340 Drafting Services  
541350 Building Inspection Services  
541370 Surveying and Mapping (except Geophysical) Services  
541611 Administrative Management and General Management Consulting Services  
561990 All Other Support Services

Run on: 05/02/2016  
Page: 1



State of Florida  
**Minority, Women &  
Service-Disabled Veteran**  
Business Certification

Tierra South Florida, Inc.

Is certified under the provisions of  
287 and 295.187, Florida Statutes for a period from:

November 30, 2015 to November 30, 2017



Torey Alston, Executive Director

Florida Department of Management Services  
Office of Supplier Diversity

Office of Supplier Diversity • 4050 Esplanade Way, Suite 380 • Tallahassee, FL 32399-0950 • 850.487.0915 • [www.osd.dms.state.fl.us](http://www.osd.dms.state.fl.us)



## 8. SUBCONSULTANTS

Kimley-Horn's emphasis on dynamic teamwork and quality performance serve as the foundation from which we selected our subconsultant partners for this project. We have worked diligently to pursue firms who are revered and accomplished in their respective fields and demonstrate enthusiasm to be a part of our team and serve their local community. We have a responsibility to provide the best possible client service to you as your consultant and we expect the same level of commitment from each of our subconsultants. These team members essentially operate as a seamless addition to our staff, providing superior technical skills with a balanced focus on the city's needs, goals, and concerns.

We have recruited the following expert subconsultants to round out our team. We have worked with all these firms in the past and found them to be excellent partners and provide outstanding quality and client service. Brief overviews of the firms and their roles are provided below, with relevant certifications and licenses included at the end of this section.

### EG Solutions – Quality Assurance/Quality Control

EG Solutions Inc. (EGS) is a Florida Corporation based in Lakewood Ranch, FL providing aviation consulting services. Each member of senior management has over 35 years of engineering and aviation experience. The majority of this experience has been on Florida aviation projects. After founding another company, MEA Group in the 1990s, the partners sold the company to a larger, national transportation company in 2007. EGS was started by two of the MEA partners, Gloria Brady, P.E. and Kelly Rubino, P.E., C.B.C. in 2013. EGS was formed to provide unique, specialty services to the transportation community within an entrepreneurial and innovative culture among its employees. These specialty services include complex geotechnical, paving, program management, design/build, water management permitting and design services, as well as traditional design projects.



*Key Contact:* Gloria Brady, P.E.  
*Address:* 9015 Town Center Parkway  
 Lakewood Ranch, FL 34202  
*Designation:* Disadvantaged Business Enterprise in the State of Florida

### Keith and Associates – Surveying Services

Keith and Associates, Inc. (K&A) was incorporated as a Florida corporation in 1998. As a mid-size closely-knit firm, they provide civil engineering, construction management, comprehensive planning, landscape architecture, surveying and mapping and subsurface utility engineering services. Currently, K&A are operating 8 survey crews and 2 S.U.E. crews in the Tri-County area of Broward, Palm Beach and Miami-Dade County.



K&A has placed a strong emphasis on quality surveying and mapping practices and procedures. This focus ensures that their surveying personnel are committed to exceeding your expectations. Technology has provided today's Surveyors and Mappers with tremendous tools that have greatly minimized the difficulties of measurement accuracy and precision; however, the art and legal principles of surveying and mapping remain unchanged today. K&A's intimate knowledge of the South Florida community and subsequent database of infrastructure surveys ensure that their surveying and mapping approach and methodology will result in accurate data collection and storage.

K&A is qualified to provide the following Surveying and Mapping, GIS and Subsurface Utility Locating (SUE) services:

- Boundary/Alta Surveys
- Topographic Surveys
- As-Built Surveys
- Platting
- Tree Surveys
- Cross-Sections & Profiles
- Control Surveys
- Wetland/Mitigation Surveys
- Construction Surveys
- Drainage Surveys
- Engineering Design Surveys
- Global Positioning Systems (GPS)
- Differential Leveling
- Geographic Information System (GIS)
- Right-of-Way Mapping
- Monumentation of Right-of-Way
- Digital Terrain Models (DTM)
- Hydrographic/Bathymetric Surveys

CAM 17-0337

EXHIBIT 2

Page 60/92

- Specific Purpose Surveys
- Photogrammetric Control Surveys
- Legal Descriptions
- Expert Witness Testimony
- 3D underground imaging
- Utility coordination
- Utility design
- Ground penetrating radar
- Computer aided design & drafting (CADD)
- Pipe and cable location
- Vacuum excavation
- Pavement coring

*Key Contact:* Lee Powers, PSM

*Address:* 301 East Atlantic Boulevard  
Pompano Beach, FL 33060

*Designation:* Disadvantaged Business Enterprise in the State of Florida

## Tierra South Florida – Geotechnical Services

Tierra South Florida, Inc. (TSF) is a full service consulting geotechnical and construction materials testing engineering firm with capabilities to provide test borings, engineering analyses and reports, AutoCAD and Microstation plan sheets, laboratory soils testing, and construction materials testing. TSF's professional team has been working together since 2000 and is committed to providing quality, responsive service establishing a reputation for sound approaches and professional competence in a wide range of technically demanding areas. Their services also include threshold/special inspection and roofing inspection services. TSF is a certified Disadvantaged Business Enterprise (DBE) with the Florida Department of Transportation. TSF is also a certified Minority Business Enterprise (MBE) with the State of Florida's Office of Supplier Diversity. TSF's main office is located in West Palm Beach, Florida with branch offices in Fort Lauderdale, Hialeah Gardens, and Winter Park, Florida. The list below illustrates airports where TSF has provided geotechnical and construction material testing services:



- Fort Lauderdale-Hollywood International Airport (FLL), Broward County, FL
- North Perry Airport (HWO), Broward County, FL
- Fort Lauderdale Executive Airport (FXE), Broward County, FL
- Pompano Beach Airpark (PMP), Broward County, FL
- Witham Field Airport (SUA), Martin County, FL
- North Palm Beach County General Aviation Airport (F45), Palm Beach County, FL
- Florida Keys Marathon Airport, Monroe County, FL
- Palm Beach County Glades Airport (PHK), Palm Beach County, FL
- Valkaria Airport (X59), Brevard County, FL
- Vero Beach Airport, Indian River County, FL
- Big Cypress Airfield, Collier County, FL
- Kendall-Tamiami Executive Airport (TMB), Miami-Dade County, FL
- Palm Beach International Airport (PBI), Palm Beach County, FL
- Lantana Airport (LNA), Palm Beach County, FL
- Naval Air Facility, Monroe County, FL
- St. Lucie County International Airport (FPR), St. Lucie County, FL
- Boca Raton Airport (BCT), Palm Beach County, FL
- Key West International Airport, Monroe County, FL

*Key Contact:* Raj Krishnasamy, P.E.

*Address:* 2765 Vista Parkway, Suite 9  
West Palm Beach, FL 33411

*Designation:* Disadvantaged Business Enterprise and Minority Business Enterprise in the State of Florida

## LICENSES/CERTIFICATIONS

### EG Solutions, Inc.

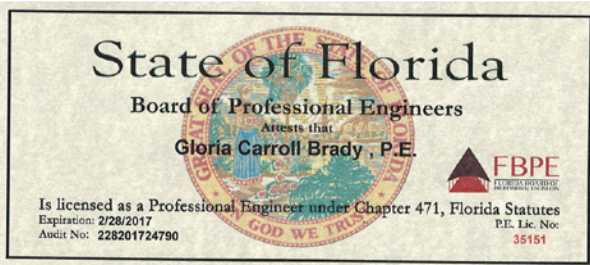

### Tierra South Florida



### Keith and Associates

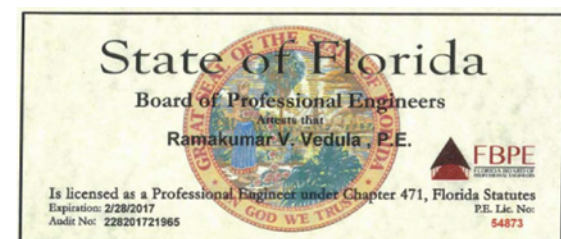
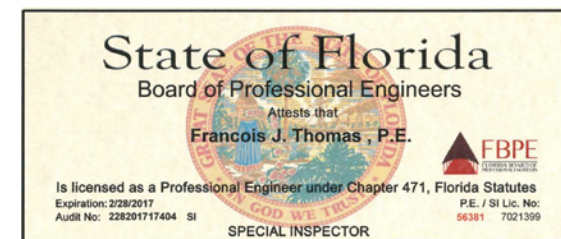
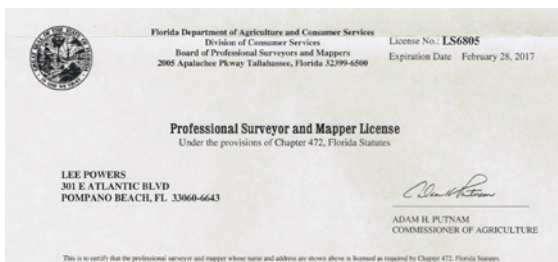
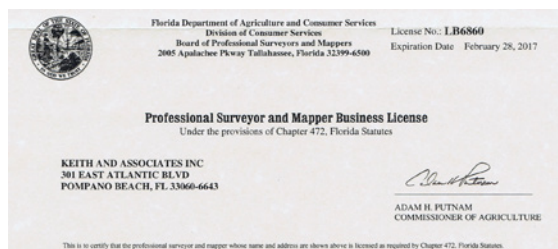

CAM 17-0337

EXHIBIT 2

Page 33 of 32



# FXE

## Master Drainage/Conceptual Environmental Resources Permit RFQ 276-11831

### 9 REQUIRED FORMS

- Statement of Qualification Certification
- Non-Collusion Statement
- Local Business Preference Certification Statement
- Contract Payment Method
- Sample Insurance Certificate
- Certificate of Secretary Signing Authority





City of Fort Lauderdale  
FXE Master Drainage / Conceptual Environmental Resources Permit  
RFQ Number #266-11831

### STATEMENT OF QUALIFICATION CERTIFICATION

**Please Note:** All fields below must be completed. If the field does not apply to you, please note N/A in that field.

If you are a foreign corporation, you may be required to obtain a certificate of authority from the department of state, in accordance with Florida Statute §607.1501 (visit <http://www.dos.state.fl.us/> ).

Company: (Legal Registration) Kimley-Horn and Associates, Inc.

Address: 600 North Pine Island Road, Suite 450

City: Plantation State: FL Zip: 33324

Telephone No. (954) 535-5100 FAX No. (561) 863-8175 Email: michael.carey@kimley-horn.com

Does your firm qualify for MBE or WBE status: MBE N/A WBE N/A

**ADDENDUM ACKNOWLEDGEMENT** - Proposer acknowledges that the following addenda have been received and are included in the proposal:

<u>Addendum No.</u>	<u>Date Issued</u>	<u>Addendum No.</u>	<u>Date Issued</u>
<u>1</u>	<u>9/21/16</u>	<u>3</u>	<u>10/25/16</u>
<u>2</u>	<u>9/21/16</u>		

**VARIANCES:** State any variations to specifications, terms and conditions in the space provided below or reference in the space provided below all variances contained on other pages of bid, attachments or bid pages. No variations or exceptions by the Proposer will be deemed to be part of the bid submitted unless such variation or exception is listed and contained within the bid documents and referenced in the space provided below. If no statement is contained in the below space, it is hereby implied that your bid/proposal complies with the full scope of this solicitation. If this section does not apply to your bid, simply mark N/A. **If submitting your response electronically through BIDSINC you must click the exception link if any variation or exception is taken to the specifications, terms and conditions.**

Kimley-Horn requests that the Indemnification Language in Section 2.22 Indemnify/Hold Harmless on page 11 of the RFP and in Section 11.9 Indemnification of City on page 41 of the RFP be modified to comply with Florida Statute 728.08 for Professional Services.

The below signatory hereby agrees to furnish the following article(s) or services at the price(s) and terms stated subject to all instructions, conditions, specifications addenda, legal advertisement, and conditions contained in the bid/proposal. I have read all attachments including the specifications and fully understand what is required. By submitting this signed proposal I will accept a contract if approved by the City and such acceptance covers all terms, conditions, and specifications of this bid/proposal. The below signatory also hereby agrees, by virtue of submitting or attempting to submit a response, hereby agrees that in no event shall the City's liability for respondent's indirect, incidental, consequential, special or exemplary damages, expenses, or lost profits arising out of this competitive solicitation process, including but not limited to public advertisement, bid conferences, site visits, evaluations, oral presentations, or award proceedings exceed the amount of five hundred dollars (\$500.00). This limitation shall not apply to claims arising under any provision of indemnification or the City's protest ordinance contained in this competitive solicitation.

Submitted by:

Kevin Schanen, P.E.

Name (printed)

October 26, 2016

Date:

  
Signature

Vice President

Title

**NON-COLLUSION STATEMENT**

By signing this offer, the vendor/contractor certifies that this offer is made independently and *free* from collusion. Vendor shall disclose below any City of Fort Lauderdale, FL officer or employee, or any relative of any such officer or employee who is an officer or director of, or has a material interest in, the vendor's business, who is in a position to influence this procurement.

Any City of Fort Lauderdale, FL officer or employee who has any input into the writing of specifications or requirements, solicitation of offers, decision to award, evaluation of offers, or any other activity pertinent to this procurement is presumed, for purposes hereof, to be in a position to influence this procurement.

For purposes hereof, a person has a material interest if they directly or indirectly own more than 5 percent of the total assets or capital stock of any business entity, or if they otherwise stand to personally gain if the contract is awarded to this vendor.

In accordance with City of Fort Lauderdale, FL Policy and Standards Manual, 6.10.8.3,

3.3. City employees may not contract with the City through any corporation or business entity in which they or their immediate family members hold a controlling financial interest (e.g. ownership of five (5) percent or more).

3.4. Immediate family members (spouse, parents and children) are also prohibited from contracting with the City subject to the same general rules.

**Failure of a vendor to disclose any relationship described herein shall be reason for debarment in accordance with the provisions of the City Procurement Code.**

<u>NAME</u>	<u>RELATIONSHIPS</u>
None	

**In the event the vendor does not indicate any names, the City shall interpret this to mean that the vendor has indicated that no such relationships exist.**

### LOCAL BUSINESS PREFERENCE CERTIFICATION STATEMENT

The Business identified below certifies that it qualifies for the local BUSINESS preference classification as indicated herein, and further certifies and agrees that it will re-affirm it's local preference classification annually no later than thirty (30) calendar days prior to the anniversary of the date of a contract awarded pursuant to this ITB. Violation of the foregoing provision may result in contract termination.

- (1) \_\_\_\_\_ is a **Class A** Business as defined in City of Fort Lauderdale Ordinance No. C-12-04, Sec.2-199.2. A copy of the City of Fort Lauderdale current year Business Tax Receipt and a complete list of full-time employees and their addresses shall be provided within 10 calendar days of a formal request by the City.  
Business Name
- (2) \_\_\_\_\_ is a **Class B** Business as defined in the City of Fort Lauderdale Ordinance No. C-12-04, Sec.2-199.2. A copy of the Business Tax Receipt or a complete list of full-time employees and their addresses shall be provided within 10 calendar days of a formal request by the City.  
Business Name
- (3) Kimley-Horn and Associates, Inc. is a **Class C** Business as defined in the City of Fort Lauderdale Ordinance No. C-12-04, Sec.2-199.2. A copy of the Broward County Business Tax Receipt shall be provided within 10 calendar days of a formal request by the City.  
Business Name
- (4) \_\_\_\_\_ requests a **Conditional Class A** classification as defined in the City of Fort Lauderdale Ordinance No. C-12-04, Sec.2-199.2. Written certification of intent shall be provided within 10 calendar days of a formal request by the City.  
Business Name
- (5) \_\_\_\_\_ requests a **Conditional Class B** classification as defined in the City of Fort Lauderdale Ordinance No. C-12-04, Sec.2-199.2. Written certification of intent shall be provided within 10 calendar days of a formal request by the City.  
Business Name
- (6) \_\_\_\_\_ is considered a **Class D** Business as defined in the City of Fort Lauderdale Ordinance No. C-12-04, Sec.2-199.2. and does not qualify for Local Preference consideration.  
Business Name

BIDDER'S COMPANY: Kimley-Horn and Associates, Inc.

AUTHORIZED COMPANY PERSON: Marcia Feldman Marcia Feldman October 26, 2016  
NAME SIGNATURE DATE

City of Fort Lauderdale  
FXE Master Drainage / Conceptual Environmental Resources Permit  
RFQ Number #276-11831

**CONTRACT PAYMENT METHOD BY P-CARD**

The City of Fort Lauderdale has implemented a Procurement Card (P-Card) program which changes how payments are remitted to its vendors. The City has transitioned from traditional paper checks to payment by credit card via MasterCard or Visa. This allows you as a vendor of the City of Fort Lauderdale to receive your payment fast and safely. No more waiting for checks to be printed and mailed.

In accordance with Article 7, item 7.4.3 of the consultant agreement attached herein, payments for all services will be made utilizing the City's P-Card program (MasterCard or Visa). Accordingly, firms must presently have the ability to accept credit card payment or take whatever steps necessary to implement acceptance of a credit card before the commencement of the agreement.

Please indicate with which credit card you prefer to be paid:

  X   Master Card

  X   Visa Card

Company Name: Kimley-Horn and Associates, Inc.

Kevin Schanen, P.E.  
Name (printed)

  
Signature

October 26, 2016  
Date:

Vice President  
Title



Client#: 25320

KIMLHORN

ACORD™

# CERTIFICATE OF LIABILITY INSURANCE

DATE (MM/DD/YYYY)  
3/28/2016

THIS CERTIFICATE IS ISSUED AS A MATTER OF INFORMATION ONLY AND CONFERS NO RIGHTS UPON THE CERTIFICATE HOLDER. THIS CERTIFICATE DOES NOT AFFIRMATIVELY OR NEGATIVELY AMEND, EXTEND OR ALTER THE COVERAGE AFFORDED BY THE POLICIES BELOW. THIS CERTIFICATE OF INSURANCE DOES NOT CONSTITUTE A CONTRACT BETWEEN THE ISSUING INSURER(S), AUTHORIZED REPRESENTATIVE OR PRODUCER, AND THE CERTIFICATE HOLDER.

IMPORTANT: If the certificate holder is an ADDITIONAL INSURED, the policy(ies) must be endorsed. If SUBROGATION IS WAIVED, subject to the terms and conditions of the policy, certain policies may require an endorsement. A statement on this certificate does not confer rights to the certificate holder in lieu of such endorsement(s).

<b>PRODUCER</b> <b>Greyling Ins. Brokerage/EPIC</b> <b>3780 Mansell Road, Suite 370</b> <b>Alpharetta, GA 30022</b> <b>877 908-5619</b>		<b>CONTACT NAME:</b> Jerry Noyola <b>PHONE (A/C, No, Ext):</b> 770-552-4225 <b>FAX (A/C, No):</b> 866-550-4082 <b>E-MAIL ADDRESS:</b> jerry.noyola@greyling.com															
<b>INSURED</b> <b>Kimley-Horn and Associates, Inc.</b> <b>P.O. Box 33068</b> <b>Raleigh, NC 27636</b>		<table border="1"> <thead> <tr> <th>INSURER(S) AFFORDING COVERAGE</th> <th>NAIC #</th> </tr> </thead> <tbody> <tr> <td>INSURER A : National Union Fire Ins. Co.</td> <td>19445</td> </tr> <tr> <td>INSURER B : Commerce &amp; Industry Ins. Co.</td> <td>19410</td> </tr> <tr> <td>INSURER C : New Hampshire Ins. Co.</td> <td>23841</td> </tr> <tr> <td>INSURER D : Lloyds of London</td> <td>085202</td> </tr> <tr> <td>INSURER E :</td> <td></td> </tr> <tr> <td>INSURER F :</td> <td></td> </tr> </tbody> </table>		INSURER(S) AFFORDING COVERAGE	NAIC #	INSURER A : National Union Fire Ins. Co.	19445	INSURER B : Commerce & Industry Ins. Co.	19410	INSURER C : New Hampshire Ins. Co.	23841	INSURER D : Lloyds of London	085202	INSURER E :		INSURER F :	
INSURER(S) AFFORDING COVERAGE	NAIC #																
INSURER A : National Union Fire Ins. Co.	19445																
INSURER B : Commerce & Industry Ins. Co.	19410																
INSURER C : New Hampshire Ins. Co.	23841																
INSURER D : Lloyds of London	085202																
INSURER E :																	
INSURER F :																	

## COVERAGES

CERTIFICATE NUMBER: 16-17

REVISION NUMBER:

THIS IS TO CERTIFY THAT THE POLICIES OF INSURANCE LISTED BELOW HAVE BEEN ISSUED TO THE INSURED NAMED ABOVE FOR THE POLICY PERIOD INDICATED. NOTWITHSTANDING ANY REQUIREMENT, TERM OR CONDITION OF ANY CONTRACT OR OTHER DOCUMENT WITH RESPECT TO WHICH THIS CERTIFICATE MAY BE ISSUED OR MAY PERTAIN, THE INSURANCE AFFORDED BY THE POLICIES DESCRIBED HEREIN IS SUBJECT TO ALL THE TERMS, EXCLUSIONS AND CONDITIONS OF SUCH POLICIES. LIMITS SHOWN MAY HAVE BEEN REDUCED BY PAID CLAIMS.

INSR LTR	TYPE OF INSURANCE	ADDL SUBR INSR WVD	POLICY NUMBER	POLICY EFF (MM/DD/YYYY)	POLICY EXP (MM/DD/YYYY)	LIMITS
A	<input checked="" type="checkbox"/> COMMERCIAL GENERAL LIABILITY <input type="checkbox"/> CLAIMS-MADE <input checked="" type="checkbox"/> OCCUR <input checked="" type="checkbox"/> Contractual Liab.  GEN'L AGGREGATE LIMIT APPLIES PER: <input type="checkbox"/> POLICY <input checked="" type="checkbox"/> PRO-JECT <input checked="" type="checkbox"/> LOC <input type="checkbox"/> OTHER:		5268169	04/01/2016	04/01/2017	EACH OCCURRENCE \$1,000,000 DAMAGE TO RENTED PREMISES (Ea occurrence) \$500,000 MED EXP (Any one person) \$25,000 PERSONAL & ADV INJURY \$1,000,000 GENERAL AGGREGATE \$2,000,000 PRODUCTS - COM/OP AGG \$2,000,000 \$
A	AUTOMOBILE LIABILITY <input checked="" type="checkbox"/> ANY AUTO <input type="checkbox"/> ALL OWNED AUTOS <input type="checkbox"/> SCHEDULED AUTOS <input checked="" type="checkbox"/> HIRED AUTOS <input checked="" type="checkbox"/> NON-OWNED AUTOS		4489663	04/01/2016	04/01/2017	COMBINED SINGLE LIMIT (Ea accident) \$1,000,000 BODILY INJURY (Per person) \$ BODILY INJURY (Per accident) \$ PROPERTY DAMAGE (Per accident) \$ \$
B	<input checked="" type="checkbox"/> UMBRELLA LIAB <input checked="" type="checkbox"/> OCCUR <input type="checkbox"/> EXCESS LIAB <input type="checkbox"/> CLAIMS-MADE <input type="checkbox"/> DED <input checked="" type="checkbox"/> RETENTION \$10,000		BE013778306	04/01/2016	04/01/2017	EACH OCCURRENCE \$5,000,000 AGGREGATE \$5,000,000 \$
C	WORKERS COMPENSATION AND EMPLOYERS' LIABILITY ANY PROPRIETOR/PARTNER/EXECUTIVE OFFICER/MEMBER EXCLUDED? <input type="checkbox"/> Y <input checked="" type="checkbox"/> N (Mandatory in NH) If yes, describe under DESCRIPTION OF OPERATIONS below	N/A	15893685 (AOS)	04/01/2016	04/01/2017	<input checked="" type="checkbox"/> PER STATUTE <input type="checkbox"/> OTH-ER E.L. EACH ACCIDENT \$1,000,000 E.L. DISEASE - EA EMPLOYEE \$1,000,000 E.L. DISEASE - POLICY LIMIT \$1,000,000
A	Professional Liab If yes, describe under DESCRIPTION OF OPERATIONS below		15893686 (CA)	04/01/2016	04/01/2017	E.L. DISEASE - POLICY LIMIT \$1,000,000
D	Professional Liab		P070831600	04/01/2016	04/01/2017	Per Claim \$2,000,000 Aggregate \$2,000,000

DESCRIPTION OF OPERATIONS / LOCATIONS / VEHICLES (ACORD 101, Additional Remarks Schedule, may be attached if more space is required)

## CERTIFICATE HOLDER

Proof of Insurance/For Proposal Only

## CANCELLATION

SHOULD ANY OF THE ABOVE DESCRIBED POLICIES BE CANCELLED BEFORE THE EXPIRATION DATE THEREOF, NOTICE WILL BE DELIVERED IN ACCORDANCE WITH THE POLICY PROVISIONS.

AUTHORIZED REPRESENTATIVE



© 1988-2014 ACORD CORPORATION. All rights reserved.

ACORD 25 (2014/01) 1 of 1 The ACORD name and logo are registered marks of ACORD  
#S464265/M461305

CUND1

CAM 17-0337

EXHIBIT 2

**Kimley-Horn and Associates, Inc.**  
**FULL CONTRACT SIGNING AUTHORITY**  
**December 17, 2015**

**CALIFORNIA**

**LOS ANGELES DT**

Blume, Robert D.  
Phaneuf, Alyssa S.

**LOS ANGELES SFV**

Fares, Jean B.

**OAKLAND**

Dankberg, Adam J.  
Durrenberger, Randal R.

**ORANGE**

Adrian, Darren J.  
Ciandella, Serine A.  
Fares, George B.  
Hourigan, E. Vincent  
Kerry, Nicole M.  
Matson, Jason B.  
Phillips, Chad E.

**PLEASANTON**

Mowery, Michael C.  
Sowers, Brian E.

**SACRAMENTO**

Coppin, Thomas G.  
Melvin, Enda  
Squires, Christopher A.

**SAN DIEGO**

Barlow, Matthew T.  
Harry, Jennifer L.  
Kaltsas, Joseph D.  
Knapton, Michael J.  
Landaal, Dennis J.  
Podegracz, Anthony J.  
Ross, Michael S.

**SAN JOSE**

Hedayat, Leyla  
Venter Frederik J.

**FLORIDA**

**BOCA-DELRAY**

Schwartz, Michael F.  
Webber, Jason A.

**CORAL GABLES**

Fernandez, Jorge L.

**FORT LAUDERDALE**

Alam, Mudassar M.  
Barnes, Roy R.  
Capelli, Jill A.  
Kyle, Gregory S.  
Ratay, Gary R.  
Saxena, K.K.

**JACKSONVILLE**

Mecca, Joseph P.  
Roland, George E.

**LAKELAND**

Bulloch, Kelly B.  
Wilson, Mark E.

**MIAMI**

Baldo, Burt L.  
Buchler, Aaron E.

**OCALA**

Bryant, M. Lewis  
Busche, Richard V.

**ORLANDO**

Chau, Hao T.  
Jackson, Jay R.  
Martin, Jonathan A.  
Mingonet, Milton S.  
Thigpen, Jonathan D.

**SARASOTA**

Nadeau, Gary J.  
Schmid, Seth E.  
Stovall, Thomas M.

**TALLAHASSEE**

Barr, Richard R.  
Sewell, Jon S.

**TAMPA**

Campbell, David C.  
Gilner, Scott W.  
White, Wayne E.

**VERO BEACH**

Cave, Derrick B.  
Good, Brian A.  
Peed, Brooks H.  
Roberson, Kevin M.

**WEST PALM BEACH**

Atz, John C.  
Bardt, David R.  
Cherry, Paul L.  
Ingram, Jerry W.  
Jackson, Kenneth W.  
Mufleh, Marwan H.  
Rapp, Bryan T.  
Schanen, Kevin M.  
Sumislaski, James M.  
Walthall, David W.

**MID-AMERICA**

**CHICAGO**

**DOWNTOWN**

Dvorak, Jr., William E.  
Morton, Jr., Arthur J.

**CHICAGO**

**SUBURBAN**

Antony, Dean M.

**NEW YORK**

Nejad, Anush A.

**NORTHERN VIRGINIA**

Barber, Christopher G.  
Chavers, James T.  
Lefton, Steven E.  
Martin, Robert J.  
Murphy, Terence T.  
Sauro, Thomas J.  
Whyte, Richard D.  
Yarnal, Brian D.

**RICHMOND**

Brewer, Brian J.  
White, Timothy E.

**TWIN CITIES**

Bishop, Mark C.  
Danielson, Paul B.  
Horn, Jon B.  
Leverett, Christopher C.  
Smalkoski, Brian R.

**VIRGINIA BEACH**

Carter, Erica V.  
Mackey, William F.  
Marscheider, Edward A.  
Nash, William A.  
Tewksbury, Carl F.

**MOUNTAIN**

**DENVER**

Colvin, Scott W.  
Phelps, Randall J.  
Rowe, Curtis D.  
Salvagio, Robin

**LAS VEGAS**

Ackeret, Kenneth W.  
Colety, Michael D.

**MESA**

Margetts, Sterling T.  
Marin, Laura S.

**PHOENIX**

Conrad, John R.  
Hermann, Michael J.  
Kissinger, John C.  
Leistiko, David J.  
Mutti, Brent H.  
Noon, Lisa K.  
Omais, Ahmad A.  
Pretorius, Petrus S.  
Purtle, Vicki L.  
Schiller, Michael G.  
Walnum, Nathan C.

**TUCSON**

Crowther, Brent C.

**SOUTHEAST**

**ALPHARETTA**

Fanney, Lawson H.

**ATLANTA**

Rushing, Michael L.  
Walker, John D.  
Wilson, Deborah L.

**ATLANTA MIDTOWN**

Fink, Kenneth L.  
Meador, Emily H.  
Montanye, Emmeline F.  
Ross, Robert A.  
Stricklin, David L.  
Webb, Floyd C.

**CARY**

Adams, Richard C.  
Barber, Barry L.  
Byrd, Michael N.  
Cook, Richard N.  
Deans, Neil T.  
Dunzo, Mark W.  
Flanagan, Tammy L.  
McEntee, David L.  
Nuckols, Charles A.  
Rohrbaugh, Richard R.  
Venters, Samantha  
Voisin, William J.  
Wilson, Jon E.  
Wilson, Mark S.

**CHARLOTTE**

Blakley, Jr., Stephen W.  
Edwards, Matthew A.  
Hume, Robert M.  
Wilhelm, William R.

**MEMPHIS**

Collins, James F.  
Danley, Drake E.

**NASHVILLE**

Benditz, John F.  
Rhodes, Christopher D.

**RALEIGH-DOWNTOWN**

Burchett, Thomas F.  
Penny, H.D.

**TEXAS**

**AUSTIN**

Boecker, Brian C.  
Van Leeuwen, Andrew

**DALLAS**

Burns, Gregory B.  
Hall, James R.  
Henigsmann, Dean A.  
Hoppers, Kevin P.  
Nathan, Aaron W.  
Smith, Eric Z.  
Swindler, Roderick P.  
Wilshire, Roy L.

**FORT WORTH**

Arnold, Scott R.  
Gary, Glenn A.  
James, Jeffery

**FRISCO**

Brignon, Brit A.  
McCracken, Paul D.

**HOUSTON**

Frysinger, Chris V.  
Guillory, Michael B.

**LAS COLINAS**

Tribble, Guy B.  
Warren, Loy F.