

OUTBOARD PROFILE VIEW

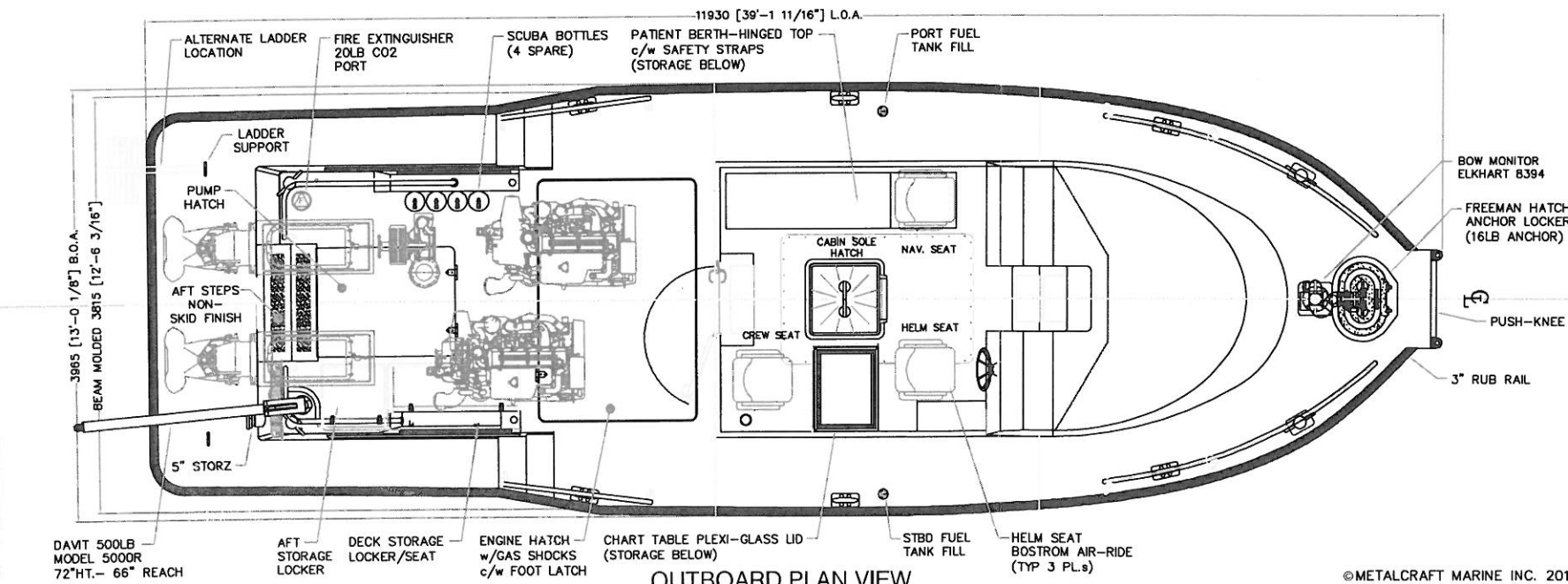

OUTBOARD PLAN VIEW

**VESSEL PARTICULARS:**

LOA: 11.9M (39'-2")  
BEAM MAXIMUM 3.96M (13')  
LENGTH MOULDED 10.8M (35'-6")  
BEAM MOULDED 3.82M (12'-6 1/2")  
DEADRISE: 18"  
PROPULSION  
MAIN ENGINES: (2) CUMMINS 5.9L-480HP@3400  
WATER JETS: (2) HJ292  
FIRE SYSTEM  
PUMP: HALE 3000GPM

Note :Some optional items may be shown.

ZONE	REV.	DESCRIPTION	DATE	APPROVED
REVISIONS				
"THIS DRAWING CONTAINS PROPRIETARY AND CONFIDENTIAL INFORMATION OF METALCRAFT MARINE INC. AND IS LOANED IN CONFIDENCE WITH THE UNDERSTANDING THAT IT WILL NOT BE REPRODUCED NOR USED IN ANY MANNER WHATSOEVER DETRIMENTAL TO THE BEST INTEREST OF METALCRAFT MARINE INC. AND SHALL BE RETURNED ON DEMAND."				
DRAWN BY: RM		DATE: 2012-06-20		
CHECKED BY:		DATE:		
APPROVED BY:		DATE:		
CONTRACT NO:		MetalCraft Marine 347 Wellington St., Kingston, Ont., Canada PHONE: (613) 342-1810 FAX: (613) 342-6313		
SOLICIT NO:		CITY OF CHARLESTON FD GENERAL ARRANGEMENT		
REQUEST NO:		SCALE: 1:50 JOB NO: 536 SHEET 1 OF 2		