

STATE OF FLORIDA
DEPARTMENT OF TRANSPORTATION

CONTRACT PLANS

FINANCIAL PROJECT ID 433688-4-C2-01

BROWARD COUNTY (86050)

STATE ROAD NO. A1A

DUNE ENHANCEMENT PLANS

A DETAILED INDEX APPEARS ON THE
KEY SHEET OF EACH COMPONENT

INDEX OF DUNE ENHANCEMENT PLANS

SHEET NO.	SHEET DESCRIPTION
LD-1	KEYSHEET
LD-2	TABULATION OF QUANTITIES
LD-3	DUNE ENHANCEMENT NOTES
LD-4	DUNE ENHANCEMENT DETAILS
LD-5	SHEET LAYOUT
LD-6 TO LD-12	DUNE ENHANCEMENT PLAN
LD-13	TRAFFIC CONTROL PLAN GENERAL NOTES

GOVERNING STANDARDS AND SPECIFICATIONS:
FLORIDA DEPARTMENT OF TRANSPORTATION, 2015 DESIGN STANDARDS AND
REVISED INDEX DRAWINGS AS APPENDED HEREIN, AND 2015 STANDARD
SPECIFICATIONS FOR ROAD AND BRIDGE CONSTRUCTION, AS AMENDED BY
CONTRACT DOCUMENTS.

FOR DESIGN STANDARDS CLICK ON THE "DESIGN STANDARDS" LINK AT THE
FOLLOWING WEBSITE:
<http://www.dot.state.fl.us/rddesign>

FOR THE STANDARD SPECIFICATIONS FOR ROAD AND BRIDGE CONSTRUCTION
CLICK ON THE "SPECIFICATIONS" LINK AT THE
FOLLOWING WEBSITE:
<http://www.dot.state.fl.us/specificationsoffice>

REVISIONS

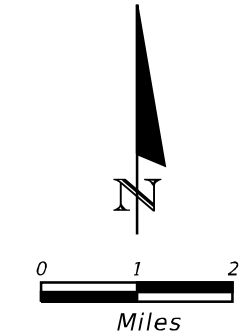
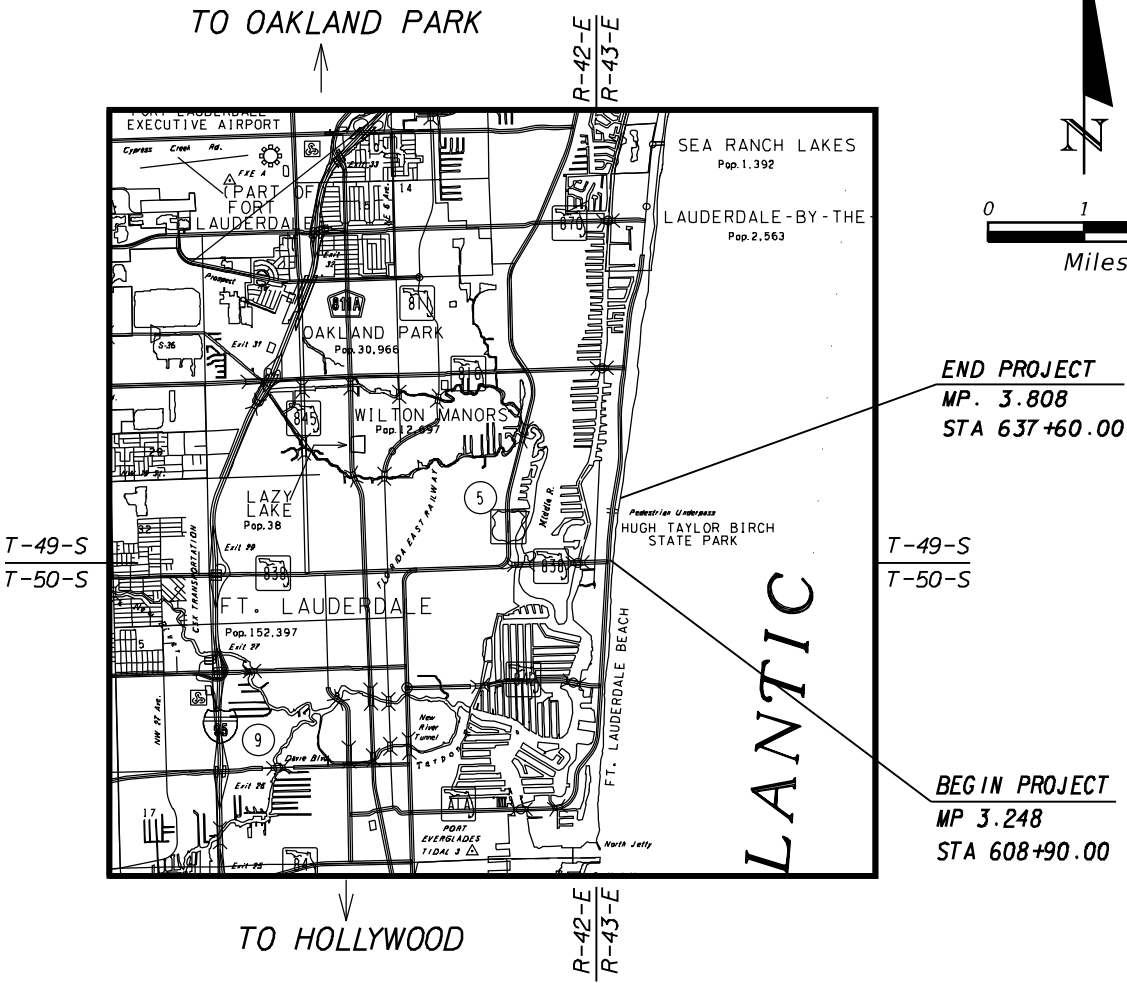

END PROJECT
MP. 3.808
STA 637+60.00

T-49-S
T-50-S

BEGIN PROJECT
MP 3.248
STA 608+90.00

KEY SHEET REVISIONS	
DATE	DESCRIPTION

LANDSCAPE PLANS
LANDSCAPE ARCHITECT CHERYL C. CALLENDER, R.L.A.
OF RECORD:

R.L.A. NO.: 6667177

FISCAL YEAR	SHEET NO.
15 CAM	LD-1 #15-1417

FDOT PROJECT MANAGER: SCOTT PETERSON, PE

CONSTRUCTION CONTRACT No.

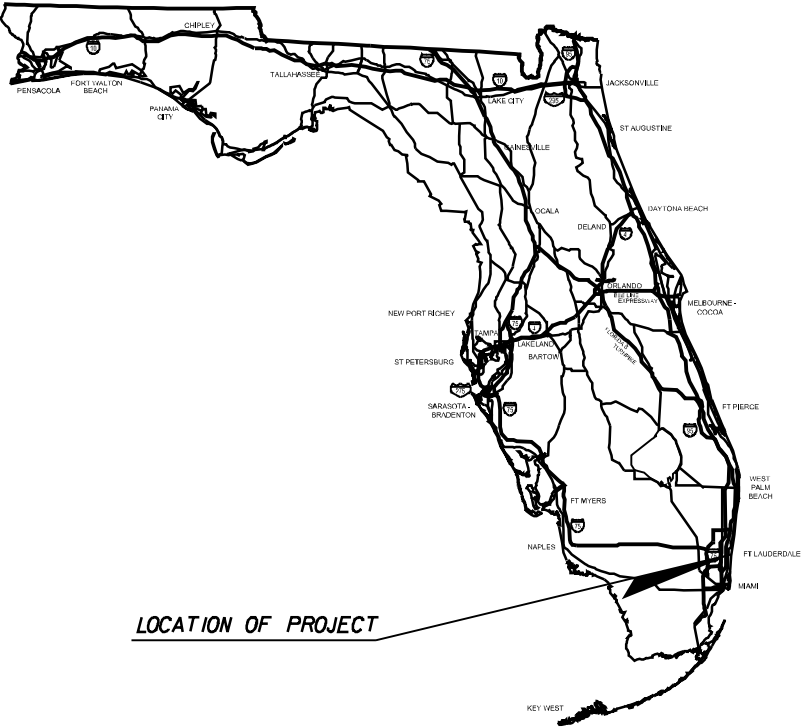

LOCATION OF PROJECT

LANDSCAPE SHOP DRAWINGS
TO BE SUBMITTED TO:

CHERYL C. CALLENDER, R.L.A.
KEITH AND SCHNARS, P.A.
6500 NORTH ANDREWS AVE
FT. LAUDERDALE, FL 33309
(954) 776-1616

PLANS PREPARED BY:

KEITH and SCHNARS, P.A.
6500 N. Andrews Ave.,
Ft. Lauderdale, FL. 33309-2132

CERTIFICATE OF AUTHORIZATION NO. 1337

VENDOR IDENTIFICATION NO. 59-1406-307
CONTRACT NO. C-9812

NOTE: THE SCALE OF THESE PLANS MAY
HAVE CHANGED DUE TO REPRODUCTION.

PERMIT PLAN SET
(SUBJECT TO CHANGE)

NOTICE: THE OFFICIAL RECORD OF THIS SHEET IS THE ELECTRONIC FILE SIGNED AND SEALED UNDER RULE 61G10-11.011, F.A.C.

SUMMARY OF QUANTITIES						
SYM	BOTANICAL NAME	COMMON NAME	MINIMUM INSTALLED SIZE	SPACING (INCHES)	UNIT	QTY
	GROUNDCOVER					
HD	HELIANTHUS DEBILIS	DUNE SUNFLOWER	LINERS	12	EA	730
IP	IPOMOEA PESCARPE	RAILROAD VINE	LINERS	12	EA	1343
IVI	IVA IMBRICATA	BEACH ELDER	LINERS	12	EA	2984
UP	UNIOLA PANICULATA	SEA OATS	LINERS	12	EA	13322
	BEACH SAND FOR DUNES				CY	439
	(Existing Beach Sand from Roadway Project)					
	or other DEP approved Source)					
	DUNE PROTECTION ROPE FENCE				LF	2570

REVISIONS						LANDSCAPE ARCHITECT OF RECORD: CHERYL C. CALLENDER, R.L.A. #0067177 CERTIFICATE OF AUTHORIZATION #1337 KEITH and SCHNARS, P.A. 6500 N. Andrews Ave, Ft. Lauderdale, FL. 33309-2132 (954)776-1616	STATE OF FLORIDA DEPARTMENT OF TRANSPORTATION			TABULATION OF QUANTITIES	SHEET NO.
DATE	BY	DESCRIPTION	DATE	BY	DESCRIPTION		ROAD NO.	COUNTY	FINANCIAL PROJECT ID		
							A/A	BROWARD	433688-4-C2-01		
									LD-2 CAM #15-1417		

DUNE LANDSCAPE NOTES

- 1) VERIFY SITE CONDITIONS AND ASSESS THE WORK REQUIRED BEFORE BIDDING.
- 2) ADDITIONAL REQUIREMENTS ARE SPECIFIED IN DEP PERMIT NUMBER BO-694.

R E V I S I O N S						LANDSCAPE ARCHITECT OF RECORD: CHERYL C. CALLENDER, R.L.A. #6667177 CERTIFICATE OF AUTHORIZATION #1337			STATE OF FLORIDA DEPARTMENT OF TRANSPORTATION			DUNE ENHACEMENT NOTES		SHEET NO.
DATE	BY	DESCRIPTION	DATE	BY	DESCRIPTION	KEITH and SCHNARS, P.A. 6500 N. Andrews Ave, Ft. Lauderdale, FL. 33309-2132 (954)776-1616			ROAD NO.	COUNTY	FINANCIAL PROJECT ID			
									A/A	BROWARD	433688-4-C2-01			

NOTICE: THE OFFICIAL RECORD OF THIS SHEET IS THE ELECTRONIC FILE SIGNED AND SEALED UNDER RULE 61G10, F.A.C.

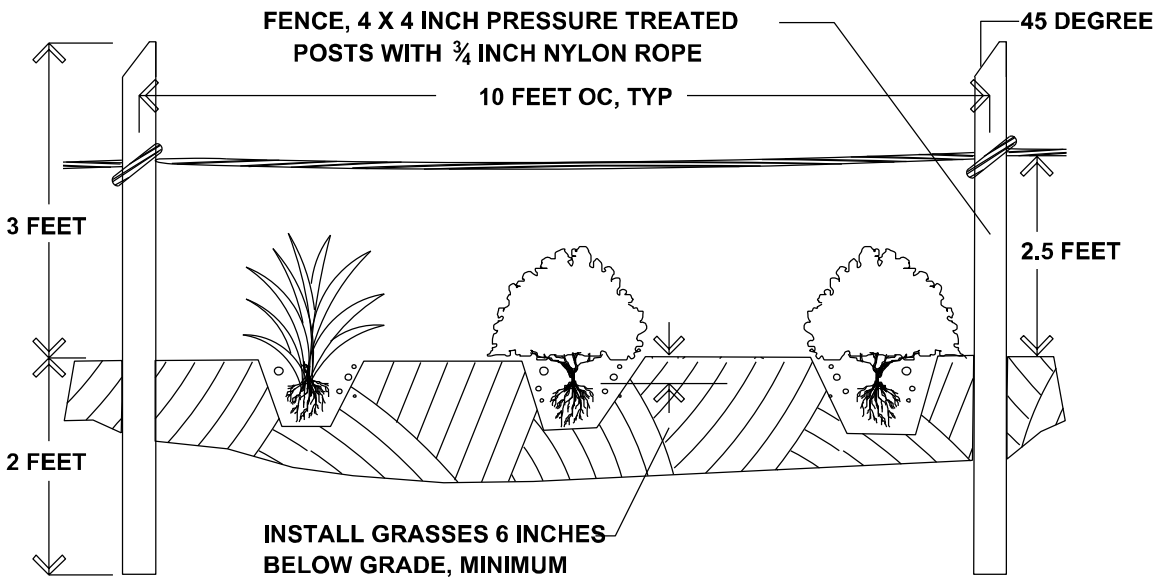

SHRUB AND FENCE INSTALLATION



ROPE INSTALLATION

R E V I S I O N S						LANDSCAPE ARCHITECT OF RECORD: CHERYL C. CALLENDER, R.L.A. #6667177 CERTIFICATE OF AUTHORIZATION #1337	STATE OF FLORIDA DEPARTMENT OF TRANSPORTATION			DUNE ENHANCEMENT DETAILS		SHEET NO.
DATE	BY	DESCRIPTION	DATE	BY	DESCRIPTION		ROAD NO.	COUNTY	FINANCIAL PROJECT ID			
							A/A	BROWARD	433688-4-C2-01			LD-4 #15-1417

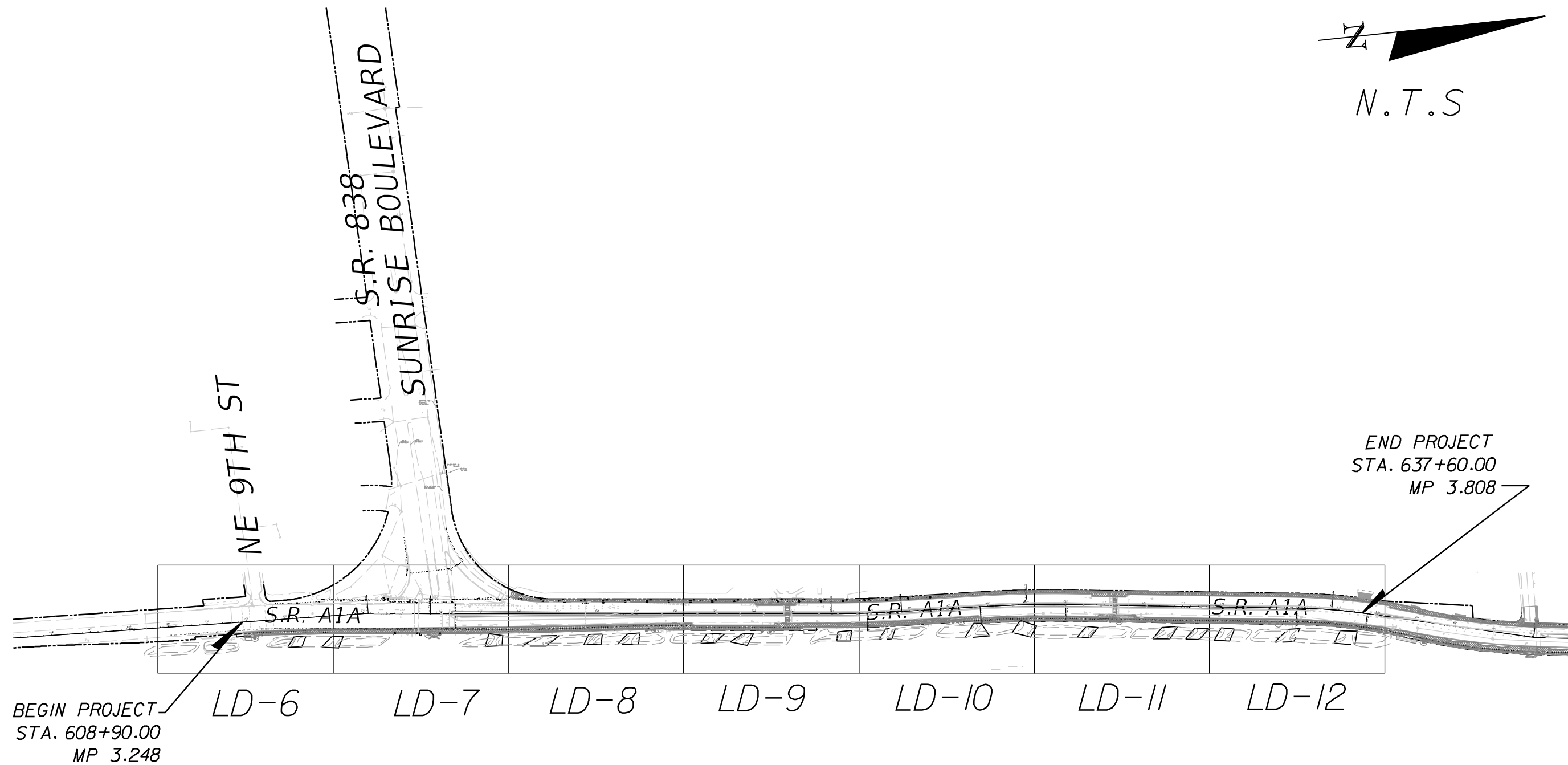

R E V I S I O N S						LANDSCAPE ARCHITECT OF RECORD, CHERYL C. CALLENDER, RLA #6667177 CERTIFICATE OF AUTHORIZATION #1337	STATE OF FLORIDA DEPARTMENT OF TRANSPORTATION			SHEET NO.
DATE	BY	DESCRIPTION	DATE	BY	DESCRIPTION		ROAD NO.	COUNTY	FINANCIAL PROJECT ID	
							A/A	BROWARD	433688-4-C2-01	
						KEITH and SCHNARS, P.A. 6500 N. Andrews Ave, Ft. Lauderdale, FL. 33309-2132 (954)776-1616				SHEET LAYOUT
										CAM #15-1417-5 Exhibit 3

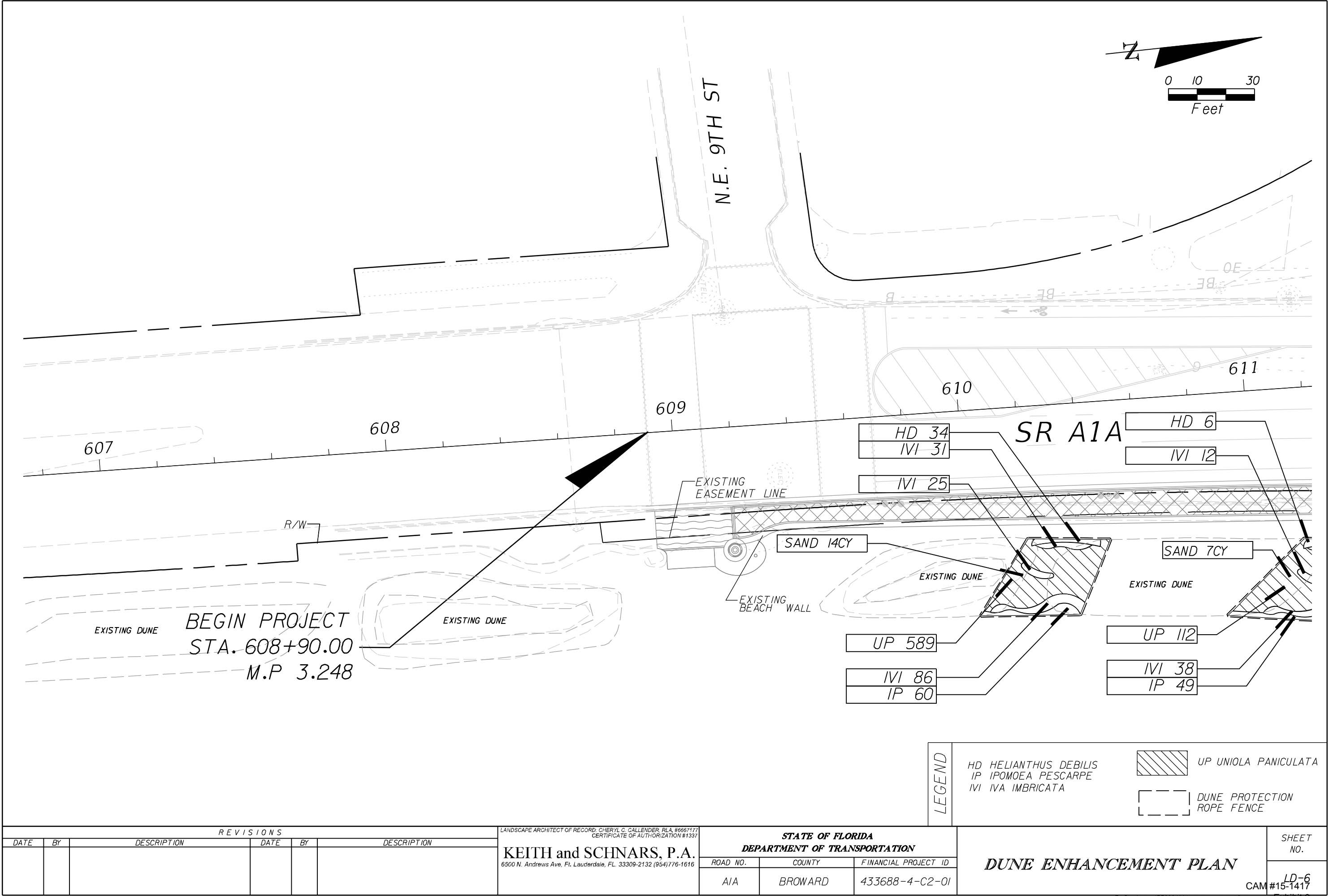

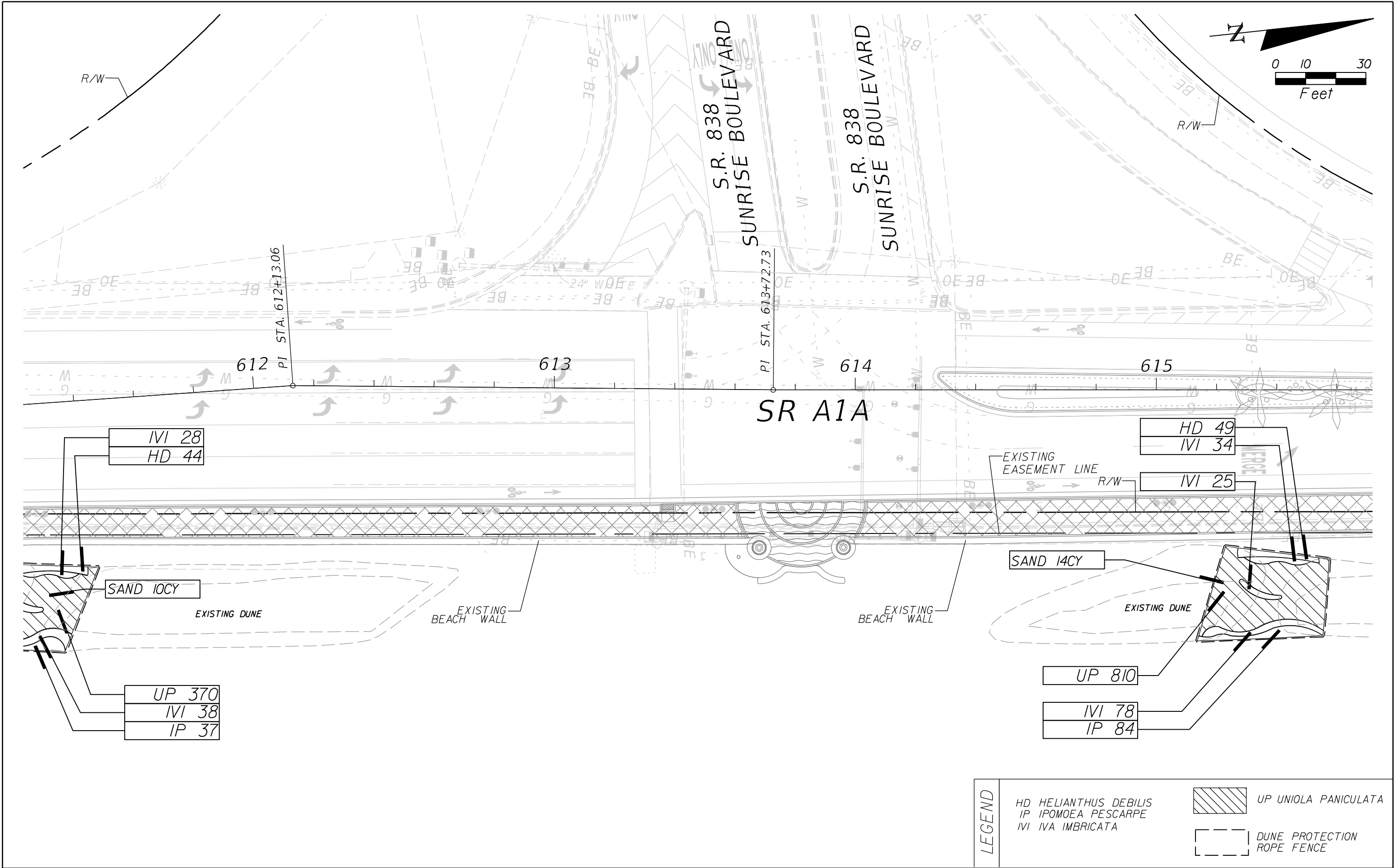

NOTICE: THE OFFICIAL RECORD OF THIS SHEET IS THE ELECTRONIC FILE SIGNED AND SEALED UNDER RULE 61G10, F.A.C.

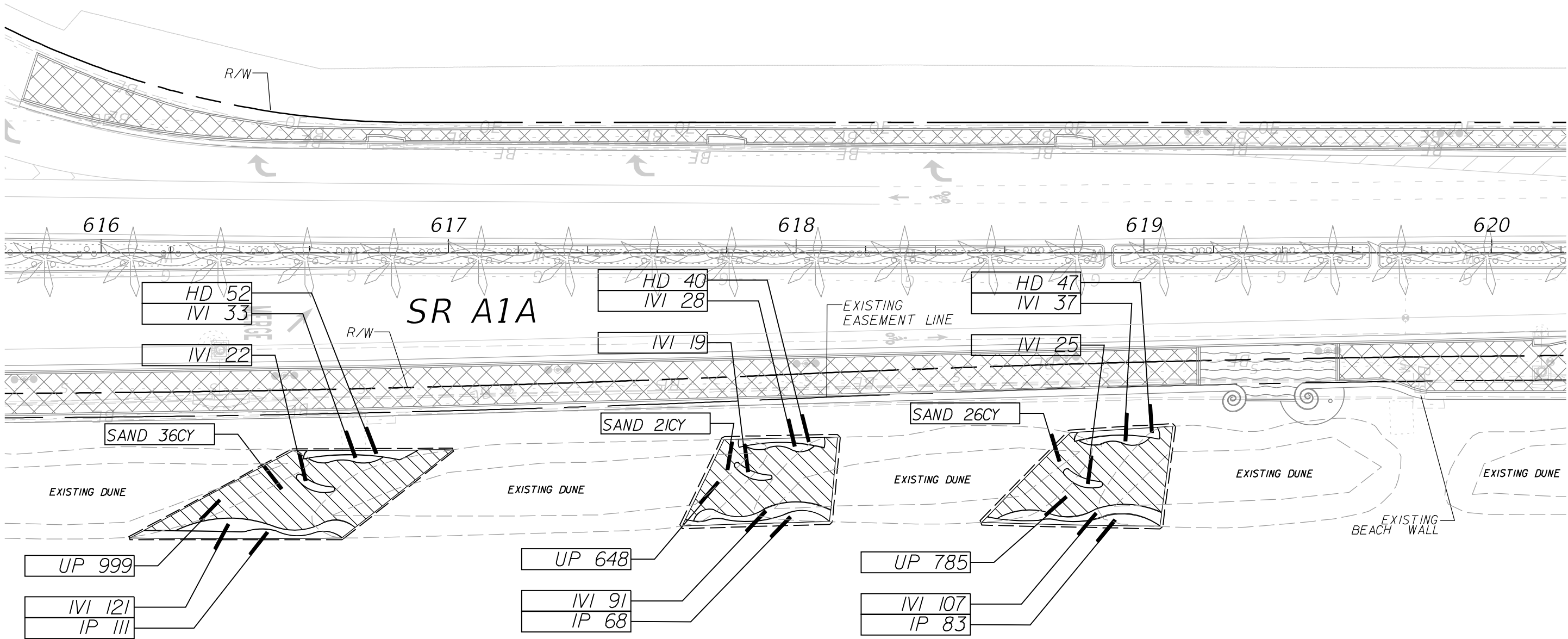
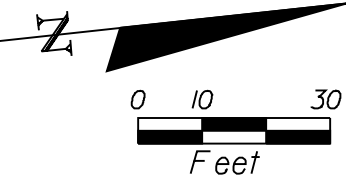

REVISIONS						LANDSCAPE ARCHITECT OF RECORD: CHERYL C. CALLENDER, R.L.A. #6967177 CERTIFICATE OF AUTHORIZATION #1337	STATE OF FLORIDA DEPARTMENT OF TRANSPORTATION			DUNE ENHANCEMENT PLAN	SHEET NO. LD-7
DATE	BY	DESCRIPTION	DATE	BY	DESCRIPTION		ROAD NO.	COUNTY	FINANCIAL PROJECT ID		
							A1A	BROWARD	433688-4-C2-01		

NOTICE: THE OFFICIAL RECORD OF THIS SHEET IS THE ELECTRONIC FILE SIGNED AND SEALED UNDER RULE 61G10, F.A.C.



LEGEND	HD HELIANTHUS DEBILIS IP IPOMOEA PESCARPE IVI IVA IMBRICATA	 UP UNIOLA PANICULATA
		 DUNE PROTECTION ROPE FENCE

REVISIONS					
DATE	BY	DESCRIPTION	DATE	BY	DESCRIPTION

LANDSCAPE ARCHITECT OF RECORD: CHERYL C. CALLENDER, R.L.A. #6667177
CERTIFICATE OF AUTHORIZATION #1337
KEITH and SCHNARS, P.A.
6500 N. Andrews Ave., Ft. Lauderdale, FL 33309-2132 (954) 776-1616

STATE OF FLORIDA DEPARTMENT OF TRANSPORTATION		
ROAD NO.	COUNTY	FINANCIAL PROJECT ID
A1A	BROWARD	433688-4-C2-01

DUNE ENHANCEMENT PLAN		SHEET NO.
CAM #15-1417		LD-8

NOTICE: THE OFFICIAL RECORD OF THIS SHEET IS THE ELECTRONIC FILE SIGNED AND SEALED UNDER RULE 61G10, F.A.C.

HUGH TAYLOR BIRCH
STATE PARK

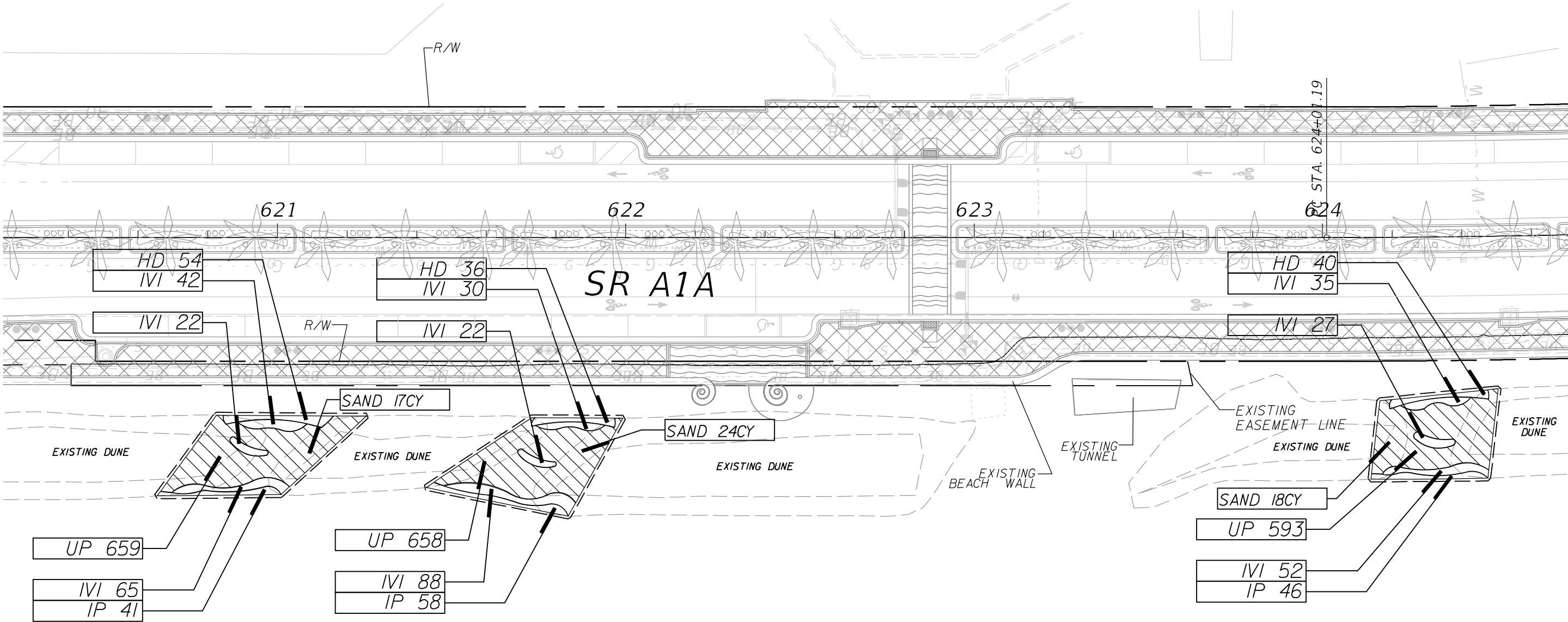
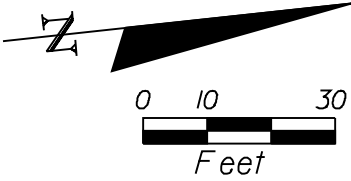

LEGEND	HD HELIANTHUS DEBILIS		UP UNIOLA PANICULATA
	IP IPOMOEA PESCARPE		
	IVI IVA IMBRICATA		
			DUNE PROTECTION ROPE FENCE

REVISIONS					
DATE	BY	DESCRIPTION	DATE	BY	DESCRIPTION

LANDSCAPE ARCHITECT OF RECORD: CHERYL C. CALLENDER, R.L.A. #6667177
CERTIFICATE OF AUTHORIZATION #1337
KEITH and SCHNARS, P.A.
6500 N. Andrews Ave., Ft. Lauderdale, FL 33309-2132 (954) 776-1616

STATE OF FLORIDA DEPARTMENT OF TRANSPORTATION		
ROAD NO.	COUNTY	FINANCIAL PROJECT ID
A1A	BROWARD	433688-4-C2-01

DUNE ENHANCEMENT PLAN		SHEET NO.
CAM #15-1417		LD-9

NOTICE: THE OFFICIAL RECORD OF THIS SHEET IS THE ELECTRONIC FILE SIGNED AND SEALED UNDER RULE 61G10, F.A.C.

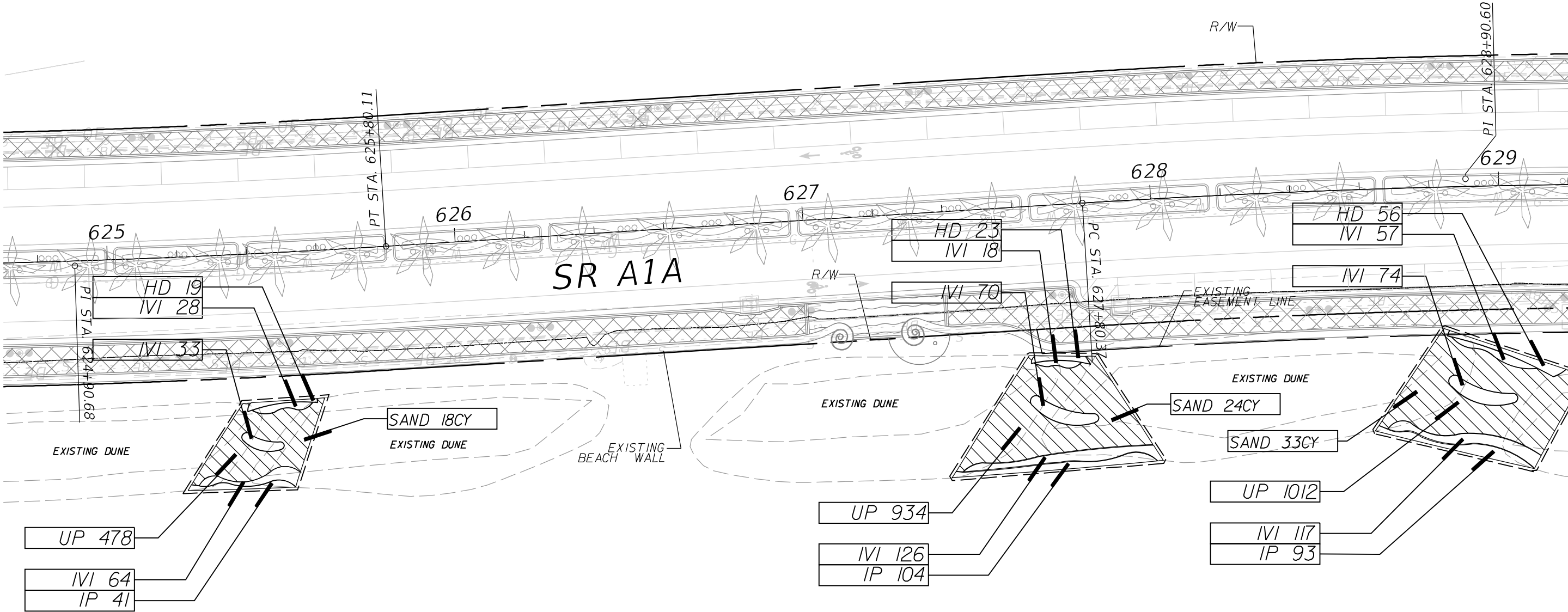
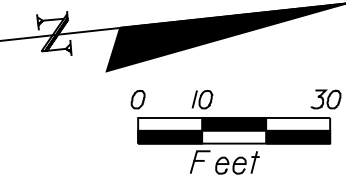

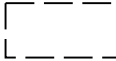
LEGEND	HD HELIANTHUS DEBILIS IP IPOMOEA PESCARPE IVI IVA IMBRICATA	 UP UNIOLA PANICULATA
		 DUNE PROTECTION ROPE FENCE

REVISIONS					
DATE	BY	DESCRIPTION	DATE	BY	DESCRIPTION

LANDSCAPE ARCHITECT OF RECORD: CHERYL C. CALLENDER, R.L.A. #6967177
CERTIFICATE OF AUTHORIZATION #1337
KEITH and SCHNARS, P.A.
6500 N. Andrews Ave., Ft. Lauderdale, FL. 33309-2132 (954) 776-1616

STATE OF FLORIDA DEPARTMENT OF TRANSPORTATION		
ROAD NO.	COUNTY	FINANCIAL PROJECT ID
A1A	BROWARD	433688-4-C2-01

DUNE ENHANCEMENT PLAN		SHEET NO.
LD-10 CAM #15-1417		10 of 13

NOTICE: THE OFFICIAL RECORD OF THIS SHEET IS THE ELECTRONIC FILE SIGNED AND SEALED UNDER RULE 61G10, F.A.C.

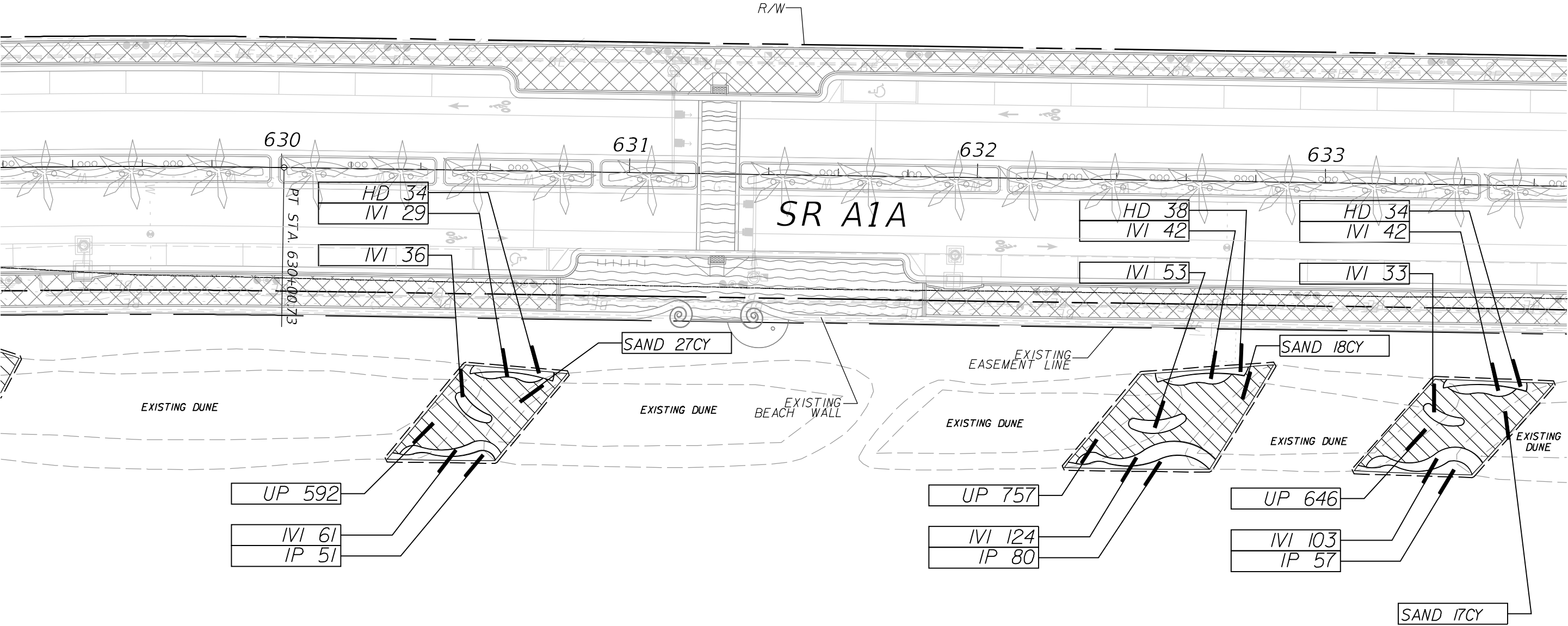
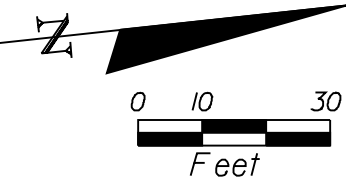

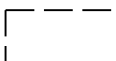
LEGEND	HD HELIANTHUS DEBILIS IP IPOMOEA PESCARPE IVI IVA IMBRICATA	 UP UNIOLA PANICULATA
		 DUNE PROTECTION ROPE FENCE

REVISIONS					
DATE	BY	DESCRIPTION	DATE	BY	DESCRIPTION

LANDSCAPE ARCHITECT OF RECORD: CHERYL C. CALLENDER, R.L.A. #6667177
CERTIFICATE OF AUTHORIZATION #1337
KEITH and SCHNARS, P.A.
6500 N. Andrews Ave., Ft. Lauderdale, FL. 33309-2132 (954)776-1616

STATE OF FLORIDA DEPARTMENT OF TRANSPORTATION		
ROAD NO.	COUNTY	FINANCIAL PROJECT ID
A1A	BROWARD	433688-4-C2-01

DUNE ENHANCEMENT PLAN		SHEET NO.
CAM #15-1417		LD-II

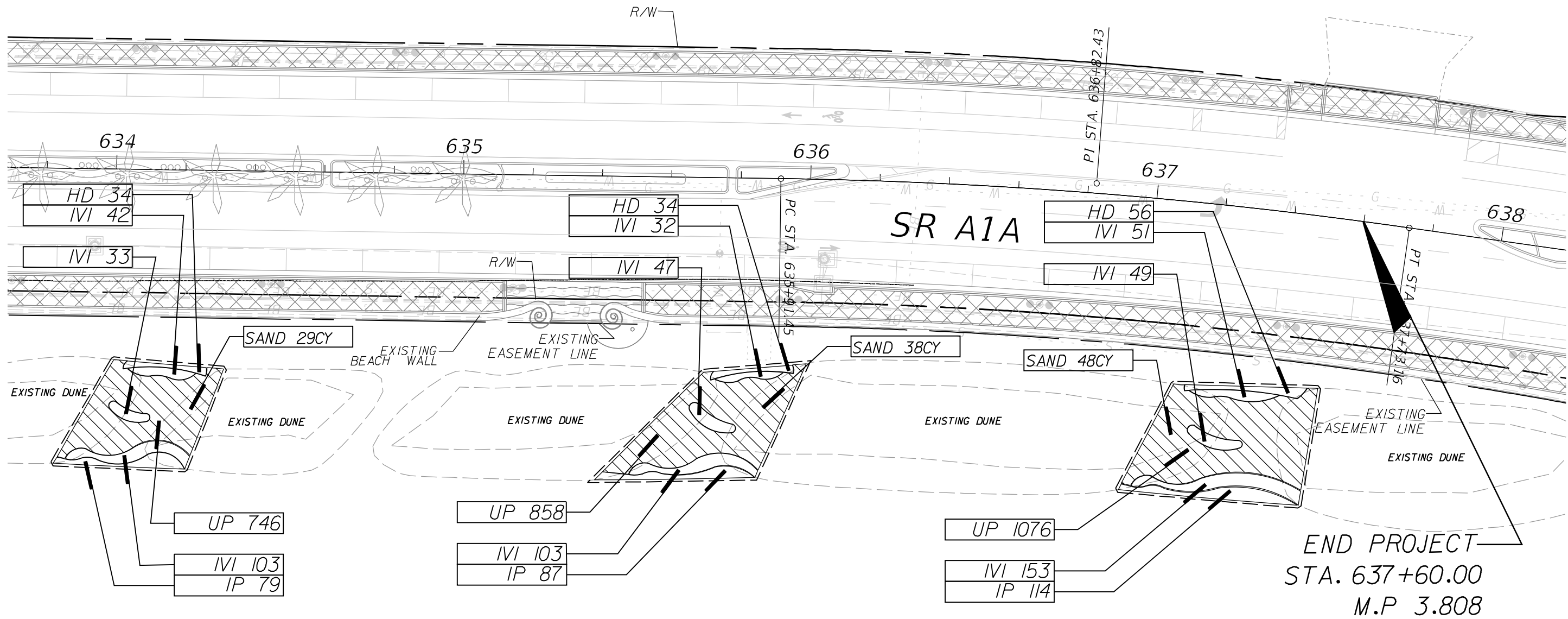
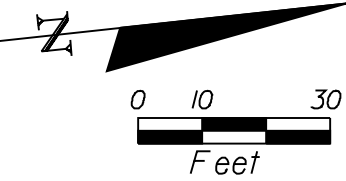

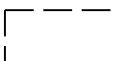
LEGEND	HD HELIANTHUS DEBILIS IP IPOMOEA PESCARPE IVI IVA IMBRICATA	 UP UNIOLA PANICULATA
		 DUNE PROTECTION ROPE FENCE

REVISIONS					
DATE	BY	DESCRIPTION	DATE	BY	DESCRIPTION

LANDSCAPE ARCHITECT OF RECORD: CHERYL C. CALLENDER, R.L.A. #6967177
CERTIFICATE OF AUTHORIZATION #1337
KEITH and SCHNARS, P.A.
6500 N. Andrews Ave., Ft. Lauderdale, FL 33309-2132 (954) 776-1616

STATE OF FLORIDA DEPARTMENT OF TRANSPORTATION		
ROAD NO.	COUNTY	FINANCIAL PROJECT ID
A1A	BROWARD	433688-4-C2-01

DUNE ENHANCEMENT PLAN		SHEET NO.
LD-12 CAM #15-1417		12 of 13

NOTICE: THE OFFICIAL RECORD OF THIS SHEET IS THE ELECTRONIC FILE SIGNED AND SEALED UNDER RULE 61G10, F.A.C.

1. REGULATORY SPEED IN AN ACTIVE WORK ZONE IS 25 MPH
2. PRIOR TO ANY LANE CLOSURE THE CONTRACTOR SHALL NOTIFY THE FDOT PROJECT ADMINISTRATOR AS WELL AS THE FDOT DISTRICT 4 PUBLIC INFORMATION OFFICERS AT LEAST 14 BUSINESS DAYS PRIOR TO CLOSURE. NOTIFY:

BARBARA KELLEHER, DISTRICT 4 PUBLIC INFORMATION OFFICER
FLORIDA DEPARTMENT OF TRANSPORTATION
3400 WEST COMMERCIAL BLVD.
FORT LAUDERDALE, FLORIDA 33309-3421
PHONE: (954) 777-4091

DAYANA IGLESIAS, BROWARD OPERATIONS PUBLIC INFORMATION OFFICER
FLORIDA DEPARTMENT OF TRANSPORTATION
5548 N.W. 9TH AVE,
FORT LAUDERDALE, FLORIDA 33309
PHONE: (954) 940-7585
3. THE CONTRACTOR SHALL NOT WORK EAST OF THE EXISTING ROADWAY FOOTPRINT WALL DURING TURTLE NESTING SEASON (MARCH TO OCTOBER) UNLESS SPECIFIC WORK ACITIVITIES ARE APPROVED BY THE ENGINEER AND THE PERMITTING AGENCIES.
4. THE CONTRACTOR SHALL ENTER THE BEACH ONLY THROUGH THE FOLLOWING APPROVED ENTRANCES:

NE 9TH STREET (STA. 609+00)
JUST SOUTH OF NE 14TH COURT (STA. 638+00)
THE ENTRANCE AT NE 18TH ST (STA. 665+00)
5. THE CONTRACTOR SHALL COORDINATE WITH THE CONTRACTOR FOR THE ROADWAY CONSTRUCTION PROJECT, 433688-4-52-01.
6. THE CONTRACTOR SHALL PROVIDE PORTABLE CHANGEABLE MESSAGE SIGNS (PCMS) IN ALL DIRECTIONS (FOR TRAFFIC DRIVING NORTH AND SOUTH ON A1A AND TRAFFIC DRIVING EAST ON SUNRISE) PRIOR TO CONSTRUCTION WITH DISPLAYS AS FOLLOWS, OR AS DIRECTED BY THE ENGINEER:

2 WEEKS PRIOR TO CONSTRUCTION

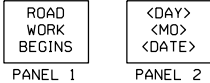

DURING CONSTRUCTION

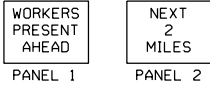

7. PROJECT INFORMATION SIGN PANELS SHALL BE FURNISHED BY THE CONTRACTOR IN ACCORDANCE WITH INDEX 600 SHEET 7 OF 13. THESE SIGNS SHALL BE POSTED WITH BLUE BACKGROUND AND WHITE LETTERING. PROJECT INFORMAION SIGNS SHALL BE INSTALLED SO AS TO BE VISIBLE ALONG EACH MAINLINE APPROACH. CONTRACTOR SHALL INSTALL THE SIGNS INCLUDING THE HARDWARE. SIGNS MAY BE REMOVED ONCE NO LONGER NEEDED AS DETERMINED BY THE ENGINEER. THE COST SHALL BE INLUDED IN PAY ITEM 102-1.

THE THREE (3) SIGNS SHALL BE LOCATED 500' BEFORE THE FIRST WARNING SIGN:

FACING NORTHBOUND ON A1A
FACING SOUTHBOUND ON A1A
FACING EASTBOUND ON SUNRISE BLVD

SIGN INFORMATOIN:

SR A1A
FALL 2015
(954) 777-4091

FOR ADDITIONAL INFORMAION, CONTACT:

BARBARA KELLEHER, DISTRICT 4 PUBLIC INFORMATION OFFICER
FLORIDA DEPARTMENT OF TRANSPORTATION
3400 WEST COMMERCIAL BLVD.
FORT LAUDERDALE, FLORIDA 33309
PHONE: (954) 777-4091

REVISIONS				ENGINEER OF RECORD: SCOTT PETERSON, P.E.	STATE OF FLORIDA DEPARTMENT OF TRANSPORTATION			TRAFFIC CONTROL PLAN GENERAL NOTES		SHEET NO.
DATE	DESCRIPTION	DATE	DESCRIPTION	P.E. LICENSE NUMBER 52740 FDOT DISTRICT IV 3400 WEST COMMERCIAL BLVD. FORT LAUDERDALE, FL 33309 (954) 777-4416 scott.peterson@dot.state.fl.us	ROAD NO.	COUNTY	FINANCIAL PROJECT ID			
					A1A	BROWARD	433688-4-C2-01		CAM #15-1417 Exhibit 13 13 of 13	D-13

NOTICE: THE OFFICIAL RECORD OF THIS SHEET IS THE ELECTRONIC FILE SIGNED AND SEALED UNDER RULE 61G15-23.003, F.A.C.