



**CITY OF FORT LAUDERDALE  
ENGINEERING DIVISION  
APPLICATION TO INSTALL AT GRADE  
COMMUNICATIONS SERVICE FACILITIES**

**PERMIT NO. CC13-12**  
**District 3**

5/2/14  
6

Applicant Name and Job Number Crown Castle NG East LLC SFL 63\_2

Job Address and Location 421 NW 12 Street

Description of Work Installing cabinet and utility pole within right-of-way.

Anticipated start and end dates of work 6/2/14- 45 days

- ☒ This permit application is for an exemption from the requirement to install communications service facilities below grade, in accordance with Section 25-100.1.B.3 of the City of Fort Lauderdale Code of Ordinances (Code). A letter by a qualified expert(s) is attached.
- ☐ Crown Castle is requesting the following waivers (check all applicable subsections and attach supporting documentation):

☐ C.1 (Size) ☐ C.2 (Height) ☐ C.3 (Front Yard) ☐ C.4 (Corner Yard) ☐ C.6 (Separation) ☐ C.7 (Exist. Facility) ☐ C.12 (Collector)

- ☒ With the exception of any waivers that may be checked above, the proposed at grade facilities conform to the requirements in Section 25-100.1 of the Code
- ☒ Notice of the pending application has been provided to all property owners abutting public rights-of-way within one hundred fifty (150) feet of the proposed site and to the relevant homeowner association, in accordance with Section 25-100.1.E.5 of the Code.
- ☒ The proposed site will be maintained by Crown Castle in accordance with the approved Graffiti Mitigation Plan dated 04/04/2013, which is on file with the City Engineer
- ☐ A landscaping maintenance commitment letter from the adjacent property owner and relevant home owner association is attached to this application.
- ☒ Crown Castle shall be responsible for maintaining landscaping
- ☒ The proposed at grade facilities depicted on the attached plans are completely located in the public rights-of-way.

As an authorized representative of Crown Castle, I certify under oath that the forgoing statements are true and correct.

Armando Hernandez

Printed Name of Authorized Crown Castle Agent

Armando Hernandez  
Signature of Authorized Crown Castle Agent

Sworn to and subscribed before me this 16<sup>TH</sup> day of May, 2008 2014

Angel Prieto  
Notary Public,  
State of Florida

My Commission Expires 8-23-16



(Do not write below this line)

Conceptual approval date \_\_\_\_\_ by \_\_\_\_\_, Subject to the following conditions:

1) A detailed visual mitigation plan is required

Final Permit approval date \_\_\_\_\_ by \_\_\_\_\_

Final Inspection date \_\_\_\_\_ by \_\_\_\_\_

\*\*Notify Engineering Permits Division 24 hours  
prior to starting work at (954) 828-5649





# CROWN CASTLE SFL63\_2

CLIENT :

CLIENT SITE ID#:

ADDRESS:

421 NW 12TH STREET  
FORT LAUDERDALE, FLORIDA 33311

SITE TYPE:

NEW CROWN CASTLE 40' CONCRETE POLE

## PROPERTY INFORMATION

SITE COORDINATES:

26.14031°  
-80.14856°

JURISDICTION:

CITY OF FORT LAUDERDALE

PROPERTY OWNER:  
ADDRESS:

CROWN CASTLE  
8555 NW 64TH STREET  
MIAMI, FL 33166

## PROJECT TEAM

PROJECT MANAGEMENT FIRM:  
ADDRESS:

CROWN CASTLE  
8555 NW 64TH STREET  
MIAMI, FL 33166

ENGINEERING FIRM:  
ADDRESS:

AW SOLUTIONS, INC.  
300 CROWN OAK CENTRE DR.  
LONGWOOD, FL 32750

CONTACT:

SHANE HAFNER  
407.260.0231 EXT. 120

FLORIDA COA#:

26983

DESIGN CRITERIA:

- FLORIDA BUILDING CODE 2010 AND ASCE 7-10. WIND LOAD PER ASCE 7-10.
  - ULTIMATE WIND SPEED: 170 MPH.
  - BUILDING RISK CATEGORY: II.
  - WIND EXPOSURE: C.
- DEAD LOAD:
  - EQUIPMENT WEIGHT PER MANUFACTURER DATA.
- SEISMIC LOAD DOES NOT GOVERN THIS DESIGN.

## DRAWING INDEX

| SHEET | SHEET DESCRIPTION         | REV |
|-------|---------------------------|-----|
| T1    | TITLE SHEET               | 2   |
| C1    | SITE PLAN                 | 2   |
| C1.1  | LANDSCAPE MITIGATION PLAN | 2   |
| C2    | ELEVATION                 | 2   |
| C3    | DETAILS                   | 2   |
| C4    | DETAILS                   | 2   |
| SP1   | SPECIFICATIONS            | 2   |
| SP2   | SPECIFICATIONS            | 2   |

## APPROVALS

PROJECT MANAGER: \_\_\_\_\_ DATE: \_\_\_\_\_

CARRIER: \_\_\_\_\_

UTILITY: \_\_\_\_\_



300 CROWN OAK CENTRE DRIVE  
LONGWOOD, FL 32750  
TEL: 407.260.0231  
FAX: 407.260.0749  
FL COA#: 26983

DRAWN BY: EW CHECKED BY: JD

| REV | DATE     | DESCRIPTION                |
|-----|----------|----------------------------|
| 2   | 05/05/14 | REVISED LOCATION/EQUIPMENT |
| 1   | 05/09/13 | REVISED PER COMMENTS       |
| 0   | 10/30/12 | ISSUED FOR PERMIT          |

| REV | DATE     | DESCRIPTION                |
|-----|----------|----------------------------|
| 2   | 05/05/14 | REVISED LOCATION/EQUIPMENT |
| 1   | 05/09/13 | REVISED PER COMMENTS       |
| 0   | 10/30/12 | ISSUED FOR PERMIT          |

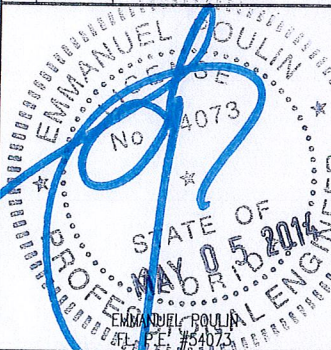

IT IS A VIOLATION OF LAW FOR ANY PERSON UNLESS THEY ARE ACTING UNDER THE DIRECTION OF A LICENSED PROFESSIONAL ENGINEER TO ALTER THIS DOCUMENT, UNLESS EXPLICITLY AGREED TO BY AW SOLUTIONS IN WRITING. AW SOLUTIONS, INC. DISCLAIMS ALL LIABILITY ASSOCIATED WITH THE REUSE, ALTERATION OR MODIFICATION OF THE CONTENTS HEREIN.

SITE#: SFL63\_2

ADDRESS: 421 NW 12TH STREET  
FORT LAUDERDALE, FL 33311

SHEET TITLE:

TITLE SHEET

SHEET NUMBER:

T1

Exhibit 9

15-0160

Page 2 of 7

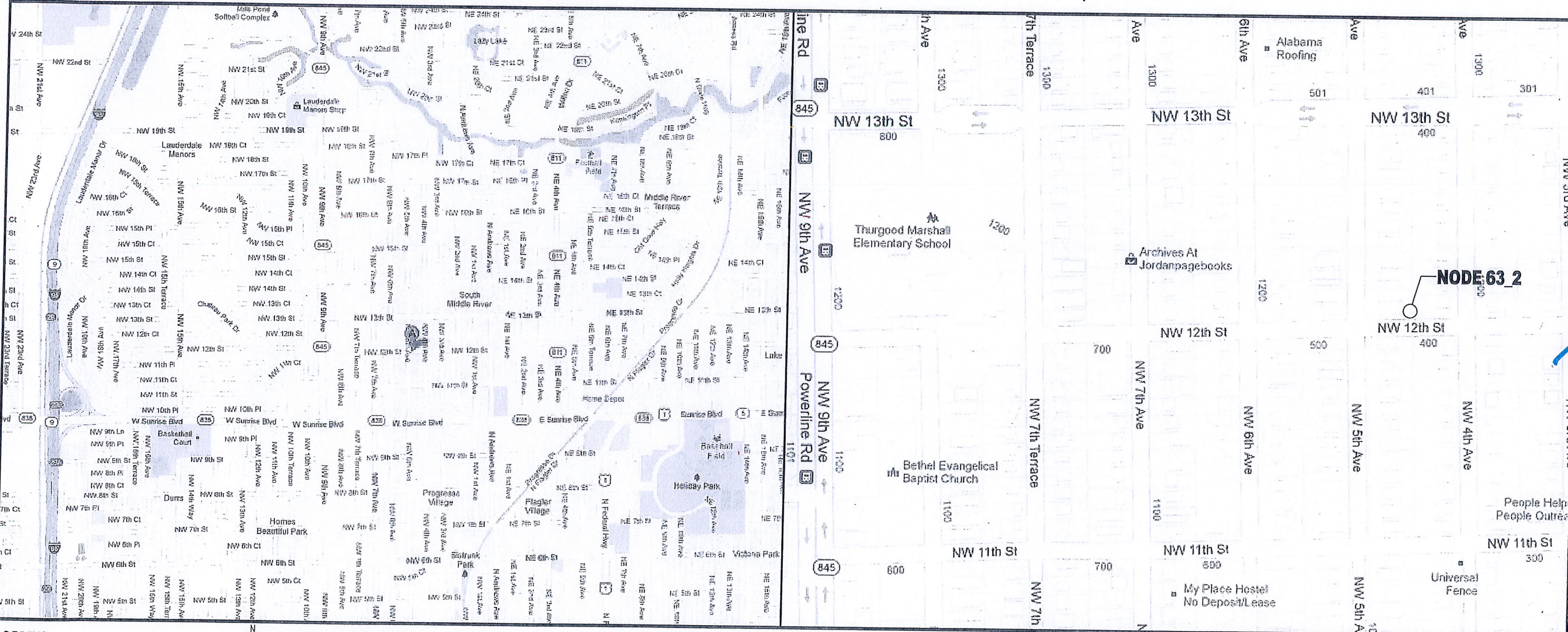

## DRIVING DIRECTIONS

FROM THE CROWN CASTLE OFFICE IN MIAMI, HEAD WEST ON NW 64TH ST TOWARD NW 87TH AVENUE. TURN RIGHT ONTO NW 87TH AVENUE. TURN RIGHT ONTO NW 74TH STREET. TURN LEFT TO MERGE ONTO FL-826 NORTH. TAKE THE EXIT TOWARD FL-826 EAST/BEACHES. MERGE ONTO FL-826 EAST/FL-91 SOUTH. TURN LEFT ONTO NW 2ND AVENUE. TAKE THE RAMP ON THE LEFT ONTO I-95 NORTH. TAKE EXIT 29A TO MERGE ONTO FL-838 E/W SUNRISE BLVD. TURN LEFT ONTO NW 7TH AVENUE. TAKE THE 2ND RIGHT ONTO NW 12TH STREET. DESTINATION WILL BE ON THE LEFT.



UNDERGROUND  
SERVICE ALERT  
CALL TOLL FREE  
1-800-432-4770  
48 HOURS BEFORE  
YOU DIG

## SPECIFIC LOCATION MAP



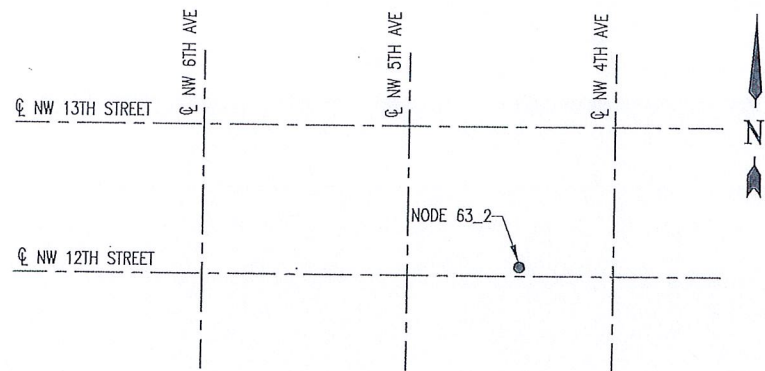

1 LOCATION SKETCH  
SCALE: NTS

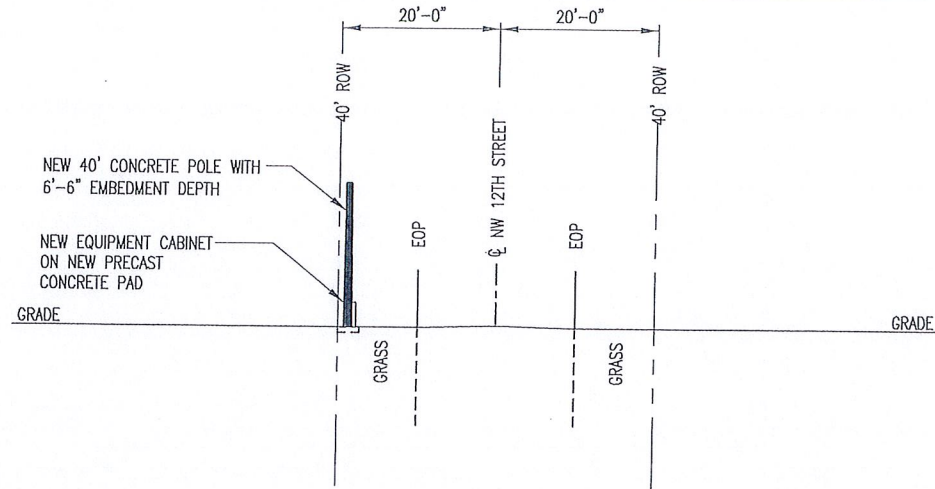

2 TYPICAL PROFILE VIEW  
SCALE: NTS

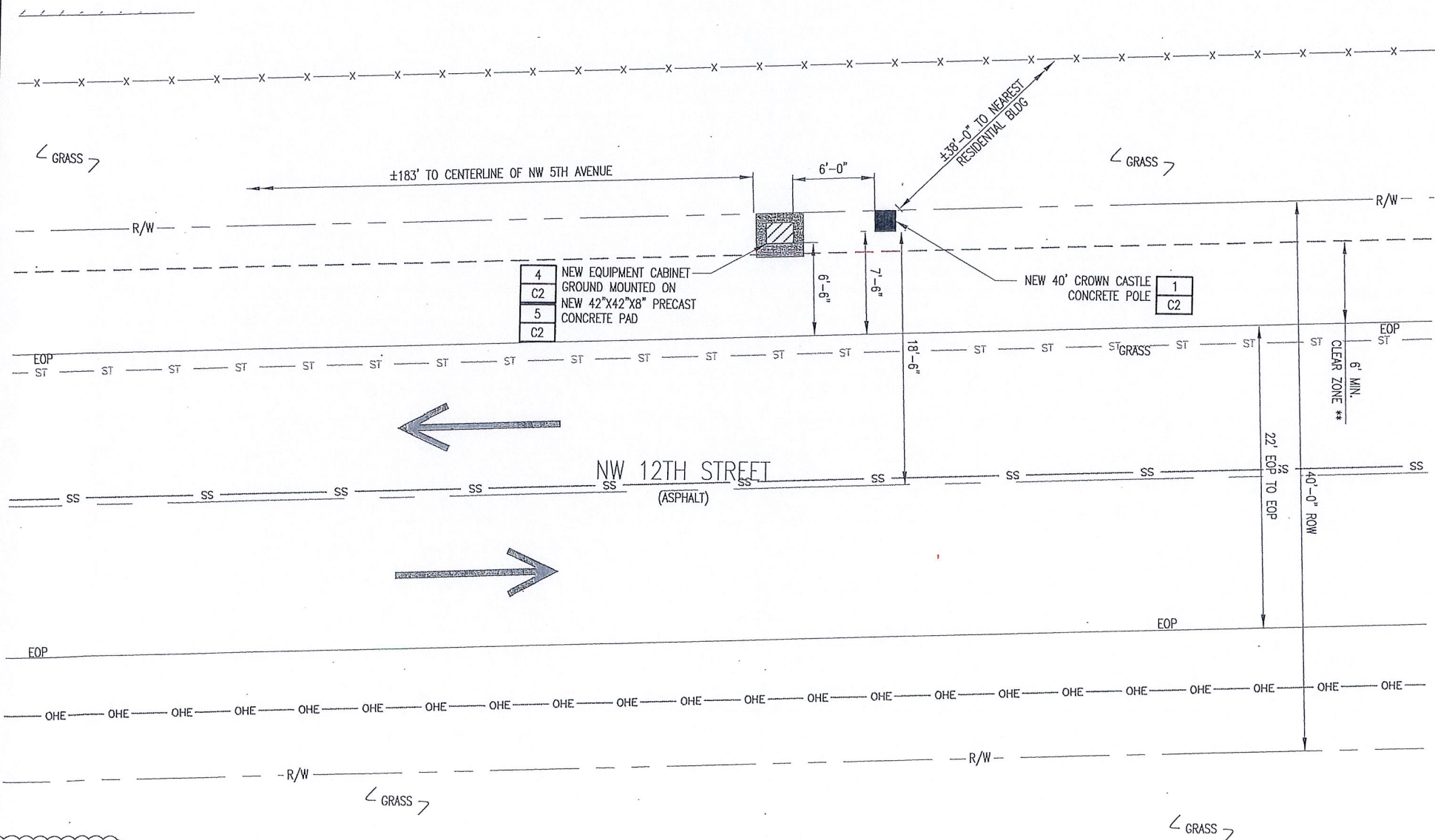

3 PLAN VIEW  
SCALE: NTS

\*\* MINIMUM CLEAR ZONES ILLUSTRATED USING  
DESIGN GUIDELINES FROM FDOT FLORIDA  
GREENBOOK, MAY 2007 EDITION

POSTED SPEED LIMIT:  
25MPH



UNDERGROUND SERVICE ALERT  
CALL TOLL FREE 1-800-432-4770  
48 HOURS BEFORE YOU DIG

- NOTES:
1. CONTRACTOR SHALL MAINTAIN UNINTERRUPTED ACCESS TO ALL DRIVEWAYS, SIDE STREETS AND WALKWAYS AT ALL TIMES UNLESS OTHERWISE PERMITTED.
  2. CONTRACTOR SHALL PREPARE A MAINTENANCE OF TRAFFIC (M.O.T.) PLAN FOR PEDESTRIAN TRAFFIC AND WORK WITHIN THE RIGHT-OF-WAY, INCLUDING VEHICLE PARKING AND EQUIPMENT STAGING.
  3. CONTRACTOR SHALL RESTORE ANY DISTURBED AREAS TO ORIGINAL CONDITION OR BETTER.

| SYMBOL LEGEND |                                      |
|---------------|--------------------------------------|
| — E —         | POWER CONDUIT                        |
| — T —         | TELCO CONDUIT                        |
| — — —         | PROPOSED FIBER CONDUIT               |
| — OHE —       | OVERHEAD CONDUCTORS                  |
| — G —         | GROUNDING                            |
| — X —         | FENCE                                |
| — W —         | WATER                                |
| — S —         | SEWER                                |
| — GAS —       | GAS                                  |
| — — —         | NEW EQUIPMENT CABINET ON PRECAST PAD |
| — X —         | STORM                                |
| — ⊗ —         | UTILITY POLE                         |
| — ⊙ —         | HYDRANT                              |
| — (MH) —      | MANHOLE                              |
| — — —         | CENTERLINE OF ROAD                   |
| — ○ —         | PROPOSED WOOD POLE                   |
| — ■ —         | PROPOSED CONCRETE UTILITY POLE       |
| 1             | REPRESENTS DETAIL #                  |
| C7            | REPRESENTS SHEET #                   |
| NOTE 1        | REPRESENTS NOTE                      |
| SHT E7        | REPRESENTS SHEET #                   |



300 CROWN OAK CENTRE DRIVE  
LONGWOOD, FL 32750  
TEL: 407.260.0231  
FAX: 407.260.0749  
FL COA#: 26983

DRAWN BY: EW CHECKED BY: JD

| REV | DATE     | DESCRIPTION                |
|-----|----------|----------------------------|
| 2   | 05/05/14 | REVISED LOCATION/EQUIPMENT |
| 1   | 05/09/13 | REVISED PER COMMENTS       |
| 0   | 10/30/12 | ISSUED FOR PERMIT          |

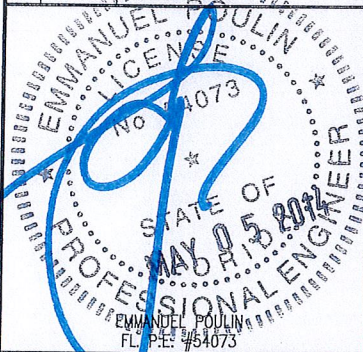

IT IS A VIOLATION OF LAW FOR ANY PERSON UNLESS THEY ARE ACTING UNDER THE DIRECTION OF A LICENSED PROFESSIONAL ENGINEER TO ALTER THIS DOCUMENT. UNLESS EXPLICITLY AGREED TO BY AW SOLUTIONS IN WRITING, AW SOLUTIONS, INC. DISCLAIMS ALL LIABILITY ASSOCIATED WITH THE REUSE, ALTERATION OR MODIFICATION OF THE CONTENTS HEREIN.

SITE#: SFL63\_2

ADDRESS: 421 NW 12TH STREET  
FORT LAUDERDALE, FL 33311

SHEET TITLE:

SITE PLAN

SHEET NUMBER:

C1









1. ALL PLANT MATERIAL SHALL CONFORM TO THE STANDARDS FOR FLORIDA NO. 1 OR BETTER, AS GIVEN IN "GRADES AND STANDARDS FOR NURSERY PLANTS" PART I, 1963, AND PART 11, STATE OF FLORIDA, DEPARTMENT OF AGRICULTURE, TALLAHASSEE, FLORIDA.
2. IT SHALL BE THE RESPONSIBILITY OF THE LANDSCAPE CONTRACTOR TO VERIFY LOCATION OF ALL UNDERGROUND UTILITIES PRIOR TO BEGINNING WORK.
3. ALL PLANT BEDS TO RECEIVE 10" OF 50/50 MIX. 50% SAND, 50% MUCK.
4. IT SHALL BE THE RESPONSIBILITY OF THE LANDSCAPE CONTRACTOR TO PROVIDE A SMOOTH UNIFORM GRADE PRIOR TO INSTALLING SOD.
5. ALL MULCH TO BE 'FLORAMULCH' MELALEUCA MULCH.
6. ALL TREES TO BE STAKED IN THE FIELD WITH APPROVED NURSERY STANDARD METHODS.
7. TREES/PALMS SHALL BE INSTALLED A MIN. OF 3' FROM UNDERGROUND UTILITIES.



UNDERGROUND SERVICE ALERT  
CALL TOLL FREE 1-800-432-4770  
48 HOURS BEFORE YOU DIG

1. CONTRACTOR SHALL MAINTAIN UNINTERRUPTED ACCESS TO ALL DRIVEWAYS, SIDE STREETS AND WALKWAYS AT ALL TIMES UNLESS OTHERWISE PERMITTED.
2. CONTRACTOR SHALL PREPARE A MAINTENANCE OF TRAFFIC (M.O.T.) PLAN FOR PEDESTRIAN TRAFFIC AND WORK WITHIN THE RIGHT-OF-WAY, INCLUDING VEHICLE PARKING AND EQUIPMENT STAGING.
3. CONTRACTOR SHALL RESTORE ANY DISTURBED AREAS TO ORIGINAL CONDITION OR BETTER.

| <u>SYMBOL LEGEND</u>  |                        |   |   |
|---|------------------------|---|---|
| — E —   | POWER CONDUIT          |  | NEW EQUIPMENT CABINET<br>ON PRECAST PAD |
| — T —   | TELCO CONDUIT          | — SS —  | STORM                                   |
|  | PROPOSED FIBER CONDUIT |  | UTILITY POLE                            |
| — OHE —   | OVERHEAD CONDUCTORS    |  | HYDRANT                                 |
| — G —   | GROUNDING              |  | MANHOLE                                 |
| — X —   | FENCE                  | — — — — —   | CENTERLINE OF ROAD                      |
| — W —   | WATER                  |  | PROPOSED WOOD POLE                      |
| — S —   | SEWER                  |  | PROPOSED CONCRETE UTILITY<br>POLE       |
| — GAS —   | GAS                    |   |   |



300 CROWN OAK CENTRE DRIVE  
LONGWOOD, FL 32750  
TEL: 407.260.0231  
FAX: 407.260.0749  
FL COA#: 26983

|           |    |             |    |
|-----------|----|-------------|----|
| DRAWN BY: | EW | CHECKED BY: | JD |
|-----------|----|-------------|----|

|     |          |                            |
|-----|----------|----------------------------|
| 2   | 05/05/14 | REVISED LOCATION/EQUIPMENT |
| 1   | 05/09/13 | REVISED PER COMMENTS       |
| 0   | 10/30/12 | ISSUED FOR PERMIT          |
| REV | DATE     | DESCRIPTION                |

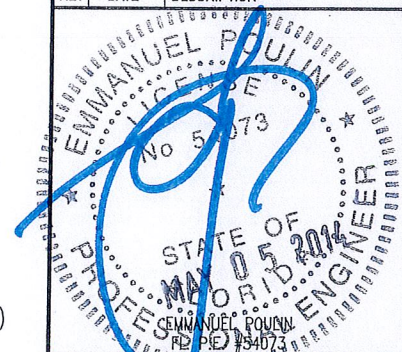

IT IS A VIOLATION OF LAW FOR ANY PERSON UNLESS THEY ARE ACTING UNDER THE DIRECTION OF A LICENSED PROFESSIONAL ENGINEER TO ALTER THIS DOCUMENT, UNLESS EXPLICITLY AGREED TO BY AW SOLUTIONS IN WRITING, AW SOLUTIONS, INC. DISCLAIMS ALL LIABILITY ASSOCIATED WITH THE REUSE, ALTERATION OR MODIFICATION OF THE CONTENTS HEREIN.

SITE#: SFL63\_2

ADDRESS: 421 NW 12TH STREET  
FORT LAUDERDALE, FL 33311

SHEET TITLE:

## LANDSCAPE MITIGATION PLAN

SHEET NUMBER:

## C1.1



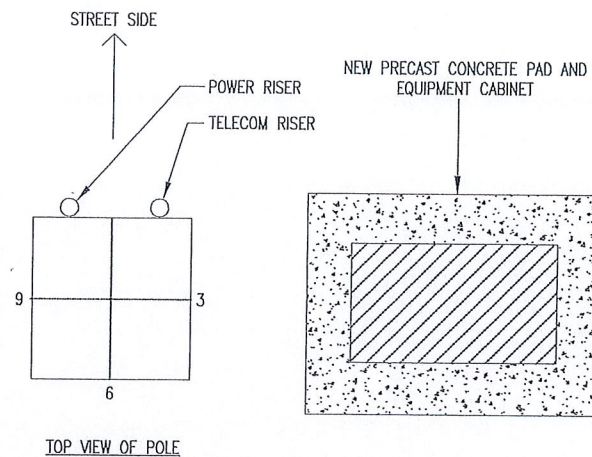
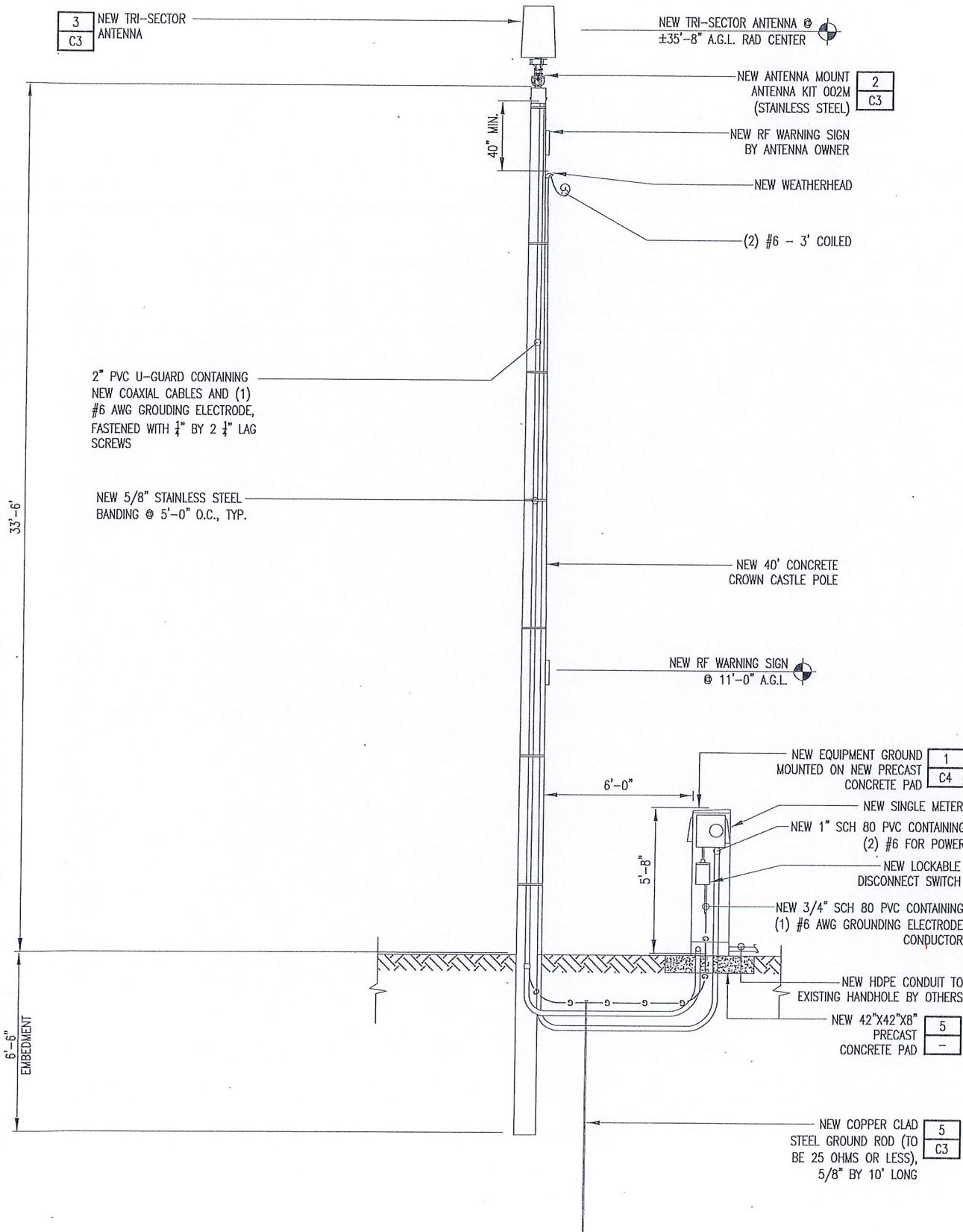

2 QUADRANT LOCATION OF PROPOSED EQUIPMENT  
SCALE: NTS

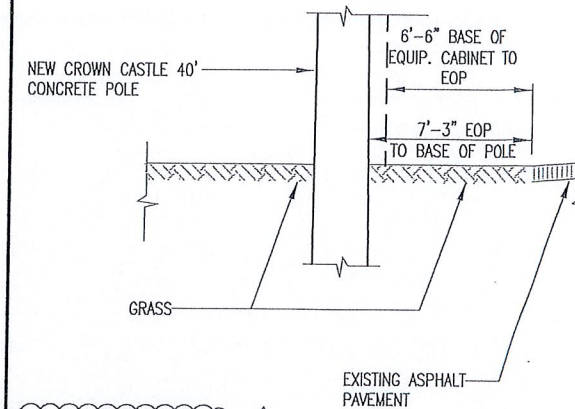

3 CURB ELEVATION  
SCALE: NTS

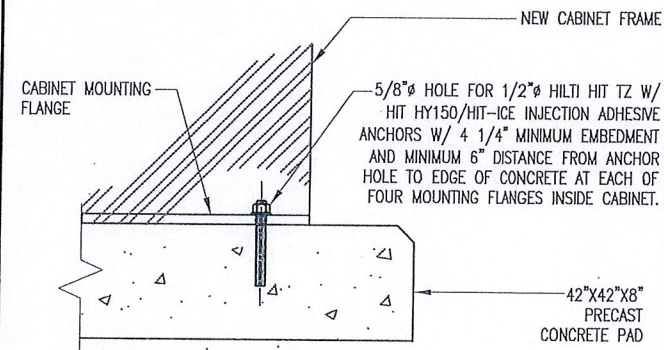

4 EQUIPMENT CABINET ATTACHMENT DETAIL  
SCALE: NTS

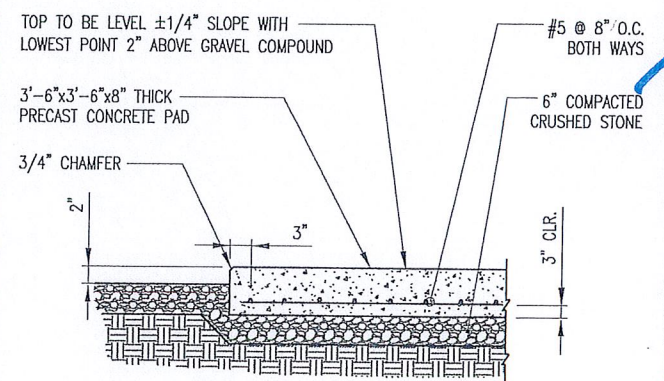

5 EQUIPMENT PAD DETAIL  
SCALE: NTS

**SYMBOL LEGEND**

|                             |                    |
|-----------------------------|--------------------|
| — E — POWER CONDUIT         | — X — FENCE        |
| — T — TELCO CONDUIT         | — (S) — SILT FENCE |
| — OHE — OVERHEAD CONDUCTORS |                    |
| — G — GROUNDING             |                    |

1 REPRESENTS DETAIL #  
C7 REPRESENTS SHEET #

NOTE 1 REPRESENTS NOTE  
SHT E7 REPRESENTS SHEET #

**CROWN CASTLE**  
INTERNATIONAL

**AW Solutions**  
INCORPORATED  
300 CROWN OAK CENTRE DRIVE  
LONGWOOD, FL 32750  
TEL: 407.260.0231  
FAX: 407.260.0749  
FL COA#: 26983

DRAWN BY: EW CHECKED BY: JD

| REV | DATE     | DESCRIPTION                |
|-----|----------|----------------------------|
| 2   | 05/05/14 | REVISED LOCATION/EQUIPMENT |
| 1   | 05/09/13 | REVISED PER COMMENTS       |
| 0   | 10/30/12 | ISSUED FOR PERMIT          |

EMMANUEL BOULIN  
PROFESSIONAL ENGINEER  
FL. P.E. #54073  
STATE OF FLORIDA  
MAY 05 2017

IT IS A VIOLATION OF LAW FOR ANY PERSON UNLESS THEY ARE ACTING UNDER THE DIRECTION OF A LICENSED PROFESSIONAL ENGINEER TO ALTER THIS DOCUMENT, UNLESS EXPLICITLY AGREED TO BY AW SOLUTIONS IN WRITING. AW SOLUTIONS, INC. DISCLAIMS ALL LIABILITY ASSOCIATED WITH THE REUSE, ALTERATION OR MODIFICATION OF THE CONTENTS HEREIN.

SITE#: SFL63\_2

ADDRESS: 421 NW 12TH STREET  
FORT LAUDERDALE, FL 33311

SHEET TITLE:  
**ELEVATION**

SHEET NUMBER:  
**C2**



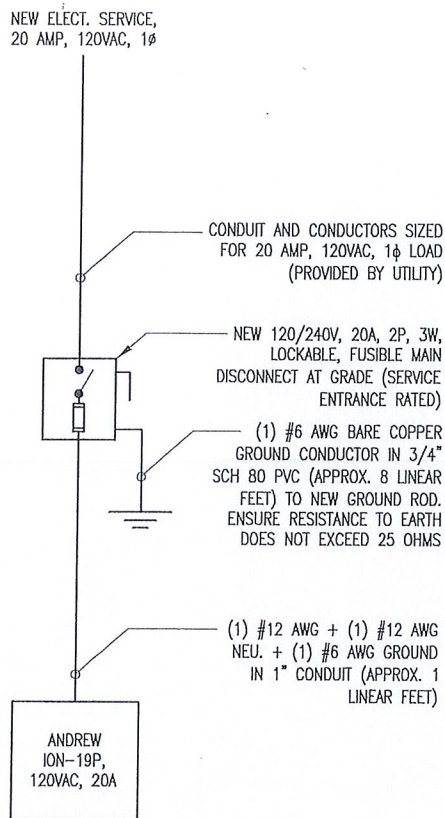

#### 1 RISER DIAGRAM

SCALE: NTS

1. SHORT CIRCUIT CURRENT RATING OF FUSIBLE MAIN DISCONNECT: 100kA.
2. PER FLORIDA BUILDING CODE 2010: FEEDER CONDUCTORS ARE SIZED FOR A MAXIMUM VOLTAGE DROP OF 2% AT DESIGN LOAD OF 20A.
3. PER FLORIDA BUILDING CODE 2010: BRANCH CIRCUIT CONDUCTORS ARE SIZED FOR A MAXIMUM VOLTAGE DROP OF 3% AT DESIGN LOAD. HOWEVER, THIS DESIGN CONTAINS NO BRANCH CIRCUITS.
4. ALL CONDUCTORS ARE TO BE COPPER WIRE WITH INSULATION TYPE XHHW.
5. ALL ABOVE GRADE CONDUIT IS TO BE UV RESISTANT SCHEDULE 80 PVC. ALL BELOW GRADE CONDUIT IS TO BE SCHEDULE 40 PVC.

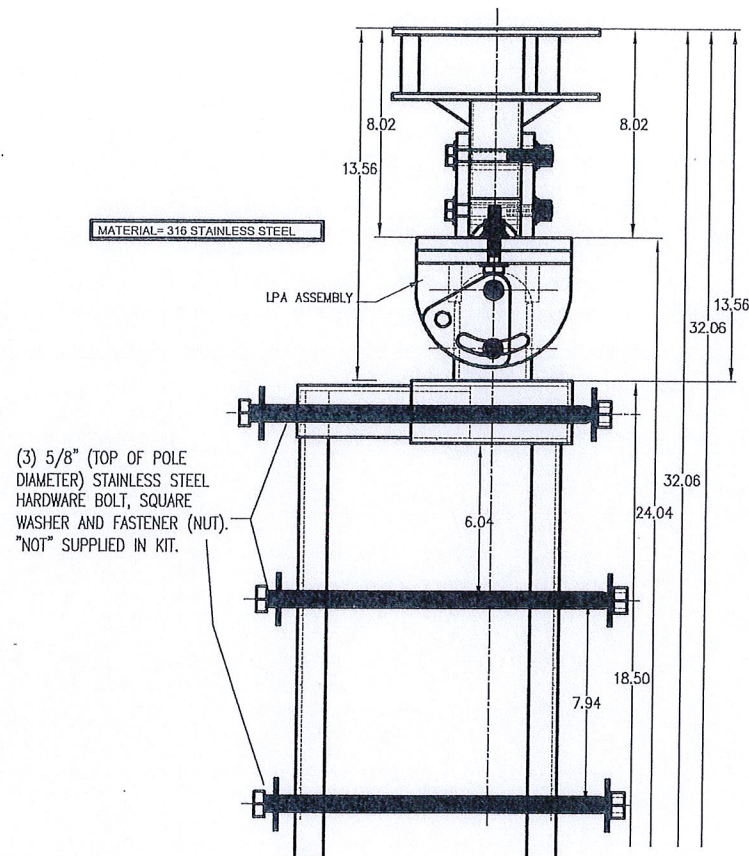

#### 2 ANTENNA MOUNTING KIT (002M)

SCALE: NTS

### KATHREIN SCALA DIVISION

Kathrein's dual band antennas are ready for 3G applications, covering all existing wireless bands as well as all spectrum under consideration for future systems, AMPS, PCS and 3G/UMTS.

- Wide band operation.
- Exceptional intermodulation characteristics.
- High strength fiberglass radome.
- Internal duplexers allow the +45° polarization (upper and lower bands) to be combined on one connector and the -45° polarization (upper and lower bands) to be combined on a second connector for each antenna.

#### General specifications:

|                            |   |
|----------------------------|---|
| Frequency range            | 808-960 MHz<br>1710-2170 MHz  |
| VSWR                       | <1.5:1  |
| Impedance                  | 50 ohms   |
| Intermodulation (2x20w)    | IM3: <-150 dBc  |
| Polarization               | +45° upper and lower band<br>-45° upper and lower band  |
| Connector                  | 6 x 7-16 DIN female   |
| Isolation intrasystem      | >30 dB  |
| Intersystem                | >40 dB (808-960 / 1710-2170 MHz)  |
| Radome color               | Brown, gray or dark gray (custom colors available at additional cost)                                     |
| Weight                     | 50 lb (22.7 kg)   |
| Height                     | 24 inches (609 mm)  |
| Radome diameter            | 16 inches (407 mm)  |
| Equivalent flat plate area | 1.6 ft² (0.148 m²)  |
| Wind survival rating*      | 100 mph (160 kph)   |
| Shipping dimensions        | 32 x 20 x 19 inches<br>(813 x 508 x 483 mm)   |
| Shipping weight            | 52 lb (23.6 kg)   |
| Mounting                   | Designed to be mounted on top of a utility pole using a custom mounting bracket supplied by the customer. |

See reverse for order information.

| Specifications:                                    | 808-960 MHz                               | 824-894 MHz                               | 890-960 MHz                               | 1710-1890 MHz                             | 1850-1990 MHz                             | 1920-2170 MHz                             |
|--|---|---|---|---|---|---|
| Gain   | 11.1 dBi                                  | 11.4 dBi                                  | 11.8 dBi                                  | 12.5 dBi                                  | 13.3 dBi                                  | 13.6 dBi                                  |
| Front-to-back ratio<br>(180° ± 30°)                | >23 dB (co-polar)<br>>20 dB (total power) | >23 dB (co-polar)<br>>20 dB (total power) | >25 dB (co-polar)<br>>22 dB (total power) | >25 dB (co-polar)<br>>22 dB (total power) | >25 dB (co-polar)<br>>22 dB (total power) | >25 dB (co-polar)<br>>22 dB (total power) |
| Maximum input power                                | 250 watts (at 50°C)                       | 250 watts (at 50°C)                       | 250 watts (at 50°C)                       | 200 watts (at 50°C)                       | 200 watts (at 50°C)                       | 200 watts (at 50°C)                       |
| +45° and -45° polarization<br>horizontal beamwidth | 67° (half-power)                          | 66° (half-power)                          | 64° (half-power)                          | 66° (half-power)                          | 60° (half-power)                          | 60° (half-power)                          |
| +45° and -45° polarization<br>vertical beamwidth   | 34° (half-power)                          | 33° (half-power)                          | 30° (half-power)                          | 20° (half-power)                          | 18° (half-power)                          | 17.5° (half-power)                        |
| Cross polar ratio<br>Main direction                | 25 dB (typical)                           | 25 dB (typical)                           | 25 dB (typical)                           | 16 dB (typical)                           | 18 dB (typical)                           | 20 dB (typical)                           |
| Sector   | >10 dB                                    | >10 dB                                    | >10 dB                                    | >10 dB                                    | >10 dB                                    | >10 dB                                    |

#### 3 ANTENNA SPECIFICATIONS

SCALE: NTS

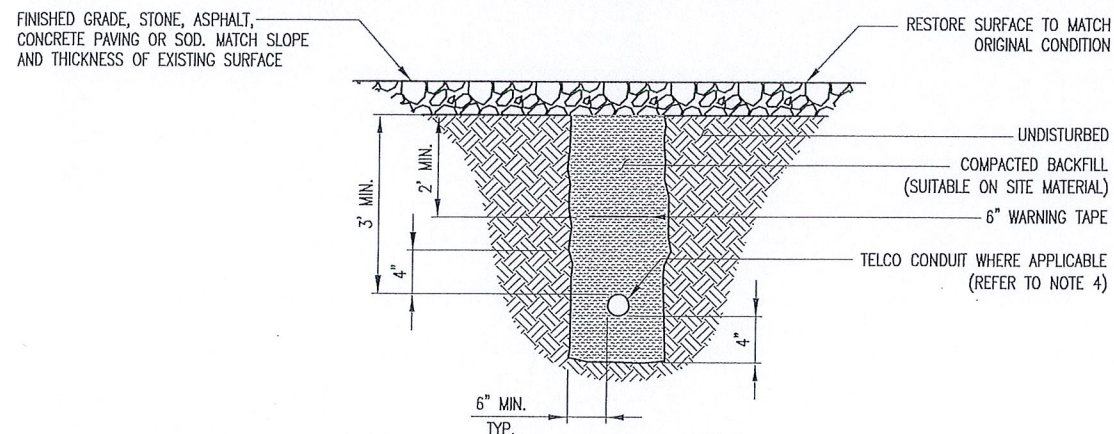
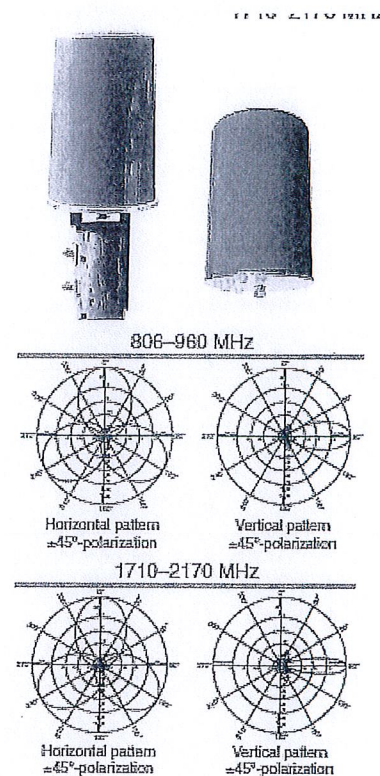

#### 4 NEW UNDERGROUND CONDUIT(S) TRENCHING DETAIL (IF APPLICABLE, REFER TO SITE PLAN)

SCALE: NTS

1. PROVIDE SCHEDULE 40 PVC CONDUIT BELOW GRADE EXCEPT AS NOTED BELOW.
2. PROVIDE SCHEDULE 80 PVC CONDUIT AND ELBOWS AT STUB UP LOCATIONS (i.e. SERVICE POLE, BTS EQUIPMENT, ETC.).
3. INSTALL UTILITY PULLBOXES PER NEC.
4. SEPARATION DIMENSION TO BE VERIFIED WITH LOCAL UTILITY CO. REQUIREMENTS.
5. CONDUIT/TUBING CONTAINING FIBER OPTIC CABLING TO BE FILLED WITH GEL TO PREVENT WATER PENETRATION, COMMONLY REFERRED TO AS "ICKY PICK."

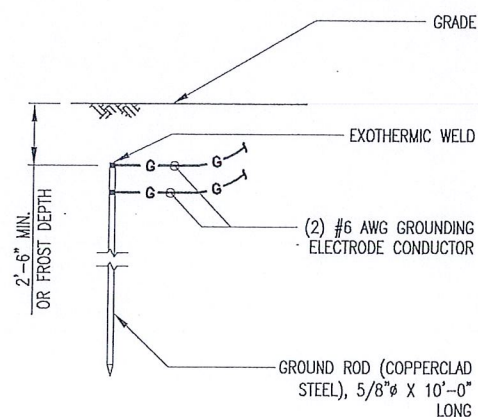

#### 5 GROUND ROD DETAIL

SCALE: NTS

1. GROUND ROD TO BE DRIVEN 10' VERTICALLY.

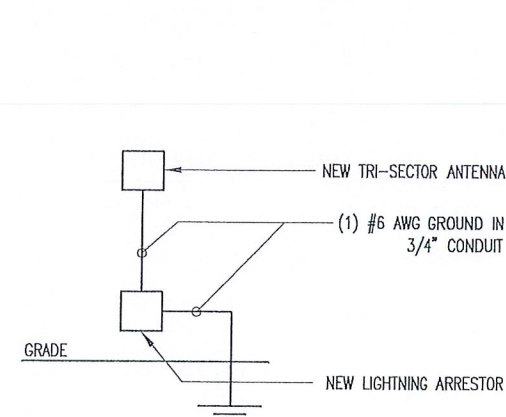

#### 6 ANTENNA GROUNDING SCHEMATIC

SCALE: NTS

CROWN  
CASTLE  
INTERNATIONAL

**AW Solutions**  
incorporated  
300 CROWN OAK CENTRE DRIVE  
LONGWOOD, FL 32750  
TEL: 407.260.0231  
FAX: 407.260.0749  
FL COA#: 26983

DRAWN BY: EW CHECKED BY: JD

2 05/05/14 REVISED LOCATION/EQUIPMENT  
1 05/09/13 REVISED PER COMMENTS  
0 10/30/12 ISSUED FOR PERMIT

REV DATE DESCRIPTION

EMMANUEL BOULIN  
No. 34073  
STATE OF  
FLORIDA  
PROFESSIONAL ENGINEER  
P.E. 154073

IT IS A VIOLATION OF LAW FOR ANY PERSON UNLESS THEY ARE ACTING UNDER THE DIRECTION OF A LICENSED PROFESSIONAL ENGINEER TO ALTER THIS DOCUMENT, UNLESS EXPLICITLY AGREED TO BY AN SOLUTIONS IN WRITING. AN SOLUTIONS, INC. DISCLAIMS ALL LIABILITY ASSOCIATED WITH THE REUSE, ALTERATION OR MODIFICATION OF THE CONTENTS HEREIN.

SITE#: SFL63\_2

ADDRESS: 421 NW 12TH STREET  
FORT LAUDERDALE, FL 33311

SHEET TITLE:

DETAILS

SHEET NUMBER:

C3



| REV | DATE     | DESCRIPTION                |
|-----|----------|----------------------------|
| 2   | 05/05/14 | REVISED LOCATION/EQUIPMENT |
| 1   | 05/09/13 | REVISED PER COMMENTS       |
| 0   | 10/30/12 | ISSUED FOR PERMIT          |

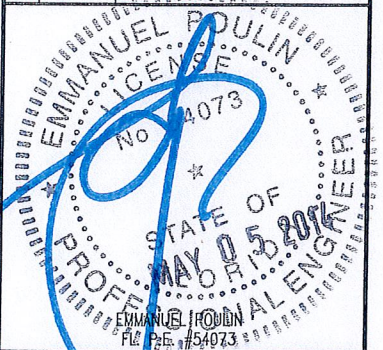

IT IS A VIOLATION OF LAW FOR ANY PERSON UNLESS THEY ARE ACTING UNDER THE DIRECTION OF A LICENSED PROFESSIONAL ENGINEER TO ALTER THIS DOCUMENT. UNLESS EXPLICITLY AGREED TO BY AW SOLUTIONS IN WRITING, AW SOLUTIONS, INC. DISCLAIMS ALL LIABILITY ASSOCIATED WITH THE REUSE, ALTERATION OR MODIFICATION OF THE CONTENTS HEREIN.

SITE#: SFL63\_2

ADDRESS: 421 NW 12TH STREET  
FORT LAUDERDALE, FL 33311

SHEET TITLE:

**DETAILS**

SHEET NUMBER:  
**C4**

