

# A1A Marathon, Ft. Lauderdale, FL.

**Race will be in the north bound lane of A1A. Runners will stay to the left going north and to the left going south.**

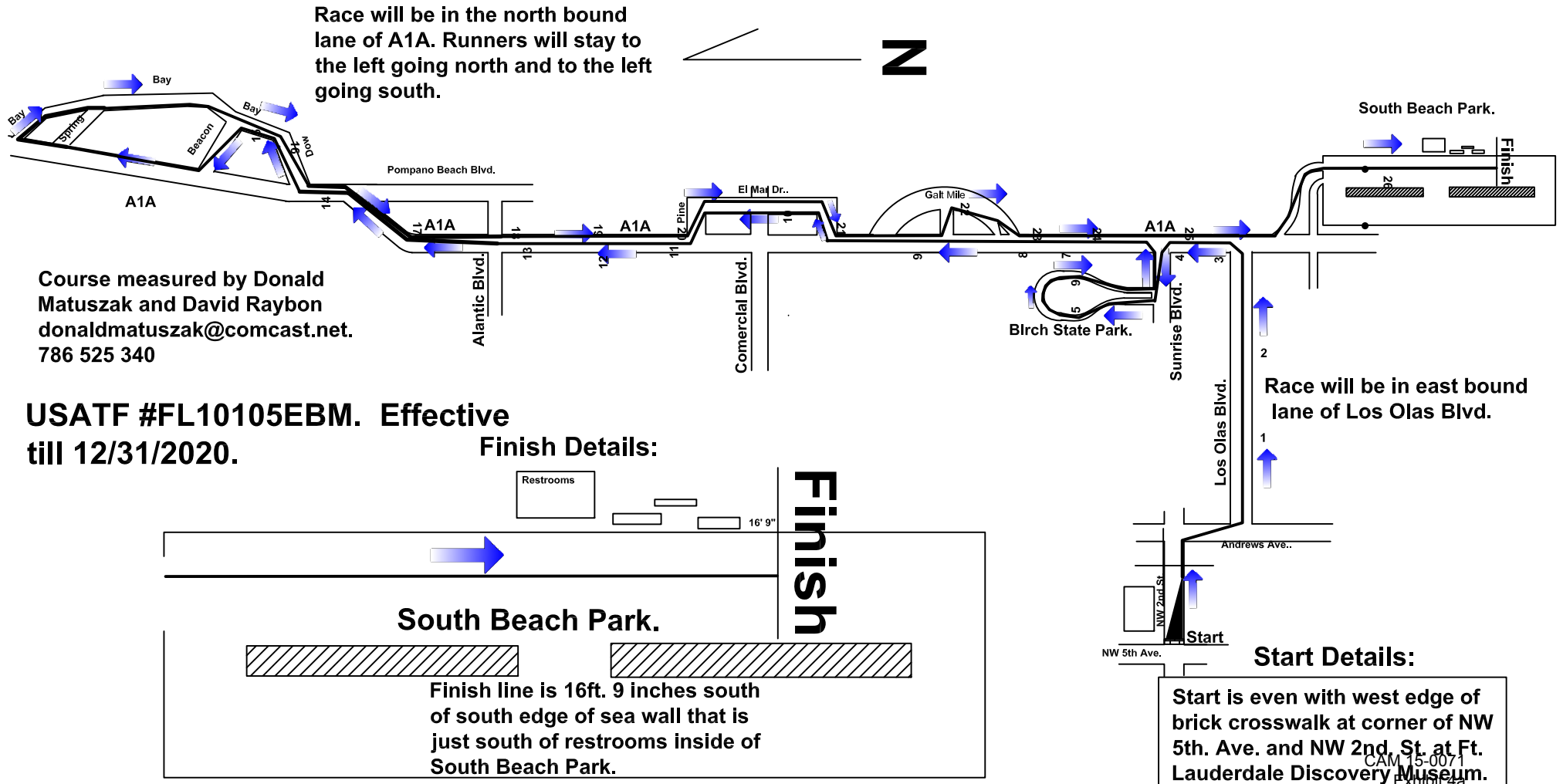

**USATF #FL10105EBM. Effective  
till 12/31/2020.**

### Finish Details:

## South Beach Park.

**Finish line is 16ft. 9 inches south of south edge of sea wall that is just south of restrooms inside of South Beach Park.**

**Race will be in east bound lane of Los Olas Blvd.**

### Start Details:

Start is even with west edge of brick crosswalk at corner of NW 5th. Ave. and NW 2nd. St. at Ft. Lauderdale Discovery Museum.