

TABLE 1
CHANNELIZING DEVICE SPACING

Work Zone Speed (mph)	Max. Spacing (feet)			
	Cones or Temporary Tubular Markers		Type II Barricades, Vertical Panels, or Drums	
	Taper	Tangent	Taper	Tangent
≤ 45	25	50	25	50
≥ 50	25	50	50	100

TABLE 4
BUFFER LENGTH "B"

Work Zone Speed (mph)	Min. Length (feet)
25	155
30	200
35	250
40	305
45	360
50	425
55	495
60	570
65	645
70	730

Note: When Buffer Length "B" cannot be attained due to geometric constraints, use the greatest length possible, but not less than 155 feet.

TABLE 3
WORK ZONE SIGN SPACING "X"

Road Type	Min. Spacing (feet)
Arterials and Collectors with Work Zone Speed ≤ 40 mph	200
Arterials and Collectors with Work Zone Speed ≥ 45 mph	500
Limited Access Roadways *	1,500

* For Limited access roadways with work zone speed ≤ 55 mph, the minimum spacing may be reduced in accordance with the MUTCD and as approved by the Engineer.

TABLE 2
TAPER LENGTH "L"

Work Zone Speed (mph)	Min. Length (feet)
≤ 40	L = WS ² 60
≥ 45	L = WS

Where: W = width of offset in feet
S = speed in mph



This Certifies that
Roosevelt M. Byres III

Has Completed a Florida Department of Transportation Approved
Temporary Traffic Control (TTC) Advanced (Refresher) Course.

Date Expires: 02/12/2022
Instructor: Juan Morales

Certificate # 36715
FDOT Provider # 37

ATSSA
Phone: 540-368-1701
15 Riverside Parkway Ste.100
Fredericksburg, VA,
www.atssa.com
donna.clark@atssa.com



MOT SHALL COMPLY WITH THE FDOT DESIGN STANDARDS AND THE MUTCD

OVERVIEW REFERENCE INDEX 102-602, 613, & 660
STANDARD SHOULDER CLOSURE
ON SE 2ND ST FOR WORK IN
THE RIGHT OF WAY SET-UP
ALL SIGN MUST BE POST
MOUNTED DUE TO 24~7 SET-UP

SE 2ND ST
FORT LAUDERDALE, FLA

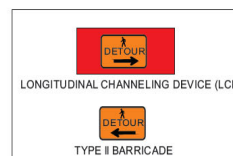

DETOUR PLAN

CAM#22-0346
Exhibit 3
Page 1 of 2

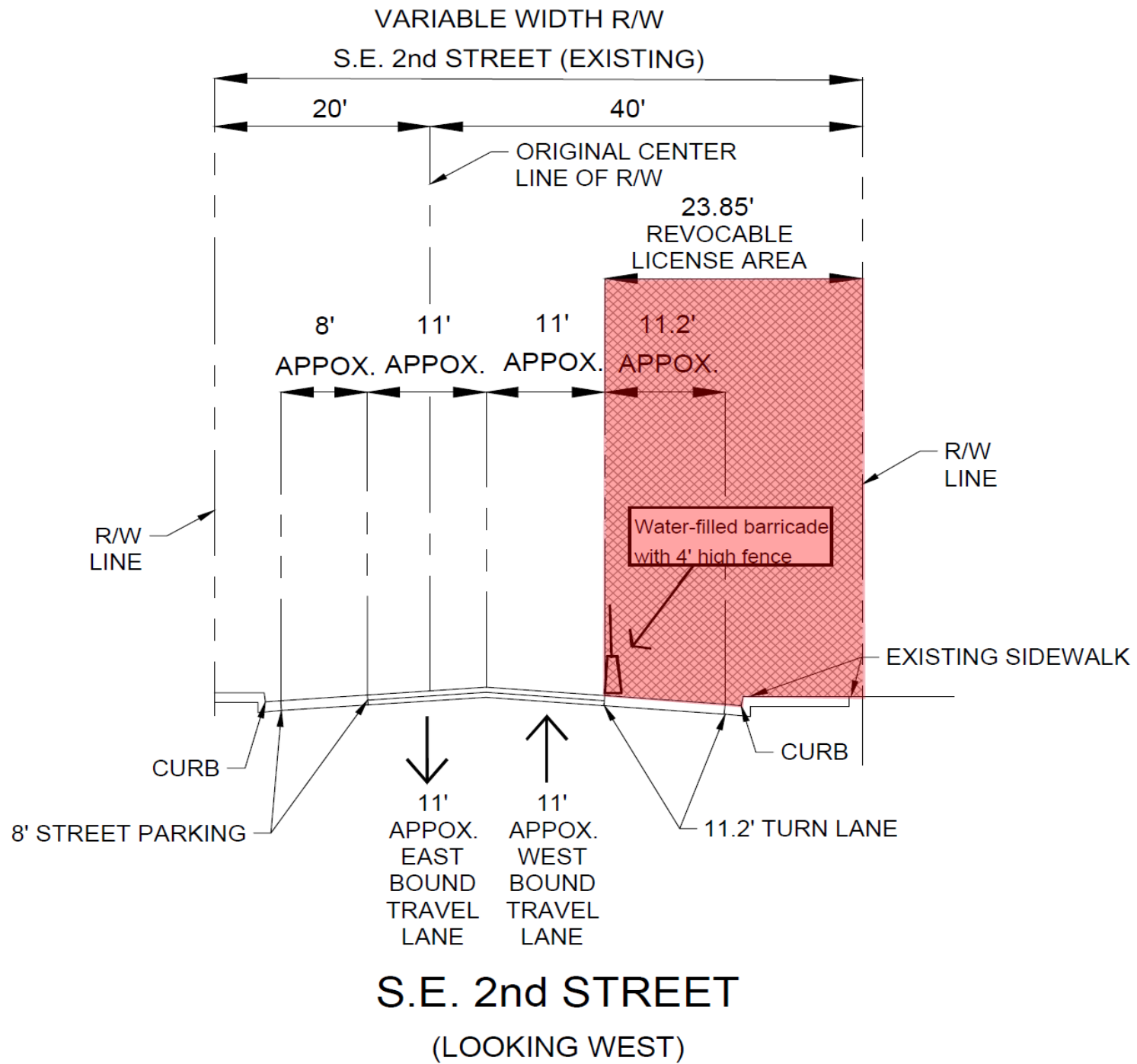

TYPICAL SECTION