



PROJECT
RIVERSIDE PARK
FORT LAUDERDALE
PARKS BOND PROGRAM

CLIENT



CONSULTANT

AECOM
 7650 W. COURTNEY CAMPBELL CAUSEWAY
 SUITE 700
 TAMPA, FL 33607
 813.286.1711 tel 813.287.8591 fax
 www.aecom.com

SUB-CONSULTANT

CIVIL
BCC ENGINEERING
 305.670.2350 tel
 www.bcceng.com

LANDSCAPE
CURTIS + ROGERS
 305.442.1774 tel
 www.curtisrogers.com

GEOTECHNICAL SERVICES
GEOSOL, INC.
 305.928.4367 tel
 www.geosol.net

SURVEYOR
PDS, INC.
 954.237.7850 tel
 www.pds-eng.com

MECHANICAL, PLUMBING AND FIRE PROTECTION
HAMMOND AND ASSOCIATES CONSULTING
 954.327.7111 tel
 www.hammondengineers.com

REGISTRATION

ISSUE/REVISION

I/R	DATE	DESCRIPTION
1	07/18/2022	BID DOCUMENTS
1	05/27/2022	CONSTRUCTION DOCUMENTS
1	04/01/2022	DESIGN DEVELOPMENT

KEY PLAN

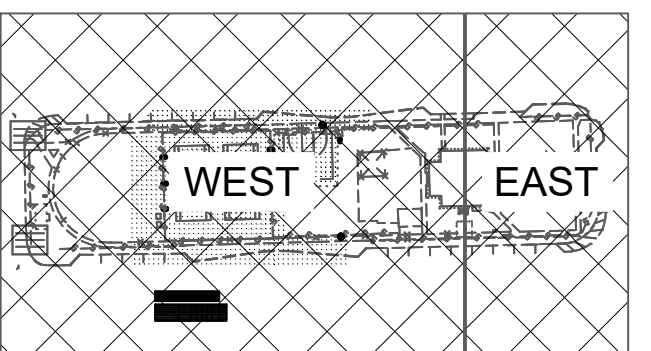

PROJECT NUMBER

P12668

SHEET TITLE

ELECTRICAL SITE PLAN

SHEET NUMBER

E201

GENERAL NOTES:

- REFER TO E300 SERIES SHEET FOR SIZES OF OVERCURRENT PROTECTION DEVICES, CONDUCTORS, CONDUITS, AND LIGHTING FIXTURE SCHEDULE.
- LABEL EACH LIGHTING POLE WITH POLE NUMBER.
- RUN NEUTRAL CONDUCTOR FROM PANEL 'B' FOR RECEPTACLE TO THE LIGHT POLES.
- IF TRENCHING IS NOT FEASIBLE USE DIRECTIONAL BORING. COORDINATE PRIOR TO COMMENCEMENT OF WORK.

KEYED NOTES:

- PROVIDE POLE MOUNTED RECEPTACLE. SEE SHEET E601.
- USE DIRECTIONAL BORING TO INSTALL UNDERGROUND CONDUIT TO LIGHTING FIXTURE.

MATCH LINE SEE PLAN BELOW THIS SHEET

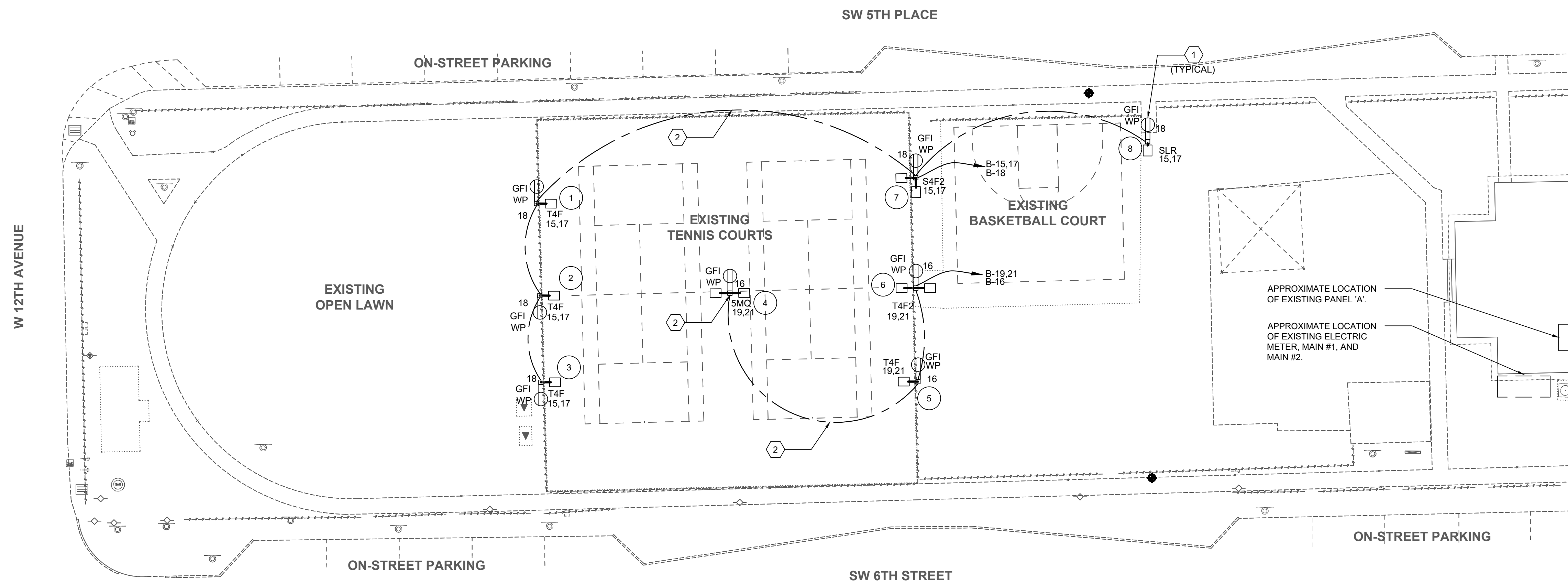

1 ELECTRICAL SITE PLAN - WEST
 SCALE : 1" = 20'-0"

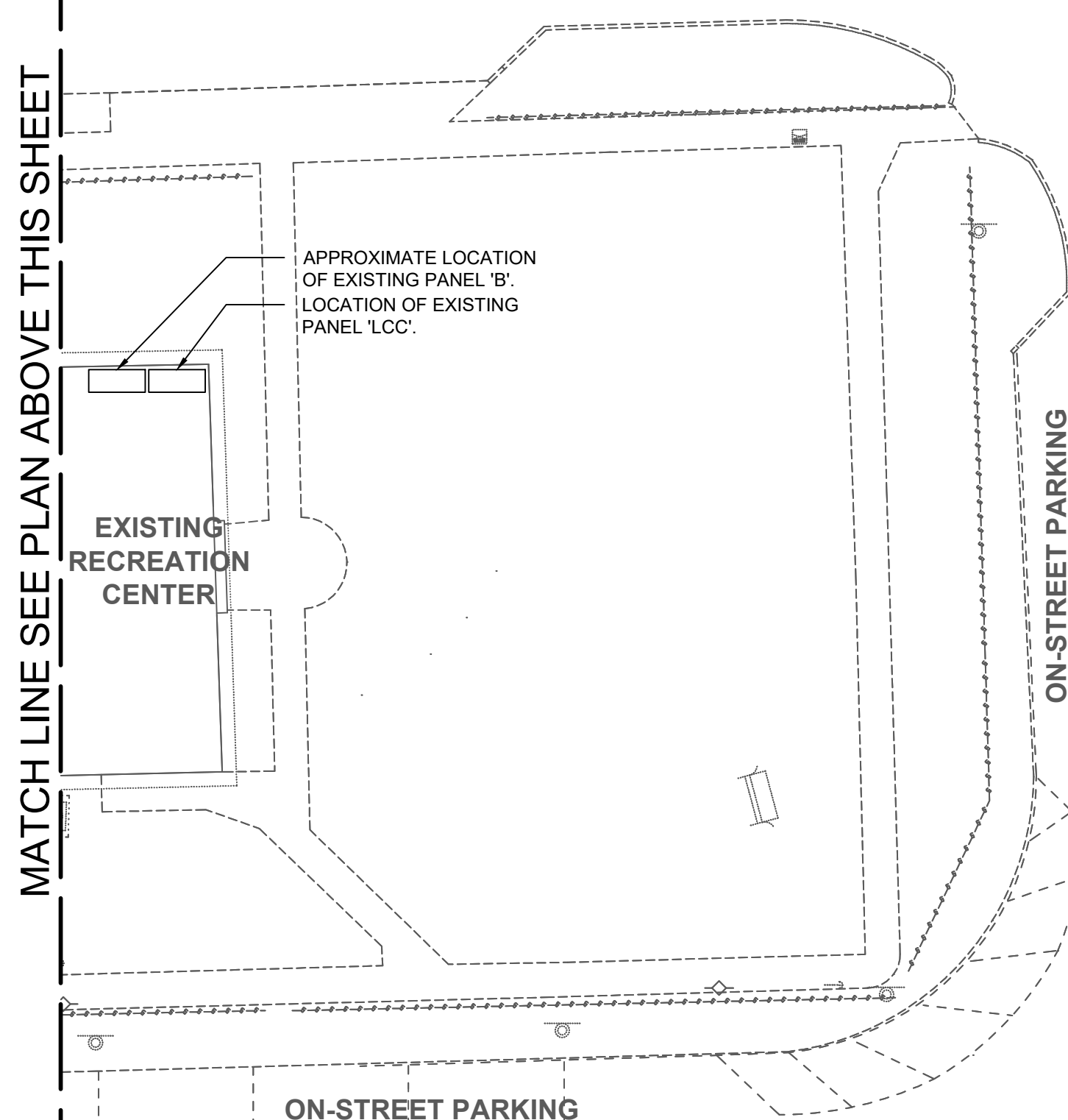

2 ELECTRICAL SITE PLAN - EAST
 SCALE : 1" = 20'-0"

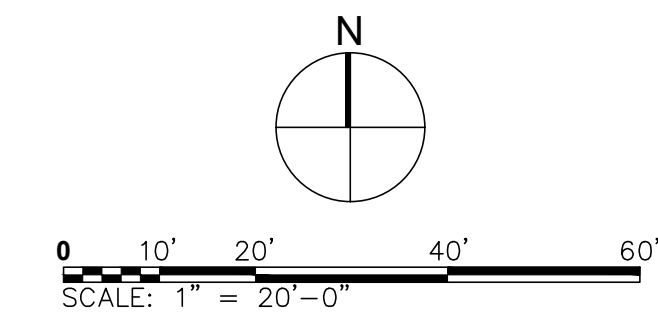

NOTICE: THE OFFICIAL RECORD OF THIS SHEET IS THE ELECTRONIC FILE SIGNED AND SEALED UNDER RULE 61G15-23.004, F.A.C.

Project Management Initials: _____ Designer: _____ Checked: _____ Approved: _____
 Last saved by: MERRITT BIRD/2022.07.15 Last Printed: 2022.07.15
 Filename: C:\USERS\MERRITT.BIRD\AECOM\BPP-AMER (USA) 60641343-FTL PBP DESIGN SERVICES\PROJECT FILES\900 DESIGN COLLABORATION\07_TO_704-RIVERSIDE\06-A-S-E-WP12668-E201-STPLN.DWG
 12/16/2022 8:35 AM

ANSI D 24" x 36" Approved: _____ Checked: _____ Designer: _____

Project Management Initials: _____ Last Printed: 2022.07.15 File Name: C:\USERS\MERRITT.BIRD\AECOM\BPP-AMER (USA) 60641343-FTL_PBP DESIGN SERVICES\PROJECT FILES\9000 DESIGN COLLABORATION\07_TO_704-RIVERSIDE\06-A-S-E-WP12668-E201-STPLN.DWG

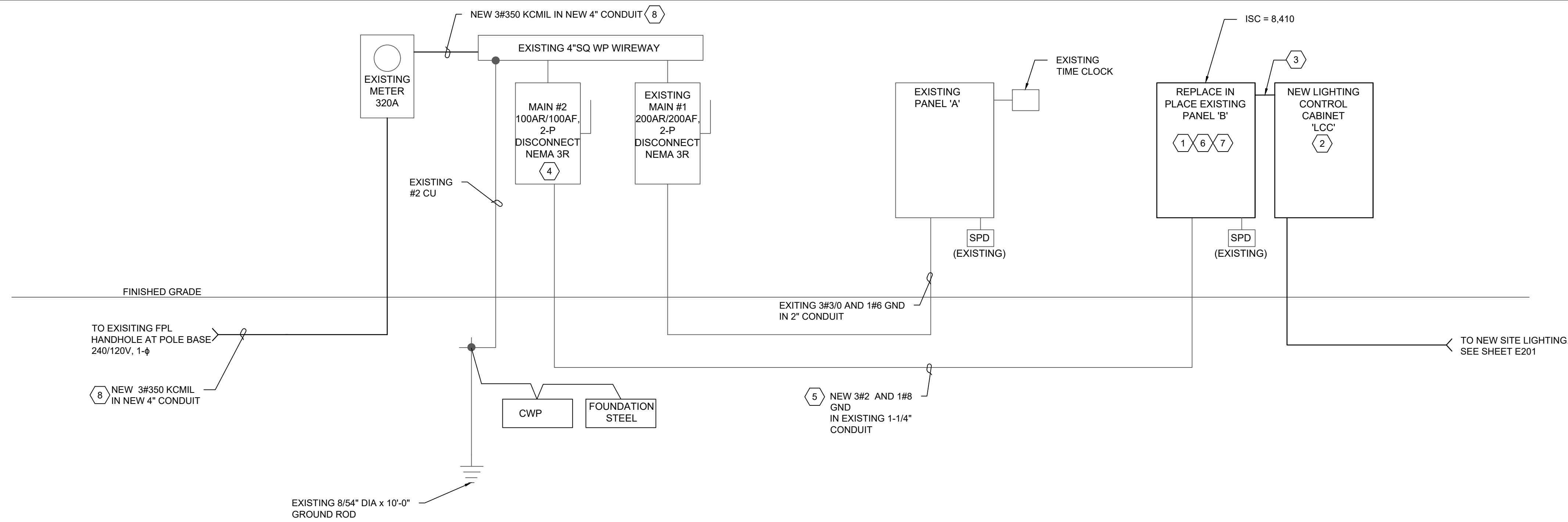

1 ELECTRICAL ONE-LINE DIAGRAM
SCALE: N.T.S.

SERVICE LOAD SUMMARY - MAIN #1 200A, 240/120V, 1-φ, MAIN #2 70A, 240/120V, 1-φ		
EXISTING CONNECTED LOAD AT MAIN FROM AS-BUILT DRAWINGS 02/03/2003	55.4 KVA	230.8 A
ADDED LOAD TO EXISTING PANEL B	7.1 KVA	29.5 A
TOTAL	62.5 KVA	260.4 A
GENERAL NOTE:		

PANELBOARD: B (NEW)												FAULT CURRENT: REFER TO GENERAL NOTES												
BUS AMPS: 125A												AIC RATING: 10000 FULLY RATED												
MAIN SIZE/TYPE: MLO												SERVES:												
VOLTS/PHASE: 240D/120V, 1PH, 3W												MOUNTING: SURFACE												
SECTION: 1												LOCATION: INTERIOR												
ENCLOSURE: NEMA 1																								
CKT NO.	DESCRIPTION	CONDUCTOR & CONDUIT					BREAKER		V/PHASE		V/PHASE		BREAKER		CONDUCTOR & CONDUIT					DESCRIPTION	CKT NO.			
		PH	NEUT	GND	IG	COND	TYP	AMP	POLE	A	B	A	B	POLE	AMP	TYP	COND	IG	GND			NEUT	PH	
1	OFFICE/STO LTS	ex	ex	ex	--	ex	ex	20	1	300													RECEPTS OFFICE	2
3	RESTROOM LTS	ex	ex	ex	--	ex	ex	20	1	650													RECEPTS OFFICE	4
5	GREAT RM LTS	ex	ex	ex	--	ex	ex	20	1	1,200													RECEPTS GREAT RM	5
7	GREAT RM LTS	ex	ex	ex	--	ex	ex	20	1	1,200													RECEPTS GREAT ROOM	8
9	SPARE	ex	ex	ex	--	ex	ex	20	1	500													RECEPT RESTROOM	10
14	SPARE	ex	ex	ex	--	ex	ex	20	1	500													RECEPT STORAGE	12
13	LIGHTING CONTACTOR	12	12	12		3/4"		20	1	200													HAND DRYER	14
15	TENNIS COURT LTS	8				1"		20	2	1,278	2,178												POLE RECEPT.	16
17	TENNIS COURT LTS	8				1"		20	2	1,022	1,022												POLE RECEPT.	18
19	TENNIS COURT LTS	8		8		1"		20	2														SPACE	20
21	SPACE																						SPACE	22
23	SPACE																						SPACE	24
25	SPACE																						SPACE	26
27	SPACE																						SPACE	28
29	SPACE																						SPACE	30
SUBTOTAL		4,500	5,550							3,420	2,520													
LOAD		CONN. VA	DF	LOAD		CONN. VA	DF	TOTAL PHASE A - VA		7,920	TOTAL PHASE B - VA		8,070	TOTAL PHASE - VA		15,990	TOTAL PHASE - VA		15,989	TOTAL PHASE - VA		17,364 VA		
COOLING			1.00	REFRIGERATION			1.00	CONN. AMPS	86	TOTAL PHASE - VA		15,989	CONN. AMPS	67	TOTAL PHASE - VA		15,989	TOTAL PHASE - VA		17,364 VA				
HEATING			0	DISPLAY CASE			1.25	CONN. AMPS	67	TOTAL PHASE - VA		15,989	CONN. AMPS	67	TOTAL PHASE - VA		15,989	TOTAL PHASE - VA		17,364 VA				
LIGHTING			5,499	KITCHEN			1.00	CONN. AMPS	67	TOTAL PHASE - VA		15,989	CONN. AMPS	67	TOTAL PHASE - VA		15,989	TOTAL PHASE - VA		17,364 VA				
RECEPTACLES			4,940	EXISTING			4,350	CONN. AMPS	67	TOTAL PHASE - VA		15,989	CONN. AMPS	67	TOTAL PHASE - VA		15,989	TOTAL PHASE - VA		17,364 VA				
MOTORS			1.00	LARGEST MOTOR			1.25	TOTAL DEMAND			TOTAL PHASE - VA		17,364 VA	TOTAL PHASE - VA		17,364 VA	TOTAL PHASE - VA		17,364 VA					
WATER HEATER			1.00	SHOW WINDOW			1.25	TOTAL PHASE - VA		17,364 VA	TOTAL PHASE - VA		17,364 VA	TOTAL PHASE - VA		17,364 VA	TOTAL PHASE - VA		17,364 VA					
MISC EQUIP			1,200	LTG TRACK			1.00	TOTAL PHASE - VA		17,364 VA	TOTAL PHASE - VA		17,364 VA	TOTAL PHASE - VA		17,364 VA	TOTAL PHASE - VA		17,364 VA					

GENERAL NOTES:

- PER AS BUILTS THE AVAILABLE FAULT CURRENT AT FPL'S AERIAL TRANSFORMER IS 19,944 AMPS (SYM). FAULT AT MAINS IS 13,371 AMPS (SYM), PANEL 'A' IS 7,301 AMPS (SYM), AND PANEL 'B' IS 3,244 AMPS (SYM) WITH CL FUSES.
- PROVIDE PLAQUE ON MAIN #1 AND MAIN #2 INDICATING "MAIN SERVICE DISCONNECT 1 OF 2 (AND 2 OF 2) MAXIMUM AVAILABLE FAULT CURRENT, AND CALCULATION DATE OF XX/XX/2022", IN ACCORDANCE WITH NEC 110.24.

KEYED NOTES:

- DISCONNECT AND RECONNECT EXISTING BRANCH CIRCUITS FOR UPGRADED PANEL 'B'.
- PROVIDE NEW LIGHTING CONTROL CABINET. LIGHTING BRANCH CONTROL CABINET SHALL BE PHOTOCELL AND TIMECLOCK CONTROLLED CONTACTOR. SEE SHEET E601.
- (2) 2" NIPPLES FOR POLE MOUNTED RECEPTACLES. LIGHTING CONTACTOR AND LIGHTING CIRCUITS FROM PANEL 'B' TO LIGHTING CONTACTOR. SEE SHEET E601.
- REPLACE EXISTING MAIN #2 70A/100KAIC RATED FUSES (FUSETRON) WITH NEW 100A FUSES, COORDINATE WITH EXISTING SITE UTILITIES PRIOR TO COMMENCEMENT OF WORK.
- REPLACE THE EXISTING 3#4 CONDUCTORS WITH 3#2 AS SHOWN ON ELECTRICAL ONE-LINE DIAGRAM AND REUSE EXISTING CONDUIT.
- PROVIDE NEW 125A, 30-POLES, 240/120V, 1-PHASE PANEL TO REPLACE EXISTING 125A, 18-POLES, 240/120V, 1-PHASE PANEL 'B'.
- RECONNECT ALL EXISTING BRANCH CIRCUITS TO THE UPGRADED NEW PANEL B.
- REPLACE THE EXISTING 3#250 KCMIL CONDUCTORS WITH 3#350 AS SHOWN ON ELECTRICAL ONE-LINE DIAGRAM AND REPLACE EXISTING 2-1/2" CONDUIT WITH 4" CONDUIT.



PROJECT
RIVERSIDE PARK
FORT LAUDERDALE
PARKS BOND PROGRAM

CLIENT



CONSULTANT

AECOM
7650 W. COURTNEY CAMPBELL CAUSEWAY
SUITE 700
TAMPA, FL 33607
813.286.1711 tel 813.287.8591 fax
www.aecom.com

SUB-CONSULTANT

CIVIL
BCC ENGINEERING
305.670.2350 tel
www.bcceng.com

LANDSCAPE
CURTIS + ROGERS
305.442.1774 tel
www.curtisrogers.com

GEOTECHNICAL SERVICES
GEOSOL, INC.
305.828.4367 tel
www.geosol.net

SURVEYOR
PDS, INC.
954.327.7850 tel
www.pds-eng.com

MECHANICAL, PLUMBING AND FIRE PROTECTION
HAMMOND AND ASSOCIATES CONSULTING
954.327.7111 tel
www.hammondengineers.com

REGISTRATION

ISSUE/REVISION

I/R	DATE	DESCRIPTION
1	07/18/2022	BID DOCUMENTS
1	05/27/2022	CONSTRUCTION DOCUMENTS
1	04/01/2022	DESIGN DEVELOPMENT

KEY PLAN

PROJECT NUMBER

P12668

SHEET TITLE

ELECTRICAL ONE-LINE
DIAGRAM AND SCHEDULES

SHEET NUMBER

E301

NOTICE: THE OFFICIAL RECORD OF THIS SHEET IS THE ELECTRONIC FILE SIGNED AND SEALED UNDER RULE 61G15-25.004, F.A.C.



PROJECT
RIVERSIDE PARK
FORT LAUDERDALE
PARKS BOND PROGRAM



CLIENT

CONSULTANT
 AECOM
 7650 W. COURTNEY CAMPBELL CAUSEWAY
 SUITE 700
 TAMPA, FL 33607
 813.286.1711 tel 813.287.8591 fax
 www.aecom.com

SUB-CONSULTANT

CIVIL
BCC ENGINEERING
 305.670.2350 tel
 www.bcceng.com

LANDSCAPE
CURTIS + ROGERS
 305.442.1774 tel
 www.curtisrogers.com

GEOTECHNICAL SERVICES
GEOSOL, INC.
 305.828.4367 tel
 www.geosol.net

SURVEYOR
PDS, INC.
 954.237.7850 tel
 www.pds-eng.com

MECHANICAL, PLUMBING AND FIRE PROTECTION
HAMMOND AND ASSOCIATES CONSULTING
 954.327.7111 tel
 www.hammondengineers.com

REGISTRATION

ISSUE/REVISION

I/R	DATE	DESCRIPTION
1	07/18/2022	BID DOCUMENTS
1	05/27/2022	CONSTRUCTION DOCUMENTS
1	04/01/2022	DESIGN DEVELOPMENT

KEY PLAN

PROJECT NUMBER
 P12668

SHEET TITLE
 FIXTURE SCHEDULE

SHEET NUMBER
 E302

LIGHTING FIXTURE SCHEDULE - RIVERSIDE

TYPE	DESCRIPTION	MOUNTING	VOLT	LAMPS	MANUFACTURER	CATALOG NUMBER	INPUT WATTS
SLR	SINGLE HEAD AREA POLE-MOUNTED LIGHTING, LED FIXTURE WITH TENON ARM TYPE IV OPTICS.	POLE MOUNT AT 20' ON POLE, UON.	240	LED MINIMUM 44,159 LUMENS	COOPER - MCGRAW EDISON	GLEON-SA8D-750-U-SLR-HSS- SYNAPSE DIM10 & SYNAPSE TL7-B2M	511
					ACUITY - LITHONIA	APPROVED EQUAL	
					PHILIPS - GARDCO	APPROVED EQUAL	
T4F2	TWIN HEADS AREA POLE-MOUNTED LIGHTING, LED FIXTURE HEAD FACING BACK TO BACK WITH 3 FEET TENON ARM TYPE IV OPTICS.	POLE MOUNT AT 20' ON POLE, UON.	240	LED MINIMUM 88,318 LUMENS	COOPER - MCGRAW EDISON	GLEON-SA8D-750-U-T4FT-HSS- SYNAPSE DIM10 & SYNAPSE TL7-B2M	1022
					ACUITY - LITHONIA	APPROVED EQUAL	
					PHILIPS - GARDCO	APPROVED EQUAL	
S4F2	TWIN HEADS AREA POLE-MOUNTED LIGHTING, LED FIXTURE HEAD AT 90 DEGREES WITH 3 FEET TENON ARM TYPE IV OPTICS.	POLE MOUNT AT 20' ON POLE, UON.	240	LED MINIMUM 88,318 LUMENS	COOPER - MCGRAW EDISON	GLEON-SA8D-750-U-T4FT-HSS- SYNAPSE DIM10 & SYNAPSE TL7-B2M	1022
					ACUITY - LITHONIA	APPROVED EQUAL	
					PHILIPS - GARDCO	APPROVED EQUAL	
T4F	SINGLE HEAD AREA POLE-MOUNTED LIGHTING, LED FIXTURE WITH 3 FEET TENON ARM TYPE IV OPTICS.	POLE MOUNT AT 20' ON POLE, UON.	240	LED MINIMUM 44,159 LUMENS	COOPER - MCGRAW EDISON	GLEON-SA8D-750-U-T4FT-HSS- SYNAPSE DIM10 & SYNAPSE TL7-B2M	511
					ACUITY - LITHONIA	APPROVED EQUAL	
					PHILIPS - GARDCO	APPROVED EQUAL	
SMQ	TWIN HEADS AREA POLE-MOUNTED LIGHTING, LED FIXTURE HEAD BACK TO BACK WITH 3 FEET TENON ARM TYPE IV OPTICS.	POLE MOUNT AT 20' ON POLE, UON.	240	LED MINIMUM 88,318 LUMENS	COOPER - MCGRAW EDISON	GLEON-SA8D-750-U-5MQ- SYNAPSE DIM10 & SYNAPSE TL7-B2M	1022
					ACUITY - LITHONIA	APPROVED EQUAL	
					PHILIPS - GARDCO	APPROVED EQUAL	

GENERAL NOTES:

- ALL POLE MOUNTED FIXTURES SHALL BE PROVIDED WITH MANUFACTURER INSTALLED BIRD DETERANT.
- ALL EXTERIOR POLE MOUNTED FIXTURES SHALL BE PROVIDED WITH SPD'S LOCATED IN THE HANDHOLE OF THE POLE.

NOTICE: THE OFFICIAL RECORD OF THIS SHEET IS THE ELECTRONIC FILE SIGNED AND SEALED UNDER RULE 61G15-23.004, F.A.C.

Project Management Initials: _____ Designer: _____ Checked: _____ Approved: _____
 ANS I D 24" x 36"
 Last saved by: MERRITT BIRD/2022.07.15 Last Printed: 2022.07.15
 Filename: C:\USERS\MERRITT.BIRD\ACDC\SAE\COMB-P-AMER (USA) 60641343-FTL PBP DESIGN SERVICES\PROJECT FILES\900 DESIGN COLLABORATION\07_TO_704-RIVERSIDE\06-A-S-E-WP12668-E201-STPLN.DWG



PROJECT
RIVERSIDE PARK
FORT LAUDERDALE
PARKS BOND PROGRAM

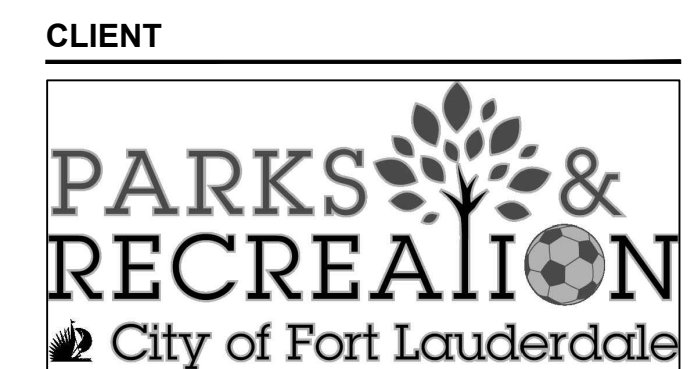

CONSULTANT
 AECOM
 7650 W. COURTNEY CAMPBELL CAUSEWAY
 SUITE 700
 TAMPA, FL 33607
 813.286.1711 tel 813.287.8591 fax
 www.aecom.com

SUB-CONSULTANT
 CIVIL
BCC ENGINEERING
 305.670.2350 tel
 www.bcceng.com

LANDSCAPE
CURTIS + ROGERS
 305.442.1774 tel
 www.curtisrogers.com

GEOTECHNICAL SERVICES
GEOSOL, INC.
 305.828.4367 tel
 www.geosol.net

SURVEYOR
PDS, INC.
 954.237.7850 tel
 www.pds-eng.com

MECHANICAL, PLUMBING AND FIRE PROTECTION
HAMMOND AND ASSOCIATES CONSULTING
 954.327.7111 tel
 www.hammondengineers.com

REGISTRATION

ISSUE/REVISION

I/R	DATE	DESCRIPTION
1	07/18/2022	BID DOCUMENTS
1	05/27/2022	CONSTRUCTION DOCUMENTS
1	04/01/2022	DESIGN DEVELOPMENT

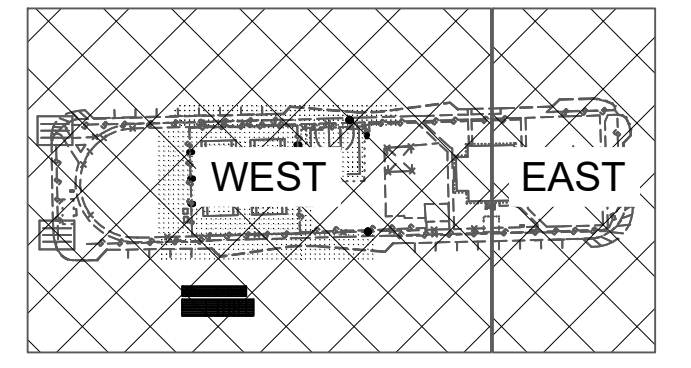

PROJECT NUMBER
 P12668

SHEET TITLE
 PHOTOMETRIC SITE PLAN

SHEET NUMBER
 E501

GENERAL NOTES:

- PHOTOMETRICS VALUES ARE IN FOOTCANDLES AND MEASURED AT GRADE.
- PHOTOMETRIC VALUES WERE CALCULATED USING LIGHTING ANALYSIS SOFTWARE AGI32 VERSION 19.9 WITH COOPER MCGRAW EDISON SERIES GALLEON LIGHTING POLE MOUNTED AT 20' ABOVE FINISH GRADE.
- PHOTOMETRIC CALCULATIONS SHALL COMPLY WITH RECREATIONAL TENNIS AND BASKETBALL REQUIREMENTS PER IESNA.

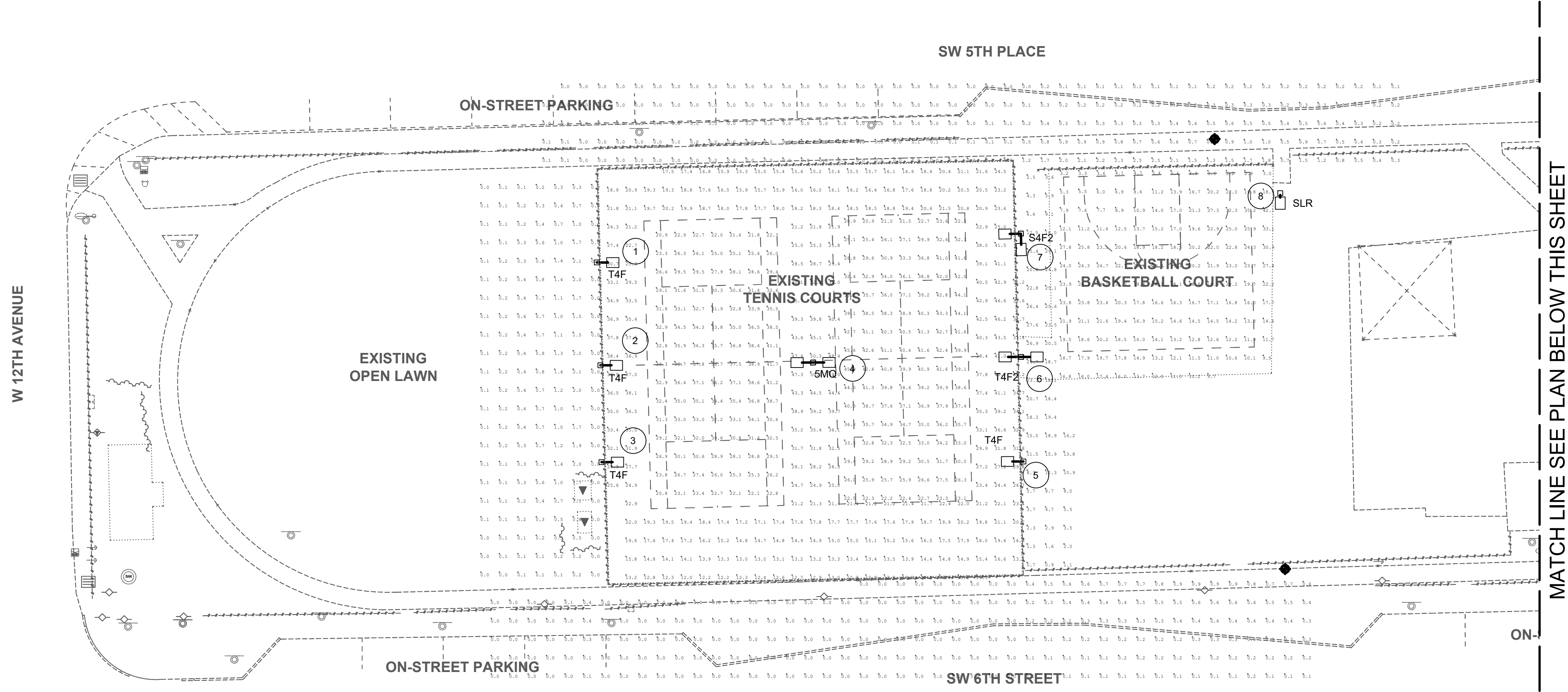

MATCH LINE SEE PLAN BELOW THIS SHEET

1 PHOTOMETRIC SITE PLAN - WEST
 SCALE: 1" = 20'-0"

Luminaire Schedule						
Symbol	Qty	Label	Arrangement	Total Lamp Lumens	LLF	
□	1	GLEON-SA8D-750-U-SLR-HSS	SINGLE	N.A.	0.950	
□-□	1	GLEON-SA8D-750-U-T4FT-HSS 2	BACK-BACK	N.A.	0.950	
□	1	GLEON-SA8D-750-U-T4FT-HSS 1	2 @ 90 DEGREES	N.A.	0.950	
□-□	4	GLEON-SA8D-750-U-T4FT-HSS 3	SINGLE	N.A.	0.950	
□-□	1	GLEON-SA8D-750-U-5MQ	BACK-BACK	N.A.	0.950	

Calculation Summary							
Label	CalcType	Units	Avg	Max	Min	Avg/Min	Max/Min
EXISTING BASKETBALL COURT	Illuminance	Fc	16.65	42.1	2.8	5.95	15.04
Existing Open Lawn	Illuminance	Fc	0.48	2.1	0.0	N.A.	N.A.
Lawn	Illuminance	Fc	13.39	29.1	0.7	19.13	41.57
N - Residential	Illuminance	Fc	0.27	2.5	0.0	N.A.	N.A.
S - Residential	Illuminance	Fc	0.13	0.9	0.0	N.A.	N.A.
TENNIS COURT INBOUND_L	Illuminance	Fc	34.45	45.9	20.9	1.65	2.20
TENNIS COURT INBOUND_R	Illuminance	Fc	30.89	41.7	20.8	1.49	2.00
TENNIS COURT OUTBOUND	Illuminance	Fc	24.45	50.3	12.0	2.04	4.19

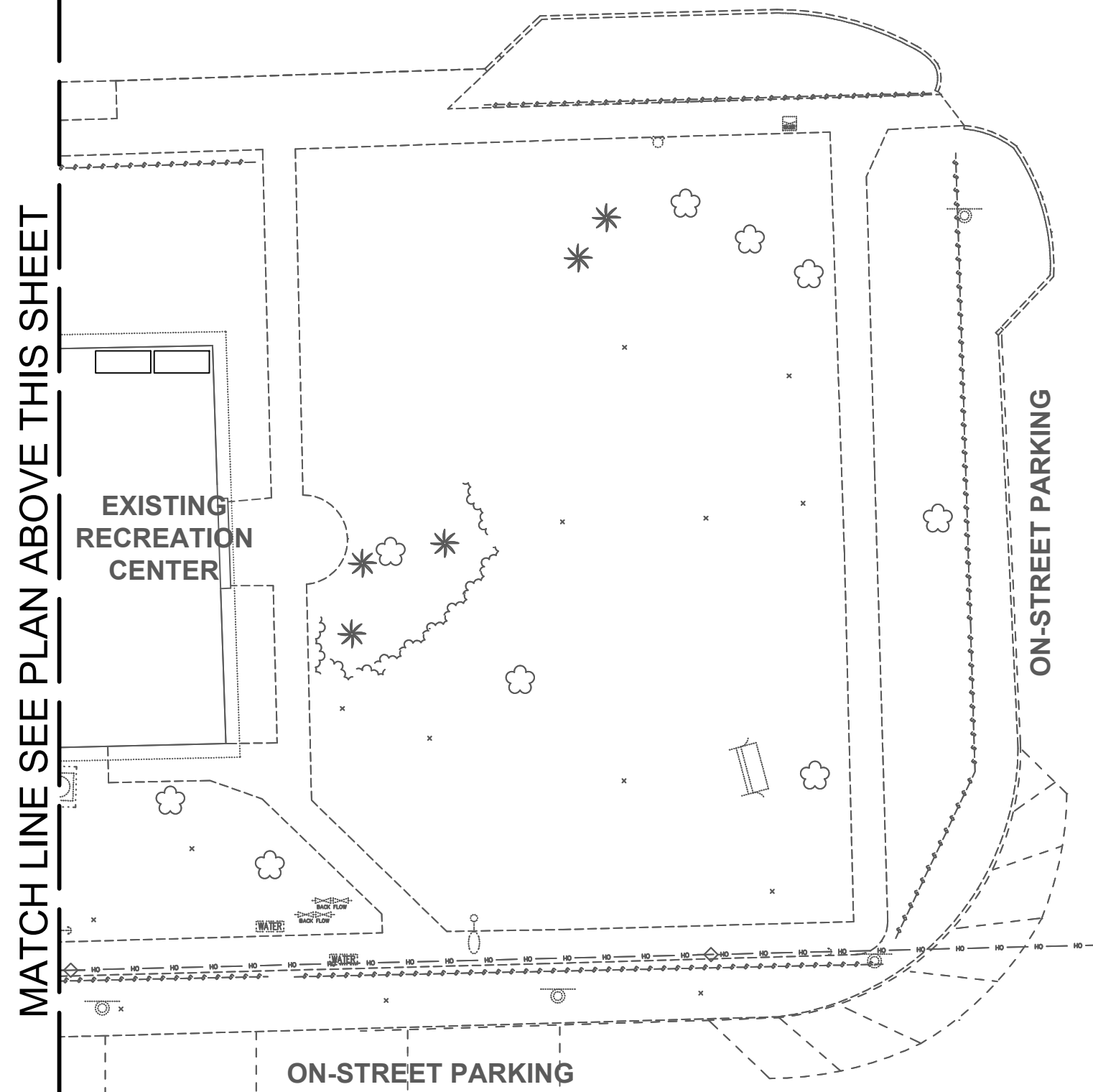

MATCH LINE SEE PLAN ABOVE THIS SHEET

2 PHOTOMETRIC SITE PLAN - EAST
 SCALE: 1" = 20'-0"

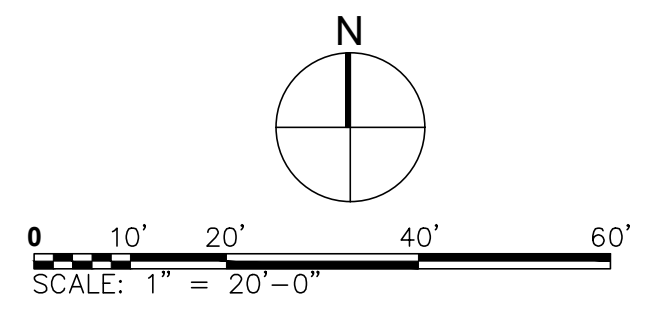

NOTICE: THE OFFICIAL RECORD OF THIS SHEET IS THE ELECTRONIC FILE SIGNED AND SEALED UNDER RULE 61G15-25.004, F.A.C.

Project Management Initials: _____ Designer: _____ Checked: _____ Approved: _____
 ANS I D 24" x 36"
 Last saved by: MERRITT.BIRD\2022.07.15 Last Printed: 2022.07.15
 Filename: C:\USERS\MERRITT.BIRD\ACDC\SAE\COMB\BP-AMER (USA) 60641343-FTL_PBP_DESIGN_SERVICES\PROJECT FILES\9000 DESIGN COLLABORATION\07_TO_704-RIVERSIDE\06-A-S-E-WP12668-E201-STPLN.DWG
 12/16/2022 8:35 AM



PROJECT RIVERSIDE PARK FORT LAUDERDALE PARKS BOND PROGRAM

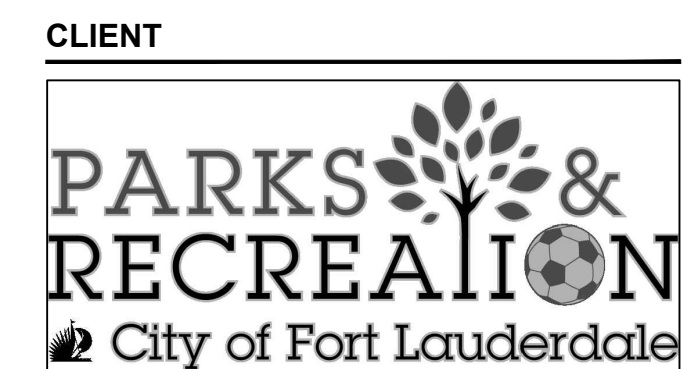

CONSULTANT AECOM 7650 W. COURTNEY CAMPBELL CAUSEWAY SUITE 700 TAMPA, FL 33607

CIVIL BCC ENGINEERING 305.670.2350 tel www.bcceng.com

LANDSCAPE CURTIS + ROGERS 305.442.1774 tel www.curtisrogers.com

MECHANICAL, PLUMBING AND FIRE PROTECTION HAMMOND AND ASSOCIATES CONSULTING 954.327.7111 tel www.hammondengineers.com

REGISTRATION

Table with 2 columns: DATE, DESCRIPTION. Includes entries for 07/18/2022 BID DOCUMENTS and 05/27/2022 CONSTRUCTION DOCUMENTS.

KEY PLAN

PROJECT NUMBER P12668

SHEET TITLE LIGHTING FIXTURE CUT SHEETS

SHEET NUMBER E502

NOTICE: THE OFFICIAL RECORD OF THIS SHEET IS THE ELECTRONIC FILE SIGNED AND SEALED UNDER RULE 61G15-25.004, F.A.C.

McGraw-Edison and GLEON Galleon Mounting Details. Includes diagrams for Standard Arm, Quick Mount Arm, QM and OMEA Pole Mount, QML Pole Mount, Standard Wall Mount, Mast Arm Mount, and Arm Mounting Requirements table.

Table with 8 columns: Number of Light Squares, Weight with Standard and Extended Arm, EPA with Standard and Extended Arm, Weight with QM Arm, EPA with QM Arm, Weight with OML, EPA with OML, Weight with OMEA, EPA with OMEA.

COOPER Lighting Solutions logo and contact information.

McGraw-Edison and GLEON Galleon Control Options. Includes diagrams for Enlightened Wireless Control and Monitoring System, Dimming Occupancy Sensor, and WaveLinX Wireless Outdoor Lighting Control Module.

COOPER Lighting Solutions logo and contact information.

McGraw-Edison and GLEON Galleon Ordering Information. Includes tables for Product Family, Options (Add as Suffix), Controls and Systems Options (Add as Suffix), and Accessories (Order Separately).

LumenSafe Integrated Network Security Camera Technology Options (Add as Suffix). Includes table with columns for Product Family, Camera Type, and Data Backhaul.

COOPER Lighting Solutions logo and contact information.

McGraw-Edison and GLEON Galleon Optical Distributions. Includes diagrams for Asymmetric Area Distributions, Asymmetric Roadway Distributions, Symmetric Distributions, Specialized Distributions, and Rotated Optics.

COOPER Lighting Solutions logo and contact information.

McGraw-Edison and GLEON Galleon Product Features. Includes Project/Notes table, Product Features list, Product Certifications, Connected Systems, and Dimensional Details table.

COOPER Lighting Solutions logo and contact information.

McGraw-Edison and GLEON Galleon Energy and Performance Data. Includes tables for Lumen Maintenance (TM-21) and Lumen Multiplier.

COOPER Lighting Solutions logo and contact information.

ANSI D 24" x 36" Approved: Designer: Project Management Initials: Last saved by: MERRITT BIRD(2022.07.15) Last Printed: 2022.07.15 File name: C:\USERS\MERRITT.BIRD\ACDC\SAE\COMB-AMER (USA) 60641343-FTL_PBP DESIGN SERVICES\PROJECT FILES\9000 DESIGN COLLABORATION\07_TO_704-RIVERSIDE\06-A-S-E-WIP\2668-E201-STPL\DWG



PROJECT
RIVERSIDE PARK
FORT LAUDERDALE
PARKS BOND PROGRAM

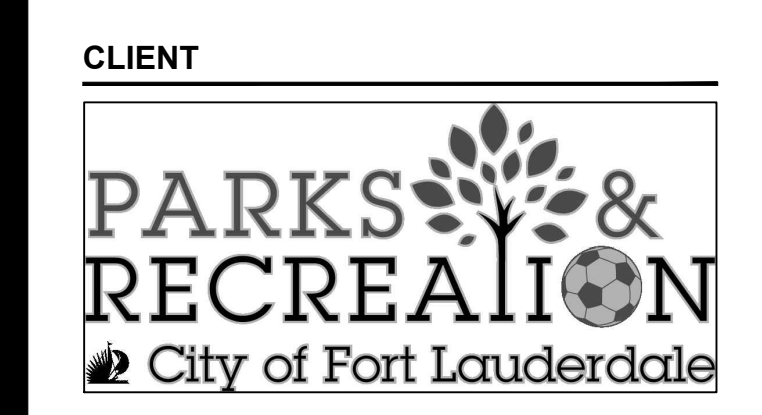

CONSULTANT
 AECOM
 7650 W. COURTNEY CAMPBELL CAUSEWAY
 SUITE 700
 TAMPA, FL 33607
 813.286.1711 tel 813.287.8591 fax
 www.aecom.com

REGISTRATION

ISSUE/REVISION	DATE	DESCRIPTION
1	07/18/2022	BID DOCUMENTS
1	05/27/2022	CONSTRUCTION DOCUMENTS
1	04/01/2022	DESIGN DEVELOPMENT

KEY PLAN

PROJECT NUMBER
 P12668

SHEET TITLE
 ELECTRICAL DETAILS

SHEET NUMBER
 E601

GENERAL NOTES:

- CONTRACTOR TO SUBMIT DESIGN WIND LOAD CALCULATIONS CERTIFYING CONFORMANCE OF POLE ASSEMBLY AS DICTATED BY THE FLORIDA BUILDING CODE. EACH CALCULATION SHALL BE SIGNED AND SEALED BY A STATE OF FLORIDA LICENSED STRUCTURAL ENGINEER.
- FURNISH AND INSTALL BUSSMAN "TRON" TYPE "HEB" IN-LINE WATERPROOF FUSE HOLDERS. FUSE WITH BUSSMAN TYPE "FNM" FUSES, FUSED AT 1.0A PER LIGHTING FIXTURE. LOCATE FUSES IN POLE HAND HOLE. PROVIDE SURGE PROTECTION DEVICE ON LOAD SIDE OF FUSES LOCATED IN POLE HANDHOLE.
- COORDINATE ALL WORK WITH CIVIL AND LANDSCAPE SITE PLANS.
- POLES SHALL BE FACTORY EQUIPPED WITH GROUNDING STUDS. EQUIPMENT GROUNDING CONDUCTOR SHALL BE BONDED TO THE GROUND STUD.
- PULLBOX MANUFACTURED BY QUAZITE W/TIER 22 DESIGN LOAD TO HAVE HEAVY-DUTY COPOLYMER FULL D.O.T. TRAFFIC RATED HANDHOLE WITH COVER (COVER TO READ "ELECTRICAL"), FURNISH AND INSTALL GRAVEL (1FT.) IN BOTTOM OF PULLBOX FOR DRAINAGE IN ACCORDANCE WITH MANUFACTURER'S INSTRUCTIONS. FIELD COORDINATE LOCATION OF PULLBOXES.
- ROUTE CONDUIT CONTINUOUS THRU POLE ASSEMBLY AND TERMINATE WITH INSULATION BUSHING AT HANDHOLE WINDOW.
- CONTRACTOR TO STAKE LOCATIONS OF LIGHTING POLES USING CIVIL DRAWINGS FOR APPROVAL BY CIVIL AND OWNER PRIOR TO INSTALLATION.

GENERAL NOTES:

- LIGHT CONTROL SHALL BE PHOTOCELL "ON", TIMECLOCK "OFF".
 - MOUNT ALL COMPONENTS SHOWN IN A NEMA 3R LOCKABLE ENCLOSURE, U.L. LABELED, WITH A MANUFACTURER MOUNTED STEEL BACK PLATE. ARRANGE ENCLOSURE TO HOUSE ALL COMPONENTS SHOWN, SUBMIT DIMENSIONED DETAIL OF ENCLOSURE SHOWING PLACEMENT OF TERMINAL STRIPS, TIMECLOCK, LIGHTING CONTACTOR, AND MAINTENANCE OVERRIDE SWITCH TO THE ELECTRICAL ENGINEER FOR APPROVAL.
 - LAMINATE ONE COPT OF THIS DETAIL AND SECURE IT TO THE INSIDE OF THE ENCLOSURE.
 - MOUNT CONTACTOR ENCLOSURE ADJACENT TO PANELBOARD.
- STT1 = MAINTENANCE OVERRIDE SWITCH, PUSHBUTTON TIMER SWITCH (WATTSTOPPER TS-400 OR EQUAL) LOCATED INSIDE CONTACTOR CABINET.
- PC = 120V PHOTOCELL, TORK, INTERMATIC, OR EQUAL. MOUNT ON SIDE OF CONTACTOR CABINET AND FACE NORTH.
- T1 = ASTRONOMICAL, 120V TIMECLOCK. TORK, INTERMATIC, OR EQUAL.
- C1 = 30A FULLY-RATED, 8-POLE NORMALLY OPEN ELECTRONICALLY HELD LIGHTING CONTACTOR WITH 120 VOLT HOLDING COIL. SQUARE-D TYPE 8903 OR EQUAL.

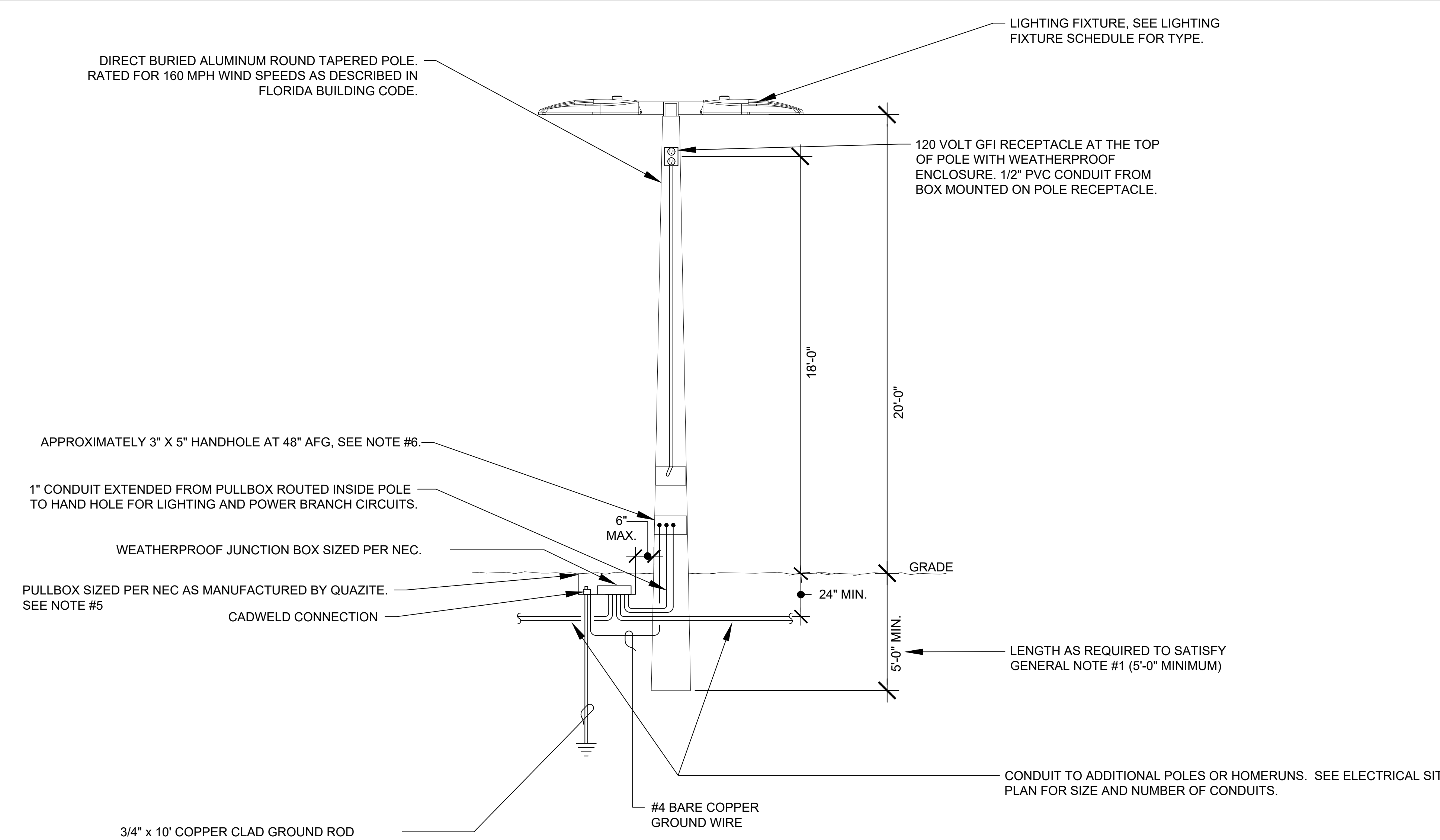

1 SITE LIGHTING FIXTURE POLE DETAIL
 SCALE: N.T.S.

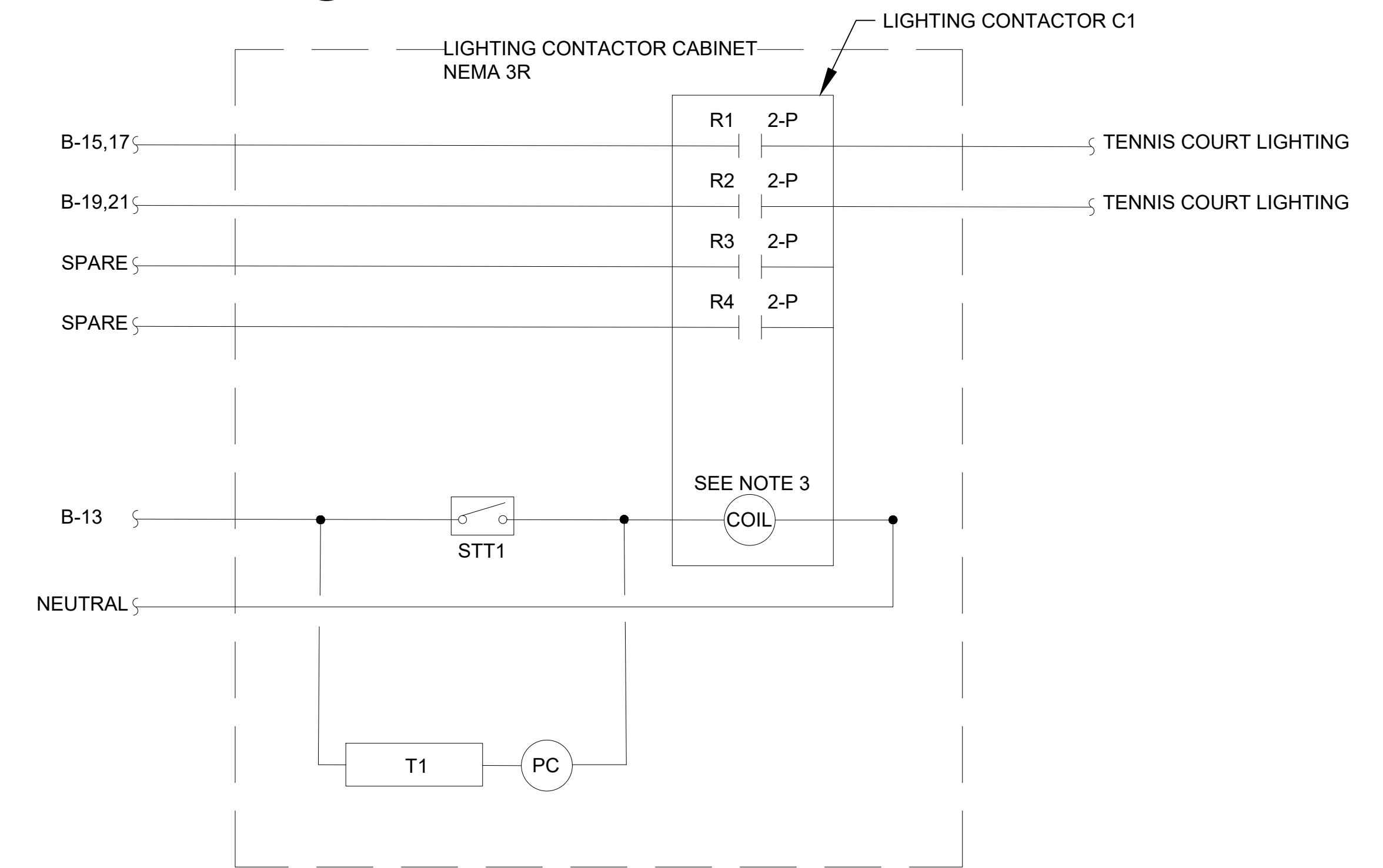

- NOTES:**
- LIGHTING CONDUITS AND CONDUCTORS ARE SHOWN ON PANEL SCHEDULES. SEE SHEET E301.
 - PROVIDE PHOTOCELL AND ALL CONNECTIONS FOR FULLY OPERABLE CONTROLS.
 - SQUARE D TYPE 8903 (OR APPROVED EQUAL) LIGHTING CONTACTOR WITH 120V HOLDING COIL.

2 LIGHTING CONTROL CABINET 'LCC'
 SCALE: N.T.S.

Project Management Initials: _____ Designer: _____ Checked: _____ Approved: _____
 Last saved by: MERRITT BIRD/2022.07.15 Last Printed: 2022.07.15
 Filename: C:\USERS\MERRITT.BIRD\ACDC\CSA\AECOM\BP-AMER (USA) 60641343-FTL_PBP DESIGN SERVICES\PROJECT FILES\9000 DESIGN COLLABORATION\07_TO 704-RIVERSIDE\06-A-S-E-WP12668-E201-STPLN.DWG
 12/16/2022 8:35 AM

NOTICE: THE OFFICIAL RECORD OF THIS SHEET IS THE ELECTRONIC FILE SIGNED AND SEALED UNDER RULE 61G15-23.004, F.A.C.

GENERAL NOTES

1. CONTRACTOR MUST VISIT THE SITE TO ACQUAINT THEMSELVES WITH THE EXISTING CONDITIONS AND FIELD VERIFY ALL DIMENSIONS, EVALUATIONS, UTILITIES, AND EXISTING CONDITIONS PRIOR TO CONSTRUCTION.

2. CONTRACTOR MUST REVIEW THE CONTRACT DOCUMENTS, VERIFY DIMENSIONS, ELEVATIONS, FIELD CONDITIONS, AND CONFIRM THAT THE WORK IS BUILDABLE AS SHOWN. REPORT ANY CONFLICTS, DISCREPANCIES, OR OMISSIONS TO THE DESIGNER IN WRITING FOR CLARIFICATION PRIOR TO PERFORMING THE WORK IN QUESTION.

3. ALL WORK MUST CONFORM TO THE CONTRACT DOCUMENTS, WHICH INCLUDES THE DRAWINGS.

4. IT IS UNDERSTOOD THAT THE DESIGNER OF RECORD MAKES NO WARRANTY, EITHER EXPRESSED OR IMPLIED, AS TO FINDINGS, DESIGNS, RECOMMENDATIONS, SPECIFICATIONS, OPINIONS, OR PROFESSIONAL ADVICES, EXCEPT THAT THESE INSTRUMENTS OR SERVICE HAVE BEEN PREPARED IN ACCORDANCE WITH THE CURRENT GENERALLY ACCEPTED PROFESSIONAL ENGINEER PRACTICES.

5. ALL WORK IS TO BE PERFORMED IN A SAFE, ORDERLY MANNER WITHOUT DAMAGE TO THE BUILDINGS, SIDEWALKS, ROADS, OR ADJACENT PROPERTIES. ANY RESULTING DAMAGE OR LOSS MUST BE CORRECTED OR REPLACED BY THE CONTRACTOR AT NO ADDITIONAL EXPENSE TO THE PROJECT CO.

6. THE CONTRACTOR IS SOLELY RESPONSIBLE FOR INITIATING, MAINTAINING, AND SUPERVISING ALL SAFETY PRECAUTIONS AND PROGRAMS IN CONNECTION WITH THE WORK ON THE PROJECT. TAKE ALL NECESSARY PRECAUTIONS FOR THE SAFETY OF ALL PERSONS AND PROTECT THEM AGAINST INJURY. PROTECT ALL PROPERTY AGAINST DAMAGE OR LOSS.

7. COMPLY WITH ALL APPLICABLE LAWS, ORDINANCES, RULES, REGULATIONS AND ORDERS OF ANY PUBLIC BODY HAVING JURISDICTION FOR THE SAFETY OF PERSONS OR PROPERTY.

8. "TYPICAL" OR "TYP" MEANS THAT THE CONDITIONS ARE REPRESENTATIVE THROUGHOUT UNLESS OTHERWISE NOTED.

9. "SIMILAR" OR "SIM" MEANS COMPARABLE IN CHARACTERISTICS FOR THE CONDITIONS NOTED. VERIFY DIMENSIONS AND ORIENTATION ON THE PLANS AND ELEVATIONS.

10. "OPP" MEANS REVERSED OR OPPOSITE HAND FOR THE CONDITIONS NOTED.

11. "NIC" OR "BY OTHERS" MEANS ITEMS OR WORK IS PROVIDED UNDER A SEPARATE CONTRACT.

12. NOTES ON SPECIFIC DRAWINGS WILL TAKE PRECEDENCE OVER GENERAL NOTES IF CONFLICTS OCCUR.

13. ALL SIGN MOUNTING TO COMPLY WITH CURRENT WIND LOAD REQUIREMENTS.

14. ALL MESSAGES SHOWN ON THESE DRAWINGS ARE TO BE CONSIDERED PLACEHOLDERS AND MUST BE VERIFIED BY OWNER DURING THE SHOP DRAWING REVIEW PHASE.

15. THESE DRAWINGS EXPRESS VISUAL DESIGN INTENT ONLY. FINAL ENGINEERING, MATERIALS, AND FABRICATION SHALL REMAIN THE RESPONSIBILITY OF THE SIGN CONTRACTOR.

16. REMOVE EXISTING BUILDING TACTILE ROOM IDENTITY SIGNS. SIGN CONTRACTOR TO INSTALL NEW TACTILE ROOM IDENTITY SIGNS AFTER COMPLETION OF BUILDING REPAIR.

SHOP DRAWINGS

1. REVIEW OF SHOP DRAWINGS BY THE OWNER OR OWNER REPRESENTATIVE IS LIMITED TO COMPLIANCE OF THE COMPLETED STRUCTURE WITH THE DESIGN CONCEPT AND INFORMATION GIVEN IN THE CONTRACT DOCUMENTS. THE CONTRACTOR IS SOLELY RESPONSIBLE FOR DIMENSIONS, QUANTITIES, PERFORMANCE, SAFETY, COORDINATION WITH OTHER WORK, AND ALL OTHER REQUIREMENTS OF THE CONTRACT DOCUMENTS. REVIEW DOES NOT AUTHORIZE CHANGES TO CONTRACT.

2. SHOP DRAWINGS MUST HAVE BEEN CHECKED BY, AND STAMPED WITH THE APPROVAL OF THE OWNER OR OWNER REPRESENTATIVE PRIOR TO BEGINNING ANY WORK. THE DATA SHOWN ON THE SHOP DRAWINGS MUST BE COMPLETE WITH RESPECT TO DIMENSIONS, DESIGN CRITERIA, AND CONTENT.

SIGN LOCATION NOTES

1. EACH SIGN HAS BEEN ASSIGNED A UNIQUE SIGN NUMBER.

2. ALL SIGN LOCATIONS MUST BE VERIFIED IN THE FIELD AND APPROVED BY OWNER OR OWNER REPRESENTATIVE PRIOR TO INSTALLATION. CONTRACTOR TO CALL OUT ANY CONFLICTS IN WRITING PRIOR TO FABRICATION.

**PROJECT**

RIVERSIDE PARK
FORT LAUDERDALE
PARKS BOND PROGRAM

CLIENT**CONSULTANT**

AECOM

7650 W. COURTNEY CAMPBELL CAUSEWAY
SUITE 700
TAMPA, FL 33607
813.286.1711 tel 813.287.8591 fax
www.aecom.com

SUB-CONSULTANT

CIVIL
BCC ENGINEERING
305.670.2350 tel
www.bcceng.com

LANDSCAPE
CURTIS + ROGERS
305.442.1774 tel
www.curtisrogers.com

GEOTECHNICAL SERVICES
GEOSOL, INC.
305.828.4367 tel
www.geosol.net

SURVEYOR
PDS, INC.
954.237.7850 tel
www.pds-eng.com

MECHANICAL, PLUMBING AND FIRE PROTECTION
HAMMOND AND ASSOCIATES CONSULTING
954.327.7111 tel
www.hammondengineers.com

REGISTRATION**ISSUE/REVISION**

I/R	DATE	DESCRIPTION
I	07/18/2022	BID DOCUMENTS
I	05/27/2022	CONSTRUCTION DOCUMENTS
I	04/01/2022	DESIGN DEVELOPMENT

KEY PLAN**PROJECT NUMBER**

P12668

SHEET TITLE

SIGNAGE AND WAYFINDING
GENERAL NOTES

SHEET NUMBER

W001

PROJECT
RIVERSIDE PARK
FORT LAUDERDALE
PARKS BOND PROGRAM

CLIENT
PARKS & RECREATION
City of Fort Lauderdale

CONSULTANT
AECOM
7650 W. COURTNEY CAMPBELL CAUSEWAY
SUITE 700
TAMPA, FL 33607
813.286.1711 tel 813.287.8591 fax
www.aecom.com

SUB-CONSULTANT
CIVIL
BCC ENGINEERING
305.670.2350 tel
www.bcceng.com
LANDSCAPE
CURTIS + ROGERS
305.442.1774 tel
www.curtisrogers.com
GEOTECHNICAL SERVICES
GEOSOL, INC.
305.828.4367 tel
www.geosol.net
SURVEYOR
PDS, INC.
954.237.7850 tel
www.pds-eng.com
MECHANICAL, PLUMBING AND FIRE PROTECTION
HAMMOND AND ASSOCIATES CONSULTING
954.327.7111 tel
www.hammondengineers.com

REGISTRATION

ISSUE/REVISION

I/R	DATE	DESCRIPTION
1	07/18/2022	BID DOCUMENTS
1	05/27/2022	CONSTRUCTION DOCUMENTS
1	04/01/2022	DESIGN DEVELOPMENT

KEY PLAN

PROJECT NUMBER
P12668

SHEET TITLE
GRAPHIC STANDARDS

SHEET NUMBER
W002



WORK SANS REGULAR
ABCDEFGHIJKLMNOPQRSTUVWXYZ
abcdefghijklmnopqrstuvwxyz
1234567890

WORK SANS MEDIUM
ABCDEFGHIJKLMNOPQRSTUVWXYZ
abcdefghijklmnopqrstuvwxyz
1234567890

1 **TYPESTYLE**
Not to Scale

2 **LOGO**
Not to Scale

SUBSTRATES

- S1 ALUMINUM
- S2 OOLITE STONE
- S3 DIRECT EMBED WOOD FINISH
- S4 CORTEN
- S5 WHITE TRANSLUCENT ACRYLIC
- S6 1/8" ZINC NATURAL FINISH

PAINT

- P1 MATTHEWS ACRYLIC POLYURETHANE SATIN FINISH MP 87478
- P2 MATTHEWS ACRYLIC POLYURETHANE SATIN FINISH MP 468
- P3 MATTHEWS ACRYLIC POLYURETHANE SATIN FINISH MP 471
- P4 MATTHEWS ACRYLIC POLYURETHANE SATIN FINISH MP 70743
- P5 MATTHEWS ACRYLIC POLYURETHANE SATIN FINISH BRUSHED ALUMINUM MP 41342
- P6 MATTHEWS ACRYLIC POLYURETHANE SATIN FINISH WHITE WONDER MP 32071
- P7 MATTHEWS ACRYLIC POLYURETHANE SATIN FINISH BLACK IS BACK MP 59647
- P8 MATTHEWS ACRYLIC POLYURETHANE SATIN FINISH WILDERNESS CABIN MP 7185

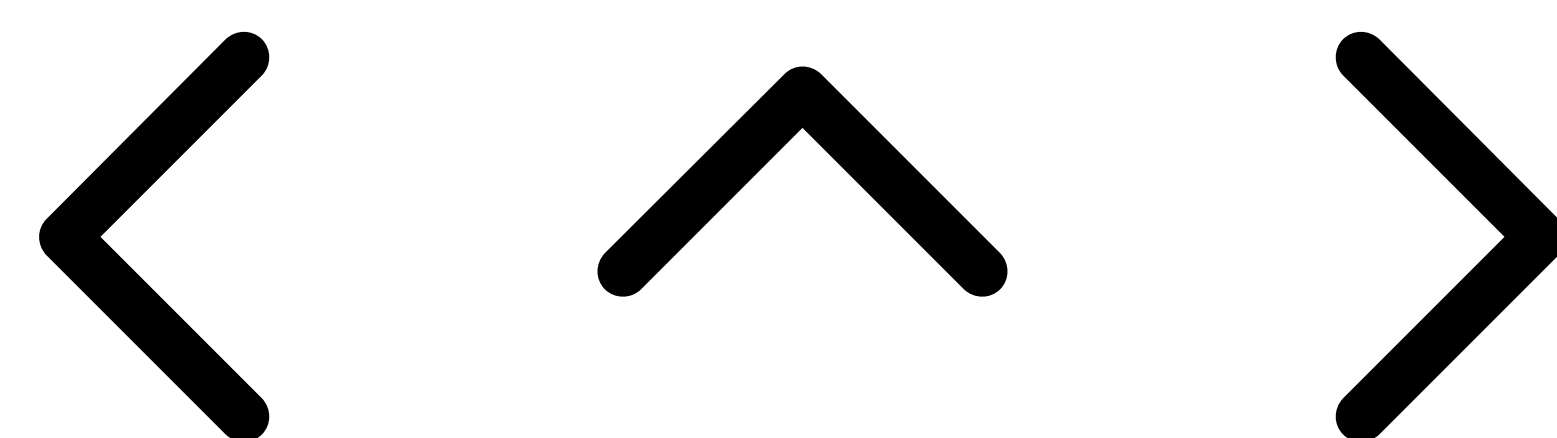

3 **MATERIALS AND FINISHES**
Not to Scale

4 **ARROW**
Not to Scale

ANSI D 24" x 36" Approved: _____ Checked: _____ Designer: _____ Project Management Initials: _____
Last saved by: JOHN ROQUE(2022-07-11) Last Picked: 2022-07-15
Filename: C:\USERS\JOHN.ROQUE\ACCORDS\AECOM\BP-AMER (USA) 60641343-FTL PBP DESIGN SERVICES\PROJECT FILES\900 DESIGN COLLABORATION\907_TO 7104-RIVERSIDE\06-A-A-E-WP12668-W101-OVRL-STPLN.DWG
12/16/2022 8:35 AM

I/R	DATE	DESCRIPTION
1	07/18/2022	BID DOCUMENTS
1	05/27/2022	CONSTRUCTION DOCUMENTS
1	04/01/2022	DESIGN DEVELOPMENT

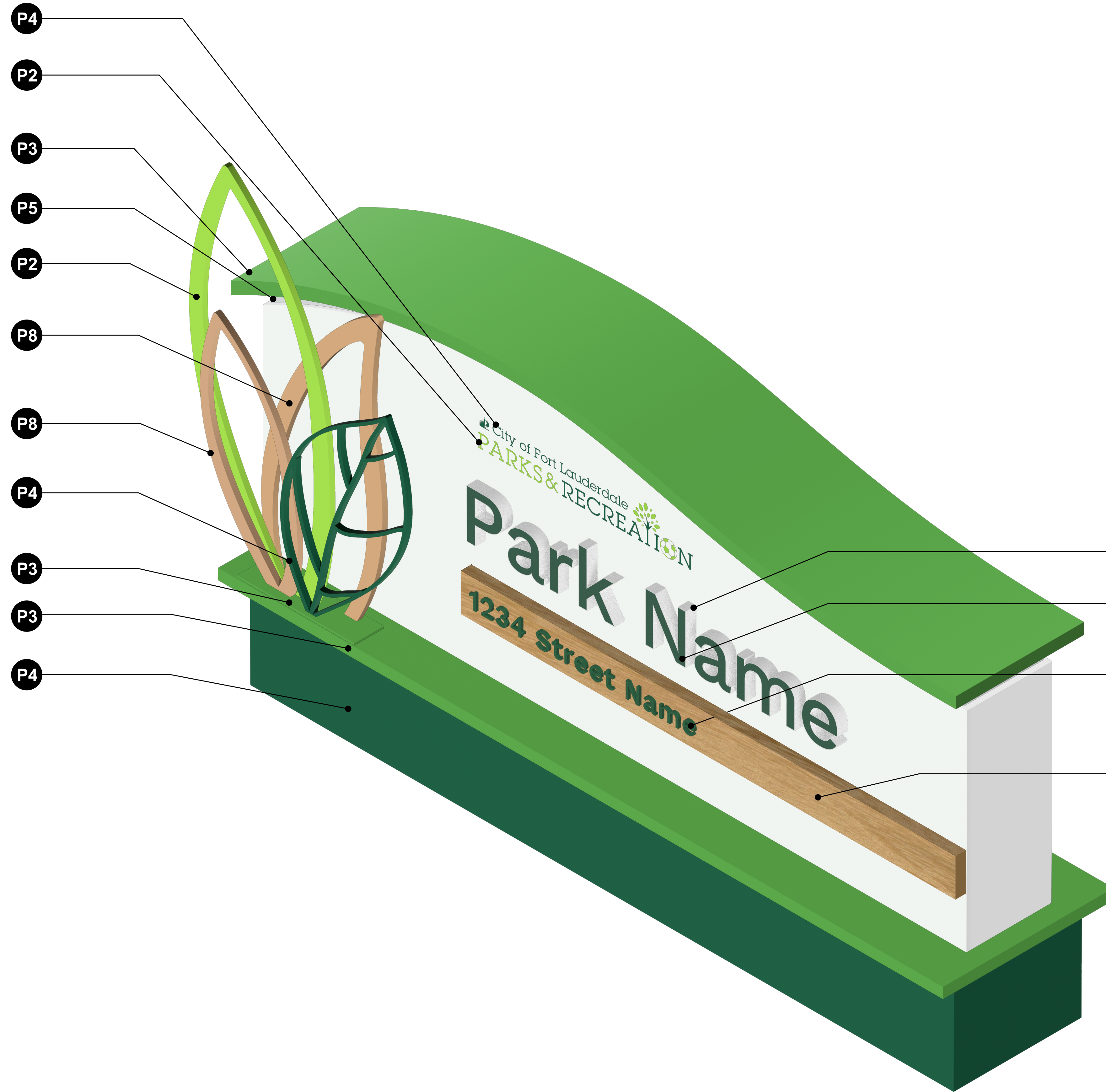

1

STANDARD SIGN FINISHES
1 1/2" = 1' 0"

PAINT BACKSIDE
OF ALL LEAVES THE
SAME COLOR AS
THE FRONT

PAINT BACKSIDE
OF ALL LEAVES THE
SAME COLOR AS
THE FRONT

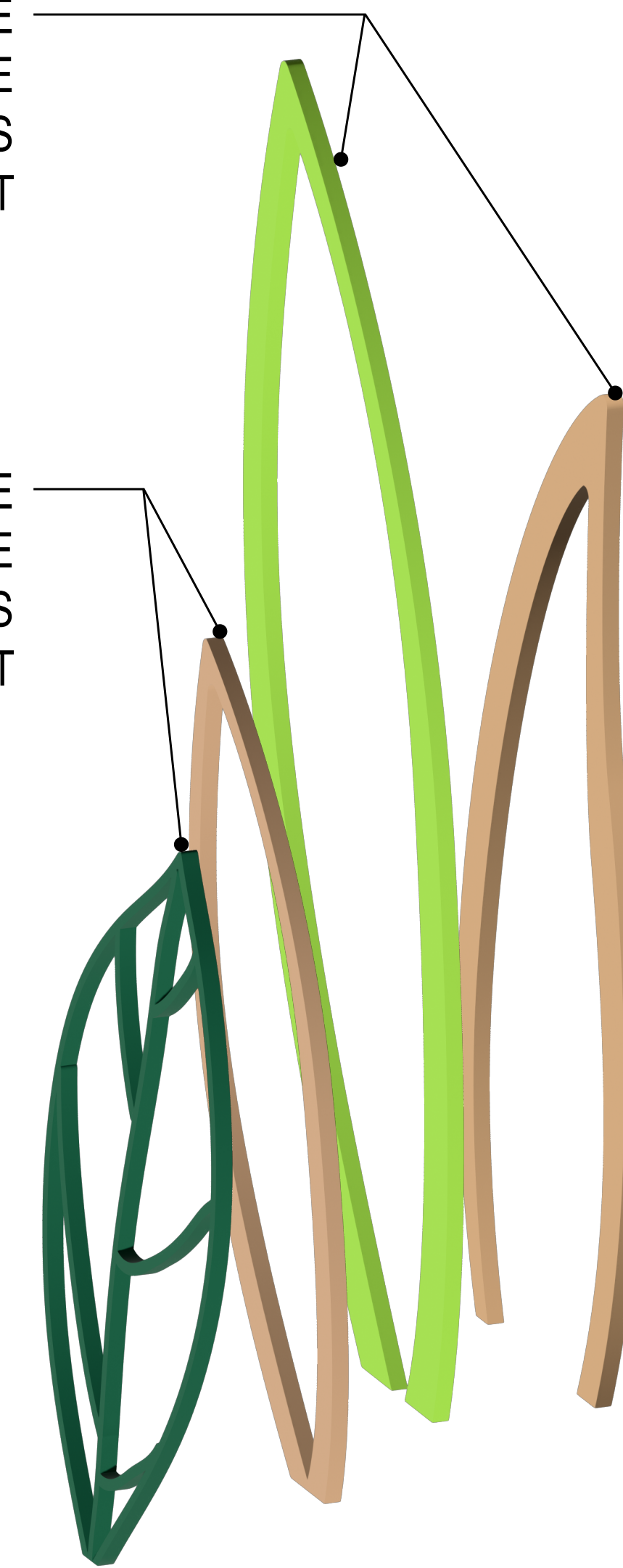

ASSEMBLY ORDER

1

LEAF DETAIL ASSEMBLY
1 1/2" = 1' 0"



PROJECT
 RIVERSIDE PARK
 FORT LAUDERDALE
 PARKS BOND PROGRAM

CLIENT

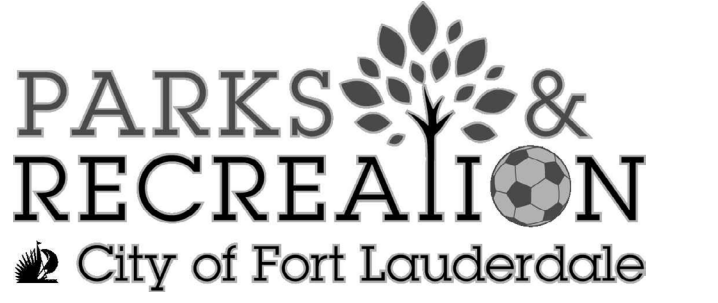

CONSULTANT

AECOM
 7650 W. COURTNEY CAMPBELL CAUSEWAY
 SUITE 700
 TAMPA, FL 33607
 813.286.1711 tel 813.287.8591 fax
 www.aecom.com

SUB-CONSULTANT

CIVIL
 BCC ENGINEERING
 305.670.2350 tel
 www.bcceng.com

LANDSCAPE
 CURTIS + ROGERS
 305.442.1774 tel
 www.curtisrogers.com

GEOTECHNICAL SERVICES
 GEOSOL, INC.
 305.828.4367 tel
 www.geosol.net

SURVEYOR
 PDS, INC.
 954.237.7850 tel
 www.pds-eng.com

MECHANICAL, PLUMBING AND FIRE PROTECTION
 HAMMOND AND ASSOCIATES CONSULTING
 954.327.7111 tel
 www.hammondengineers.com

REGISTRATION

ISSUE/REVISION

I/R	DATE	DESCRIPTION
1	07/18/2022	BID DOCUMENTS
1	05/27/2022	CONSTRUCTION DOCUMENTS
1	04/01/2022	DESIGN DEVELOPMENT

KEY PLAN

PROJECT NUMBER

P12668

SHEET TITLE

OVERALL SIGN LOCATION
 PLAN

SHEET NUMBER

W101

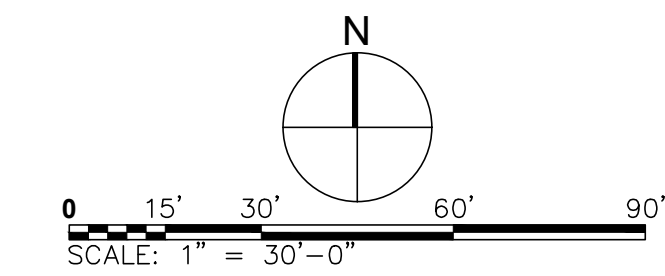
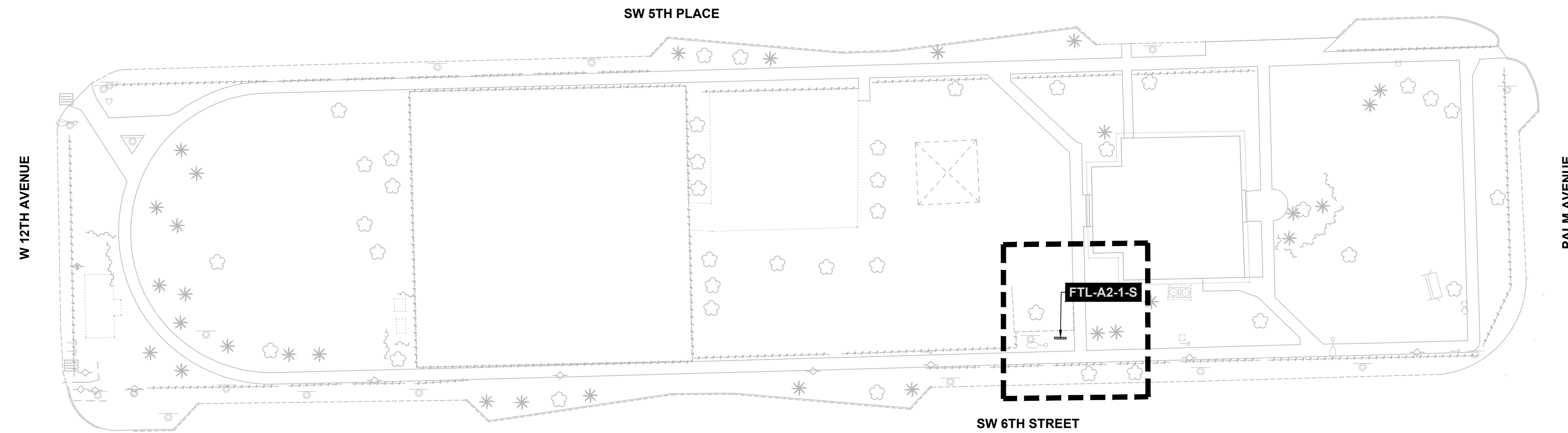
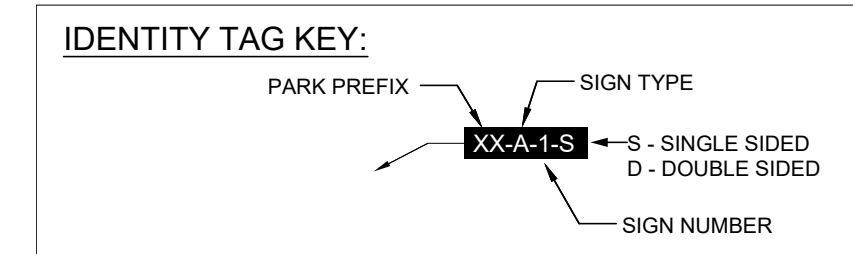

Project Management Initials: _____ Designer: _____ Checked: _____ Approved: _____
 ANS I D 24" x 36"
 Last saved by: JOHN ROQUE(2022-07-11) - Last Plotted: 2022-07-15
 Filename: C:\USERS\JOHN.ROQUE\ACCD\CSAECOM\BP-AMER (USA) 60641345-FTL PBP DESIGN SERVICES\PROJECT FILES\900 DESIGN COLLABORATION\907_TO 7104-RIVERSIDE\06-A-S-E-WP12668-W101-OVRL-STPLN.DWG



PROJECT
RIVERSIDE PARK
FORT LAUDERDALE
PARKS BOND PROGRAM

CLIENT

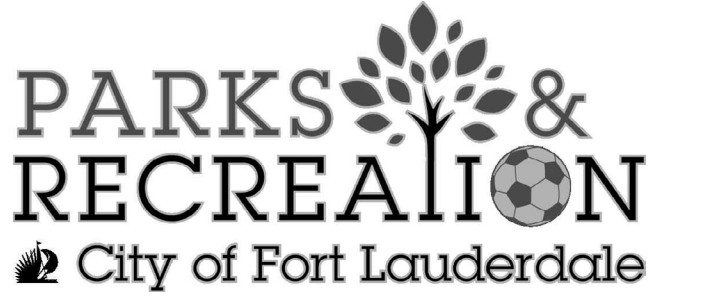

CONSULTANT

AECOM
 7650 W. COURTNEY CAMPBELL CAUSEWAY
 SUITE 700
 TAMPA, FL 33607
 813.286.1711 tel 813.287.8591 fax
 www.aecom.com

SUB-CONSULTANT

CIVIL
BCC ENGINEERING
 305.670.2350 tel
 www.bcceng.com

LANDSCAPE
CURTIS + ROGERS
 305.442.1774 tel
 www.curtisrogers.com

GEOTECHNICAL SERVICES
GEOSOL, INC.
 305.828.4367 tel
 www.geosol.net

SURVEYOR
PDS, INC.
 954.237.7850 tel
 www.pds-eng.com

MECHANICAL, PLUMBING AND FIRE PROTECTION
HAMMOND AND ASSOCIATES CONSULTING
 954.327.7111 tel
 www.hammondengineers.com

REGISTRATION

ISSUE/REVISION

I/R	DATE	DESCRIPTION
1	07/18/2022	BID DOCUMENTS
1	05/27/2022	CONSTRUCTION DOCUMENTS
1	04/01/2022	DESIGN DEVELOPMENT

KEY PLAN

PROJECT NUMBER

P12668

SHEET TITLE

SIGN LOCATION PLAN
 ENLARGEMENT

SHEET NUMBER

W102

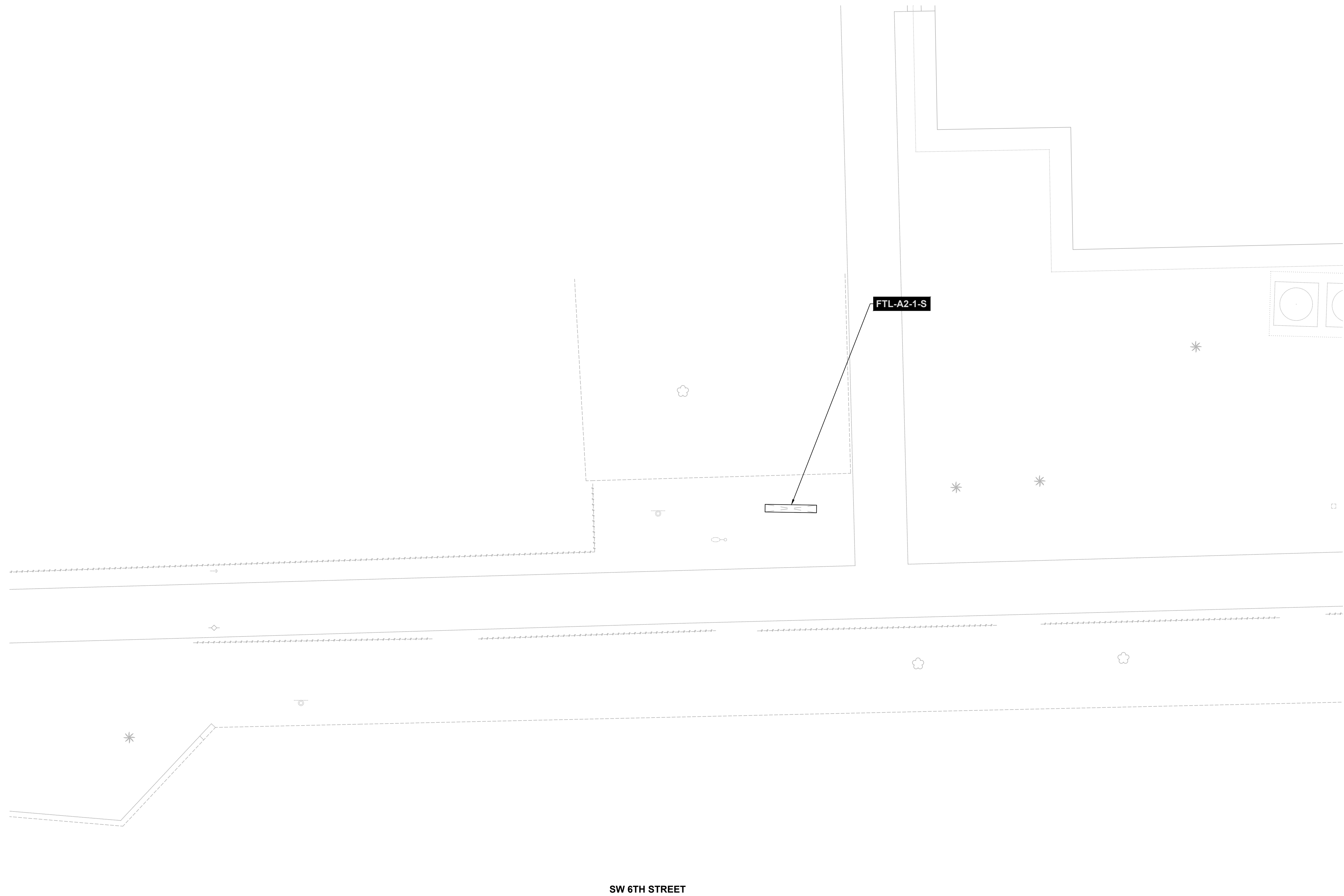
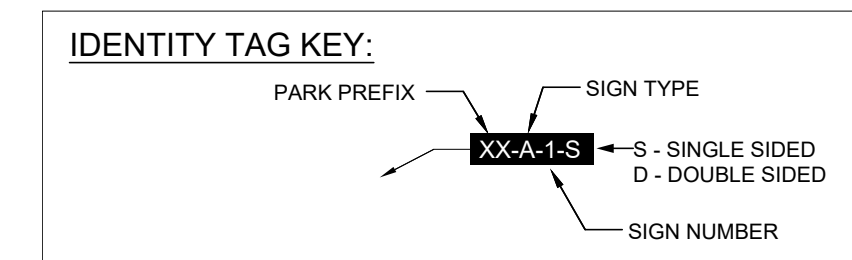

SW 6TH STREET

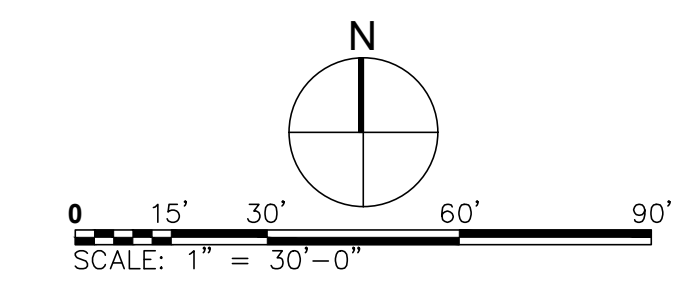

ANSI D 24" x 36" Approved: _____ Checked: _____ Designer: _____ Project Management Initials: _____

Last saved by: JOHN ROQUE(2022-07-11) _Last Plotted: 2022-07-15
 Filename: C:\USERS\JOHN.ROQUE\ACCD\CSAECOM\BP-AMER (USA) 60641343-FTL_PBP DESIGN SERVICES\PROJECT FILES\900 DESIGN COLLABORATION\07_TO 7104-RIVERSIDE\06-A-S-E-WP12668-W101-OVRL-STPLN.DWG



PROJECT
 RIVERSIDE PARK
 FORT LAUDERDALE
 PARKS BOND PROGRAM

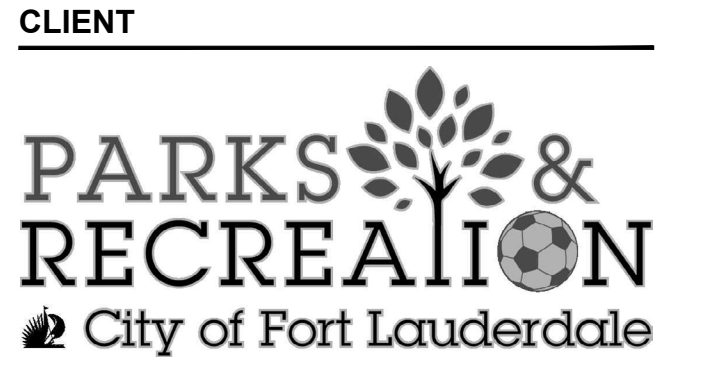

CONSULTANT
 AECOM
 7650 W. COURTNEY CAMPBELL CAUSEWAY
 SUITE 700
 TAMPA, FL 33607
 813.286.1711 tel 813.287.8591 fax
 www.aecom.com

SUB-CONSULTANT
 CIVIL
BCC ENGINEERING
 305.670.2350 tel
 www.bcceng.com
 LANDSCAPE
CURTIS + ROGERS
 305.442.1774 tel
 www.curtisrogers.com

GEOTECHNICAL SERVICES
GEOSOL, INC.
 305.828.4367 tel
 www.geosol.net

SURVEYOR
PDS, INC.
 954.237.7850 tel
 www.pds-eng.com

MECHANICAL, PLUMBING AND FIRE PROTECTION
HAMMOND AND ASSOCIATES CONSULTING
 954.327.7111 tel
 www.hammondengineers.com

REGISTRATION

ISSUE/REVISION

I/R	DATE	DESCRIPTION
1	07/18/2022	BID DOCUMENTS
1	05/27/2022	CONSTRUCTION DOCUMENTS
1	04/01/2022	DESIGN DEVELOPMENT

KEY PLAN

PROJECT NUMBER
 P12668

SHEET TITLE
 SIGN TYPE A2

SHEET NUMBER
 W201

Project Management Initials: _____ Designer: _____ Checked: _____ Approved: _____ ANS I D 24" x 36"

Last saved by: JOHN ROQUE(2022-07-11) - Last Picked: 2022-07-15
 Filename: C:\USERS\JOHN.ROQUE\ACCORDS\AECOM\BP-AMER (USA) 60641344-FTL PBP DESIGN SERVICES\PROJECT FILES\900 DESIGN COLLABORATION\07_TO 7104-RIVERSIDE\06-A-E-WP12668-W101-OVRL-STPLN.DWG

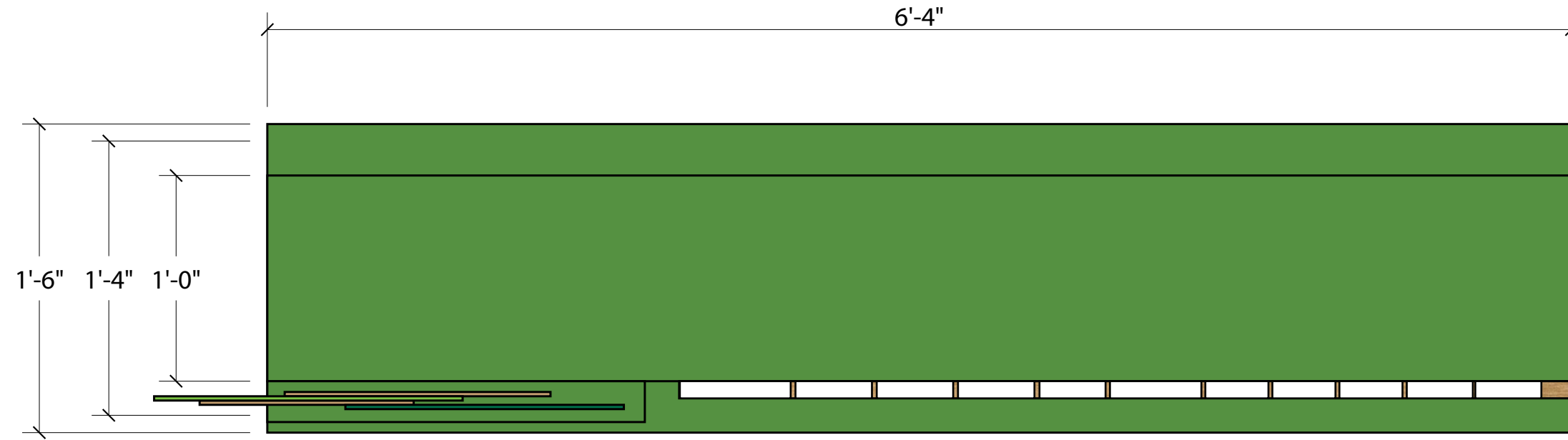

1

SIGN TYPE A2 PLAN VIEW

1 1/2" = 1'0"

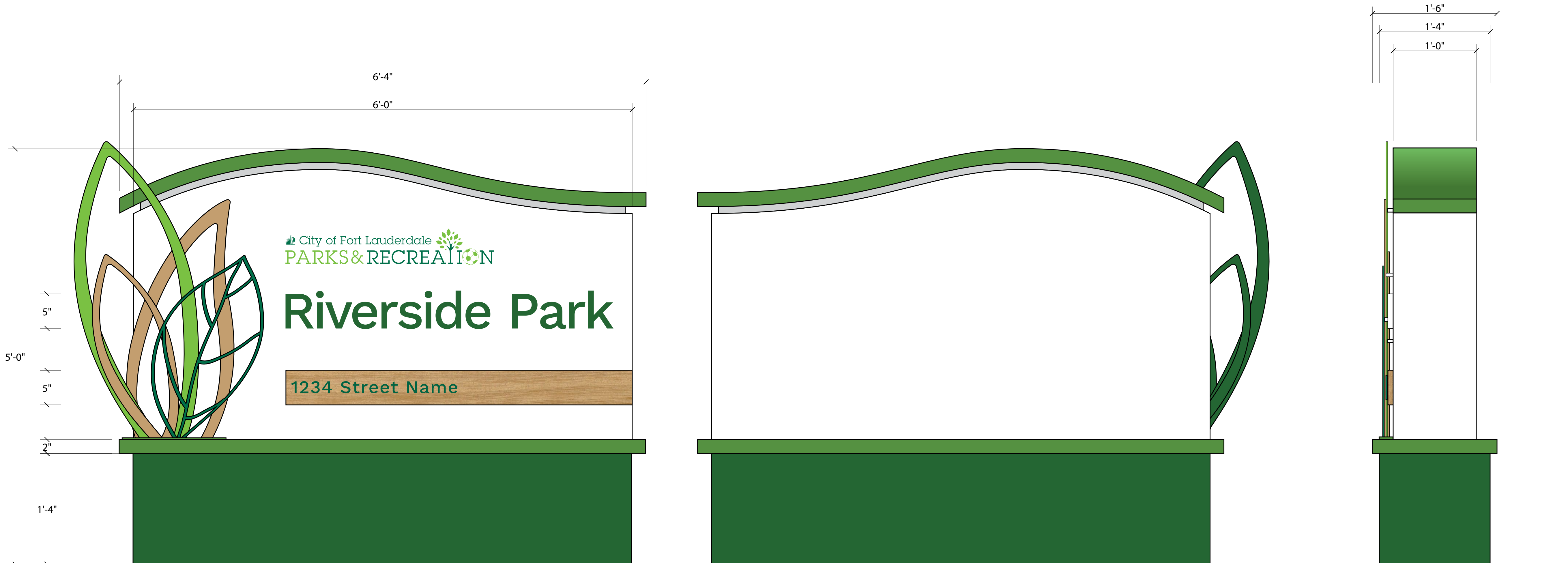

2

SIGN TYPE A2 ELEVATION VIEW

1 1/2" = 1'0"

I/R	DATE	DESCRIPTION
1	07/18/2022	BID DOCUMENTS
1	05/27/2022	CONSTRUCTION DOCUMENTS
1	04/01/2022	DESIGN DEVELOPMENT

Project Management Initials: _____ Designer: _____ Checked: _____ Approved: _____ ANS I D 24" x 36"

Last saved by: JOHN ROQUE(2022-07-11) - Last Picked: 2022-07-15
 Filename: C:\USERS\JOHN.ROQUE\ACCORDS\AECOM\BP-AMER (USA) 60641343-FTL_PBP DESIGN SERVICES\PROJECT FILES\900 DESIGN COLLABORATION\07_TO 7104-RIVERSIDE\06-A-E-WP12668-W101-OVRL-STPLN.DWG

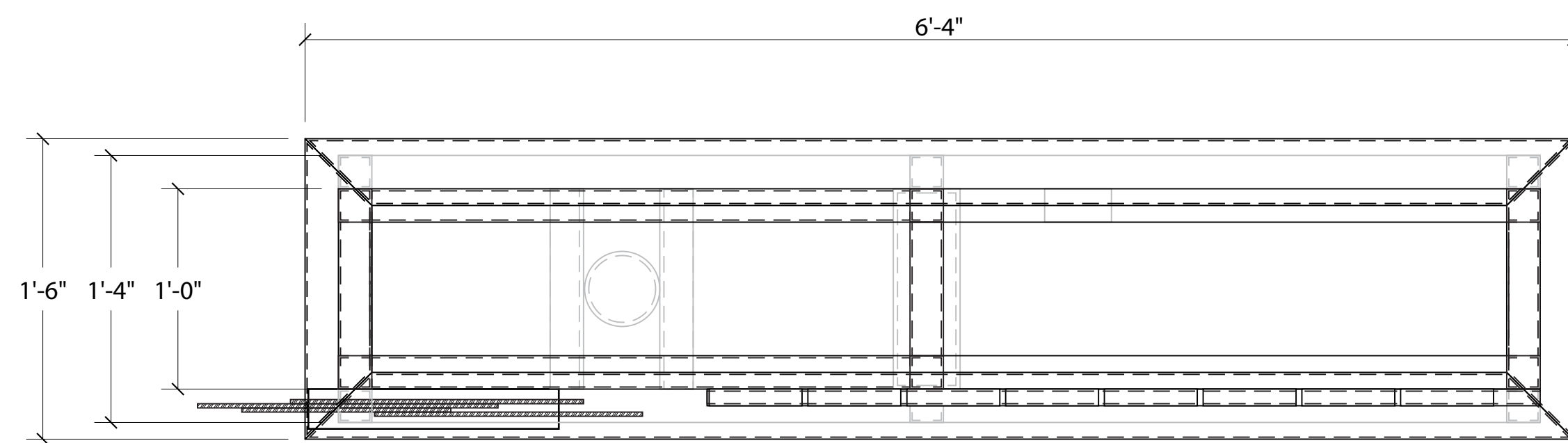

1

SIGN TYPE A2 PLAN VIEW

1 1/2" = 1' 0"

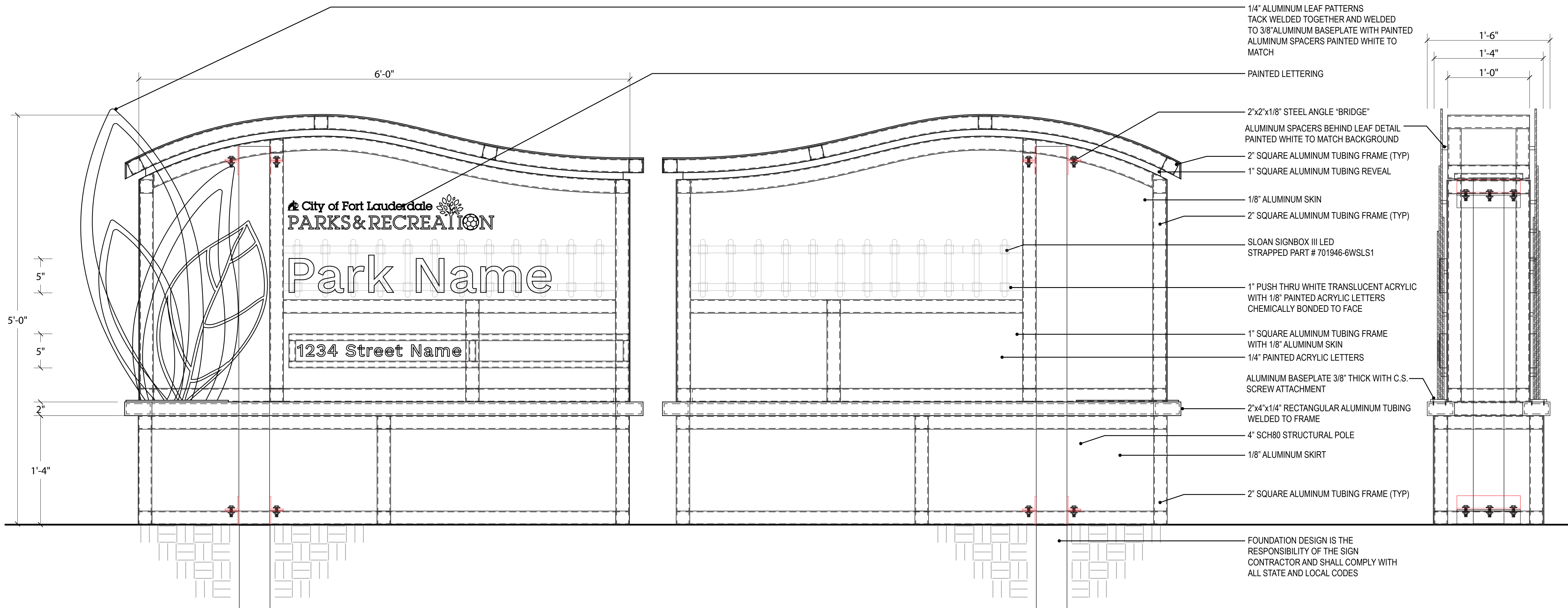

2

SIGN TYPE A2 ELEVATION VIEW

1 1/2" = 1' 0"

ISSUE/REVISION

I/R	DATE	DESCRIPTION
1	07/18/2022	BID DOCUMENTS
1	05/27/2022	CONSTRUCTION DOCUMENTS
1	04/01/2022	DESIGN DEVELOPMENT

KEY PLAN

PROJECT NUMBER
P12668

SHEET TITLE
ADA SIGNAGE
SIGN TYPE G1-G6

SHEET NUMBER
W301

Project Management Initials: _____ Designer: _____ Checked: _____ Approved: _____
ANSI D 24" x 36"

File saved by: JOHN ROULIE(2022-07-11) Last Picked: 2022-07-15
Filename: C:\USERS\JOHN.ROULIE\ACCD\CSAECOM\BP-AMER (USA) 60641345-FTL PBP DESIGN SERVICES\PROJECT FILES\900 DESIGN COLLABORATION\07_TO 7104-RIVERSIDE\06-A-E-WP12668-W101-OVRL-STPLN.DWG

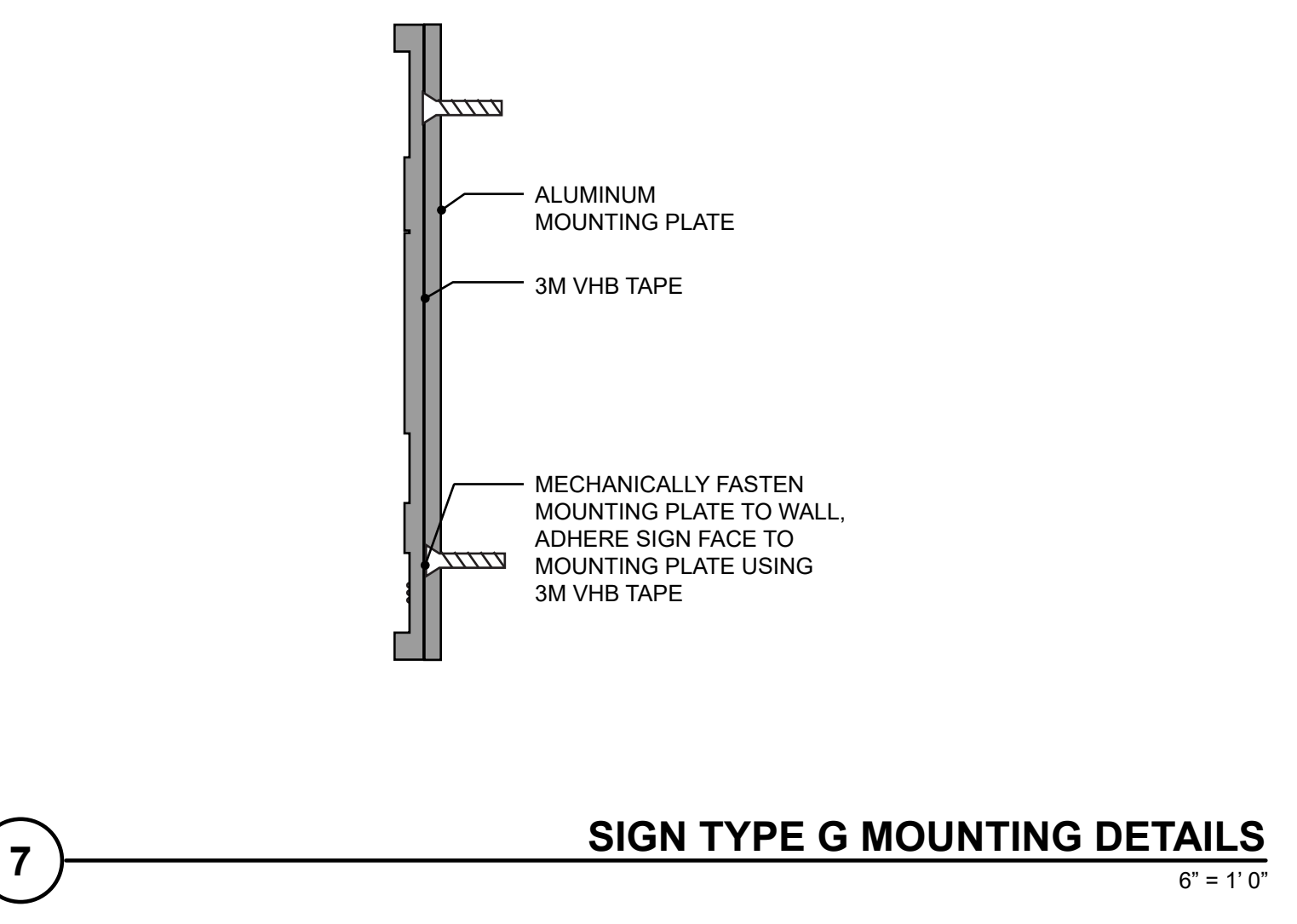
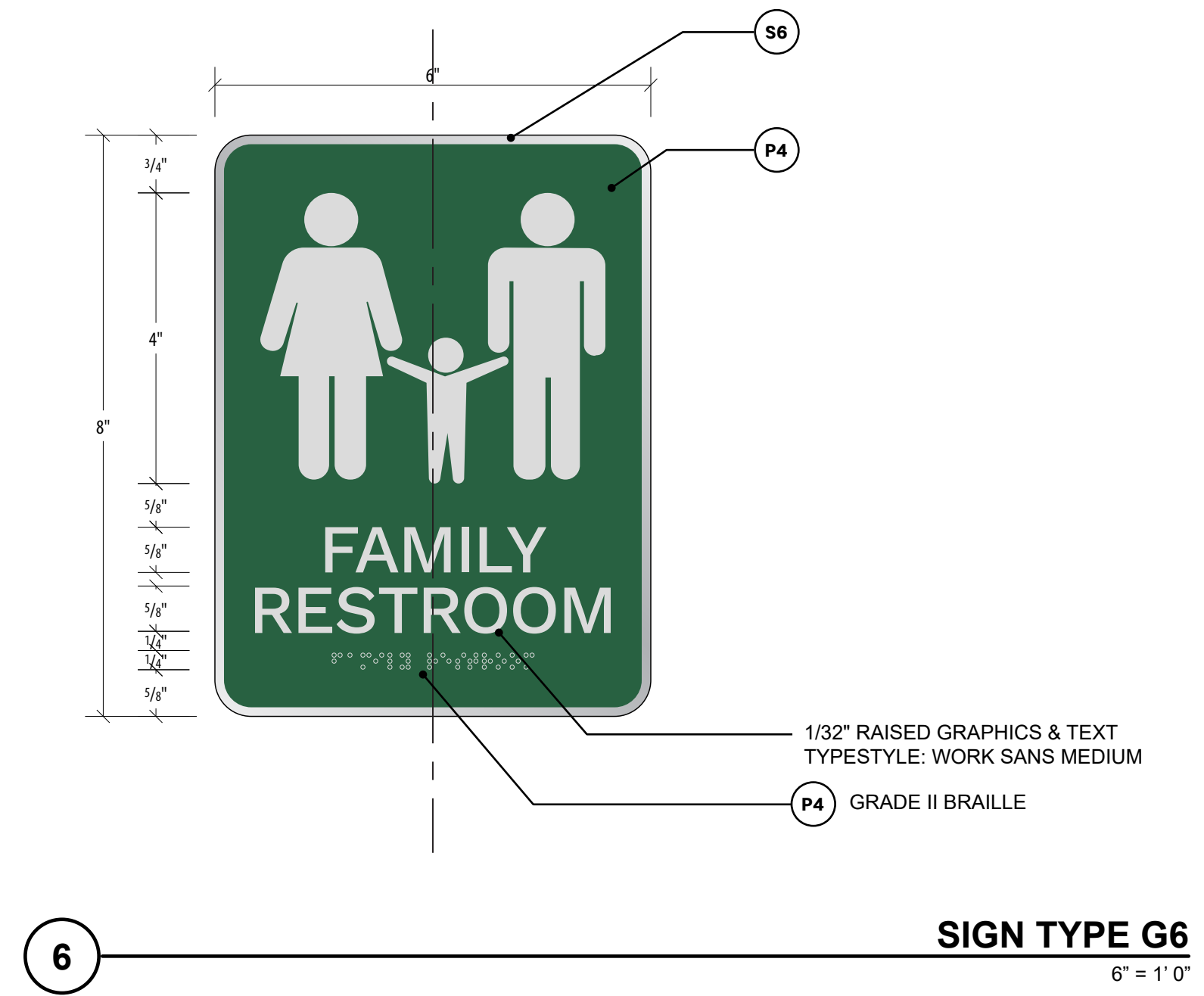
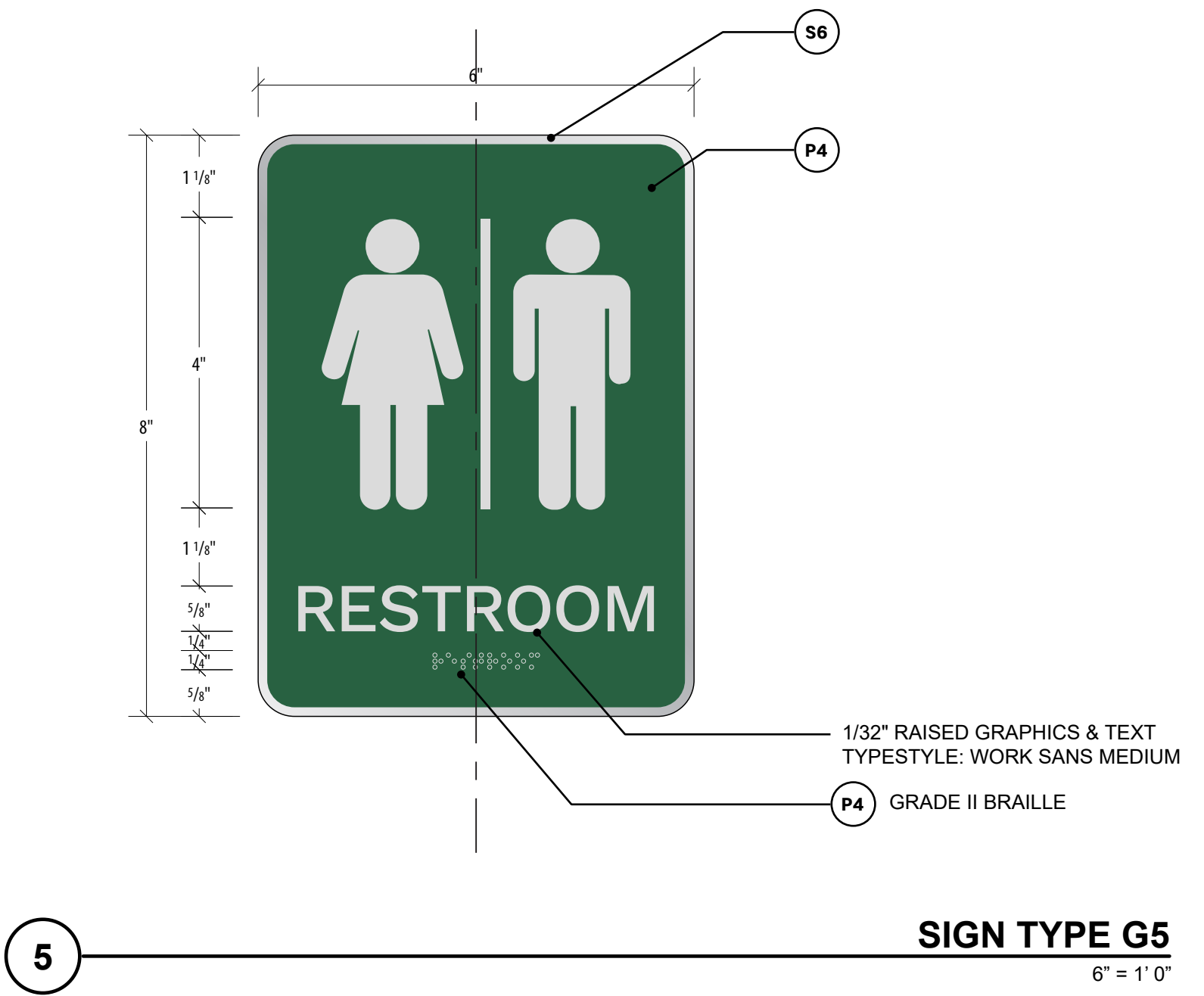
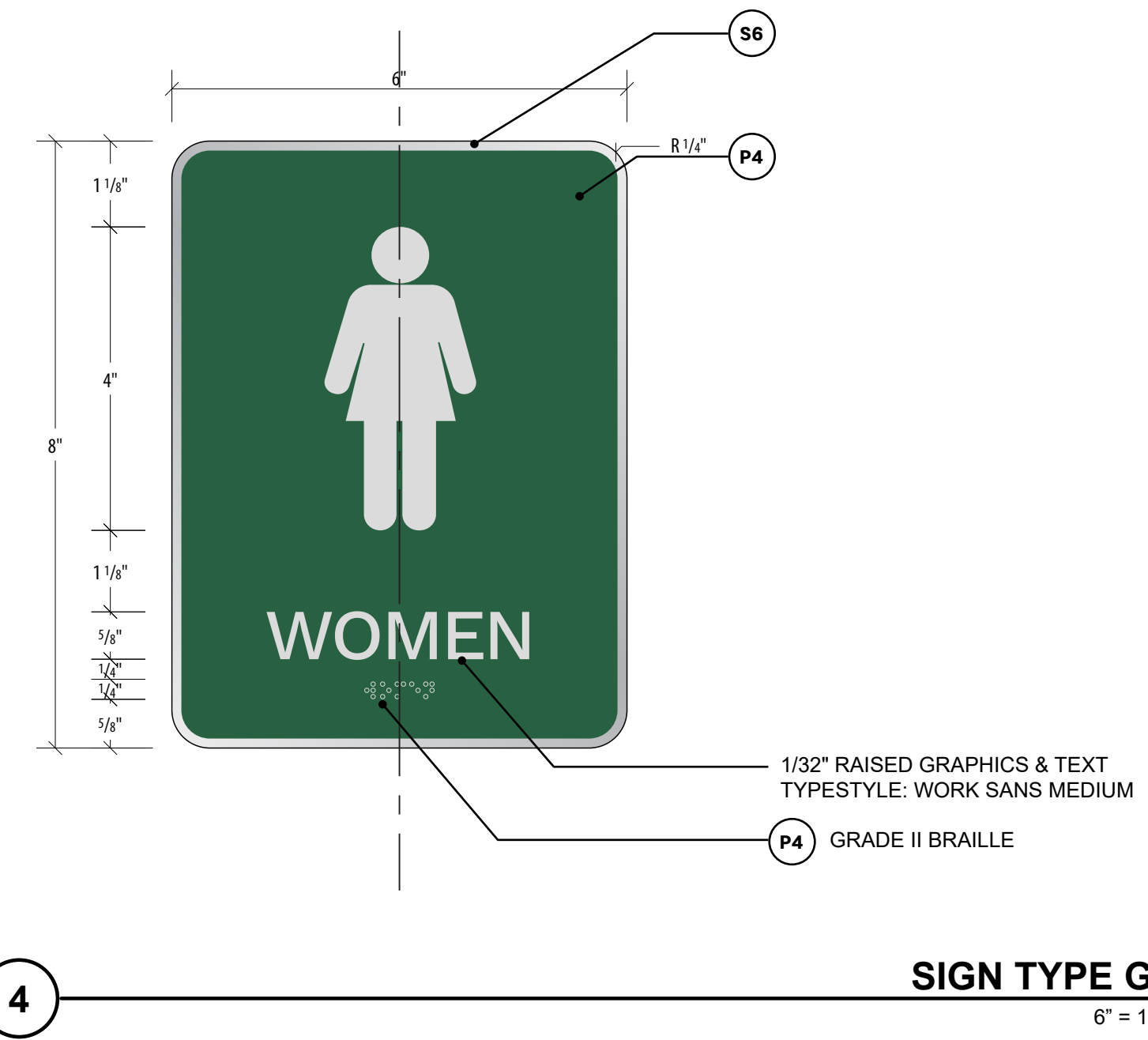
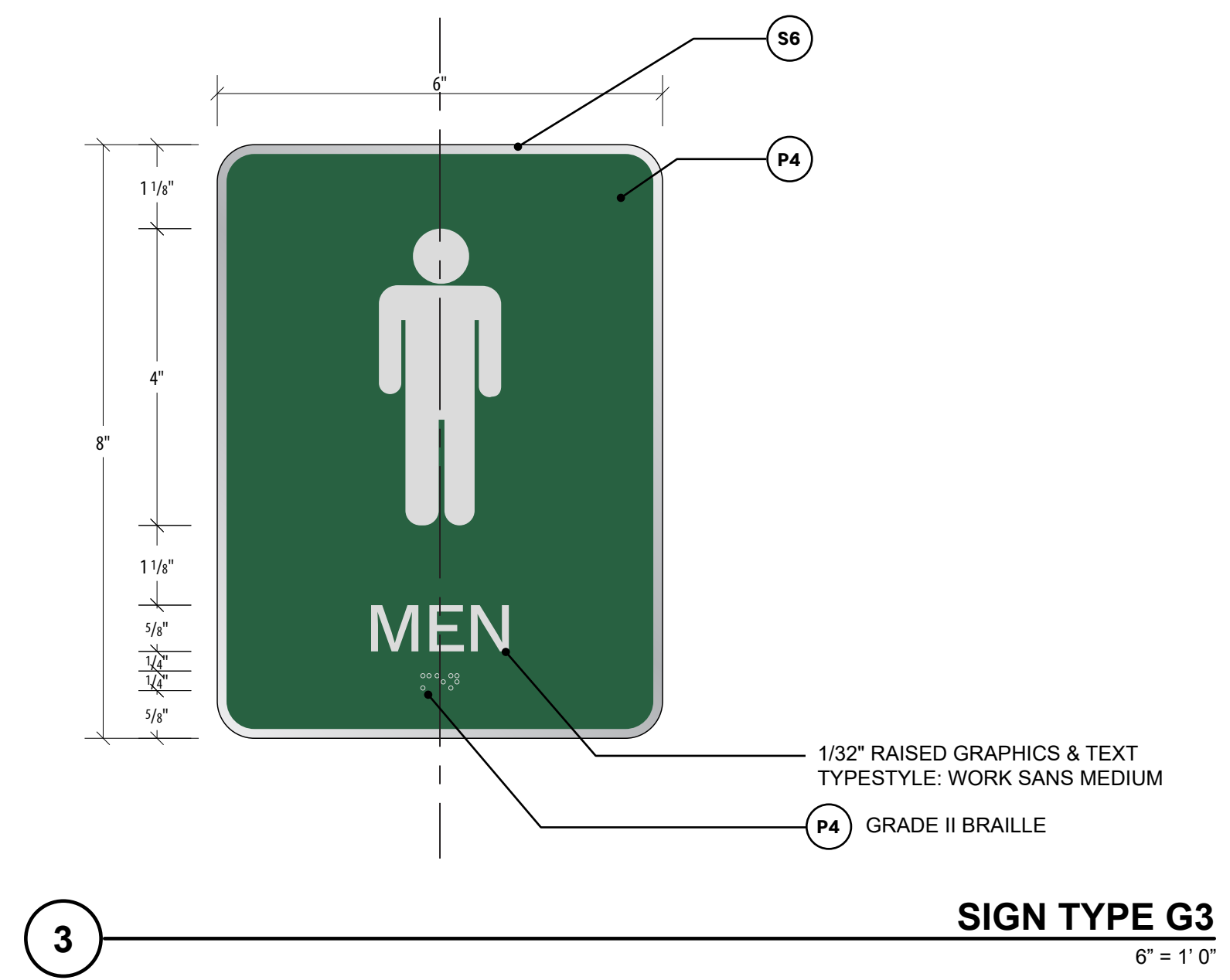
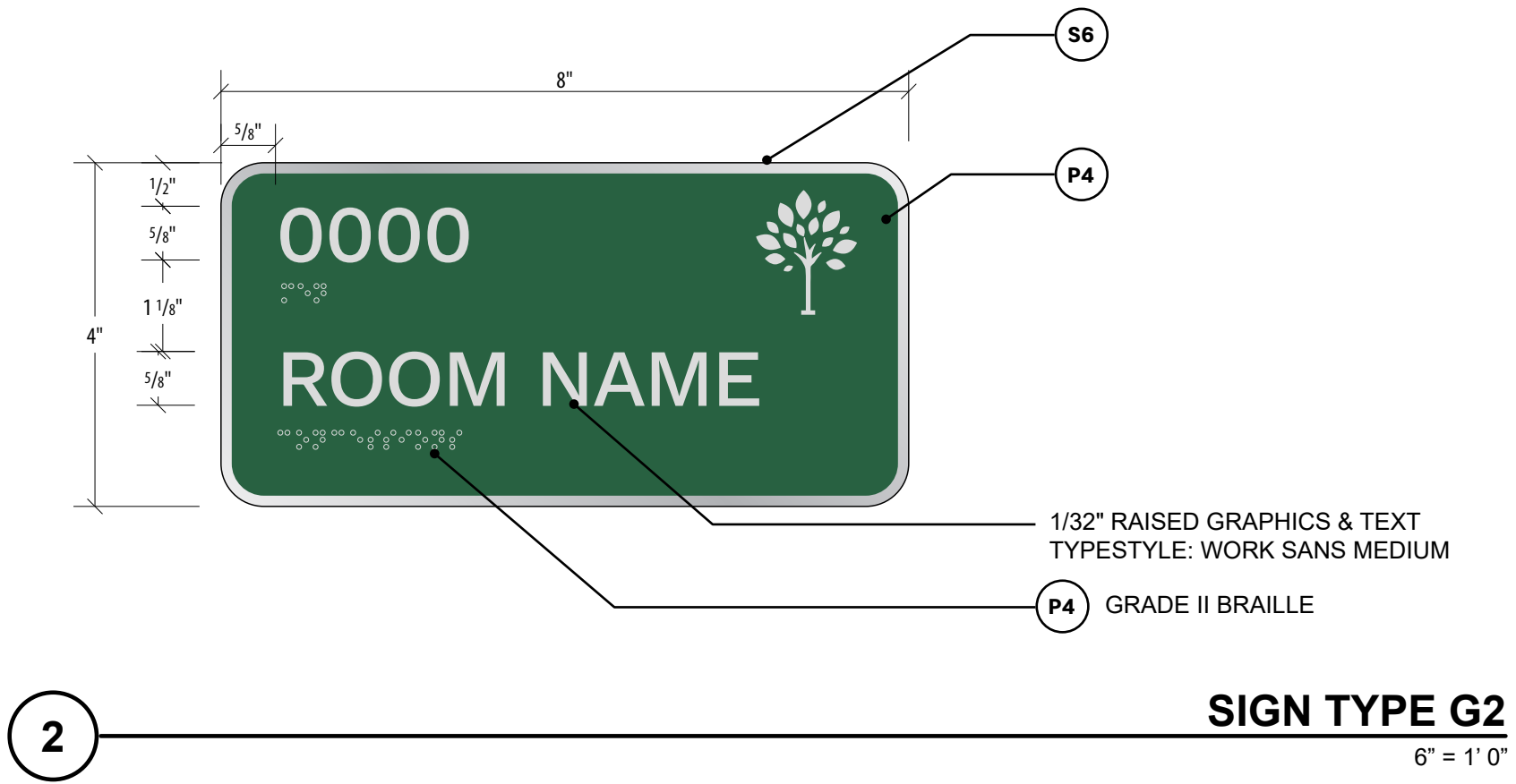
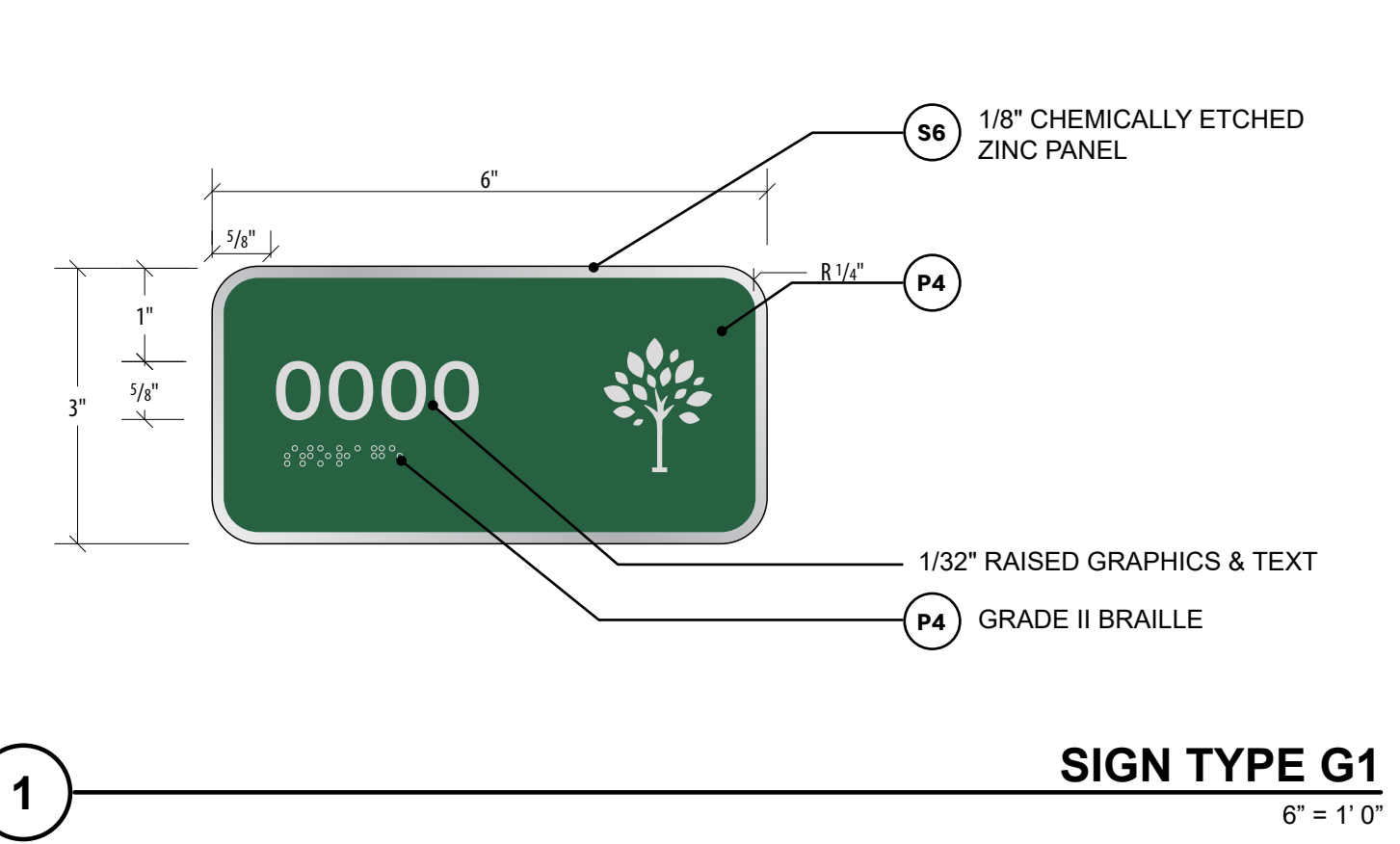

NOTES
Refer to sheet A101 for architectural plans with room designations.

QUESTIONNAIRE SHEET

PLEASE PRINT OR TYPE:

Firm Name:

President

Business Address:

Telephone:

Fax:

E-Mail Address:

What was the last project of this nature which you completed? Include the year, description, and contract value.

The following are named as three corporations and representatives of those corporations for which you have performed work similar to that required by this contract, and which the City may contact as your references (include addresses, telephone numbers and e-mail addresses). Include the project name, year, description, and contract value.

How many years has your organization been in business?

Have you ever failed to complete work awarded to you; if so, where and why?

The name of the qualifying agent for the firm and his position is:

Certificate of Competency Number of Qualifying Agent:

Effective Date: Expiration Date:

Licensed in: Engineering Contractor's License #

(County/State)

Expiration Date:

NOTE: To be considered for award of this contract, the bidder must submit a financial statement upon request.

NOTE: Contractor must have proper licensing and shall provide copy of same with his proposal.

QUESTIONNAIRE SHEET

1. Have you personally inspected the proposed work and have you a complete plan for its performance?

2. Will you sublet any part of this work? If so, list the portions or specialties of the work that you will.

a)

b)

c)

d)

e)

f)

g)

3. What equipment do you own that is available for the work?

4. What equipment will you purchase for the proposed work?

5. What equipment will you rent for the proposed work?

TRENCH SAFETY

Bidder acknowledges that included in the appropriate bid items of his bid and in the Total Bid Price are costs for complying with the Florida Trench Safety Act, Florida Statutes 553.60 – 553.64. The bidder further identifies the costs of such compliance to be summarized below:

Trench Safety Measure (Description)	Units of Measure (LF/SF)	Unit (Quantity)	Unit Cost	Extended Cost
A. <input type="text"/>	<input type="text"/>	<input type="text"/>	\$ <input type="text"/>	\$ <input type="text"/>
B. <input type="text"/>	<input type="text"/>	<input type="text"/>	\$ <input type="text"/>	\$ <input type="text"/>
C. <input type="text"/>	<input type="text"/>	<input type="text"/>	\$ <input type="text"/>	\$ <input type="text"/>
D. <input type="text"/>	<input type="text"/>	<input type="text"/>	\$ <input type="text"/>	\$ <input type="text"/>

Total: \$

The bidder certifies that all trench excavation done within his control in excess of five feet (5') in depth shall be in accordance with the Occupational Safety and Health Administration's excavation safety standards, C.F.R. s. 1926.650 Subpart P., and the Florida Trench Safety Act, Florida Statutes 553.60-553.64.

Failure to complete the above may result in the bid being declared non-responsive.

DATE:

(SIGNATURE)

STATE OF: COUNTY OF:

PERSONALLY APPEARED BEFORE ME, the undersigned authority,

(Name of Individual Signing)

who, after first being duly sworn by me,
 affixed his/her signature in the space provided above on this
 day of , 20 .

NOTARY PUBLIC

My Commission Expires:

NON-COLLUSION STATEMENT:

By signing this offer, the vendor/contractor certifies that this offer is made independently and *free* from collusion. Vendor shall disclose below any City of Fort Lauderdale, FL officer or employee, or any relative of any such officer or employee who is an officer or director of, or has a material interest in, the vendor's business, who is in a position to influence this procurement.

Any City of Lauderdale FL officer or in writing of specifications or requirements, solicitation of offers, decision to award, evaluation of offers, or any other activity pertinent to this procurement is presumed, for purposes hereof, to be in a position to influence this procurement.

For purposes hereof, a person has a material interest if they directly or indirectly own more than 5 percent of the total assets or capital stock of any business entity, or if they otherwise stand to personally gain if the contract is awarded to this vendor.

 **Text Box: 3.3. City employees may not contract with the City through any corporation or business entity in which they or their immediate family members hold a controlling financial interest (e.g. ownership of five (5) percent or more). 3.4. Immediate family members (spouse, parents and children) are also prohibited from contracting with the City subject to the same general rules.**

In accordance with City of Fort Lauderdale, FL Policy and Standards Manual, 6.10.8.3,

Failure of a vendor to disclose any relationship described herein shall be reason for debarment in accordance with the provisions of the City Procurement Code.

Name

Relationships

In the event the vendor does not indicate any names, the City shall interpret this to mean that the vendor has indicated that no such relationships exist.

Authorized Signature

Title

Name (Printed)

Date

**CONTRACTOR'S CERTIFICATE OF COMPLIANCE WITH
NON-DISCRIMINATION PROVISIONS OF THE CONTRACT**

The completed and signed form should be returned with the Contractor's submittal. If not provided with submittal, the Contractor must submit within three business days of City's request. Contractor may be deemed non-responsive for failure to fully comply within stated timeframes.

Pursuant to the City Ordinance Sec. 2-187(c), bidders must certify compliance with the Non-Discrimination provision of the ordinance.

The Contractor shall not, in any of his/her/its activities, including employment, discriminate against any individual on the basis of race, color, national origin, religion, creed, sex, disability, sexual orientation, gender, gender identity, gender expression, or marital status.

1. The Contractor certifies and represents that he/she/it will comply with Section 2-187, Code of Ordinances of the City of Fort Lauderdale, Florida, as amended by Ordinance C-18-33 (collectively, "Section 2-187").
2. The failure of the Contractor to comply with Section 2-187 shall be deemed to be a material breach of this Agreement, entitling the City to pursue any remedy stated below or any remedy provided under applicable law.
3. The City may terminate this Agreement if the Contractor fails to comply with Section 2-187.
4. The City may retain all monies due or to become due until the Contractor complies with Section 2-187.
5. The Contractor may be subject to debarment or suspension proceedings. Such proceedings will be consistent with the procedures in [section 2-183](#) of the Code of Ordinances of the City of Fort Lauderdale, Florida.

Authorized Signature

Print Name and Title

Date

CONTRACT PAYMENT METHOD

The City of Fort Lauderdale has implemented a Procurement Card (P-Card) program which changes how payments are remitted to its vendors. The City has transitioned from traditional paper checks to credit card payments via MasterCard or Visa as part of this program.

This allows you as a vendor of the City of Fort Lauderdale to receive your payments fast and safely. No more waiting for checks to be printed and mailed.

In accordance with the contract, payments on this contract will be made utilizing the City's P-Card (MasterCard or Visa). Accordingly, bidders must presently have the ability to accept these credit cards or take whatever steps necessary to implement acceptance of a card before the start of the contract term, or contract award by the City.

All costs associated with the Contractor's participation in this purchasing program shall be borne by the Contractor. The City reserves the right to revise this program as necessary.

By signing below you agree with these terms.

Please indicate which credit card payment you prefer:

MasterCard

Visa

Company Name

Name (Printed)

Signature

Date

Title

E-VERIFY AFFIRMATION STATEMENT

RFP/Bid /Contract No:

Project Description:

Contractor/Proposer/Bidder acknowledges and agrees to utilize the U.S. Department of Homeland Security's E-Verify System to verify the employment eligibility of,

- (a) all persons employed by Contractor/Proposer/Bidder to perform employment duties within Florida during the term of the Contract, and,
- (b) all persons (including subcontractors/vendors) assigned by Contractor/Proposer/Bidder to perform work pursuant to the Contract.

The Contractor/Proposer/Bidder acknowledges and agrees that use of the U.S. Department of Homeland Security's E-Verify System during the term of the Contract is a condition of the Contract.

Contractor/Proposer/ Bidder Company Name:

Authorized Company Person's Signature:

Authorized Company Person's Title:

Date:

CONSTRUCTION BID CERTIFICATION

Please Note: It is the sole responsibility of the bidder to ensure that his bid is submitted electronically through www.BidSync.com prior to the bid opening date and time listed. Paper bid submittals will not be accepted. All fields below must be completed. If the field does not apply to you, please note N/A in that field.

If you are a foreign corporation, you may be required to obtain a certificate of authority from the Department of State, in accordance with Florida Statute §607.1501 (visit http://www.dos.state.fl.us/).

Company: (Legal Registration)

Address:

City: State: Zip:

Telephone No.: FAX No.: Email:

Check box if your firm qualifies for MBE / SBE / WBE:

If a corporation, state the name of the President, Secretary and Resident Agent. If a partnership, state the names of all partners. If a trade name, state the names of the individuals who do business under the trade name.

<input type="text"/>	<input type="text"/>	<input type="text"/>	<input type="text"/>
Name	Title	Name	Title
<input type="text"/>	<input type="text"/>	<input type="text"/>	<input type="text"/>
Name	Title	Name	Title

ADDENDUM ACKNOWLEDGEMENT - Bidder acknowledges that the following addenda have been received and are included in the proposal:

<u>Addendum No.</u>	<u>Date Issued</u>	<u>Addendum No.</u>	<u>Date Issued</u>	<u>Addendum No.</u>	<u>Date Issued</u>
<input type="text"/>	<input type="text"/>	<input type="text"/>	<input type="text"/>	<input type="text"/>	<input type="text"/>

VARIANCES: If you take exception or have variances to any term, condition, specification, or requirement in this bid you must specify such variance in the space provided below or reference in the space provided below all variances contained on other pages within your bid. Additional pages may be attached if necessary. No variances will be deemed to be part of the bid submitted unless such is listed and contained in the space provided below. The City does not, by virtue of submitting a variance, necessarily accept any variances. If no statement is contained in the below space, it is hereby implied that your response is in full compliance with this competitive solicitation. If you do not have variances, simply mark N/A. **You must also click the "Take Exception" button.**

The below signatory affirms that he has or will obtain all required permits and licenses from the appropriate agencies, and that his firm is authorized to do business in the State of Florida. The below signatory agrees to furnish all labor, tools, material, equipment and supplies, and to sustain all the expense incurred in doing the work set forth in strict accordance with the bid plans and contract documents at the unit prices indicated if awarded a contract. The below signatory has not divulged to, discussed, or compared this bid with other bidders, and has not colluded with any other bidder or parties to this bid whatsoever. Furthermore, the undersigned guarantees the truth and accuracy of all statements and answers contained in this bid. The below signatory also hereby agrees, by virtue of submitting or attempting to submit a bid, that in no event shall the City's liability for bidder's direct, indirect, incidental, consequential, special or exemplary damages, expenses, or lost profits arising out of this competitive solicitation process, including but not limited to public advertisement, bid conferences, site visits, evaluations, oral presentations, or award proceedings exceed the amount of Five Hundred Dollars (\$500.00). This limitation shall not apply to claims arising under any provision of indemnification or the City's protest ordinance contained in this competitive solicitation.

Submitted by:

Name (printed)

Signature

Date

Title

Revised 4/28/2020

Question and Answers for Bid #12752-633 - Bayview, Hortic and Riverside Parks Improvements (P12645, 12655 and 12668)

Overall Bid Questions

There are no questions associated with this bid.