

Kimley»Horn
 1920 WERVA WAY #200
 WEST PALM BEACH, FL 33411
 PHONE: 561-845-0865 FAX: 561-330-2345
 WWW.KIMLEY-HORN.COM
 REGISTRY 696
 © 2022 KIMLEY-HORN AND ASSOCIATES, INC.

SEAL:
 JONATHAN D. HAIGH, PLA
 STATE LICENSE NUMBER
 LA #6666795
 06/30/2022

DATE: 07/01/2021
 DRAWN BY: [blank]
 DESIGNED BY: [blank]
 CHECKED BY: [blank]
 FIELD BOOK: [blank]

CITY OF FORT LAUDERDALE
 TRANSPORTATION & MOBILITY

 290 NE 3RD AVE., FORT LAUDERDALE, FL 33301

REVISIONS	
NO.	DESCRIPTION

PROJECT # 12557
 NE 4TH AVENUE STREETSCAPE PROJECT
 E SUNRISE BLVD TO NE 13TH ST
 FORT LAUDERDALE, FL
 TREE DISPOSITION PLAN

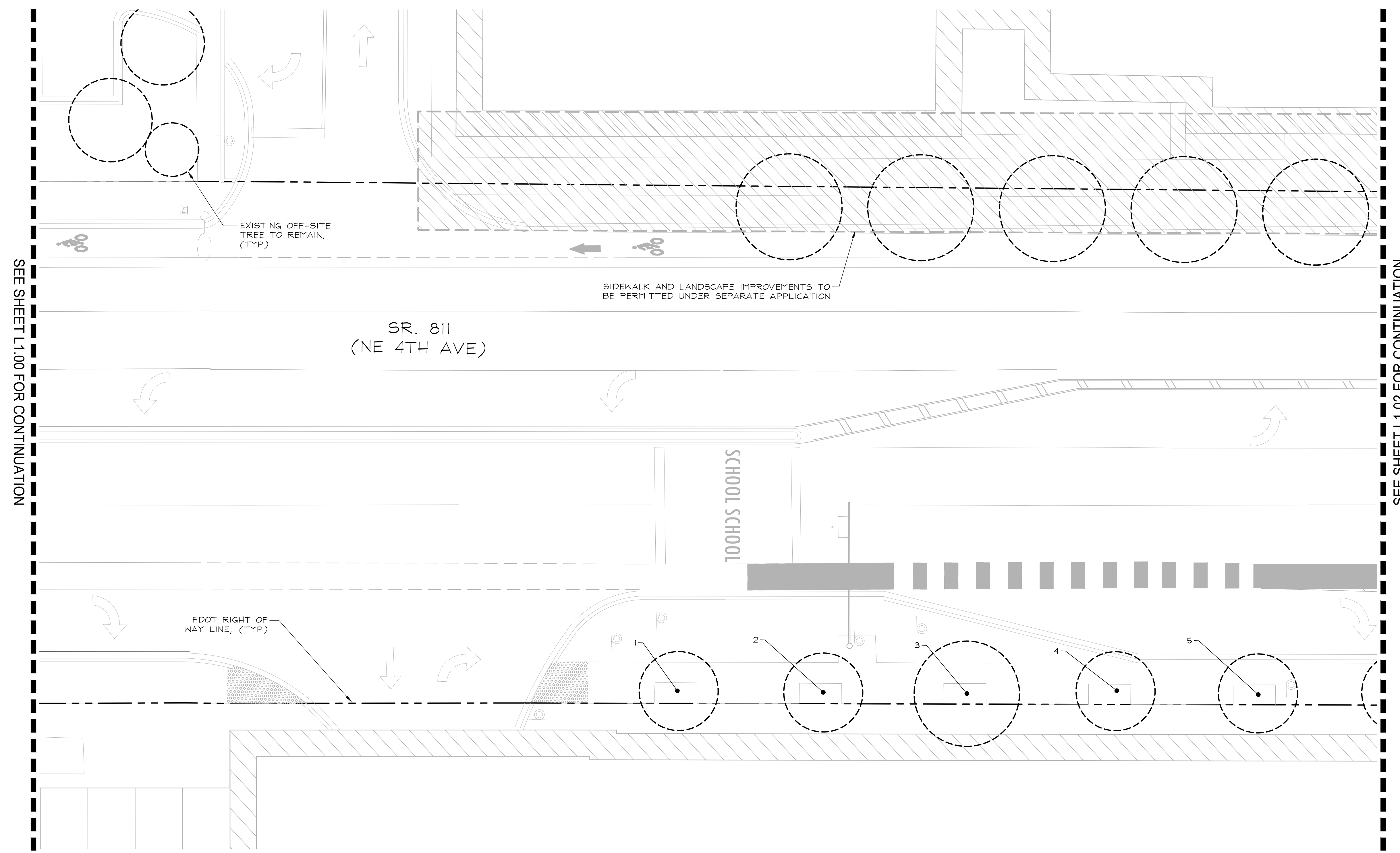
SHEET NO.
L1.01



SEE SHEET L1.00 FOR CONTINUATION

SEE SHEET L1.02 FOR CONTINUATION

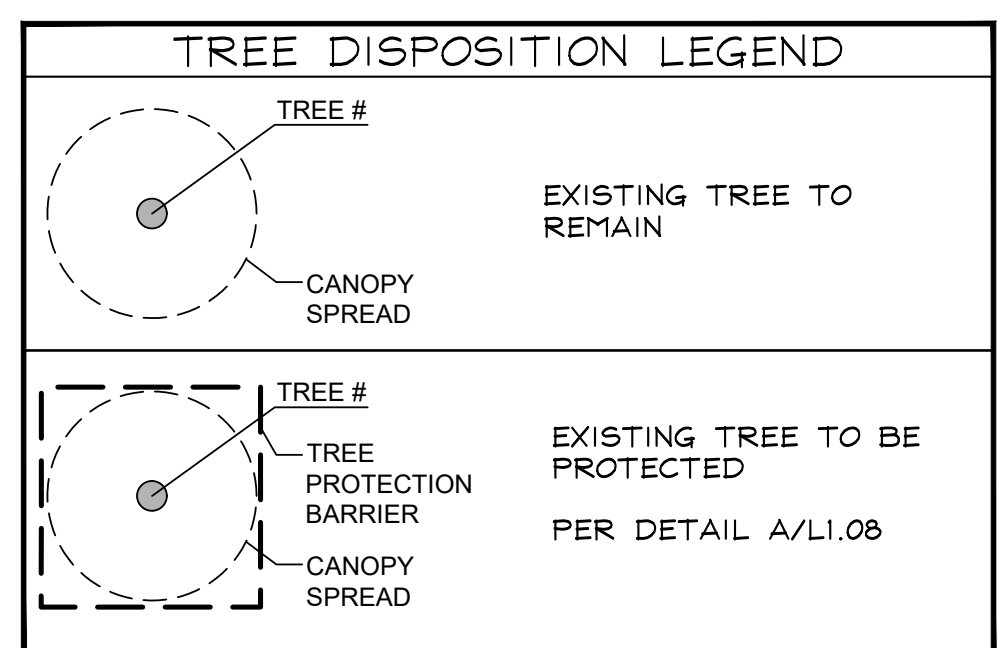

VERTICAL DATUM
 ELEVATIONS SHOWN HEREON ARE BASED ON THE NORTH AMERICAN VERTICAL DATUM OF 1988.
 NAVD '88 ELEV. + 1.565' = NGVD '29 ELEVATION

THE PRESENCE OF GROUNDWATER SHOULD BE ANTICIPATED. CONTRACTOR'S BID SHALL INCLUDE CONSIDERATION FOR ADDRESSING THIS ISSUE AND OBTAINING ALL NECESSARY PERMITS.

CALL 2 WORKING DAYS BEFORE YOU DIG 

IT'S THE LAW! DIAL 811 

SUNSHINE STATE ONE CALL OF FLORIDA, INC.

Plotted By: Hargrett, Tom Sheet Set: NE 4th Avenue Layout: L1.01 TREE DISPOSITION PLAN June 29, 2022 09:10:01am K:\WPB_LURC\043184061 - NE 4th AVE FTL\CAD\Plansheets\L1.00 TREE DISPOSITION.dwg

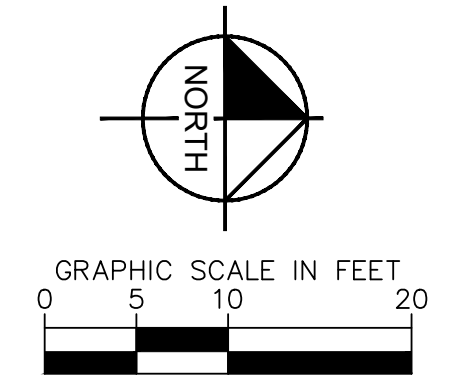

Kimley»Horn
 1920 WERVA WAY #200
 WEST PALM BEACH, FL 33411
 PHONE: 561-845-0865 FAX:
 561-330-2345
 WWW.KIMLEY-HORN.COM
 REGISTRY 696
 © 2022 KIMLEY-HORN AND
 ASSOCIATES, INC.

SEAL:
 JONATHAN D. HAIGH, PLA
 STATE LICENSE NUMBER
 LA #6666795
 06/30/2022

DATE: 07/01/2021
 DRAWN BY: AS SHOWN
 DESIGNED BY: AS SHOWN
 CHECKED BY:
 FIELD BOOK:

CITY OF FORT LAUDERDALE
 TRANSPORTATION
 &
 MOBILITY

 290 NE 3RD AVE., FORT LAUDERDALE, FL 33301

NO.	DATE	BY	CHK'D	DESCRIPTION

PROJECT # 12557
 NE 4TH AVENUE STREETSCAPE PROJECT
 E SUNRISE BLVD TO NE 13TH ST
 FORT LAUDERDALE, FL
 TREE DISPOSITION PLAN

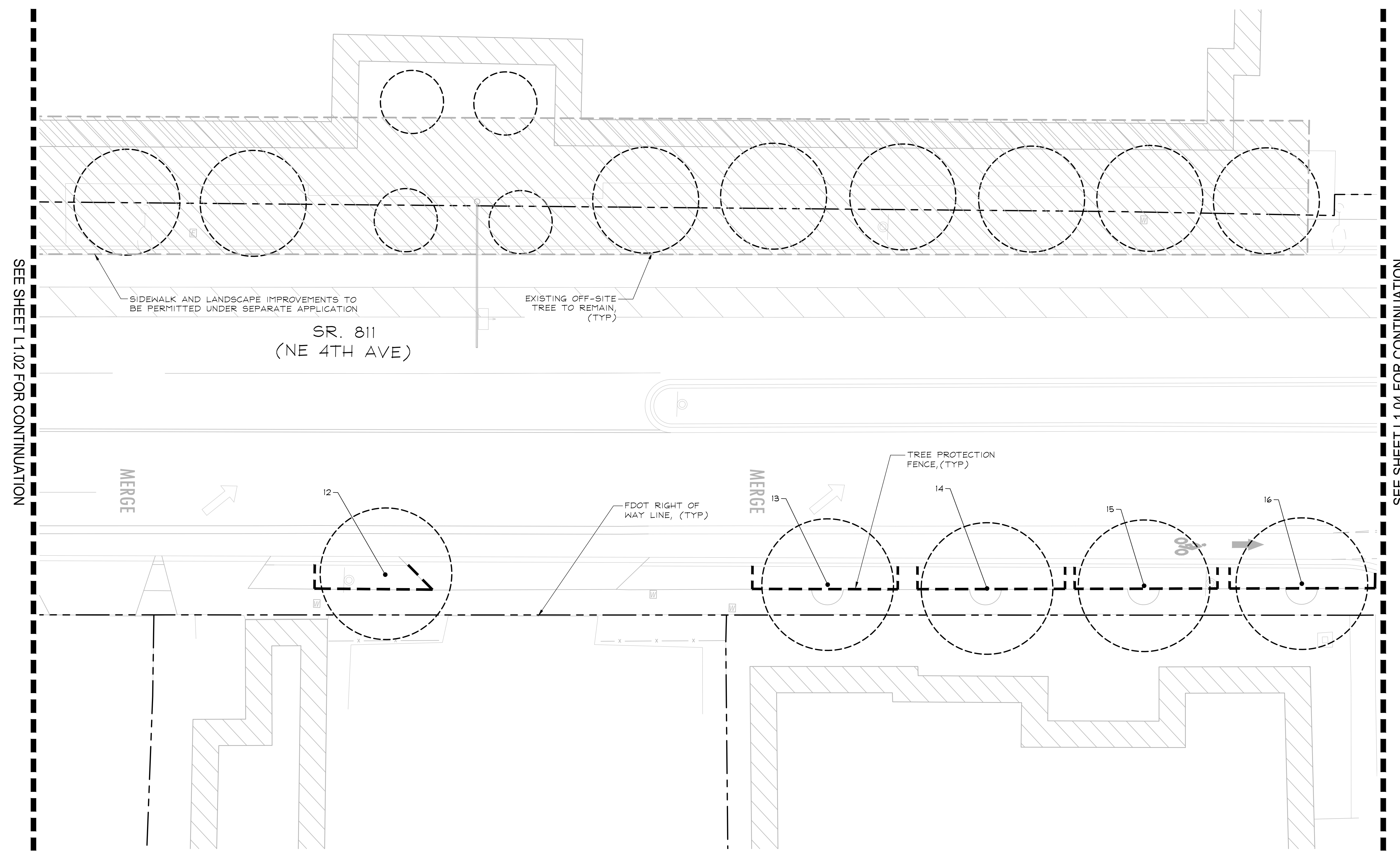
SHEET NO.
L1.03



SEE SHEET L1.02 FOR CONTINUATION

SEE SHEET L1.04 FOR CONTINUATION

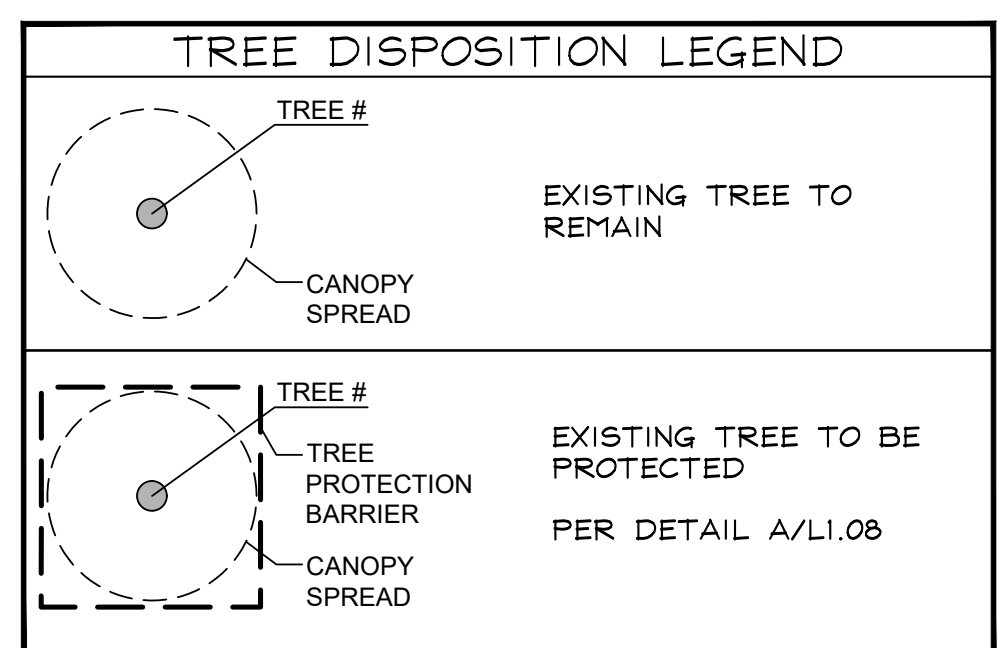

VERTICAL DATUM
 ELEVATIONS SHOWN HEREON ARE BASED ON THE
 NORTH AMERICAN VERTICAL DATUM OF 1988.
 NAVD '88 ELEV. + 1.565' = NGVD '29 ELEVATION

THE PRESENCE OF GROUNDWATER SHOULD BE
 ANTICIPATED. CONTRACTOR'S BID SHALL
 INCLUDE CONSIDERATION FOR ADDRESSING THIS
 ISSUE AND OBTAINING ALL NECESSARY PERMITS.

CALL 2 WORKING DAYS
 BEFORE YOU DIG



IT'S THE LAW!
 DIAL 811

Know what's below.
 Call before you dig.

SUNSHINE STATE ONE CALL OF FLORIDA, INC.

Plotted By: Hargrett, Tom Sheet: Sct: NE 4th Avenue Layout: L1.03 TREE DISPOSITION PLAN June 29, 2022 09:10:06am K:\WPB_LUR\043184081 - NE 4th Ave FTL\CAD\Plansheets\L1.00 TREE DISPOSITION.dwg

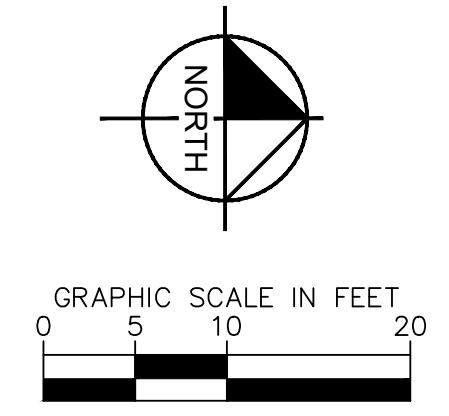

Kimley»Horn
 1920 WERVA WAY #200
 WEST PALM BEACH, FL 33411
 PHONE: 561-845-0865 FAX: 561-330-2345
 WWW.KIMLEY-HORN.COM
 REGISTRY 696
 © 2022 KIMLEY-HORN AND ASSOCIATES, INC.

SEAL:
 JONATHAN D. HAIGH, PLA
 STATE LICENSE NUMBER
 LA #6666795
 06/30/2022

DATE: 07/01/2021
 DRAWN BY: AS SHOWN
 DESIGNED BY: AS SHOWN
 CHECKED BY:
 FIELD BOOK:

CITY OF FORT LAUDERDALE
 TRANSPORTATION & MOBILITY

 290 NE 3RD AVE., FORT LAUDERDALE, FL 33301

REVISIONS	
NO.	DESCRIPTION

PROJECT # 12557
 NE 4TH AVENUE STREETSCAPE PROJECT
 E SUNRISE BLVD TO NE 13TH ST
 FORT LAUDERDALE, FL
 TREE DISPOSITION PLAN

SHEET NO.
L1.04

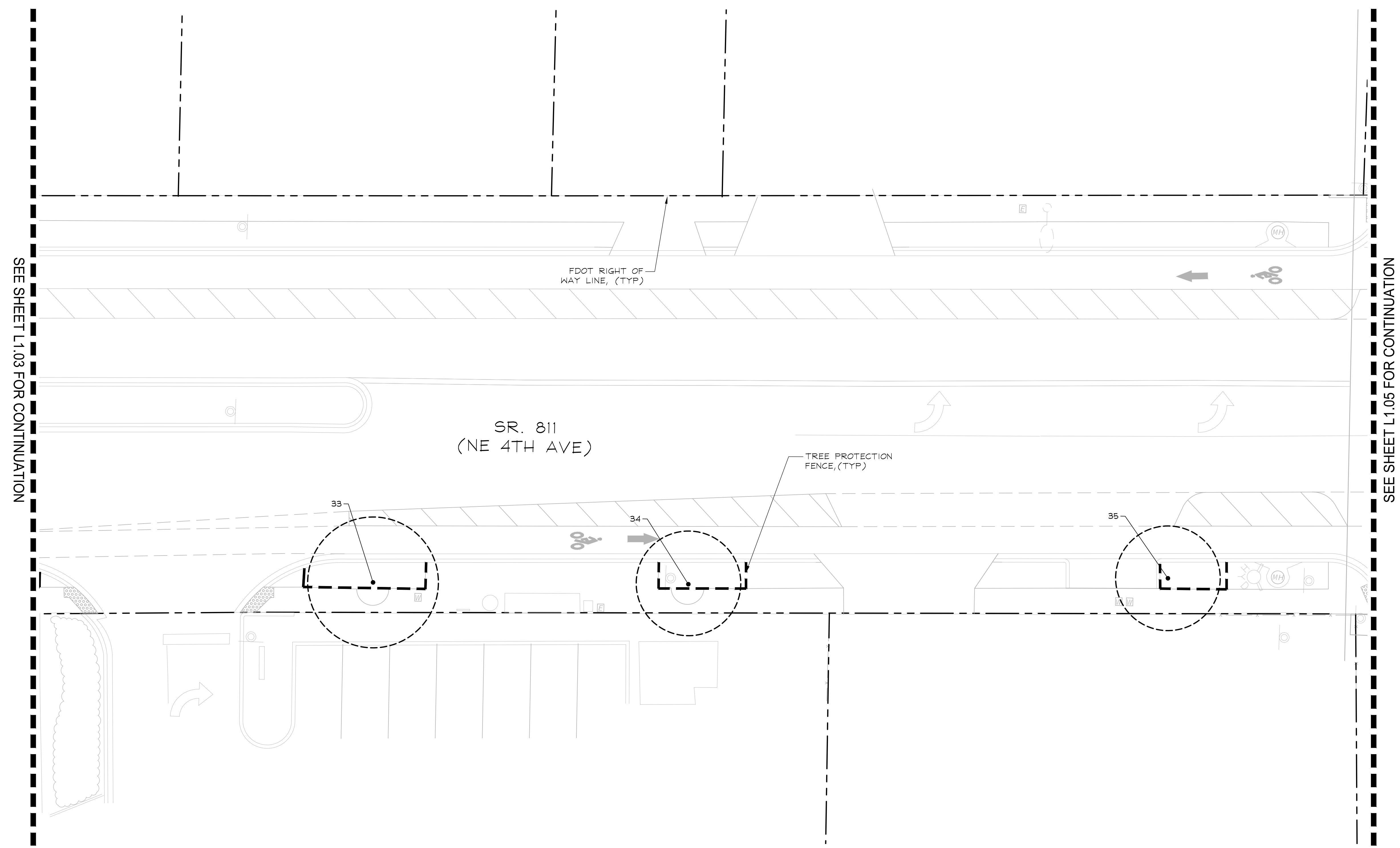

SEE SHEET L1.03 FOR CONTINUATION

SEE SHEET L1.05 FOR CONTINUATION

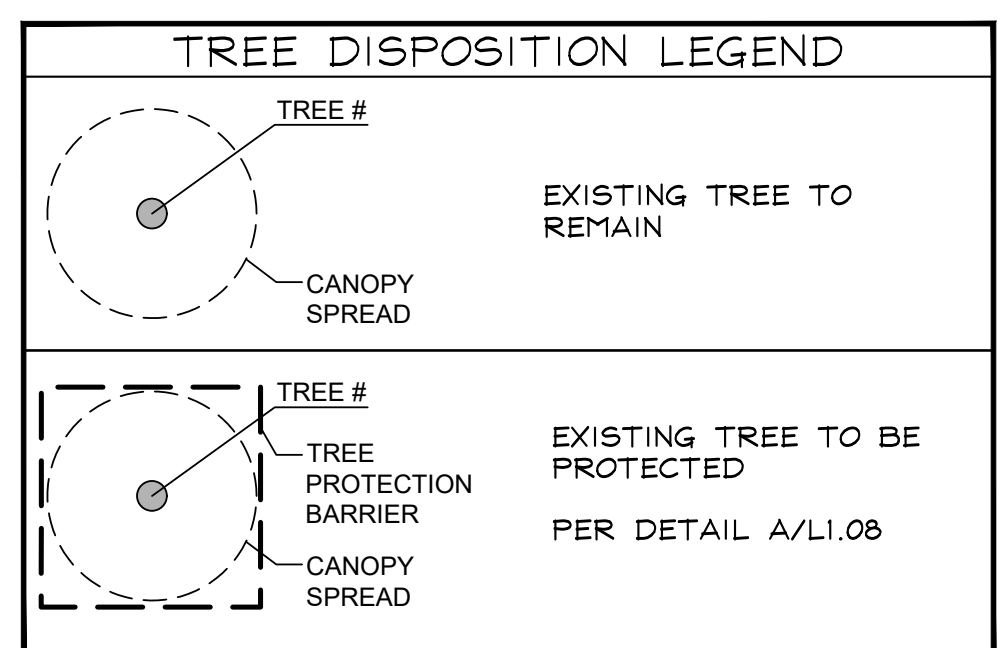

VERTICAL DATUM
 ELEVATIONS SHOWN HEREON ARE BASED ON THE NORTH AMERICAN VERTICAL DATUM OF 1988.
 NAVD '88 ELEV. + 1.565' = NGVD '29 ELEVATION

THE PRESENCE OF GROUNDWATER SHOULD BE ANTICIPATED. CONTRACTOR'S BID SHALL INCLUDE CONSIDERATION FOR ADDRESSING THIS ISSUE AND OBTAINING ALL NECESSARY PERMITS.

CALL 2 WORKING DAYS BEFORE YOU DIG

IT'S THE LAW! DIAL 811

Know what's below. Call before you dig.

SUNSHINE STATE ONE CALL OF FLORIDA, INC.

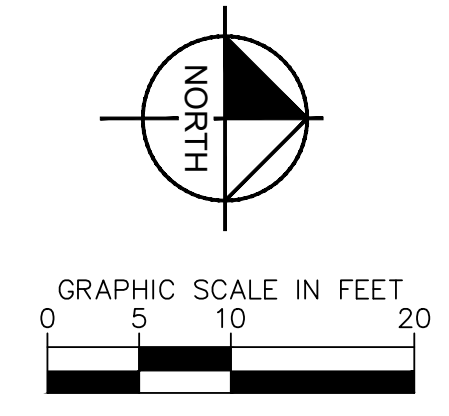
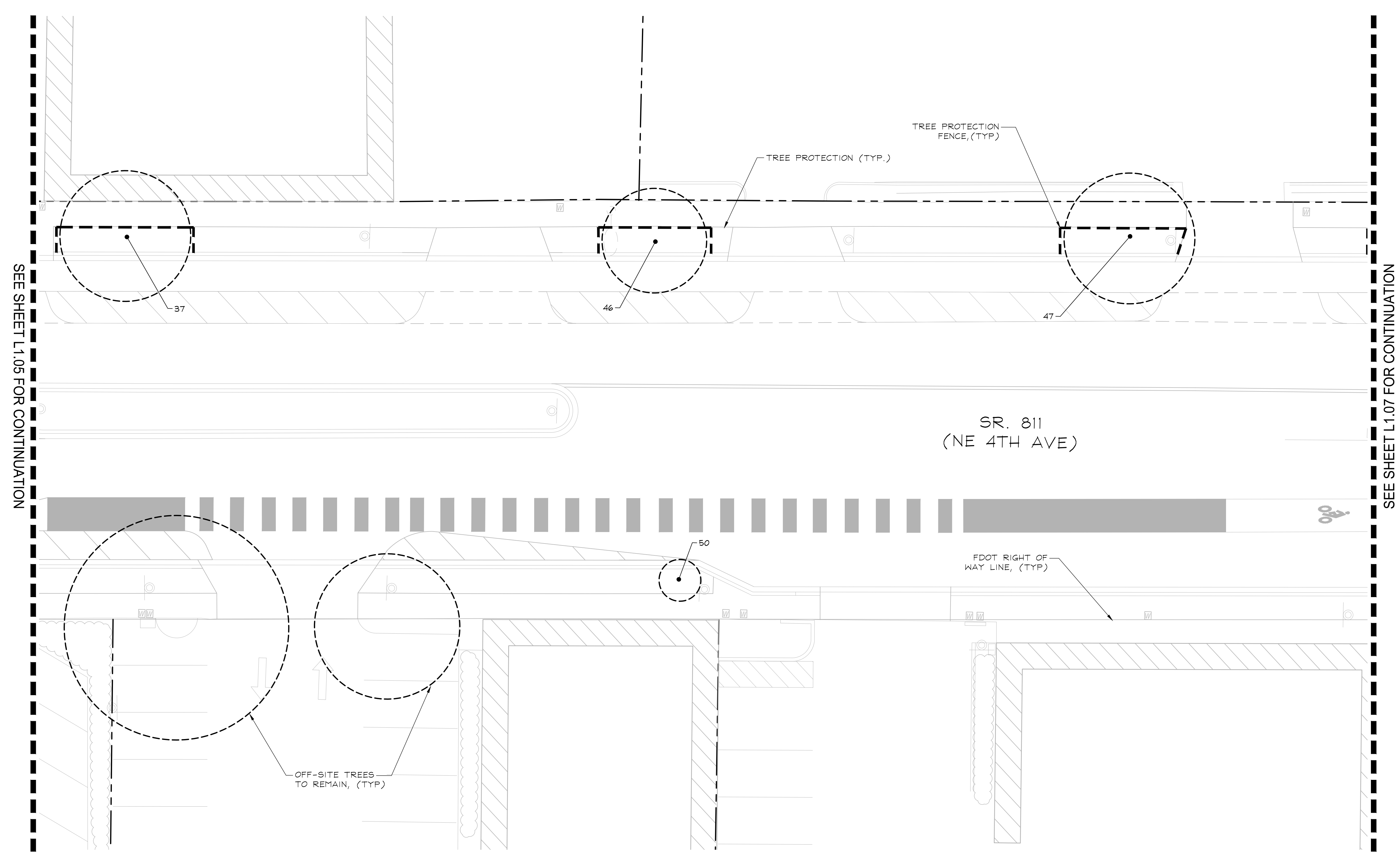

SEE SHEET L1.05 FOR CONTINUATION

SEE SHEET L1.07 FOR CONTINUATION

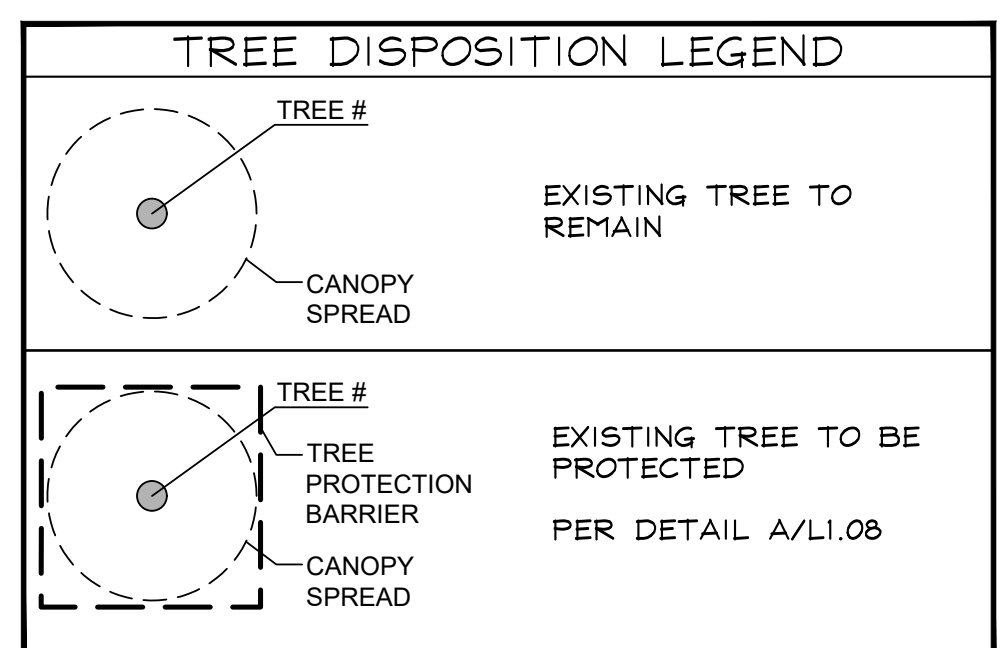

Kimley»Horn
 1920 WERKVA WAY #200
 WEST PALM BEACH, FL 33411
 PHONE: 561-845-0865 FAX: 561-330-2345
 WWW.KIMLEY-HORN.COM
 REGISTRY 696
 © 2022 KIMLEY-HORN AND ASSOCIATES, INC.

SEAL:
 JONATHAN D. HAIGH, PLA
 STATE LICENSE NUMBER
 LA #6666795
 06/30/2022

DATE: 07/01/2021
 DRAWN BY: AS SHOWN
 DESIGNED BY: AS SHOWN
 CHECKED BY:
 FIELD BOOK:

CITY OF FORT LAUDERDALE
 TRANSPORTATION & MOBILITY

 290 NE 3RD AVE., FORT LAUDERDALE, FL 33301

REVISIONS	
NO.	DESCRIPTION

PROJECT # 12557
 NE 4TH AVENUE STREETSCAPE PROJECT
 E SUNRISE BLVD TO NE 13TH ST
 FORT LAUDERDALE, FL
 TREE DISPOSITION PLAN

SHEET NO.
L1.06

VERTICAL DATUM
 ELEVATIONS SHOWN HEREON ARE BASED ON THE
 NORTH AMERICAN VERTICAL DATUM OF 1988.
 NAVD '88 ELEV. + 1.565' = NGVD '29 ELEVATION

THE PRESENCE OF GROUNDWATER SHOULD BE
 ANTICIPATED. CONTRACTOR'S BID SHALL
 INCLUDE CONSIDERATION FOR ADDRESSING THIS
 ISSUE AND OBTAINING ALL NECESSARY PERMITS.

CALL 2 WORKING DAYS
 BEFORE YOU DIG
 IT'S THE LAW!
 DIAL 811
 Know what's below.
 Call before you dig.
 SUNSHINE STATE ONE CALL OF FLORIDA, INC.

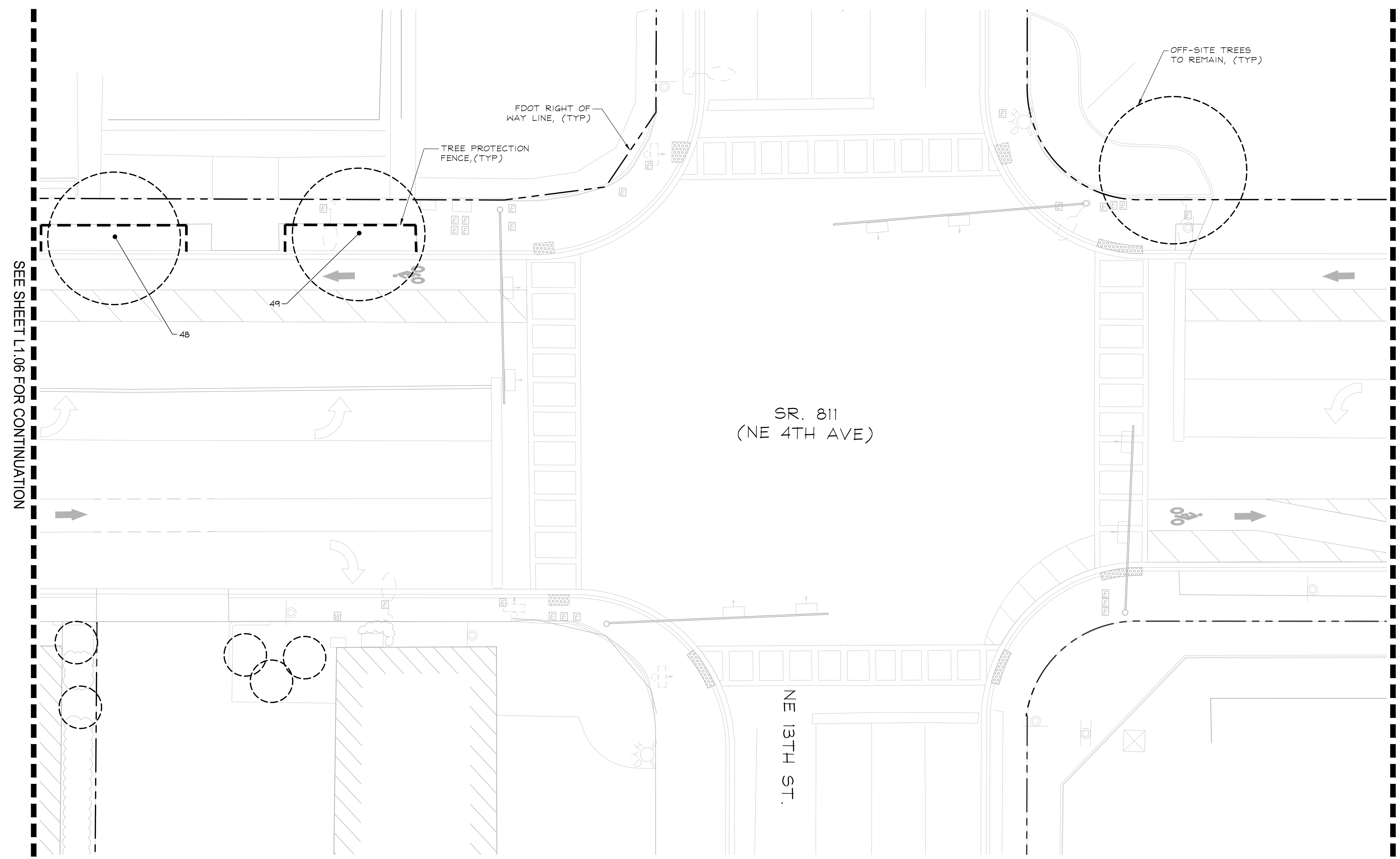

SEE SHEET L1.06 FOR CONTINUATION

SEE SHEET L1.08 FOR CONTINUATION

SR. 811
(NE 4TH AVE)

NE 13TH ST.

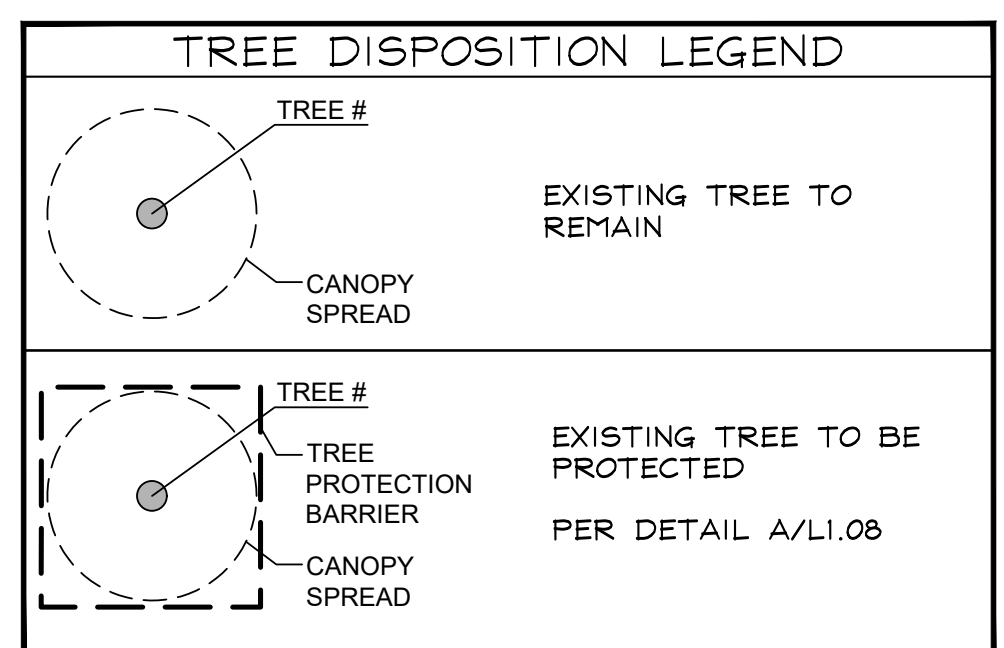

VERTICAL DATUM
ELEVATIONS SHOWN HEREON ARE BASED ON THE
NORTH AMERICAN VERTICAL DATUM OF 1988.
NAVD '88 ELEV. + 1.565' = NGVD '29 ELEVATION

THE PRESENCE OF GROUNDWATER SHOULD BE
ANTICIPATED. CONTRACTOR'S BID SHALL
INCLUDE CONSIDERATION FOR ADDRESSING THIS
ISSUE AND OBTAINING ALL NECESSARY PERMITS.

CALL 2 WORKING DAYS
BEFORE YOU DIG

811

IT'S THE LAW!
DIAL 811

Know what's below.
Call before you dig.

SUNSHINE STATE ONE CALL OF FLORIDA, INC.

Kimley»Horn

1920 WERVA WAY #200
WEST PALM BEACH, FL 33411
PHONE: 561-845-0865 FAX:
561-330-2345
WWW.KIMLEY-HORN.COM
REGISTRY 696

© 2022 KIMLEY-HORN AND
ASSOCIATES, INC.

SEAL:

JONATHAN D. HAIGH, PLA

STATE LICENSE NUMBER
LA #6666795

06/30/2022

DATE: 07/01/2021
DESIGNED BY: AS SHOWN
CHECKED BY:
FIELD BOOK:

CITY OF FORT LAUDERDALE
TRANSPORTATION & MOBILITY

290 NE 3RD AVE., FORT LAUDERDALE, FL 33301

NO.	DATE	BY	CHK'D	DESCRIPTION

PROJECT # 12557
NE 4TH AVENUE STREETSCAPE PROJECT
E SUNRISE BLVD TO NE 13TH ST
FORT LAUDERDALE, FL
TREE DISPOSITION PLAN

SHEET NO.
L1.07

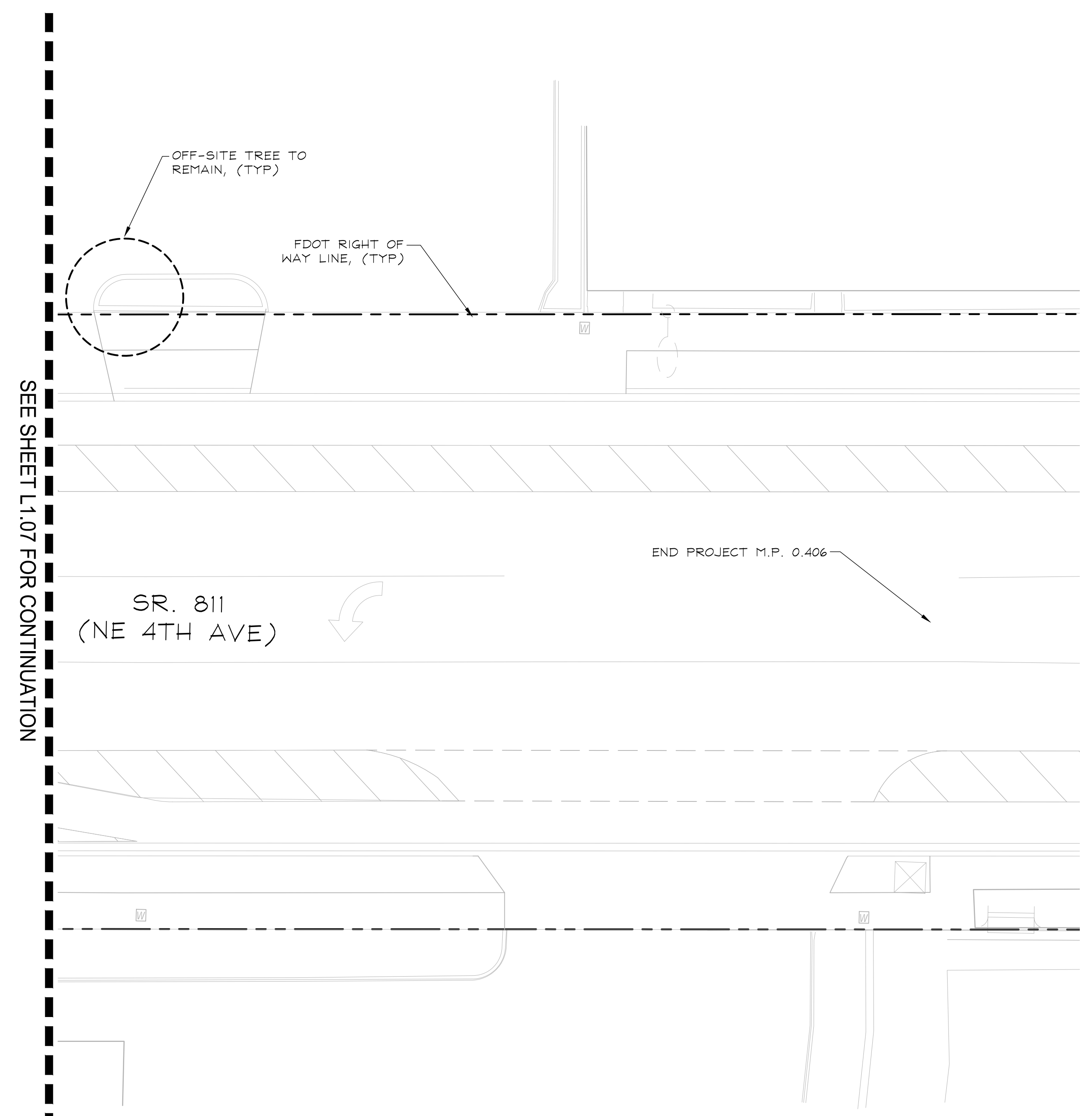

NO.	BOTANICAL NAME	COMMON NAME	DBH (in)	CT (ft)	SPR (ft)	CONDITION	DISPOSITION
1	<i>Washingtonia robusta</i>	Washington Palm		25	15	Good	Remain
2	<i>Washingtonia robusta</i>	Washington Palm		40	15	Good	Remain
3	<i>Washingtonia robusta</i>	Washington Palm		30	20	Good	Remain
4	<i>Washingtonia robusta</i>	Washington Palm		40	15	Good	Remain
5	<i>Washingtonia robusta</i>	Washington Palm		40	15	Good	Remain
6	<i>Washingtonia robusta</i>	Washington Palm		25	15	Good	Remain
7	<i>Washingtonia robusta</i>	Washington Palm		40	15	Good	Remain
8	<i>Washingtonia robusta</i>	Washington Palm		40	15	Good	Remain
9	<i>Sabal palmetto</i>	Cabbage Palm		10	12	Good	Remain
10	<i>Sabal palmetto</i>	Cabbage Palm		15	12	Good	Remain
11	<i>Quercus virginiana</i>	Southern Live Oak	7	25	25	Good	Remain
12	<i>Quercus virginiana</i>	Southern Live Oak	10	25	25	Good	Remain
13	<i>Quercus virginiana</i>	Southern Live Oak	6	25	25	Good	Remain
14	<i>Quercus virginiana</i>	Southern Live Oak	6	25	25	Good	Remain
15	<i>Quercus virginiana</i>	Southern Live Oak	6	25	25	Good	Remain
16	<i>Quercus virginiana</i>	Southern Live Oak	6	25	25	Good	Remain
33	<i>Quercus virginiana</i>	Southern Live Oak	14	30	25	Good	Remain
34	<i>Quercus virginiana</i>	Southern Live Oak	10	30	20	Good	Remain
35	<i>Quercus virginiana</i>	Southern Live Oak	8	25	20	Good	Remain
36	<i>Quercus virginiana</i>	Southern Live Oak	8	30	25	Good	Remain
37	<i>Quercus virginiana</i>	Southern Live Oak		35	25	Good	Remain
46	<i>Quercus virginiana</i>	Southern Live Oak	8	25	20	Good	Remain
47	<i>Quercus virginiana</i>	Southern Live Oak	10	25	25	Good	Remain
48	<i>Quercus virginiana</i>	Southern Live Oak	8	30	25	Good	Remain
49	<i>Quercus virginiana</i>	Southern Live Oak	10	30	25	Good	Remain
50	<i>Phoenix roebelenii</i>	Pygmy Date Palm		6	8	Good	Remain

- EXISTING TREE - PRUNING NOTES:
- TREE PRUNING WORK MUST BE PERFORMED BY OR DIRECTLY SUPERVISED BY AN ISA CERTIFIED ARBORIST.
 - CONTRACTOR SHALL HOLD A PRE-PRUNING CONFERENCE WITH THE OWNER AND LANDSCAPE ARCHITECT PRIOR TO COMMENCING PRUNING OPERATIONS.
 - PRUNE TREES PER ANSI A300 FOR THE FOLLOWING:
 - MAINTENANCE - TO MAINTAIN OR IMPROVE THE TREE'S HEALTH AND STRUCTURE
 - HAZARD REDUCTION - TO REMOVE DEAD LIMBS OR OTHER VISIBLE HAZARDS FROM THE TREE CANOPY
 - CROWN CLEANING - TO SELECTIVELY REMOVE DEAD, DYING OR DISEASED BRANCHES, WEAK BRANCHES, AND SUCKER SPROUTS.
 - CROWN RAISING - TO REMOVE LOWER BRANCHES TO PROVIDE VERTICAL CLEARANCE
 - VISTA PRUNING - TO SELECTIVELY THIN FRAMEWORK LIMBS WITHIN THE CROWN TO ALLOW FOR VIEWS THROUGH THE TREE
 - CROWN RESTORATION - TO IMPROVE THE STRUCTURE, FORM, AND APPEARANCE OF A TREE THAT HAS BEEN DAMAGED, HEADED, OR VANDALIZED

Kimley»Horn
 1920 WENONA WAY #200
 WEST PALM BEACH, FL 33411
 PHONE: 561-845-0865 FAX: 561-330-2345
 WWW.KIMLEY-HORN.COM
 REGISTRY 696
 © 2022 KIMLEY-HORN AND ASSOCIATES, INC.

SEAL:
 JONATHAN D. HAIGH, PLA
 STATE LICENSE NUMBER
 LA #6666795
 06/30/2022

DATE: 07/01/2021
 DRAWN BY: AS SHOWN
 DESIGNED BY: AS SHOWN
 CHECKED BY: FIELD BOOK

CITY OF FORT LAUDERDALE
 TRANSPORTATION & MOBILITY

 290 NE 3RD AVE., FORT LAUDERDALE, FL 33301

NO.	DATE	BY	CHK'D	DESCRIPTION

PROJECT # 12557
 NE 4TH AVENUE STREETSCAPE PROJECT
 E SUNRISE BLVD TO NE 13TH ST
 FORT LAUDERDALE, FL
 TREE DISPOSITION PLAN

SHEET NO. L1.08

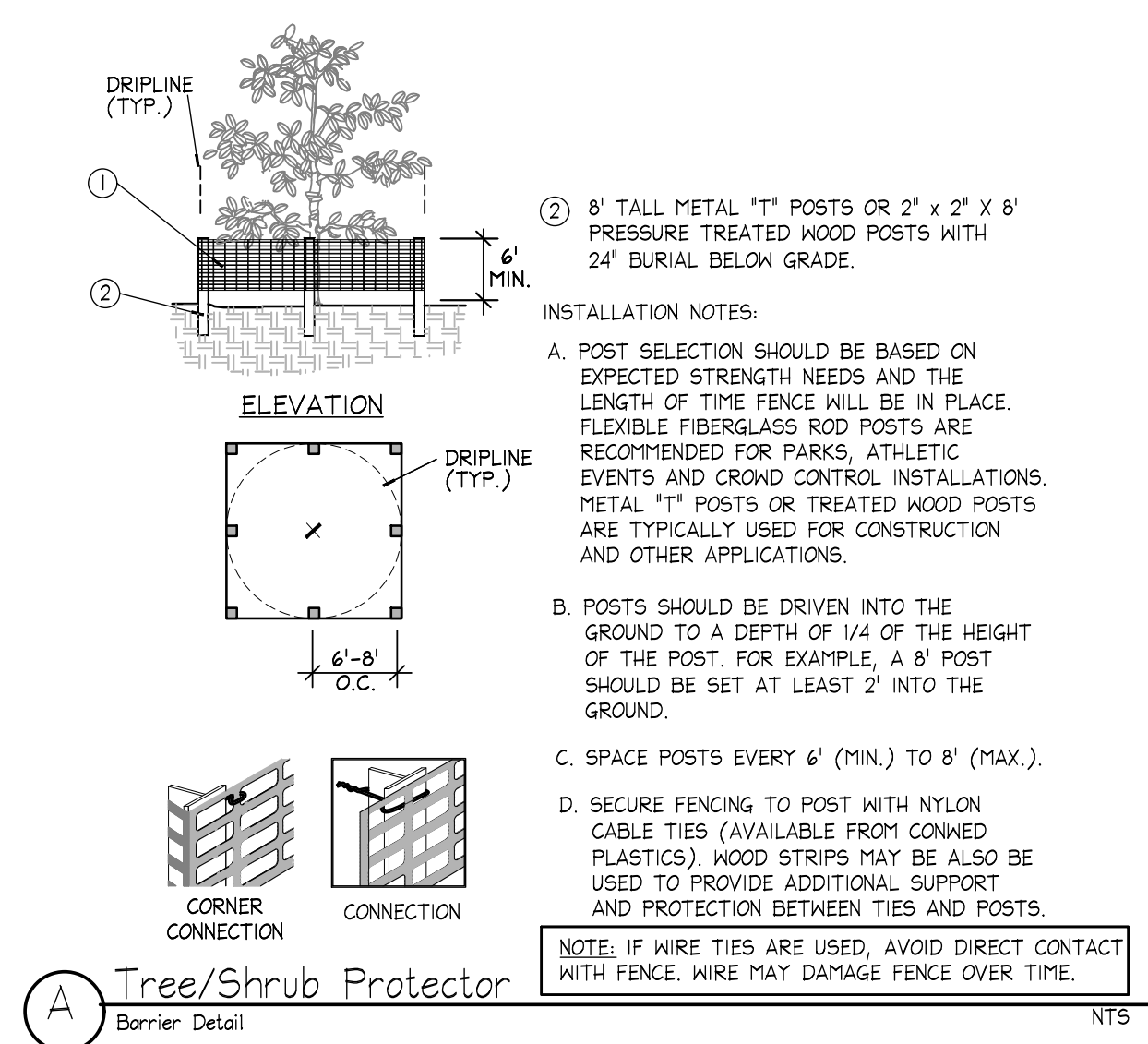

Plotted By: Hargrett, Tom Sheet: Sect: NE 4th Avenue Layout: L1.08 TREE DISPOSITION PLAN June 29, 2022 09:10:18am K:\WPB_LURC\04318\001 - NE 4th AVE FTL\CAD\Plansheets\L1.00 TREE DISPOSITION.dwg

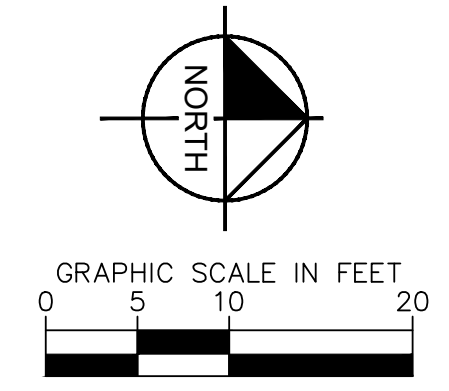
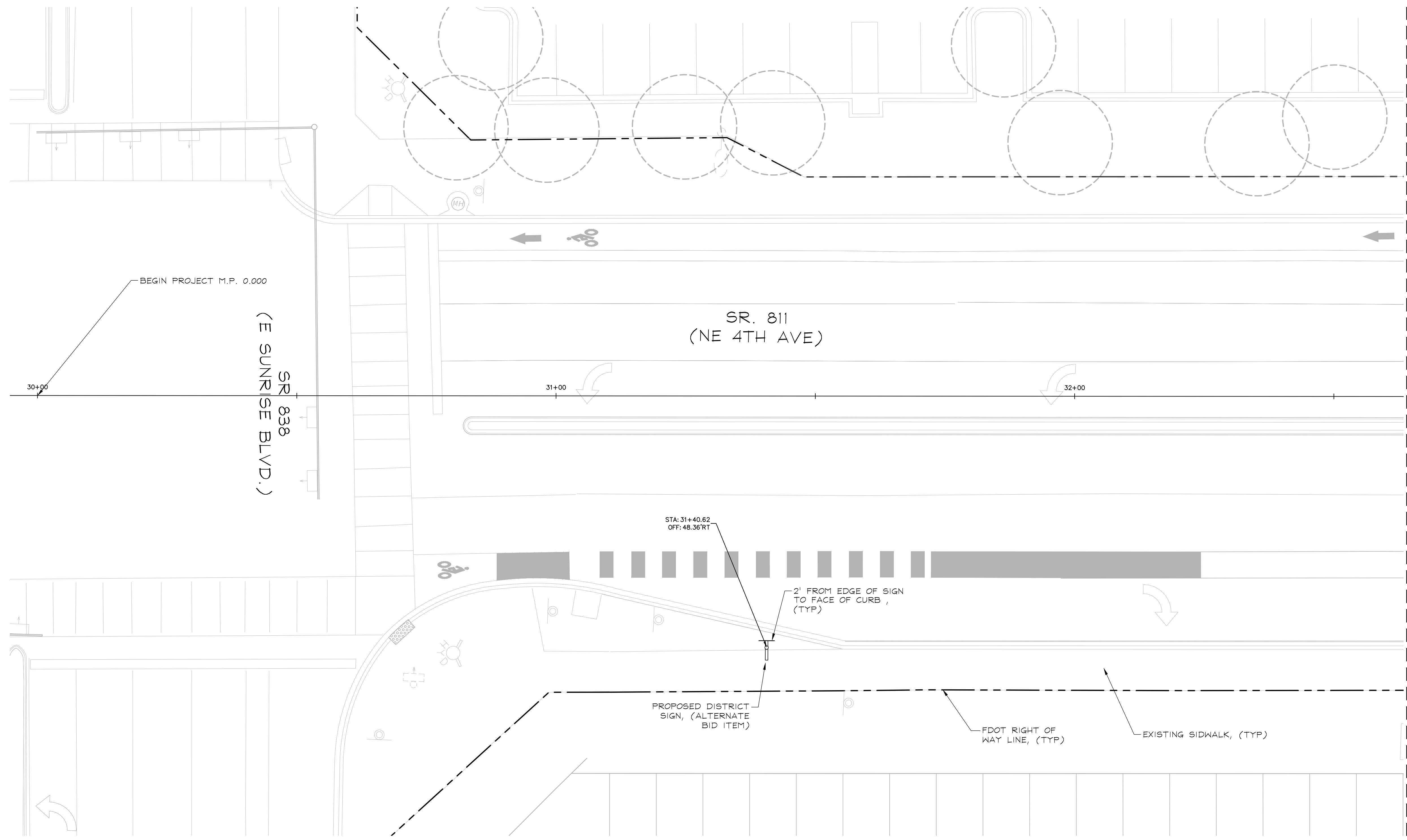

SEE SHEET L2.01 FOR CONTINUATION

Plotted By: Hargrett, Tom Sheet: NE 4th Avenue Layout: L2.00 HARDSCAPE PLAN June 29, 2022 09:10:40am K:\WPB_LURC\04378\001 - NE 4th AVE FTL\CAD\PlanSheets\L2.00 HARDSCAPE PLAN.dwg

Kimley-Horn
 1920 WERVA WAY #200
 WEST PALM BEACH, FL 33411
 PHONE: 561-845-0865 FAX: 561-330-2345
 WWW.KIMLEY-HORN.COM
 REGISTRY 696
 © 2022 KIMLEY-HORN AND ASSOCIATES, INC.

SEAL:
 JONATHAN D. HAIGH, PLA
 STATE LICENSE NUMBER
 LA #6666795
 06/30/2022

DATE: 07/01/2021
 DRAWN BY: DESIGNED BY: AS SHOWN
 CHECKED BY: FIELD BOOK

CITY OF FORT LAUDERDALE
 TRANSPORTATION & MOBILITY

 290 NE 3RD AVE., FORT LAUDERDALE, FL 33301

REVISIONS	
NO.	DESCRIPTION

PROJECT # 12557
 NE 4TH AVENUE STREETSCAPE PROJECT
 E SUNRISE BLVD TO NE 13TH ST
 FORT LAUDERDALE, FL
 HARDSCAPE PLAN

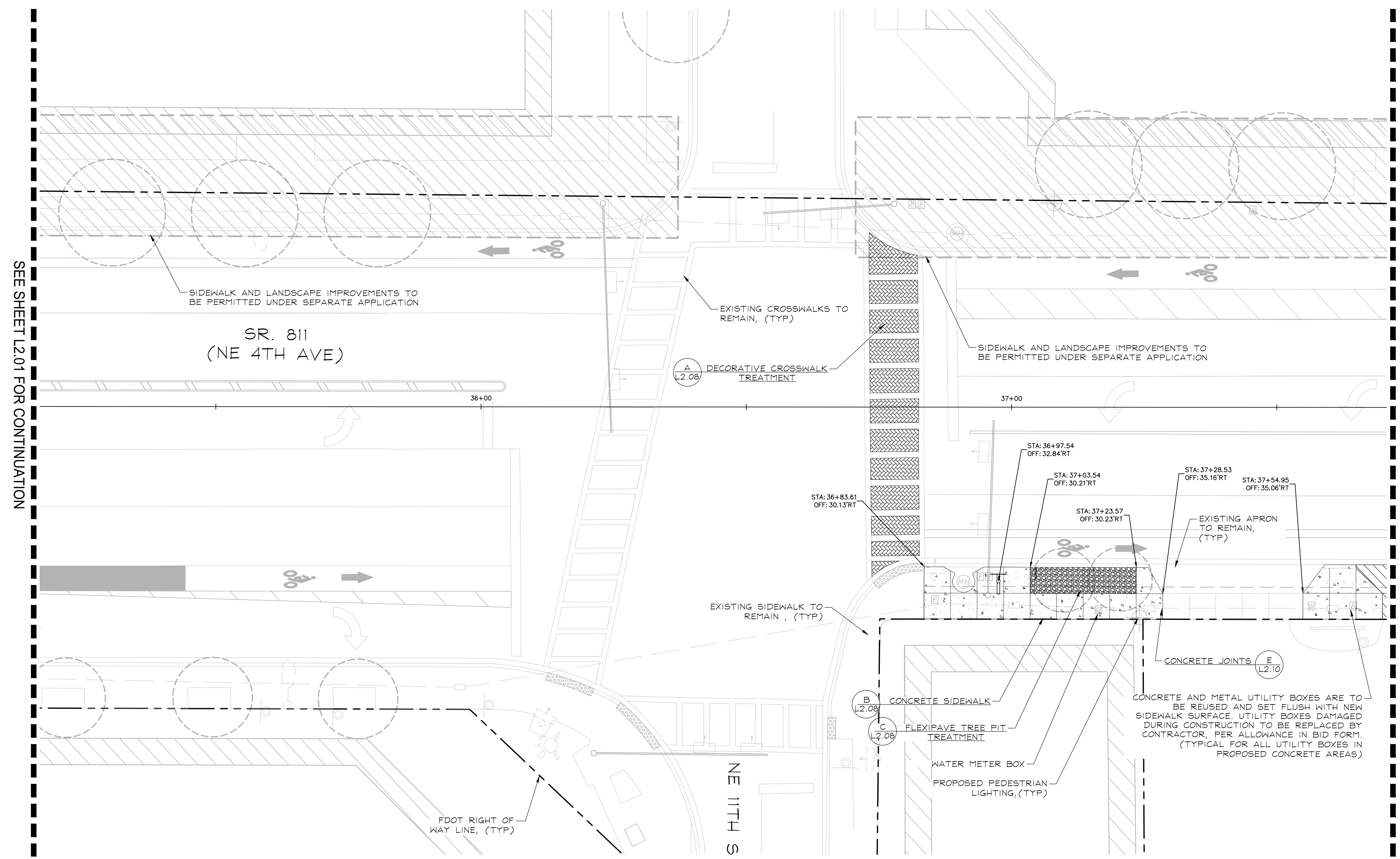
SHEET NO.
L2.00



SEE SHEET L2.01 FOR CONTINUATION

SEE SHEET L2.03 FOR CONTINUATION

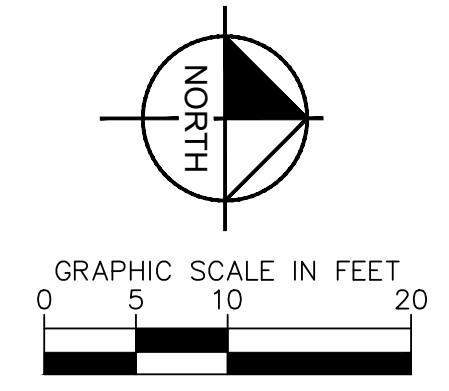

Kimley»Horn
 1920 WERKVA WAY #200
 WEST PALM BEACH, FL 33411
 PHONE: 561-845-0865 FAX:
 561-330-2345
 WWW.KIMLEY-HORN.COM
 REGISTRY 696
 © 2022 KIMLEY-HORN AND
 ASSOCIATES, INC.

SEAL:
 JONATHAN D. HAIGH, PLA
 STATE LICENSE NUMBER
 LA #6666795
 06/30/2022

DATE: 07/01/2021
 DRAWN BY: SCALE: AS SHOWN
 DESIGNED BY: CHECKED BY: FIELD BOOK:

CITY OF FORT LAUDERDALE
 TRANSPORTATION & MOBILITY

 290 NE 3RD AVE., FORT LAUDERDALE, FL 33301

REVISIONS	
NO.	DESCRIPTION

PROJECT # 12557
 NE 4TH AVENUE STREETSCAPE PROJECT
 E SUNRISE BLVD TO NE 13TH ST
 FORT LAUDERDALE, FL
 HARDSCAPE PLAN

SHEET NO.
L2.02

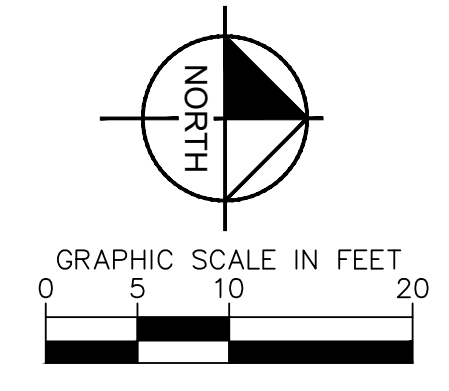
Plotted By: Hargrett, Tom Sheet Set: NE 4th Avenue Layout: L2.02 HARDSCAPE PLAN June 29, 2022 09:10:47am K:\WPB_LURC\04318\001 - NE 4th Ave FTL\CAD\Plansheets\L2.00 HARDSCAPE PLAN.dwg



Kimley»Horn
 1920 WENNA WAY #200
 WEST PALM BEACH, FL 33411
 PHONE: 561-845-0865 FAX: 561-330-2345
 WWW.KIMLEY-HORN.COM
 REGISTRY 696
 © 2022 KIMLEY-HORN AND ASSOCIATES, INC.

SEAL:
 JONATHAN D. HAIGH, PLA
 STATE LICENSE NUMBER
 LA #6666795
 06/30/2022

DATE: 07/01/2021
 DRAWN BY: DESIGNED BY: AS SHOWN
 CHECKED BY: FIELD BOOK

CITY OF FORT LAUDERDALE
 TRANSPORTATION & MOBILITY

 290 NE 3RD AVE., FORT LAUDERDALE, FL 33301

NO.	DATE	BY	DESCRIPTION

PROJECT # 12557
 NE 4TH AVENUE STREETSCAPE PROJECT
 E SUNRISE BLVD TO NE 13TH ST
 FORT LAUDERDALE, FL
 HARDSCAPE PLAN

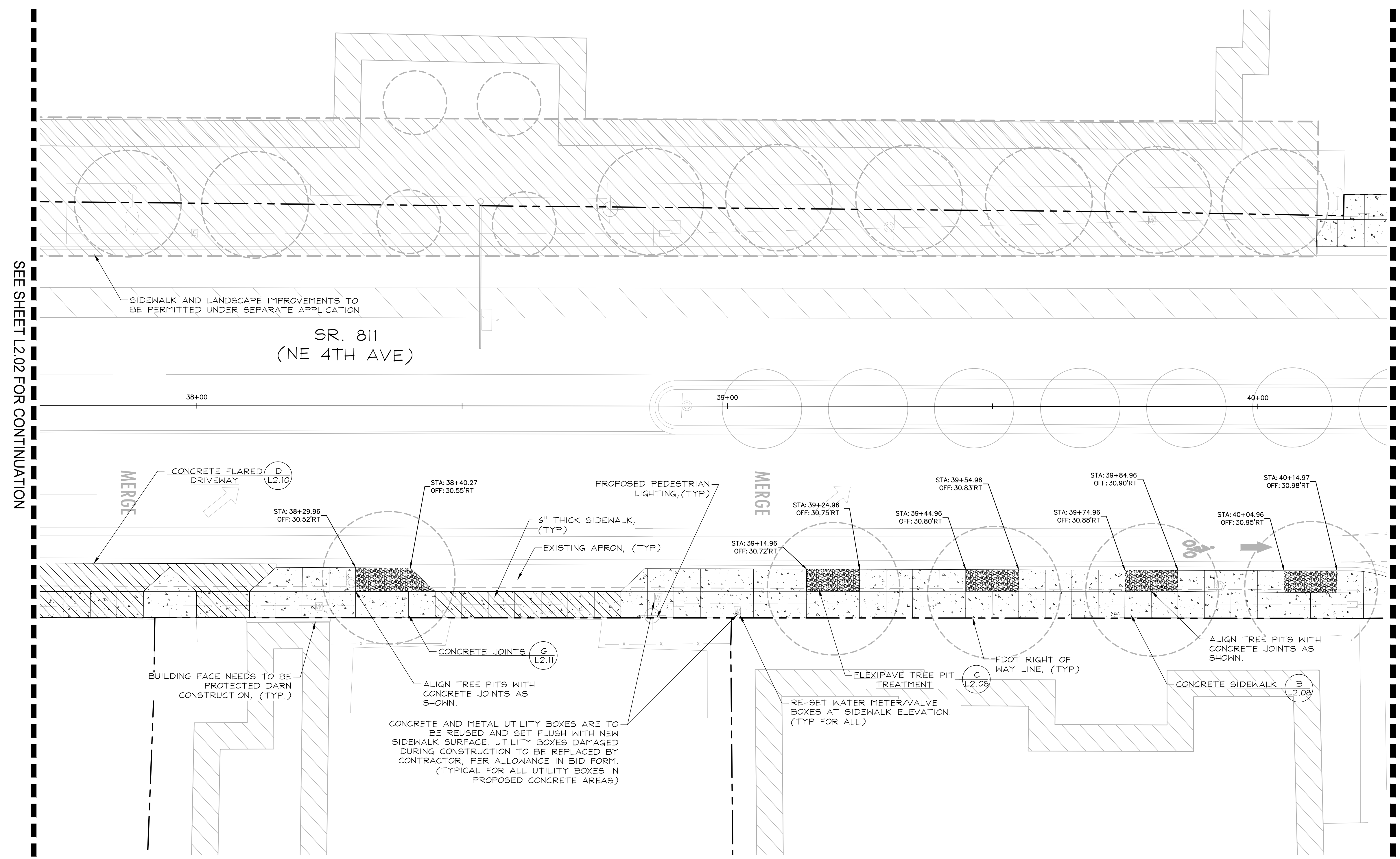
SHEET NO.
L2.03



SEE SHEET L2.02 FOR CONTINUATION

SEE SHEET L2.04 FOR CONTINUATION

Plotted By: Hargrett, Tom Sheet Set: NE 4th Avenue Layout: L2.03 HARDSCAPE PLAN June 29, 2022 09:10:50am K:\WPB_LURC\043184061 - NE 4th Ave FTL\CAD\Plansheets\L2.00 HARDSCAPE PLAN.dwg