

RACE NAME: Riverwalk 5 Miller Run
LOCATION: Ft. Lauderdale, FL.
MEASURED BY: Gene Witkowski

#FL10131EBM
 Effective 12/28/2010
 to 12/31/2020

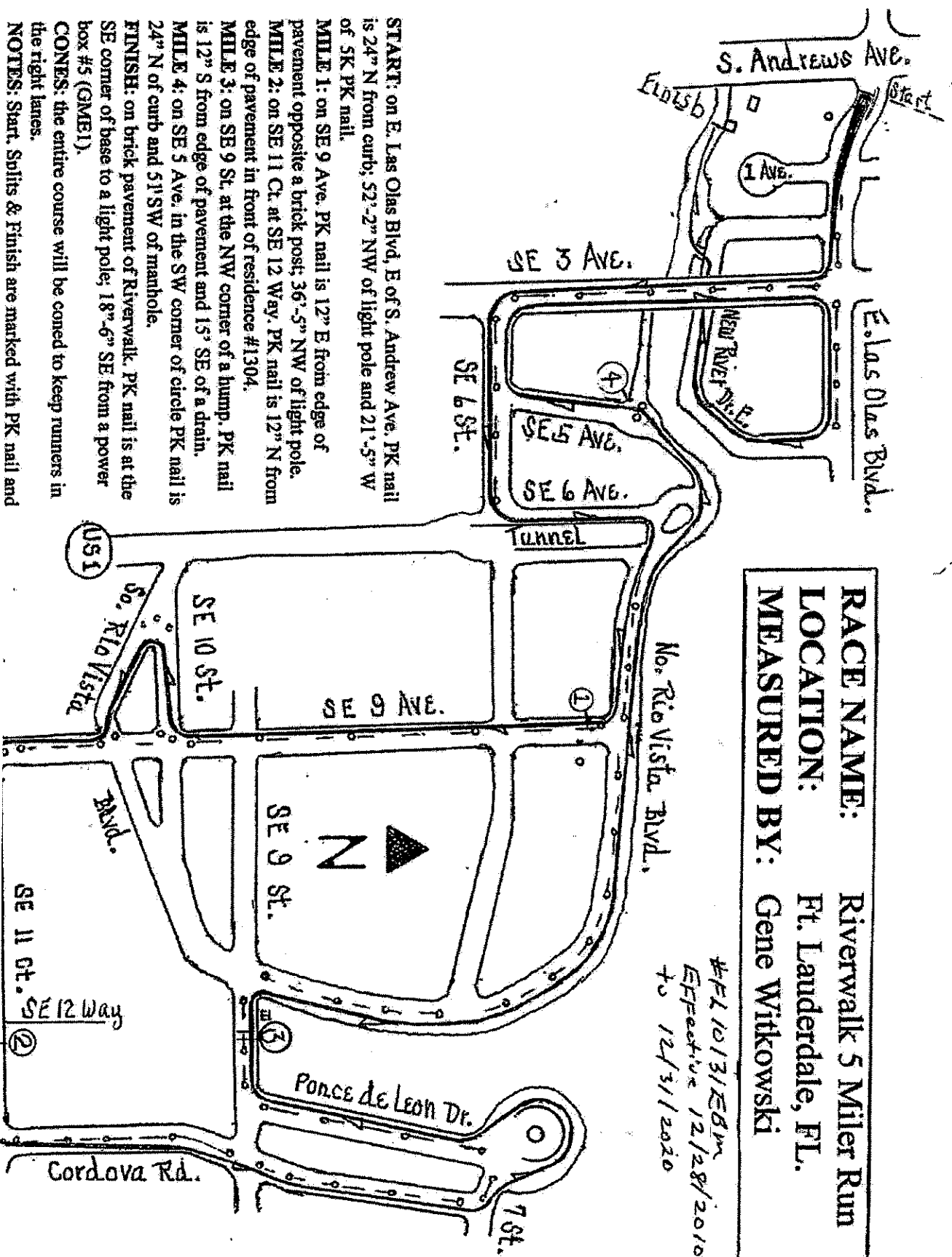

START: on E. Las Olas Blvd, E of S. Andrew Ave. PK nail is 24" N from curb; 52'-2" NW of light pole and 21'-5" W of 5K PK nail.

MILE 1: on SE 9 Ave. PK nail is 12" E from edge of pavement opposite a brick post; 36'-5" NW of light pole.

MILE 2: on SE 11 Ct. at SE 12 Way. PK nail is 12" N from edge of pavement in front of residence #1304.

MILE 3: on SE 9 St. at the NW corner of a hump. PK nail is 12" S from edge of pavement and 15" SE of a drain.

MILE 4: on SE 5 Ave. in the SW corner of circle PK nail is 24" N of curb and 51" SW of manhole.

FINISH: on brick pavement of Riverwalk. PK nail is at the SE corner of base to a light pole; 18'-6" SE from a power box #5 (GME1).

CONES: the entire course will be coned to keep runners in the right lanes.

NOTES: Start, Splits & Finish are marked with PK nail and