

**GENERAL NOTES:**

1. Work this Index with Specification 522.
2. Refer to Index 520-001 for drop curb details and Index 522-001 for joints between driveway, sidewalks, and curb.
3. Existing Curb and Gutter: Remove existing curb and gutter to either the nearest joint beyond the flared point or to where no remaining section is less than 5 feet long.
4. Grades and cross slopes shown are maximums.
5. Longitudinal Joints: Construct 1/2" open joints placed at equal (20' max.) intervals for driveways over 20' wide. Match joints in curb and gutter to match joints in driveways.
6. Transverse Joints: Construct 1/2" open joints @ 10' Centers and 1/2" expansion joints with preformed joint filler every 5th joint.
7. Construct driveways (6" thick concrete) to a uniform width (W) to the R/W line or the extent shown in the Plans.
8. Width of Sidewalk Thru Driveway is 4'-0" minimum. Match sidewalk width when shown in Plans or when utility strip width is equal to or greater than the depth of the Driveway Apron.
9. Alpha-Numeric Identification: Concrete Flared Driveway Alpha-Numeric Identifications (e.g. G4) are provided for reference purposes in the Plans.

**LEGEND:**

- Sidewalk
- Flared Driveway (6" Thick Concrete)
- Sidewalk Thru Driveway (6" Thick Concrete)
- Utility Strip
- G<sub>1</sub> Grade of Apron
- G<sub>2</sub> Grade of Driveway (Per Plans)

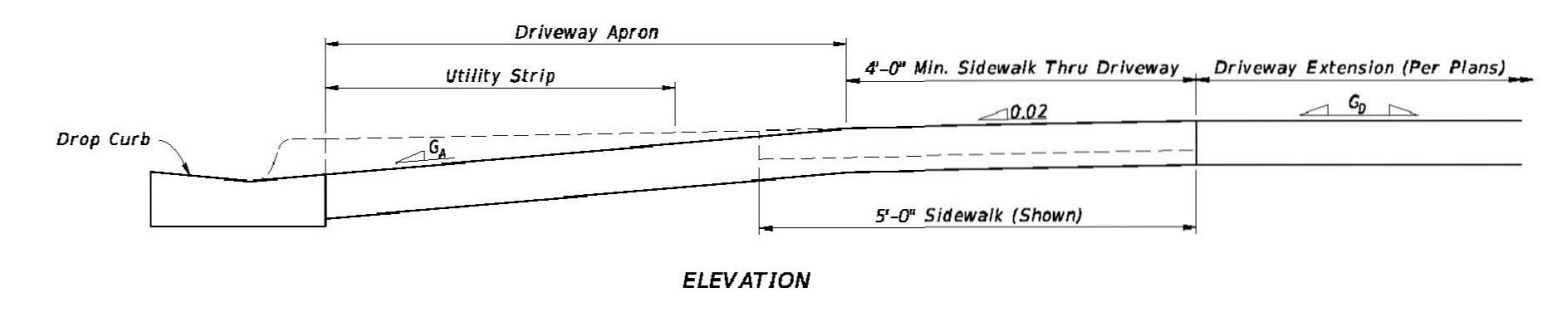
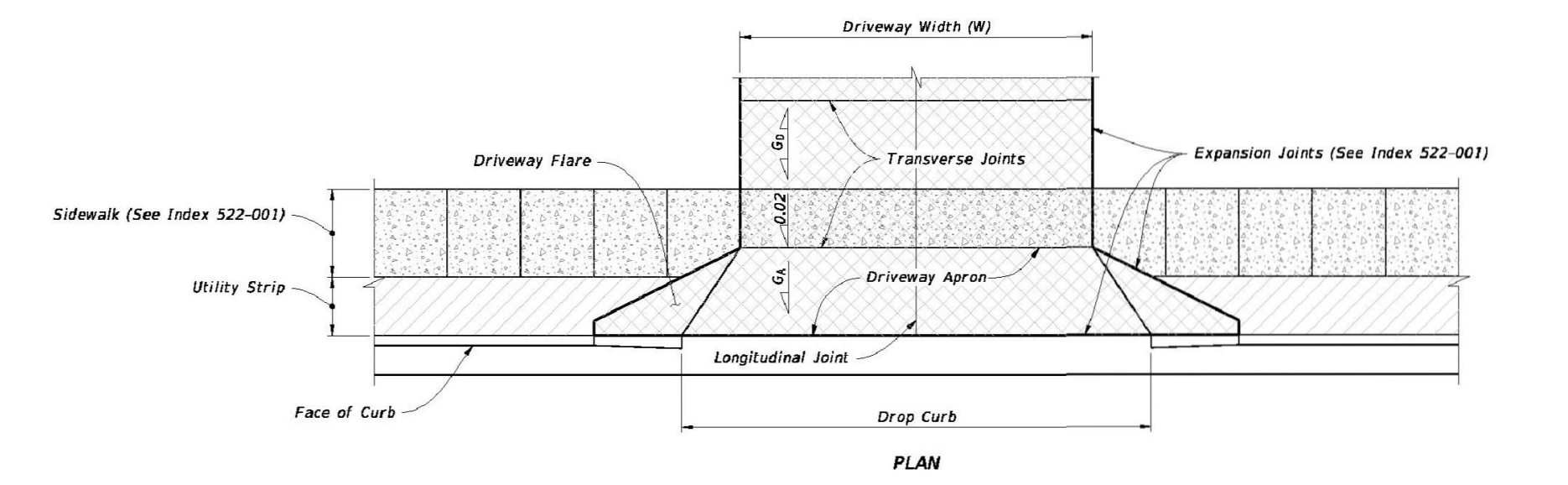

CONCRETE FLARED DRIVEWAY NOMENCLATURE

LAST REVISION 11/01/18	DESCRIPTION	FDOT FY 2021-22 STANDARD PLANS	INDEX 522-003	SHEET 1 of 4
---------------------------	-------------	--------------------------------------	------------------	-----------------

**D CONCRETE FLARED DRIVEWAY**

NTS

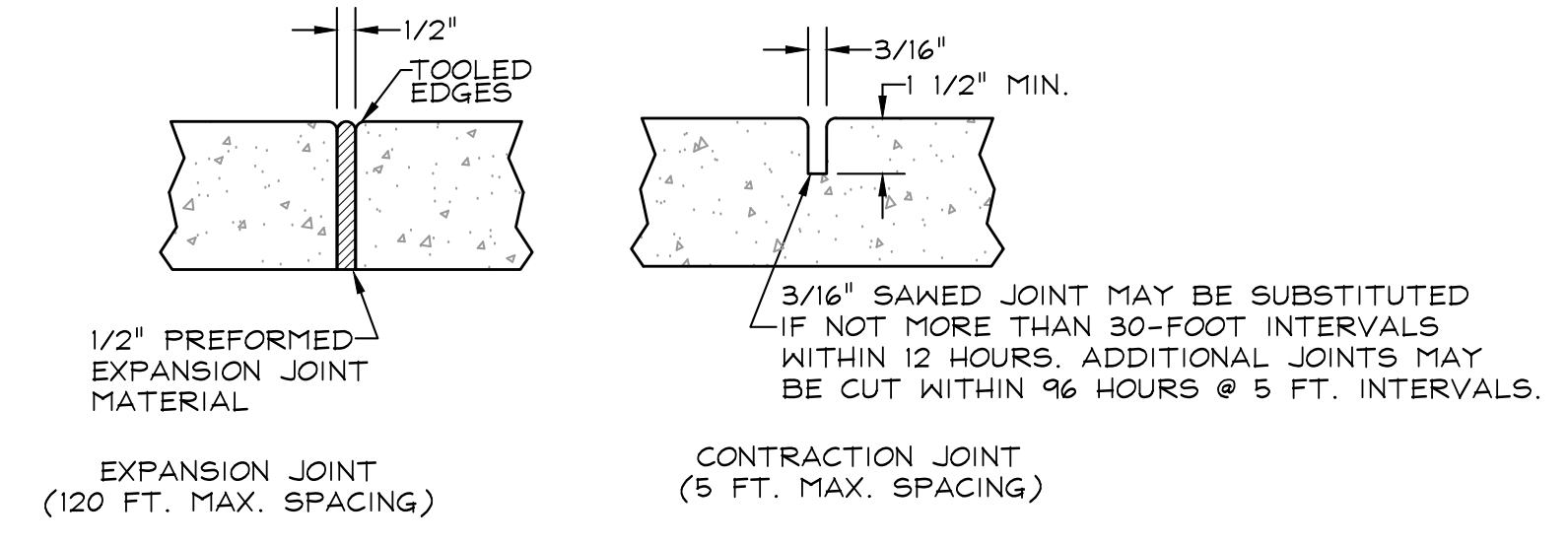

**NOTES:**

1. PROVIDE EXPANSION JOINTS BETWEEN NEW SIDEWALK AND EXISTING SIDEWALK, CURB, OR AT ANY OTHER RIGID STRUCTURE. EXPANSION JOINTS ALONG SIDEWALK SHALL BE PROVIDED AT 120' FT. MAXIMUM SPACING.
2. ULTIMATE COMPRESSIVE STRENGTH OF CONCRETE SHALL BE 3,000 P.S.I. @ 28 DAYS.
3. MINIMUM THICKNESS OF SIDEWALK SHALL BE AS SHOWN BELOW (WITH THICKENED EDGE AS SHOWN).
4. FOR SIDEWALKS WITH ANY VEHICULAR TRAFFIC, COMPACT SUBGRADE TO 98% OF MAXIMUM DENSITY AS DETERMINED BY ASTM1557. FOR SIDEWALKS WITH ONLY PEDESTRIAN TRAFFIC, COMPACTION MAY BE 95% OF MAXIMUM DENSITY.
5. TOOLED CONTRACTION JOINT SHALL BE PROVIDED AT 5 FT. MAXIMUM SPACING. SAWED CONTRACTION JOINT MAY BE SUBSTITUTED IF CUT AT NO MORE THAN 30 FT. INTERVALS WITHIN 12 HOURS AFTER CONCRETE HAS SET. ADDITIONAL CUTS @ 5 FT. INTERVALS MUST BE CUT WITHIN 96 HOURS.

**E CONCRETE JOINTS**

NTS

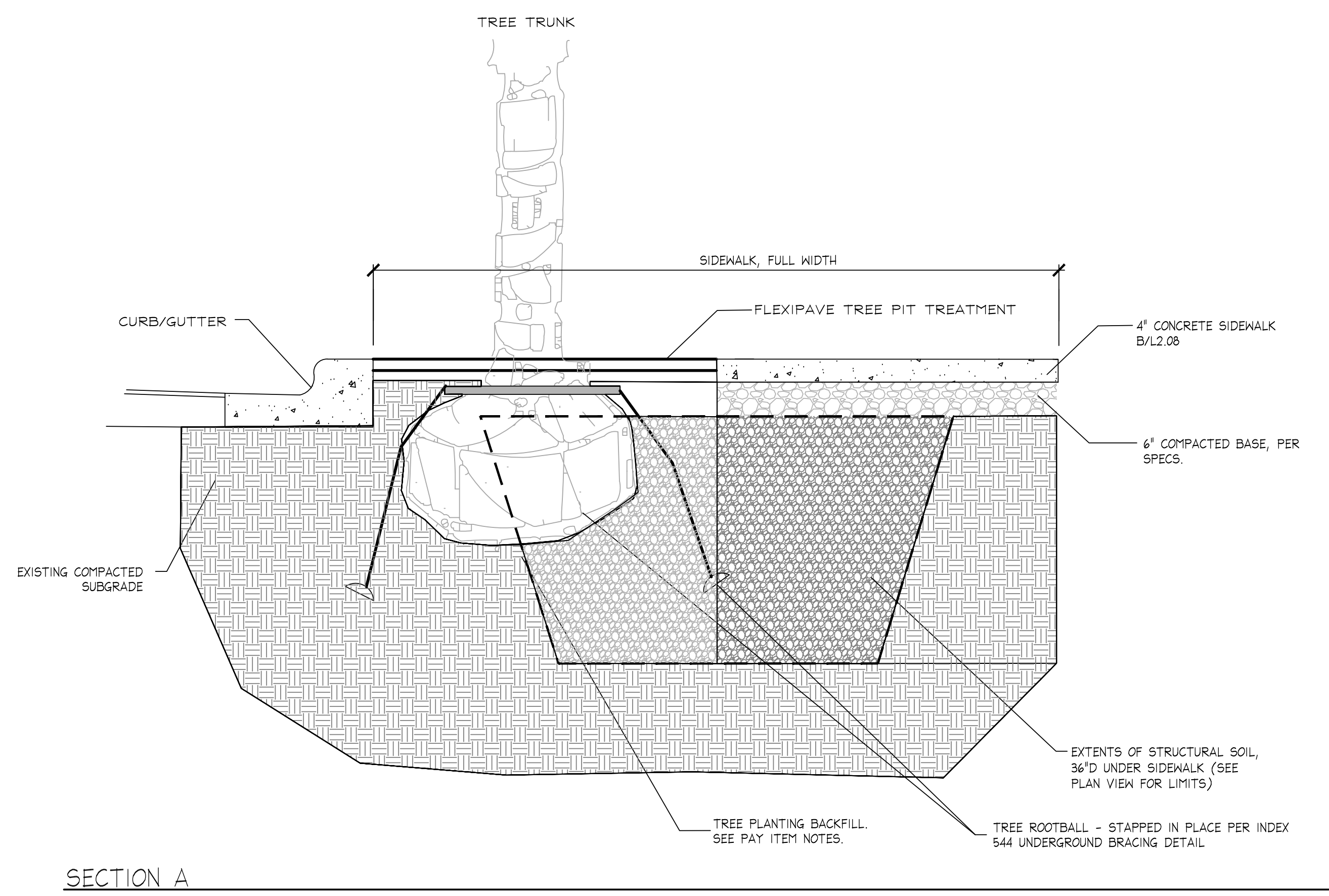

SECTION A

**F STRUCTURAL SOIL - TREE PLANTERS ONLY**

NTS

CONTRACTOR TO FIELD-ADJUST STRUCTURAL SOIL LIMITS TO MEET FIELD CONDITIONS. REFER TO PLANS AND TYPICAL SECTION FOR PROPOSED EXTENTS OF PLACEMENT @ 3' DEPTH.

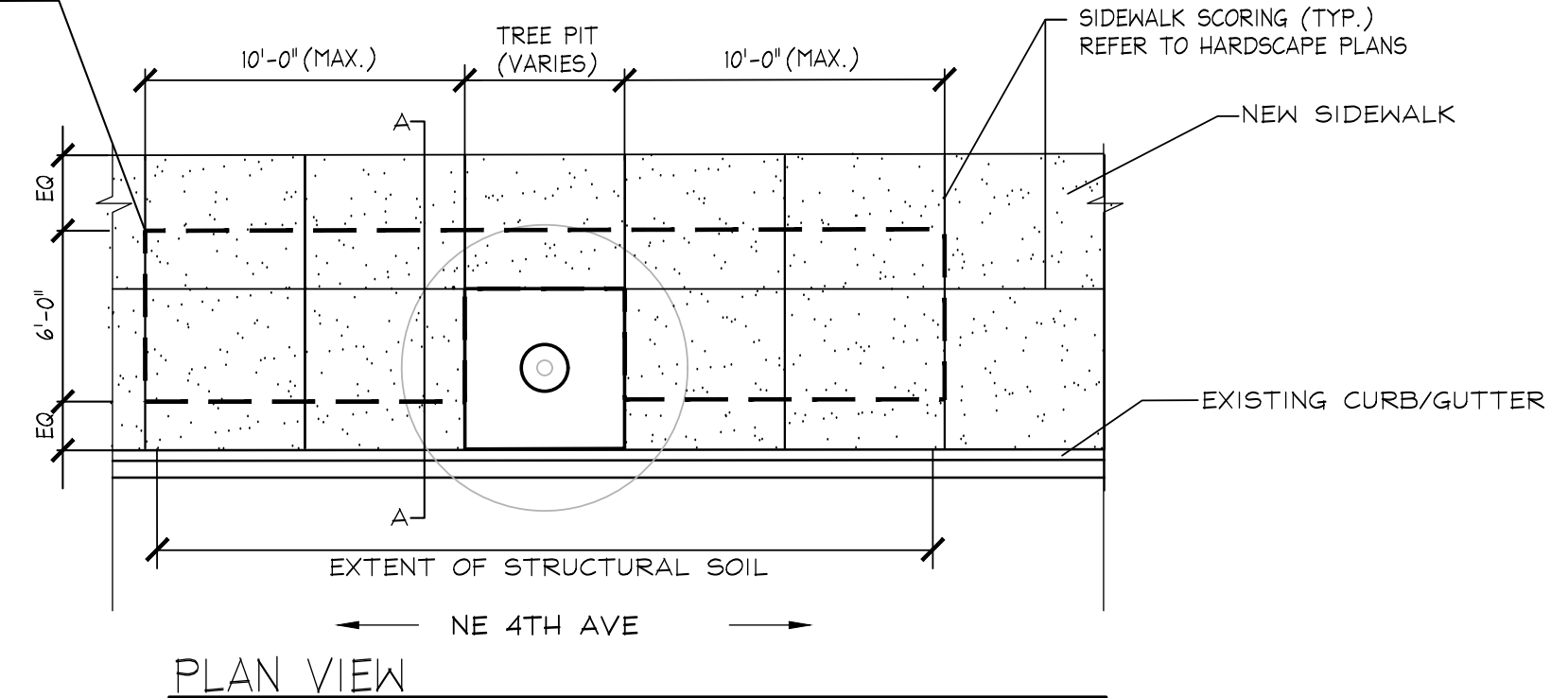

PLAN VIEW

**CU-STRUCTURAL SOIL MIX:**

1. 80% CLEAN STONE AND 20% CLAY LOAM AND 0.3% HYDROGEL MIX:
  - 1.1. CLEAN STONE SHALL BE GRANITE GRADED 3/4"-1-1/2", HIGHLY ANGULAR WITH NO FINES.
  - 1.2. CLAY LOAM SHALL CONSIST OF 45% GRAVEL, 25%-30% SAND, 20%-40% SILT, AND 25%-40% CLAY, 2%-5% ORGANIC MATTER.
  - 1.3. HYDROGEL ACTS AS A TACKIFIER SO SOIL WILL STICK TO STONE.
2. MIX THE HYDROGEL AND CLEAN STONE FIRST, THEN MIX IN THE CLAY LOAM MIX.
3. INSTALL STRUCTURAL SOIL IN 6" LIFTS, COMPACTING EACH TO 95% STANDARD PROCTOR.
4. SUBMIT PRODUCT DATA AND SAMPLES FOR APPROVAL.

**Kimley-Horn**  
1920 WERKVA WAY #200  
WEST PALM BEACH, FL 33411  
PHONE: 561-945-0065 FAX: 561-530-2245  
WWW.KIMLEY-HORN.COM  
REGISTRY #996  
© 2023 KIMLEY-HORN AND ASSOCIATES, INC.

REAL:  
JONATHAN D. HAIGH, PLA  
STATE LICENSE NUMBER  
LA #6666795  
06/30/2022

DRAWN BY: DATE: 07/01/2021  
DESIGNED BY: SCALE: AS SHOWN  
CHECKED BY:  
FIELD BOOK:

CITY OF FORT LAUDERDALE  
TRANSPORTATION & MOBILITY  
290 NE 3RD AVE., FORT LAUDERDALE, FL 33301

NO.	DATE	BY	DESCRIPTION

PROJECT # 12557  
NE 4TH AVENUE STREETSCAPE PROJECT  
E SUNRISE BLVD TO NE 13TH ST  
FORT LAUDERDALE, FL  
HARDSCAPE DETAILS

SHEET NO.  
**L2.12**

Plotted By: Hargrett, Tom Sheet Set: NE 4th Avenue Layout: L2.00 LANDSCAPE PLAN June 29, 2022 09:12:08am K:\WPB\_LURC\043184061 - NE 4th AVE FTL\CAD\PlanSheets\L3.00 LANDSCAPE PLAN.dwg

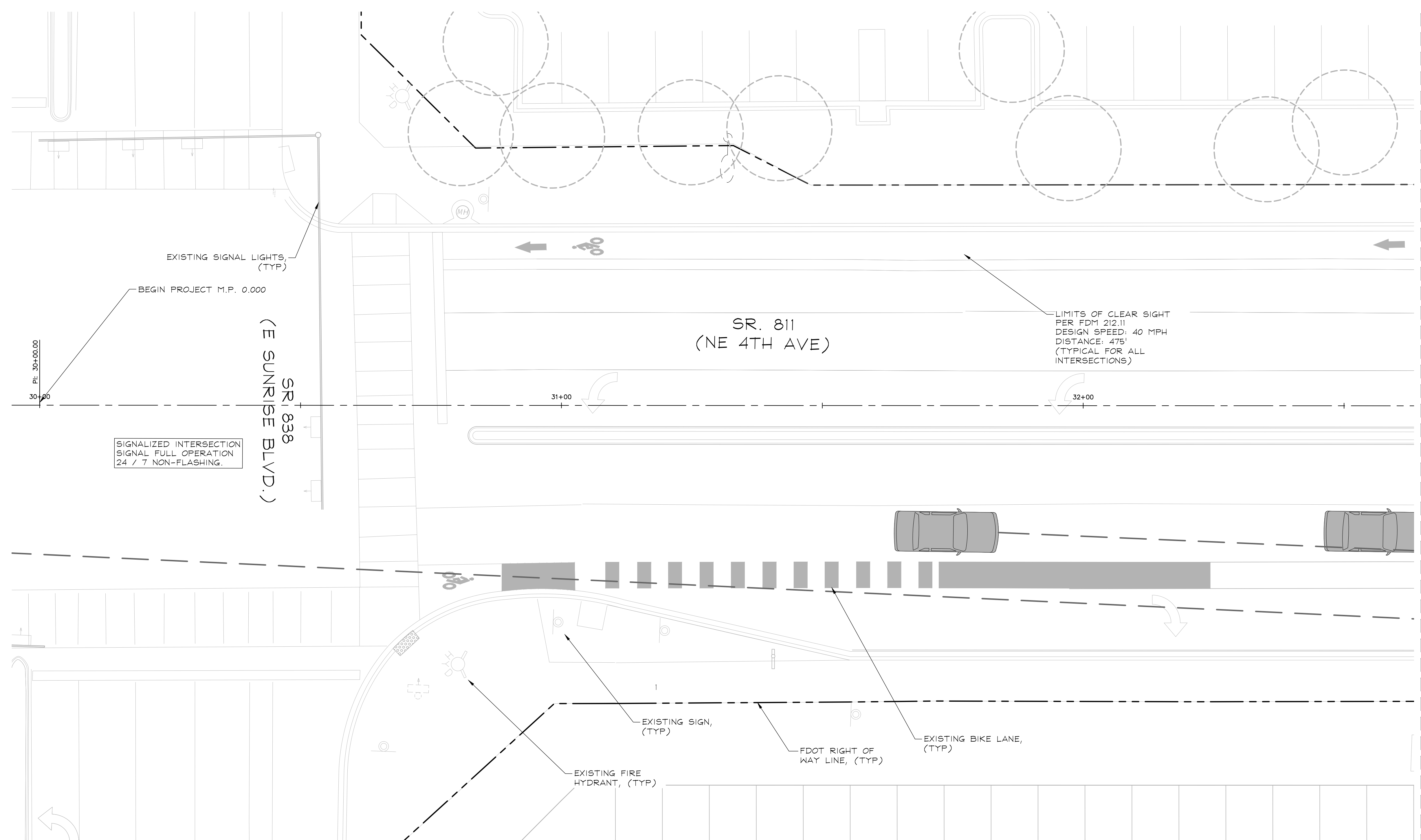

SEE SHEET L3.01 FOR CONTINUATION

**Kimley»Horn**  
 1920 WERVA WAY #200  
 WEST PALM BEACH, FL 33411  
 PHONE: 561-945-0665 FAX: 561-530-5245  
 WWW.KIMLEY-HORN.COM  
 REGISTRY 096  
 © 2023 KIMLEY-HORN AND ASSOCIATES, INC.

REAL:  
 JONATHAN D. HAIGH, PLA  
 STATE LICENSE NUMBER  
 LA #6666795  
 06/30/2022

DRAWN BY: DATE: 07/01/2021  
 DESIGNED BY: SCALE: AS SHOWN  
 CHECKED BY:  
 FIELD BOOK:

CITY OF FORT LAUDERDALE  
 TRANSPORTATION & MOBILITY  
  
 290 NE 3RD AVE., FORT LAUDERDALE, FL 33301

REVISIONS	
NO.	DESCRIPTION

PROJECT # 12557  
 NE 4TH AVENUE STREETSCAPE PROJECT  
 E SUNRISE BLVD TO NE 13TH ST  
 FORT LAUDERDALE, FL  
 LANDSCAPE PLAN  
 SHEET NO.  
**L3.00**

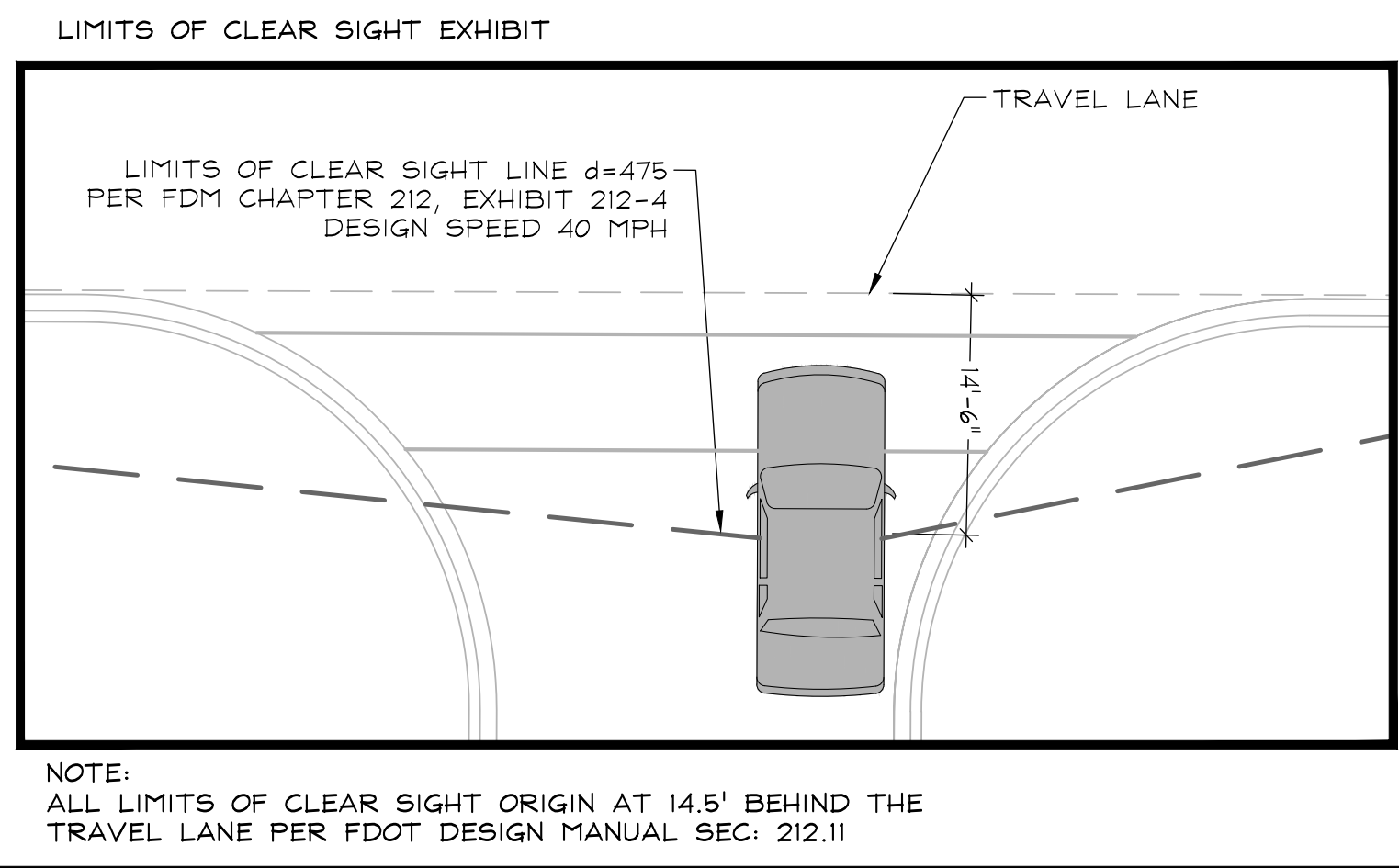

NO PROPOSED IMPROVEMENTS, THIS SHEET

NOTE: EXISTING SHRUB AND GROUND COVER PLANTINGS LOCATED WITHIN CLEAR SIGHT LIMIT INDICATED TO REMAIN SHALL BE TRIMMED 12" FROM BACK OF CURB AND MAINTAINED HEIGHT NOT TO EXCEED 10". ALL TREES AND PALMS TO BE MAINTAINED WITH 8' OF CLEAR TRUNK.

NOTE: THE FDOT REQUIRES A 14.5' VERTICAL CLEARANCE ABOVE ROADWAYS AND ALSO REQUIRES AN 8.5' VERTICAL CLEARANCE ABOVE WALKWAYS.

NOTE: SECTION 7-1.4: COMPLIANCE WITH FEDERAL ENDANGERED SPECIES ACT AND OTHER WILDLIFE REGULATIONS OF THE FDOT STANDARD SPECIFICATIONS FOR ROAD AND BRIDGE CONSTRUCTION MANUAL SHOULD BE ADHERED TO FOR WILDLIFE INVOLVEMENT DURING CONSTRUCTION.

**PLANT SCHEDULE**

TREES	COMMON NAME
LA	Muskogee Grape Myrtle 8' CT, Standard
LD	Natchez Grape Myrtle 8' CT, Standard
QV	High Rise Live Oak 8' CT
VA	Montgomery Palm Single Trunk, 10' GW MIN.

VERTICAL DATUM  
 ELEVATIONS SHOWN HEREON ARE BASED ON THE NORTH AMERICAN VERTICAL DATUM OF 1988.  
 NAVD '88 ELEV. + 1.565' = NGVD '29 ELEVATION

THE PRESENCE OF GROUNDWATER SHOULD BE ANTICIPATED. CONTRACTOR'S BID SHALL INCLUDE CONSIDERATION FOR ADDRESSING THIS ISSUE AND OBTAINING ALL NECESSARY PERMITS.

CALL 2 WORKING DAYS BEFORE YOU DIG

IT'S THE LAW!  
 DIAL 811  
 Know what's below.  
 Call before you dig.  
  
 SUNSHINE STATE ONE CALL OF FLORIDA, INC.

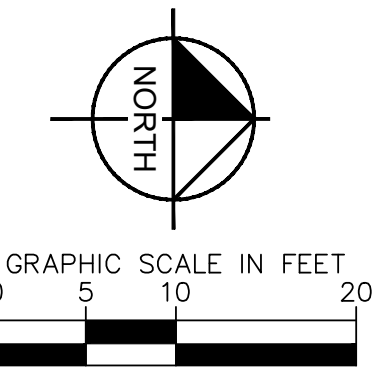

**Kimley»Horn**  
 1920 WERVA WAY #200  
 WEST PALM BEACH, FL 33411  
 PHONE: 561-945-0665 FAX: 561-530-2245  
 WWW.KIMLEY-HORN.COM  
 REGISTRY 696  
 © 2023 KIMLEY-HORN AND ASSOCIATES, INC.

REAL: JONATHAN D. HAIGH, PLA  
 STATE LICENSE NUMBER LA #6666795  
 06/30/2022

DRAWN BY: DATE: 07/01/2021  
 DESIGNED BY: SCALE: AS SHOWN  
 CHECKED BY: FIELD BOOK:

CITY OF FORT LAUDERDALE  
 TRANSPORTATION & MOBILITY  
  
 290 NE 3RD AVE., FORT LAUDERDALE, FL 33301

REVISIONS		DESCRIPTION
NO.	DATE	BY

PROJECT # 12557  
 NE 4TH AVENUE STREETSCAPE PROJECT  
 E SUNRISE BLVD TO NE 13TH ST  
 FORT LAUDERDALE, FL  
 LANDSCAPE PLAN  
 SHEET NO. L3.01

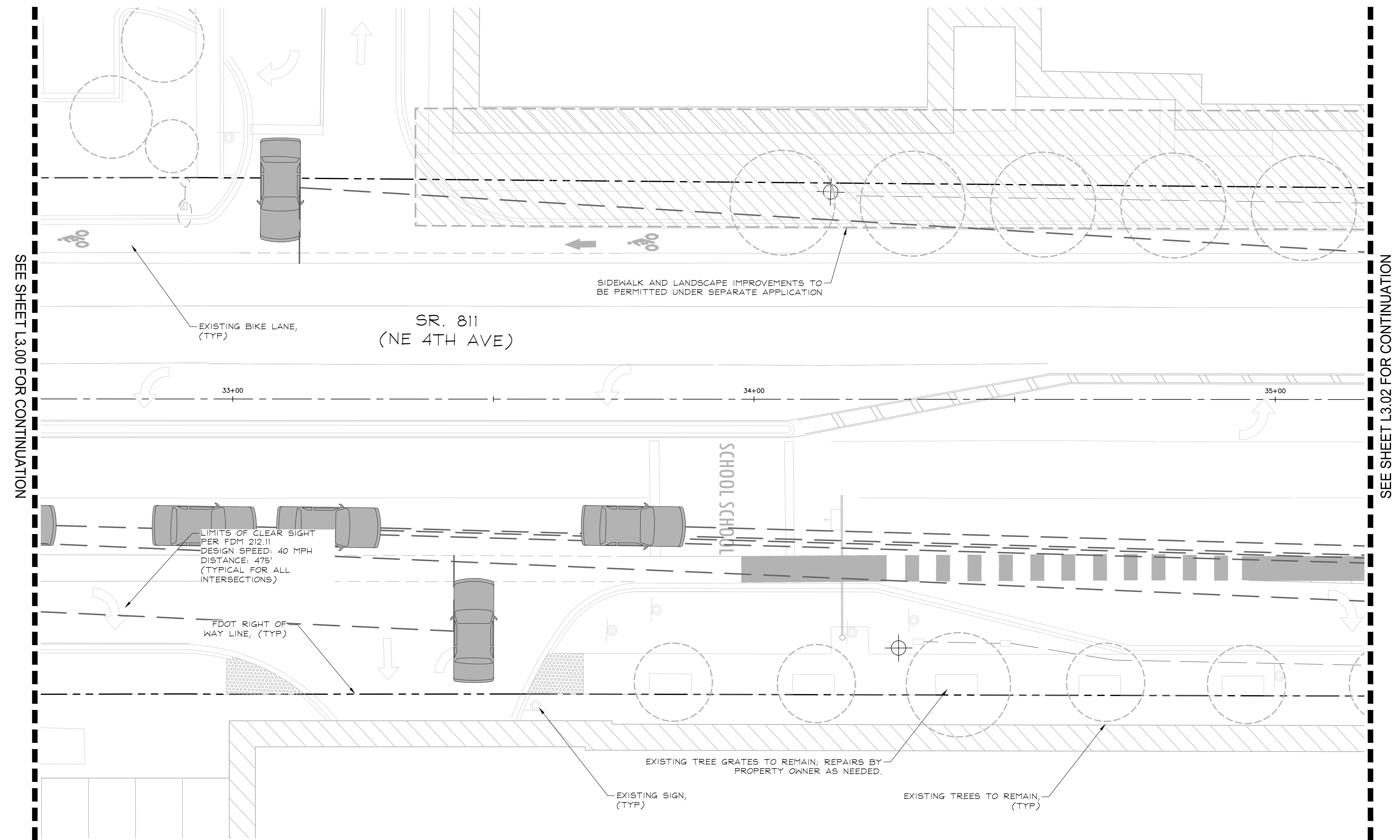

SEE SHEET L3.00 FOR CONTINUATION

SEE SHEET L3.02 FOR CONTINUATION

NO PROPOSED IMPROVEMENTS, THIS SHEET

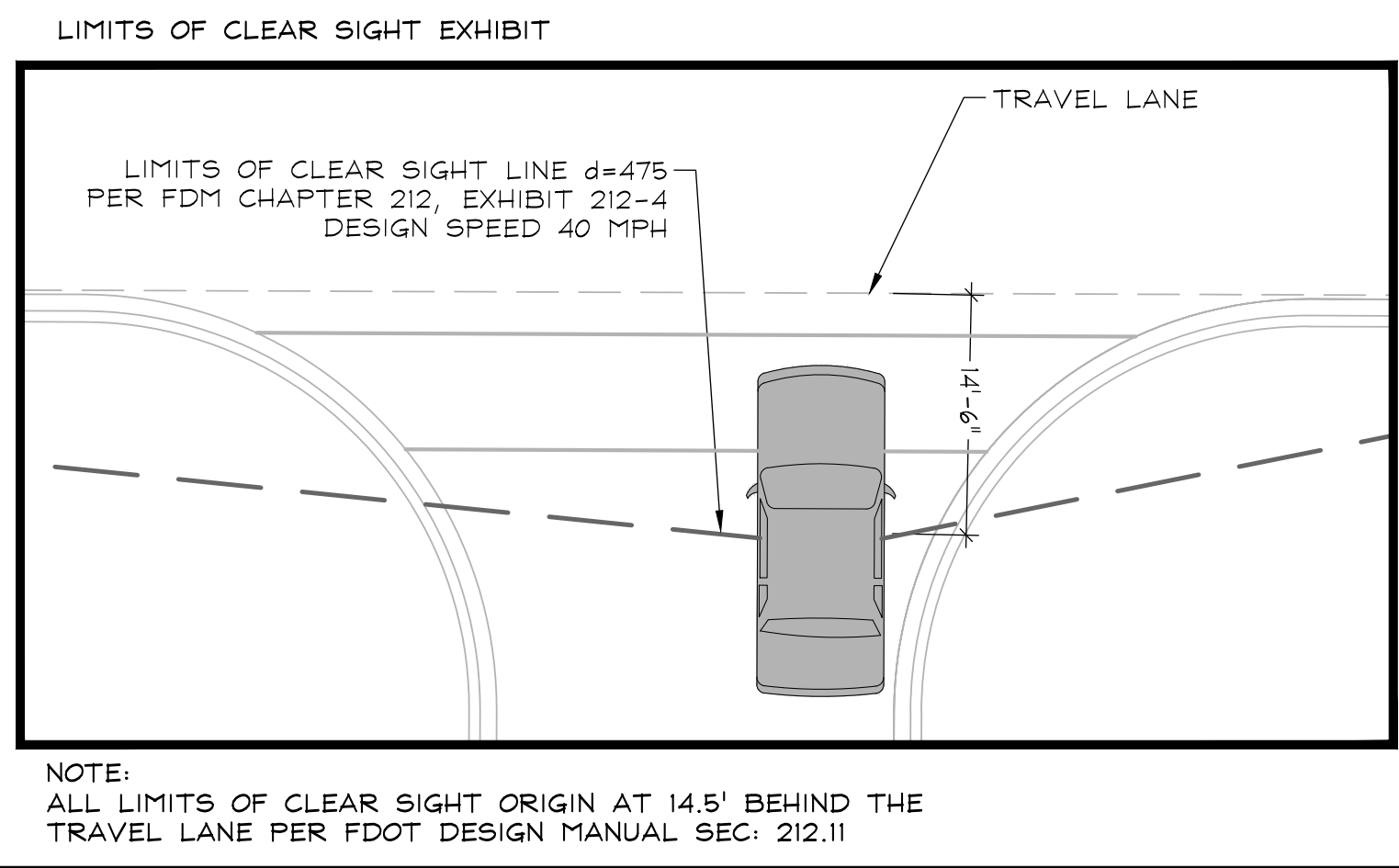

NOTE: EXISTING SHRUB AND GROUND COVER PLANTINGS LOCATED WITHIN CLEAR SIGHT LIMIT INDICATED TO REMAIN SHALL BE TRIMMED 12" FROM BACK OF CURB AND MAINTAINED HEIGHT NOT TO EXCEED 10". ALL TREES AND PALMS TO BE MAINTAINED WITH 8' OF CLEAR TRUNK.

NOTE: THE FDOT REQUIRES A 14.5' VERTICAL CLEARANCE ABOVE ROADWAYS AND ALSO REQUIRES AN 8.5' VERTICAL CLEARANCE ABOVE WALKWAYS.

NOTE: SECTION 7-1.4. COMPLIANCE WITH FEDERAL ENDANGERED SPECIES ACT AND OTHER WILDLIFE REGULATIONS OF THE FDOT STANDARD SPECIFICATIONS FOR ROAD AND BRIDGE CONSTRUCTION MANUAL SHOULD BE ADHERED TO FOR WILDLIFE INVOLVEMENT DURING CONSTRUCTION.

PLANT SCHEDULE

TREES	COMMON NAME
LA	Muskogee Grape Myrtle 8' CT, Standard
LD	Natchez Grape Myrtle 8' CT, Standard
QV	High Rise Live Oak 8' CT
VA	Montgomery Palm Single Trunk, 10' GW MIN.

VERTICAL DATUM  
 ELEVATIONS SHOWN HEREON ARE BASED ON THE NORTH AMERICAN VERTICAL DATUM OF 1988.  
 NAVD '88 ELEV. + 1.565' = NGVD '29 ELEVATION

THE PRESENCE OF GROUNDWATER SHOULD BE ANTICIPATED. CONTRACTOR'S BID SHALL INCLUDE CONSIDERATION FOR ADDRESSING THIS ISSUE AND OBTAINING ALL NECESSARY PERMITS.

CALL 2 WORKING DAYS BEFORE YOU DIG



IT'S THE LAW!  
 DIAL 811  
 SUNSHINE STATE ONE CALL OF FLORIDA, INC.

**Kimley-Horn**  
1920 WERVA WAY #200  
WEST PALM BEACH, FL 33411  
PHONE: 561-945-0665 FAX:  
561-530-2245  
WWW.KIMLEY-HORN.COM  
REGISTRY 096  
© 2023 KIMLEY-HORN AND  
ASSOCIATES, INC.

REAL:  
JONATHAN D. HAIGH, PLA  
STATE LICENSE NUMBER  
LA #6666795  
06/30/2022

DRAWN BY: DATE: 07/01/2021  
DESIGNED BY: SCALE: AS SHOWN  
CHECKED BY:  
FIELD BOOK:

CITY OF FORT LAUDERDALE  
TRANSPORTATION & MOBILITY  
290 NE 3RD AVE., FORT LAUDERDALE, FL 33301

REVISIONS

NO.	DATE	BY	CHKD	DESCRIPTION

PROJECT # 12557  
NE 4TH AVENUE STREETSCAPE PROJECT  
E SUNRISE BLVD TO NE 13TH ST  
FORT LAUDERDALE, FL  
LANDSCAPE PLAN

SHEET NO.  
L3.02

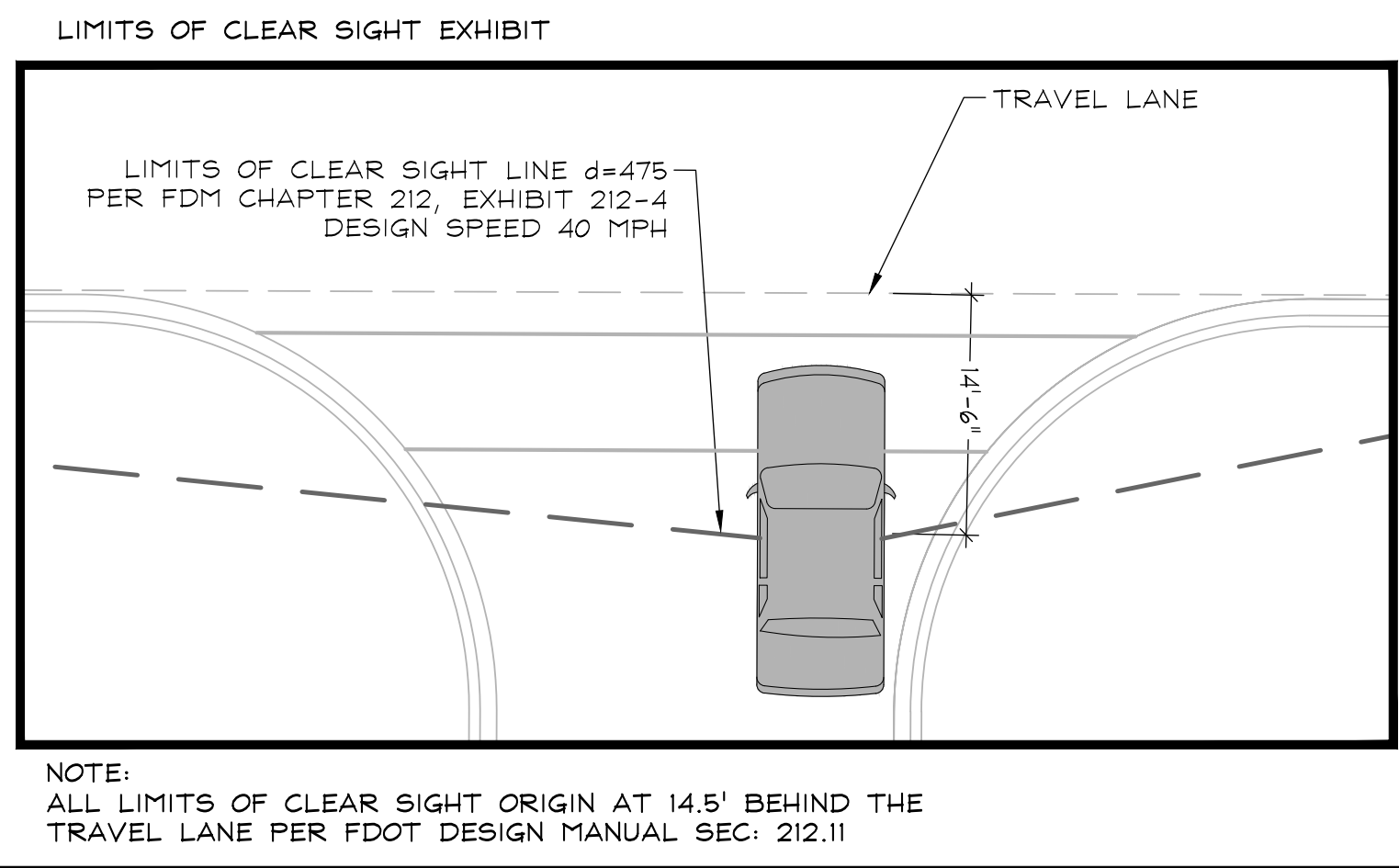
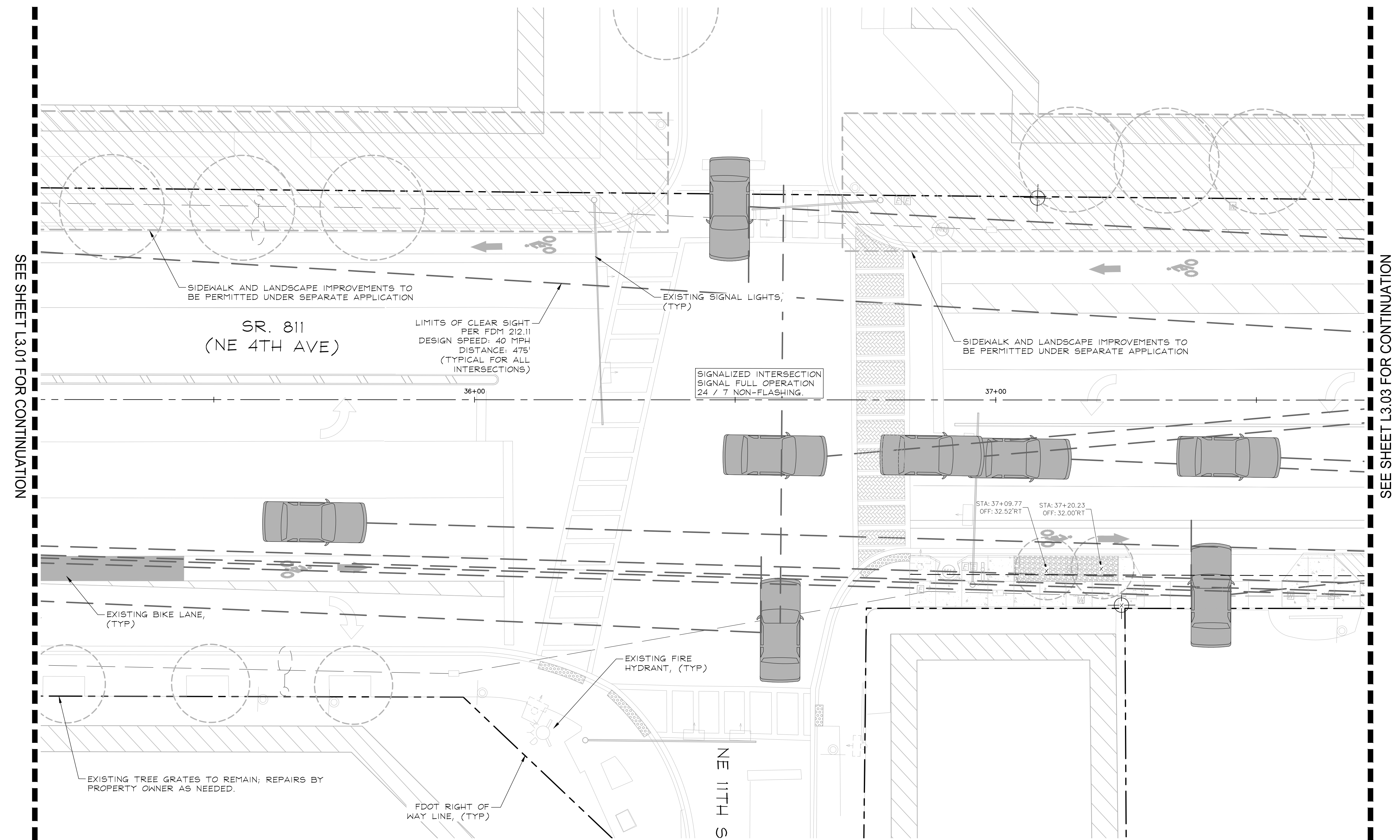
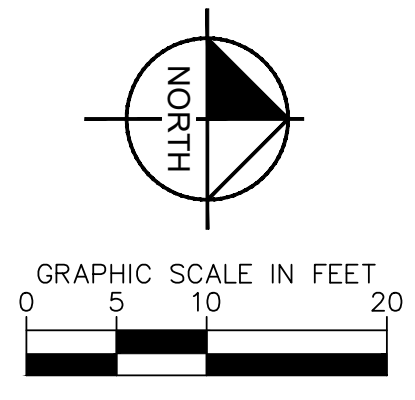

NOTE: EXISTING SHRUB AND GROUND COVER PLANTINGS LOCATED WITHIN CLEAR SIGHT LIMIT INDICATED TO REMAIN SHALL BE TRIMMED 12" FROM BACK OF CURB AND MAINTAINED HEIGHT NOT TO EXCEED 18". ALL TREES AND PALMS TO BE MAINTAINED WITH 8' OF CLEAR TRUNK.

NOTE: THE FDOT REQUIRES A 14.5' VERTICAL CLEARANCE ABOVE ROADWAYS AND ALSO REQUIRES AN 8.5' VERTICAL CLEARANCE ABOVE WALKWAYS.

NOTE: SECTION 7-1.4: COMPLIANCE WITH FEDERAL ENDANGERED SPECIES ACT AND OTHER WILDLIFE REGULATIONS OF THE FDOT STANDARD SPECIFICATIONS FOR ROAD AND BRIDGE CONSTRUCTION MANUAL SHOULD BE ADHERED TO FOR WILDLIFE INVOLVEMENT DURING CONSTRUCTION.

PLANT SCHEDULE

TREES	COMMON NAME
LA	Muskogee Grape Myrtle 8' CT, Standard
LD	Natchez Grape Myrtle 8' CT, Standard
QV	High Rise Live Oak 8' CT
VA	Montgomery Palm Single Trunk, 10' GW MIN.

VERTICAL DATUM  
ELEVATIONS SHOWN HEREON ARE BASED ON THE NORTH AMERICAN VERTICAL DATUM OF 1988.  
NAVD '88 ELEV. + 1.565' = NGVD '29 ELEVATION

THE PRESENCE OF GROUNDWATER SHOULD BE ANTICIPATED. CONTRACTOR'S BID SHALL INCLUDE CONSIDERATION FOR ADDRESSING THIS ISSUE AND OBTAINING ALL NECESSARY PERMITS.

CALL 2 WORKING DAYS BEFORE YOU DIG

IT'S THE LAW!  
DIAL 811  
Know what's below.  
Call before you dig.

SUNSHINE STATE ONE CALL OF FLORIDA, INC.

Plotted By: Hargrett, Tom Sheet Set: NE 4th Avenue Layout: L2.02 LANDSCAPE PLAN June 29, 2022 09:12:25am K:\WPB\_LURG\043184061 - NE 4th Ave FTL\CAD\PlanSheets\L3.00 LANDSCAPE PLAN.dwg

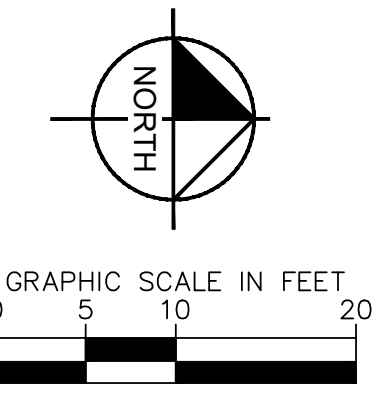

**KimleyHorn**  
 1920 WERVIA WAY #200  
 WEST PALM BEACH, FL 33411  
 PHONE: 561-945-0665 FAX: 561-530-2245  
 WWW.KIMLEY-HORN.COM  
 REGISTRY 096  
 © 2023 KIMLEY-HORN AND ASSOCIATES, INC.

REAL: JONATHAN D. HAIGH, PLA  
 STATE LICENSE NUMBER LA #6666795  
 06/30/2022

DRAWN BY: DATE: 07/01/2021  
 DESIGNED BY: SCALE: AS SHOWN  
 CHECKED BY: FIELD BOOK:

CITY OF FORT LAUDERDALE  
 TRANSPORTATION & MOBILITY  
  
 290 NE 3RD AVE., FORT LAUDERDALE, FL 33301

REVISIONS		DESCRIPTION
NO.	DATE	BY (CHK'D)

PROJECT # 12557  
 NE 4TH AVENUE STREETSCAPE PROJECT  
 E SUNRISE BLVD TO NE 13TH ST  
 FORT LAUDERDALE, FL  
 LANDSCAPE PLAN

SHEET NO. L3.03

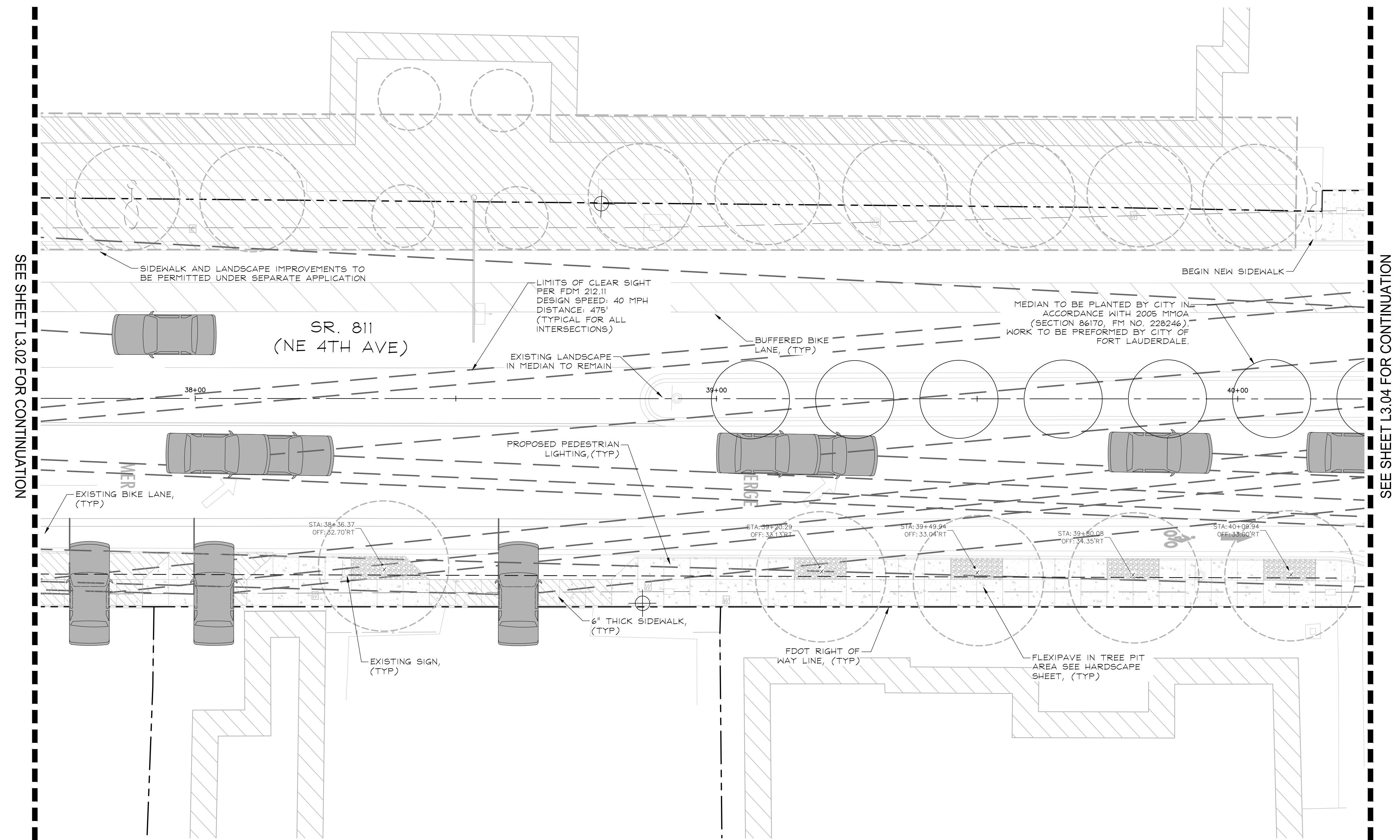

SEE SHEET L3.02 FOR CONTINUATION

SEE SHEET L3.04 FOR CONTINUATION

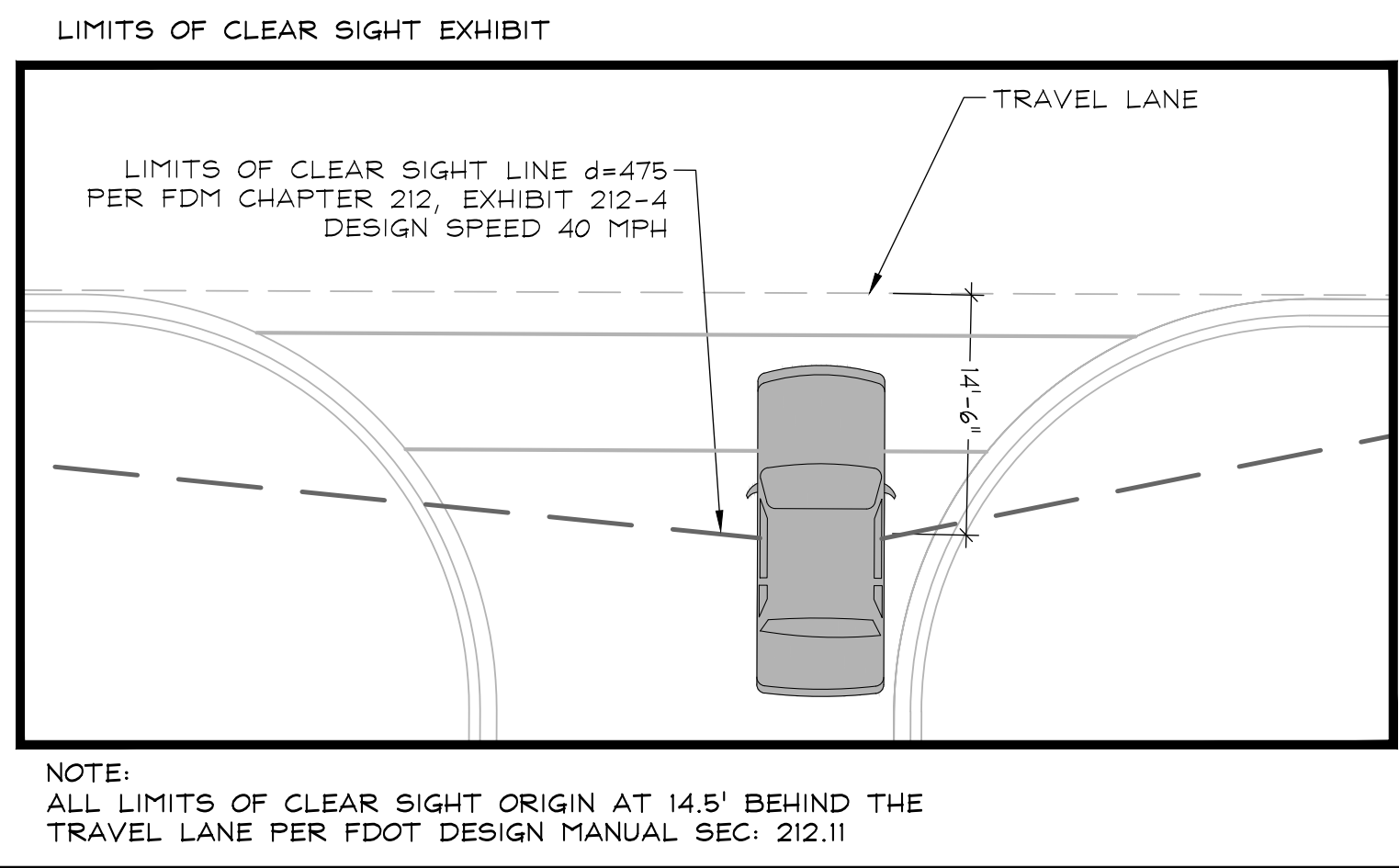

NOTE: EXISTING SHRUB AND GROUND COVER PLANTINGS LOCATED WITHIN CLEAR SIGHT LIMIT INDICATED TO REMAIN SHALL BE TRIMMED 12" FROM BACK OF CURB AND MAINTAINED HEIGHT NOT TO EXCEED 18". ALL TREES AND PALMS TO BE MAINTAINED WITH 8' OF CLEAR TRUNK.

NOTE: THE FDOT REQUIRES A 14.5' VERTICAL CLEARANCE ABOVE ROADWAYS AND ALSO REQUIRES AN 8.5' VERTICAL CLEARANCE ABOVE WALKWAYS.

NOTE: SECTION 7-1.4: COMPLIANCE WITH FEDERAL ENDANGERED SPECIES ACT AND OTHER WILDLIFE REGULATIONS OF THE FDOT STANDARD SPECIFICATIONS FOR ROAD AND BRIDGE CONSTRUCTION MANUAL SHOULD BE ADHERED TO FOR WILDLIFE INVOLVEMENT DURING CONSTRUCTION.

PLANT SCHEDULE

TREES	COMMON NAME
LA	Muskogee Grape Myrtle 8' CT, Standard
LD	Natchez Grape Myrtle 8' CT, Standard
QV	High Rise Live Oak 8' CT
VA	Montgomery Palm Single Trunk, 10' GW MIN.

VERTICAL DATUM  
 ELEVATIONS SHOWN HEREON ARE BASED ON THE NORTH AMERICAN VERTICAL DATUM OF 1988.  
 NAVD '88 ELEV. + 1.565' = NGVD '29 ELEVATION

THE PRESENCE OF GROUNDWATER SHOULD BE ANTICIPATED. CONTRACTOR'S BID SHALL INCLUDE CONSIDERATION FOR ADDRESSING THIS ISSUE AND OBTAINING ALL NECESSARY PERMITS.

CALL 2 WORKING DAYS BEFORE YOU DIG

IT'S THE LAW!  
 DIAL 811  
 Know what's below.  
 Call before you dig.  
 SUNSHINE STATE ONE CALL OF FLORIDA, INC.

Plotted By: Hargrett, Tom Sheet Set: NE 4th Avenue Layout: L2.04 LANDSCAPE PLAN June 29, 2022 09:12:43am K:\WPB\_LRG\_043184061 - NE 4th Ave FTL\CAD\PlanSheets\L3.00 LANDSCAPE PLAN.dwg

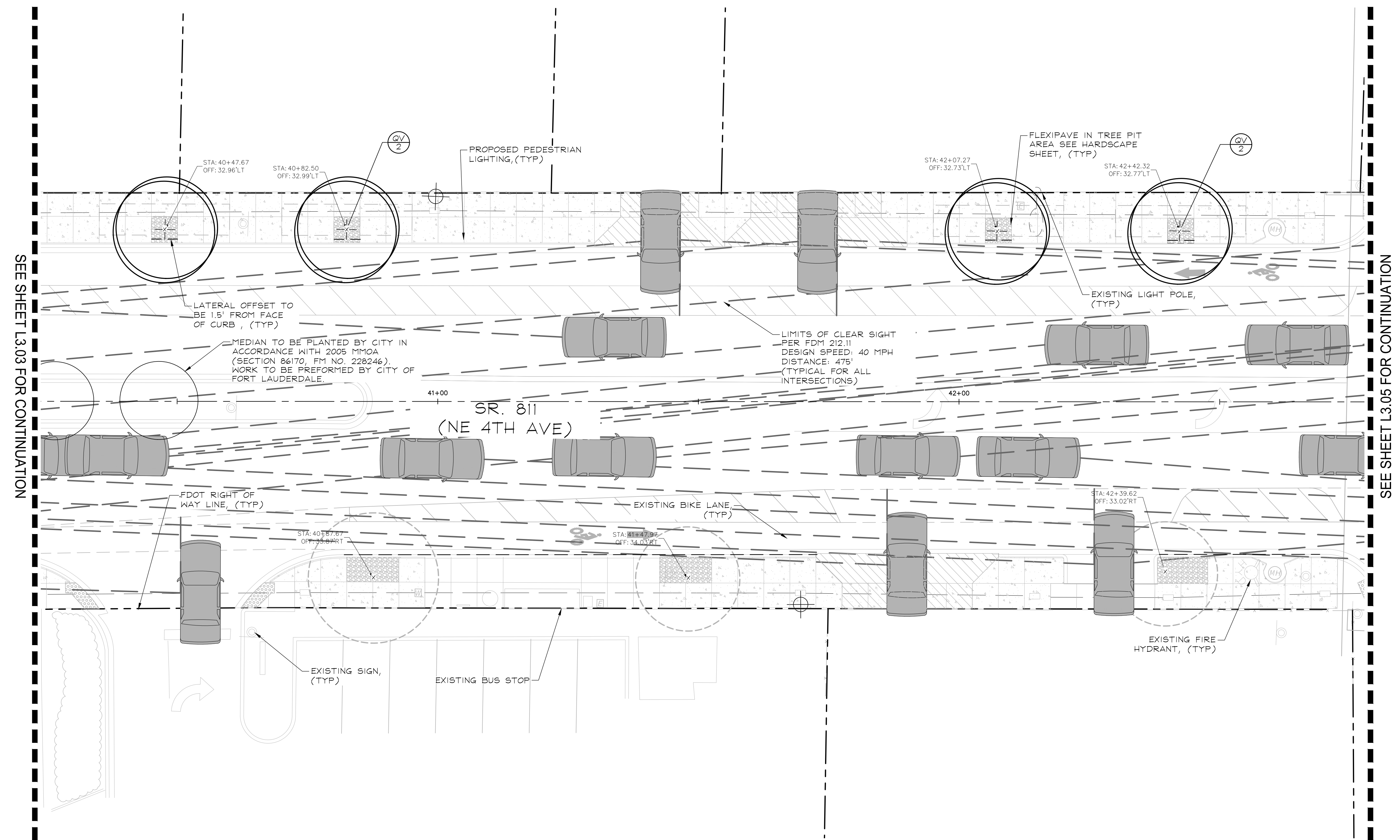

SEE SHEET L3.03 FOR CONTINUATION

SEE SHEET L3.05 FOR CONTINUATION

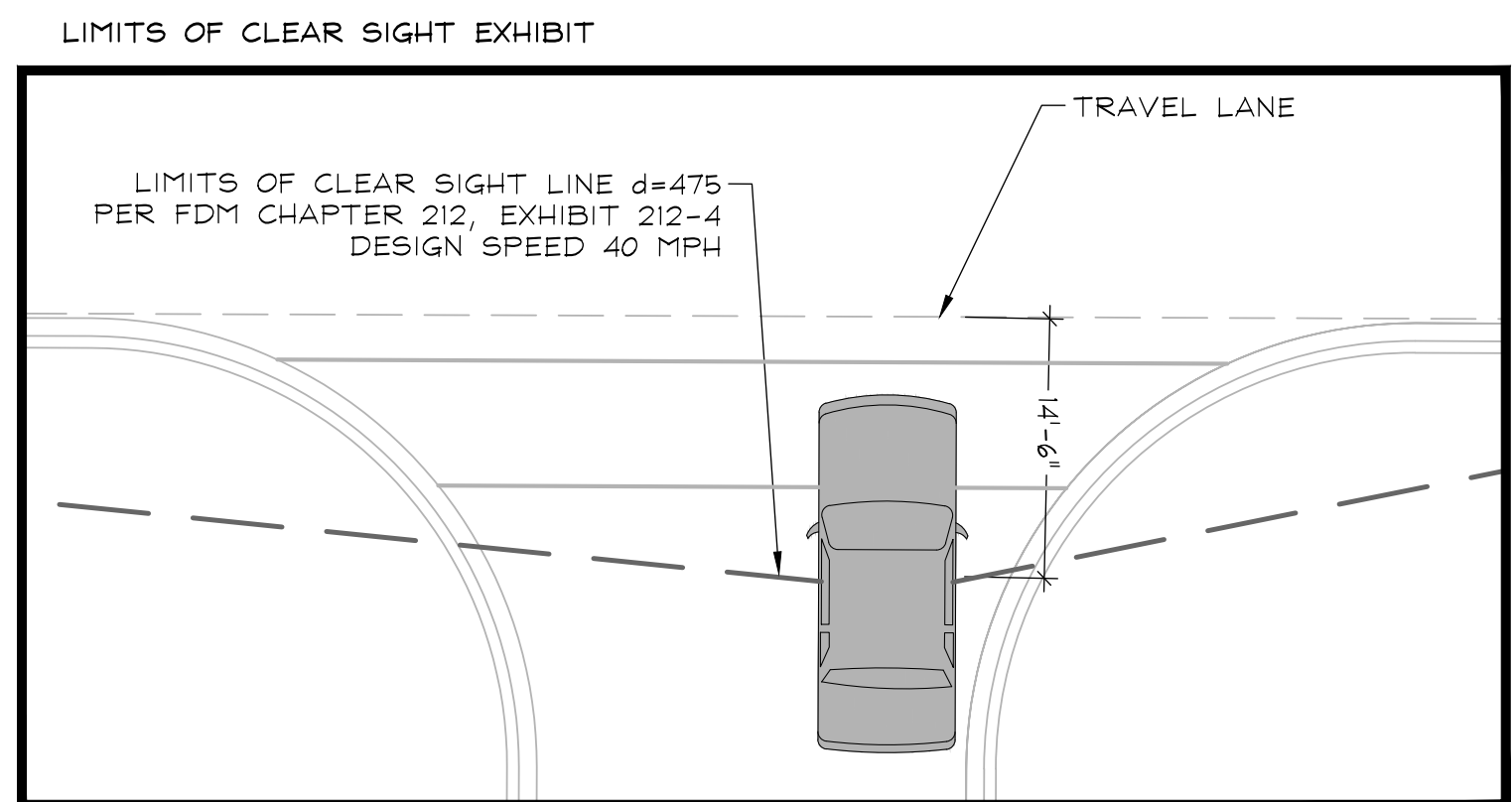
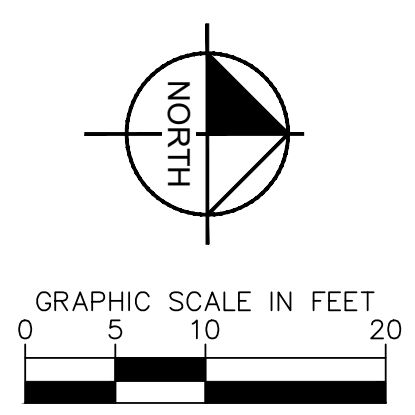

NOTE:  
ALL LIMITS OF CLEAR SIGHT ORIGIN AT 14.5' BEHIND THE TRAVEL LANE PER FDOT DESIGN MANUAL SEC. 212.11

NOTE: EXISTING SHRUB AND GROUND COVER PLANTINGS LOCATED WITHIN CLEAR SIGHT LIMIT INDICATED TO REMAIN SHALL BE TRIMMED 12" FROM BACK OF CURB AND MAINTAINED HEIGHT NOT TO EXCEED 10". ALL TREES AND PALMS TO BE MAINTAINED WITH 8' OF CLEAR TRUNK.

NOTE: THE FDOT REQUIRES A 14.5' VERTICAL CLEARANCE ABOVE ROADWAYS AND ALSO REQUIRES AN 8.5' VERTICAL CLEARANCE ABOVE WALKWAYS.

NOTE: SECTION 7-1.4. COMPLIANCE WITH FEDERAL ENDANGERED SPECIES ACT AND OTHER WILDLIFE REGULATIONS OF THE FDOT STANDARD SPECIFICATIONS FOR ROAD AND BRIDGE CONSTRUCTION MANUAL SHOULD BE ADHERED TO FOR WILDLIFE INVOLVEMENT DURING CONSTRUCTION.

**PLANT SCHEDULE**

TREES	COMMON NAME
LA	Muskogee Grape Myrtle 8' CT, Standard
LD	Natchez Grape Myrtle 8' CT, Standard
QV	High Rise Live Oak 8' CT
VA	Montgomery Palm Single Trunk, 10' GW MIN.

VERTICAL DATUM  
ELEVATIONS SHOWN HEREON ARE BASED ON THE NORTH AMERICAN VERTICAL DATUM OF 1988.  
NAVD '88 ELEV. + 1.565' = NGVD '29 ELEVATION

THE PRESENCE OF GROUNDWATER SHOULD BE ANTICIPATED. CONTRACTOR'S BID SHALL INCLUDE CONSIDERATION FOR ADDRESSING THIS ISSUE AND OBTAINING ALL NECESSARY PERMITS.

CALL 2 WORKING DAYS BEFORE YOU DIG

IT'S THE LAW!  
DIAL 811

SUNSHINE STATE ONE CALL OF FLORIDA, INC.

**Kimley-Horn**  
1920 WEKIVA WAY #200  
WEST PALM BEACH, FL 33411  
PHONE: 561-945-0665 FAX: 561-530-2245  
WWW.KIMLEY-HORN.COM  
REGISTRY 096  
© 2023 KIMLEY-HORN AND ASSOCIATES, INC.

REAL:  
JONATHAN D. HAIGH, PLA  
STATE LICENSE NUMBER  
LA #6666795  
06/30/2022

DRAWN BY: DATE: 07/01/2021  
DESIGNED BY: SCALE: AS SHOWN  
CHECKED BY:  
FIELD BOOK:

CITY OF FORT LAUDERDALE  
TRANSPORTATION & MOBILITY

290 NE 3RD AVE., FORT LAUDERDALE, FL 33301

REVISIONS		DESCRIPTION
NO.	DATE	BY (CHKD)

PROJECT # 12557  
NE 4TH AVENUE STREETSCAPE PROJECT  
E SUNRISE BLVD TO NE 13TH ST  
FORT LAUDERDALE, FL  
LANDSCAPE PLAN

SHEET NO.  
**L3.04**

Plotted By: Hargrett, Tom Sheet Set: NE 4th Avenue Layout: L2.05 LANDSCAPE PLAN June 29, 2022 09:12:50am K:\WPB\_LRG\_04\3184061 - NE 4th Ave FTL\CAD\PlanSheets\L3.00 LANDSCAPE PLAN.dwg

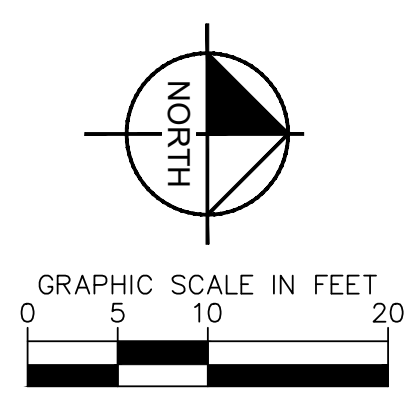
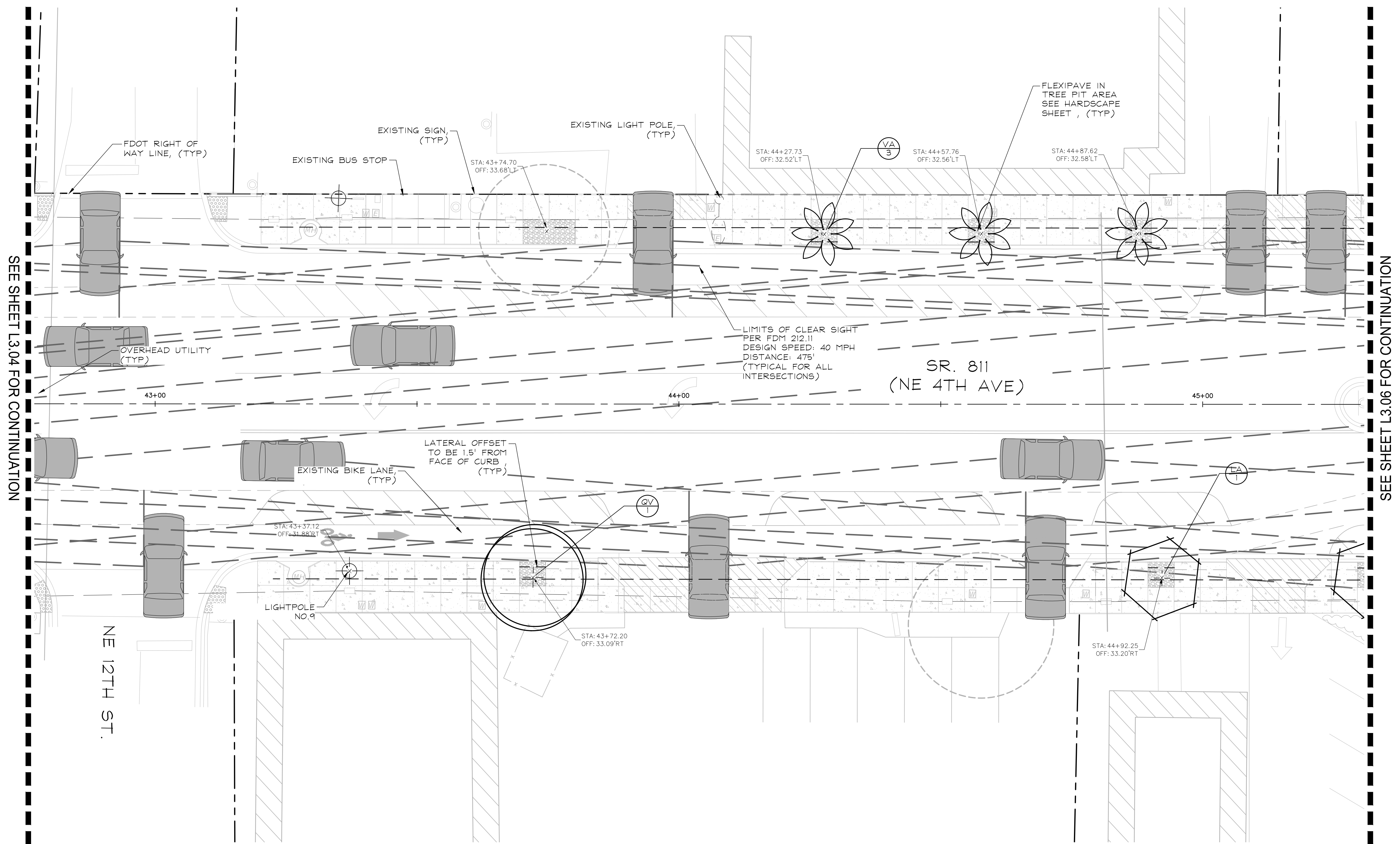

SEE SHEET L3.04 FOR CONTINUATION

SEE SHEET L3.06 FOR CONTINUATION

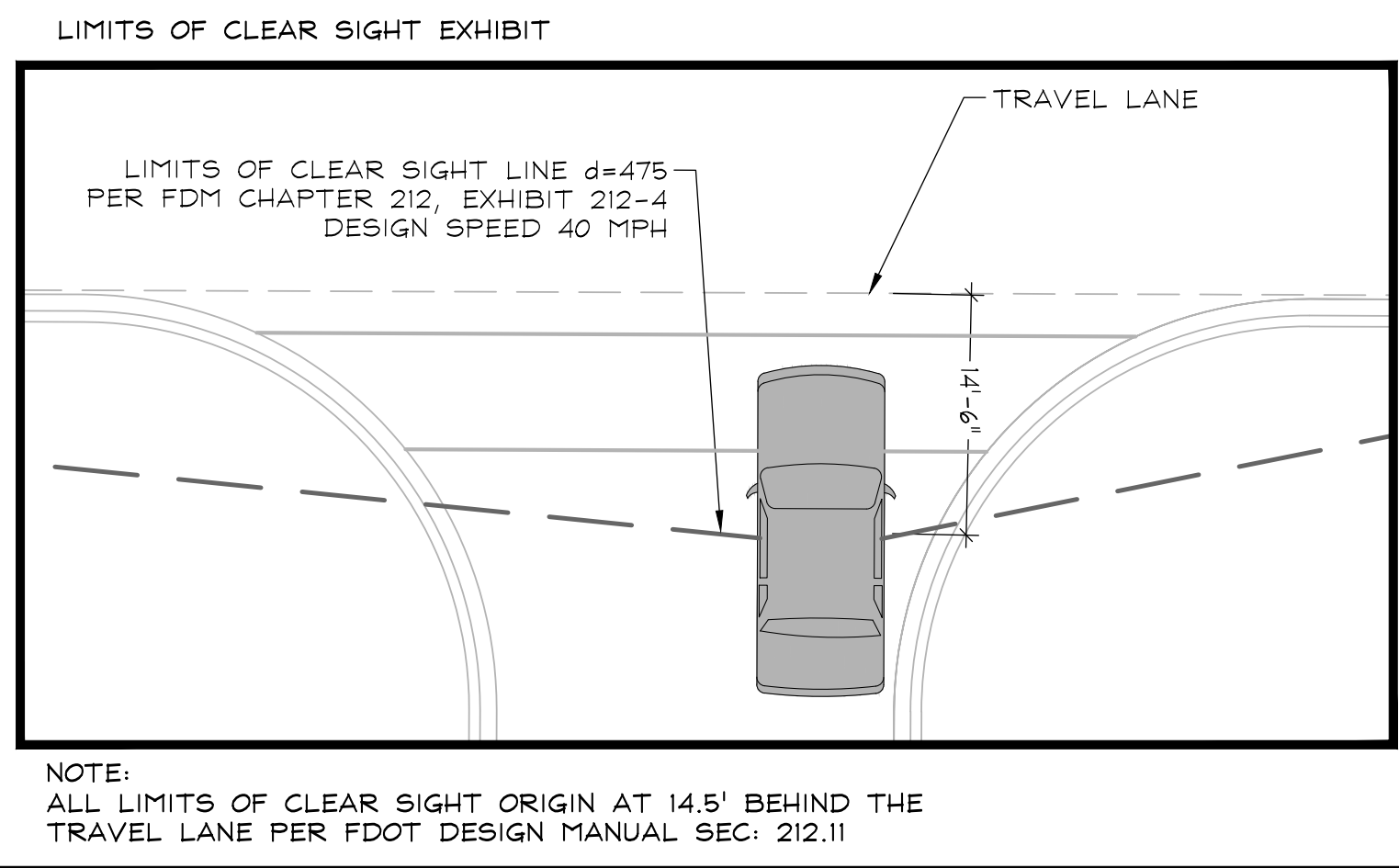

NOTE: EXISTING SHRUB AND GROUND COVER PLANTINGS LOCATED WITHIN CLEAR SIGHT LIMIT INDICATED TO REMAIN SHALL BE TRIMMED 12" FROM BACK OF CURB AND MAINTAINED HEIGHT NOT TO EXCEED 10". ALL TREES AND PALMS TO BE MAINTAINED WITH 8' OF CLEAR TRUNK.

NOTE: THE FDOT REQUIRES A 14.5' VERTICAL CLEARANCE ABOVE ROADWAYS AND ALSO REQUIRES AN 8.5' VERTICAL CLEARANCE ABOVE WALKWAYS.

NOTE: SECTION 7-1.4. COMPLIANCE WITH FEDERAL ENDANGERED SPECIES ACT AND OTHER WILDLIFE REGULATIONS OF THE FDOT STANDARD SPECIFICATIONS FOR ROAD AND BRIDGE CONSTRUCTION MANUAL SHOULD BE ADHERED TO FOR WILDLIFE INVOLVEMENT DURING CONSTRUCTION.

**PLANT SCHEDULE**

TREES	COMMON NAME
LA	Muskogee Grape Myrtle 8' CT, Standard
LD	Natchez Grape Myrtle 8' CT, Standard
QV	High Rise Live Oak 8' CT
VA	Montgomery Palm Single Trunk, 10' GW MIN.

VERTICAL DATUM  
ELEVATIONS SHOWN HEREON ARE BASED ON THE NORTH AMERICAN VERTICAL DATUM OF 1988.  
NAVD '88 ELEV. + 1.565' = NGVD '29 ELEVATION

THE PRESENCE OF GROUNDWATER SHOULD BE ANTICIPATED. CONTRACTOR'S BID SHALL INCLUDE CONSIDERATION FOR ADDRESSING THIS ISSUE AND OBTAINING ALL NECESSARY PERMITS.

CALL 2 WORKING DAYS BEFORE YOU DIG



IT'S THE LAW!  
DIAL 811

SUNSHINE STATE ONE CALL OF FLORIDA, INC.

**Kimley Horn**  
1920 WERVA WAY #200  
WEST PALM BEACH, FL 33411  
PHONE: 561-945-0665 FAX: 561-530-2245  
WWW.KIMLEY-HORN.COM  
REGISTRY 096  
© 2022 KIMLEY-HORN AND ASSOCIATES, INC.

REAL: JONATHAN D. HAIGH, PLA  
STATE LICENSE NUMBER LA #6666795  
06/30/2022

DRAWN BY: DATE: 07/01/2021  
DESIGNED BY: SCALE: AS SHOWN  
CHECKED BY: FIELD BOOK:

**CITY OF FORT LAUDERDALE**  
TRANSPORTATION & MOBILITY  
290 NE 3RD AVE., FORT LAUDERDALE, FL 33301

**REVISIONS**

NO.	DATE	BY	CHKD	DESCRIPTION

**PROJECT # 12557**  
NE 4TH AVENUE STREETSCAPE PROJECT  
E SUNRISE BLVD TO NE 13TH ST  
FORT LAUDERDALE, FL  
LANDSCAPE PLAN

SHEET NO. **L3.05**