



COMMERCIAL ROOFING INDUSTRIES

1864 NW 38th Avenue, #4 Fort Lauderdale, Florida 33311

Main office: (954)317-2500 www.CommercialRoofingIndustries.com

June 20, 2022

Owner: DELDS

Project: Reroof

Address: 2250 NW 21st Avenue
Fort Lauderdale, Florida 33311

Phone: (954) 579-9279

Attn: Alfreda Coward

We are pleased to submit for your consideration:

Scope of Work:

Remove existing roof
Install new roof system

Procedure of work:

A. Pre-Construction Phase

1. Provide owner with insurance certificate listing owner as additionally insured.
2. Provide owner with construction schedule.
3. Provide Product Approval NOA for the proposed system.
4. Obtain all necessary permits, drainage calculations and engineered design wind pressure calculations for the project.
5. Schedule and facilitate a pre-construction meeting with the owner's representative and the CRI team.
6. Design and implement an OSHA approved safety plan.

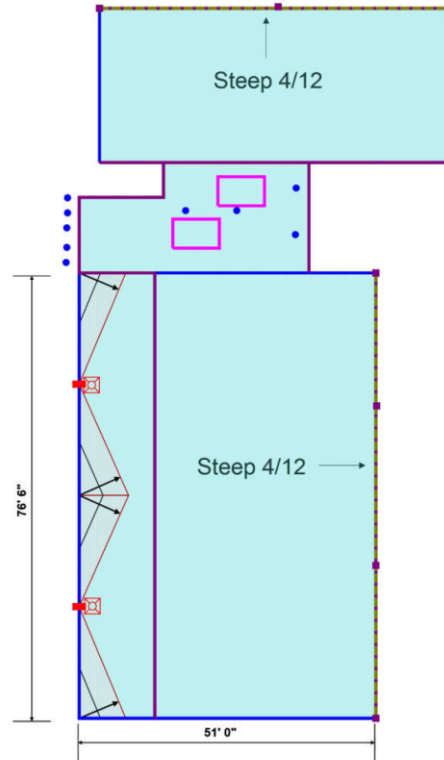

B. Preparatory Work:

1. Cut and remove all existing roofing down to the tectum deck. Remove only as much roofing as can be replaced in each day. At the end of each day the completed areas will be sealed to the existing roof to maintain watertight integrity.
2. Replace rotten tectum / lumber associated with roof.
3. Any replacement of the tectum deck will be at the cost of \$14.00 / sf, fascia and framing \$9.00 / lf. X _____
4. Broom clean the entire roof surface to remove all dust, dirt, and debris. Thoroughly clean with a power air blower.

C. Flat Roof Installation:

1. Install one (1) layer of Type 43 CertainTeed All Weather/Empire Base Sheet with Twin-Lok base sheet fasteners.
2. Install tapered insulation crickets on SE section to promote positive drainage with hot type IV asphalt.
3. Install ½" high density wood fiber insulation to crickets with hot type IV asphalt.
4. Install two (2) layers of type IV fiberglass felt with hot type IV asphalt.
5. Install one (1) layer of class A FR granulated cap sheet with hot type IV asphalt.
6. Apply loose granules at all hot asphalt overruns side and end laps.

D. Miscellaneous Roof Installation:

1. Install new lead flashings on all plumbing vents.
2. Install 26-gauge galvanized 4" x 5" base flashing metal where necessary.
3. Remove and replace 26-gauge galvanized goose-neck vents.
4. Install new wood bucks on parapet wall tops to facilitate new coping installation.
5. Install new 24g continuous cleat at all wall tops to receive new coping.
6. Install new 26g coping to parapet wall tops attached with #12 fasteners with neoprene washers.

7. Install new 26g cover plates at all coping joints.
8. For additional ultraviolet protection, install loose granules on all seams of the granular surfaced fiberglass cap sheet.
9. Install new 7" seamless gutters and downspouts at eaves of steep roof sections.

E. Exclusions

1. Mechanical, electrical and plumbing work.
2. Paint and stucco.
3. Interior protection and repairs.

F. Warranties

Manufacturer to provide Twenty (20) Year System Warranty.

Commercial Roofing Industries to provide a Seven (7) Year Workmanship Warranty.

G. Quotation

Investment for new roof system: **\$99,971.00**

Ninety-nine thousand, nine hundred and seventy-one dollars

H. Terms

- 20% deposit for permitting
- 40% due day of start
- 30% due day of half completion
- 10% due day of completion

Acceptance: _____
Authorized Signature

Print Name

Date

Sincerely,
Kelly O'Brien
Commercial Roofing Industries
(954)268-5863