

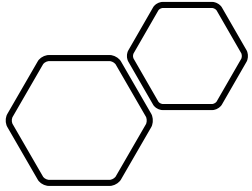

Art + Design = >Shade x Economic Activity in cool Streets



A Creative Solution for a more walkable downtown...

EXISTING



AFTER: Andrews Avenue at City Hall looking northwest



AFTER: Andrews Avenue looking towards Broward County Government Center

Andrews Avenue may be temporarily closed to use for farmer markets, night markets and festivals. Jasmine Lot, the surface parking lot across from City Hall, is proposed to receive a shade structure and also be used for community events. In addition to street events, 'parklets' may occupy street-parking to encourage active streets. Examples are:



URBAN STREET SHADE 2018 Fort Lauderdale Design and Ideas Competition
STITCH

Shade

as part of Transport and Temperature Reduction



Los Angeles

Examples/history applicable to South Florida

“You can’t install a shade here without disrupting underground utilities, violating the ADA, or blocking driveway sightlines. Shade is basically outlawed,” cites a local business owner trying to implement inexpensive shade options.





“Shade was integral to the urban design of southern California until the advent of cheap electricity in the 1930s.”

Pershing Park 1930, 1951 under construction and today.



Pershing Park reimagined in |
2019...

Leaders want to reduce heat and uncomfortable walking in urban areas recognizing the challenge of successfully providing tree shade canopy in these older neighborhoods.





Much of the city's bus stops in urban areas were not covered at all, even those most used at or near major transit nodes.



LANI, in partnership with the CRA/LA transformed vacant lots surrounding commercial businesses and created innovative **Transit Art Parks**

Los Angeles Neighborhood Initiative



Coastal Northern Australia



Cavenagh Street
Shade Structure

Cavenagh Street
Shade Structure





Shade as Art
temporary and permanent



Spain's Metropol Parasol

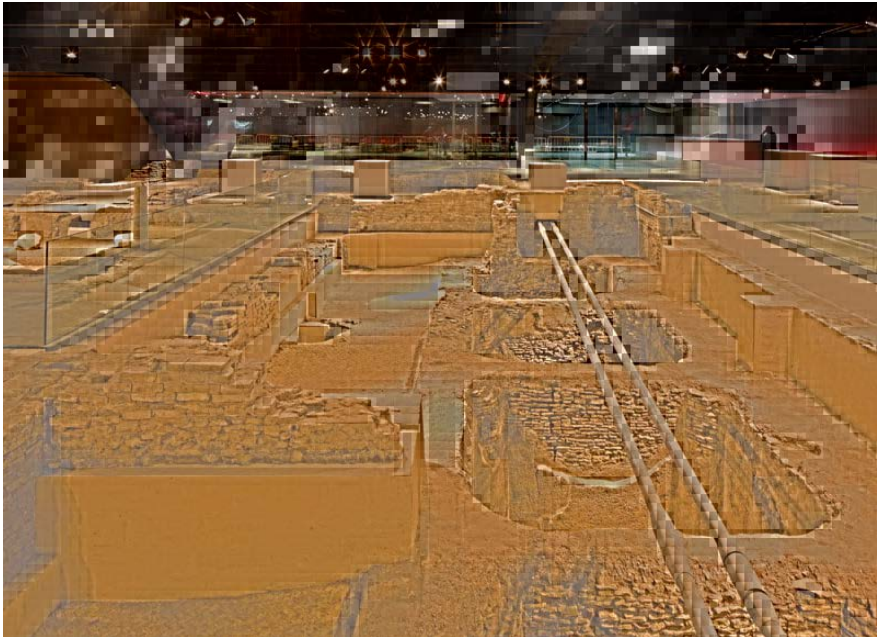

Concerts, museum and
outdoor dining areas

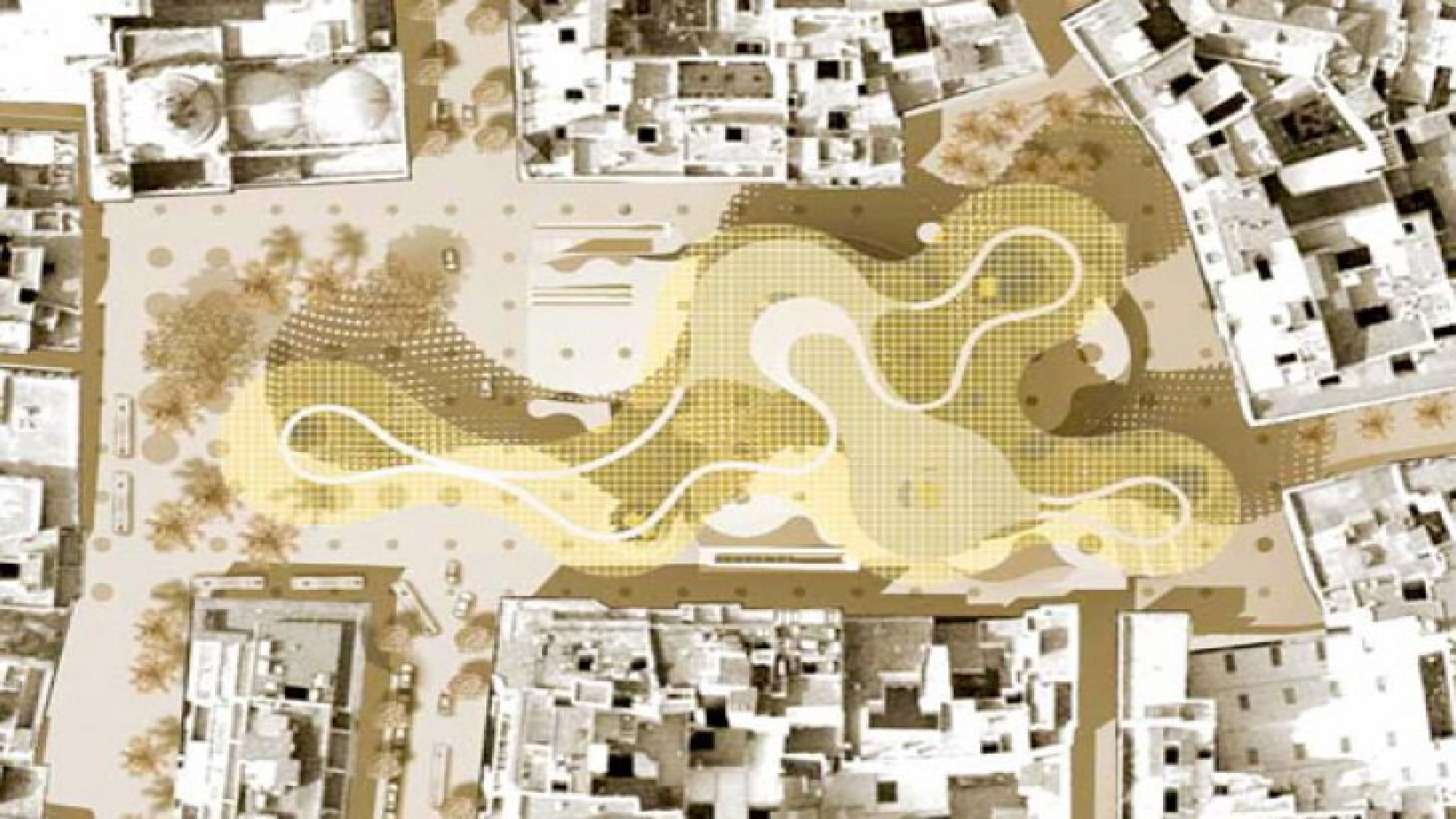

In our own
backyard, Coral
Gables 2018



Umbrella Sky





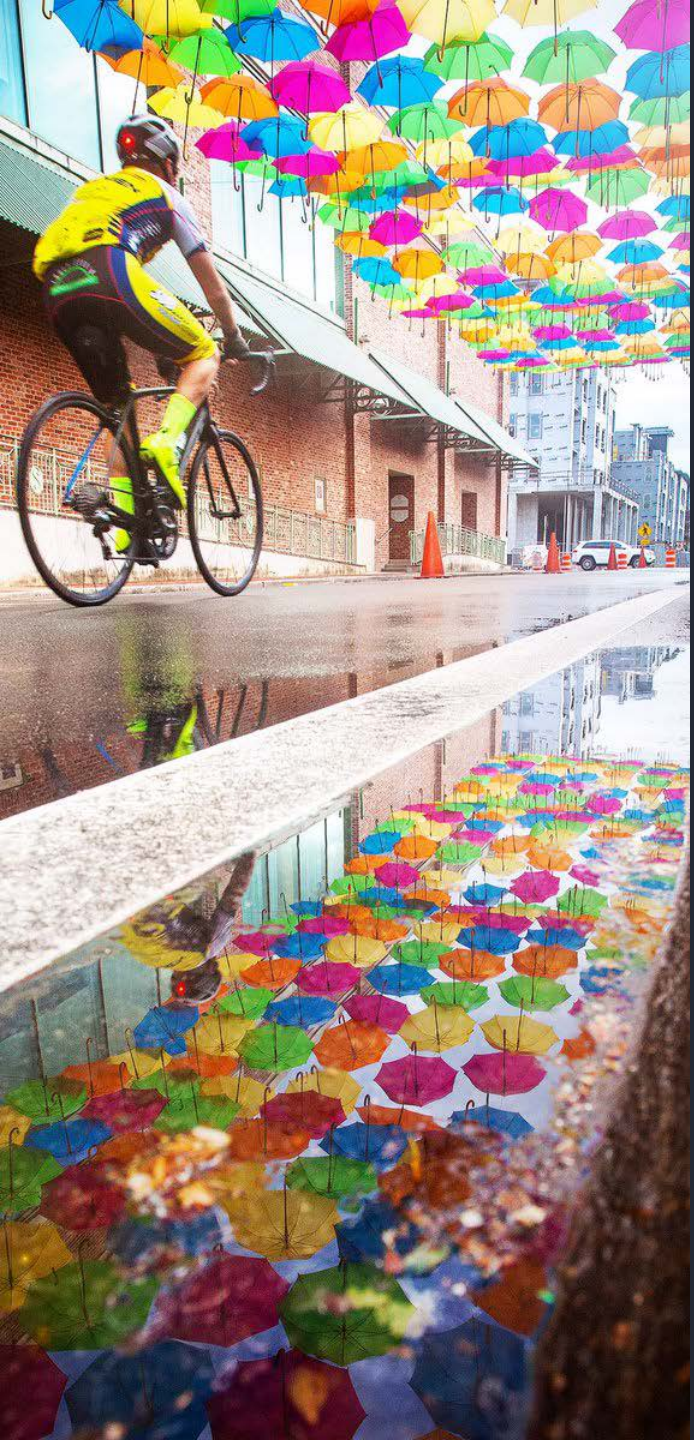

Pensacola US was
over a functioning
city street



Shade with Art



COAT FTL 2017-19



“A great street should be a desirable place to be, to spend time, to live, to play, to work, at the same time, it markedly contributes to what a neighborhood can be. This approach to thinking about public space transcends our thoughts about what it means to gather in what previously was a place to pass through.”

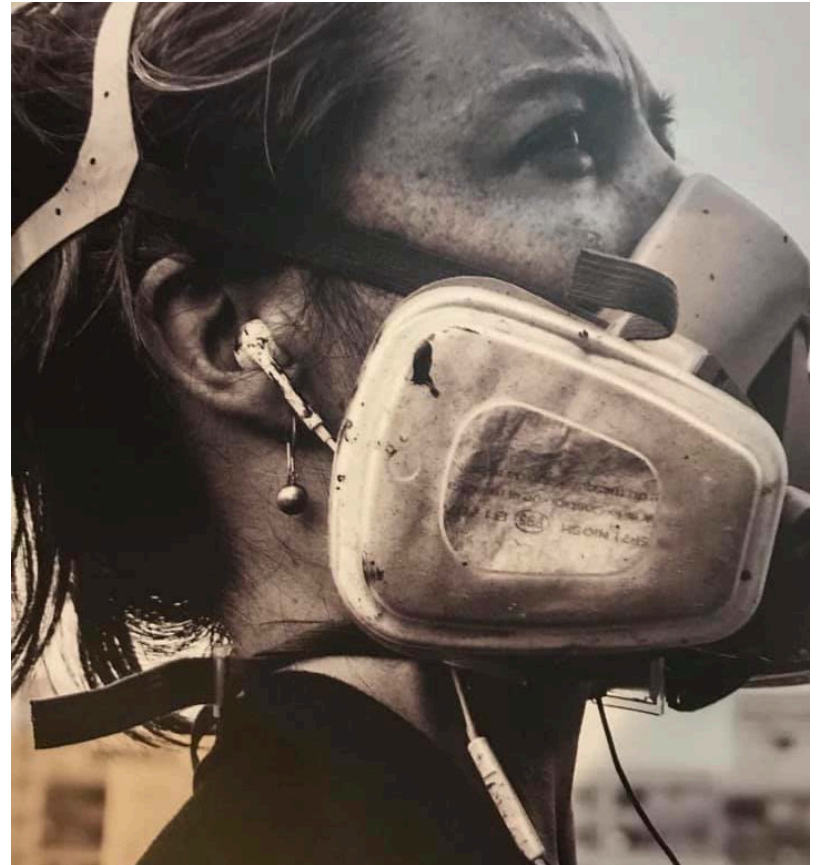

Installing murals along NE 2 Avenue between 8 and 7 Streets along Brightline sparked an idea...



AFTER: Andrews Avenue at City Hall looking northwest



AFTER: Andrews Avenue looking towards Broward County Government Center

Andrews Avenue may be temporarily closed to use for farmer markets, night markets and festivals. Jasmine Lot, the surface parking lot across from City Hall, is proposed to receive a shade structure and also be used for community events. In addition to street events, 'parklets' may occupy street-parking to encourage active streets. Examples are:



The competition site includes two super blocks which encompass the City's government, cultural and transit buildings. These buildings contribute to a rich and multi-dimension downtown experience.

The addition of a street shade system as proposed in this competition not only provides shade relief to users but also introduces an organizing framework to civic space and an opportunity to connect this space to the broader physical environment.

This design proposal is inspired by Fort Lauderdale's urban and natural context. The proposed shade structure system along existing sidewalks and streets **STITCHES** dispersed downtown uses for a more vibrant urban experience that activates the street and offers alternate means of transportation to promote well-being for all.

Walking Area of downtown Fort Lauderdale:

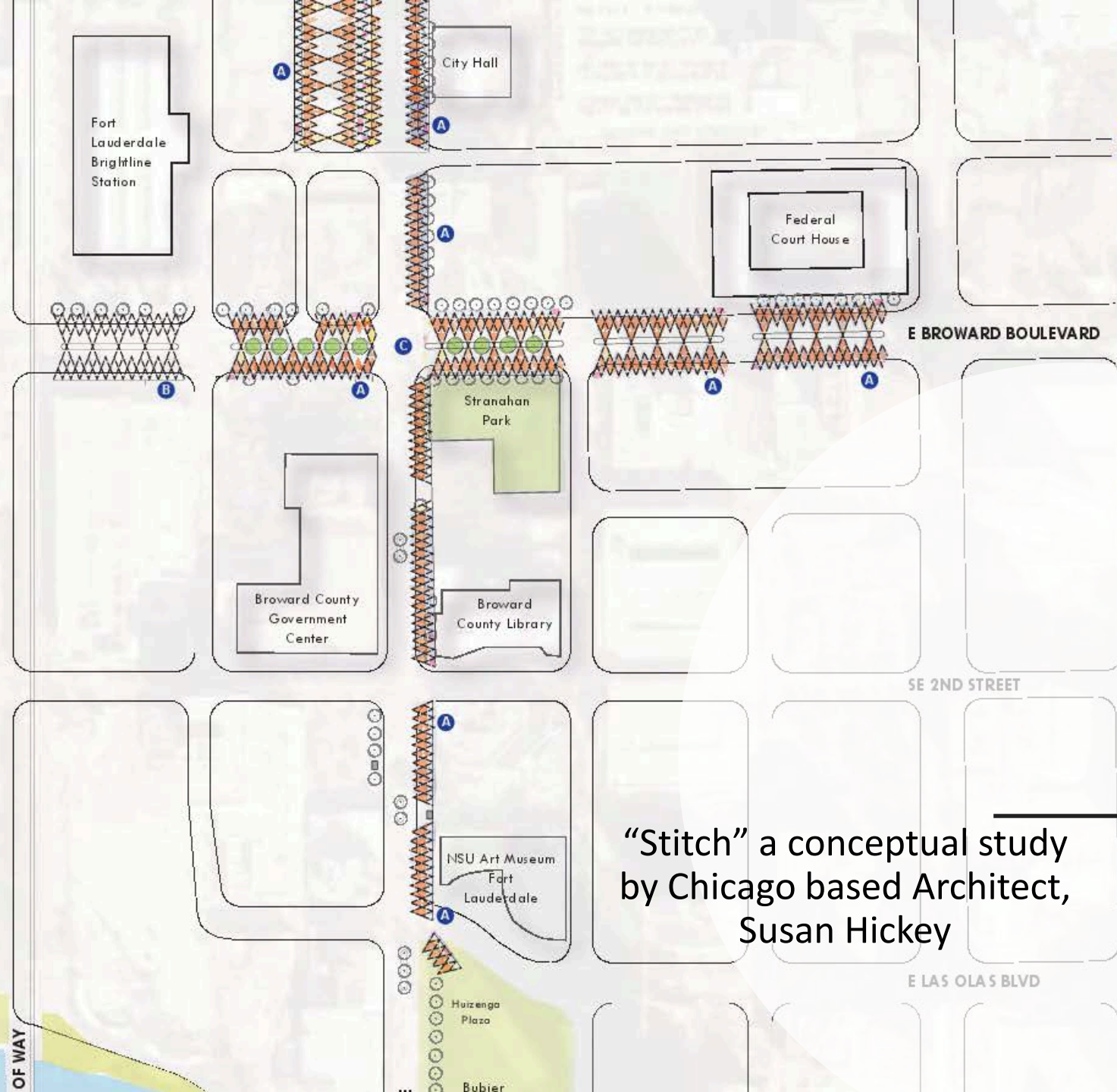

- Proposed Tree
- Existing Bus Shelter
- Existing Road Lightpole
- Proposed Shade Structure
- Proposed Overhead LED String Lights, adjacent to train crossing to allow for unobstructed views of signals (in lieu of shade structure). String lights to be solar powered. Examples include:



- Decorative Pedestrian Crosswalk. Examples include:



“Stitch” a conceptual study by Chicago based Architect, Susan Hickey



AFTER: E Broward Blvd looking east

2 of 4



AFTER: W Broward Blvd walking from transit station at SW 1st Avenue, looking east

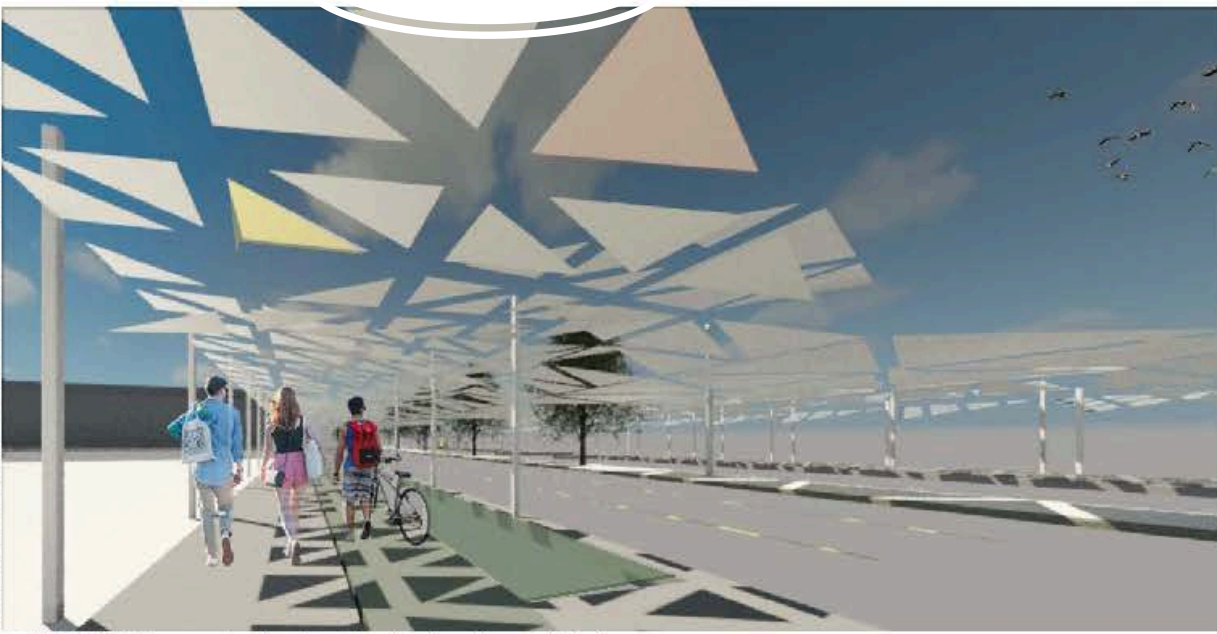

AFTER: Walking west under street shade along Broward Blvd



AFTER: Walking east under street shade along Broward Blvd



AFTER: Andrews Avenue at City Hall looking northwest



AFTER: Andrews Avenue looking towards Broward County Government Center

Andrews Avenue may be temporarily closed to use for farmer markets, night markets and festivals. Jasmine Lot, the surface parking lot across from City Hall, is proposed to receive a shade structure and also be used for community events. In addition to street events, 'parklets' may occupy street-parking to encourage active streets. Examples are:



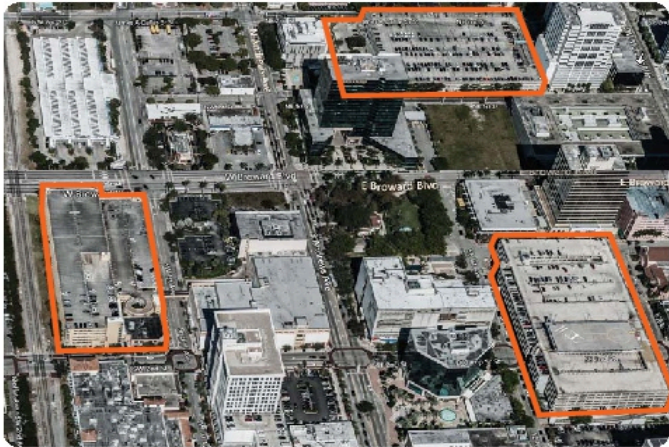

LOCATION OF PARKING FACILITIES in Competition Area

examples of alternate uses for parking garage

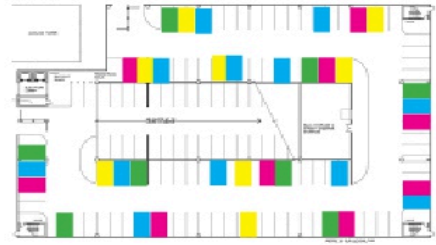

To provide shelter for the City's homeless, unused portions of public parking structures may be used by allocating accessible area for this use, parking structures provide shade and partial protection from the elements. The allocated area may be separated from public access. A parking space is approximately 162 square feet, which may be converted to a comfortable sleeping area. There are several parking spaces in the Competition area.

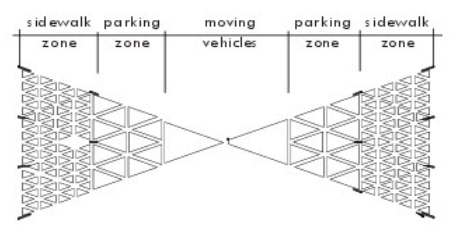

PLAN / ISOMETRIC VIEW Segment of Urban Shade Structure

Fabric structure is angled to address sun angles for maximum shade

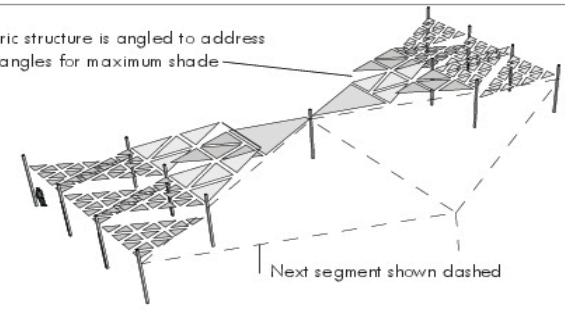

MATERIALITY

Shade Structure

- Steel Columns, 12-ft tall with high-performance paint and concrete foundation system (roughly 88% recycled content per SRI)
- Stainless-steel structural cable system (100% recyclable per SSINA)
- Sail cloth, recycled, multi-color, cut to size
- Solar-powered LED string lighting attached to cable system

COST ESTIMATE

This design is roughly estimated at \$150 per square foot.



STREET SECTION E Broward Blvd at Andrews Avenue looking west

Panel #4

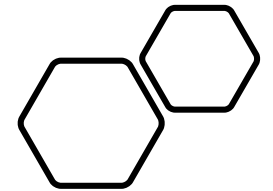

Where there is an active alleyway, install murals and design urban shade that maximizes safe pedestrian and auto flow on the main local street with a focus on more gathering spaces outdoors for residents and visitors and supports burgeoning businesses.

A dark, irregular, ink-like splash shape on a white background. The splash is roughly circular but has jagged, organic edges. It is filled with a dark, almost black color, and there are some lighter, greyish-blue spots and streaks around its perimeter, suggesting a liquid spill or a paint splatter. The text is centered within this dark shape.

Create an urban design program
addressing the growing unhoused
populations in parks and streets





Perhaps the best way to think about parks for unhoused users is as a conduit for service delivery...



BUILDING A BRIDGE FOR L.A.'S Unhoused



Top left (middle) Gensler Park

Bottom new proposed Lafayette Park



Next steps...



Identify fabricators of
excellence and innovation

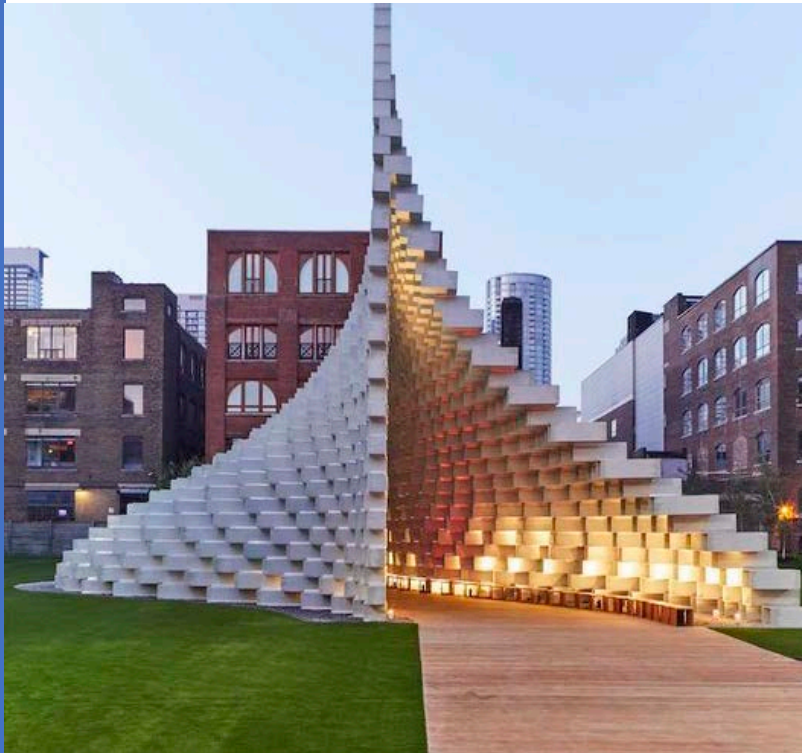

Identify Grants and Local Developers



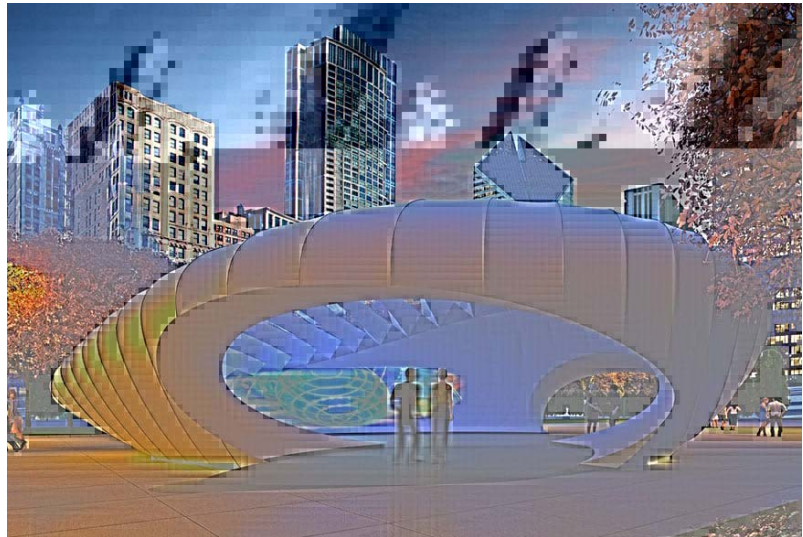
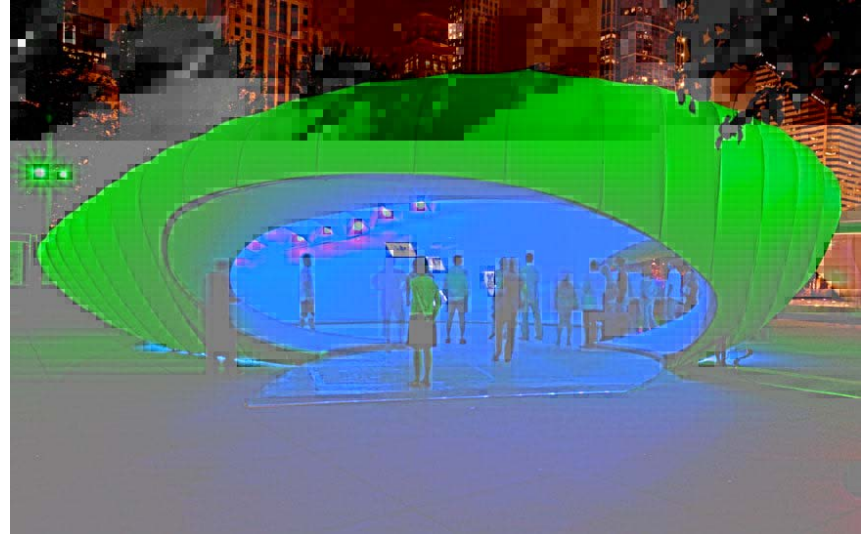



Art + Design = >Shade x Economic Activity in cool Streets