

CITY OF FORT LAUDERDALE
RFQ#936-11270
ARCHITECTURAL CONSULTING SERVICES
(CCNA – CONSULTANT’S COMPETITIVE NEGOTIATION ACT)



Walters • Zackria Associates
Architecture • Engineering • Planning
620 SE 1st Street, Ft. Lauderdale, FL 33301
954-522-4123 Fax: 954-522-4128
Contact Person: Robert S. Walters, AIA

32

THIRTY-TWO
YEARS

OF DESIGN

EXCELLENCE

DUE DATE/TIME:
FEBRUARY 27, 2014
2:00 P.M.

TABLE OF CONTENTS

1



CITY OF FORT LAUDERDALE

RFQ# 936-11270

AN ANNUAL CONTRACT

FOR

ARCHITECTURAL CONSULTING SERVICES

(CCNA – CONSULTANTS’ COMPETITIVE NEGOTIATION ACT)

TABLE OF CONTENTS

SECTION 1	TABLE OF CONTENTS	1
SECTION 2	PROPOSAL LETTER/ LETTER OF INTEREST/ PROPOSAL SIGNATURE FORM	3
SECTION 3	QUALIFICATIONS OF THE FIRM	9
SECTION 4	QUALIFICATIONS OF THE PROJECT TEAM	41
SECTION 5	PROJECTS MANAGER’S EXPERIENCE	59
SECTION 6	APPROACH TO SCOPE OF WORK	74
SECTION 7	REFERENCES	88
SECTION 8	MINORITY / WOMEN (M/MBE) PARTICIPATION	93
SECTION 9	LOCAL BUSINESS PREFERENCE (LBP)	107
SECTION 10	SAMPLE INSURANCE CERTIFICATE	111
SECTION 11	JOINT VENTURES	115
SECTION 12	SUBCONSULTANTS	117
SECTION 13	NON-COLLUSION STATEMENT	120

**LETTER OF INTEREST
&
PROPOSAL SIGNATURE
FORM**

2

February 13, 2014

Fort Lauderdale City Hall
Procurement Services Division
100 N. Andrews Avenue, #619
Ft. Lauderdale, FL 33301

RFQ No. 936-11270 – An Annual Contract for Architectural Consulting Services

Dear Selection Committee:

CITY OF FT. LAUDERDALE needs an experienced A/E team that specializes in **ARCHITECTURE & ENGINEERING** for Municipal Clients. **WALTERS • ZACKRIA ASSOCIATES, WZA** is the answer to your various project needs. **WZA’s 32 YEARS OF SERVING SOUTH FLORIDA** municipalities lends it the vast experience and understanding of scope of work under this RFQ. **WZA** will be an extension of your staff. We understand the scope and the prowess for successful completion. “**KNOWLEDGE AND PRECISION, THE ULTIMATE CONFIDENCE BOOSTERS**”.

WALTERS • ZACKRIA ASSOCIATES PORTFOLIO INCLUDES EXTENSIVE MUNICIPAL FACILITY PLANNING AND DESIGN and ENGINEERING EXPERIENCE. You will benefit from the experience gained through similar multi-project contracts with the following government clients:

- Broward County
- City of Dania
- City of Coconut Creek
- City of Lauderhill
- City of North Lauderdale
- Town of Hillsboro Beach
- City of Coral Springs
- City of Pompano Beach
- City of Boca Raton
- City of Margate
- City of Sunrise
- City of Hallandale Beach
- City of Miramar
- City of Oakland Park
- City of Ft. Lauderdale



Long Key Nature Center



Pompano Beach Community Park



Coconut Creek New Public Works Building

WZA HAS SUCCESSFULLY COMPLETED OVER 400 SOUTH FLORIDA GOVERNMENT PROJECTS! No other firm has a track record of delivering completed projects on time with minimal change orders in this local public bid arena. The quality control of our construction documents and specifications is superior. We do not design buildings for our ego, we design attractive functional buildings that meet the owner’s budgets, functional and long term maintenance requirements and blend in with their surroundings. Your staff and City residents will be proud of our project delivery.

ARCHITECTURAL FIRM WITH LONGEST SAME OWNERSHIP IN CITY OF FT. LAUDERDALE 32 YEARS !

Please turn the page for WZA’s answers to your concerns and needs.....

CITY OF FT. LAUDERDALE EXPERIENCE & KNOWLEDGE

As a lifelong Ft. Lauderdale native, Robert Walters AIA knows the City’s past, present and future. Mr. Walters has been involved with the City facilities since a teenager as his father worked with the Ft. Lauderdale Utilities Department. Robert Walters has served on several City Advisory Boards including most recently the Sustainability Board.

The firm has provided Architecture/Engineering Services for over 4 decades.

City of Ft. Lauderdale Projects

- **Bryan House Building System Analysis** - 2013
- **Architect on Holiday Park Renovation** - 2004
- **Riverside Park Community Center** - 2003
- **Lauderdale Manors Community Center** - 2002
- **South Beach Restrooms** - 2002
- **Hall of Fame Pool Masterplan + Renovation** - 2001
- **Holiday Park** - 2000
- **Cancer Survivor Park – D.C. Alexander** - 2001
- **Warfield Park Community Center** - 2001
- **Croissant Park Community Center** - 2001
- **George English Park Renovations / Additions** - 1990
- **Lockhart Stadium Renovations** - 1979



Holiday Park



Riverside Park



George English Park



Holiday Park



Warfield Park



Lauderdale Manors Pool Park

WALTERS • ZACKRIA ASSOCIATES Park & Recreation experience is leaps and bounds ahead of any local firm. Since 1996, **WALTERS • ZACKRIA ASSOCIATES** has served **BROWARD COUNTY** directly on over 100 recreational projects!

- 35+ DESIGN BUILD PROJECTS
- 35+ PARK & RECREATION MULTI-TERM
- 30+ DISTRICT VI – OWNER’S REPRESENTATIVE
- DISTRICT II DESIGN BUILD
- LONG KEY NATURE CENTER



*Anne Kolb Nature Center
Reroof*



*Roosevelt Gardens
Community Center*



Quiet Waters Park Activity Pool

BUILDING RENOVATION

WZA has renovated over 250 buildings in Broward County. Recent renovation and wind hardening projects include:

- Broward County Sheriff’s Headquarters
- Coconut Creek Public Safety
- Coconut Creek Public Works Admin.
- Coconut Creek Public Works Fleet Bldg
- TCRA – Pompano Beach Station
- Lauderhill City Hall
- Broward Community College
- Oakland Park – 10 Building Renov./Additions
- Hollywood – 8 Building Renov./Additions
- Coral Springs Public Safety

LEED EXPERIENCE

Our staff includes **LEED** certified architects. **WZA** will implement **LEED** design components, building systems and design into your new facility. We have been working together for over two decades and have successfully achieved LEED status and energy efficiency savings for a myriad host of projects.



Broward County Aviation



Coconut Creek Public Works



*Broward Sheriff’s Office
Public Safety Building
Renovation/Hardening*

ROOFING/BUILDING ENVELOPE SPECIALIST

It is our policy to protect our client's investment. We make inspections of existing roofs to determine the feasibility of repair versus replacement. Our experience and unbiased viewpoint produce solutions to roof problems that are less costly and more efficient.

The roofing industry has been experiencing a period of tremendous change with the influx of new roofing materials, and code changes made after Hurricane Andrew. Our hands-on experience with roofing, and waterproofing systems application, and the knowledge gained from the investigation of roofing, and waterproofing system failure enables us to provide you the most up-to-date information.

Rooftop equipment will be reviewed for code compliance. New stands and attachments will be provided.

CITY OF FT. LAUDERDALE APPROVALS

WZA is familiar with FT. LAUDERDALE's approval process and your staff. Our past experience will enable us to proceed with these approvals in an effective manner.

The firm of WALTERS • ZACKRIA ASSOCIATES will coordinate all of the necessary approvals, ordinances, consulting engineering firms, space planning and interior design services. It is our goal to make the building process as simple as possible to the user so that your daily business obligations are not disturbed. The project schedules and budgets are set up in the initial schematic design phase and adhered to throughout the project. We will help establish a streamline project management system with one project representative.

WZA possesses **BIM** project support experience and project status reporting

LOCATION

Located in DOWNTOWN FT. LAUDERDALE, our office is 3 minutes away. WZA has previously worked on over a dozen City projects and are very familiar with the City of Ft. Lauderdale.

M/WBE PARTICIPATION

WZA is a certified CBE with Broward County Office of Economic and Small Business Development. **WZA will provide over 30% M/WBE participation.** Our Civil Engineering Sub-consultant, **Abaco Engineering, is an M/WBE certified company.**

TIME AND BUDGET

Utilizing consulting cost estimation firms throughout the design phase and incorporating add/deduct alternates; you will receive a project on budget and on time! The firm's 2012 and 2013 projects were bid within 2% of construction budgets. Our quality controlled construction documents system minimizes change orders.

LIABILITY INSURANCE

The firm maintains a professional errors and omissions liability policy of \$2,000,000.00. The firm has no outstanding claims. After selection, certifications will be provided.

Yes the **WALTERS • ZACKRIA ASSOCIATES** Team will provide these credentials and more!
Located in downtown Ft. Lauderdale

AVAILABILITY, FAMILIARITY, AND RESPONSIBITLITY WILL BE COMBINED IN ONE PACKAGE...**THE WALTERS • ZACKRIA ASSOCIATES TEAM.**

Very truly yours,



Robert S. Walters, A.I.A.
Vice President

PROPOSAL SIGNATURE PAGE

How to submit proposals: Proposals must be submitted by hard copy only. It will be the sole responsibility of the Proposer to ensure that the proposal reaches the City of Fort Lauderdale, City Hall, Procurement Services Division, Suite 619, 100 N. Andrews Avenue, Fort Lauderdale, FL 33301, prior to the proposal due date and time listed. Proposals submitted by fax or email will not be accepted.

The below signed individual hereby agrees to furnish services subject to all instructions, terms, conditions, specifications, and addenda contained in the Request For Qualifications (RFQ). I have read the RFQ and all attachments including the specifications and fully understand what is required. By submitting this signed Proposal I understand any resulting City contract will be subject to RFQ instructions, terms, conditions, specifications, and addenda.

Submitted by: _____ (Signature) _____ (Date) *2-24-14*

Name (Printed) ROBERT S. WALTERS Title: VICE PRESIDENT

Company: (Legal Registration) WALTERS ZACKRIA ASSOCIATES, PLLC

FOREIGN CORPORATIONS MAY BE REQUIRED TO OBTAIN A CERTIFICATE OF AUTHORITY FROM THE DEPARTMENT OF STATE, IN ACCORDANCE WITH FLORIDA STATUTE §607.1501 (visit <http://www.dos.state.fl.us/>).

Address: 620 SE 1ST STREET

City FT. LAUDERDALE State: FLORIDA Zip 33301

Telephone No. 954-522-4123 FAX No. 954-522-4128 Email: ADMIN@WZA-ARCHITECTS.COM

Does your firm qualify for MBE or WBE status (General Conditions Section 1.09)? MBE WBE

ADDENDUM ACKNOWLEDGEMENT - Proposer acknowledges that the following addenda have been received and are included in its proposal:

Addendum No. Date Issued

Payment by P-CARD: Will your firm accept the City's Credit Card as payment for services performed under a resulting contract?

YES NO

QUALIFICATIONS OF THE FIRM

3

ARCHITECT – ENGINEER QUALIFICATIONS

PART I – CONTRACT SPECIFIC QUALIFICATIONS

A. CONTRACT INFORMATION

1. TITLE AND LOCATION *(City and State)*

City of Fort Lauderdale – An Annual Contract for Architectural Consultant Services
(CCNA – Consultants’ Competitive Negotiation Act)

2. PUBLIC NOTICE DATE

3. SOLICITATION OR PROJECT NUMBER

RFQ NO. 936-11270

B. ARCHITECT – ENGINEER POINT OF CONTACT

4. NAME AND TITLE

Abbas H. Zackria/ President

5. NAME OF FIRM

Walters Zackria Associates, PLLC

6. TELEPHONE NUMBER

954-522-4123

7. FAX NUMBER

954-522-4128

8. E-MAIL ADDRESS

admin@wza-architects.com

C. PROPOSED TEAM

(Complete this section for the prime contractor and all key subcontractors.)

	<i>(Check)</i>			9. FIRM NAME	10. ADDRESS	11. ROLE IN THIS CONTRACT
	PRIME	J-V PARTNER	SUBCONTRACTOR			
a.	x			Walters Zackria Associates, PLLC <input type="checkbox"/> CHECK IF BRANCH OFFICE	620 SE 1 st Street Fort Lauderdale, FL 33301	Architectural Services and Structural Engineering CBE, MBE
b.			x	Delta G. Consulting Engineers, Inc. <input type="checkbox"/> CHECK IF BRANCH OFFICE	707 N.E. 3 rd Avenue Ft. Lauderdale, FL 33304	Mechanical, Electrical, Plumbing and Fire Protection Engineering CBE, DBE
c.			x	Abaco Engineering, Inc. <input checked="" type="checkbox"/> CHECK IF BRANCH OFFICE	5997 NW 73 rd Ct. Parkland, FL 33067	Civil Engineering MBE,CBE,DBE
d.			x	TBG Partners <input checked="" type="checkbox"/> CHECK IF BRANCH OFFICE	200 Sw First Ave., Suite 103 Ft. Lauderdale, FL 33301	Landscape
e.			x	Nutting Engineers of Florida, Inc. <input type="checkbox"/> CHECK IF BRANCH OFFICE	1310 Neptune Drive Boynton Beach, FL 33426	Geotechnical Engineering SBE
f.			x	AWN Design & Consulting Group, Inc. <input type="checkbox"/> CHECK IF BRANCH OFFICE	227 Goolsby Boulevard Deerfield Beach, FL 33442	Surveyor Engineering CBE
g.				 <input type="checkbox"/> CHECK IF BRANCH OFFICE		

D. ORGANIZATIONAL CHART OF PROPOSED TEAM

(Attached)

E. RESUMES OF KEY PERSONNEL PROPOSED FOR THIS CONTRACT

(Complete one Section E for each key person.)

12. NAME Robert S. Walters, AIA	13. ROLE IN THIS CONTRACT Principal	14. YEARS EXPERIENCE	
		a. TOTAL 32	b. WITH CURRENT FIRM 32
15. FIRM NAME AND LOCATION <i>(City and State)</i> Walters Zackria Associates, PLLC, Fort Lauderdale, Florida			
16. EDUCATION <i>(DEGREE AND SPECIALIZATION)</i> Master of Architecture Bachelor of Science, Architecture Urban School of Design (Genoa, Italy)		17. CURRENT PROFESSIONAL REGISTRATION <i>(STATE AND DISCIPLINE)</i> Florida, Registered Architect Florida, Certified General Contractor	
18. OTHER PROFESSIONAL QUALIFICATIONS <i>(Publications, Organizations, Training, Awards, etc.)</i> Certified CPTED training			

19. RELEVANT PROJECTS

	(1) TITLE AND LOCATION <i>(City and State)</i>	(2) YEAR COMPLETED	
		PROFESSIONAL SERVICES	CONSTRUCTION <i>(If Applicable)</i>
a.	New City Hall and Police Station Wilton Manors, Florida	2008	2009
	(3) BRIEF DESCRIPTION <i>(Brief scope, size, cost, etc.)</i> AND SPECIFIC ROLE 33,500 S.F. – Two (2) story Joint use facility with Commission Chambers, City Manager’s Suite, City Clerk’s Department, Human Resources Department, Finance Department, Community Services Department, and Police Station.	<input checked="" type="checkbox"/> Check if project performed with current firm	
b.	North Lauderdale Fire Station #34 North Lauderdale, Florida	2007	2008
	(3) BRIEF DESCRIPTION <i>(Brief scope, size, cost, etc.)</i> AND SPECIFIC ROLE 18,000 square-foot, three-story, apparatus bay, dormitory, and administrative facility.	<input checked="" type="checkbox"/> Check if project performed with current firm	
c.	Communications/Dispatch Center-Addition to Existing Building Coral Springs, Florida	1994	
	(3) BRIEF DESCRIPTION <i>(Brief scope, size, cost, etc.)</i> AND SPECIFIC ROLE New 5,000 S.F Addition to the roof of the existing facility. Construction implements hurricane resistant design for this new 911 Emergency Operation Center. Building components include raised computer flooring, UPS systems, redundant mechanical / electrical systems, etc.	<input checked="" type="checkbox"/> Check if project performed with current firm	
d.	City of Pompano Beach Avondale Park Pompano Beach, Florida	2005	2005
	(3) BRIEF DESCRIPTION <i>(Brief scope, size, cost, etc.)</i> AND SPECIFIC ROLE Master plan and construction documents for new 2.5 acre park which includes: Multi-purpose ballfield, basketball court, restroom building, shelters, fishing piers, jogging trail with exercise stations, playground, barbecue grilles, concrete circulation pathways, landscape, irrigation and parking facilities.	<input checked="" type="checkbox"/> Check if project performed with current firm	
e.	Riverside Park Community Center Ft. Lauderdale, FL	2003	2004
	(3) BRIEF DESCRIPTION <i>(Brief scope, size, cost, etc.)</i> AND SPECIFIC ROLE 5,000 S.F. community center with kitchen, restrooms, offices, and sport facilities.	<input type="checkbox"/> Check if project performed with current firm	

E. RESUMES OF KEY PERSONNEL PROPOSED FOR THIS CONTRACT

(Complete one Section E for each key person.)

12. NAME Abbas H. Zackria	13. ROLE IN THIS CONTRACT Principal	14. YEARS EXPERIENCE	
		a. TOTAL 17	b. WITH CURRENT FIRM 15
15. FIRM NAME AND LOCATION <i>(City and State)</i> Walters Zackria Associates, PLLC, Fort Lauderdale, Florida			
16. EDUCATION <i>(DEGREE AND SPECIALIZATION)</i> Bachelor of Architecture		17. CURRENT PROFESSIONAL REGISTRATION <i>(STATE AND DISCIPLINE)</i> Florida, Registered Architect	
18. OTHER PROFESSIONAL QUALIFICATIONS <i>(Publications, Organizations, Training, Awards, etc.)</i> LEED accredited training US Green Building Council FBC training Construction Specification Institute Roofing training NCARB – National Registration Certified CPTED training			

19. RELEVANT PROJECTS

	(1) TITLE AND LOCATION <i>(City and State)</i>	(2) YEAR COMPLETED	
		PROFESSIONAL SERVICES	CONSTRUCTION <i>(If Applicable)</i>
a.	Broward County A/E Miscellaneous Services Broward County, FL	2005 - Current	
	(3) BRIEF DESCRIPTION <i>(Brief scope, size, cost, etc.)</i> AND SPECIFIC ROLE County wide – A/E Miscellaneous Services	<input checked="" type="checkbox"/> Check if project performed with current firm	
b.	Miramar Police Headquarters Miramar, FL	2013	
	(3) BRIEF DESCRIPTION <i>(Brief scope, size, cost, etc.)</i> AND SPECIFIC ROLE New (3)-Story 80,000 S.F. Police Headquarters Building - Site Evaluation, Programming, Schematic Design, Design Development, Design-Build Criteria, Agency Approvals and LEED Administration. Green building design LEED "Silver Certification".	<input checked="" type="checkbox"/> Check if project performed with current firm	
c.	CSI Staff Offices, Police Evidence Processing, and Evidence Storage Facility Miramar, Florida	2008	
	(3) BRIEF DESCRIPTION <i>(Brief scope, size, cost, etc.)</i> AND SPECIFIC ROLE 5,000 S.F. – Project was added to and incorporated within a Public Works Storage Building designed by WZA for the City of Miramar in 2006. CSI Staff Offices portion includes offices for Evidence Department Supervisor, (7) Evidence Technicians, Evidence Return Window, Security Controls and General Closets.	<input checked="" type="checkbox"/> Check if project performed with current firm	
d.	Fire Station 94 Renovations	2008	
	(3) BRIEF DESCRIPTION <i>(Brief scope, size, cost, etc.)</i> AND SPECIFIC ROLE WZA designed the original Public Safety sub-station in 1992 to include 10,000 S.F. – Two (2) Story, Four (4) Apparatus Bay, Dormitory, Fire and Police Administrative Offices, and a rifle and pistol range.	<input checked="" type="checkbox"/> Check if project performed with current firm	
e.	New Police Station and Town hall Renovation Hillsboro Beach, Florida	2005	
	(3) BRIEF DESCRIPTION <i>(Brief scope, size, cost, etc.)</i> AND SPECIFIC ROLE New police station, dispatch center for the Town of Hillsboro Beach. Exterior renovations to existing Town Hall. New site amenities for circulation, public access, secured police to access and shift change and coordination with utility water plant.	<input type="checkbox"/> Check if project performed with current firm	

E. RESUMES OF KEY PERSONNEL PROPOSED FOR THIS CONTRACT

(Complete one Section E for each key person.)

12. NAME Anthony M. Scala, PE	13. ROLE IN THIS CONTRACT Structural Engineer	14. YEARS EXPERIENCE	
		a. TOTAL 28 Yrs.	b. WITH CURRENT FIRM 3 Yrs.
15. FIRM NAME AND LOCATION <i>(City and State)</i> Walters Zackria Associates, PLLC – Ft. Lauderdale, FL			
16. EDUCATION <i>(DEGREE AND SPECIALIZATION)</i> BSCE Structural Engineering		17. CURRENT PROFESSIONAL REGISTRATION <i>(STATE AND DISCIPLINE)</i> Florida PE 34353 Qualify Walters Zackria CA Qualify A. Mark Scala, P.E., Inc. CA 5838	
18. OTHER PROFESSIONAL QUALIFICATIONS <i>(Publications, Organizations, Training, Awards, etc.)</i> President of the Florida Structural Engineers Association, Palm Beaches Chapter Current Member AISC, ACI, ASCE, NCSEA			

19. RELEVANT PROJECTS

		(1) TITLE AND LOCATION <i>(City and State)</i> Plantation Community Church Plantation, FL	(2) YEAR COMPLETED 2004	
			PROFESSIONAL SERVICES Delegated engineer for structural steel	CONSTRUCTION <i>(If Applicable)</i>
a.		(3) BRIEF DESCRIPTION <i>(Brief scope, size, cost, etc.)</i> AND SPECIFIC ROLE Structural design of complex, cantilevered steel roof system. 16000sqft, cost unknown	[] Check if project performed with current firm	
		(1) TITLE AND LOCATION <i>(City and State)</i> Hot Chocolates restaurant and night club. Ft. Lauderdale, FL	(2) YEAR COMPLETED 1995	
			PROFESSIONAL SERVICES Structural engineering	CONSTRUCTION <i>(If Applicable)</i>
b.		(3) BRIEF DESCRIPTION <i>(Brief scope, size, cost, etc.)</i> AND SPECIFIC ROLE New concrete and steel structure attached to the second floor of an existing high rise building. Significant piling and cantilever construction. Cost unknown.	[] Check if project performed with current firm	
		(1) TITLE AND LOCATION <i>(City and State)</i> Casa Bonita, Delray Beach, FL	(2) YEAR COMPLETED 1997	
			PROFESSIONAL SERVICES Structural Engineering	CONSTRUCTION <i>(If Applicable)</i>
c.		(3) BRIEF DESCRIPTION <i>(Brief scope, size, cost, etc.)</i> AND SPECIFIC ROLE Single Family Residence, 27000sqft, 3 level house + 6000sqft detached parking garage, all on the ocean. Cost about \$25000000.	[] Check if project performed with current firm	
		(1) TITLE AND LOCATION <i>(City and State)</i> Aventura Mall Addition, Aventura, FL	(2) YEAR COMPLETED 1998	
			PROFESSIONAL SERVICES Delegated designer of structural steel connections	CONSTRUCTION <i>(If Applicable)</i>
d.		(3) BRIEF DESCRIPTION <i>(Brief scope, size, cost, etc.)</i> AND SPECIFIC ROLE Delegated designer for Steel Fabricators, LLC to a 4 story mall addition Cost unknown	[] Check if project performed with current firm	
		(1) TITLE AND LOCATION <i>(City and State)</i> Emerald Bay, Bahamas	(2) YEAR COMPLETED 2000	
			PROFESSIONAL SERVICES Structural design	CONSTRUCTION <i>(If Applicable)</i>
e.		(3) BRIEF DESCRIPTION <i>(Brief scope, size, cost, etc.)</i> AND SPECIFIC ROLE Resort consisting of 4, single story buildings; a casino, conference center, pool cabana and golf structure. Cost unknown	[] Check if project performed with current firm	

E. RESUMES OF KEY PERSONNEL PROPOSED FOR THIS CONTRACT
(Complete one Section E for each key person.)

12. NAME <u>Marta Villazon</u>	13. ROLE IN THIS CONTRACT Mechanical Professional Engineer	14. YEARS EXPERIENCE	
		a. TOTAL 23	b. WITH CURRENT FIRM 6
15. FIRM NAME AND LOCATION <i>(City and State)</i> Delta G Consulting Engineering, Inc. Ft. Lauderdale, Florida			
16. EDUCATION <i>(DEGREE AND SPECIALIZATION)</i> Master of Science in Energy Efficiency, 1998 Bachelor Science Mechanical Engineering 1988		17. CURRENT PROFESSIONAL REGISTRATION <i>(STATE AND DISCIPLINE)</i> Professional Engineer (PE) FL #60789	
18. OTHER PROFESSIONAL QUALIFICATIONS <i>(Publications, Organizations, Training, Awards, etc.)</i> LEEP AP 2009			

19. RELEVANT PROJECTS

a.	(1) TITLE AND LOCATION <i>(City and State)</i> Dania Beach Library Dania Beach, FL	(2) YEAR COMPLETED	
		PROFESSIONAL SERVICES 2009	CONSTRUCTION <i>(If applicable)</i>
	(3) BRIEF DESCRIPTION <i>(Brief scope, size, cost, etc.)</i> AND SPECIFIC ROLE A one story 10,000 s.f. project consisting of complete site electrical infrastructure and M/E/P/FS construction documents. LEED Gold Certification is included.	<input type="checkbox"/> Check if project performed with current firm	
b.	(1) TITLE AND LOCATION <i>(City and State)</i> Lauderhill Municipal Building Lauderhill, FL	(2) YEAR COMPLETED	
		PROFESSIONAL SERVICES 2007	CONSTRUCTION <i>(If applicable)</i>
	(3) BRIEF DESCRIPTION <i>(Brief scope, size, cost, etc.)</i> AND SPECIFIC ROLE Deltag G was responsible for the M/E/P/F Design of this 40,000 s.f. building includes staff offices with workspaces, building department, city commission chambers and a Multi-use meeting room.	<input type="checkbox"/> Check if project performed with current firm	
c.	(1) TITLE AND LOCATION <i>(City and State)</i> Broward County Library - Hallandale Branch Hallandale, FL	(2) YEAR COMPLETED	
		PROFESSIONAL SERVICES 2002	CONSTRUCTION <i>(If applicable)</i>
	(3) BRIEF DESCRIPTION <i>(Brief scope, size, cost, etc.)</i> AND SPECIFIC ROLE Lighting Design for new lighting at specific reading stations. Power design for new power for systems furniture, and special equipment. We did a low voltage design for data and CCTV outlet locations.	<input type="checkbox"/> Check if project performed with current firm	
d.	(1) TITLE AND LOCATION <i>(City and State)</i> Weston City Hall Weston, FL	(2) YEAR COMPLETED	
		PROFESSIONAL SERVICES 2005	CONSTRUCTION <i>(If applicable)</i>
	(3) BRIEF DESCRIPTION <i>(Brief scope, size, cost, etc.)</i> AND SPECIFIC ROLE Services included detailed construction documents for fire sprinklers, electrical and mechanical systems with specifications and coordination with regulatory agencies and building departments for permit.	<input type="checkbox"/> Check if project performed with current firm	
e.	(1) TITLE AND LOCATION <i>(City and State)</i> City of Miramar Fire Station #107 Miramar, FL	(2) YEAR COMPLETED	
		PROFESSIONAL SERVICES 2009	CONSTRUCTION <i>(If applicable)</i>
	(3) BRIEF DESCRIPTION <i>(Brief scope, size, cost, etc.)</i> AND SPECIFIC ROLE The scope of work for this project is a code update and redesign to current codes and modifications for LEED Certification.	<input type="checkbox"/> Check if project performed with current firm	

E. RESUMES OF KEY PERSONNEL PROPOSED FOR THIS CONTRACT
(Complete one Section E for each key person.)

12. NAME <u>Jorge Bahamonde</u>	13. ROLE IN THIS CONTRACT Fire Protection Engineer	14. YEARS EXPERIENCE	
		a. TOTAL 8	b. WITH CURRENT FIRM 6

15. FIRM NAME AND LOCATION *(City and State)*
 Delta G Consulting Engineering, Inc. Ft. Lauderdale, Florida

16. EDUCATION *(DEGREE AND SPECIALIZATION)*
 Bachelor of Science in Mechanical Engineering at Catholic University of Peru.

17. CURRENT PROFESSIONAL REGISTRATION *(STATE AND DISCIPLINE)*

18. OTHER PROFESSIONAL QUALIFICATIONS *(Publications, Organizations, Training, Awards, etc.)*
 LEEP AP 2009

19. RELEVANT PROJECTS

(1) TITLE AND LOCATION <i>(City and State)</i> Dania Beach Library Dania Beach, FL	(2) YEAR COMPLETED	
	PROFESSIONAL SERVICES 2009	CONSTRUCTION <i>(If applicable)</i>

a. (3) BRIEF DESCRIPTION *(Brief scope, size, cost, etc.)* AND SPECIFIC ROLE Check if project performed with current firm
 A one story 10,000 s.f. project consisting of complete site electrical infrastructure and M/E/P/FS construction documents. LEED Gold Certification is included.

(1) TITLE AND LOCATION <i>(City and State)</i> Lauderhill Municipal Building Lauderhill, FL	(2) YEAR COMPLETED	
	PROFESSIONAL SERVICES 2007	CONSTRUCTION <i>(If applicable)</i>

b. (3) BRIEF DESCRIPTION *(Brief scope, size, cost, etc.)* AND SPECIFIC ROLE Check if project performed with current firm
 Deltag G was responsible for the M/E/P/F Design of this 40,000 s.f. building includes staff offices with workspaces, building department, city commission chambers and a Multi-use meeting room.

(1) TITLE AND LOCATION <i>(City and State)</i> Broward County Library - Hallandale Branch Hallandale, FL	(2) YEAR COMPLETED	
	PROFESSIONAL SERVICES 2002	CONSTRUCTION <i>(If applicable)</i>

c. (3) BRIEF DESCRIPTION *(Brief scope, size, cost, etc.)* AND SPECIFIC ROLE Check if project performed with current firm
 Lighting Design for new lighting at specific reading stations. Power design for new power for systems furniture, and special equipment. We did a low voltage design for data and CCTV outlet locations.

(1) TITLE AND LOCATION <i>(City and State)</i> Weston City Hall Weston, FL	(2) YEAR COMPLETED	
	PROFESSIONAL SERVICES 2005	CONSTRUCTION <i>(If applicable)</i>

d. (3) BRIEF DESCRIPTION *(Brief scope, size, cost, etc.)* AND SPECIFIC ROLE Check if project performed with current firm
 Services included detailed construction documents for fire sprinklers, electrical and mechanical systems with specifications and coordination with regulatory agencies and building departments for permit.

(1) TITLE AND LOCATION <i>(City and State)</i> City of Miramar Fire Station #107 Miramar, FL	(2) YEAR COMPLETED	
	PROFESSIONAL SERVICES 2009	CONSTRUCTION <i>(If applicable)</i>

e. (3) BRIEF DESCRIPTION *(Brief scope, size, cost, etc.)* AND SPECIFIC ROLE Check if project performed with current firm
 The scope of work for this project is a code update and redesign to current codes and modifications for LEED Certification.

E. RESUMES OF KEY PERSONNEL PROPOSED FOR THIS CONTRACT
(Complete one Section E for each key person.)

12. NAME <u>Craig Bozeman</u>	13. ROLE IN THIS CONTRACT Electrical Engineer	14. YEARS EXPERIENCE	
		a. TOTAL 30	b. WITH CURRENT FIRM 5

15. FIRM NAME AND LOCATION *(City and State)*
 Delta G Consulting Engineering, Inc. Ft. Lauderdale, Florida

16. EDUCATION *(DEGREE AND SPECIALIZATION)*

17. CURRENT PROFESSIONAL REGISTRATION *(STATE AND DISCIPLINE)*

18. OTHER PROFESSIONAL QUALIFICATIONS *(Publications, Organizations, Training, Awards, etc.)*
 Various Lighting and Power Distribution Seminars.

19. RELEVANT PROJECTS

(1) TITLE AND LOCATION <i>(City and State)</i> Dania Beach Library Dania Beach, FL	(2) YEAR COMPLETED	
	PROFESSIONAL SERVICES 2009	CONSTRUCTION <i>(If applicable)</i>

a. (3) BRIEF DESCRIPTION *(Brief scope, size, cost, etc.)* AND SPECIFIC ROLE Check if project performed with current firm
 A one story 10,000 s.f. project consisting of complete site electrical infrastructure and M/E/P/FS construction documents. LEED Gold Certification is included.

(1) TITLE AND LOCATION <i>(City and State)</i> Lauderhill Municipal Building Lauderhill, FL	(2) YEAR COMPLETED	
	PROFESSIONAL SERVICES 2007	CONSTRUCTION <i>(If applicable)</i>

b. (3) BRIEF DESCRIPTION *(Brief scope, size, cost, etc.)* AND SPECIFIC ROLE Check if project performed with current firm
 Deltag G was responsible for the M/E/P/F Design of this 40,000 s.f. building includes staff offices with workspaces, building department, city commission chambers and a Multi-use meeting room.

(1) TITLE AND LOCATION <i>(City and State)</i> Broward County Library - Hallandale Branch Hallandale, FL	(2) YEAR COMPLETED	
	PROFESSIONAL SERVICES 2002	CONSTRUCTION <i>(If applicable)</i>

c. (3) BRIEF DESCRIPTION *(Brief scope, size, cost, etc.)* AND SPECIFIC ROLE Check if project performed with current firm
 Lighting Design for new lighting at specific reading stations. Power design for new power for systems furniture, and special equipment. We did a low voltage design for data and CCTV outlet locations.

(1) TITLE AND LOCATION <i>(City and State)</i> Weston City Hall Weston, FL	(2) YEAR COMPLETED	
	PROFESSIONAL SERVICES 2005	CONSTRUCTION <i>(If applicable)</i>

d. (3) BRIEF DESCRIPTION *(Brief scope, size, cost, etc.)* AND SPECIFIC ROLE Check if project performed with current firm
 Services included detailed construction documents for fire sprinklers, electrical and mechanical systems with specifications and coordination with regulatory agencies and building departments for permit.

(1) TITLE AND LOCATION <i>(City and State)</i> City of Miramar Fire Station #107 Miramar, FL	(2) YEAR COMPLETED	
	PROFESSIONAL SERVICES 2009	CONSTRUCTION <i>(If applicable)</i>

e. (3) BRIEF DESCRIPTION *(Brief scope, size, cost, etc.)* AND SPECIFIC ROLE Check if project performed with current firm
 The scope of work for this project is a code update and redesign to current codes and modifications for LEED Certification.

E. RESUMES OF KEY PERSONNEL PROPOSED FOR THIS CONTRACT

(Complete one Section E for each key person.)

12. NAME Azita Behmardi	13. ROLE IN THIS CONTRACT Civil design, permitting & construction certification	14. YEARS EXPERIENCE	
		a. TOTAL 26	b. WITH CURRENT FIRM 14
15. FIRM NAME AND LOCATION <i>(City and State)</i> ABACO Engineering, Inc.			
16. EDUCATION <i>(DEGREE AND SPECIALIZATION)</i> B.S. in Civil Engineering		17. CURRENT PROFESSIONAL REGISTRATION <i>(STATE AND DISCIPLINE)</i> Florida Professional Civil Engineer #44388	
18. OTHER PROFESSIONAL QUALIFICATIONS <i>(Publications, Organizations, Training, Awards, etc.)</i> Washington State Professional Engineer (1991 - 1999) American Society of Civil Engineers - Member			

19. RELEVANT PROJECTS

(1) TITLE AND LOCATION <i>(City and State)</i>	(2) YEAR COMPLETED	
	PROFESSIONAL SERVICES	CONSTRUCTION <i>(If applicable)</i>
Miramar Pinelands Natural Area, Miramar, FL	2012	2012
a. (3) BRIEF DESCRIPTION <i>(Brief scope, size, cost, etc.)</i> AND SPECIFIC ROLE	<input checked="" type="checkbox"/>	Check if project performed with current firm
Design , permitting and construction certification of roads, water, sewer, parking lots, and general site improvements for Phase I construction of Miramar Pinelands NATural Area in Broward County.		
(1) TITLE AND LOCATION <i>(City and State)</i>	(2) YEAR COMPLETED	
City of Wilton Manors City Hall, Wilton Manors, FL	2010	2010
b. (3) BRIEF DESCRIPTION <i>(Brief scope, size, cost, etc.)</i> AND SPECIFIC ROLE	<input checked="" type="checkbox"/>	Check if project performed with current firm
Design , permitting and construction certification of paving, grading, water, sewer and parking lot improvements for the new City Hall and Police Building in Wilton Manors, FL.		
(1) TITLE AND LOCATION <i>(City and State)</i>	(2) YEAR COMPLETED	
Richardson Park, Wilton Manors, FL	2011	2011
c. (3) BRIEF DESCRIPTION <i>(Brief scope, size, cost, etc.)</i> AND SPECIFIC ROLE	<input checked="" type="checkbox"/>	Check if project performed with current firm
Design , permitting and construction certification of paving, grading, water, sewer and parking lot, boat ramp, boardwalk and other site improvements for the new Park in Wilton Manors, FL.		
(1) TITLE AND LOCATION <i>(City and State)</i>	(2) YEAR COMPLETED	
Tradewinds Park Maintenance Building, Coconut Creek, FL	2011	2011
d. (3) BRIEF DESCRIPTION <i>(Brief scope, size, cost, etc.)</i> AND SPECIFIC ROLE	<input checked="" type="checkbox"/>	Check if project performed with current firm
Design , permitting and construction certification of paving, grading, water, sewer and parking lot improvements for the new Maintenance Building in Tradewinds Park.		
(1) TITLE AND LOCATION <i>(City and State)</i>	(2) YEAR COMPLETED	
Easterline Park Administration Building, Oakland Park, FL	2013	2013

E. RESUMES OF KEY PERSONNEL PROPOSED FOR THIS CONTRACT
(Complete one Section E for each key person.)

12. NAME Clece Aurelus	13. ROLE IN THIS CONTRACT Civil Engineer	14. YEARS EXPERIENCE	
		a. TOTAL 18	b. WITH CURRENT FIRM 8
15. FIRM NAME AND LOCATION (City and State) ABACO Engineering, Inc. Coral Springs, FL			
16. EDUCATION (DEGREE AND SPECIALIZATION) B.S. in Civil Engineering		17. CURRENT PROFESSIONAL REGISTRATION (STATE AND DISCIPLINE) Florida Professional Engineer	
18. OTHER PROFESSIONAL QUALIFICATIONS (Publications, Organizations, Training, Awards, etc.) American Society of Civil Engineers			

19. RELEVANT PROJECTS

(1) TITLE AND LOCATION (City and State)	(2) YEAR COMPLETED	
	PROFESSIONAL SERVICES	CONSTRUCTION (If applicable)
Corporate Pavilions at CB Smith, TY, Markham & Tradewinds Parks	2011	2011
a. (3) BRIEF DESCRIPTION (Brief scope, size, cost, etc.) AND SPECIFIC ROLE Design of the water, sewer, drainage and grading for the new corporate pavilions at various Broward County Parks	<input checked="" type="checkbox"/>	Check if project performed with current firm
Long Key Nature Center, Davie, Florida	2010	2010
b. (3) BRIEF DESCRIPTION (Brief scope, size, cost, etc.) AND SPECIFIC ROLE Design of the roadway, parking lot, water, sewer, drainage and grading for the new Broward County Nature Center at Long Key Park.	<input checked="" type="checkbox"/>	Check if project performed with current firm
N. 28th Ave. Infrastructure Improvements, Hollywood, FL	2010	2011
c. (3) BRIEF DESCRIPTION (Brief scope, size, cost, etc.) AND SPECIFIC ROLE Design and permitting of 10,000 LF of watermain and 1850 LF of sanitary sewer along N. 28th Avenue in Hollywood, FL	<input type="checkbox"/>	Check if project performed with current firm
Long Key Mitigation Project	2011	
d. (3) BRIEF DESCRIPTION (Brief scope, size, cost, etc.) AND SPECIFIC ROLE Grading and drainage design of approximately 22.5 Acres of freshwater wetlands as mitigation for other Broward County Roadway Projects.	<input checked="" type="checkbox"/>	Check if project performed with current firm
Dixie Highway corridor septic to sewer conversion, Hollywood, FL	2012	
e. (3) BRIEF DESCRIPTION (Brief scope, size, cost, etc.) AND SPECIFIC ROLE Design of 11,300 LF of gravity sewer main and 1400 LF of forcemain to convert existing septic systems to municipal sewer.	<input type="checkbox"/>	Check if project performed with current firm

E. RESUMES OF KEY PERSONNEL PROPOSED FOR THIS CONTRACT

(Complete one Section E for each key person.)

12. NAME Paul Weinberg, RLA	13. ROLE IN THIS CONTRACT Landscape Architect	14. YEARS EXPERIENCE	
		a. TOTAL 14	b. WITH CURRENT FIRM 1
15. FIRM NAME AND LOCATION <i>(City and State)</i> TBG Partners (Fort Lauderdale, Florida)			
16. EDUCATION <i>(DEGREE AND SPECIALIZATION)</i> Bachelor of Science, Landscape Architecture with Honors, Michigan State University, 2000		17. CURRENT PROFESSIONAL REGISTRATION <i>(STATE AND DISCIPLINE)</i> Registered Landscape Architect - State of Florida, No. 6666804	
18. OTHER PROFESSIONAL QUALIFICATIONS <i>(Publications, Organizations, Training, Awards, etc.)</i>			

19. RELEVANT PROJECTS

	(1) TITLE AND LOCATION <i>(City and State)</i>	(2) YEAR COMPLETED	
		PROFESSIONAL SERVICES	CONSTRUCTION <i>(If Applicable)</i>
a.	Huizenga Plaza and Las Olas Riverfront - Fort Lauderdale, Florida	2013-present	N/A
	(3) BRIEF DESCRIPTION <i>(Brief scope, size, cost, etc.)</i> AND SPECIFIC ROLE TBG is working with Fort Lauderdale's Downtown Development Authority to help transform Huizenga Plaza, Las Olas Boulevard and the surrounding waterfront area. The key components within the overall study area include a plan for repositioning of the special event and open space area associated with Huizenga Park and Plaza, an iconic park known as the tunnel top park, and the development of the Las Olas corridor through pedestrian activation and infill development. Paul is serving as Principal in Charge.	<input checked="" type="checkbox"/> Check if project performed with current firm	
b.	City of Destin CRA and Harborfront Plan - Destin, Florida	2013-present	N/A
	(3) BRIEF DESCRIPTION <i>(Brief scope, size, cost, etc.)</i> AND SPECIFIC ROLE TBG was commissioned to continue the harbor front CRA development and focus on the Heritage Park site, which is strategically located in the center of the harbor front. A key project objective is to provide physical and visual access to the harbor and pay to tribute to the legacy and importance of fishing to the city. A sophisticated park design accommodates the elevation change and ADA accessibility needs with interactive exhibits, a children's play and splash pad. Paul is serving as Principal in Charge.	<input checked="" type="checkbox"/> Check if project performed with current firm	
c.	Columbus Riverfront and Uptown 10 Street Terminus Study – Columbus, Georgia	2013-present	N/A
	(3) BRIEF DESCRIPTION <i>(Brief scope, size, cost, etc.)</i> AND SPECIFIC ROLE TBG is providing design services for the waterfront along the Chattahoochee River in Columbus, Georgia to enhance the urban fabric and provide an immersive environment. Features include improved riverfront connections, promenades, open lawns, splash pad and fountain, pavilion and stage, a zip line and tower, and rock climbing. Paul is serving as Principal in Charge.	<input checked="" type="checkbox"/> Check if project performed with current firm	
d.	(1) TITLE AND LOCATION <i>(City and State)</i>	PROFESSIONAL SERVICES	CONSTRUCTION <i>(If Applicable)</i>
	(3) BRIEF DESCRIPTION <i>(Brief scope, size, cost, etc.)</i> AND SPECIFIC ROLE	<input type="checkbox"/> Check if project performed with current firm	
e.	(1) TITLE AND LOCATION <i>(City and State)</i>	PROFESSIONAL SERVICES	CONSTRUCTION <i>(If Applicable)</i>
	(3) BRIEF DESCRIPTION <i>(Brief scope, size, cost, etc.)</i> AND SPECIFIC ROLE	<input type="checkbox"/> Check if project performed with current firm	

E. RESUMES OF KEY PERSONNEL PROPOSED FOR THIS CONTRACT

(Complete one Section E for each key person.)

12. NAME Richard C. Wohlfarth, P.E.	13. ROLE IN THIS CONTRACT Principal-in-Charge/ Director of Engineering	14. YEARS EXPERIENCE	
		a. TOTAL 25	b. WITH CURRENT FIRM 20
15. FIRM NAME AND LOCATION <i>(City and State)</i> Nutting Engineers of Florida, Inc., Boynton Beach, Florida			
16. EDUCATION <i>(DEGREE AND SPECIALIZATION)</i> University of Florida - B.S. Civil Engineering		17. CURRENT PROFESSIONAL REGISTRATION <i>(STATE AND DISCIPLINE)</i> Florida Professional Engineer (PE) #50858 Registered Building Inspector BN #3580 SBCCI #6528 ACI Level 1, UBCI	
18. OTHER PROFESSIONAL QUALIFICATIONS <i>(Publications, Organizations, Training, Awards, etc.)</i> Florida Engineering Society - Broward Chapter (Past President), Treasure Coast Builders Association, Florida Transportation Builders Association, Associated Builders & Contractors, Red Cross First Aid & CPR			

19. RELEVANT PROJECTS

	(1) TITLE AND LOCATION <i>(City and State)</i>	(2) YEAR COMPLETED	
		PROFESSIONAL SERVICES	CONSTRUCTION <i>(If Applicable)</i>
a.	Broward County, Qualification Based Contract- Multiple Departments inc. Public Works, Building, Parks & Recreation, Aviation, Fire Rescue, Water/Sewer	ongoing since '87	ongoing
	(3) BRIEF DESCRIPTION <i>(Brief scope, size, cost, etc.)</i> AND SPECIFIC ROLE West Regional Library and Parking Garage, EDP Laboratory, Pembroke Park Fire Stations #17 and #27, multiple roadway improvements, Aviation Dept. (several new buildings, new terminal building and apron, a 1.3M SF 7-story short term parking structure, fuel line relocations, roadways and bridges). Phase I/II environmental assessments, geotechnical engineering, site and building pad preparation monitoring, construction materials testing, special/threshold inspection services.	<input checked="" type="checkbox"/> Check if project performed with current firm	
b.	Bridge Point Port 95 Industrial Park, Dania Beach, Florida	ongoing since 2013	ongoing
	(3) BRIEF DESCRIPTION <i>(Brief scope, size, cost, etc.)</i> AND SPECIFIC ROLE Provided geotechnical exploration/engineering and deep dynamic compaction monitoring for the construction of two, one-story industrial warehouse buildings. Building 'A' will be ~95,680 square feet and building 'B' will be ~133,952 square feet. Construction is cast-on-site concrete tilt-wall panels supported on continuous and spread footings, interior structural steel columns, beams, and steel bar joists at the roof. NE is currently providing construction material testing and special inspection services for this project.	<input checked="" type="checkbox"/> Check if project performed with current firm	
c.	City of Miramar - Various Departments, Broward County, Florida	ongoing	ongoing
	(3) BRIEF DESCRIPTION <i>(Brief scope, size, cost, etc.)</i> AND SPECIFIC ROLE Providing geotechnical engineering, construction materials testing and inspection services per a qualification based continuing service contract. Projects include the City of Miramar overflow parking facility, Old City Hall site, Ansin Sports Complex, Miramar Multi-Service Center, numerous parks and infrastructure improvement projects.	<input checked="" type="checkbox"/> Check if project performed with current firm	
d.	Broward College, All Campuses, Broward County, Florida	ongoing	ongoing
	(3) BRIEF DESCRIPTION <i>(Brief scope, size, cost, etc.)</i> AND SPECIFIC ROLE Contract in correlation with Miller Legg and Associates for all campuses of BC for geotechnical engineering/exploration services, construction materials testing, special and threshold inspections services. Projects have included administration and classroom buildings, campus roadways and parking areas, athletic fields/ facilities.	<input checked="" type="checkbox"/> Check if project performed with current firm	
e.	Memorial Healthcare Systems, Broward County, Florida	ongoing	ongoing
	(3) BRIEF DESCRIPTION <i>(Brief scope, size, cost, etc.)</i> AND SPECIFIC ROLE Providing geotechnical engineering, construction materials testing and special/threshold inspection services throughout Broward County campuses. Projects include, but are not limited to parking lots and new parking structures/expansions, renovations, building additions and new construction. Recent experience includes the Phase II NICU, parking garage and central energy plant at the Hollywood campus.	<input checked="" type="checkbox"/> Check if project performed with current firm	

E. RESUMES OF KEY PERSONNEL PROPOSED FOR THIS CONTRACT

(Complete one Section E for each key person.)

12. NAME Steven M. Watts	13. ROLE IN THIS CONTRACT Land Surveying Services	14. YEARS EXPERIENCE	
		a. TOTAL 29	b. WITH CURRENT FIRM 10
15. FIRM NAME AND LOCATION <i>(City and State)</i> AWN Design & Consulting Group, Inc., Deerfield Beach, FL			
16. EDUCATION <i>(DEGREE AND SPECIALIZATION)</i> BSLS: Bachelor of Science – Land Surveying Purdue University		17. CURRENT PROFESSIONAL REGISTRATION <i>(STATE AND DISCIPLINE)</i> Professional Surveyor & Mapper – PSM #4588 State of Florida	
18. OTHER PROFESSIONAL QUALIFICATIONS <i>(Publications, Organizations, Training, Awards, etc.)</i>			

19. RELEVANT PROJECTS

	(1) TITLE AND LOCATION <i>(City and State)</i>	(2) YEAR COMPLETED	
		PROFESSIONAL SERVICES	CONSTRUCTION <i>(If Applicable)</i>
a.	Surveying Consulting Services – City of Coral Springs, FL	On-going	
	(3) BRIEF DESCRIPTION <i>(Brief scope, size, cost, etc.)</i> AND SPECIFIC ROLE Boundary & Topographic Surveys: City Hall North, Wiles Road Terminus Linear Park, Westside Maintenance Compound, Utility Division Complex, Pedestrian Bridge @ NW 87 th Ave, Charter School, City Art\Statue Riverside Dr., Covered Bridge @ NW 95 th Ave., Right-of-Way Surveys for Rock Island Road, University Drive, Remsburg Boulevard; NW 29 th St., Riverside Dr. & Shadow Wood Blvd., NW 28 th St., NW 39 th St.	<input checked="" type="checkbox"/> Check if project performed with current firm	
b.	Public Works\Facility Management Compound– City of Coconut Creek	2010/2011	
	(3) BRIEF DESCRIPTION <i>(Brief scope, size, cost, etc.)</i> AND SPECIFIC ROLE As-Built & Engineering Design Survey for new Public Works Building Boundary & Topographic Surveys, Legal Descriptions, CAD Mapping, Engineering & Architectural Design Surveys	<input checked="" type="checkbox"/> Check if project performed with current firm	
c.	Broward County Property Appraiser – Parcel Base Mapping Fort Lauderdale, FL	2006	
	(3) BRIEF DESCRIPTION <i>(Brief scope, size, cost, etc.)</i> AND SPECIFIC ROLE Parcel Base Mapping for the cities of Deerfield Beach, Pompano, Fort Lauderdale, Lighthouse Point	<input checked="" type="checkbox"/> Check if project performed with current firm	
d.	City of North Lauderdale, FL	On-going	
	(3) BRIEF DESCRIPTION <i>(Brief scope, size, cost, etc.)</i> AND SPECIFIC ROLE , Boundary & Topographic Surveys, Legal Descriptions, CAD Mapping, Engineering & Architectural Design Surveys	<input checked="" type="checkbox"/> Check if project performed with current firm	
e.	City of Pompano Beach, FL	On-going	
	(3) BRIEF DESCRIPTION <i>(Brief scope, size, cost, etc.)</i> AND SPECIFIC ROLE Right-of-Way surveys for Drainage Basins SE 4-1 and SE 4-2, Topographic Surveys: Community Park, McNair Park Pompano Beach Air Park – Engineering Design Surveys for Runway 15-33 and Taxiway Kilo	<input checked="" type="checkbox"/> Check if project performed with current firm	

F. EXAMPLE PROJECTS WHICH BEST ILLUSTRATE PROPOSED TEAM'S QUALIFICATIONS FOR THIS CONTRACT
(Present as many projects as requested by the agency, or 10 projects, if not specified. Complete one Section F for each project.)

20. EXAMPLE PROJECT KEY NUMBER
1

21. TITLE AND LOCATION <i>(City and State)</i> Miramar Police Headquarters Miramar, FL	22. YEAR COMPLETED	
	PROFESSIONAL SERVICES 2013	CONSTRUCTION (if Applicable)

23. PROJECT OWNER'S INFORMATION

a. PROJECT OWNER City of Miramar	b. POINT OF CONTACT NAME Eric Watters, MPA	c. POINT OF CONTACT TELEPHONE NUMBER 954-602-4321
-------------------------------------	---	--

24. BRIEF DESCRIPTION OF PROJECT AND RELEVANCE TO THIS CONTRACT *(Include scope, size, and cost)*

New (3)-Story 80,000 S.F. Police Headquarters Building - Site Evaluation, Programming, Schematic Design, Design Development, Design-Build Criteria, Agency Approvals and LEED Administration. Green building design LEED "Silver Certification".



25. FIRMS FROM SECTION C INVOLVED WITH THIS PROJECT

a.	(1) FIRM NAME Walters Zackria Associates, PLLC	(2) FIRM LOCATION <i>(City and State)</i> Fort Lauderdale, Florida	(3) ROLE Architectural services
b.	(1) FIRM NAME	(2) FIRM LOCATION <i>(City and State)</i>	(3) ROLE
c.	(1) FIRM NAME TLC	(2) FIRM LOCATION <i>(City and State)</i>	(3) ROLE
d.	(1) FIRM NAME	(2) FIRM LOCATION <i>(City and State)</i>	(3) ROLE
e.	(1) FIRM NAME	(2) FIRM LOCATION <i>(City and State)</i>	(3) ROLE
f.	(1) FIRM NAME	(2) FIRM LOCATION <i>(City and State)</i>	(3) ROLE

F. EXAMPLE PROJECTS WHICH BEST ILLUSTRATE PROPOSED TEAM'S QUALIFICATIONS FOR THIS CONTRACT
(Present as many projects as requested by the agency, or 10 projects, if not specified. Complete one Section F for each project.)

20. EXAMPLE PROJECT KEY NUMBER
2

21. TITLE AND LOCATION <i>(City and State)</i> Coconut Creek Public Works Building Coconut Creek, FL	22. YEAR COMPLETED	
	PROFESSIONAL SERVICES 2013	CONSTRUCTION (if Applicable)

23. PROJECT OWNER'S INFORMATION

a. PROJECT OWNER City of Coconut Creek	b. POINT OF CONTACT NAME Jim Berkman Director of Public Works	c. POINT OF CONTACT TELEPHONE NUMBER 954-956-1415
---	---	--

25. BRIEF DESCRIPTION OF PROJECT AND RELEVANCE TO THIS CONTRACT *(Include scope, size, and cost)*

- 25,000 S.F. of enclosed space on two stories;
- South-facing 'Greenscreen' landscape element doubles as a sunscreen;
- North-facing expanse of glazing allows daylight in and ample views out for the staff office areas;
- Redundant mechanical systems utilized for critical operations;
- IT Server room and 911 Dispatch Center with raised floor access flooring;
- EOC Center with state-of-the-art communication and technology systems
- Green building design LEED "Silver Certification"



25. FIRMS FROM SECTION C INVOLVED WITH THIS PROJECT

	(1) FIRM NAME	(2) FIRM LOCATION <i>(City and State)</i>	(3) ROLE
a.	Walters Zackria Associates, PLLC	Fort Lauderdale, Florida	Architectural services
b.			
c.			
d.			
e.			
f.			

F. EXAMPLE PROJECTS WHICH BEST ILLUSTRATE PROPOSED TEAM'S QUALIFICATIONS FOR THIS CONTRACT
(Present as many projects as requested by the agency, or 10 projects, If not specified. Complete one Section F for each project.)

20. EXAMPLE PROJECT KEY NUMBER
3

21. TITLE AND LOCATION <i>(City and State)</i> Broward County Aviation Department – New Maintenance Building Ft. Lauderdale, Florida	22. YEAR COMPLETED	
	PROFESSIONAL SERVICES 2013	CONSTRUCTION (if Applicable)

23. PROJECT OWNER'S INFORMATION

a. PROJECT OWNER BCAD	b. POINT OF CONTACT NAME Staci Montefusco, LEED GA, Project Manager III	c. POINT OF CONTACT TELEPHONE NUMBER 954-359-6149
--------------------------	---	--

26. BRIEF DESCRIPTION OF PROJECT AND RELEVANCE TO THIS CONTRACT *(Include scope, size, and cost)*

- 66,193 S.F. – Enhance overall BCAD Maintenance Department operations including an environment that enhances communications, increases productivity, lowers costs, and improves resource management.
- Create a facility to resist hurricanes to current code standards, which is capable of remaining operational during such emergencies.
- Create a 'green' building that is LEED Silver certified.



25. FIRMS FROM SECTION C INVOLVED WITH THIS PROJECT

	(1) FIRM NAME	(2) FIRM LOCATION <i>(City and State)</i>	(3) ROLE
a.	Walters Zackria Associates, PLLC	Fort Lauderdale, Florida	Architectural services
b.			
c.			
d.			
e.			
f.			

F. EXAMPLE PROJECTS WHICH BEST ILLUSTRATE PROPOSED TEAM'S QUALIFICATIONS FOR THIS CONTRACT
(Present as many projects as requested by the agency, or 10 projects, if not specified. Complete one Section F for each project.)

20. EXAMPLE PROJECT KEY NUMBER
4

21. TITLE AND LOCATION <i>(City and State)</i> New City Hall and Police Station Wilton Manors, Florida	22. YEAR COMPLETED	
	PROFESSIONAL SERVICES 2008	CONSTRUCTION (if Applicable) 2009

23. PROJECT OWNER'S INFORMATION

a. PROJECT OWNER City of Wilton Manors	b. POINT OF CONTACT NAME Richard Perez, Police Chief	c. POINT OF CONTACT TELEPHONE NUMBER 954-390-2155
---	---	--

27. BRIEF DESCRIPTION OF PROJECT AND RELEVANCE TO THIS CONTRACT *(Include scope, size, and cost)*

33,500 S.F. – Two (2) story Joint use facility with Commission Chambers, City Manager's Suite, City Clerk's Department, Human Resources Department, Finance Department, Community Services Department, and Police Station. POLICE STATION INCLUDES Chief's Suite, Detective Area, Sergeants and Captains Area, 911 Dispatch, Booking and Interview Rooms, Jail Cells, Evidence Processing and Storage, Sally Port, Gym, Lockers, Showers, Mail and Briefing Room, Ammunition Storage, Break Room, Quiet Room, Conference Room and Records Storage. This building is designed as an Emergency Operation Center with redundant power supply. The police station is secured by a perimeter fence, card access control, and security cameras. Police Department is designed to comply with CALEA ACCREDITATION STANDARDS.

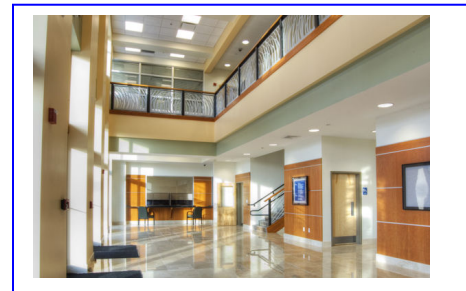

25. FIRMS FROM SECTION C INVOLVED WITH THIS PROJECT

	(1) FIRM NAME	(2) FIRM LOCATION <i>(City and State)</i>	(3) ROLE
a.	Walters Zackria Associates, PLLC	Fort Lauderdale, Florida	Architectural services
b.			
c.			
d.			
e.			
f.			

F. EXAMPLE PROJECTS WHICH BEST ILLUSTRATE PROPOSED TEAM'S QUALIFICATIONS FOR THIS CONTRACT
(Present as many projects as requested by the agency, or 10 projects, if not specified. Complete one Section F for each project.)

20. EXAMPLE PROJECT KEY NUMBER
5

21. TITLE AND LOCATION <i>(City and State)</i> CSI Staff Offices, Police Evidence Processing, and Evidence Storage Facility Miramar, Florida	22. YEAR COMPLETED	
	PROFESSIONAL SERVICES 2008	CONSTRUCTION (if Applicable)

23. PROJECT OWNER'S INFORMATION

a. PROJECT OWNER City of Miramar - Police Department	b. POINT OF CONTACT NAME Major Ray Black	c. POINT OF CONTACT TELEPHONE NUMBER 954-602-4041
---	---	--

28. BRIEF DESCRIPTION OF PROJECT AND RELEVANCE TO THIS CONTRACT *(Include scope, size, and cost)*

5,000 S.F. – Project was added to and incorporated within a Public Works Storage Building designed by WZA for the City of Miramar in 2006. CSI Staff Offices portion includes offices for Evidence Department Supervisor, (7) Evidence Technicians, Evidence Return Window, Security Controls and General Closets. Evidence Processing includes Secure Drop-off and Pick-up Garage, Chain of Custody Lockers, Evidence Processing Stations, and Crime Investigation Laboratory. Evidence Storage includes separate rooms for General Evidence Storage, Narcotics Storages, Fire Arms Storage, and Evidence Staging. An exterior fenced enclosure was design for bulk items and bicycle evidence storage. The entire evidence area is secured by prison mesh, burglar bars over all penetrations, card access control, security cameras, and motions sensors. This Evidence Facility is designed to comply with CALEA accreditation standards.



25. FIRMS FROM SECTION C INVOLVED WITH THIS PROJECT

	(1) FIRM NAME	(2) FIRM LOCATION <i>(City and State)</i>	(3) ROLE
a.	Walters Zackria Associates, PLLC	Fort Lauderdale, Florida	Architectural services
b.	(1) FIRM NAME	(2) FIRM LOCATION <i>(City and State)</i>	(3) ROLE
c.	(1) FIRM NAME	(2) FIRM LOCATION <i>(City and State)</i>	(3) ROLE
d.	(1) FIRM NAME	(2) FIRM LOCATION <i>(City and State)</i>	(3) ROLE
e.	(1) FIRM NAME	(2) FIRM LOCATION <i>(City and State)</i>	(3) ROLE
f.	(1) FIRM NAME	(2) FIRM LOCATION <i>(City and State)</i>	(3) ROLE

F. EXAMPLE PROJECTS WHICH BEST ILLUSTRATE PROPOSED TEAM'S QUALIFICATIONS FOR THIS CONTRACT
(Present as many projects as requested by the agency, or 10 projects, if not specified. Complete one Section F for each project.)

20. EXAMPLE PROJECT KEY NUMBER
6

21. TITLE AND LOCATION <i>(City and State)</i> North Lauderdale Fire Station #34 North Lauderdale, Florida	22. YEAR COMPLETED	
	PROFESSIONAL SERVICES 2007	CONSTRUCTION (if Applicable) 2008

23. PROJECT OWNER'S INFORMATION

a. PROJECT OWNER City of North Lauderdale	b. POINT OF CONTACT NAME Mr. Mike Shields	c. POINT OF CONTACT TELEPHONE NUMBER (954) 724-7039
--	--	--

24. BRIEF DESCRIPTION OF PROJECT AND RELEVANCE TO THIS CONTRACT *(Include scope, size, and cost)*

18,000 square-foot, three-story, apparatus bay, dormitory, and administrative facility.

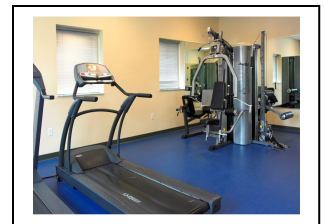

25. FIRMS FROM SECTION C INVOLVED WITH THIS PROJECT

	(1) FIRM NAME	(2) FIRM LOCATION <i>(City and State)</i>	(3) ROLE
a.	Walters Zackria Associates, PLLC	Fort Lauderdale, Florida	Architectural services
b.	Saad Elia El-Hage Consulting Engineers, Inc.	Fort Lauderdale, Florida	Structural Engineer
c.			
d.			
e.			
f.			

F. EXAMPLE PROJECTS WHICH BEST ILLUSTRATE PROPOSED TEAM'S QUALIFICATIONS FOR THIS CONTRACT
(Present as many projects as requested by the agency, or 10 projects, If not specified. Complete one Section F for each project.)

20. EXAMPLE PROJECT KEY NUMBER

7

21. TITLE AND LOCATION <i>(City and State)</i> Broward County Sheriff's Office – Wind Mitigation Ft. Lauderdale, Florida	22. YEAR COMPLETED	
	PROFESSIONAL SERVICES 2010	CONSTRUCTION (if Applicable)

23. PROJECT OWNER'S INFORMATION

a. PROJECT OWNER Broward County Sheriff's Office	b. POINT OF CONTACT NAME Mike Cahill, Director of Facilities Dept.	c. POINT OF CONTACT TELEPHONE NUMBER (954) 831-8163
---	--	--

24. BRIEF DESCRIPTION OF PROJECT AND RELEVANCE TO THIS CONTRACT *(Include scope, size, and cost)*

- Headquarters - Hurricane Hardening
 - Replace all windows, doors, louvers
 - Replace roof
 - Cover skylight
 - Tie down all equipment



25. FIRMS FROM SECTION C INVOLVED WITH THIS PROJECT

	(1) FIRM NAME	(2) FIRM LOCATION <i>(City and State)</i>	(3) ROLE
a.	Walters Zackria Associates, PLLC	Fort Lauderdale, Florida	Architectural services
b.			
c.			
d.			
e.			
f.			

F. EXAMPLE PROJECTS WHICH BEST ILLUSTRATE PROPOSED TEAM'S QUALIFICATIONS FOR THIS CONTRACT
(Present as many projects as requested by the agency, or 10 projects, If not specified. Complete one Section F for each project.)

20. EXAMPLE PROJECT KEY NUMBER
8

21. TITLE AND LOCATION <i>(City and State)</i> Avondale Park Pompano Beach, Florida	22. YEAR COMPLETED	
	PROFESSIONAL SERVICES 2004	CONSTRUCTION (if Applicable) 2005

23. PROJECT OWNER'S INFORMATION

a. PROJECT OWNER Pompano Beach	b. POINT OF CONTACT NAME Mr. Mark Beaudreu	c. POINT OF CONTACT TELEPHONE NUMBER (954) 786-4184
-----------------------------------	---	--

24. BRIEF DESCRIPTION OF PROJECT AND RELEVANCE TO THIS CONTRACT *(Include scope, size, and cost)*

Master plan and construction documents for new 2.5 acre park which includes: Multi-purpose ballfield, basketball court, restroom building, shelters, fishing piers, jogging trail with exercise stations, playground, barbecue grilles, concrete circulation pathways, landscape, irrigation and parking facilities



25. FIRMS FROM SECTION C INVOLVED WITH THIS PROJECT

	(1) FIRM NAME	(2) FIRM LOCATION <i>(City and State)</i>	(3) ROLE
a.	Walters Zackria Associates, PLLC	Fort Lauderdale, Florida	Architectural services
b.			
c.			
d.			
e.			
f.			

F. EXAMPLE PROJECTS WHICH BEST ILLUSTRATE PROPOSED TEAM'S QUALIFICATIONS FOR THIS CONTRACT
(Present as many projects as requested by the agency, or 10 projects, If not specified. Complete one Section F for each project.)

20. EXAMPLE PROJECT KEY NUMBER

9

21. TITLE AND LOCATION <i>(City and State)</i> Broward County Owner's Representative Services For Repair/Replacement of Certain Facilities – 35 Projects	22. YEAR COMPLETED	
	PROFESSIONAL SERVICES 2009	CONSTRUCTION (if Applicable)

23. PROJECT OWNER'S INFORMATION

a. PROJECT OWNER Broward County Parks & Recreation Div.	b. POINT OF CONTACT NAME Shobhan Smart, Project Manager	c. POINT OF CONTACT TELEPHONE NUMBER (954)-577-4624
--	--	--

24. BRIEF DESCRIPTION OF PROJECT AND RELEVANCE TO THIS CONTRACT *(Include scope, size, and cost)*

Broward County Owner's Representative Services For Repair/Replacement of Certain Facilities – 35 Projects

Scope included all projects located within District 5 with overall budget of \$8 million– Parks include Brian Piccolo Park, C.B. Smith Park, Long Key Natural Area, Markham Park, and Vista View Park. To date, we have completed over 20 different project ranging in construction dollar value from \$50,000 to \$1.5 million. Scope include as-builts, historical restoration, wetland creation, re-roofing, ADA renovations, construction and bid documents, and construction administration.

- CB Smith Park - Bridges
- CB Smith Park - Meeting Cabin
- Brian Piccolo Park - Track Repair
- Brian Piccolo Park - Irrigation Repair
- CB Smith Park - Pathway Repair
- Brian Piccolo Park - Street Light
- CB Smith Park - Lift Station Repair
- Vista View Park - Parking Lot/Curbir
- Long Key - Parking/Walkway Repair
- Markham Park - Playground Equip
- Markham Park – Roofs
- CB Smith Park - Fence Replace
- CB Smith Park - Plant Removal
- Pavilion Re-roofing
- Long Key - CA/Eng/Permit
- CB Smith - Bridge Permit/CA
- Markham Restrooms
- Baez Residence
- CB Smith Pavilion Re-Roof RE BID
- Markham Park - Pavilion Re-Roof RE BID
- Markham Park - Dog Park
- Long Key Natural Area - Utility and Landscape Coord. With Regulatory Agencies
- Markham Park - Campground "G" Renovation
- Markham Park – Bicycle Pathway
- Markham Park – New East Restroom Building
- Markham Park – Campground Landscape and Lift Station Renovations
- Brian Piccolo Park - Cricket Shelter Roof Renovations
- CB Smith Park – Entrance Roadway Improvements
- Markham Park Campsite Civil and Landscape Inspections
- CB Smith Park - New Parking Lot at Administration Building and Public Access ADA Walkways
- Various Parks - (4) New Restrooms
- Markham Park – Roof Replacement #3 Addl.



25. FIRMS FROM SECTION C INVOLVED WITH THIS PROJECT

	(1) FIRM NAME	(2) FIRM LOCATION <i>(City and State)</i>	(3) ROLE
a.	Walters Zackria Associates, PLLC	Fort Lauderdale, Florida	Architectural services
b.			
c.			
d.			
e.			
f.			

F. EXAMPLE PROJECTS WHICH BEST ILLUSTRATE PROPOSED TEAM'S QUALIFICATIONS FOR THIS CONTRACT
(Present as many projects as requested by the agency, or 10 projects, if not specified. Complete one Section F for each project.)

20. EXAMPLE PROJECT KEY NUMBER
10

21. TITLE AND LOCATION <i>(City and State)</i> General A/E Consultant Services for Broward County Parks - 25 Projects	22. YEAR COMPLETED	
	PROFESSIONAL SERVICES On-Going	CONSTRUCTION (if Applicable) On-Going

23. PROJECT OWNER'S INFORMATION

a. PROJECT OWNER Broward County	b. POINT OF CONTACT NAME Martin Gross	c. POINT OF CONTACT TELEPHONE NUMBER 954-370-3810
------------------------------------	--	--

29. BRIEF DESCRIPTION OF PROJECT AND RELEVANCE TO THIS CONTRACT *(Include scope, size, and cost)*
Services For Repair/Replacement Of Certain Park Facilities Within The Broward County, Florida Parks System

- Snake Warrior Island
- Deerfield Island Park
- Deerfield Island Park Additional Serv
- Roosevelt Gardens
- Miramar Pinelands
- Carpenter House
- Roosevelt Gardens
- Deerfield Island Water & Soil Testing
- Anne Kolb Nature Roof Study
- Loggerhead Restroom Evaluation
- Various Restrooms
- CB Smith Park-Marina Bldg Repairs
- Roosevelt Gardens Pk - A/E Services
- Hollywood N. Beach Pk. Carpenter House-Interior
- Loggerhead Restrooms
- Anne Kolb Nature - Cost Estimate
- Anne Kolb Re-Roofing
- Delevoe Park Comm. Ctr. Add. Fire Alarm
- Brow. Cty parks:Markham G, East, Sunview, Tradewinds
- Elec. Study Tradewinds Park
- Various Restrooms ADA Renovations
- Civil Engineering CB, Markham, Trade, TY
- TY Park Bldg Elec
- Fern Forest Nature Ctr-Exist Structure
- CBRP Waterfall



25. FIRMS FROM SECTION C INVOLVED WITH THIS PROJECT

	(1) FIRM NAME	(2) FIRM LOCATION <i>(City and State)</i>	(3) ROLE
a.	Walters Zackria Associates, PLLC	Fort Lauderdale, Florida	Architectural services
b.			
c.			
d.			
e.			
f.			

ARCHITECT – ENGINEER QUALIFICATIONS

1. SOLICITATION NUMBER (if any)

PART II – GENERAL QUALIFICATIONS

(If a firm has branch offices, complete for each specific branch office seeking work.)

2a. FIRM (OR BRANCH OFFICE) NAME Walters Zackria Associates, PLLC			3. YEAR ESTABLISHED 2005	4. DUNS NUMBER
2b. STREET 620 SE 1 st Street			5. OWNERSHIP	
2c. CITY Fort Lauderdale			a. TYPE Corporation	
2d. STATE FL		2e. ZIP CODE 33301		
6a. POINT OF CONTACT NAME AND TITLE Abbas H. Zackria, President			b. SMALL BUSINESS STATUS MBE	
6b. TELEPHONE NUMBER (954) 522-4123		6c. E-MAIL ADDRESS admin@wza-architects.com		
8a. FORMER FIRM NAME(S) (if any)			8b. YR. ESTABLISHED 1981	8c. DUNS NUMBER

9. EMPLOYEES BY DISCIPLINE				10. PROFILE OF FIRM'S EXPERIENCE AND ANNUAL AVERAGE REVENUE FOR LAST 5 YEARS		
a. Function Code	b. Discipline	c. No. of Employees		a. Profile Code	b. Experience	c. Revenue Index Number (see below)
		(1) FIRM	(2) BRANCH			
06	Architect	2		P13	City of Wilton Manors, City of Miramar, Broward Sheriff's Office, City of North Lauderdale, City of Coconut Creek	6
48	Project Manager	2				
08	CADD Technician	2				
02	Administrative	1		W01	City of Miramar, Group IV Industrial, City of Pompano, Broward County	5
57	Structural Engineer	1				
37	Interior Designer	1				
15	Construction Inspector	1		S11	Broward County, Broward County Aviation, City of Coconut Creek and City of Miramar	6
				C11	Broward County, City of Fort Lauderdale, City of Coconut Creek, City of Pompano Beach	6
				R04	City of Pompano Beach, Broward County, Coral Springs, Sunrise, School Board of Broward County, N. Lauderdale, Boca Raton, Delray Beach, Oakland Park	6
				I05	Broward County Aviation	2
				O01	Broward County Aviation	6
	Other Employees					
Total		10				

<p>11. ANNUAL AVERAGE PROFESSIONAL SERVICES REVENUES OF FIRM FOR LAST 3 YEARS (Insert revenue index number shown at right)</p> <table style="width: 100%;"> <tr> <td style="width: 50%;">a. Federal Work</td> <td></td> </tr> <tr> <td>b. Non-Federal Work</td> <td></td> </tr> <tr> <td>c. Total Work</td> <td></td> </tr> </table>	a. Federal Work		b. Non-Federal Work		c. Total Work		<p style="text-align: center;">PROFESSIONAL SERVICES REVENUE INDEX NUMBER</p> <table style="width: 100%;"> <tr> <td style="width: 50%;">1. Less than \$100,000</td> <td style="width: 50%;">6. \$2 million to less than \$5 million</td> </tr> <tr> <td>2. \$100,000 to less than \$250,000</td> <td>7. \$5 million to less than \$10 million</td> </tr> <tr> <td>3. \$250,000 to less than \$500,000</td> <td>8. \$10 million to less than \$25 million</td> </tr> <tr> <td>4. \$500,000 to less than \$1 million</td> <td>9. \$25 million to less than \$50 million</td> </tr> <tr> <td>5. \$1 million to less than \$2 million</td> <td>10. \$50 million or greater</td> </tr> </table>	1. Less than \$100,000	6. \$2 million to less than \$5 million	2. \$100,000 to less than \$250,000	7. \$5 million to less than \$10 million	3. \$250,000 to less than \$500,000	8. \$10 million to less than \$25 million	4. \$500,000 to less than \$1 million	9. \$25 million to less than \$50 million	5. \$1 million to less than \$2 million	10. \$50 million or greater
a. Federal Work																	
b. Non-Federal Work																	
c. Total Work																	
1. Less than \$100,000	6. \$2 million to less than \$5 million																
2. \$100,000 to less than \$250,000	7. \$5 million to less than \$10 million																
3. \$250,000 to less than \$500,000	8. \$10 million to less than \$25 million																
4. \$500,000 to less than \$1 million	9. \$25 million to less than \$50 million																
5. \$1 million to less than \$2 million	10. \$50 million or greater																

12. AUTHORIZED REPRESENTATIVE

The foregoing is a statement of facts.

a. SIGNATURE 	b. DATE 2/24/14
c. NAME AND TITLE Robert S. Walters, AIA, Vice President	

State of Florida

Department of State

I certify from the records of this office that WALTERS ZACKRIA ASSOCIATES, PLLC, is a limited liability company organized under the laws of the State of Florida, filed on September 30, 2004.

The document number of this company is L04000071177.

I further certify that said company has paid all fees due this office through December 31, 2014, that its most recent annual report was filed on January 27, 2014, and its status is active.

*Given under my hand and the
Great Seal of the State of Florida
at Tallahassee, the Capital, this
the Twenty-seventh day of
January, 2014*



Ken DeFoner
Secretary of State

Authentication ID: CC5818824357

To authenticate this certificate, visit the following site, enter this ID, and then follow the instructions displayed.

<https://efile.sunbiz.org/certauthver.html>

STATE OF FLORIDA
DEPARTMENT OF BUSINESS AND PROFESSIONAL REGULATION
BOARD OF ARCHITECTURE & INTERIOR DESIGN

LICENSE NUMBER	
	AA26000970

The ARCHITECT CORPORATION
 Named below IS CERTIFIED
 Under the provisions of Chapter 481 FS.
 Expiration date: FEB 28, 2015

WALTERS ZACKRIA ASSOCIATES PLLC
 620 SE FIRST STREET
 FORT LAUDERDALE FL 33301





RICK SCOTT
GOVERNOR
ISSUED: 02/22/2013 SEQ # L1302220000429
DISPLAY AS REQUIRED BY LAW
KEN LAWSON
SECRETARY

STATE OF FLORIDA
DEPARTMENT OF BUSINESS AND PROFESSIONAL REGULATION
BOARD OF ARCHITECTURE & INTERIOR DESIGN

LICENSE NUMBER	
	AR91520

The ARCHITECT
 Named below IS LICENSED
 Under the provisions of Chapter 481 FS.
 Expiration date: FEB 28, 2015

ZACKRIA, ABBAS H
 1733 SW 13TH STREET
 FORT LAUDERDALE FL 33312-4145





RICK SCOTT
GOVERNOR
ISSUED: 02/19/2013 SEQ # L1302190000682
DISPLAY AS REQUIRED BY LAW
KEN LAWSON
SECRETARY

STATE OF FLORIDA
DEPARTMENT OF BUSINESS AND PROFESSIONAL REGULATION
BOARD OF ARCHITECTURE & INTERIOR DESIGN

LICENSE NUMBER	
	AR0008880

The ARCHITECT
 Named below IS LICENSED
 Under the provisions of Chapter 481 FS.
 Expiration date: FEB 28, 2015

WALTERS, ROBERT S
 620 SE 1ST ST
 FT LAUDERDALE FL 333012018





RICK SCOTT
GOVERNOR
ISSUED: 02/19/2013 SEQ # L1302190000671
DISPLAY AS REQUIRED BY LAW
KEN LAWSON
SECRETARY

State of Florida

Board of Professional Engineers

Attests that

Walters Zackria Associates, PLLC



is authorized under the provisions of Section 471.023, Florida Statutes, to offer engineering services to the public through a Professional Engineer, duly licensed under Chapter 471, Florida Statutes.

Expiration: 2/28/2015

Audit No: 228201504447

Certificate of Authorization

CA Lic. No:

29507

State of Florida

Board of Professional Engineers

Attests that

Anthony M. Scala, P.E.



Is licensed as a Professional Engineer under Chapter 471, Florida Statutes

Expiration: 2/28/2015

Audit No: 228201507320

P.E. Lic. No:

34353

State of Florida

Board of Professional Engineers

Attests that

ABACO Engineering, Inc.

is authorized under the provisions of Section 471.023, Florida Statutes, to offer engineering services to the public through a Professional Engineer, duly licensed under Chapter 471, Florida Statutes.

Expiration: 2/28/2015

Audit No: 228201502270

Certificate of Authorization

CA Lic. No:

8237

State of Florida

Board of Professional Engineers

Attests that

Azita O. Behmardi, P.E.

Is licensed as a Professional Engineer under Chapter 471, Florida Statutes

Expiration: 2/28/2015

Audit No: 228201518332

P.E. Lic. No:

44388

State of Florida

Board of Professional Engineers

Attests that

Marta Elena Villazon, P.E.



FBPE

Is licensed as a Professional Engineer under Chapter 471, Florida Statutes

Expiration: 2/28/2015

Audit No: 228201523049

P.E. Lic. No:

60789

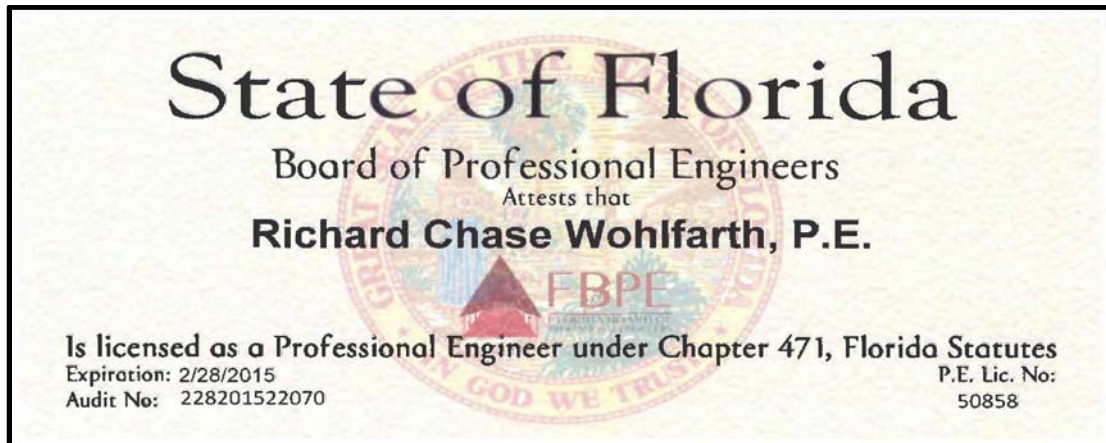



Florida Department of Agriculture and Consumer Services
 Division of Consumer Services
 Board of Professional Surveyors and Mappers
 2005 Apalachee Pkway Tallahassee, Florida 32399-6500

License No.: **LS4588**

Expiration Date: February 28, 2015

Professional Surveyor and Mapper License

Under the provisions of Chapter 472, Florida Statutes

STEVEN MICHAEL WATTS
 2611 NE 50TH STREET
 LIGHTHOUSE POINT, FL 33064

ADAM H. PUTNAM
 COMMISSIONER OF AGRICULTURE

This is to certify that the professional surveyor and mapper whose name and address are shown above is licensed as required by Chapter 472, Florida Statutes.



Florida Department of Agriculture and Consumer Services
 Division of Consumer Services
 Board of Professional Surveyors and Mappers
 2005 Apalachee Pkway Tallahassee, Florida 32399-6500

License No.: **LB7260**

Expiration Date: February 28, 2015

Professional Surveyor and Mapper Business License

Under the provisions of Chapter 472, Florida Statutes

AWN DESIGN & CONSULTING GROUP INC
 227 GOOLSBY BLVD
 DEERFIELD BEACH, FL 33442-3068

ADAM H. PUTNAM
 COMMISSIONER OF AGRICULTURE

This is to certify that the professional surveyor and mapper whose name and address are shown above is licensed as required by Chapter 472, Florida Statutes.

QUALIFICATIONS OF THE PROJECT TEAM

4



CITY OF FORT LAUDERDALE

RFQ. NO. 936-11270
 AN ANNUAL CONTRACT
 FOR
 ARCHITECTURAL CONSULTANT SERVICES
 (CCNA-CONSULTANTS' COMPETITIVE NEGOTIATION ACT)



PRIME PROJECT ARCHITECT
 Walters Zackria Associates, PLLC

PRINCIPALS-IN-CHARGE
 Abbas H. Zackria and Robert S. Walters

CBE • MBE

ENGINEERING
<p><i>Structural</i> WALTERS ZACKRIA ASSOCIATES, PLLC Mark Scala, P.E.</p>
<p>CBE • MBE</p>
<p><i>Mechanical, Electrical, Plumbing & Fire Protection</i> DELTA G. CONSULTING Marta Villazon, PE Jorge Bahamonde, PE Craig Bozeman</p>
<p>CBE • DBE</p>
<p><i>Civil</i> ABACO ENGINEERING Azita Behmardi, PE Clece Aurelus, PE</p>
<p>MBE • CBE • DBE</p>

SPECIAL CONSULTANTS
<p><i>Landscape</i> TBG PARTNERS Paul Weinberg, RLA</p>
<p><i>Geotechnical</i> NUTTING ENGINEERS OF FLORIDA, INC. Richard C. Wohlfarth, PE</p>
<p>SBE</p>
<p><i>Surveying</i> AWN DESIGN & CONSULTING GROUP, INC. Steve Watts</p>
<p>CBE</p>

ABBAS H. ZACKRIA, CSI CDT CPSI LEED AP

POSITION: PRINCIPAL ARCHITECT – PRESIDENT

EDUCATION: 1997, Intern Development Program
1998, Certified CPTED Training
1999, Roofing Systems Design Seminar - NRCA
2001, Florida Building Code Seminar
2001, Bachelor of Architecture, Rensselaer Polytechnic Institute
2001, Bachelor of Building Science, Rensselaer Polytechnic Institute
2004 and 2007 LEED Accredited Professional Training
2010, Construction Specification Institute CDT Training and Certification
2011, Florida Parks and Rec. Assoc. Playground Safety Inspector Training and Certification

EXPERIENCE: Mr. Zackria has fourteen years of progressive experience in planning, design and construction of municipal, recreational, commercial and institutional projects. Since joining the firm in 1998, he has worked extensively on municipal and commercial projects in this office. Currently, he is responsible for all firm projects from inception to final completion. Mr. Zackria is the firm's primary client liaison. He performs all construction document quality control checks, prepares project specifications and bid documents, and thorough consultant coordination. He has successfully completed hundreds of traditional Design / Bid / Build and Design / Build projects.

PROFESSIONAL REGISTRATION:

2012 / 2013, Broward County Board of Rules & Appeals Member
2009 / 2012, Broward County Board of Rules & Appeals Member
2009 / 2010, Construction Specification Institute Fort Lauderdale Chapter - President
2008 / 2009, Florida Parks and Recreation Association - Associate Member
2008 / 2009, Broward League of Cities - Associate Member
2008 / 2009, Broward 2030 Energy Committee, US Green Building Council
2008 / 2009, Construction Specification Institute Fort Lauderdale Chapter - Vice President
2007, US Green Building Council: LEED AP
2006 / 2008, Construction Specification Institute Fort Lauderdale Chapter – Director, Treasurer
2004, US Green Building Council: Florida
2004, Registered Architect: Illinois
2003, Registered Architect: Florida
1998, NCARB - National Registration

PROJECT EXPERIENCE:

2005 to 2013 - **City of Miramar**
Miramar Police Headquarters, Utilities Department Administration Offices, Public Works Locker Rooms, Water Plant Storage Building, Police Evidence Facility, Utility Headquarter's Building Renovations, and Water Treatment Plant Various Renovations.

2007 to 2009 - **City of Wilton Manors**
City Hall and Police Station

- 1999 to 2013 - **City of Coconut Creek**
\$7 million Design / Bid / Build New Public Works Building with Regional 911 Dispatch Center and EOC Recreation Center Addition, Hosford Park Renovations, Fire Stations 50 and 94 Hurricane Hardening, Public Works Administration and Fleet Building Hurricane Hardening, Police Station 911 Dispatch Renovations.
- 2007 to 2013 - **Broward County Sheriff's Office**
Juvenile Assessment Center Renovation, Pompano Jail Renovations, Headquarters Building Renovations, Tactical Training Center Renovations, and Cooper City Sub-station Renovations.
- 1999 to 2013 - **City of Coral Springs**
North Community Park, **Police Station Renovations**, City Hall Office Renovations, Mullins Park Soccer Building and Teen Center, Aquatic Center Renovations, Tennis Center Renovations, Mullins Park Concession Buildings, Water Treatment Plant Administration Building, Police Firing Range and other projects.
- 2002 to 2005 - **Town of Hillsboro Beach**
Police Station and Town Hall Renovations
- 2010 to 2013 - **Broward County Aviation Division**
\$15 million Public Works Maintenance Facility for Fort Lauderdale International Airport.
- 2010 to 2012 - **Broward County Construction Management Division**
\$8 million Design / Bid / Build Hurricane Hardening Upgrades to existing Public Safety Building.
- 2010 to 2012 - **Broward County Facilities Maintenance Division**
Various Renovations to existing facilities including Chiller Plant Replacement, New Library Lights, New Condensate Lines, and ADA Renovations.
- 1998 to 2013 - **Broward County Parks & Recreation**
\$10 million Design / Build District 2 Renovations for Quiet Waters Park, Tradewinds Park, North Broward Park and Deerfield Island Park (includes Quiet Waters Park Maintenance Building).
\$7 million Design / Build Long Key Nature Center and Maintenance Building
Continuing Services Contract Projects include:
Prototype Maintenance Buildings at Markham Park and Central Broward Park;
Administration Buildings at Markham, Tradewinds, and Easterlin Parks;
ADA Facility Upgrade for entire Broward County Park System; and over 100 other Parks and Recreation Projects in the past 14 years.
- 2004 to 2013 - **Broward County School Board**
Prototypical Competition Swimming Pools and Teaching Pools at Nova High, Northeast High, Fort Lauderdale High, Cooper City High, and Deerfield Beach High. Motor Training Center Pool Renovations at Bright Horizons, Quest, and Wingate Oaks. Food Court Style Cafeteria Implementation Feasibility Study.

- 2004 to 2009 - **City of Delray Beach**
Western Community Center, Seacrest Soccer Complex Building, Miller Park
Various Buildings, and Cornell Park.
- 2000 to 2003 - **Town of Davie**
Bamford Park Community Center, 61st Ave Park Pool Complex, Public Works
and Utilities Compound Master Plan, and various other projects.
- 2000 to 2006 - **Embraer Aircraft Holding, Inc. at Fort Lauderdale Airport**
Corporate Sales Center Building, Campus Masterplan, Various Building
Renovations.
- 2000 to 2004 - **City of Fort Lauderdale**
Warfield Park Community Center, Lauderdale Manors Community Center,
Croissant Park Community Center, Holiday Park Dugouts, Snyder Park Bldg.
D.C. Alexander Park, Cancer Survivor's Plaza, and South Beach Restroom.
- 2010 to 2013 - **City of Margate**
Water Treatment Plant Re-roofing Various Renovations.
- 2004 to 2013 - **City of North Lauderdale**
Water Treatment Plant Controls Building, Teen Center Renovations, Aquatic
Center Renovations, Public Works Building Roof Replacement, New Fire
Station #34, Fire Station #44 Renovations and other projects.
- 2001 to 2004 - **North Broward Hospital District**
Outpatient Care Center Renovation and various ADA renovations.
- 1998 to 2013 - **City of Oakland Park**
Engineering Building Renovations, North Andrews Gardens Community
Center, Jaco Pastorius Community Center, Collins Community Center, City
wide ADA Study, City Hall and Library Renovations, Wimberly Field
Renovations, and various other projects.
- 1998 to 1999 - **City of Palm Beach Gardens**
Tennis Center Building
- 1998 to 2013 - **City of Pompano Beach**
New Public Works Storage Warehouse Building, Utilities Department
Administrative Offices, Water Plant Renovations, Golf Course Maintenance
Building, Community Park Phases 1, 2 and 3, Avondale Park, Weaver Park,
Hunters Manor Park, Weaver Park, Herb Skolnick Center and various other
projects.
- 2002 to 2004 - **Saint Marks Episcopal School**
Gymnasium and Classroom Building
- 1999 to 2013 - **City of Sunrise**
Civic Center 50-Meter Pool, Civic Center Splash Pad, Sunrise Athletic
Complex Concession and Press Box, Tennis Complex Phase 2, Sunrise
Athletic Complex and Welleby Park Renovations.
- 1999 to 2001 - **City of Tamarac**
Community Center
- 1999 to 2000 - **Village of Wellington**
Aquatic Complex Building Renovations

ROBERT S. WALTERS, AIA

POSITION: PRINCIPAL ARCHITECT – VICE PRESIDENT

EDUCATION: 1979, Masters of Architecture - Clemson University –
Thesis: Stadium Design
1978, Urban School of Design - Genoa, Italy
1977, Bachelor of Science, Architecture - Clemson University
2004, Certified CPTED Training

**PROFESSIONAL
REGISTRATION:** 1981, Registered Architect: Florida
1982, NCARB - National Registration
1982, Certified General Contractor

**PROFESSIONAL
AFFILIATION:** American Institute of Architects
Fort Lauderdale Chamber of Commerce
National Historical Society
Leadership Broward Alumni
Construction Association of South Florida
City of Fort Lauderdale Code Enforcement Board - Past Member
School Board of Broward County - Consultant Selection Committee
Board of Trustee - First Presbyterian Church

EXPERIENCE: Mr. Walters founded the firm in 1981 and has since been principal architect and architect of record for over 1,000 projects. Leading the design team, his duties include building program phase, schematic design phase, design development phase, quality control of all construction documents, and review of construction administration phase. Mr. Walters' hands-on management concept starts with the design of every project, and terminates with the final punch list during the construction administration phase.

As a licensed general contractor, all construction documents are reviewed with a contractor's view; Construction costs and data reports are utilized throughout each phase of the project to assure the building owner that all budget constraints are met.

ARCHITECT OF RECORD EXPERIENCE:	Park and Recreational Structures	Site Master Planning
	Public Safety Facilities	Building Renovations
	Public Works Facilities	Food Preparation Facilities
	Educational Facilities	Hurricane Resistant Design
	Governmental Office Buildings	Medical Offices
	Transit Station Design	Religious Facilities
	Laboratories	Stadium Design

ANTHONY MARK SCALA, P.E.

POSITION: STRUCTURAL ENGINEER – VICE PRESIDENT

EDUCATION: UNIVERSITY OF CENTRAL FLORIDA
Bachelor of Science in Civil Engineering

LICENSE: Florida Professional Engineer #34353 since 1984
Florida Certified General Contractor, CGC0027660 since 1984

AWARDS: Florida Engineering Society Academic Scholarship
Professional Engineer, active, registered in Florida P.E No. 34353
State Certified General Contractor, inactive, CGC0027660

CURRENT MEMBERSHIPS: American Institute of Steel Construction
American Concrete Institute
National Council of Structural Engineers Association
American Society of Civil Engineers

EXPERIENCE: **August 2004 – November 5, 2010**
Broward County, FL
Chief Code Compliance Officer, Structural Engineer
Broward County Board of Rules and Appeals

January 1990 - August 2004
President of A. Mark Scala P.E., Inc. CA5838
Pompano Beach, FL

August 1991 – January 1993
STEEL FABRICATORS, INC.
Ft. Lauderdale, FL

July 1990 – August 1991
A. MARK SCALA, P.E., INC.
Pompano Beach, FL

June 1985 – July 1990
AMS AND ASSOCIATES, INC.
Pompano Beach, FL

Marta Villazon P.E., LEED AP

Mechanical Engineer

Experience



Marta Villazon is a Mechanical Professional Engineer with 22 years experience as a Mechanical Design Engineer, Project Manager, and Licensed Engineer. She is responsible for total management of all aspects of projects to ensure they are completed on time and at the highest level of quality.

Education:

Bachelor of Science in Mechanical Engineering Degree at University of Cienfuegos, Cuba
 Energy Efficiency and Thermal Design at University of Cienfuegos, Cuba

Ms. Villazon has designed mechanical systems for various buildings, such as Office/Commercial, Educational, Healthcare Facilities/Hospitals, Airports and Residential/Hotel.

Ms. Villazon has performed Energy and Load calculations and analysis using various software programs, selected equipment and prepared technical documentation. She provides project related service to clients, architects and contractors, and performs field inspections.

Registration:

LEED Accredited Professional (2009)

Experience

22 Years
 7 years with Delta G Consulting Engineers

Hotel / Residential Facilities:

- Plantation Holiday Inn
- The Euro Club
- Hyatt Place in Jacksonville, Fl
- Hyatt Place in Wyoming, Michigan
- Hyatt Place in Brandon, Fl
- Bliss Spa at the W Hotel Ft. Lauderdale
- Embassy Suites Deerfield Beach
- Ramada in Florida City
- Double Tree Hotel and Condo Building
- Venezia Las Olas
- Las Olas River House
- Icon South Beach
- Gables Marquis
- Continuum II Miami Beach
- Turnberry Village
- The Villas of Positano

Craig Bozeman

Electrical Engineer



Experience

30 years

Experience

Craig Bozeman is an Electrical Engineer with thirty years of experience as an Electrical designer and project manager. He is responsible for total management of all aspects of projects to ensure they are completed on time and at the highest level of quality.

Mr. Bozeman has designed Electrical systems for various buildings, such as Office/Commercial, Educational, and Residential/Hotel.

Mr. Bozeman's years of experience includes all phases of electrical engineering design and analysis.

- Have completed over 100 projects at **Fort Lauderdale International Airport** and other airports in South Florida
- **American Access Care** in Broward County, Florida
- **Starbucks and Dunkin Donuts** throughout Florida
- Over 40 **Elementary and High Schools**; Broward County, FL
- **Hyatt Hotels** (LEED Certified) in Michigan, and FI
- **Sunrise Public Work**, Sunrise, FL
- **BSO Main Jail Switchgear**; Fort Lauderdale, FL
- **Town of Davie Gun Range**, Davie, FL
- **Broward County Edgar Mills Multipurpose Center**, Design-Build Criteria
- **Pompano Beach Transit Center Bus Canopy**, Pompano Beach, FL
- **Sunnyland Housing Development** (LEED Certified); City of Sunrise, FL
- **The Cove in Deerfield Beach**, Deerfield Beach, FI
- **Pompano Beach Street Lighting**, Pompano Beach, FI

Jorge Bahamonde

Fire Protection Engineer



Education:

Bachelor of
Science, 2004

Registration:

LEED Accredited
Professional (2009)

Experience

6 years

Experience

Jorge Bahamonde is a Fire Protection Engineer with six years experience as a Fire Protection designer, and Project Manager. He is responsible for total management of all aspects of the projects to ensure they are completed on time and at the highest level of quality.

Mr. Bahamonde has designed fire systems for various buildings, such as Office/Commercial, Educational, Healthcare Facilities/Hospitals, Airports and Residential/Hotel.

Mr. Bahamonde has performed Energy and Load calculations and analysis using various software programs, selected equipment and prepared technical documentation. He provides project related service to clients, architects and contractors, and performs field inspections.

- **Dania Beach Library**, City of Dania Beach
- **Broward Performing Art**, Program and Building Expansion Studies, Fort Lauderdale, FL
- **Broward County Edgar Mills Multipurpose Center**, Broward County.
- Pompano Beach **Transit Center Bus Canopy**, Pompano Beach, FL
- **Weston City Hall** Weston, Fl
- **Coral Springs City Hall**, Coral Springs, Fl
- **Lauderdale Municipal Building**, Lauderhill, Fl
- **Sunrise Public Work**, Sunrise, FL
- Numerous **Police Stations** in Broward County, Florida
- Numerous **Fire Stations** In Broward County, Florida
- Over 40 **Elementary and High Schools**; Broward County, FL
- **Fort Lauderdale-Hollywood International Airport** , Fort Lauderdale, FL
- JAFCO, **Respite and Residential Center for Children with Developmental Disabilities**; City of Sunrise, FL

Azita O. Behmardi, P.E.
10100 W Sample Road, Suite 334
Coral Springs, Florida 33065
abehmardi@abacoengineering.com

Phone: 954-599-3726

Fax: 954-692-9033

Education University of Texas, Austin, Texas
Bachelor of Science in Civil Engineering

Registration Professional Engineer, Florida License No. 44388
Professional Engineer, Washington License No. 27345

Experience 5/99 – Present:

ABACO Engineering Inc., 5997 NW73rd Ct., Parkland, Florida
Founder and President of the company, responsible for marketing, design, permitting, inspection and construction project management of all in-house civil engineering projects. In this position consistent communication and coordination with the clients (i.e., various consulting firms, architects, and governmental agencies) are ongoing in order to provide highest level of quality. Projects range from roadway design, construction engineering, administration, inspection and traffic engineering to site planning for several government buildings and parks.

9/10 – 6/12:

City of Parkland, 6600 University Drive, Parkland, Florida.
Assistant Public Works Director and City Engineer, responsible for management of the City's Engineering Division, including Development Review, Capital Improvement Projects and Consultant management. Responsibilities also included addressing day-to-day engineering issues and review of future traffic studies for future development projects. As the Assistant Public Works Director I oversaw the day to day operation of Streets, Stormwater, Landscaping and Facilities Divisions.

12/97 – 7/99:

City of Tamarac, 6011 Nob Hill Road, Tamarac, Florida.
City Engineer, responsible for management of the City's Engineering Division, including Development Review, Traffic Engineering, Stormwater Engineering, Stormwater Maintenance and Street Maintenance Divisions. Responsibilities also included addressing day-to-day traffic engineering issues and analysis and review of future traffic studies for future development projects. Additional responsibilities included managing a four million dollar roadway construction project and overseeing the implementation of the City's seventeen million dollar Citywide Street Improvement Project

Experience (Continued)

12/95 - 12/97:

City of Hollywood, 2600 Hollywood Blvd, Hollywood, Florida.

Assistant City Engineer and Acting City Engineer responsible for management of the Development Administration Department's Engineering Division. Tasked with implementation of the City's multi-million dollar Capital Improvement Program as well as addressing all traffic related concerns for the City and responding to citizens' traffic engineering related complaints and concerns.

8/94 – 12/95:

City of Tumwater, 555 Israel Road, Tumwater, Washington.

City Engineer responsible for administration, coordination and management of the City's Engineering Department, establishment of the Department budget, design and project management of all capital improvement projects including design and construction of traffic signals and monitoring of consultant contracts, review of development projects and preparation of federal and state grant applications for new projects.

6/90 – 7/94:

City of Lacey, 420 College Street SE, Lacey, Washington.

Public Works Design Manager responsible for supervision of Department's engineers and technicians, project management of all in-house and consultant projects including conducting traffic studies, implementation of a signal synchronization project, administration of right of way acquisition and Utility Local Improvement Districts, review of all development projects in addition to administration of various project grants and loans.

10/89 – 2/90:

Blum Schumacher & Assoc., 2444 NE 1st Blvd. Gainesville, Florida. **Civil Engineer** responsible for the firm's civil engineering projects including traffic engineering, roadway and drainage design as well as feasibility studies for future construction.

5/86 – 10/89:

Texas Department of Transportation, 7901 North I-35, Austin, Texas.

Special Design Engineer, responsible for design of various roadway widening projects. (5/86 to 4/88)

Construction Project Manager, responsible for inspection, construction project administration and management of highway projects. (4/88 to 10/89)

References Will be provided upon request.

CLECE AURELUS, PE

145 NE 165th Street Miami, Florida 33162-3437

305-332-1834

Professional Experience

May 2003 – Present

ABACO ENGINEERING, INC.

10100 W Sample Rd, Suite 334, Coral Springs, FL 33067

Project Engineer. Responsible for paving, grading, drainage and utility design of engineering projects.

- ❖ The following is a list of a few of these projects:
 - ❖ Broward County Miramar Pinelands Nature Center
 - ❖ Broward County Long Key Nature Center
 - ❖ Wilton Manors City Hall
 - ❖ Broward County Tradewinds Park Maintenance Building
 - ❖ Broward County Tree Top Park Maintenance Building
 - ❖ Wilton Manors Richardson Park

December 1998 - Present

CITY OF HOLLYWOOD, DEPARTMENT OF DESIGN AND CONSTRUCTION MANAGEMENT

2717 Van Buren Street, Hollywood, Florida.

Civil Engineer. Responsible for the design, permitting and construction of engineering projects.

- ❖ Construction Manager for Hollywood Boulevard Gateway Streetscape, a \$3.6 million drainage, electrical, street lighting, brick paver sidewalk, signalization, landscaping and irrigation improvement.
- ❖ Construction Manager for Young Circle Streetscape and Site II, a \$2.5 million drainage, electrical, street lighting, brick paver sidewalk, signalization, landscaping and irrigation improvement.
- ❖ Polk Street and Tyler Street, a \$4.2 million major drainage and road reconstruction in low line area, electrical, street lighting.
- ❖ Project Manager for Arthur Street Widening, design and installation of aluminum sheet piling to prevent erosion, paving and drainage, sidewalk.
- ❖ Construction Manager for Jefferson Park restroom renovation and John William Park new restroom building, Keating Park restroom renovation.
- ❖ Project Manager for Attucks Middle School Sport Field Lighting, Stanley Goldman Park walkway restoration, new playground installation, picnic shelter, nature signs, and several miscellaneous projects.
- ❖ Design Engineer for Hollywood Boulevard Gateway Streetscape Phase II, a \$4.5 million drainage, electrical, street lighting, brick paver sidewalk, signalization, landscaping and irrigation improvement.

May 1997 - December 1998

MILLER LEGG AND ASSOCIATES, INC.

1800 N. Douglas Road, Pembroke Pines, Florida.

Project Engineer. Responsible for the design, drafting, permitting of engineering projects.

- ❖ Westpoint Industrial Park, 160-acre land developments project in the City of Tamarac, 2,800 LF of Hiatus Road north of Commercial Boulevard, drainage master plan, and sanitary sewer master plan and water master plan.
- ❖ Cameron Palms and Miramar Commons, land development projects in the Town of Davie and City of Miramar, sanitary sewer, water mains, force mains, paving and drainage.

October 1995 - April 1997

CIVIL CADD ENGINEERING, INC.

1011 Ives Dairy Road, Miami, Florida.

Project Engineer. Responsible for the design, drafting, permitting of engineering projects for Miami-Dade County and Broward County governments.

- ❖ SW 137th Avenue from 152nd street to 184th street, Miami, Florida, reconstruction and widening of the existing two-lane highway, paving and drainage, coordination with other consultants such as electrical, street lighting, signalization and utility companies.
- ❖ NW 17th Avenue from 103rd Street to 135th Street, Miami, Florida, reconstruction and widening of the two-lane residential street.
- ❖ Copans Road, Pompano Beach, Florida, a 2-mile roadway project consisting in reconstructing and widening of a four-lane highway, paving and drainage system.

May 1994 - October 1995

BERMELLO, AJAMIL and PARTNERS, INC.

2601 South Bayshore Drive, Miami, Florida.

Project Engineer. Responsible for the design, drafting and permitting of engineering projects.

- ❖ International Corporate Park at NW 107th Avenue and NW 19th Street, Miami, Florida, 300-acre land development project. Drainage, sanitary sewer and water master plans, 9,000 LF of roadway and water mains, 3,000 feet of sanitary force mains and gravity mains, lift station, paving, drainage, signage and pavement marking.
- ❖ Redondo and Brassfield, Homestead, Florida, two neighborhood improvements projects for City of Homestead, water mains, gravity mains, force mains, lift stations, paving and drainage.
- ❖ Homestead Motor Sport complex, Homestead, Florida.

Professional Credentials

Registered Civil Engineer in the State of Florida February 1999

Florida International University - Bachelor of Science in Civil Engineering conferred April 1994

Professional Associations

American Society of Civil Engineer



PAUL WEINBERG

RLA | Principal

Paul Weinberg is a multitalented designer and team leader who has been based in South Florida since 2000; during this time he has worked on a variety of significant public sector projects including urban parks, plazas, streetscapes and waterfront projects that provide meaning and purpose to the community. He has a unique understanding of how to create immersive and memorable public spaces that strengthen civic identity bring vitality to the larger area. Paul often works with artists and other consultants with innovative skills to create transcendent spaces; he is committed to a team-based approach that delivers creative, thought-provoking solutions tailored to the distinct character of each project.

EDUCATION

Bachelor of Science, Landscape Architecture with Honors, Michigan State University, 2000

REGISTRATION

Registered Landscape Architect - State of Florida, No. 6666804

// SELECTED PROJECT EXPERIENCE

- Huizenga Plaza and Las Olas Riverfront - Fort Lauderdale, Florida
- City of Destin CRA and Harborfront Plan - Destin, Florida
- West Caicos Molasses Reef - Turks and Caicos
- Fort Lauderdale Beach Streetscape Master Plan - Fort Lauderdale, Florida*
- Santa Rosa Island Authority Master Plan - San Rosa Island, Florida*
- Pensacola Beach Master Plan - Pensacola Beach, Florida*
- Owensboro Riverfront District Master Plan - Owensboro, Kentucky*
- Valletta Waterfront and Cruise Ship Terminal - Valletta, Malta*
- Hialeah Park Master Plan - Hialeah, Florida*
- Grove at Grand Bay - Miami, Florida*
- Saxony Condo and Hotel, Faena Development - Miami, Florida*
- Seville Hotel, Marriott - Miami, Florida*

*Denotes projects prior to joining TBG

Richard C. Wohlfarth, P.E.

Principal/ Director of Engineering

FORMAL EDUCATION:

University of Florida,
Gainesville, Bachelor of Science,
Civil Engineering

PROFESSIONAL REGISTRATIONS:

Registered Engineer-
State of Florida #50858

Registered Building Inspector-
State of Florida BN #3580

SBCCI #6528

ACI Level 1 #991175

UBCI

PROFESSIONAL AFFILIATIONS:

Florida Engineering Society
*Past Chapter President

National Society of Professional
Engineers

REFERENCES:

City of Miramar
2200 Civic Center Place
Miramar, Florida 33025
Mr. Alex Shershevsky
954-602-3315

Palm Beach County Engineering
& Public Works Department
2300 North Jog Road
West Palm Beach, Florida
33411
Mr. David Young
561-684-4149

Village of Wellington
14001 Pierson Road
Wellington, Florida 33414
Mr. Dennis Flaherty
561-791-4147

PROFESSIONAL EXPERIENCE:

Mr. Wohlfarth, P.E. is the Director of the Engineering Department which includes professional and technical personnel. He also has overall responsibility for the Special Inspection, Construction Materials Testing and Geotechnical Engineering Divisions where he directs training, quality system review and personnel evaluations. His responsibilities include report review, signing and sealing geotechnical engineering, structural inspection and laboratory testing reports for the company, providing contract negotiation and administration, budget estimating and project management.

Mr. Wohlfarth has 25 years of experience (20 with NE) in various aspects of geotechnical engineering which include determining feasibility of site development, foundation design analysis and recommendations, providing engineering evaluation for bridge and roadway construction, pavement design for roadways, roadway subgrade stabilization by geotextiles and other means, design of shoring systems for utility trenches and other deep excavations, dewatering methodology for trench and other excavations and backfill procedures, setting up and monitoring pile load tests, and providing value engineering for foundations.

Mr. Wohlfarth served as Project Engineer for the FDOT Broward Boulevard/ I-95 fly over ramps and access improvements to the Tri-Rail system, which included three new bridges. Additional project experience includes being the Project Engineer for the FDOT roadway widening and Turnpike improvements at Tamiami Trail. This particular project included three new bridges and over three miles of roadway improvements.

Mr. Wohlfarth served as the Project Engineer for numerous helical pier projects. He helped provide recommendations supporting portions of the Crate and Barrel building at Gulfstream Park in Hallandale Beach Florida. The main structure was being supported upon shallow foundations, however helical piers were warranted when the building footprint extended beyond initial demucking limits at the structure location. This recommendation allowed the project to be constructed on time without the need of additional demucking.

He currently serves as the Principal-in-Charge/Senior Project Manager for our qualification based continuing contract with Palm Beach and Broward County.

STEVEN M. WATTS, PSM
AWN DESIGN & CONSULTING GROUP, INC.

EDUCATION:

BSLS, Purdue University, 1984

PROFESSIONAL REGISTRATION:

Florida PSM No. 4588

QUALIFICATIONS:

Mr. Watts is President of AWN Design & Consulting Group, Inc. (AWN) specializing in surveying and mapping, land acquisition, computer mapping, land information/geographic information systems (LIS/GIS) and facilities management. As Principal Surveyor of AWN he is responsible and involved in all aspects of the company's surveying and mapping projects.

Prior to incorporating AWN in April, 2003, he was Vice President and Director of Surveying for Williams, Hatfield and Stoner, Inc. (WHS) having been an employee of WHS since 1984 upon graduation from Purdue University (BSLS-Lambda Sigma: Land Surveying Honorary). Having spent his entire professional surveying career working in Florida, he is extremely knowledgeable of the rules, requirements and specifications for completing large scale surveying and mapping projects in the South Florida area.

Mr. Watts has also been the Principle Surveyor for The Las Olas Company and their land holdings within the environs of the City of Fort Lauderdale, preparing boundary, topographic and design surveys for the various acquisitions, design projects, etc., for over ten years.

EXPERIENCE:

General Surveying & Mapping Services – City of Pompano Beach

Boundary & Topographic Surveys: Community Park, Canal Point Park; Legal Descriptions: Avondale Fishing Piers; Topographic Surveys: Pompano Beach Air Park; Taxiway "N" – Pavement Widening, Runway 15 – Runway Protection Zone, Magnetic Heading, Runways 6-24, 15-33 and 10-28.

General Surveying & Mapping Services – City of North Lauderdale

Boundary and Topographic Surveys, As-Built Surveys, Legal Descriptions, City Limit Determinations and General Surveying Services for the City of North Lauderdale. Additional responsibilities include project surveyor for the topographic survey of the municipal complex, GIS, water control district and utility mapping, Hampton Pines Park and Silver Lakes Middle School ball field renovation.

General Surveying & Mapping Services – City of Coral Springs

Boundary and Topographic Surveys, As-Built Surveys, Legal Descriptions, Design Surveys, Construction Stakeout, and General Surveying Services for the City of Coral Springs

WALTERS ZACKRIA ARCHITECTS PROJECT EXPERIENCE:

Architectural\Engineering Design Surveys:

- **Quite Waters Park, Deerfield Beach, FL**
- **Sunrise Aquatics Center, Sunrise, FL**
- **Sunrise Public Works Complex, Sunrise, FL**
- **Tradewinds Park, Coconut Creek, FL**
- **Canal Point Park, Pompano beach, FL**
- **CB Smith Park, Pembroke Pines, FL**
- **Public Works\Facility Management Compound, Coconut Creek, FL**
- **Utility Division Complex, Coral Springs, FL**
- **Easterlin Park, Oakland Park, FL**
- **Highlands Park, Pompano Beach, FL**
- **Markham Park, Sunrise, FL,**
- **Miramar Wastewater Treatment Plant, Miramar, FL**
- **Mullins Park, Coral Springs, FL**
- **Community Park, Pompano Beach, FL**

PROJECT MANAGER'S EXPERIENCE

5

Consultant Team Profile

Prime Consultant:

Architectural and Structural Engineering:

Walters Zackria Associates, PLLC
Abbas H. Zackria, President
Robert S. Walters, Vice President
Anthony M. Scala, P.E., Structural Eng.
620 SE 1st Street
Ft. Lauderdale, FL 33301
954-522-4123 Fax: 954-522-4128

CBE, MBE

Sub-Consultants:

Mechanical/Electrical/ Plumbing Engineering And Fire Protection:

Delta G. Consulting Engineers, Inc.
George San Juan, P.E.
707 NE 3rd Ave., Suite 200
Ft. Lauderdale, FL 33304
954-527-1112 Fax: 954-524-7505

DBE, CBE

Civil Engineering:

Abaco Engineering, Inc.
Azita Behmardi, P.E.
5997 NW 73rd Ct.
Parkland, FL 33067
954-599-3726 Fax: 954-692-9033

MBE, CBE, DBE

Landscape:

TBG Partners
Paul Weinberg, RLA
200 SW 1st Avenue, Suite 103
Ft. Lauderdale, FL 33301
954-713-1000

Geotechnical Engineering:

Nutting Engineers of Florida, Inc
Richard C. Wohlfarth, PE
1310 Neptune Drive
Boynton Beach, FL 33426
561-736-4900 Fax: 561-737-9975

SBE

Surveyor and Mapping:

AWN Design & Consulting Group, Inc.
Steve Watts
227 Goolsby Boulevard
Deerfield Beach, Florida 33442
954-481-8682 Fax: 954-725-3342

CBE

ABBAS H. ZACKRIA, CSI CDT CPSI LEED AP

POSITION: PRINCIPAL ARCHITECT – PRESIDENT

EDUCATION: 1997, Intern Development Program
1998, Certified CPTED Training
1999, Roofing Systems Design Seminar - NRCA
2001, Florida Building Code Seminar
2001, Bachelor of Architecture, Rensselaer Polytechnic Institute
2001, Bachelor of Building Science, Rensselaer Polytechnic Institute
2004 and 2007 LEED Accredited Professional Training
2010, Construction Specification Institute CDT Training and Certification
2011, Florida Parks and Rec. Assoc. Playground Safety Inspector Training and Certification

EXPERIENCE: Mr. Zackria has fourteen years of progressive experience in planning, design and construction of municipal, recreational, commercial and institutional projects. Since joining the firm in 1998, he has worked extensively on municipal and commercial projects in this office. Currently, he is responsible for all firm projects from inception to final completion. Mr. Zackria is the firm's primary client liaison. He performs all construction document quality control checks, prepares project specifications and bid documents, and thorough consultant coordination. He has successfully completed hundreds of traditional Design / Bid / Build and Design / Build projects.

PROFESSIONAL REGISTRATION:

2012 / 2013, Broward County Board of Rules & Appeals Member
2009 / 2012, Broward County Board of Rules & Appeals Member
2009 / 2010, Construction Specification Institute Fort Lauderdale Chapter - President
2008 / 2009, Florida Parks and Recreation Association - Associate Member
2008 / 2009, Broward League of Cities - Associate Member
2008 / 2009, Broward 2030 Energy Committee, US Green Building Council
2008 / 2009, Construction Specification Institute Fort Lauderdale Chapter - Vice President
2007, US Green Building Council: LEED AP
2006 / 2008, Construction Specification Institute Fort Lauderdale Chapter – Director, Treasurer
2004, US Green Building Council: Florida
2004, Registered Architect: Illinois
2003, Registered Architect: Florida
1998, NCARB - National Registration

PROJECT EXPERIENCE:

2005 to 2013 - **City of Miramar**
Miramar Police Headquarters, Utilities Department Administration Offices, Public Works Locker Rooms, Water Plant Storage Building, Police Evidence Facility, Utility Headquarter's Building Renovations, and Water Treatment Plant Various Renovations.

2007 to 2009 - **City of Wilton Manors**
City Hall and Police Station

- 1999 to 2013 - **City of Coconut Creek**
\$7 million Design / Bid / Build New Public Works Building with Regional 911 Dispatch Center and EOC Recreation Center Addition, Hosford Park Renovations, Fire Stations 50 and 94 Hurricane Hardening, Public Works Administration and Fleet Building Hurricane Hardening, Police Station 911 Dispatch Renovations.
- 2007 to 2013 - **Broward County Sheriff's Office**
Juvenile Assessment Center Renovation, Pompano Jail Renovations, Headquarters Building Renovations, Tactical Training Center Renovations, and Cooper City Sub-station Renovations.
- 1999 to 2013 - **City of Coral Springs**
North Community Park, **Police Station Renovations**, City Hall Office Renovations, Mullins Park Soccer Building and Teen Center, Aquatic Center Renovations, Tennis Center Renovations, Mullins Park Concession Buildings, Water Treatment Plant Administration Building, Police Firing Range and other projects.
- 2002 to 2005 - **Town of Hillsboro Beach**
Police Station and Town Hall Renovations
- 2010 to 2013 - **Broward County Aviation Division**
\$15 million Public Works Maintenance Facility for Fort Lauderdale International Airport.
- 2010 to 2012 - **Broward County Construction Management Division**
\$8 million Design / Bid / Build Hurricane Hardening Upgrades to existing Public Safety Building.
- 2010 to 2012 - **Broward County Facilities Maintenance Division**
Various Renovations to existing facilities including Chiller Plant Replacement, New Library Lights, New Condensate Lines, and ADA Renovations.
- 1998 to 2013 - **Broward County Parks & Recreation**
\$10 million Design / Build District 2 Renovations for Quiet Waters Park, Tradewinds Park, North Broward Park and Deerfield Island Park (includes Quiet Waters Park Maintenance Building).
\$7 million Design / Build Long Key Nature Center and Maintenance Building
Continuing Services Contract Projects include:
Prototype Maintenance Buildings at Markham Park and Central Broward Park;
Administration Buildings at Markham, Tradewinds, and Easterlin Parks;
ADA Facility Upgrade for entire Broward County Park System; and over 100 other Parks and Recreation Projects in the past 14 years.
- 2004 to 2013 - **Broward County School Board**
Prototypical Competition Swimming Pools and Teaching Pools at Nova High, Northeast High, Fort Lauderdale High, Cooper City High, and Deerfield Beach High. Motor Training Center Pool Renovations at Bright Horizons, Quest, and Wingate Oaks. Food Court Style Cafeteria Implementation Feasibility Study.

- 2004 to 2009 - **City of Delray Beach**
Western Community Center, Seacrest Soccer Complex Building, Miller Park
Various Buildings, and Cornell Park.
- 2000 to 2003 - **Town of Davie**
Bamford Park Community Center, 61st Ave Park Pool Complex, Public Works
and Utilities Compound Master Plan, and various other projects.
- 2000 to 2006 - **Embraer Aircraft Holding, Inc. at Fort Lauderdale Airport**
Corporate Sales Center Building, Campus Masterplan, Various Building
Renovations.
- 2000 to 2004 - **City of Fort Lauderdale**
Warfield Park Community Center, Lauderdale Manors Community Center,
Croissant Park Community Center, Holiday Park Dugouts, Snyder Park Bldg.
D.C. Alexander Park, Cancer Survivor's Plaza, and South Beach Restroom.
- 2010 to 2013 - **City of Margate**
Water Treatment Plant Re-roofing Various Renovations.
- 2004 to 2013 - **City of North Lauderdale**
Water Treatment Plant Controls Building, Teen Center Renovations, Aquatic
Center Renovations, Public Works Building Roof Replacement, New Fire
Station #34, Fire Station #44 Renovations and other projects.
- 2001 to 2004 - **North Broward Hospital District**
Outpatient Care Center Renovation and various ADA renovations.
- 1998 to 2013 - **City of Oakland Park**
Engineering Building Renovations, North Andrews Gardens Community
Center, Jaco Pastorius Community Center, Collins Community Center, City
wide ADA Study, City Hall and Library Renovations, Wimberly Field
Renovations, and various other projects.
- 1998 to 1999 - **City of Palm Beach Gardens**
Tennis Center Building
- 1998 to 2013 - **City of Pompano Beach**
New Public Works Storage Warehouse Building, Utilities Department
Administrative Offices, Water Plant Renovations, Golf Course Maintenance
Building, Community Park Phases 1, 2 and 3, Avondale Park, Weaver Park,
Hunters Manor Park, Weaver Park, Herb Skolnick Center and various other
projects.
- 2002 to 2004 - **Saint Marks Episcopal School**
Gymnasium and Classroom Building
- 1999 to 2013 - **City of Sunrise**
Civic Center 50-Meter Pool, Civic Center Splash Pad, Sunrise Athletic
Complex Concession and Press Box, Tennis Complex Phase 2, Sunrise
Athletic Complex and Welleby Park Renovations.
- 1999 to 2001 - **City of Tamarac**
Community Center
- 1999 to 2000 - **Village of Wellington**
Aquatic Complex Building Renovations

ANTHONY MARK SCALA, P.E.

POSITION: STRUCTURAL ENGINEER – VICE PRESIDENT

EDUCATION: UNIVERSITY OF CENTRAL FLORIDA
Bachelor of Science in Civil Engineering

LICENSE: Florida Professional Engineer #34353 since 1984
Florida Certified General Contractor, CGC0027660 since 1984

AWARDS: Florida Engineering Society Academic Scholarship
Professional Engineer, active, registered in Florida P.E No. 34353
State Certified General Contractor, inactive, CGC0027660

CURRENT MEMBERSHIPS: American Institute of Steel Construction
American Concrete Institute
National Council of Structural Engineers Association
American Society of Civil Engineers

EXPERIENCE: **August 2004 – November 5, 2010**
Broward County, FL
Chief Code Compliance Officer, Structural Engineer
Broward County Board of Rules and Appeals

January 1990 - August 2004
President of A. Mark Scala P.E., Inc. CA5838
Pompano Beach, FL

August 1991 – January 1993
STEEL FABRICATORS, INC.
Ft. Lauderdale, FL

July 1990 – August 1991
A. MARK SCALA, P.E., INC.
Pompano Beach, FL

June 1985 – July 1990
AMS AND ASSOCIATES, INC.
Pompano Beach, FL

Marta Villazon P.E., LEED AP

Mechanical Engineer

Experience



Marta Villazon is a Mechanical Professional Engineer with 22 years experience as a Mechanical Design Engineer, Project Manager, and Licensed Engineer. She is responsible for total management of all aspects of projects to ensure they are completed on time and at the highest level of quality.

Education:

Bachelor of Science in Mechanical Engineering Degree at University of Cienfuegos, Cuba
 Energy Efficiency and Thermal Design at University of Cienfuegos, Cuba

Ms. Villazon has designed mechanical systems for various buildings, such as Office/Commercial, Educational, Healthcare Facilities/Hospitals, Airports and Residential/Hotel.

Ms. Villazon has performed Energy and Load calculations and analysis using various software programs, selected equipment and prepared technical documentation. She provides project related service to clients, architects and contractors, and performs field inspections.

Registration:

LEED Accredited Professional (2009)

Experience

22 Years
 7 years with Delta G Consulting Engineers

Hotel / Residential Facilities:

- Plantation Holiday Inn
- The Euro Club
- Hyatt Place in Jacksonville, Fl
- Hyatt Place in Wyoming, Michigan
- Hyatt Place in Brandon, Fl
- Bliss Spa at the W Hotel Ft. Lauderdale
- Embassy Suites Deerfield Beach
- Ramada in Florida City
- Double Tree Hotel and Condo Building
- Venezia Las Olas
- Las Olas River House
- Icon South Beach
- Gables Marquis
- Continuum II Miami Beach
- Turnberry Village
- The Villas of Positano

Craig Bozeman

Electrical Engineer



Experience

30 years

Experience

Craig Bozeman is an Electrical Engineer with thirty years of experience as an Electrical designer and project manager. He is responsible for total management of all aspects of projects to ensure they are completed on time and at the highest level of quality.

Mr. Bozeman has designed Electrical systems for various buildings, such as Office/Commercial, Educational, and Residential/Hotel.

Mr. Bozeman's years of experience includes all phases of electrical engineering design and analysis.

- Have completed over 100 projects at **Fort Lauderdale International Airport** and other airports in South Florida
- **American Access Care** in Broward County, Florida
- **Starbucks and Dunkin Donuts** throughout Florida
- Over 40 **Elementary and High Schools**; Broward County, FL
- **Hyatt Hotels** (LEED Certified) in Michigan, and FI
- **Sunrise Public Work**, Sunrise, FL
- **BSO Main Jail Switchgear**; Fort Lauderdale, FL
- **Town of Davie Gun Range**, Davie, FL
- **Broward County Edgar Mills Multipurpose Center**, Design-Build Criteria
- **Pompano Beach Transit Center Bus Canopy**, Pompano Beach, FL
- **Sunnyland Housing Development** (LEED Certified); City of Sunrise, FL
- **The Cove in Deerfield Beach**, Deerfield Beach, FI
- **Pompano Beach Street Lighting**, Pompano Beach, FI

Jorge Bahamonde

Fire Protection Engineer



Education:

Bachelor of
Science, 2004

Registration:

LEED Accredited
Professional (2009)

Experience

6 years

Experience

Jorge Bahamonde is a Fire Protection Engineer with six years experience as a Fire Protection designer, and Project Manager. He is responsible for total management of all aspects of the projects to ensure they are completed on time and at the highest level of quality.

Mr. Bahamonde has designed fire systems for various buildings, such as Office/Commercial, Educational, Healthcare Facilities/Hospitals, Airports and Residential/Hotel.

Mr. Bahamonde has performed Energy and Load calculations and analysis using various software programs, selected equipment and prepared technical documentation. He provides project related service to clients, architects and contractors, and performs field inspections.

- **Dania Beach Library**, City of Dania Beach
- **Broward Performing Art**, Program and Building Expansion Studies, Fort Lauderdale, FL
- **Broward County Edgar Mills Multipurpose Center**, Broward County.
- Pompano Beach **Transit Center Bus Canopy**, Pompano Beach, FL
- **Weston City Hall** Weston, Fl
- **Coral Springs City Hall**, Coral Springs, Fl
- **Lauderdale Municipal Building**, Lauderhill, Fl
- **Sunrise Public Work**, Sunrise, FL
- Numerous **Police Stations** in Broward County, Florida
- Numerous **Fire Stations** In Broward County, Florida
- Over 40 **Elementary and High Schools**; Broward County, FL
- **Fort Lauderdale-Hollywood International Airport** , Fort Lauderdale, FL
- JAFCO, **Respite and Residential Center for Children with Developmental Disabilities**; City of Sunrise, FL

CLECE AURELUS, PE

145 NE 165th Street Miami, Florida 33162-3437

305-332-1834

Professional Experience

May 2003 – Present

ABACO ENGINEERING, INC.

10100 W Sample Rd, Suite 334, Coral Springs, FL 33067

Project Engineer. Responsible for paving, grading, drainage and utility design of engineering projects.

- ❖ The following is a list of a few of these projects:
 - ❖ Broward County Miramar Pinelands Nature Center
 - ❖ Broward County Long Key Nature Center
 - ❖ Wilton Manors City Hall
 - ❖ Broward County Tradewinds Park Maintenance Building
 - ❖ Broward County Tree Top Park Maintenance Building
 - ❖ Wilton Manors Richardson Park

December 1998 - Present

CITY OF HOLLYWOOD, DEPARTMENT OF DESIGN AND CONSTRUCTION MANAGEMENT

2717 Van Buren Street, Hollywood, Florida.

Civil Engineer. Responsible for the design, permitting and construction of engineering projects.

- ❖ Construction Manager for Hollywood Boulevard Gateway Streetscape, a \$3.6 million drainage, electrical, street lighting, brick paver sidewalk, signalization, landscaping and irrigation improvement.
- ❖ Construction Manager for Young Circle Streetscape and Site II, a \$2.5 million drainage, electrical, street lighting, brick paver sidewalk, signalization, landscaping and irrigation improvement.
- ❖ Polk Street and Tyler Street, a \$4.2 million major drainage and road reconstruction in low line area, electrical, street lighting.
- ❖ Project Manager for Arthur Street Widening, design and installation of aluminum sheet piling to prevent erosion, paving and drainage, sidewalk.
- ❖ Construction Manager for Jefferson Park restroom renovation and John William Park new restroom building, Keating Park restroom renovation.
- ❖ Project Manager for Attucks Middle School Sport Field Lighting, Stanley Goldman Park walkway restoration, new playground installation, picnic shelter, nature signs, and several miscellaneous projects.
- ❖ Design Engineer for Hollywood Boulevard Gateway Streetscape Phase II, a \$4.5 million drainage, electrical, street lighting, brick paver sidewalk, signalization, landscaping and irrigation improvement.

May 1997 - December 1998

MILLER LEGG AND ASSOCIATES, INC.

1800 N. Douglas Road, Pembroke Pines, Florida.

Project Engineer. Responsible for the design, drafting, permitting of engineering projects.

- ❖ Westpoint Industrial Park, 160-acre land developments project in the City of Tamarac, 2,800 LF of Hiatus Road north of Commercial Boulevard, drainage master plan, and sanitary sewer master plan and water master plan.
- ❖ Cameron Palms and Miramar Commons, land development projects in the Town of Davie and City of Miramar, sanitary sewer, water mains, force mains, paving and drainage.

October 1995 - April 1997

CIVIL CADD ENGINEERING, INC.

1011 Ives Dairy Road, Miami, Florida.

Project Engineer. Responsible for the design, drafting, permitting of engineering projects for Miami-Dade County and Broward County governments.

- ❖ SW 137th Avenue from 152nd street to 184th street, Miami, Florida, reconstruction and widening of the existing two-lane highway, paving and drainage, coordination with other consultants such as electrical, street lighting, signalization and utility companies.
- ❖ NW 17th Avenue from 103rd Street to 135th Street, Miami, Florida, reconstruction and widening of the two-lane residential street.
- ❖ Copans Road, Pompano Beach, Florida, a 2-mile roadway project consisting in reconstructing and widening of a four-lane highway, paving and drainage system.

May 1994 - October 1995

BERMELLO, AJAMIL and PARTNERS, INC.

2601 South Bayshore Drive, Miami, Florida.

Project Engineer. Responsible for the design, drafting and permitting of engineering projects.

- ❖ International Corporate Park at NW 107th Avenue and NW 19th Street, Miami, Florida, 300-acre land development project. Drainage, sanitary sewer and water master plans, 9,000 LF of roadway and water mains, 3,000 feet of sanitary force mains and gravity mains, lift station, paving, drainage, signage and pavement marking.
- ❖ Redondo and Brassfield, Homestead, Florida, two neighborhood improvements projects for City of Homestead, water mains, gravity mains, force mains, lift stations, paving and drainage.
- ❖ Homestead Motor Sport complex, Homestead, Florida.

Professional Credentials

Registered Civil Engineer in the State of Florida February 1999

Florida International University - Bachelor of Science in Civil Engineering conferred April 1994

Professional Associations

American Society of Civil Engineer



PAUL WEINBERG

RLA | Principal

Paul Weinberg is a multitalented designer and team leader who has been based in South Florida since 2000; during this time he has worked on a variety of significant public sector projects including urban parks, plazas, streetscapes and waterfront projects that provide meaning and purpose to the community. He has a unique understanding of how to create immersive and memorable public spaces that strengthen civic identity bring vitality to the larger area. Paul often works with artists and other consultants with innovative skills to create transcendent spaces; he is committed to a team-based approach that delivers creative, thought-provoking solutions tailored to the distinct character of each project.

EDUCATION

Bachelor of Science, Landscape Architecture with Honors, Michigan State University, 2000

REGISTRATION

Registered Landscape Architect - State of Florida, No. 6666804

// SELECTED PROJECT EXPERIENCE

- Huizenga Plaza and Las Olas Riverfront - Fort Lauderdale, Florida
- City of Destin CRA and Harborfront Plan - Destin, Florida
- West Caicos Molasses Reef - Turks and Caicos
- Fort Lauderdale Beach Streetscape Master Plan - Fort Lauderdale, Florida*
- Santa Rosa Island Authority Master Plan - San Rosa Island, Florida*
- Pensacola Beach Master Plan - Pensacola Beach, Florida*
- Owensboro Riverfront District Master Plan - Owensboro, Kentucky*
- Valletta Waterfront and Cruise Ship Terminal - Valletta, Malta*
- Hialeah Park Master Plan - Hialeah, Florida*
- Grove at Grand Bay - Miami, Florida*
- Saxony Condo and Hotel, Faena Development - Miami, Florida*
- Seville Hotel, Marriott - Miami, Florida*

*Denotes projects prior to joining TBG

Richard C. Wohlfarth, P.E.

Principal/ Director of Engineering

FORMAL EDUCATION:

University of Florida,
Gainesville, Bachelor of Science,
Civil Engineering

PROFESSIONAL REGISTRATIONS:

Registered Engineer-
State of Florida #50858

Registered Building Inspector-
State of Florida BN #3580

SBCCI #6528

ACI Level 1 #991175

UBCI

PROFESSIONAL AFFILIATIONS:

Florida Engineering Society
*Past Chapter President

National Society of Professional
Engineers

REFERENCES:

City of Miramar
2200 Civic Center Place
Miramar, Florida 33025
Mr. Alex Shershevsky
954-602-3315

Palm Beach County Engineering
& Public Works Department
2300 North Jog Road
West Palm Beach, Florida
33411
Mr. David Young
561-684-4149

Village of Wellington
14001 Pierson Road
Wellington, Florida 33414
Mr. Dennis Flaherty
561-791-4147

PROFESSIONAL EXPERIENCE:

Mr. Wohlfarth, P.E. is the Director of the Engineering Department which includes professional and technical personnel. He also has overall responsibility for the Special Inspection, Construction Materials Testing and Geotechnical Engineering Divisions where he directs training, quality system review and personnel evaluations. His responsibilities include report review, signing and sealing geotechnical engineering, structural inspection and laboratory testing reports for the company, providing contract negotiation and administration, budget estimating and project management.

Mr. Wohlfarth has 25 years of experience (20 with NE) in various aspects of geotechnical engineering which include determining feasibility of site development, foundation design analysis and recommendations, providing engineering evaluation for bridge and roadway construction, pavement design for roadways, roadway subgrade stabilization by geotextiles and other means, design of shoring systems for utility trenches and other deep excavations, dewatering methodology for trench and other excavations and backfill procedures, setting up and monitoring pile load tests, and providing value engineering for foundations.

Mr. Wohlfarth served as Project Engineer for the FDOT Broward Boulevard/ I-95 fly over ramps and access improvements to the Tri-Rail system, which included three new bridges. Additional project experience includes being the Project Engineer for the FDOT roadway widening and Turnpike improvements at Tamiami Trail. This particular project included three new bridges and over three miles of roadway improvements.

Mr. Wohlfarth served as the Project Engineer for numerous helical pier projects. He helped provide recommendations supporting portions of the Crate and Barrel building at Gulfstream Park in Hallandale Beach Florida. The main structure was being supported upon shallow foundations, however helical piers were warranted when the building footprint extended beyond initial demucking limits at the structure location. This recommendation allowed the project to be constructed on time without the need of additional demucking.

He currently serves as the Principal-in-Charge/Senior Project Manager for our qualification based continuing contract with Palm Beach and Broward County.

STEVEN M. WATTS, PSM
AWN DESIGN & CONSULTING GROUP, INC.

EDUCATION:

BSLS, Purdue University, 1984

PROFESSIONAL REGISTRATION:

Florida PSM No. 4588

QUALIFICATIONS:

Mr. Watts is President of AWN Design & Consulting Group, Inc. (AWN) specializing in surveying and mapping, land acquisition, computer mapping, land information/geographic information systems (LIS/GIS) and facilities management. As Principal Surveyor of AWN he is responsible and involved in all aspects of the company's surveying and mapping projects.

Prior to incorporating AWN in April, 2003, he was Vice President and Director of Surveying for Williams, Hatfield and Stoner, Inc. (WHS) having been an employee of WHS since 1984 upon graduation from Purdue University (BSLS-Lambda Sigma: Land Surveying Honorary). Having spent his entire professional surveying career working in Florida, he is extremely knowledgeable of the rules, requirements and specifications for completing large scale surveying and mapping projects in the South Florida area.

Mr. Watts has also been the Principle Surveyor for The Las Olas Company and their land holdings within the environs of the City of Fort Lauderdale, preparing boundary, topographic and design surveys for the various acquisitions, design projects, etc., for over ten years.

EXPERIENCE:

General Surveying & Mapping Services – City of Pompano Beach

Boundary & Topographic Surveys: Community Park, Canal Point Park; Legal Descriptions: Avondale Fishing Piers; Topographic Surveys: Pompano Beach Air Park; Taxiway "N" – Pavement Widening, Runway 15 – Runway Protection Zone, Magnetic Heading, Runways 6-24, 15-33 and 10-28.

General Surveying & Mapping Services – City of North Lauderdale

Boundary and Topographic Surveys, As-Built Surveys, Legal Descriptions, City Limit Determinations and General Surveying Services for the City of North Lauderdale. Additional responsibilities include project surveyor for the topographic survey of the municipal complex, GIS, water control district and utility mapping, Hampton Pines Park and Silver Lakes Middle School ball field renovation.

General Surveying & Mapping Services – City of Coral Springs

Boundary and Topographic Surveys, As-Built Surveys, Legal Descriptions, Design Surveys, Construction Stakeout, and General Surveying Services for the City of Coral Springs

WALTERS ZACKRIA ARCHITECTS PROJECT EXPERIENCE:

Architectural\Engineering Design Surveys:

- **Quite Waters Park, Deerfield Beach, FL**
- **Sunrise Aquatics Center, Sunrise, FL**
- **Sunrise Public Works Complex, Sunrise, FL**
- **Tradewinds Park, Coconut Creek, FL**
- **Canal Point Park, Pompano beach, FL**
- **CB Smith Park, Pembroke Pines, FL**
- **Public Works\Facility Management Compound, Coconut Creek, FL**
- **Utility Division Complex, Coral Springs, FL**
- **Easterlin Park, Oakland Park, FL**
- **Highlands Park, Pompano Beach, FL**
- **Markham Park, Sunrise, FL,**
- **Miramar Wastewater Treatment Plant, Miramar, FL**
- **Mullins Park, Coral Springs, FL**
- **Community Park, Pompano Beach, FL**

APPROACH TO SCOPE OF WORK

6

UNDERSTANDING THE PROJECT AND PROJECT REQUIREMENTS

As a leader of a highly qualified and responsive team of design professionals, Walters Zackria Associates and its team of highly qualified consultants will provide the City of Fort Lauderdale with Architectural Consulting Professional Services on an annual contract basis.

WZA has been providing many Municipalities with Architectural and Engineering services on various projects for the past thirty years. We thoroughly understand the needs and have the solutions to make each project a success.

WZA and our Consultants' staff of design and engineering experts can readily provide professional services for the following project types:

- **Space Planning**
- **Programming**
- **Specifications**
- **Architectural Design**
- **Contract Administration**
- **Cost Estimating, Planning and Scheduling**
- **Architectural 3D Rendering and Animation Services**
- **Interior Design**
- **Landscape Architecture**
- **ADA Analysis and Design**
- **Sustainable Design**
- **Building Performance Analysis**
- **Historical Preservation**
- **LEED Design**
- **Structural Design**
- **Mechanical, Electrical, Plumbing Design**

We have tremendous knowledge and experience working on similar projects for various local municipalities for almost 30 years. Best way to demonstrate the firm's capabilities on continuing services contracts is by providing a brief sampling of similar projects successfully completed by WZA for Broward County and various local municipalities:

CITY OF DELRAY BEACH EXPERIENCE

CITY OF DELRAY BEACH – MILLER PARK COMPLEX - 2009

5,500 S.F. Three New Buildings on 23 Acre Site. Two-Story Concession and Meeting Room Building, One-Story Concession Building and One-Story Storage Facility.

CITY OF DELRAY BEACH – SEACREST SOCCER COMPLEX - 2008

2,000 S.F. One-Story Concession and Restroom Building for 8.5 Acre Park

CITY OF DELRAY BEACH – WESTERN COMMUNITY CENTER – (NOT BUILT)- 2007

6 Acre Site Masterplan for New Community Center & Passive Park
34,500 S.F. Community Center with Assembly, Offices, Fitness & Gymnasium

CITY OF DELRAY BEACH - FIRE ADMINISTRATION BUILDING - 1994

Design for Fire Administration Offices, Emergency Operation Center, and Fire Station – 55,000 sq. ft.

CITY OF DELRAY BEACH - FIRE STATION - 1992

Design for Fire Station Renovation and Addition

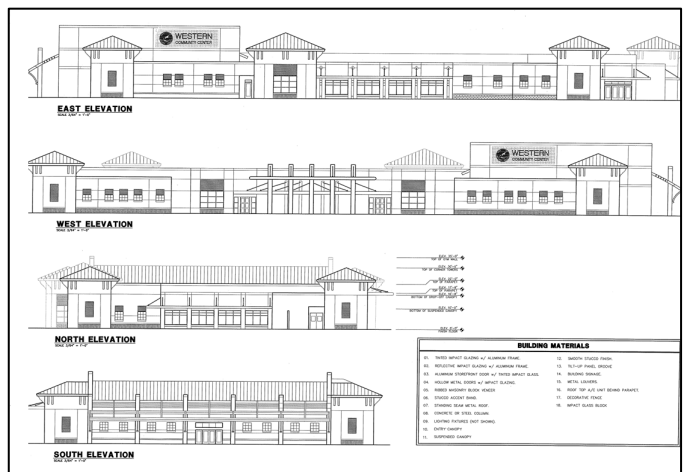
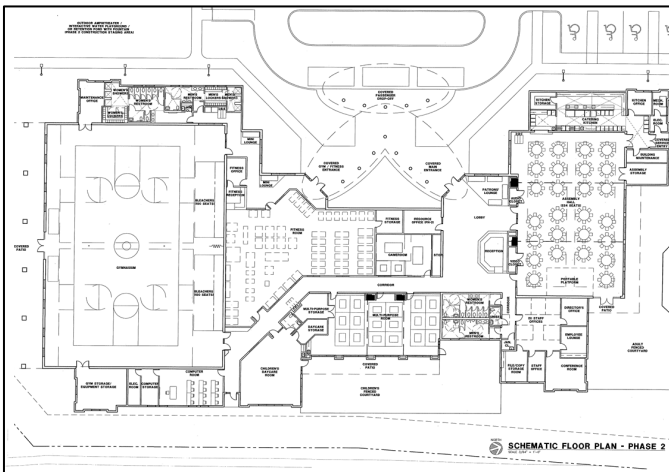

Western Community Center



Seacrest Soccer Complex

City of Pompano Beach (1996 to 2012):

City Golf Course Renovations, Golf Course Maintenance Bldg, Golf Course Masterplan, Civic Center Masterplan, Community Park Masterplan, Avondale Park Master Plan, Canal Point Park Masterplan, Hunters Manor Park Master Plan, Water Treatment Plant Renovations, Public Works Building B Office Renovations, Public Works Storage Building, and Herb Skolnick Community Center.

Broward County Parks and Recreation – A/E Owner’s Representative on 2000 bond projects (2002 to 2007):

Long Key Natural Area	CB Smith Park	Markham Park
Parking Lot Redesign Irrigation System Replacement Street Light Replacement Wetland Creation Native Landscaping Restoration Exotic Vegetation Removal Site Masterplan for future Nature Center and Maintenance Building Baez Residence – Historical House Restoration (Won State Award!!!)	(3) Pedestrian Bridge Structural and Architectural teardown and rebuild. Meeting Cabin Structural and Architectural Repairs Velodrome Track Concrete Restoration and Surface Repairs Asphalt Pavement Repairs (5) Lift Station Teardown and Rebuild Park Boundary Fence Replacement Exotic Vegetation Removal Pavilion Re-Roofing –20 buildings CB Smith Entrance Roadway, sidewalk – over ½ mile of pavement	Playground Replacement (2) New Restroom Buildings Pavilion Re-Roofing – three phases 30 buildings New Dog Park Camp Ground – sewer system installation for 120 campsites with new sewer main and lateral connections. Pavement Repairs. Camp Ground – Exotic Vegetation Removal and Replacement Landscaping – over 60 acres. Lift Station Renovations
Brian Piccolo Park	Vista View Park	
Irrigation System Replacement Street Light Replacement Cricket Shelter Roof Renovations	New Parking lots over Existing Landfill New Walkways	

Broward County Parks and Recreation – A/E Miscellaneous Services – County Wide (2006 to 2012):

- Snake Warrior Island – Nature Center and Pavilion
- Deerfield Island Park – Permitting for new boat docks and sea wall in the Intracoastal waterway
- Roosevelt Gardens Park – Community Center, Playground, Landscaping and Irrigation
- Miramar Pinelands Natural Area - Nature Center, Pavilion, Restroom, Gatehouse, and Playground
- Hollywood North Beach Park – Carpenter House – Historical Restoration of (3) structures on the beach
- Anne Kolb Nature Center - Roof Evaluation after Hurricane Wilma
- Hollywood North Beach Park – Loggerhead Restroom Evaluation after Hurricane Wilma
- Various Restrooms – 5 new restrooms in Markham, Sunview, and Tradewinds Park
- CB Smith Park - Marina Building – Repair damage from Hurricane Wilma
- Anne Kolb Re-roofing – Replace roof over (5) structures, over 60,000 sf of metal roofing.
- Delevoe Park – New Fire Alarm
- Miscellaneous Electrical Design -Various Parks: Fern Forest, Markham, Tradewinds, Vista View, Sunview
- Tradewinds Park Electrical Study – Review FPL transformer loading at
- Miscellaneous Civil Engineering – CB Smith, Markham, Tradewinds, TY Park
- TY Park Slavin Bldg - Electrical Design with new building service and lighting
- Fern Forest Park - Structural Evaluation
- VGBA Pool Renovations - CB Smith, Markham, Central Broward, TY Park
- Markham Park - New Playground
- Lafayette Hart Park - New Playground
- Easterlin Park – New Administration Building
- Tradewinds Park – New Administration Building
- Deerfield Island Park - Fire Line service design to new boat docks
- Quiet Waters Park – Elec. Distribution Centers
- Helwig Natural Area - Parking lot, Playground, Landscaping and Irrigation
- TY Park - Aquatic Playground Replacement
- Markham Park – New Maintenance Building
- Markham Park - (8) ADA Restrooms Renovations
- Hollywood North Beach Park – Shelter & Restroom
- Brian Piccolo Park – (5) ADA Restrooms Renovations
- Long Key Natural Area – 40 Acre Wetland Mitigation
- CB Smith Park - Flume Slide

City of Coconut Creek – A/E Miscellaneous Services – County Wide (1999 to 2012):

- Recreation Center Addition – 7,500sf Fitness Center
- Hosford Park Maintenance Building
- Police Department – Roof Evaluation after Hurricane Wilma
- Police Department – Roof Enclosures
- Police Department – 911 Dispatch Renovations
- Police Department – 911 Office Renovations
- Fire Department – Station 50 and 94 – Wind Hardening Study for FEMA Grant
- Fire Department – Station 50 and 94 – Wind Hardening Construction Documents
- Public Works Department – Administration Building - Wind Hardening Study for FEMA Grant
- Public Works Department – Administration Building - Wind Hardening Construction Documents
- Public Works Department – Fleet Building - Wind Hardening Study for FEMA Grant
- Public Works Department – Fleet Building - Wind Hardening Construction Documents
- Public Works Department – New Administration Building - Construction Documents

City of Coral Springs – A/E Miscellaneous Services – County Wide (1999 to 2012):

- Mullins Park Teen Center
- Mullins Park Meeting Building
- Aquatic Center – Various Renovations and Additions
- Water Treatment Plant - Administration Building – Construction Documents for Wind Hardening
- Water Treatment Plant - Administration Building – Construction Documents for 2-story Addition
- Police Department – Ballistic Lobby Separation
- Police Department – Emergency Power Generator Replacement
- Police Department – Cooling Tower Replacement
- Police Department - Electrical Service Study
- Police Department - Interior Office Renovations
- Center For The Arts – Lighting Design for Outdoor Mural
- Center For The Arts – Dressing Room Renovations
- Historical Covered Bridge – Study and Renovation Documents
- Westside Maintenance Compound – Roof Replacement
- City Hall South – Mechanical Replacement
- City Hall North – Interior Office Renovations
- Tennis Center – Mechanical Replacement
- Tennis Center – Drainage Improvements
- Charter School – Electrical Service Study
- Many others between 1987 to 1998

We will work closely with City Commission, City staff, and others to develop and implement projects, as required. We can phase projects to allow continual use and occupancy for the City during the construction phase. WZA will develop a phasing plan with construction access, routing, and construction barriers to allow construction to proceed and allow simultaneous partial use. If staff relocation is required, WZA can provide plans and specifications for temporary office facilities for City staff as part of the bid documents.

WZA and our Consultants will provide the City of Fort Lauderdale with a unique blend of experience in architectural design, engineering, finance, project management, and construction administration. Through the coordination of dedicated professional consultants working under the direction of WZA staff, your projects will be developed carefully and skillfully from the planning process through implementation.

SCOPE OF WORK

TECHNICAL APPROACH AND METHODOLOGY

Task 1 – Existing Facilities Analysis

WZA and its Consultants will review the existing City facilities and functions to develop a baseline analysis of existing conditions.

Task 2 – Needs Assessment

WZA will meet with City Commission, City staff, and others to document current and future needs for the projects. WZA will distribute Questionnaire and Survey to obtain input from various stakeholders, as required. Small renovation projects may not require this, whereas larger project master planning studies may require extensive meetings and consultation.

As part of the Needs Assessment process, the WZA team will interview key City personnel to gather additional information, specific insight, and special needs.

Task 3 – Site Analysis

WZA and its Consultants will review the proposed project site for ingress, egress, parking, vehicular movement, security, access control, green space, existing trees, existing grading, any environmentally sensitive conditions, protected species habitat, utility services, etc.

WZA will send staff to measure existing buildings or project sites to review existing conditions and to prepare CAD as-builts.

If a current Site Survey is not available, WZA can hire a surveyor prepare a Site Survey on behalf of the owner. If a Geotechnical Report is not available, WZA can order a Geotechnical Report on behalf of the owner.

Task 4 – Programming

Based on the review of the existing condition, staff questionnaire and interviews, WZA team will prepare a space program. This program will define function and size of each space. In additional, relationships and adjacencies will be outlined. Equipment and finishes for each space will be listed. Specialized equipment and / or special finishes will be highlighted.

Small renovation projects may not require this step, whereas larger projects will require detailed programming studies and may require extensive meetings and consultation.

Task 5 – Masterplan Development

WZA will update the existing master plan to incorporate the proposed renovations and modifications, site ingress and egress, public and staff parking areas, vehicular movement, security and access control, disposition of existing trees, and proposed landscape areas, etc.

Task 6 – Sustainability

WZA will review the USGBC LEED design rating criteria with City staff and affirm the level LEED performance desired (Certified, Silver, Gold, or Platinum). WZA will review various options available to achieve the desired goal. Alternate systems and technologies will be discussed, including on-site power generation, energy efficient lighting, etc.

Task 7 – Schematic Designs

Based on the review of the existing condition, staff questionnaire and interviews, space program, LEED goals, and project budget, WZA will prepare schematic design drawings for the project. These drawings will provide a concept for the project.

Task 8 – Outline Specifications

WZA will prepare outline specifications for major materials and services to be provided as part of the project. The Outline specifications will set minimum quality standards

Task 9 – Design Development and Construction Documents

WZA will incorporate the Site Survey, Geotechnical Report, Site Masterplan Schematic Design Drawings, Outline Specification, and all supporting criteria to develop the Project Construction and Bid Documents.

WZA will submit the drawings and specification submittals to the City at 50% and 100% Construction Document levels for review and approval.

Task 10 – Project Cost Estimating

WZA will prepare a probable budget estimate for the project. Probable budget estimate will provide the City with a breakdown of costs for various items and budgetary allowances for hard and soft costs.

Task 12 – Permitting

WZA will submit for and obtain all necessary permits, including but not limited to Building Department, Broward County EPD, SFWMD, FDEP, etc. Depending on the scope of the project, FAA approvals may also be required.

Task 12 – Post Design Support

WZA will provide technical support to the City during the bid and award phase, during the bidder evaluation process, and after the successful contractor has been selected, and through the final completion of the project.

WZA will provide full construction administration services throughout the construction phase by attending regularly scheduled meetings, review on-site construction, coordinate with Owner's Fixtures, Furnishings, and Equipment suppliers and the Contractor.

COMMITMENT

WZA will meet with City staff and gather all necessary information to complete the tasks outlined under the Scope of Work section. WZA will work closely with City staff to ensure implementation of the project goals and successful final completion of the project.

METHODOLOGY

Here are some critical aspects of WZA's work methodology.

The first aspect is to develop and facilitate a framework to involve all stakeholders within a project team. The framework involves constant communication and cooperation between all parties. We provide the hub for all the spokes on the project team, include WZA staff, City staff, Engineering Consultants, Specialty Consultants, Owner's Vendors and Suppliers, Contractor and his Design Professionals, Building Officials and all other individuals involved in the project.

Second is to have rigorous Quality Assurance and Quality Control Standards for the firm and for the project.

Third is to hire and engage highly qualified individuals and field experts to perform the necessary tasks.

Fourth is to provide the resources and flexibility to the working individuals so they can provide the best results for the City and for the project.

CODES

WZA staff is very familiar with the current building codes. In fact, one of the firm Principal Architects, Abbas Zackria, recently served as the Chairman on the Broward County Board of Rules and Appeals, an agency responsible for certifying all building officials and inspectors, and hearing code appeals in Broward County.

PERMITTING

WZA is very familiar with the Permitting Process in Broward County in its various municipalities. We submit for and obtain all required regulatory agency approvals, including Building Department, Zoning Department, Engineering, Broward County Traffic Engineering, South Florida Water Management District, Broward County Water and Sewer, Broward County Surface Management, Broward County Tree Section, Broward County Elevator Section, Broward County Health Department, etc.

In addition, WZA has experience in obtaining specialty permits or approvals for various projects from the following agencies or regulatory bodies:

- **Development Review Committee**
- **Architectural Appearance Committee**
- **Community Appearance Board**
- **Planning and Zoning Board**
- **US Army Corps of Engineers**
- **Florida Inland Navigation District**
- **Florida Department of Environmental Protection**
- **Federal Aviation Administration**
- **Florida Historical Commission**
- **Local Historical Committee**
- **Broward County Historical Commission**

BUDGET

WZA produces construction cost estimates using our database of current construction costs for similar municipal facilities. WZA's cost estimates are very detailed and accurate.

Currently, this database includes projects publicly bid over the past 10 years. We have project that go out to bid almost on a monthly basis. As the latest prices come in, we update our database to stay current with the market conditions.

We supplement pricing knowledge by utilizing our strong relationships with local general contractors and subcontractors to verify project costs and to provide the owner with another level of cost and budget control prior to the project going to bid.

PROJECT SCHEDULE CONTROL, COST CONTROL, AND QUALITY CONTROL

Listed below is a brief summary, in an outline bullet format, that describes WZA's schedule control methods for the (1) Design Phase and (2) the Construction Phase of project development for a typical project.

1) Schedule Control During Design / Pre-Construction Phase

- Specific target dates for both completion dates and critical path dates are pre-determined by the City's project schedule or occupancy date.
- Hitting the necessary dates starts with coordination between WZA and City staff in which milestone dates and a completion date are set.
- We do a thorough walk through of the construction site, and review all as-built documents to minimize potential conflicts.
- The Design Team creates a CPM schedule with early start and finish dates for each design phase.
- Bi-weekly Design meetings are held to keep the project on track.
- Civil Engineering and Landscaping Construction Documents are completed early for long lead environmental permitting submittals while the other disciplines complete building systems coordination.
- Meetings are scheduled with the building department to review the project scope and expedite the permitting process.
- Architect and Engineers begin to address comments prior to the release of the entire package. In a "best case" scenario, within a day of when we receive the plans back from the plans reviewers their comments have already been addressed and the plans are immediately back into the building department for the final review.

2) Schedule Control During Construction Phase

- Once the permit is issued, the construction CPM schedule is revised to track all critical tasks and advanced as necessary to ensure early project completion.
- Weekly Construction meetings are held to keep the project on track.
- The Schedule of Values supplements the monitoring of the schedule each month by raising red flags as indicated by the percentage of completion billings on the Schedule.
- The weekly meetings and the monthly billing review give the team represented by the Contractor, the Owner, and the Architect time to identify and address issues that could negatively impact the Team's ability to complete the job on time and on budget.
- The WZA actively participates in the creation, enforcement and modification (when necessary) of the project schedule while maintaining milestone dates.

Listed below is a brief summary, in an outline bullet format, that describes WZA's cost control methods for the (1) Design Phase and (2) the Construction Phase of project development for a typical project.

1) Cost Control During Design Phase

- WZA produces pre-construction budgets using our database of current construction costs for similar municipal facilities
- Currently, this database includes projects bid out in the past 10 years. We have project that go out to bid almost on a monthly basis. As the latest prices come in, we update our database to stay current with the market conditions.
- We supplement square foot pricing by meeting one on one with players to clearly establish scope of work, brainstorm on potential issues, and emphasize our client's expectations for this project.
- We perform thorough walk through of the construction site, and review all as-built documents to minimize potential conflicts.
- We evaluate the overall project and adjust the construction programming to gain efficiencies and save expenses.
- We work closely with the Design Team to reduce overall project cost.
- We coordinate phased construction to meet City's Annual or Project budget and timeline requirements.
- We provide Deduct Alternate Bid Items in the Construction Documents maintain cost control.
- WZA provides Value Engineering services to extend the client's budget.
- WZA provides concise detailing to reduce cost and construction time.

2) Cost Control During Construction Phase

- Since most projects are hard bid, the project cost is known at the start of construction.
- WZA produces a superior set of construction documents that ensure the owner gets what is specified and so there are no change orders to increase the project bid cost.

Listed below is a brief summary, in an outline bullet format, that describes WZA's quality control methods for the (1) Design Phase and (2) the Construction Phase of project development for a typical project.

1) Quality Control During Design / Pre-Construction Phase

- WZA's Project Manager and the company's principals work closely with the Design Team to ensure that the Construction Documents meet the City's intended project scope.
- We do an early thorough walk through of the the construction site, and review all as-built documents to minimize potential conflicts and unnecessary costs for field modifications.
- Construction Documents are reviewed by the entire team at 30%, 60%, 90%, and at 100% stages.
- WZA's 28 years of public bid construction projects had resulted in a quality control program that is second to none. Not only are the firm principals directly involved in the design and the construction document generation, they also review the sets with a keen eye for potential conflicts.
- WZA uses an AIA Document Checklist to ensure each project meets the highest quality standards.

- A full set of specifications, based on the Construction Specifications Institute format, is generated for the project. All products, techniques, materials, warranties, and basis of quality are defined.
- As a testament to our standards, WZA has Zero Errors and Omissions Insurance Claims in 28 years.

2) Quality Control During Construction Phase

Specific responsibilities include:

- The quality of the finished product we achieve together starts with comprehensive, high quality Construction Documents. This component is assured by WZA and the strong team of Consultants.
- The construction team, specifically the CM, PM, and Superintendent ensure that the proper level of Quality Control of all subcontracted and self-performed work is maintained. They coordinate the performance of all required inspections and testing, and have the authority to stop all work when it is determined to either be unsafe, defective or not to the proper standards of quality.
- The design team and the construction team have direct responsibility to review all shop drawings and specification submittals to ensure compliance with design drawings. Accurate and timely delivery and review of these documents is mandatory to ensure on time supply of the required materials and equipment necessary for success of the project.
- Quality Control is the responsibility of everyone on this Team, collectively and individually.
- WZA pursues a quality job through its long-term relationships with proven contractors that have for years or even decades shown qualities of both character and craftsmanship. These contractors have proven job after job that the client's expectations and needs come first.
- WZA looks at not just on price but on many factors including the life cycle of products being considered, and emphasis on quality.
- Though out the job, quality is stressed daily and in weekly jobsite meetings. An ultimate goal of the Team is "quality is job #1".

CURRENT WORKLOAD

Please see current workload chart included in this submittal. Essentially, most of the major project we are working on are near final completion or have recently been completed. We have smaller miscellaneous services contracts which provide constant source of work from various municipalities. We have the staff ready, available, and capable to provide the necessary services for this project.

MAJOR PROJECTS	CURRENT STATUS	WORK TO BE PERFORMED
City of Miramar Police Headquarters Design / Build Criteria Package	Bidding	Construction Administration To be completed 8/2015
City of Pompano Beach Misc. Services Contract – 2011 Highlands Park Restroom	Construction	Construction Administration To be completed 2/2014
Broward County Aviation Division Maintenance Building	Construction	Construction Administration To be completed 9/2014
City of Sunrise Miscellaneous Services 2010 contract Public Works Compound Demolition	Construction	Construction Administration
City of Coral Springs Water Plant Administration Bldg Renovation	Construction	Construction Administration To be completed 9/2014
Broward County Parks and Recreation - Miscellaneous Services 2005 contract	Firm has completed 95% of a Five -year contract. 41 Work Authorizations	Multiple Projects are in Construction Phase. Projects completed in 2014.
Broward County Parks and Recreation - Miscellaneous Services 2011 contract	Firm has completed 80% of a New Five -year contract. 20 Work Authorizations	Multiple Projects are in Design, Permitting, and Construction Phases
City of Boca Raton Miscellaneous Services 2012 contract Red Reef Park	On-Hold	Bid Permitting Construction Administration

REFERENCES

7

LONG KEY NATURE CENTER



Location:
Davie, FL

Owner:
Broward County

Owner's Representative:
Shobhan Smart
Project Manager
954-577-4624



Services Provided:

- Design/Build
- Full Architectural/Engineering
- Interior Design
- Agency Approvals
- LEED Design Components

18,000 SQ. FT. ASSEMBLY AND EXHIBIT HALL

- Classrooms
- Nature Walk
- Banquet Facility
- Parking
- New Wetlands
- Boardwalk
- Maintenance Building
- Site Lighting

COCONUT CREEK PUBLIC WORKS BUILDING



Location:
Coconut Creek, FL

Owner:
City of Coconut Creek

Owner's Representative:
Jim Berkman
Director of Public Works
954-956-1415

Services:

- Architectural/Engineering
- Programming
- Cost Estimating
- Permitting
- Construction Administration
- LEED Design Components



25,000 SQ. FT. PUBLIC WORKS BUILDING

- 25,000 S.F. of enclosed space on two stories;
- South-facing 'Greenscreen' landscape element doubles as a sunscreen;
- North-facing expanse of glazing allows daylight in and ample views out for the staff office areas;
- Redundant mechanical systems utilized for critical operations;
- IT Server room and 911 Dispatch Center with raised floor access flooring;
- EOC Center with state-of-the-art communication and technology systems
- Green building design LEED "Certification"

OWNER'S REPRESENTATIVE – DISTRICT 5 RENOVATION AND REPAIR SERVICES



Location:
Broward County, Florida

Owner:
Broward County Parks

Owner's Representative:
Shobhan Smart
954-577-4624



Services:

- Remodeling
- Renovation
- Building Addition
- Historical Preservation

- CB Smith Park - Bridges
- CB Smith Park - Meeting Cabin
- Brian Piccolo Park - Track Repair
- Brian Piccolo Park - Irrigation Repair
- CB Smith Park - Pathway Repair
- Brian Piccolo Park - Street Light
- CB Smith Park - Lift Station Repair
- Vista View Park - Parking Lot/Curbing
- Long Key - Parking/Walkway Repair
- Markham Park – Roofs
- CB Smith Park - Fence Replace
- CB Smith Park - Plant Removal
- Pavilion Re-roofing
- Long Key - CA/Eng/Permit
- CB Smith - Bridge Permit/CA
- Markham Restrooms
- Baez Residence
- CB Smith Pavilion Re-Roof RE BID
- Markham Park - Pavilion Re-Roof RE BID
- Markham Park - Dog Park
- Long Key Natural Area - Utility and Landscape Coord. With Regulatory Agencies
- Markham Park - Campground "G" Renovation
- Markham Park – Bicycle Pathway
- Markham Park – New East Restroom Building
- Markham Park – Campground Landscape and Lift Station Renovations
- Brian Piccolo Park - Cricket Shelter Roof Renovations
- CB Smith Park – Entrance Roadway Improvements
- Markham Park Campsite Civil and Landscape Inspections
- Deerfield Island Boat Docks



- CB Smith Park - New Parking Lot at Administration Building and Public Access ADA Walkways
- Various Parks Restrooms
- Snake Warriors Island - Office/Restroom
- Deerfield Island Boat Docks
- Snake Warriors Island - Office/Restroom
- Roosevelt Gardens
- Miramar Pinelands Natural Area
- Hollywood North Beach Park Carpenter House
- Deerfield Island Water & Soil test
- Anne Kolb Nature Center Roof Study
- Hollywood N. Beach Pk- Loggerhead Rest Room Evaluation
- CB Smith Park Marina Bldg Repairs
- Roosevelt Gardens Pk - A/E Services
- Hollywood North Beach Pk Carpenter House
- Hollywood North Beach Pk Loggerhead Restroom Building Construction
- Anne Kolb Nat. Center - Roofing/Gutters/Downspouts Maint/Repair

HISTORICAL RENOVATIONS

- Davie – Baez House
- Hollywood – Carpenter House
- Ft. Lauderdale - Sterling House





Location:
 Broward County
 Ft. Lauderdale-Hollywood
 International Airport

Owner:
 Broward County Aviation
 Department

Owner's Representative:
 Staci Montefusco,
 Project Manager III
 954-359-6149

Services:

- Architectural/Engineering
- Programming
- Validation Reporting
- Cost Estimating
- Permitting
- Construction Administration
- LEED Design Components



66,193 SQ. FT. BCAD NEW MAINTENANCE BUILDING

Program:	• Maintenance Shop Facilities	33,445 sf
	• Maintenance Operation Office	10,330 sf
	• Common Use Area	6,515 sf
	• Inventory Management	5,385 sf
	• Building Support	4,500 sf
	• Future Growth	6,018 sf
	• TOTAL BUILDING AREA:	66,193 sf

Site:	• Exterior Use Areas	81,000 sf
	• Parking Areas	70,000 sf
	• Fuel Station	1,500 sf
	• Mechanical / Electrical Yards	2,500 sf
	• Landscape Area	20,000 sf

- Enhance overall BCAD Maintenance Department operations including an environment that enhances communications, increases productivity, lowers costs, and improves resource management.
- Create a facility to resist hurricanes to current code standards, which is capable of remaining operational during such emergencies.
- Create a greenbuilding that is LEED Silver certified.

MINORITY/WOMEN (M/WBE) PARTICIPATION

8

MINORITY/WOMEN (M/WBE) PARTICIPATION

Walters Zackria Associates is CBE certified with Broward County Office of Economic and Small Business Development, MBE certified with School Board of Broward County and/or Broward Health Office of Supplier Diversity and Outreach Program. Our sub-consultants have a diversity of minority business certificates shown below.

WZA will put forth all efforts in meeting and exceeding City of Ft. Lauderdale M/WBE Goals.

Prime Consultant:

**Architectural and
Structural Engineering:**

Walters Zackria Associates, PLLC
Abbas H. Zackria, President
Robert S. Walters, Vice President
Anthony M. Scala, P.E., Structural Eng.
620 SE 1st Street
Ft. Lauderdale, FL 33301
954-522-4123 Fax: 954-522-4128

CBE, MBE

Sub-Consultants:
**Mechanical/Electrical/
Plumbing Engineering
And Fire Protection:**

Delta G. Consulting Engineers, Inc.
George San Juan, P.E.
707 NE 3rd Ave., Suite 200
Ft. Lauderdale, FL 33304
954-527-1112 Fax: 954-524-7505

DBE, CBE

Civil Engineering:

Abaco Engineering, Inc.
Azita Behmardi, P.E.
5997 NW 73rd Ct.
Parkland, FL 33067
954-599-3726 Fax: 954-692-9033

MBE, CBE, DBE

Landscape:

TBG Partners
Paul Weinberg, RLA
200 SW 1st Avenue, Suite 103
Ft. Lauderdale, FL 33301
954-713-1000

Geotechnical Engineering: Nutting Engineers of Florida, Inc

Richard C. Wohlfarth, PE
1310 Neptune Drive
Boynton Beach, FL 33426
561-736-4900 Fax: 561-737-9975

SBE

Surveyor and Mapping:

AWN Design & Consulting Group, Inc.
Steve Watts
227 Goolsby Boulevard
Deerfield Beach, Florida 33442
954-481-8682 Fax: 954-725-3342

CBE

Minority Business Certificates

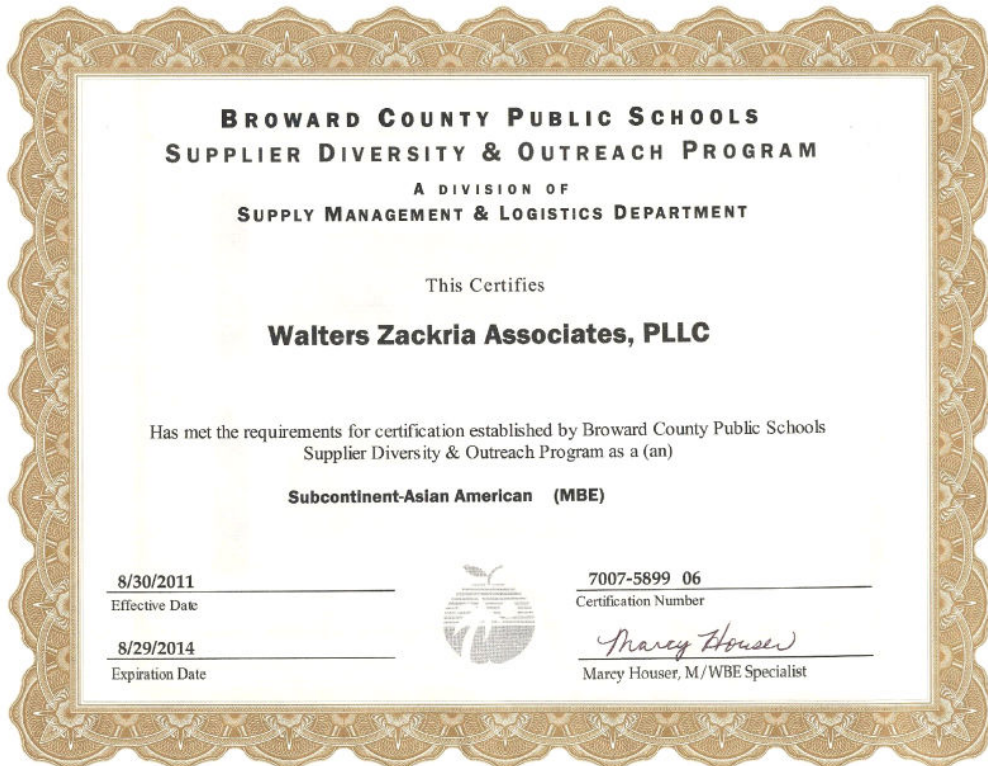



State of Florida
*Minority, Women &
Service-Disabled Veteran*
Business Certification

ABACO Engineering, Inc.

Is certified under the provisions of
287 and 295.187, Florida Statutes for a period from:

10/16/2013 to 10/16/2015

John P Miles, Secretary

Florida Department of Management Services
Office of Supplier Diversity



Office of Economic and Small Business Development

Governmental Center Annex
115 S. Andrews Avenue, Room A680 • Fort Lauderdale, Florida 33301 • 954-357-6400 • FAX 954-357-5674 • TTY 954-357-5664

This Certificate is Awarded to:

ABACO ENGINEERING, INC.

As set forth in the Broward County Business Opportunity Act of 2012, the certification requirements have been met for:

**County Business Enterprise
Small Business Enterprise
Anniversary Date: February 4th**

A handwritten signature in black ink, appearing to read "Chris Johnson", is written over a horizontal line.

Authorized Representative

The Office of Economic and Small Business Development must be notified within 30 days of any material changes in the business which may affect ownership and control. Failure to do so may result in the revocation of this certificate and/or imposition of other sanctions.

A service of the Broward County Board of County Commissioners
www.broward.org/smallbusiness



Disadvantaged Business Enterprise Certificate of Eligibility

Granted to

ABACO ENGINEERING INC

It has been determined that the firm listed above has met the federal requirements in accordance with the Code of Federal Regulations (49 CFR Part 26) and is thereby eligible to participate in the Disadvantaged Business Enterprise Program in the State of Florida.

NAICS CODES:

541330 541990 541620

Issue Date: August 9, 2013



VICTORIA V. SMITH

*Disadvantaged Business Enterprise Certification Manager
Florida Department of Transportation*



OFFICE OF ECONOMIC AND SMALL BUSINESS DEVELOPMENT

Governmental Center Annex
115 S. Andrews Avenue, Room A680 • Fort Lauderdale, Florida 33301
954-357-6400 • FAX 954-357-5674 • TTY 954-357-5664

May 22, 2013

Mr. George San Juan
DELTA G CONSULTING ENGINEERS, INC.
707 NE 3rd Avenue, #200
Fort Lauderdale, Florida 33304

ANNIVERSARY DATE – Annually, on June 14th

Dear Mr. San Juan

Broward County is pleased to announce that **Delta G Consulting Engineers, Inc.** has renewed its certification as a **Disadvantaged Business Enterprise [DBE]** in Florida, under a **Unified Certification Program [UCP]** in accordance with 49 CFR, PART 26.

DBE certification continues from your anniversary date, but is contingent upon Delta G Consulting Engineers, Inc. renewing its eligibility annually through this office, Office of Economic and Small Business Development (OESBD). OESBD will notify you in advance of your obligation to provide continuing eligibility documents; however, to assure continued certification is your responsibility. Failure to continue your eligibility will result in immediate action to remove Delta G Consulting Engineers, Inc. as a DBE.

As long as Delta G Consulting Engineers, Inc. is listed in the DBE Directory, it is considered DBE Certified by all Florida UCP Members.

DBE Certification is subject to actions by governmental agencies impacting the disadvantaged status of Delta G Consulting Engineers, Inc.

Delta G Consulting Engineers, Inc. will be listed in Florida's **UCP DBE Directory** which can be accessed via the internet, at

<https://www3.dot.state.fl.us/EqualOpportunityOffice/BizNet/mainmenu.asp> or through FDOT's website at www.dot.state.fl.us/equalopportunityoffice and by "clicking" on "BizNet DBE UCP Directory" in the center of the page.

Re: Delta G Consulting Engineers, Inc.

May 22, 2013

DBE certification is **NOT** a guarantee of work, but enables Delta G Consulting Engineers, Inc. to compete for, and perform, contract work on all USDOT Federal Aid (FAA, FTA and FHWA) projects in Florida as a DBE contractor, sub-contractor, consultant, and sub-consultant or material supplier.

If, at any time, there is a material change in Delta G Consulting Engineers, Inc., including, but not limited to, ownership, officers, directors, scope of work being performed, daily operations, affiliations with other businesses or individuals or physical location of Delta G Consulting Engineers, Inc., you must notify OESBD, in writing, without delay. Notification should include supporting documentation. You will receive acknowledgement and confirmation of continued eligibility, if applicable after notification of changes.

Delta G Consulting Engineers, Inc. may compete for, and perform, work on all USDOT Federal Aid projects throughout Florida, receiving DBE credit for work performed in the following area:

NAICS: 541330 Engineering Services

Please feel free to contact OESBD for any questions or concerns pertaining to your DBE certification. Our telephone number is (954) 357-6400; our fax number is (954) 357-5674.

Sincerely,



Chris Atkinson, Assistant Director
Office of Economic and Small Business Development



Office of Economic and
Small Business Development

Governmental Center Annex
115 S. Andrews Avenue, Room A680 • Fort Lauderdale, Florida 33301 • 954-357-6400 • FAX 954-357-6010 • TTY 954-357-5664

This Certificate is Awarded to:

DELTA G CONSULTING ENGINEERS, INC.

As set forth in the Broward County Business Opportunity Act of 2012, the certification requirements have been met for:

County Business Enterprise

Anniversary Date: February 15th

A handwritten signature in black ink that reads "Chris Anderson".

Small Business Development Manager

The Office of Economic and Small Business Development must be notified within 30 days of any material changes in the business which may affect ownership and control. Failure to do so may result in the revocation of this certificate and/or imposition of other sanctions.

A service of the Broward County Board of County Commissioners
www.broward.org/smallbusiness

503



miamidade.gov

Sustainability, Planning and Economic Enhancement Department

111 NW 1 Street, 19th Floor
Miami, Florida 33128
T 305-375-3111 F 305-375-3160

April 9, 2012

Mr. Richard Iossi
NUTTING ENGINEERS OF FLORIDA INC
1310 Neptune Dr
Boynton Beach, FL 33426

CERT. NO: 14476
Approval Date: 04/30/2012 - CBE Tier 2
Expiration Date: 04/30/2015

ANNUAL ANNIVERSARY: 04/30/2013

Dear Mr. Iossi:

Small Business Development (SBD), a division of Sustainability, Planning and Economic Enhancement Department (SPEED) has completed the review of your application and attachments submitted for certification. Your firm is officially certified as a Community Business Enterprise (CBE) in accordance with section 2-10.4.01 of the Code of Miami Dade County.

This certification is valid for three years provided there are no changes rendering your firm ineligible for certification. You are required to submit a "Continuing Eligibility Affidavit" annually with specific supporting documents on or before your Anniversary Date as listed above. You will be notified in advance of your firm's Anniversary Date. Failure to comply with the said responsibilities may result in immediate action to decertify your firm. Every three years you will receive a full recertification review that may include an onsite investigation; SBD will also notify you accordingly.

If at any time during the certification period, there is a material change in your firm, including, but not limited to ownership, officers, Director, scope of work being performed, daily operations, affiliations with other business (es) or physical location of the firm, you must notify this office in writing within (30) days. Notification should include supporting documentation. You will receive timely instructions from this office as to how you should proceed, if necessary.

Your company is certified in the following categories as listed below, affording you the opportunity to bid and participate on contracts with small business measures. Please note that the categories listed are very general and are used only to assist our customers in searching the directory for certified firms to meet contract needs. The directory for all certified firms can be accessed on the Miami-Dade County SPEED website http://www.miamidade.gov/sba .

Thank you for doing business with Miami Dade County.

Sincerely,

[Handwritten signature of Sher McGriff]

Sher McGriff, Director
Business Opportunity Support Services
Small Business Development Division
Sustainability, Planning and Economic Enhancement Department

CATEGORIES: (Your firm may bid or participate on contracts only under these categories)

- DRILLING SUBSURFACE INVESTIGATIONS & SEISMOGRAPHIC (CBE)
GEOTECHNICAL & MATERIALS ENGINEERING SERVICES (CBE)
CONCRETE AND ASPHALT TESTING SERVICES (CBE)
ENVIRONMENTAL ENG-CONTAMINATION ASSESS & MONITOR (CBE)
ENGINEERING SERVICES (CBE)

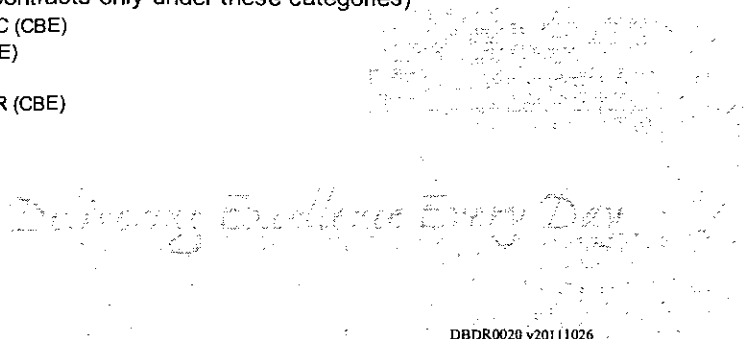

DBDR0020 v20111026

**Palm Beach County
Office of Small Business Assistance**

Certifies That

Nutting Engineers of Florida, Inc.

VENDOR # **NUTT0001**

is a Small Business Enterprise as prescribed by section 2-80.21 – 2-80.35 of the Palm Beach County Code for a three year period from September 30, 2011 to September 29, 2014.

The following Services and/or Products are covered under this certification:

**Engineering Services, Professional
Environmental Consulting Services
Geotechnical Engineering
Inspecting, Structural/Engineering
Quality Control Testing Services for Construction**

Palm Beach County Board of County Commissioners

Karen T. Marcus, Chair
Shelley Vana, Vice Chair
Paulette Burdick
Steven L. Abrams
Burt Aaronson
Jess R. Santamaria
Priscilla A. Taylor

County Administrator

Robert Weisman
Deputy County Administrator

Verdenia C. Baker

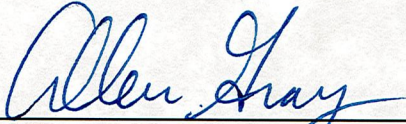
Allen Gray, Manager

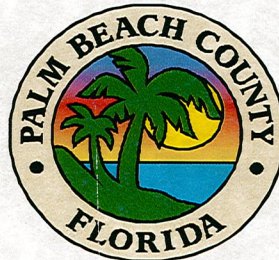

09/30/2011

WILLIS HOLCOMBE CENTER
111 East Las Olas Blvd.
Fort Lauderdale, FL 33301

OFFICE OF SUPPLIER RELATIONS AND DIVERSITY

INSTITUTE FOR
ECONOMIC DEVELOPMENT
111 East Las Olas Blvd.
Fort Lauderdale, FL 33301

March 22, 2012

A. HUGH ADAMS
CENTRAL CAMPUS
3501 S.W. Davie Road
Davie, FL 33314

Richard Iossi
Nutting Engineers of Florida, Inc.
1310 Neptune Drive
Boynton Beach, FL 33426

NORTH CAMPUS
1000 Coconut Creek Blvd.
Coconut Creek, FL 33066

Dear Richard Iossi:

JUDSON A. SAMUELS
SOUTH CAMPUS
7200 Hollywood/Pines Blvd.
Pembroke Pines, FL 33024

Congratulations! The Broward College Office of Supplier Relations and Diversity is pleased to announce that your firm is eligible to participate in the Small Disadvantaged Business Program (SDB).

PINES CENTER
16957 Sheridan St.
Pembroke Pines, FL 33331

The documentation received from one of our certification agents has been verified in accordance with Broward College's SDB Program requirements. The validation process documents your firm as a certified vendor.

WESTON CENTER
4205 Bonaventure Blvd.
Weston, FL 33332

Your firm's eligibility status as a certified vendor is valid through September 29, 2014.

MIRAMAR AUTOMOTIVE/
MARINE CENTER
7451 Riviera Blvd.
Miramar, FL 33023

Broward College provides access to supplier resources and procurement opportunities on line at www.broward.edu/procurement. This link also gives you access to the Certified Vendor Directory and the Seahawk Sourcing System for supplier management and registration.

MIRAMAR TOWN CENTER
2050 Civic Center Place
Miramar, FL 33025

During the certification period, you are required to provide current contact information for your firm with the Office of Supplier Relations and Diversity. Report any changes in your firm's ownership and managerial or operational control to your company's certifying agency.

TIGERTAIL LAKE
RECREATIONAL CENTER
580 Gulfstream Way
Dania Beach, FL 33004

Should you have questions, you may contact the Office of Supplier Relations and Diversity by telephone at (954) 201-7898 or email SDC@broward.edu.

Sincerely,



Shirley Gainey
Director, Supplier Diversity



SOUTH FLORIDA WATER MANAGEMENT DISTRICT

REGISTERED VENDOR NO.: 101910

October 24, 2011

CERTIFICATION EXPIRATION DATE
October 24, 2014

Mr. Richard G. Iossi
President
Nutting Engineers of Florida Inc
1310 Neptune Drive
Boynton Beach, Florida 33426

Dear Mr. Iossi:

Congratulations, the South Florida Water Management District (District) has certified your firm as a Small Business Enterprise (SBE). This certification is valid for three (3) years and may only be applied when business is conducted in the following area(s):

Professional Engineering Services

Your submittal of bids or proposals to supply other products or services outside of the specialty area(s) noted above will not count toward SBE participation. If you require certification in other specialty areas, please contact the Procurement Bureau, SBE Section, for additional information.

Renewal is required every three (3) years and should be requested a minimum of 45 days prior to the above expiration date.

If any changes occur within your company during the certification period such as ownership, affiliate company status, address, telephone number, licensing status, gross revenue, or any information that relates to your SBE Certification status, you must notify this office in writing immediately. It is imperative that we maintain current information on your company at all times. **FAILURE TO REPORT CHANGES MAY RESULT IN DECERTIFICATION.**

Certification is not a guarantee that your firm will receive work, nor an assurance that your firm will remain in the District's vendor database.

We look forward to a mutually beneficial working relationship.

Sincerely,

A handwritten signature in cursive script that reads "Colleen M. Robbs".

Colleen M. Robbs
Sr. Compliance Specialist
Procurement Bureau

/cr



Office of Economic and
Small Business Development

Governmental Center Annex
115 S. Andrews Avenue, Room A680 • Fort Lauderdale, Florida 33301 • 954-357-6400 • FAX 954-357-6010 • TTY 954-357-5664

This Certificate is Awarded to:

AWN DESIGN CONSULTING GROUP, INC.

As set forth in the Business Opportunity Act of 2004
and/or the County Business Enterprise Act of 2009, the
certification requirements have been met for:

**County Business Enterprise
Small Business Enterprise**

BC – CBE/SBE – Certificate Expires: 11/2/2013

Small Business Development Manager

The Office of Economic and Small Business Development must be notified within 30 days of any material changes in the business which may affect ownership and control.
Failure to do so may result in the revocation of this certificate and/or imposition of other sanctions.

A service of the Broward County Board of County Commissioners
www.broward.org/smallbusiness

Renewed Certificate – in process

LOCAL BUSINESS PREFERENCE

9

LOCAL BUSINESS PREFERENCE CERTIFICATION STATEMENT

The Business identified below certifies that it qualifies for the local BUSINESS preference classification as indicated herein, and further certifies and agrees that it will re-affirm it's local preference classification annually no later than thirty (30) calendar days prior to the anniversary of the date of a contract awarded pursuant to this ITB. Violation of the foregoing provision may result in contract termination.

(1) _____ is a Class A Business as defined in City of Fort Lauderdale Ordinance No. C-12-04, Sec.2-199.2. A copy of the City of Fort Lauderdale current year Business Tax Receipt and a complete list of full-time employees and their addresses shall be provided within 10 calendar days of a formal request by the City.
Business Name

(2) WALTERS ZACKRIA ASSOCIATES, PLLC is a Class B Business as defined in the City of Fort Lauderdale Ordinance No. C-12-04, Sec.2-199.2. A copy of the Business Tax Receipt or a complete list of full-time employees and their addresses shall be provided within 10 calendar days of a formal request by the City.
Business Name

(3) _____ is a Class C Business as defined in the City of Fort Lauderdale Ordinance No. C-12-04, Sec.2-199.2. A copy of the Broward County Business Tax Receipt shall be provided within 10 calendar days of a formal request by the City.
Business Name

(4) _____ requests a Conditional Class A classification as defined in the City of Fort Lauderdale Ordinance No. C-12-04, Sec.2-199.2. Written certification of intent shall be provided within 10 calendar days of a formal request by the City.
Business Name

(5) _____ requests a Conditional Class B classification as defined in the City of Fort Lauderdale Ordinance No. C-12-04, Sec.2-199.2. Written certification of intent shall be provided within 10 calendar days of a formal request by the City.
Business Name

(6) _____ is considered a Class D Business as defined in the City of Fort Lauderdale Ordinance No. C-12-04, Sec.2-199.2. and does not qualify for Local Preference consideration.
Business Name

BIDDER'S COMPANY: _____ WALTERS ZACKRIA ASSOCIATES, PLLC

AUTHORIZED COMPANY PERSON: _____ ROBERT S. WALTERS, AIA / VICE PRESIDENT

NAME: _____ ROBERT S. WALTERS

SIGNATURE: _____



CITY OF
FORT LAUDERDALE BUSINESS TAX YEAR 2013-2014

Venice of America

BUSINESS TAX DIVISION
700 NW 19 AVENUE, FORT LAUDERDALE, FLORIDA 33311
(954)828-5195

Business ID: 238089 Business Name: WALTERS, ROBERT S REV TR
Business Address: 620 SE 1 ST
Tax Category: ARCHITECT Tax#: 238089 Fee:
(EACH LICENSED INDIVIDUALLY)

WALTERS, ROBERT S REV TR
ROBERT S WALTERS AIA
620 SE 1 ST
FORT LAUDERDALE, FL 33301

DETACH AND POST THIS RECEIPT IN A CONSPICUOUS PLACE

Business ID: 238089
Tax Number: 238089
Business Name: WALTERS, ROBERT S REV TR
Business Address: 620 SE 1 ST
Business Owner: WALTERS, ROBERT S REV TR

- This Receipt is issued for the period commencing October 1st and ending September 30th of the years shown above.
- If you have moved out of the city, please provide a written statement.
- A transfer of business location within the city limits is subject to zoning approval. Please complete a Business Tax Transfer Application and bring it to our office to obtain the necessary approval.
- A Transfer fee applies of 10% of the annual business tax fee. The fee shall not be less than \$3.00, nor greater than \$25.00.
- If you have sold your business, please provide us with a copy of the Bill of Sale.

Please be advised that this issuance of a Business Tax Receipt establishes that the business you intend to conduct is a use permitted by the City Zoning Code for the location at which you intend to operate. The issuance of a Business Tax Receipt in no way certifies that the property located at this address is in compliance with other provisions of the City Code of Ordinances.

BUSINESS TAX DIVISION
700 NW 19 AVENUE, FORT LAUDERDALE, FLORIDA 33311
TEL (954)828-5195 FAX (954)828-6929
WWW.FORTLAUDERDALE.GOV

SAMPLE INSURANCE CERTIFICATES

10

Client#: 7724

WALTZAC3

ACORD™

CERTIFICATE OF LIABILITY INSURANCE

DATE (MM/DD/YYYY)

06/12/2013

THIS CERTIFICATE IS ISSUED AS A MATTER OF INFORMATION ONLY AND CONFERS NO RIGHTS UPON THE CERTIFICATE HOLDER. THIS CERTIFICATE DOES NOT AFFIRMATIVELY OR NEGATIVELY AMEND, EXTEND OR ALTER THE COVERAGE AFFORDED BY THE POLICIES BELOW. THIS CERTIFICATE OF INSURANCE DOES NOT CONSTITUTE A CONTRACT BETWEEN THE ISSUING INSURER(S), AUTHORIZED REPRESENTATIVE OR PRODUCER, AND THE CERTIFICATE HOLDER.

IMPORTANT: If the certificate holder is an ADDITIONAL INSURED, the policy(ies) must be endorsed. If SUBROGATION IS WAIVED, subject to the terms and conditions of the policy, certain policies may require an endorsement. A statement on this certificate does not confer rights to the certificate holder in lieu of such endorsement(s).

PRODUCER SunCoast Insurance, div of USI 1715 N. Westshore Blvd. #700 Tampa, FL 33607 813 321-7500	CONTACT NAME: PHONE (A/C, No, Ext): 813 321-7500 FAX (A/C, No): 813 321-7525	
	E-MAIL ADDRESS: PRODUCER CUSTOMER ID #:	
INSURED Walters Zackria Associates, PLLC 620 S.E. 1st Street Fort Lauderdale, FL 33301	INSURER(S) AFFORDING COVERAGE NAIC #	
	INSURER A : Hudson Insurance Company 25054	
	INSURER B :	
	INSURER C :	
	INSURER D :	
	INSURER E :	

COVERAGES **CERTIFICATE NUMBER:** **REVISION NUMBER:**

THIS IS TO CERTIFY THAT THE POLICIES OF INSURANCE LISTED BELOW HAVE BEEN ISSUED TO THE INSURED NAMED ABOVE FOR THE POLICY PERIOD INDICATED. NOTWITHSTANDING ANY REQUIREMENT, TERM OR CONDITION OF ANY CONTRACT OR OTHER DOCUMENT WITH RESPECT TO WHICH THIS CERTIFICATE MAY BE ISSUED OR MAY PERTAIN, THE INSURANCE AFFORDED BY THE POLICIES DESCRIBED HEREIN IS SUBJECT TO ALL THE TERMS, EXCLUSIONS AND CONDITIONS OF SUCH POLICIES. LIMITS SHOWN MAY HAVE BEEN REDUCED BY PAID CLAIMS.

INSR LTR	TYPE OF INSURANCE	ADDL INSR	SUBR WVD	POLICY NUMBER	POLICY EFF (MM/DD/YYYY)	POLICY EXP (MM/DD/YYYY)	LIMITS
	GENERAL LIABILITY <input type="checkbox"/> COMMERCIAL GENERAL LIABILITY <input type="checkbox"/> CLAIMS-MADE <input type="checkbox"/> OCCUR GEN'L AGGREGATE LIMIT APPLIES PER: <input type="checkbox"/> POLICY <input type="checkbox"/> PRO-JECT <input type="checkbox"/> LOC						EACH OCCURRENCE \$ DAMAGE TO RENTED PREMISES (Ea occurrence) \$ MED EXP (Any one person) \$ PERSONAL & ADV INJURY \$ GENERAL AGGREGATE \$ PRODUCTS - COMP/OP AGG \$
	AUTOMOBILE LIABILITY <input type="checkbox"/> ANY AUTO <input type="checkbox"/> ALL OWNED AUTOS <input type="checkbox"/> SCHEDULED AUTOS <input type="checkbox"/> HIRED AUTOS <input type="checkbox"/> NON-OWNED AUTOS						COMBINED SINGLE LIMIT (Ea accident) \$ BODILY INJURY (Per person) \$ BODILY INJURY (Per accident) \$ PROPERTY DAMAGE (Per accident) \$ \$ \$
	UMBRELLA LIAB <input type="checkbox"/> OCCUR EXCESS LIAB <input type="checkbox"/> CLAIMS-MADE DEDUCTIBLE RETENTION \$						EACH OCCURRENCE \$ AGGREGATE \$ \$ \$
	WORKERS COMPENSATION AND EMPLOYERS' LIABILITY ANY PROPRIETOR/PARTNER/EXECUTIVE OFFICER/MEMBER EXCLUDED? (Mandatory in NH) If yes, describe under DESCRIPTION OF OPERATIONS below						<input type="checkbox"/> Y <input type="checkbox"/> N <input type="checkbox"/> N/A WC STATUTORY LIMITS OTH-ER E.L. EACH ACCIDENT \$ E.L. DISEASE - EA EMPLOYEE \$ E.L. DISEASE - POLICY LIMIT \$
A	Professional Liability			AEE7142408	06/16/2013	06/16/2014	\$2,000,000 per claim \$4,000,000 annl aggr.

DESCRIPTION OF OPERATIONS / LOCATIONS / VEHICLES (Attach ACORD 101, Additional Remarks Schedule, if more space is required)
Professional Liability coverage is written on a claims-made and reported basis.

CERTIFICATE HOLDER For Proposal Purposes	CANCELLATION SHOULD ANY OF THE ABOVE DESCRIBED POLICIES BE CANCELLED BEFORE THE EXPIRATION DATE THEREOF, NOTICE WILL BE DELIVERED IN ACCORDANCE WITH THE POLICY PROVISIONS. AUTHORIZED REPRESENTATIVE 
--	--

© 1988-2009 ACORD CORPORATION. All rights reserved.

ACORD™ CERTIFICATE OF LIABILITY INSURANCE

DATE (MM/DD/YYYY)
10/29/13

PRODUCER
PATRICK BRADY INSURANCE SERVICES, INC.
901 SE 17TH ST CSWY #218
FORT LAUDERDALE, FL 33316

INSURED
WALTER & ZACKRIA ASSOCIATES
620 SE 1ST STREET
FORT LAUDERDALE, FL 33301

THIS CERTIFICATE IS ISSUED AS A MATTER OF INFORMATION ONLY AND CONFERS NO RIGHTS UPON THE CERTIFICATE HOLDER. THIS CERTIFICATE DOES NOT AMEND, EXTEND OR ALTER THE COVERAGE AFFORDED BY THE POLICIES BELOW.

INSURERS AFFORDING COVERAGE	NAIC #
INSURER A: HARTFORD	
INSURER B:	
INSURER C:	
INSURER D:	
INSURER E:	

COVERAGES

THE POLICIES OF INSURANCE LISTED BELOW HAVE BEEN ISSUED TO THE INSURED NAMED ABOVE FOR THE POLICY PERIOD INDICATED. NOTWITHSTANDING ANY REQUIREMENT, TERM OR CONDITION OF ANY CONTRACT OR OTHER DOCUMENT WITH RESPECT TO WHICH THIS CERTIFICATE MAY BE ISSUED OR MAY PERTAIN, THE INSURANCE AFFORDED BY THE POLICIES DESCRIBED HEREIN IS SUBJECT TO ALL THE TERMS, EXCLUSIONS AND CONDITIONS OF SUCH POLICIES. AGGREGATE LIMITS SHOWN MAY HAVE BEEN REDUCED BY PAID CLAIMS.

INSR ADD'L LTR	INSRD	TYPE OF INSURANCE	POLICY NUMBER	POLICY EFFECTIVE DATE (MM/DD/YY)	POLICY EXPIRATION DATE (MM/DD/YY)	LIMITS
A		GENERAL LIABILITY	01 SBM AR4565 DW	10/03/2013	10/03/2014	EACH OCCURRENCE \$ 1,000,000
		<input checked="" type="checkbox"/> COMMERCIAL GENERAL LIABILITY				DAMAGE TO RENTED PREMISES (Ea occurrence) \$ 300,000
		<input type="checkbox"/> CLAIMS MADE <input checked="" type="checkbox"/> OCCUR				MED EXP (Any one person) \$ 10,000
						PERSONAL & ADV INJURY \$ 1,000,000
		GEN'L AGGREGATE LIMIT APPLIES PER:				GENERAL AGGREGATE \$ 2,000,000
		<input type="checkbox"/> POLICY <input type="checkbox"/> PRO-JECT <input type="checkbox"/> LOC				PRODUCTS - COMP/OP AGG \$ 2,000,000
		AUTOMOBILE LIABILITY				COMBINED SINGLE LIMIT (Ea accident) \$
		<input type="checkbox"/> ANY AUTO				BODILY INJURY (Per person) \$
		<input type="checkbox"/> ALL OWNED AUTOS				BODILY INJURY (Per accident) \$
		<input type="checkbox"/> SCHEDULED AUTOS				PROPERTY DAMAGE (Per accident) \$
		<input type="checkbox"/> HIRED AUTOS				
		<input type="checkbox"/> NON-OWNED AUTOS				
		GARAGE LIABILITY				AUTO ONLY - EA ACCIDENT \$
		<input type="checkbox"/> ANY AUTO				OTHER THAN EA ACC \$
						AUTO ONLY: AGG \$
		EXCESS/UMBRELLA LIABILITY				EACH OCCURRENCE \$
		<input type="checkbox"/> OCCUR <input type="checkbox"/> CLAIMS MADE				AGGREGATE \$
		<input type="checkbox"/> DEDUCTIBLE				\$
		<input type="checkbox"/> RETENTION				\$
		WORKERS COMPENSATION AND EMPLOYERS' LIABILITY				WC STATU-TORY LIMITS OTH-ER
		ANY PROPRIETOR/PARTNER/EXECUTIVE OFFICER/MEMBER EXCLUDED?				E.L. EACH ACCIDENT \$
		If yes, describe under SPECIAL PROVISIONS below				E.L. DISEASE - EA EMPLOYEE \$
		OTHER				E.L. DISEASE - POLICY LIMIT \$

DESCRIPTION OF OPERATIONS / LOCATIONS / VEHICLES / EXCLUSIONS ADDED BY ENDORSEMENT / SPECIAL PROVISIONS

ADDITIONAL INSURED:

CERTIFICATE HOLDER

For Proposal Purposes

CANCELLATION

SHOULD ANY OF THE ABOVE DESCRIBED POLICIES BE CANCELLED BEFORE THE EXPIRATION DATE THEREOF, THE ISSUING INSURER WILL ENDEAVOR TO MAIL 30 DAYS WRITTEN NOTICE TO THE CERTIFICATE HOLDER NAMED TO THE LEFT, BUT FAILURE TO DO SO SHALL IMPOSE NO OBLIGATION OR LIABILITY OF ANY KIND UPON THE INSURER, ITS AGENTS OR REPRESENTATIVES.

AUTHORIZED REPRESENTATIVE



CERTIFICATE OF LIABILITY INSURANCE

DATE (MM/DD/YYYY)
02/18/2014

THIS CERTIFICATE IS ISSUED AS A MATTER OF INFORMATION ONLY AND CONFERS NO RIGHTS UPON THE CERTIFICATE HOLDER. THIS CERTIFICATE DOES NOT AFFIRMATIVELY OR NEGATIVELY AMEND, EXTEND OR ALTER THE COVERAGE AFFORDED BY THE POLICIES BELOW. THIS CERTIFICATE OF INSURANCE DOES NOT CONSTITUTE A CONTRACT BETWEEN THE ISSUING INSURER(S), AUTHORIZED REPRESENTATIVE OR PRODUCER, AND THE CERTIFICATE HOLDER.

IMPORTANT: If the certificate holder is an ADDITIONAL INSURED, the policy(ies) must be endorsed. If SUBROGATION IS WAIVED, subject to the terms and conditions of the policy, certain policies may require an endorsement. A statement on this certificate does not confer rights to the certificate holder in lieu of such endorsement(s).

PRODUCER State Farm Insurance 3038 N Federal Highway Ft Lauderdale, Florida 33306 	CONTACT NAME: Steve Botkin PHONE (A/C, No, Ext): 954-537-3333 FAX (A/C, No): 954-537-3332 E-MAIL ADDRESS: www.stevebotkin.net PRODUCER CUSTOMER ID #:	
	INSURER(S) AFFORDING COVERAGE NAIC #	
INSURED Walters-Zackria Associates 620 SE 1st St Fort Lauderdale, FL 33301	INSURER A : State Farm Mutual Automobile Insurance Company 25178	
	INSURER B :	
	INSURER C :	
	INSURER D :	
	INSURER E :	
	INSURER F :	

COVERAGES **CERTIFICATE NUMBER:** **REVISION NUMBER:**

THIS IS TO CERTIFY THAT THE POLICIES OF INSURANCE LISTED BELOW HAVE BEEN ISSUED TO THE INSURED NAMED ABOVE FOR THE POLICY PERIOD INDICATED. NOTWITHSTANDING ANY REQUIREMENT, TERM OR CONDITION OF ANY CONTRACT OR OTHER DOCUMENT WITH RESPECT TO WHICH THIS CERTIFICATE MAY BE ISSUED OR MAY PERTAIN, THE INSURANCE AFFORDED BY THE POLICIES DESCRIBED HEREIN IS SUBJECT TO ALL THE TERMS, EXCLUSIONS AND CONDITIONS OF SUCH POLICIES. LIMITS SHOWN MAY HAVE BEEN REDUCED BY PAID CLAIMS.

INSR LTR	TYPE OF INSURANCE	ADDL INSR	SUBR WVD	POLICY NUMBER	POLICY EFF (MM/DD/YYYY)	POLICY EXP (MM/DD/YYYY)	LIMITS	
	GENERAL LIABILITY <input type="checkbox"/> COMMERCIAL GENERAL LIABILITY <input type="checkbox"/> CLAIMS-MADE <input type="checkbox"/> OCCUR GEN'L AGGREGATE LIMIT APPLIES PER: <input type="checkbox"/> POLICY <input type="checkbox"/> PRO-JECT <input type="checkbox"/> LOC						EACH OCCURRENCE \$ DAMAGE TO RENTED PREMISES (Ea occurrence) \$ MED EXP (Any one person) \$ PERSONAL & ADV INJURY \$ GENERAL AGGREGATE \$ PRODUCTS - COMP/OP AGG \$ \$	
	AUTOMOBILE LIABILITY <input type="checkbox"/> ANY AUTO <input checked="" type="checkbox"/> ALL OWNED AUTOS <input checked="" type="checkbox"/> SCHEDULED AUTOS <input type="checkbox"/> HIRED AUTOS <input type="checkbox"/> NON-OWNED AUTOS			D086222	01/08/2014	07/08/2014	COMBINED SINGLE LIMIT (Ea accident) \$ 1,000,000 BODILY INJURY (Per person) \$ BODILY INJURY (Per accident) \$ PROPERTY DAMAGE (Per accident) \$ Comp/Coll \$ 1,000 \$	
	UMBRELLA LIAB <input type="checkbox"/> OCCUR EXCESS LIAB <input type="checkbox"/> CLAIMS-MADE DEDUCTIBLE RETENTION \$						EACH OCCURRENCE \$ AGGREGATE \$ \$ \$	
	WORKERS COMPENSATION AND EMPLOYERS' LIABILITY ANY PROPRIETOR/PARTNER/EXECUTIVE OFFICER/MEMBER EXCLUDED? <input type="checkbox"/> Y/N (Mandatory in NH) If yes, describe under SPECIAL PROVISIONS below ENOL		N/A	98-BK-N478-3	02/19/2014	02/19/2015	<input checked="" type="checkbox"/> WC STATUTORY LIMITS <input type="checkbox"/> OTHER E.L. EACH ACCIDENT \$ 500,000 E.L. DISEASE - EA EMPLOYEE \$ 500,000 E.L. DISEASE - POLICY LIMIT \$ 500,000	
				916 9794-59	12/01/2013	06/01/2014	1 MILLION/ 1 MILLION/ 1 MILLION	

DESCRIPTION OF OPERATIONS / LOCATIONS / VEHICLES (Attach ACORD 101, Additional Remarks Schedule, if more space is required)

CERTIFICATE HOLDER For Proposal Purposes	CANCELLATION SHOULD ANY OF THE ABOVE DESCRIBED POLICIES BE CANCELLED BEFORE THE EXPIRATION DATE THEREOF, NOTICE WILL BE DELIVERED IN ACCORDANCE WITH THE POLICY PROVISIONS.
	AUTHORIZED REPRESENTATIVE RS BOTKIN

JOINT VENTURES

11

JOINT VENTURES

Walters Zackria Associates, PLLC – is not involved in a joint venture.

Any firm(s) involved in a joint venture in its Proposal will be evaluated individually, as each firm of the joint venture would have to stand on its own merits.

SUBCONSULTANTS

12



CITY OF FORT LAUDERDALE

RFQ NO. 936-11270
AN ANNUAL CONTRACT
FOR

ARCHITECTURAL CONSULTANT SERVICES

Key Personnel

Prime

Walters • Zackria Associates, PLLC (WZA) – Architecture. Walters • Zackria Associates is a full service, CBE, architectural firm serving South Florida for more than 32 years. **Robert S. Walters AIA** and **Abbas H. Zackria, CSI CDT LEED AP** will lead the WZA design team composed of two principal architects two project managers and two CADD draftpersons, and specialized consultants listed below. This team of personnel has worked together for many years and functions in a well-organized manner.

Mr. Walters is Architect of Record for more than 1,000 Broward County projects. Services will include feasibility studies, existing facility review and as-built documentation, site and building programming, conceptual design, site master planning and development, space planning, design development, construction documents, design and bid specifications, cost estimating, renderings, permitting, bid review, and contract administration.

Walters • Zackria Associates is a County Business Enterprise. Our certification has been included for your review.

Subconsultants

To serve you better, we have added four specialty subconsultants to our team.

Walters Zackria Associates, PLLC / Mark Scala, PE – Structural Engineering – will assist in the structural system design. Mark’s 40 years of South Florida experience includes expertise in all structural systems. Mark Scala has previous experience with the Broward County Board of Rules and Appeals as Chief Code Compliance Officer as Structural Engineer. He reviewed projects submitted to Broward’s 30 building departments for structural accuracy on both the plans and in the calculations and municipal structures.

Delta G. Consulting Engineers, Inc. – Mechanical, Electrical & Plumbing, Fire Protection – Delta G is a DBE and CBE certified Mechanical and Electrical Engineering Consulting firm. Since 1992, Delta G Consulting Engineers has been providing the mechanical and electrical engineering design services various municipalities and private clients. Delta G has worked with WZA on over three dozen municipal projects.

Abaco Engineering, Inc. – Civil – Tasks will include traffic circulation, site drainage, paving and grading, and site utility design. Abaco Engineering is familiar with local development ordinances and has experience with obtaining Civil Engineering permits from local municipalities and local water management district. Abaco Engineering has provided civil engineering services for Southwest Community Center, Coconut Creek Recreational Complex, C. B. Smith Park, Vista View Park and Long Key Natural Area among other projects.

TBG Partners –Landscape Architecture - Founded more than 27 years ago and staffed by more than 100 dedicated professionals, TBG Partners is a landscape architecture and planning firm that works on diverse projects at all scales around the world. Driven by a commitment to excellence and innovative design, TBG has enjoyed sustained growth and development over the years, with offices in Fort Lauderdale, Austin, Dallas, Houston, San Antonio and Tulsa. The Fort Lauderdale office is led by Managing Principal Paul Weinberg, who has been living and working throughout South Florida on significant projects for more than 14 years.

Nutting Engineers of Florida, Inc. – Geotechnical Engineering and Testing - Nutting Engineers has been serving South and Central Florida since 1967. Their experience includes site explorations, material sample analysis, and recommendations for site feasibility on runways, building foundations, roadways, and earth retaining structures. The laboratories are accredited by AASHTO, CMEC, FDOT, and ASTM. Mr. Richard C. Wohlfarth, P.E. will lead all geotechnical testing tasks.

Office location responsible for this project:

**Walters • Zackria Associates, PLLC
620 SE 1st Street
Fort Lauderdale, Florida 33301**





CITY OF FORT LAUDERDALE

RFQ NO. 936-11270
AN ANNUAL CONTRACT
FOR

ARCHITECTURAL CONSULTANT SERVICES

AWN Design & Consulting Group, Inc. – *Survey Engineering* - They will perform any survey work required in CADD format. AWN Design & Consulting Group is also a **CBE** Firm.

NON-COLLUSION STATEMENT

13

NON-COLLUSION STATEMENT:

By signing this offer, the vendor/contractor certifies that this offer is made independently and *free* from collusion. Vendor shall disclose below any City of Fort Lauderdale, FL officer or employee, or any relative of any such officer or employee who is an officer or director of, or has a material interest in, the vendor's business, who is in a position to influence this procurement.

Any City of Fort Lauderdale, FL officer or employee who has any input into the writing of specifications or requirements, solicitation of offers, decision to award, evaluation of offers, or any other activity pertinent to this procurement is presumed, for purposes hereof, to be in a position to influence this procurement.

For purposes hereof, a person has a material interest if they directly or indirectly own more than 5 percent of the total assets or capital stock of any business entity, or if they otherwise stand to personally gain if the contract is awarded to this vendor.

In accordance with City of Fort Lauderdale, FL Policy and Standards Manual, 6.10.8.3,

3.3. City employees may not contract with the City through any corporation or business entity in which they or their immediate family members hold a controlling financial interest (e.g. ownership of five (5) percent or more).

3.4. Immediate family members (spouse, parents and children) are also prohibited from contracting with the City subject to the same general rules.

Failure of a vendor to disclose any relationship described herein shall be reason for debarment in accordance with the provisions of the City Procurement Code.

<u>NAME</u>	<u>RELATIONSHIPS</u>
NOT APPLICABLE	
_____	_____
_____	_____

In the event the vendor does not indicate any names, the City shall interpret this to mean that the vendor has indicated that no such relationships exist.

