

The Tri-Party RLA/AARLA for this project includes improvements to County right-of-way including driveway paving with header curbs, paver crosswalk, sidewalks, curb & gutter, landscaping including structural soil, and irrigation for approximately 600 LF abutting the west property line of the project on the east side of SW 27th Avenue (Riverland Road). The improvement area is approximately 7,836 SF.

These improvements will be installed under County Permit #190719001, a copy of which is on file with DSD and that can be made available upon request.

LICENSE AREA

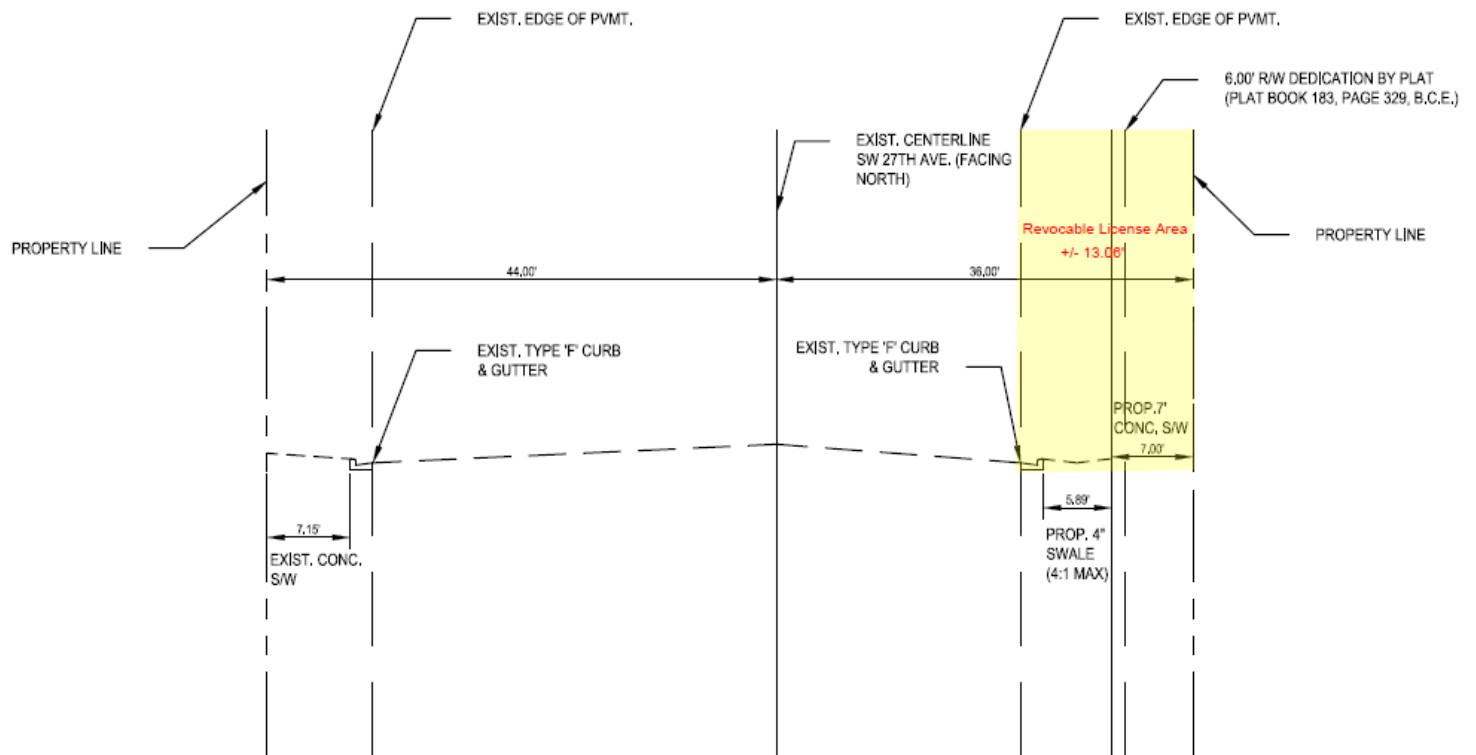

TYPICAL SECTION

SW 27th Avenue (Looking North)