



CITY OF FORT LAUDERDALE OUTDOOR EVENT APPLICATION

\$100 Fee
must
accompany
application

Application must be filled out completely, in DARK ink or type, and submitted at least 90 days ahead of your planned event.

The application will be reviewed by our administrative staff to determine the following criteria:

1. Facility requested
2. Compliance with City ordinances
3. Special permits required
4. Charges your organization will incur when City assistance and/or services are required
5. Security requirements
6. Environmental issues/effects on surrounding areas

PART I: EVENT REQUEST

Event name: 13th Annual Riverwalk Run

Purpose of event (check one): Fundraiser Awareness Recreation Other _____

Detailed event description: Event will include 5K, 5mile and 1mile road races, starting & finishing at Huizenga Plaza. A brunch & awards ceremony will follow the races.

Requested location: Huizenga Plaza

Estimated daily attendance: 1,500

Requested dates and time of event:

DATE	DAY	BEGIN	END
BEGIN SETUP: <u>March 22, 2013</u>	<u>Friday</u>	<u>10</u> <input checked="" type="radio"/> AM <input type="radio"/> PM	
EVENT DAY 1: <u>March 23, 2013</u>	<u>Saturday</u>	<u>4</u> <input checked="" type="radio"/> AM <input type="radio"/> PM	<u>12</u> AM <input checked="" type="radio"/> PM <input type="radio"/> AM
EVENT DAY 2: _____	_____	_____ AM/PM	_____ AM/PM
EVENT DAY 3: _____	_____	_____ AM/PM	_____ AM/PM
BREAKDOWN: <u>March 23, 2013</u>	<u>Saturday</u>		10 <input checked="" type="radio"/> AM <input type="radio"/> PM <u>1:00</u>

Has this event been held in the past? Yes No

If yes, please list past dates and locations: Riverfront/Las Olas: 3/3/01

Riverfront/Rio Vista: 3/9/02, 3/22/03, 3/20/04, 3/19/05, 3/25/06, 3/24-3/25/07
3/21-3/22/08, 3/20-3/21/09, 3/19-3/20/10, 2/26-2/27/11, 3/23-3/24/12

PART II: APPLICANT

Organization name: Junior League of Greater Fort Lauderdale, Inc.

Address: 704 S.E. 1st St. City, State, Zip: Fort Lauderdale, FL 33301

Phone: 954-462-1350 Fax: 954-462-1677

Non-Profit Organization? Yes No Tax ID #: 16-03-252827-85C

Corporation name: S/A
(as it appears in articles of incorporation)

Date of incorporation: 1959 State incorporated in: FL Federal ID #: 65950932701-85C

Two authorizing officials for the organization:

President: Alicia Malinowski Phone: 248-835-9931

Secretary: Catherine Givens Phone: 954-462-1350

Event Coordinator Name: Billie Dalglish Will you be on-site? Yes No

Title: Riverwalk Run Co-Chair Phone: 954-701-7798 Cell: 954-701-7798

E-mail address: bjdalglish@att.net Fax: 954-713-6230

Event production company (if other than applicant): _____

Address: _____ City, State, Zip: _____

Contact person: _____ Title: _____

Phone: (day) _____ (night) _____ (cell) _____

E-mail address: _____ Fax: _____

PART III: EVENT INFORMATION

Are you planning to charge admission? Yes No

If yes, how much? \$25 advance registration
\$40 Race day registration

Are you requesting to fence the event? Yes No

Are you planning on having any type of concession? Yes No

If yes, State Health Dept. must be notified 10 days prior to event. Call John Litscher at 954-632-8094.

Are you planning on selling alcoholic beverages? Yes No

If yes, how will the beverages be served? (Draft truck, cold plate, mini-bar, beer tub, table service, etc.)

Are you planning on serving free alcoholic beverages? Yes No

If yes, to whom will it be given? _____

Are you planning to have any type of amusement rides? Yes No

If yes, name of company: _____

What type of rides are you planning? _____

(All rides must be approved by the State of Florida Bureau of Fair Rides and all permits must be secured prior to opening. Contact Ron Jacobs at jacobsr@doacs.state.fl.us or (850) 488-9790).

Are you planning to play or have music? Yes No

If yes, what music format(s) will be used? (amplified, acoustic, recorded, live, disc jockey, etc):

DJ

List the type of equipment you will use (speakers, amplifier, drums, etc):

Speakers

Will you use any type of soundproofing equipment? Yes No

List the days and times music will be played: Saturday, March 23, 2013 - 8am - 10am

How close is the event to the nearest residential use? _____

Will your event require road closings? Yes No

If yes, list requested streets and times in detail: See attached copy of the

Smile and 5K race courses. Road Closures are required for the entire race.

******PLEASE NOTE****** You are required to secure barricades and/or directional traffic signs for road closings. Please attach a layout of your traffic plan, including the placement and number of barricades, signs, directional arrows, cones, and message boards, as well as the name of the company you will be using. Your traffic plan must be approved by the Police Dept. which may terminate any event occurring without the proper use of barricades.

Will your road closings affect access to parking spaces or parking lots? Yes No

******PLEASE NOTE****** All road closings which result in loss of revenue from inaccessible parking spaces will be billed to the event organizer and must be paid in full before the event. Please call Keela Black at 828-3794.

Will any recyclable materials be utilized at this event? Yes No

(Materials that can be recycled include all clean paper, cardboard, glass, plastic drink containers, aluminum cans, and milk or juice boxes.) Please refrain from the use of Styrofoam plates and cups.

Who will provide clean up services for garbage and recyclables? Junior League Volunteers
(Company name)

Contact Name: Billie Dalglish Phone: 954-701-7798

******PLEASE NOTE****** All grounds must be cleaned up **immediately** after completion of event. Recyclable materials should be recycled at all City facilities and parks. Recycling service may be provided by your organization, a private company or in some cases by the City of Fort Lauderdale. You are responsible for securing recycling services. Contact Janet Townsend at jtownsend@fortlauderdale.gov or (954) 828-5956.

Will you require electricity? Yes No

Events requiring electricity are the responsibility of the applicant. All permits must be obtained through the City's Building Department at (954) 828-5191 before setting up.

Company: power boxes are currently License #: _____
available at Huizenga Plaza

Name of electrician: _____ Phone: _____

PART IV: APPLICANT'S ACCEPTANCE/SIGNATURE

The information I have provided on this application is true and complete to the best of my knowledge.

Before receiving final approval from the City Commission, I understand that I (and the production company, if applicable) must furnish an original certificate of General Liability insurance naming the City of Fort Lauderdale as additionally insured in the amount of at least one million dollars (\$1,000,000) or greater as deemed satisfactory by the City Risk Manager, and an original certificate of liquor liability insurance in the amount of \$500,000 if alcohol is being served.

I understand that a Parks and Recreation sponsored activity has precedence over the above schedule and I will be notified if any conflicts arise.

I understand that the City of Fort Lauderdale Police Department will determine all security requirements and that EMS is required by City Ordinance to be onsite during all outdoor events.

I understand that the City has a noise ordinance. If at any time during the event it is determined by law enforcement personnel, code enforcement personnel, parks and recreation personnel, or any other city representative that the entertainment or music is causing a noise disturbance, I will be directed to lower the volume to an acceptable level as determined by City staff. If a second noise disturbance arises during the event, I may be directed to shut down the music or entertainment for the remainder of the event. I agree to abide by all provisions of the noise control ordinance and understand that my failure to do so may result in a civil citation, a physical arrest, or the shutting down of the event.

Alicia B. Molinar
Signature of applicant

President, Junior League of FTL
Title

4/17/12
Date

Please return completed application at least 90 days ahead of your planned event, along with \$100.00 application fee (payable to the City of Fort Lauderdale) and an event site plan to:

Susan Fye Molnar, Outdoor Event Coordinator
1350 W. Broward Boulevard, Fort Lauderdale, FL 33312
E-mail address: smolnar@fortlauderdale.gov Phone: (954) 828-5362 Fax: (954) 828-5650

EVENT APPLICATION SUBMISSION CHECKLIST:

- Completed application form
- \$100 application fee payable to the City of Fort Lauderdale
- Event Site Plan, showing:
 - layout of event (stage(s), other types of entertainment, activities, booths, restrooms, canopies, dumpsters, fencing, generator location or other source of electricity, etc.)
 - traffic plan (including the placement and number of barricades, signs, directional arrows, cones, message boards, and name of the barricade and/or directional traffic signs company being used.)
- We are prepared to furnish our Certificate of Liability Insurance as well as our Certificate of Liquor Liability Insurance (if applicable) before submittal to the City Commission

FIRE DEPARTMENT QUESTIONNAIRE

PREVENTION

1. Are you planning to have canopies (no sides) for this event? Yes No

How many and what sizes? 6-8 10' x 10'

Name of Company: The Junior League will provide our own.
A building permit is required. Please contact Lt. Strandhagen at 954-828-5892.

2. Are you planning to have tents (with sides) for this event? Yes No

How many and what sizes? _____

Name of Company: _____
In addition to a building permit, exit signs, emergency lights, fire extinguishers, and "No Smoking" signs are required for tents. A fire watch at overtime rate may apply. Contact Lt. Strandhagen at 954-828-5892.

******PLEASE NOTE****** All permits required by the Florida Building Code must be obtained through the Building Department (including but not limited to electrical, structural, plumbing). Contact the Building Department at 954-828-6520.

3. Are you planning to have fireworks? Yes No

Name of company conducting the show: _____
A Fireworks permit is required for all pyrotechnics displays. Contact Capt. D'Agostino at 954-828-5884.

4. Are you having food vendors? Yes No

How many and what kind? A complimentary brunch served by volunteers

A fire extinguisher is required for each food booth. If a propane tank is used for a fuel source, it must be secured on the outside of the booth. A Fire inspection is required for all food booths. If the inspection is during non-working hours the cost will be \$60 - \$70 per hour.

OPERATIONS/EMS

Special Event Detail Guidelines:

- * One rescue unit/cart for 500 to 5,000 people in attendance (sustained attendance)
- * Two rescue units/carts for 5,000 to 10,000 people in attendance (sustained attendance)
- * One more rescue unit/cart per 5,000 additional people
- * One command person if two or more rescue units/carts are required

The number of rescue units and paramedics is determined according to attendance and other risk factors.

1. Does your event require EMS medical standby services based on the guidelines above? YES NO

2. What is your estimated sustained attendance? 1500

3. On-site contact? NAME Billie Dalglish PHONE 954-701-7798

A minimum of 4 hours will be charged for all special event details. 45 minutes will be added to the pre and post event times (totaling 1.5 hours), allowing for travel and preparation for the event.

POLICE DEPARTMENT QUESTIONNAIRE

1. Does your event require use of police vehicles? Yes X No

2. Is this a new or previously held event? New Previous X

Previous date(s)? 3/3/01, 3/9/02, 3/22/03, 3/20/04, 3/19/05, 3/25/06, 3/25/07, 3/22/08
3/21/09, 3/20/10, 2/27/11, 3/24/12

3. Any established security, traffic, or other appropriate plan(s)? Yes X No

If yes, besides Fort Lauderdale Police, who will you be using for this plan?
(private security company, volunteers, etc.)

Volunteers to direct runners along the
VRCE course

4. Do you have an established detail of off-duty officers? Yes X No
If yes, who is your Police department contact?

Sgt Frank Sousa

5. Any notable entertainers or special circumstances scheduled for your event? Yes No X

Who/What?

I understand the off duty rate for Police personnel for ALL special events is calculated at a 3-hour minimum rate. The hourly rate and costs to be incurred by the event organizer will be quoted on the City of Ft. Lauderdale Special Events "Cost Estimate" worksheet developed at the Special Events logistics meeting and provided to the organizer.

Alicia B. Morrow
Signature

4/17/12
Date

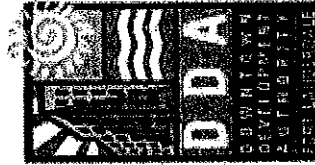

HUIZENGA PLAZA
FT. LAUDERDALE, FL

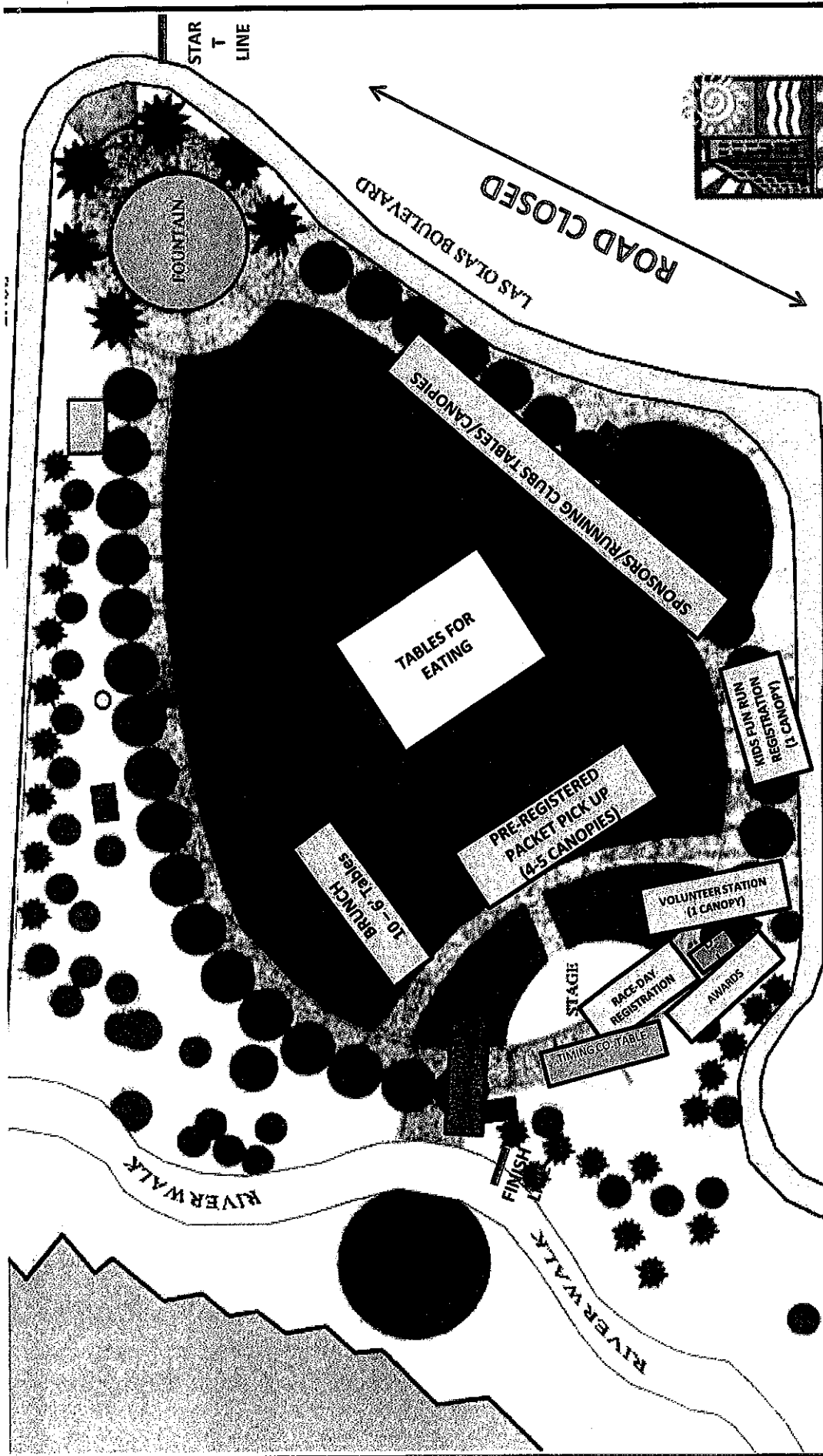

- SE 2ND AVENUE
- YOU SHOW:**
- FENCING
 - RESTROOMS
 - CANOPIES (NO SIDES)
 - TENTS (WITH SIDES)
- PORTO-JES**
- BAND/SET-UP
 - DUMPSTER
 - ROAD CLOSURES
 - CONCESSIONS/VENDORS

- ELECTRICAL BOX
- WATER HOOK-UP
- PUMP HOUSE

RACE NAME: Riverwalk 5 Miller Run
LOCATION: Ft. Lauderdale, FL.
MEASURED BY: Gene Witkowski

#FL10131EBM
 EPPastive 12/28/2010
 to 12/31/2020

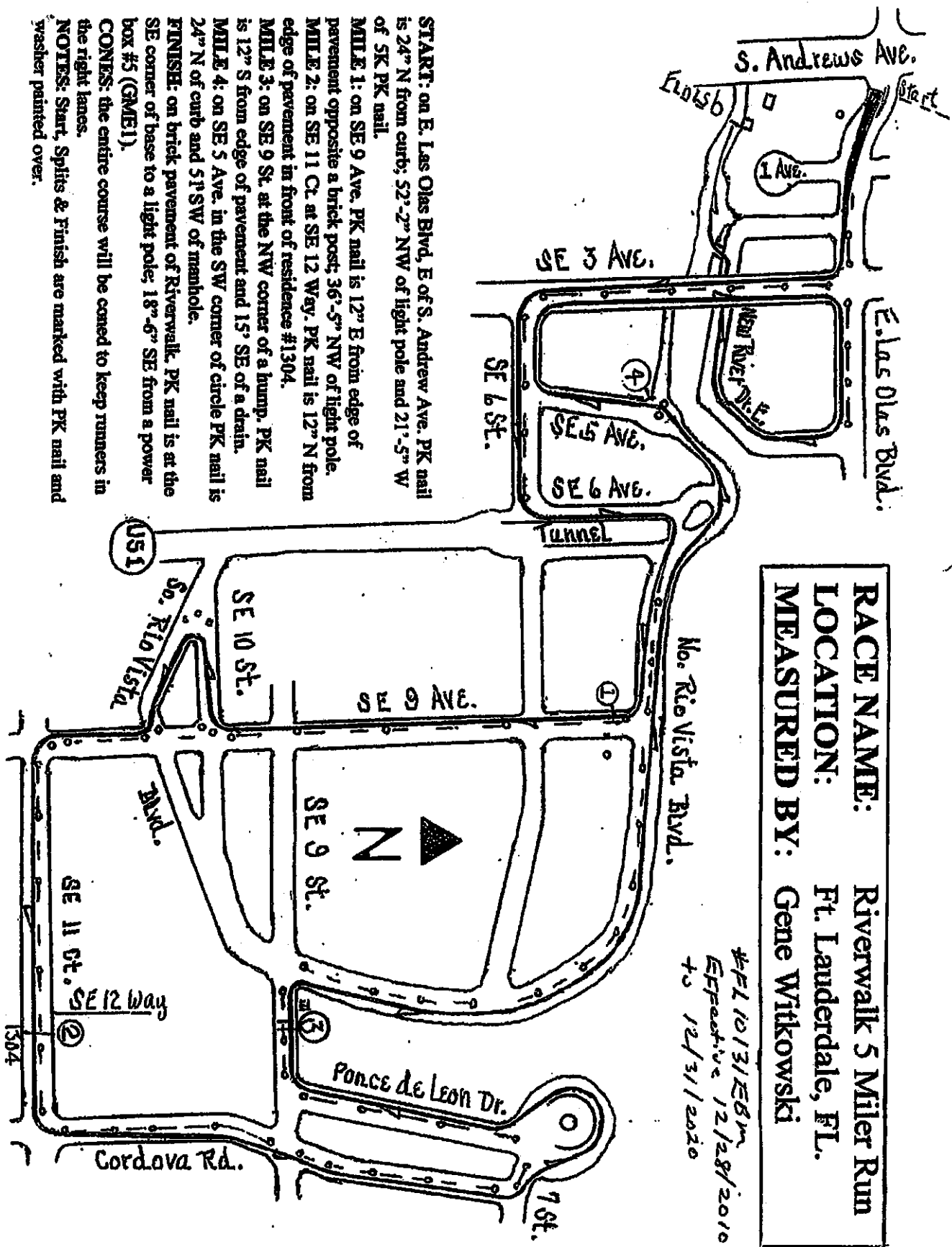

START: on E. Las Olas Blvd, E of S. Andrew Ave. PK nail is 24" N from curb; 52'-2" NW of light pole and 21'-5" W of 5K PK nail.

MILE 1: on SE 9 Ave. PK nail is 12" E from edge of pavement opposite a brick post; 36'-5" NW of light pole.

MILE 2: on SE 11 Ct. at SE 12 Way. PK nail is 12" N from edge of pavement in front of residence #1304.

MILE 3: on SE 9 St. at the NW corner of a hump. PK nail is 12" S from edge of pavement and 15' SE of a drain.

MILE 4: on SE 5 Ave. in the SW corner of circle PK nail is 24" N of curb and 51" SW of manhole.

FINISH: on brick pavement of Riverwalk. PK nail is at the SE corner of base to a light pole; 18'-6" SE from a power box #5 (GME1).

CONES: the entire course will be coned to keep runners in the right lanes.

NOTES: Start, Splits & Finish are marked with PK nail and washer painted over.