

LEGEND

- PROJECT BOUNDARY
- PROPOSED BUILDING
- PROPOSED TYPE 'F' CURB AND GUTTER
- PROPOSED SAN. MANHOLE
- PROPOSED 8" BACKFLOW PREVENTION & METER ASSY
- PROPOSED HYDRANT
- PROPOSED BENDS
- PROPOSED PLUG
- PROPOSED TEE
- PROPOSED GATE VALVE (GV)
- PROPOSED REDUCER
- EXISTING 30" WATER MAIN
- EXISTING 6" WATER MAIN
- EXISTING 8" WATER MAIN
- EXISTING 6" WATER MAIN TO BE REMOVED
- EXISTING 10" FORCE MAIN TO BE REMOVED
- EXISTING 8" GRAVITY SEWER
- EXISTING 10" GRAVITY SEWER
- EXISTING 10" FORCE MAIN
- EXISTING 20" FORCE MAIN
- EXISTING UNDERGROUND AT&T
- EXISTING OVERHEAD AT&T
- EXISTING UNDERGROUND COMCAST
- EXISTING OVERHEAD COMCAST
- EXISTING OVERHEAD UTILITIES
- EXISTING GAS LINE
- EXISTING GAS LINE
- PROPOSED 8" FIRE MAIN
- PROPOSED 12" FIRE MAIN
- PROPOSED 8" WATER MAIN
- PROPOSED 6" WATER MAIN
- PROPOSED 4" WATER MAIN
- PROPOSED 3" WATER MAIN
- PROPOSED 10" FORCE MAIN
- PROPOSED 8" GRAVITY SEWER
- PROPOSED CAMERA CONDUIT
- PROPOSED ELECTRICAL CONDUIT
- PROPOSED UNDERGROUND AT&T
- PROPOSED UNDERGROUND COMCAST

LIGHT LEGEND

(REFER TO SEPARATE PLANS FOR SITE LIGHTING ELECTRICAL PLAN.)

| KEY | ATTRIBUTES |
|-----|--|
| + | DESCRIPTION: XXX-XXXX-XX 35' POLE ON 3' BASE, 3 FIXTURES PER POLE |
| + | DESCRIPTION: XXX-XXXX-XX 35' POLE ON 3' BASE, 3 FIXTURES PER POLE WITH LOSS PREVENTION (LP) CAMERAS |
| - | DESCRIPTION: XXX-XXXX-XX 35' POLE ON 3' BASE, 1 FIXTURE PER POLE |
| - | DESCRIPTION: XXX-XXXX-XX (ROTATED OPTICS) 35' POLE ON 3' BASE, 2 FIXTURES PER POLE |
| - | DESCRIPTION: XXX-XXXX-XX 35' POLE ON 3' BASE, 2 FIXTURES PER POLE |
| * | DECORATIVE STREET LIGHT DESCRIPTION: XXX-XXXX-XX 15' POLE ON 3' BASE, 1 FIXTURE PER POLE |

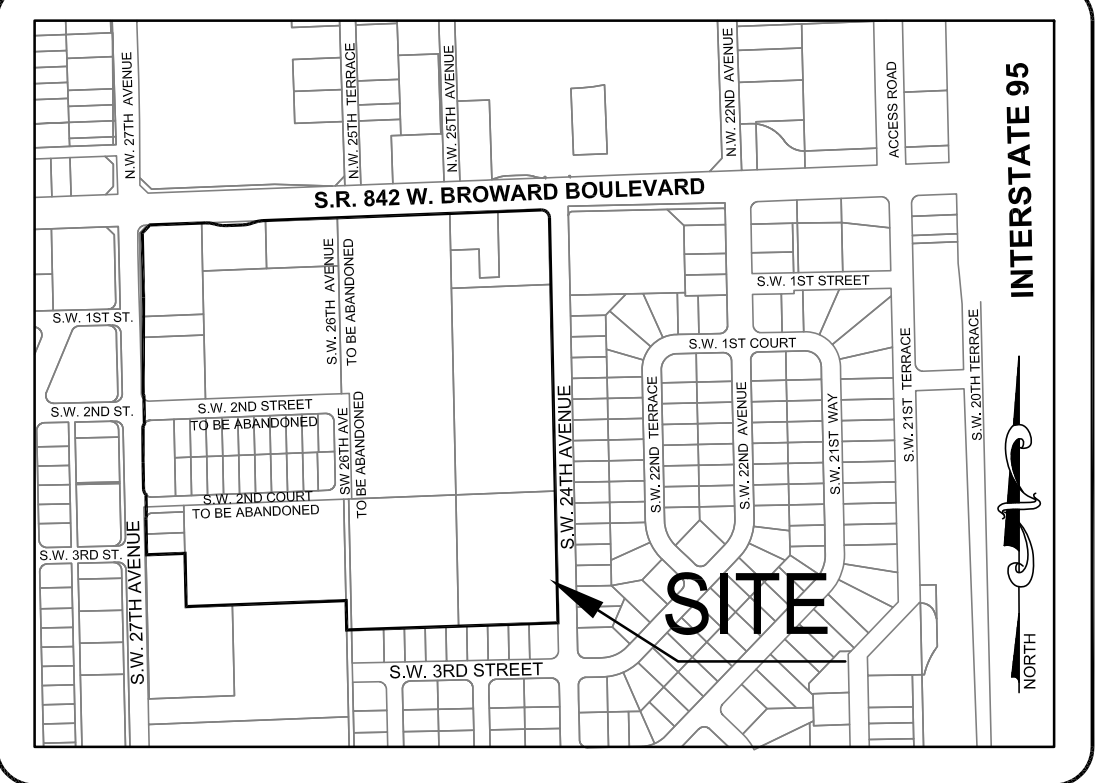

**GENERAL RETAIL & GROCERY STORE
W/ AUTO SERVICE CENTER**
183,072 S.F. BASE BUILDING + 3,861 S.F. AUTO SERVICE = 186,933 ± S.F. GFA
PROPOSED F.F.E. = 10.00 NAVD

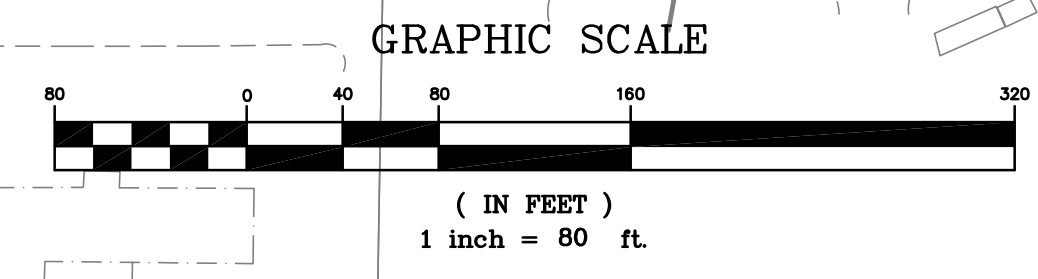

**CONCEPTUAL UTILITY
RELOCATION PLAN**

Exhibit 5
14-0050
Page 1 of 1

REVISIONS BY

| NO. | DESCRIPTION | BY | DATE |
|-----|-------------|----|------|
| | | | |

CREECH ENGINEERS INC.
REGISTERED PROFESSIONAL ENGINEERS
OFFICES ALSO IN MELBOURNE, FORT ST. LUCIE AND TALLAHASSEE, FL.
17881 S.W. ELLIPSE WAY, SUITE 100, FORT ST. LUCIE, FL 34947
TEL: 888-888-8888 FAX: 888-888-8888

RIVERBEND MARKETPLACE
FORT LAUDERDALE, BROWARD COUNTY, FLORIDA
GATLIN DEVELOPMENT CO., INC.
888 EAST LAS OLAS BLVD SUITE 600
FORT LAUDERDALE, FL 33301

| | |
|---------|----------|
| DRAWN | C.S.M. |
| CHECKED | M.C. |
| DATE | 08/13/13 |
| SCALE | 1" = 80' |
| JOB NO. | 12016.00 |
| SHEET | |