

DATUM POINT INTERSECTION OF S.W. 2ND STREET & S.W. 5TH AVENUE CENTERLINE
 S.W. 2ND STREET CENTERLINE 6+44.85
 S.W. 5TH AVENUE CENTERLINE 10+35.00
 IN REFERENCE TO THE RECORDED PLAN

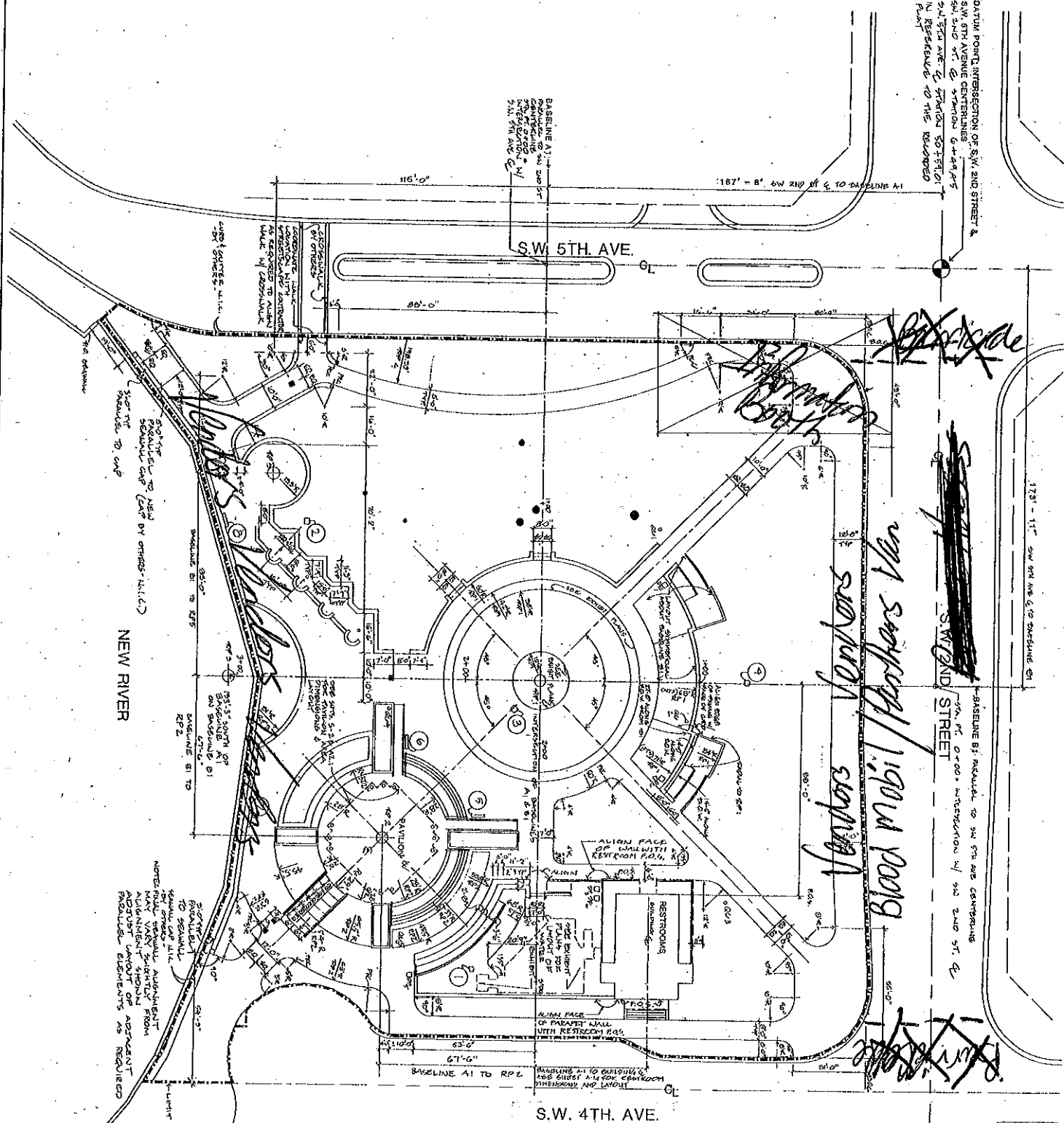

NOTE: THE NEW RIVER BRIDGE CAP TO BE AS SHOWN IN THE PLAN. THE BRIDGE SHALL BE CONSTRUCTED TO CARRY THE TRAFFIC LOADS AS SHOWN IN THE PLAN.

NEW RIVER

Vendors
Blood mobile
Members Van

NOTE: THE NEW RIVER BRIDGE CAP TO BE AS SHOWN IN THE PLAN. THE BRIDGE SHALL BE CONSTRUCTED TO CARRY THE TRAFFIC LOADS AS SHOWN IN THE PLAN.

S.W. 4TH AVE.

NO.	DESCRIPTION	REMARKS
1	AL 2+85.35 RT 28.0'	
2	AL 1+08.00 RT 0.0'	
3	AL 1+75.92 LEFT 87.5'	
4	AL 2+30.83 RT	
5	AL 2+00.72 RT 30.0' PARALLEL TO CURB	
6	AL 2+33.33 RT 13.0' PARALLEL TO CURB	
7	AL 1+08.00 RT 15.1' PARALLEL TO CURB	
8	AL 1+73.92 RT 0.0'	
9	AL 2+41.42 RT 57.5'	
10	AL 3+00.92 RT 0.0'	
11	AL 1+04.75 RT 37.42'	
12	AL 2+82.75 RT 87.00'	