



CITY MANAGER'S OFFICE

CITY MANAGER SIGNATURE REQUEST ROUTING FORM

Rev: 14 | Revision Date: 12/18/2025

SECTION 1 | SUMMARY INFORMATION

Date: 3/4/26

Commission Agenda Item Letter to the Commission (LTC) Letter to External Stakeholder(s) Other Document

Document Title/Purpose: Agree.COFL & Downtown Dev Auth - Installation & Maintenance - of the Manolo Valdés' sculpture titled, "Head with Butterflies" at Huizenga Park

Commission Meeting Date: 2/17/2026 CAM #: CAM 26-0034 Item #: CM-6

CAM attached: Yes No Action Summary Attached: Yes No CIP FUNDED: Yes No

Community Investment Plan (CIP) Project defined as having a life of at least 10 years and a cost of at least \$100,000 and shall mean improvements to real property (land, buildings, or fixtures) that add value and/or extend useful life, including major repairs such as roof replacement. Term "real property" includes land, real estate, realty, or real.

SECTION 2 | REQUESTOR (CHARTER OFFICE/DEPARTMENT)

Charter Office: CAO Router Name: Sonia Sierra Ext: 5598

Department: Community Serv Dept Router Name: Joshua Carden Ext: 5044

Department Approval (Director/Chief): Name _____ Init _____ Date: _____

*Return Document To: Joshua Carden Department: Comm Serv. Dept. Ext: 5044

**REMINDER: Once review and signature at the last level of government (Federal, State, County) is complete, scan the final record copy and send to the City Clerk's Office.*

Scan Date: _____ Attach Certified Resolution #: _____ Original form route to CAO: Yes No

THE FOLLOWING SECTIONS ARE FOR CHARTER OFFICE USE ONLY

SECTION 3 | CITY ATTORNEY'S OFFICE (CAO): CAO signed/routed Required Yes No

Is the attached Granicus document final? Yes No Number of Originals Attached: 1

Attorney's Name: Shaun Amarnani Approved as to Form: Yes No Initials: SA

Route to: Finance (if applicable) Date: N/A Route to: CCO Date: 3/5/26

SECTION 4 | CITY CLERK'S OFFICE (CCO)

City Clerk Office Receive and Scan Date: _____ Number of Originals: 1

Route to CMO Date: 03/05/26 Route to Mayor Date: _____

SECTION 5 | CITY MANAGER'S OFFICE (CMO)

LOG #: MAR49 Date Received: 3/6/26 Received From: CCO

To CM/ACM: R. Williams C. Cooper Y. Matthews Q. Pough B. Rogers

Approved Init.: [Signature] for continuous routing to **Rickelle Williams, City Manager/Executive Director**

Disapproved: _____ Comments: _____

CMO Executive Assistant Route to: CCO | HR | OMB | Other: _____ Date: 3/10/26 Initial: APD



HUIZENGA PARK ART SCULPTURE AGREEMENT

THIS AGREEMENT (the "Agreement"), with an effective date of March 10 2026, is entered into by and between:

CITY OF FORT LAUDERDALE, a municipal corporation of the State of Florida, hereinafter referred to as "CITY," whose principal address is 101 NE 3rd Ave., Fort Lauderdale, FL 33301,

and

DOWNTOWN DEVELOPMENT AUTHORITY OF THE CITY OF FORT LAUDERDALE, a Florida body politic, hereinafter referred to as "DDA," whose principal address is 201 E Las Olas Blvd., Suite 1150 Fort Lauderdale, FL 33301

(CITY and DDA are also referred to herein "PARTIES")

WITNESSETH:

WHEREAS, PARTIES recognize the importance of displaying art in public spaces for the benefit of the community;

WHEREAS, CITY has authorized the acquisition of Manolo Valdes' *Head with Butterflies* sculpture (the "Art") as part of the James Winder Laird Donation and has authorized placement of the Art within Huizenga Park at the "Licensed Premises" more particularly described in Exhibit A attached hereto;

WHEREAS, CITY will retain ownership of the Art and will work with DDA to place the Art; and

WHEREAS, PARTIES are desirous of outlining the roles and responsibilities for design, permitting, construction, installation, and the ongoing maintenance of the Art.

NOW, THEREFORE, in consideration of the mutual promises and covenants contained herein, and other good and valuable consideration, the receipt and adequacy of which are acknowledged, PARTIES covenant and agree to the following terms and conditions:

1. **RECITALS AND EXHIBITS.** PARTIES agree the foregoing recitals are true and correct and incorporated herein by this reference. This Agreement includes the following Exhibits, each of which is hereby incorporated herein:
 - 1.1.1. Exhibit A - Description of Art
 - 1.1.2. Exhibit B - Licensed Premises
 - 1.1.3. Exhibit C – Construction Plans
 - 1.1.4. Exhibit D - Waiver of 1990 Visual Artists' Rights Act
- 1.2. **TERM AND EFFECTIVE DATE.** The term of Agreement (the "Term") shall commence on the date this Agreement is executed by the last of the Parties ("the Effective Date") and continue until CITY or DDA terminate this Agreement by giving ninety (90) days' written notice of such termination. Upon the expiration or earlier termination of this Agreement, CITY shall, at its sole cost and expense, remove the Art and CITY's other personal property from the Licensed Premises and restore the Licensed Premises to substantially the same condition existing on the Effective Date of this Agreement, except for ordinary wear and tear. Any Art not removed from the Licensed Premises within ten (10) calendar days after the expiration or earlier termination of this Agreement may be removed by DDA at the sole expense of CITY, and CITY shall reimburse DDA all such expense(s) including DDA's administrative fee within thirty (30) days after invoice by DDA.
2. **THE ART.**
 - 2.1. *Description of the Art.* The Art consists of the sculpture "*Head with Butterflies*" sculpted by Manola Valdes (the "Artist") more particularly described in **Exhibit A**. The Art was acquired from Artist by CITY in [month]_____, 2026.

- 2.2. *Ownership.* CITY expressly warrants and represents to DDA that (a) CITY is the owner of the Art, free and clear of any liens, encumbrances or restrictions, and (b) CITY possesses full power to enter into this Agreement and to convey the rights herein granted to DDA, including the rights to use, display, and publish the Art, without the consent of any third party, including the Artist.
- 2.3. *No Infringement.* CITY expressly warrants and represents that CITY has obtained from Artist the following licenses, representations and warranties, each of which CITY hereby affirms, represents and warrants to DDA: (a) the Art is the original product of Artists' own creative efforts, (b) the Art is original and is a single edition, (c) the Art does not infringe upon or violate any license, copyright law, patent law, trade secret law, trademark law, moral rights law, semiconductor chip protection law, unfair competition law, proprietary information, non-disclosure, intellectual property or other right of any third party, or infringe upon or violate any right of privacy, or contain libelous material, (d) the Art complies with all applicable patent, trademark and copyright laws, rules, regulations, and codes, and (e) the Art does not utilize any protected patent, trademark or copyright, and (f) Artist has provided, and CITY has obtained, all permission, authority and documentation necessary or required in connection with this Agreement and the placement and display of the Art.
- 2.4. *Art License.* CITY expressly grants to DDA either directly or indirectly, a non-exclusive, unlimited, perpetual, and irrevocable right to use, display, publish, or reproduce the Art in any two-dimensional noncommercial manner or media whatsoever, including without limitation to prepare derivative works based upon the Art, and to distribute copies of the Art, and all other uses inherent or necessarily associated with the placement or installation of the Art at the Licensed Premises. Any reproductions of the Art by DDA must contain a credit to the Art, the Artists, CITY and DDA, and the James Winder Laird Donation. CITY represents and warrants that it has the right to convey the rights and licenses granted to DDA in this Agreement and that all other rights in and to the Art, relating to any continuing interest CITY or Artists may otherwise have in the art are hereby waived and, to the extent transferable, assigned and transferred to DDA.
- 2.5. *Controlling License and Waiver.* The provisions of this Agreement shall control over the provisions of 17 U.S.C. § 106A and, to the extent permitted by applicable law, shall constitute a waiver by CITY, including on behalf of Artist, and Artist of any rights in the Art set out in or otherwise granted by the Visual Artists Rights Act of 1990, 17 U.S.C. § 106A, and any provision contained in any domestic or international law, including without limitation the European Union law. If there is a conflict or inconsistency between any provision contained in this Agreement any such laws, CITY expressly represents and warrants to DDA that CITY and Artist each understand and agree that the provisions of this Agreement, and the licenses granted to DDA hereunder, shall control and shall constitute a waiver by each of CITY and Artist of any rights in the Art set out in or otherwise granted by any such laws.
- 2.6. *Taxes.* If any sales or use taxes, fines, or assessments are levied under this Agreement and are related to CITY's use of the Licensed Premises ("Taxes"), CITY shall directly pay such Taxes to the applicable taxing authority.
- 2.7. *Waiver of 1990 Visual Artists' Rights Act.* CITY represents and warrants that it has obtained from Artist the "Waiver of 1990 Visual Artists' Rights Act" included in **Exhibit D**.
3. **LICENSED PREMISES.**
- 3.1. *License.* DDA hereby grants to CITY the nonexclusive right, license, and privilege of accessing and using the portion of the DDA Property known as "Huizenga Park" that is more particularly described on **Exhibit B** attached hereto (the "Licensed Premises") in accordance with the terms of this Agreement.
- 3.2. *"As Is" Condition.* CITY has inspected the Licensed Premises and accepts the premises in "as is" condition, with no representation by DDA as to suitability, compliance with any required standards

or conditions, or compliance with any building, life/safety, disability, and other laws, codes, and regulations applicable to CITY's use of the Licensed Premises as contemplated by this Agreement.

- 3.3. *Use and Access.* CITY and its employees, agents, contractors, and subcontractors shall use and access the Licensed Premises only to prepare, install, maintain, inspect, remove, and operate, at CITY's sole option and cost, the Art for the purpose of enhancing the public experience. The Licensed Premises shall not be used by CITY for any other purpose whatsoever without the prior written consent of DDA. DDA shall allow CITY and its employees, agents, contractors, and subcontractors access to the Licensed Premises at times and dates to be agreed upon in advance between the respective designated staff contacts of CITY and DDA. DDA shall provide notice to CITY, and CITY shall comply with any applicable security or access restrictions for Huizenga Park or the Licensed Premises.
 - 3.4. *Liens.* CITY or its employees, agents, contractors or subcontractors shall have no power or authority to place any liens or other encumbrances of any kind or character upon the right, title, or interest of DDA in and to the Licensed Premises. CITY shall be responsible for the satisfaction or payment of any liens for any provider of work, labor, material or services claiming by, through, or under CITY. CITY shall also indemnify, hold harmless, and defend DDA against any such liens, including the reasonable attorney's fees of DDA. Such liens shall be discharged by CITY within thirty (30) calendar days after CITY receives notice from DDA of filing thereof, by bonding, payment, or otherwise, provided that CITY may contest, in good faith and by appropriate proceedings, any such liens.
 - 3.5. *Hazardous Materials, Waste Materials and Rubbish.* CITY agrees that CITY and its employees, agents, contractors, and subcontractors shall not (a) commit any waste, nuisance, or hazardous trade or occupation on, in, or upon any portion of Huizenga Park, (b) take any action, or keep anything in or about any portion of Huizenga Park that will increase the risk of any hazard, fire, or catastrophe, or (c) damage any portion of Huizenga Park; or (d) use or occupy any portion of Huizenga Park in any manner that will violate any applicable laws. CITY, at its own cost and expense, shall keep any portion of Huizenga Park utilized by CITY in the installation, placement or maintenance of the ART free from waste materials and rubbish during any such work, and shall remove any waste materials, rubbish, tools, equipment, machinery, and surplus materials from the any portion of Huizenga Park utilized by CITY during and upon completion of such work.
4. **DAMAGE; REMOVAL.**
- 4.1. The Art shall belong to CITY and shall be installed, maintained, and operated on the Licensed Premises at CITY's sole risk and obligation. CITY shall maintain the Art and shall inspect the Art at least bimonthly (every two months) and advise the DDA, in writing by e-mail, when the inspection is complete and the results of each such inspection. CITY shall repair any damage or perform any routine maintenance of the Art within seven (7) calendar days of each such inspection, unless DDA provides written approval of a longer time period. In the event that the Art cannot be repaired, CITY shall remove the Art within seven (7) calendar days of the inspection or such longer period of time as approved in writing by DDA. DDA shall provide CITY and its employees, agents, or subcontractors access to the Licensed Premises as reasonably requested for purposes of inspection, repair, maintenance, or removal.
 - 4.2. DDA shall not be liable for any damage to the Art, or any theft, misappropriation, or loss thereof, or any third parties' actions or omissions relating in any way to the Art, except in the event of the negligence or willful misconduct of DDA or its employees, agents, or contractors.
 - 4.3. **Sovereign Immunity:** Nothing herein shall be deemed, construed, or asserted as DDA or City waiving its sovereign immunity or waiving any limits established by Section 768.28, Florida Statutes.

- 4.4. CITY shall repair any damage of any kind or nature to the Licensed Premises or any portion of Huizenga Park caused by the use of the Licensed Premises by CITY or its employees, agents, contractors, or subcontractors. CITY shall give DDA prompt written notice, in compliance with the "Notices" section of this Agreement, of any occurrence, incident, or accident occurring on any portion of Huizenga Park relating to this Agreement.
5. **INSURANCE.**
- 5.1. The City represents that it maintains a program of self-insurance for coverage of the risks and liabilities for which this Agreement requires insurance from the City, and no commercial insurance policy shall be required of the City.
6. **DEFAULT/TERMINATION.**
- 6.1. Should either Party default in the performance of a material provision of this Agreement and fail to correct same within thirty (30) calendar days after having received notice specifying the nature of such default, unless such default is of a nature that it cannot be completely cured within thirty (30) calendar days, if a cure is not commenced within such time and thereafter diligently pursued to completion, then the non-defaulting Party may terminate this Agreement and may pursue all other remedies available to it at law and/or equity.
- 6.2. In the event of any violation of any representation or warranty provided by CITY under this Agreement, DDA may terminate this Agreement and CITY shall, upon request by DDA, remove the Art in accordance with Article 6 at DDA's sole cost and expense.
- 6.3. This Agreement may also be terminated for convenience by either Party upon providing written notice to the other Party of the termination date, which shall be not less than thirty (30) days after the date such written notice is provided.
7. **OTHER.**
- 7.1. *Assignment Or Subletting.* CITY shall not assign or transfer this Agreement without DDA's prior written consent, which will not be unreasonably withheld or conditioned or unduly delayed.
- 7.2. *Indemnification.* CITY shall at all times hereafter indemnify, hold harmless and defend DDA and all of DDA's current, former, and future officers, agents, servants, and employees (collectively, "Indemnified Party") from and against any and all causes of action, demands, claims, losses, liabilities, and expenditures of any kind, including reasonable attorneys' fees, court costs, and expenses (collectively, a "Claim"), raised or asserted by any person or entity not a party to this Agreement, which Claim is relating to personal injury, death, or damage to tangible personal property or is alleged to have resulted or alleged to be caused, in whole or in part, by any intentional, reckless, or negligent act or omission of CITY or its current or former officers, employees, agents, or servants, arising from, relating to, or in connection with this Agreement. In the event any Claim is brought against an Indemnified Party, CITY shall, upon written notice from DDA, defend each Indemnified Party against each such Claim by counsel approved in advance by DDA, approval of which shall not be unreasonably withheld. The obligations of this Section shall survive the expiration or earlier termination of this Agreement.
- 7.3. *Limitation Of Damages.* Neither Party shall be liable to the other Party for any of its lost profits, special, incidental, punitive, exemplary, or consequential damages, including, but not limited to, frustration of economic or business expectations, loss of profits, loss of capital, cost of substitute product(s), facilities or services, down time cost or cost of re-procurement, even if advised of the possibility of such damages.
- 7.4. *Materiality And Waiver Of Breach.* DDA and CITY each agree that each requirement, duty, and obligation set forth herein was bargained for at arms-length and is agreed to by the Parties in exchange for quid pro quo, that each is substantial and important to the formation of this

Agreement, and that each is, therefore, a material term hereof. Either Party's failure to enforce any provision of this Agreement shall not be deemed a waiver of such provision or modification of this Agreement. A waiver of any breach of a provision of this Agreement shall not be deemed a waiver of any subsequent breach and shall not be construed to be a modification of the terms of this Agreement.

7.5. *Notices.* In order for a notice to a party to be effective under this Agreement, notice must be sent via U.S. first-class mail, hand delivery, or commercial overnight delivery, each with a contemporaneous copy via e-mail, to the addresses listed below and shall be effective upon mailing or hand delivery (provided the contemporaneous email is also sent). The addresses for notice shall remain as set forth in this section unless and until changed by providing notice of such change in accordance with the provisions of this section.

NOTICE TO CITY: City of Fort Lauderdale, Florida
Attn: City Manager
401 SE 21st Street
Fort Lauderdale, FL 33301

With a copy to: City of Fort Lauderdale, Florida
Attn: City Attorney
1 E. Broward Blvd., Suite 1320
Fort Lauderdale, FL 33301

NOTICE TO DDA: Fort Lauderdale Downtown Development Authority
Attn: President & CEO
201 E Las Olas Blvd., Suite 1150
Fort Lauderdale, FL 33301
E-mail: jenni@ddaftl.org

With a copy to: Fort Lauderdale Downtown Development Authority
Attn: Executive Vice-President
201 E Las Olas Blvd., Suite 1150
Fort Lauderdale, FL 33301
E-mail: elizabeth@ddaftl.org

7.6. *Independent Contractor.* CITY is an independent contractor under this Agreement. Services provided by CITY pursuant to this Agreement shall be subject to the supervision of CITY. In providing such services, neither CITY nor its agents shall act as officers, employees, or agents of DDA. No partnership, joint venture, or other joint relationship is created hereby. DDA does not extend to CITY or CITY's agents any authority of any kind to bind DDA in any respect whatsoever.

7.7. *Third-Party Beneficiaries.* Neither CITY nor DDA intends to directly or substantially benefit a third party by this Agreement. Therefore, the Parties agree that there are no third-party beneficiaries to this Agreement and that no third party shall be entitled to assert a right or claim against either of them based upon this Agreement.

7.8. *Severance.* In the event that any part of this Agreement is found to be invalid by a court of competent jurisdiction, that part shall be severed from this Agreement and the balance of this Agreement shall remain in full force and effect unless both CITY and DDA elect to terminate the Agreement. The election to terminate this Agreement pursuant to this Section shall be made within seven (7) calendar days after the court's finding becomes final.

7.9. *Public Records.* To the extent CITY is acting on behalf of DDA as stated in Section 119.0701, Florida Statutes, DDA shall:

- 7.9.1. Keep and maintain public records required if DDA were performing the services of CITY under this Agreement;
 - 7.9.2. Upon request from DDA, provide DDA with a copy of the requested records or allow the records to be inspected or copied within a reasonable time and at a cost that does not exceed that provided in Chapter 119, Florida Statutes, or as otherwise provided by law;
 - 7.9.3. Ensure that public records that are exempt or that are confidential and exempt from public record requirements are not disclosed except as authorized by law for the duration of the Agreement and following completion of the Agreement if the records are not transferred to DDA; and
 - 7.9.4. At completion of the Agreement, transfer to DDA, at no cost, all public records in possession of CITY keep and maintain public records required by DDA to perform the service. If CITY transfers all public records to DDA, upon the completion of the Agreement, DDA shall destroy any duplicate public records that are exempt or confidential and exempt. If CITY keeps and maintains public records upon completion of the Agreement, CITY shall meet all applicable requirements for retaining public records. All records stored electronically must be provided to DDA upon request in a format that is compatible with the information technology systems of DDA.
 - 7.9.5. The failure of CITY to comply with the provisions of this Section shall constitute a material breach of this Agreement entitling DDA to exercise any remedy provided in this Agreement or under applicable law. A request for public records regarding this Agreement must be made directly to CITY, who will be responsible for responding to any such public records requests. CITY will provide any requested records to DDA to enable DDA to respond to the public records request.
- 7.10. *Joint Preparation.* The Parties hereto acknowledge that they have had the opportunity to seek and receive whatever competent advice and counsel as each Party deemed necessary for them to form a full and complete understanding of all rights and obligations herein and that the preparation of this Agreement has been a joint effort of the Parties, the language has been agreed to by the Parties to express their mutual intent, and the resulting document shall not, solely as a matter of judicial construction, be construed more severely against one of the Parties than the other.
- 7.11. *Jurisdiction, Venue, Waiver Of Jury Trial.* This Agreement shall be interpreted and construed in accordance with and governed by the laws of the State of Florida. The Parties agree and accept that jurisdiction of any controversies or legal problems arising out of this Agreement, and any action involving the enforcement or interpretation of any rights hereunder, shall be exclusively in the state courts of the Seventeenth Judicial Circuit in Broward County, Florida, and venue for litigation arising out of this Agreement shall be exclusively in such state courts, forsaking any other jurisdiction which either Party may claim by virtue of its residency or other jurisdictional device.
- BY ENTERING INTO THIS AGREEMENT, CITY AND DDA HEREBY EXPRESSLY WAIVE ANY RIGHTS EITHER PARTY MAY HAVE TO A TRIAL BY JURY OF ANY CIVIL LITIGATION RELATED TO THIS AGREEMENT.**
- 7.12. *Force Majeure.* Neither Party will be responsible for any delay, interruption, or other failure to perform under this Agreement due to acts or events beyond the reasonable control of the otherwise responsible Party. Force majeure events include, but are not limited to: natural disasters (e.g. lightning, earthquakes, hurricanes, floods); wars, riots, terrorist activities, and civil commotions; inability to obtain parts or equipment from third party suppliers, and cable cuts by third parties; explosions and fires; embargoes, strikes, and labor disputes; and governmental decrees.

7.13. *Multiple Originals; Counterparts.* This Agreement may be executed in multiple counterparts, each of which shall be deemed an original, but all of which, taken together, shall constitute one and the same agreement.

(THE REMAINDER OF THIS PAGE IS INTENTIONALLY LEFT BLANK)

IN WITNESS WHEREOF, the parties hereto have made and executed this Agreement: CITY OF FORT LAUDERDALE, FLORIDA, through its CITY COMMISSION, signing by and through its Mayor or Vice-Mayor and DDA through its BOARD OF DIRECTORS, signing by and through its President and CEO, authorized to execute same by Board action on October 9, 2025.

CITY OF FORT LAUDERDALE, FLORIDA

ATTEST:

David Soloman
David Soloman, City Clerk



CITY OF FORT LAUDERDALE, a municipal corporation of the State of Florida, By and through its City Commission

By: Dean J. Trantalis
Dean J. Trantalis, Mayor

16 day of March, 2026

By: Rickelle Williams
Rickelle Williams, City Manager

10th day of March, 2026

Approved as to form and correctness:
Shari L. McCartney, City Attorney

By: Shaun Amarnani
Shaun Amarnani, Assistant City Attorney

STATE OF FLORIDA
COUNTY OF BROWARD

The foregoing instrument was acknowledged before me by means of physical presence or online notarization, this 16 day of March, 2026, by DEAN J. TRANTALIS, Mayor of the City of Fort Lauderdale, a municipal corporation of Florida on behalf of the City of Fort Lauderdale. He is personally known to me or has produced _____ as identification.

Krystal Lazcano
Notary Public, State of Florida

KRYSTAL LAZCANO
Name of Notary Typed, Printed or Stamped

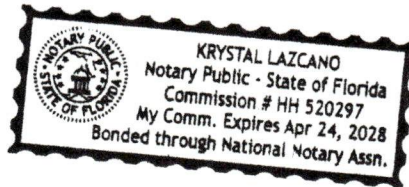

DOWNTOWN DEVELOPMENT AUTHORITY OF THE CITY OF FORT LAUDERDALE

ATTEST:

DDA, through its BOARD OF DIRECTORS

[Signature]

By [Signature]
Jenni Morejon, President & CEO
20 day of January 2026

STATE OF FLORIDA:
COUNTY OF BROWARD:

The foregoing instrument was acknowledged before me by means of physical presence or online notarization, this 20th day of January, 2026, by JENNI MOREJON, PRESIDENT & CEO of DOWNTOWN DEVELOPMENT AUTHORITY OF FORT LAUDERDALE, FLORIDA, a special taxing district established by State Legislature.

[Signature]
Signature: Notary Public, State of Florida

(SEAL)



Personally Known or _____ Provided Identification

Name of Notary Typed, Printed or Stamped
Alexandra Saiz

EXHIBIT A
DESCRIPTION OF ART

EXHIBIT B
LICENSED PREMISES

EXHIBIT C
CONSTRUCTION PLANS

EXHIBIT D
WAIVER OF 1990 VISUAL ARTISTS' RIGHTS ACT

EXHIBIT A
Description of Art



**CITY OF FORT LAUDERDALE
City Commission Agenda Memo
REGULAR MEETING**

#24-0554

TO: Honorable Mayor & Members of the
Fort Lauderdale City Commission

FROM: Susan Grant, Acting City Manager *Susan Grant*

DATE: May 21, 2024

TITLE: **Walk On** - Acquisition of Manolo Valdes Sculpture - **(District 4)**

Recommendation

Staff recommends the City Commission approve the acquisition of Manolo Valdes' *Head with Butterflies* as an integral part of the James Winder Laird Donation and authorize the placement of the sculpture within Huizenga Park. The City will retain ownership of the sculpture and will work with the Downtown Development Authority to place the sculpture.

Background

In November of 2022 the City Commission approved the donation of \$5,000,000 from the James Winder Laird estate to fund the acquisition, installation, and maintenance of public art throughout the City. The City has an opportunity to acquire a sculpture by Manolo Valdes titled, *Head with Butterflies* for \$800,000. The sculpture will be displayed within Huizenga Park.

Resource Impact

There is no fiscal impact associated with this action. The sculpture will be acquired by the Estate for \$800,000 and installed at their sole expense.

Strategic Connections

This item is a *2024 Top Commission Priority*, advancing the Parks and Public Places initiative of City beautification.

This item supports the *Press Play Fort Lauderdale 2029 Strategic Plan*, specifically advancing:

- The Public Places Focus Area
- Goal 5: Build a beautiful and welcoming community.
- Objective: Improve the appearance of public parks, green spaces, and landscapes while attracting visitors and creating a sense of place for neighbors.

This item advances the *Fast Forward Fort Lauderdale 2035 Vision Plan: We Are Here*

This item supports the Advance Fort Lauderdale 2040 Comprehensive Plan specifically advancing:

- The Parks, Recreation, and Open Space Focus Area
- The Public Art in Parks Element
- Goal 2: Be a community with high quality parks and recreational facilities that highlight the character of our City.

Attachment

Exhibit 1 – Manolo Valdes *Head with Butterflies*

Prepared by: Joshua Carden, Cultural Affairs Officer

Department Director: Christopher Cooper, AICP, Development Services
Department



Manolo Valdes
Head with Butterflies
10 feet (h)
2011
Purchase Price: \$800,000.

EXHIBIT B
Licensed Premises



Huizenga Park
 Fort Lauderdale, Florida
 July 17, 2025

- | | | | |
|---------------------------|-----------------------|------------------------|---------------------|
| 1. Las Olas Plaza | 6. Civic Lawn | 11. New River Landing | 16. Liberty Circle |
| 2. Legacy Terrace | 7. Valet Drop-off | 12. Poppy's Play Patch | 17. River View |
| 3. Spirit of FTL Fountain | 8. The Nook | 13. Andrews Ave Plaza | 18. Water Taxi Stop |
| 4. Stiles Pavilion | 9. Dining Terrace | 14. Riverwalk | |
| 5. The Dog Spot | 10. Future Restaurant | 15. Riverwalk Terrace | |

EXHIBIT C

Construction Plans

MAYOR & COMMISSION

Mayor Dean J. Trantalis
 John C. Herbst
 Vice Mayor/Commissioner - District 1
 Steven Cassman
 Commissioner - District 2
 Pamela Beasley-Pitman
 Commissioner - District 3
 Ben Sorenson
 Commissioner - District 4

MANOLO VALDES SCULPTURE

Huizenga Park

City of Fort Lauderdale, Florida



RVL
 ARCHITECTURE + DESIGN



1000 WEST PALM BLVD. SUITE 500
 FORT LAUDERDALE, FL 33304



OFFICE OF THE ARCHITECTURAL
 REVIEW BOARD
 1000 WEST PALM BLVD. SUITE 500
 FORT LAUDERDALE, FL 33304
 (954) 438-2222
 WWW.FORTLAUDERDALEFLORIDA.GOV



DATE	DESCRIPTION

COVER

PROJECT NAME: 1987
 SHEET NO.: 10-001
 DRAWING: EC | PRELIMINARY: DL
 PROJECT NUMBER: 2014
 SHEET NUMBER:

A-001



INDEX OF DRAWINGS	
DESCRIPTION	ISSUE DATE / REVISIONS
ARCHITECTURAL DRAWINGS	
A-001 COVER	
A-002 GENERAL NOTES / SCOPE OF WORK	
A-003 GENERAL NOTES	
A-004 SCHEMATIC RENDERING AND FACTORS	
A-005 SITE SCULPTURE LOCATION PLAN	
A-002 SCULPTURE BASE PLAN, SECTIONS AND DETAILS	
STRUCTURAL DRAWINGS	
S-1 SECTIONS AND DETAILS	

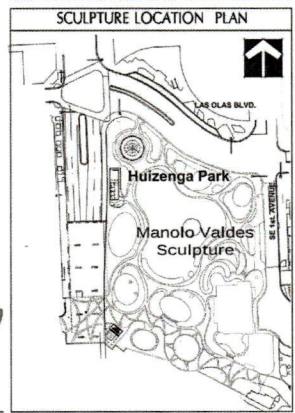

GENERAL CONTRACTOR



TEAM CONTRACTING, INC.
 126 SW 42ND STREET, SUITE 309 - MIAMI, FL 33135 - PHONE: 781-999-9789 FAX: 781-999-9790

ARCHITECTS

RVL ARCHITECTURE + DESIGN, PA
 ARCHITECTURE DESIGN PLANNING
 1380 SW 15TH STREET - SUITE 807 - MIAMI, FLORIDA 33136 - PHONE: 781-999-9789 FAX: 781-999-9790

STRUCTURAL ENGINEER

JUAN FERNANDEZ - BARQUIN
 250 NW 97TH AVENUE - SUITE 340 - CORAL GABLES, FLORIDA 33172 - PHONE: 305-443-0800 FAX: 305-443-0801

© 2014 RVL Architecture + Design, PA. All Rights Reserved. RVL and TEAM are registered trademarks of RVL Architecture + Design, PA.

0124 West Lake Drive - Sierra Account Equipment - (P) 414 424-1100 / (F) 414 424-1101
 0124 West Lake Drive
 Fort Lauderdale, FL 33309

FVL
FORT LAUDERDALE
CITY OF FORT LAUDERDALE

FOR MORE INFORMATION, VISIT
WWW.FORTLAUDERDALEFL.GOV
OR CALL 305.461.1100

CITY OF FORT LAUDERDALE
CITY MANAGER
CITY COMMISSIONERS

MARCO VALDES
SCULPTURE
SCULPTURE PLACEMENT

PROJECT NAME: SCULPTURE
PROJECT NO.: 15-0000000000
PROJECT LOCATION: 15-0000000000
PROJECT DATE: 15-0000000000
PROJECT STATUS: 15-0000000000
PROJECT TYPE: 15-0000000000
PROJECT VALUE: 15-0000000000

SCHEMATIC RENDERING AND PHOTO

NO.	DESCRIPTION	DATE
1	SCULPTURE / STORAGE PHOTOS	15-0000000000
2	SCULPTURE / SCHEMATIC RENDERING	15-0000000000

A-004

2 SCULPTURE / SCHEMATIC RENDERING

LEFT VIEW

FRONT VIEW

RIGHT VIEW

BACK VIEW

4 SCULPTURE / SCHEMATICS RENDERINGS VIEWS

3 SCULPTURE / EXISTING PLATE DETAIL

3 SCULPTURE / NEW PLATE DETAIL

3/4" CONTINUOUS WELD
NEW 8"x10"x1/2" ALUMINUM BEZELLED PLATE BEHIND EXISTING PLATE
NOTE: SEE DIMENSIONS AT DETAILS 15-1 AND 15-1

1 SCULPTURE / STORAGE PHOTOS

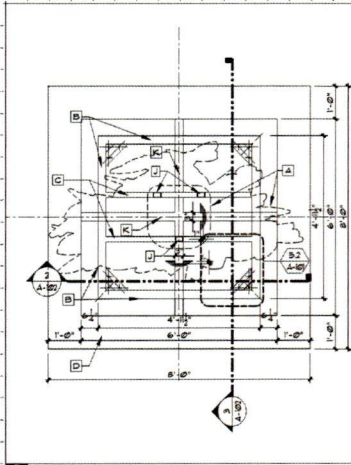

1.1 MVS - EXISTING SCULPTURE BASE FRAMING PLATFORM

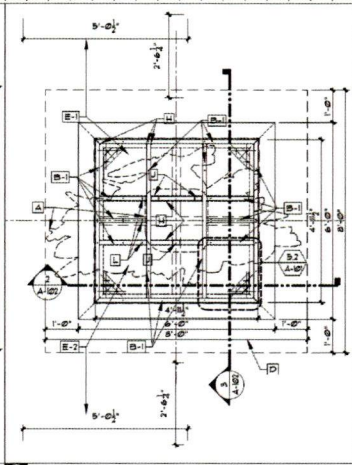

1.2 MVS - ADDED SCULPTURE BASE COVER PLATE FRAMING MEMBERS

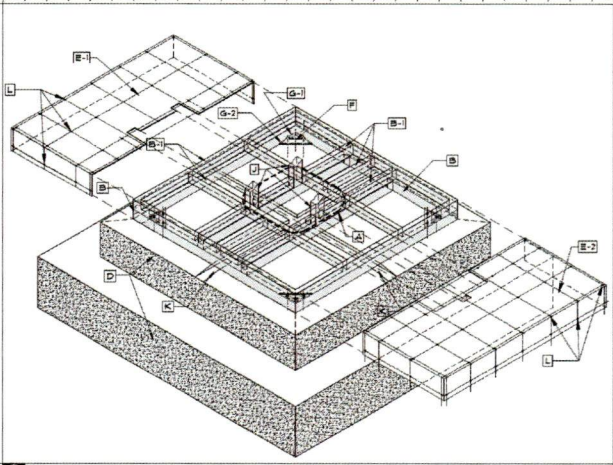

6 MVS - CONCRETE FOOTING / ISOMETRIC

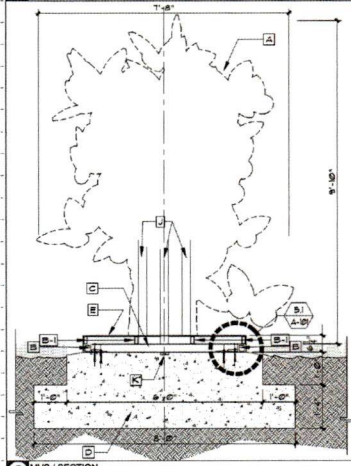

2 MVS / SECTION

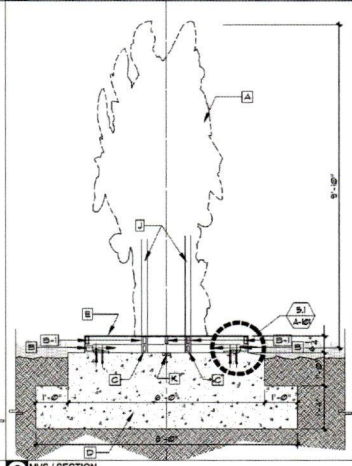

3 MVS / SECTION

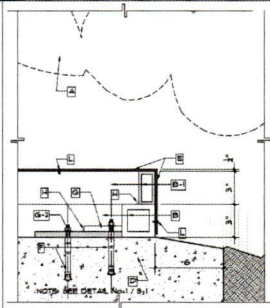

5.1 MVS / ANCHORING SECTION DETAIL - TYPICAL

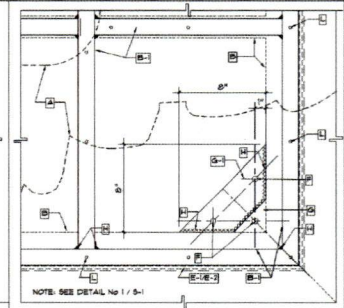

5.2 MVS / ANCHORING DETAIL - TYPICAL

- 1 MANOLO VALDES SCULPTURE (MVS) OUTLINE
- 2 3" X 3" X 3/16" MVS EXISTING PLATFORM FRAME ALUMINUM TUBE
- 3 NEW 1/2" X 3" X 3/16" ALUMINUM TUBE COVER PLATE SUPPORT FRAMING
- 4 2" X 3" X 3/16" MVS EXISTING PLATFORM FRAME ALUMINUM TUBE
- 5 NEW CONCRETE FOOTING MVS FOUNDATION
- 6 1/4" THK ALUMINUM PLATFORM COVER PLATES 6061-T651 A571 5525
- 7 1/4" THK ALUMINUM PLATFORM COVER PLATES 6061-T651 A571 5525
- 8 EXPANSION BOLTS (SEE STRUCTURAL DGS)
- 9 MVS EXISTING ALUMINUM ANCHORING PLATE
- 10 8" X 8" X 1/2" THK ALUMINUM ADDED TRIANGULAR BASE SUPPORT PLATE
- 11 3/8" CONTINUOUS WELD
- 12 2" X 3" VERTICAL ALUMINUM FRAMING TUBE
- 13 7" X 3" CONCRETE DRAINAGE CHANNEL # TOP OF FOOTING
- 14 8" X 1/2" TORX PAN HEAD SELF TAPPING 66 SCREW

4 MVS / LEGEND

RVL
ARCHITECTURE + DESIGN

1500 SW 17th Street, Suite 100
Fort Lauderdale, FL 33304

CITY OF FORT LAUDERDALE

MANOLO VALDES
SCULPTURE

PLACEMENT

SCULPTURE BASE PLAN
SECTIONS AND DETAILS

PROJECT NAME: MVS
DRAWN BY: JAC
CHECKED BY: JAC
DATE: 12-15-2025
SCALE: AS SHOWN
SHEET NUMBER: 2514

A-102

© 2025 Manolo Valdes Sculpture - All Rights Reserved. No reproduction or distribution without permission.



JUAN FERNANDEZ-BARQUIN, P.E.

STRUCTURAL ENGINEER * THRESHOLD INSPECTOR * PLANS EXAMINER

2520 NW 97TH Ave, Suite 240, Doral, FL 33172
Ph: 786-336-0881 / E-mail: jfbeng@f-m.fm

**526 NW 34TH STREET
MIAMI, FLORIDA 33127**

STRUCTURAL CALCULATIONS

12/04/2025

**JUAN A
FERNANDEZ
Z-BARQUIN**

Digitally signed by JUAN A FERNANDEZ-BARQUIN
DN: c=US, o=Unaffiliated, dnQualifier=A01410C000019A2884B84B00043F57, cn=JUAN A FERNANDEZ-BARQUIN
Date: 2025.12.04 16:20:17 -05'00'

TABLE OF CONTENTS	PAGE
WIND LOAD DESIGN	1
FOUNDATION DESIGN	6
GEOTECHNICAL REPORT	12



JUAN FERNANDEZ-BARQUIN, P.E.
 STRUCTURAL ENGINEER * THRESHOLD INSPECTOR * PLANS EXAMINER

PROJECT NAME 526 NW 34TH Street
 ENGINEER _____ DATE 11-2023 PAGE 1

* WIND Load Foot Load data

Wind @ 170 MPH Exposure: C

ASCE 7-22 Risk - II

INCLUDE ASD

RIGID $h = 9.89 \text{ ft}$

$K_d = 0.85$ $width = 2.67 \text{ ft}$

Gust Factor $G = 0.85$ $D. of Return = 3.92 \text{ ft}$ $\times 7'8'' \times$

$W = 3.11''$ Vertical Height of sign = 9.84 ft

$L = 7'8''$ solid sign solidity Ratio = 1.0

thickness of sign = 3.92 ft

MecaWind v2422

Developed by Meca Enterprises Inc., www.mecaenterprises.com, Copyright © 2025

Calculations Prepared by:

Date: Nov 20, 2025

File Location: Current Project Not Saved

2

General:

Wind Load Standard	= ASCE 7-22	Basic Wind Speed	= 170.0 mph
Exposure Classification	= C	Risk Category	= II
Structure Type	= Solid Sign	Design Basis for Wind Pressures	= ASD
Dynamic Type of Structure	= Rigid	MWFRS Analysis Method	= Ch 29
C&C Analysis Method	= None	Base Elevation Of Structure	= 0.000 ft
MWFRS Pressure Elevations	= Automatic	Topographic Effects	= None
Show Base Reactions in Output	= None	Override Directionality Factor K_d	= True
Manually Specified Directionality Factor K_d	= 0.8500	Override the Gust Factor G	= True
Override the Gust Factor	= 0.8500		

Solid Sign Inputs:

h	= Height from Grade to Top of Solid Sign	= 9.840 ft
S	= Height of Solid Sign	= 9.840 ft
B	= Width of Solid Sign	= 7.670 ft
T	= Thickness of Solid Sign	= 3.920 ft
L_r	= Dimension of return corner L_r	= 1.000 ft
e	= Solidity Ratio	= 1.0000
AttachWall	= Attached to Wall	= False
Dbf	= Double Faced & All Sides Enclosed	= False
IsCol	= Supported on Columns	= False

Exposure Constants [Table 26.11-1]:

α = 3-s Gust-speed exponent	= 9.800	Z_g = Nominal Ht of Boundary Layer	= 2460.000 ft
â = Recipical of α	= 0.102 ft	b = 3 sec gust speed factor	= 1.000
α_m = Mean hourly Wind-Speed Exponent	= 0.156	b_m = Mean hourly Windspeed Exponent	= 0.660
c = Turbulence Intensity Factor	= 0.200	ε = Integral Length Scale Exponent	= 0.2000

Gust Factor Calculation for Wind:

Gust Factor Category I Rigid Structures - Simplified Method

G ₁	= For Rigid Structures (Natural Frequency > 1 Hz) use 0.85	= 0.85
----------------	--	--------

Gust Factor Category II Rigid Structures - Complete Analysis

Z _m	= Equiv Height of Struc: Max(0.6*Ht, Z _{min})	= 15.000 ft
I _{zm}	= Intensity of Turbulence at height Z _m : $c \cdot (33/Z_m)^{1/6}$ [Eqn 26.11-7]	= 0.228
L _{zm}	= Integral Length Scale of Turbulence [Eqn 26.11-9]	= 427.057 ft
B	= Avg Structure Width Normal to Wind Direction	= 7.670 ft
Q	= $1/(1+0.63 \cdot [(B+Ht)/L_{zm}]^{0.63})$ [Eqn 26.11-8]	= 0.960
G ₂	= $0.925 \cdot ((1+1.7 \cdot 3.4 \cdot I_{zm} \cdot Q) / (1+1.7 \cdot 3.4 \cdot I_{zm}))$	= 0.904

Gust Factor Used in Analysis

G	= User has elected to override the calculated G value	= 0.850
G	= Gust Factor: Min(G ₁ , G ₂)	= 0.850

Main Wind Force Resisting System (MWFRS) Wind Calculations for Solid Sign per Sec 29.4

h	= Mean structure height	= 9.840 ft
K _z	= $2.41 \cdot (15/Z_g)^{2/\alpha}$ [Table 26.10-1]	= 0.851
K _{zt}	= No Topographic feature specified	= 1.000
K _d	= Wind Directionality Factor Manually Specified by Designer	= 0.85
+GC _{pi}	= Positive Internal Pressure for Enclosed [Table 26.13-1]	= +0.18
-GC _{pi}	= Negative Internal Pressure for Enclosed [Table 26.13-1]	= -0.18
LF	= Load Factor based upon ASD Design	= 0.60
q _h	= $0.00256 \cdot K_h \cdot K_{zt} \cdot K_e \cdot V^2 \cdot LF$ [Eqn 26.10-1]	= 37.78 psf
K _e	= Ground Elevation Factor: $e^{-0.000362 \cdot 2g}$ [Table 26.10-1]	= 1.000

MWFRS Wind Pressures on Solid Sign per Fig 29.3-1

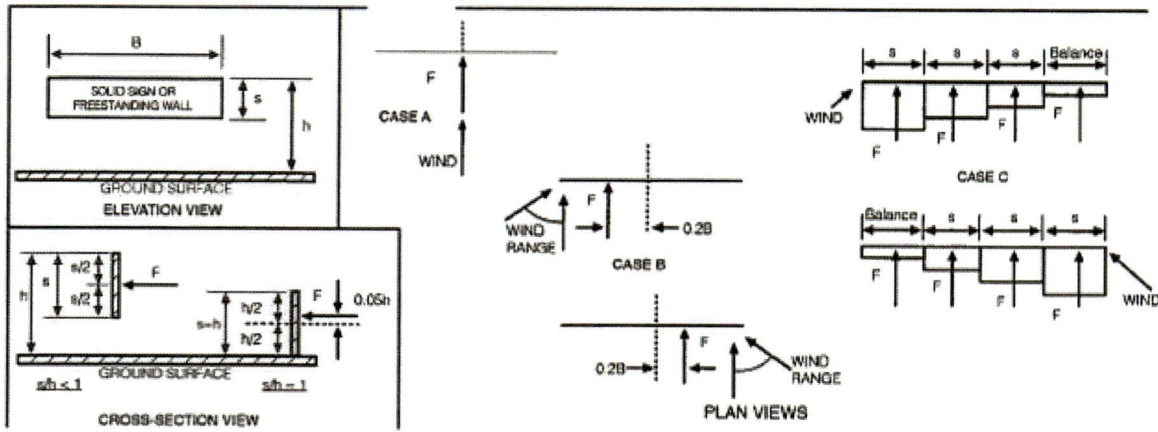

R	= Reduction factor to account for openings: $(1 - (1 - e)^{1.5})$	= 1.000
Rc	= Reduction factor for Case C since $s/h > 0.8$: $(1.8 - s/h)$	= 0.800
As	= Gross Area of Solid Sign: $B * s$	= 75.47 ft ²
B/s	= Aspect Ratio: B / s	= 0.779
s/h	= Clearance Ratio: s / h	= 1.000
Cf	= Net Force Coefficient for Case A and B per Fig 29.3-1	= 1.494
e	= Not Double Faced, Case B eccentricity is 0.2	= 0.2000

Case A: Resultant force acts normal to face through geometric center and since $s/h = 1$ then consider force acting $0.05*s$ above the geometric center

0.05*s	= Since $s/h = 1$, load applied at vertical offset from geom center	= 0.492 ft
F	= Wind Force: $q_z * K_d * G * C_f * A_s * Qty$ [Eqn 29.3-1]	= 3078 lb

Case B: Resultant force acts normal to face at a distance from the geometric center toward the windward edge equal to e times the average width and since $s/h = 1$ then consider force acting $0.05*s$ above the geometric center

0.05*s	= Since $s/h = 1$, load applied at vertical offset from geom center	= 0.492 ft
Dx	= Force Offset from Center toward windward edge: $e * B$	= 1.534 ft
F	= Wind Force: $q_z * K_d * G * C_f * A_s * Qty$ [Eqn 29.3-1]	= 3078 lb
F1	= Reduced Design Force: $F * R$	= 3078 lb

Case C: Since $B/s < 2$ then Case C need not be considered

$9.84 \times 7.67 = \underline{75.47} \text{ ft}^2$

Wind pressure :

$$\frac{3078}{75.47} = 40.8 \text{ PSF}$$



JUAN FERNANDEZ-BARQUIN, P.E.
 STRUCTURAL ENGINEER * THRESHOLD INSPECTOR * PLANS EXAMINER

PROJECT NAME 526 NW 34TH Street
 ENGINEER _____ DATE 11-20-25 PAGE 4

Foundation Design

wind pressure = 41 psf

$w = 41 \text{ psf} (7.67) = 314.5 \text{ plf} = \underline{0.32 \text{ kcf}}$

$M_w = \frac{1}{2} (0.32) (9.84)^2 = 15.49 \text{ k-ft}$

$M_v = (0.32) (9.84) \times 2 = 6.30 \text{ k-ft}$

$M_T = 15.49 + 6.30 = 21.79 \text{ k-ft}$

$S = \frac{8 \times 8^2}{6} \rightarrow S = 85.33$

$f_b = \frac{M}{S} = \frac{21.79 \text{ k-ft}}{85.33 \text{ ft}^3} = 0.26 \text{ ksf}$

$D = 1.8 \text{ k} + \frac{144 (8.0 \times 8.0) \times 1.34}{1000} + \frac{144 (5.16 \times 5.16) \times 1}{1000}$

$D_{\text{conc}} = 1.8 + 12.39 + 3.83 = 17.97 \text{ k}$

$D_{\text{soil}} = \frac{100 (8.0 + 8.0) \times 1.42 \times 1}{1000} + \frac{100 (5.16 + 5.16) \times 1.42 \times 1}{1000}$

$D_{\text{soil}} = 2.72 \text{ k} + 1.61 = 4.33 \text{ k}$

$D = 17.97 + 4.33 = 22.3 \text{ k}$

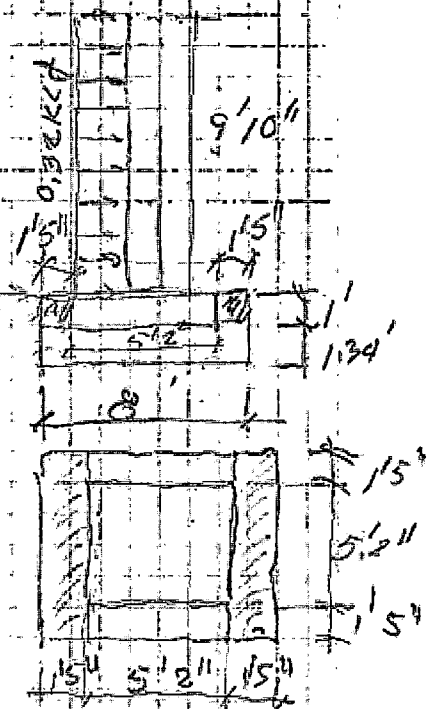

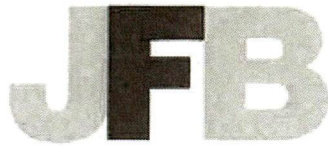

JUAN FERNANDEZ-BARQUIN, P.E.
 STRUCTURAL ENGINEER * THRESHOLD INSPECTOR * PLANS EXAMINER

PROJECT NAME _____
 ENGINEER _____ DATE _____ PAGE 5

allowab soil bearing = 1.5 ksf

$$f_b = 0.6D + 0.6W$$

$$f_b = \frac{0.6(22.3) + 0.26}{8 \times 0.21} = 0.47$$

$$e = \frac{21.79 \text{ k-ft}}{13.38} = 1.63 \text{ ft}$$

$$a = \left(\frac{8}{2} - 1.63 \right) \times 3 = 7.11 \text{ ft}$$

$$P = \frac{1}{2} f_b \times a \times b$$

$$f_b = \frac{2(P)}{a \times b} = \frac{2 \times 13.38}{7.11 \times 8} \Rightarrow f_b = 0.47$$

$$\text{overturning} = \frac{P \times 4}{M}$$

$$\text{over} = \frac{13.38 \times 4}{21.79} = 2.45 > 1.67 \text{ OK}$$

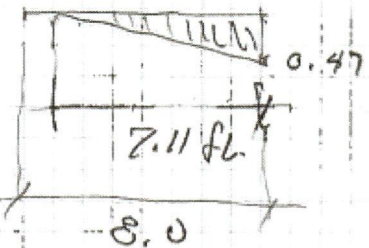
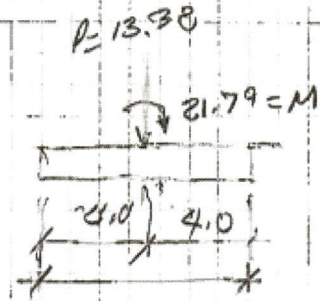

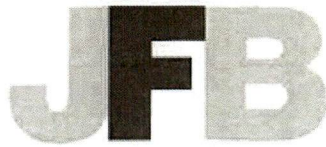

JUAN FERNANDEZ-BARQUIN, P.E.
 STRUCTURAL ENGINEER * THRESHOLD INSPECTOR * PLANS EXAMINER

PROJECT NAME 526 NW 34TH STREET Fort Lauderdale
 ENGINEER _____ DATE 11-2025 PAGE 6

* CONNECTION DESIGN 5.17 - 0.5 - 0.5 = 4.17

$$T = C = \frac{M}{d} = \frac{21.79}{4.17} = 5.23$$

$$V = 0.32 \times 9.84 = 3.15$$

$$T = C \text{ per bolt} = \frac{5.23 \text{ k}}{4} = 1.31 \text{ k} = 1310 \# \text{ PER EXPANSION bolt}$$

$$V \text{ per bolt} = \frac{3.15}{8} = 0.40 \text{ k PER EXPANSION bolt}$$

try 3/4" diam stainless steel Expansion bolt (normal concrete)

$f'_c = 4000 \text{ psi}$ embedment 4 3/4"
 allowable tension = 3870 #
 allowable shear = 5645 #

$f_{TV} = 0.62$ (spacing)
 $f_{RW} = 0.81$ (edge distance)

$$\text{allowable tension} = 3870 \# \times 0.62 \times 0.81 = 1949 \#$$

$$1949 > 1310 \#$$

Kwik Bolt 3 Expansion Anchor 4.3.5

Table 4 - Stainless Steel Kwik Bolt 3 Allowable Loads in Normal-Weight Concrete¹

Anchor Diameter in. (mm)	Embedment Depth in. (mm)	$f'_c = 2000$ psi (13.8 MPa)		$f'_c = 3000$ psi (20.7 MPa)		$f'_c = 4000$ psi (27.6 MPa)		$f'_c = 6000$ psi (41.4 MPa)	
		Tension lb (kN)	Shear ² lb (kN)	Tension lb (kN)	Shear ² lb (kN)	Tension lb (kN)	Shear ² lb (kN)	Tension lb (kN)	Shear ² lb (kN)
1/4 (6.4)	1-1/8 (29)	260 (1.2)	595 (2.6)	320 (1.4)	675 (3.0)	380 (1.7)	725 (3.2)	470 (2.1)	805 (3.6)
	2 (51)	540 (2.4)	675 (3.0)	625 (2.8)		705 (3.1)	805 (3.6)	910 (4.0)	
	3 (76)	685 (3)	750 (3.3)	810 (3.6)		910 (4.0)			
3/8 (9.5)	1-5/8 (41)	605 (2.7)	880 (3.9)	670 (3.0)	1110 (4.9)	730 (3.2)	1345 (6.0)	950 (4.2)	1690 (7.5)
	2-1/2 (64)	1285 (5.7)	1655 (7.4)	1430 (6.4)	1655 (7.4)	1575 (7.0)	1870 ³ (8.3)	1940 (8.6)	1870 ³ (8.3)
	3-1/2 (89)	1620 (7.2)	1755 (7.8)	1755 (7.8)	1885 (8.4)	2035 (9.1)			
1/2 (12.7)	2-1/4 (57)	1015 (4.5)	1875 (8.3)	1230 (5.5)	2130 (9.5)	1450 (6.4)	2380 (10.6)	1620 (7.2)	2740 (12.2)
	3-1/2 (89)	1445 (6.4)	3170 ³ (14.1)	1975 (8.8)	3170 ³ (14.1)	2510 (11.2)	3580 ⁴ (15.9)	2655 (11.8)	3580 ⁴ (15.9)
	4-3/4 (121)	1990 (8.9)	2250 (10.0)	2250 (10.0)	2510 (11.2)	2985 (13.3)			
5/8 (15.9)	2-3/4 (70)	1650 (7.3)	2875 (12.8)	1755 (7.8)	3485 (15.5)	1860 (8.3)	4095 (18.2)	2335 (10.4)	4870 (21.7)
	4 (102)	2455 (10.9)	4870 (21.7)	2900 (12.9)	4870 (21.7)	3340 (14.9)	4395 (19.5)	4395 (19.5)	
	5-1/2 (140)	3480 (15.5)	3885 (17.3)	3885 (17.3)	4290 (19.1)	6260 (27.8)			
3/4 (19.1)	3-1/4 (83)	1550 (6.9)	3945 (17.5)	1950 (8.7)	4260 (18.9)	2350 (10.5)	5645 (25.1)	2610 (11.6)	5645 (25.1)
	4-3/4 (121)	2510 (11.2)	5535 (24.6)	3250 (14.5)	5535 (24.6)	3870 (17.2)	4670 (20.8)	4670 (20.8)	
	6-1/2 (165)	2930 (13.0)	3870 (17.2)	3870 (17.2)	4530 (20.2)	5120 (22.8)			
1 (25.4)	4-1/2 (114)	3120 (13.9)	6080 (27.0)	3870 (17.2)	6770 (30.1)	4610 (20.5)	7420 (33.2)	4800 (21.4)	7470 (33.2)
	6 (152)	4400 (19.6)	7470 (33.2)	6400 (28.5)	7470 (33.2)	7200 (32.0)	7330 (32.6)	7330 (32.6)	
	9 (229)	5600 (24.9)	8000 (35.6)	8000 (35.6)	9390 (41.8)	9390 (41.8)			

- Intermediate load values for other concrete strengths and embedments can be calculated by linear interpolation.
- Unless otherwise noted, values shown are valid for the shear plane acting through either the anchor body or the anchor threads.
- Values shown are for a shear plane through the anchor body. When the shear plane is acting through the the anchor threads, reduce the shear value by 5%.
- Values shown are for a shear plane through the anchor body. When the shear plane is acting through the the anchor threads, reduce the shear value by 15%.

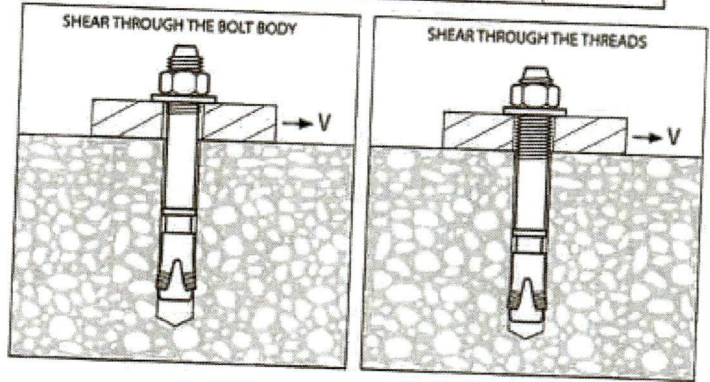

4.3.5 Kwik Bolt 3 Expansion Anchor

Influence of Edge Distance and Anchor Spacing on Anchor Performance

Load Adjustment Factors for 5/8 in. Diameter Anchors									
Adjustment Factor 5/8 in.	Spacing Tension f_{AN}		Edge Distance Tension, f_{AN}		Spacing Shear f_{AN}		Edge Distance Shear		
	2-3/4	≥4	2-3/4	≥4	2-3/4	≥4	⊥ toward edge f_{N1}	∥ to edge f_{N2}	⊥ away from edge f_{N3}
Embedment Depth, in.	2-3/4	≥4	2-3/4	≥4	2-3/4	≥4	≥2-3/4	≥2-3/4	≥2-3/4
Spacing (in.)	2-3/4	0.60	0.80	0.90					
	3-1/2	0.69	0.87	0.92					
	4	0.75	0.60	0.92	0.80	0.94	0.90		
	4-1/4	0.77	0.62	0.95	0.82	0.94	0.91	0.52	0.61
	4-3/4	0.83	0.66	1.00	0.85	0.96	0.92	0.58	0.66
	5-1/2	0.92	0.72		0.90	0.98	0.93	0.67	0.73
	6	0.98	0.76		0.93	0.99	0.94	0.73	0.78
	6-1/4	1.00	0.78		0.95	1.00	0.95	0.76	0.81
	7		0.84		1.00		0.96	0.85	0.88
	7-1/2		0.88				0.97	0.91	0.93
	7-3/4		0.90				0.98	0.94	0.95
	8-1/2		0.96				0.99	1.00	1.00
9		1.00							

Load Adjustment Factors for 3/4 in. Diameter Anchors									
Adjustment Factor 3/4 in.	Spacing Tension f_{AN}		Edge Distance Tension, f_{AN}		Spacing Shear f_{AN}		Edge Distance Shear		
	3-1/4	≥4-3/4	3-1/4	≥4-3/4	3-1/4	≥4-3/4	⊥ toward edge f_{N1}	∥ to edge f_{N2}	⊥ away from edge f_{N3}
Embedment Depth, in.	3-1/4	≥4-3/4	3-1/4	≥4-3/4	3-1/4	≥4-3/4	≥3-1/4	≥3-1/4	≥3-1/4
Spacing (in.)	3-3/8	0.61	0.81	0.90					
	4	0.67	0.86	0.92					
	5	0.77	0.62	0.94	0.81	0.94	0.90	0.51	0.61
	5-3/4	0.85	0.67	1.00	0.86	0.96	0.92	0.59	0.67
	6-1/4	0.90	0.70		0.88	0.97	0.93	0.64	0.71
	6-1/2	0.92	0.72		0.90	0.98	0.93	0.67	0.73
	7	0.97	0.75		0.93	0.99	0.94	0.72	0.77
	7-1/2	1.00	0.79		0.95	1.00	0.95	0.77	0.82
	8-1/4		0.84		1.00		0.96	0.85	0.88
	9		0.89				0.97	0.92	0.94
	9-3/4		0.94				0.98	1.00	1.00
	10-1/4		0.97				0.99		
10-3/4		1.00				1.00			

Load Adjustment Factors for 1 in. Diameter Anchors									
Adjustment Factor 1 in.	Spacing Tension f_{AN}		Edge Distance Tension, f_{AN}		Spacing Shear f_{AN}		Edge Distance Shear		
	4-1/2	≥6	4-1/2	≥6	4-1/2	≥6	⊥ toward edge f_{N1}	∥ to edge f_{N2}	⊥ away from edge f_{N3}
Embedment Depth, in.	4-1/2	≥6	4-1/2	≥6	4-1/2	≥6	≥4-1/2	≥4-1/2	≥4-1/2
Spacing (in.)	4-1/2	0.60	0.80	0.90					
	6	0.71	0.60	0.89	0.80	0.93	0.90		
	7	0.78	0.65	0.95	0.84	0.94	0.91	0.52	0.61
	8	0.85	0.71	1.00	0.89	0.96	0.93	0.59	0.67
	9	0.92	0.76		0.93	0.98	0.94	0.67	0.73
	9-3/4	0.97	0.80		0.97	0.99	0.95	0.72	0.78
	10-1/4	1.00	0.83		0.99	1.00	0.96	0.76	0.81
	11-1/4		0.88		1.00		0.97	0.83	0.87
	11-5/8		0.90				0.98	0.86	0.89
	12-1/2		0.95				0.99	0.93	0.94
	13		0.97				0.99	0.96	0.97
	13-1/2		1.00				1.00	1.00	1.00
14-3/4									

Standard Anchor Embedments (in.)		
5/8	h_{min}	2-3/4
	h_{nom}	4
	h_{deep}	5-1/2
3/4	h_{min}	3-1/4
	h_{nom}	4-3/4
	h_{deep}	6-1/2 ¹
1	h_{min}	4-1/2
	h_{nom}	6
	h_{deep}	9

1 Embedment depth shown reflects embedment for carbon steel anchor, deep embedment depth for stainless steel anchor is 8 inch.

Note: Tables apply for listed embedment depths. Reduction factors for other embedment depths must be calculated using equations below.

Spacing — Tension	
$h_{min} \leq h_{act} \leq h_{nom}$	$h_{act} \geq h_{nom}$
$f_{AN} = \frac{s/h_{act} + 0.88}{3.13}$	$f_{AN} = \frac{s/h_{nom} + 0.88}{3.13}$

Edge Distance — Tension	
$h_{min} \leq h_{act} \leq h_{nom}$	$h_{act} \geq h_{nom}$
$f_{AN} = \frac{c/h_{act} + 2}{3.75}$	$f_{AN} = \frac{c/h_{nom} + 2}{3.75}$

Spacing — Shear	
$h_{min} \leq h_{act} \leq h_{nom}$	$h_{act} \geq h_{nom}$
$f_{AN} = \frac{s/h_{act} + 10.25}{12.5}$	$f_{AN} = \frac{s/h_{nom} + 10.25}{12.5}$

Edge Distance — Shear	
$h_{act} \geq h_{min}$	
perpendicular toward edge	
$f_{N1} = \frac{c}{3h_{min}}$	
parallel to edge	
$f_{N2} = \frac{c/h_{min} + 0.75}{3.75}$	
perpendicular away from edge	
$f_{N3} = \frac{c/h_{min} + 5.82}{8.82}$	

Note: Edge distance and anchor spacing for all light-weight and sand-lightweight concrete are obtained by dividing the normal-weight dimensions by 0.75 and 0.85 respectively.



JUAN FERNANDEZ-BARQUIN, P.E.
 STRUCTURAL ENGINEER * THRESHOLD INSPECTOR * PLANS EXAMINER

PROJECT NAME 526 NW 34TH AVE. Port Lauderdale
 ENGINEER _____ DATE 12-2025 PAGE 9

* CONNECTION DESIGN
ALUMINUM PLATE DESIGN

Tension per plate = $\frac{M}{d} = \frac{2179 \text{ K-in}}{4.17 \text{ ft}} = 5.23 \text{ K per Row}$

there are 2 plates per row

$\frac{5.23}{2} = 2.62 \text{ K}$

$A_{pl} = 35.4 \text{ in}^2$

plate $\frac{1}{2}$ "

$f_b = \frac{2.62 \text{ K}}{35.4} = 0.074 \text{ K/si}$

$M = \frac{1}{8} (0.074) 6^2 \Rightarrow M = 0.333 \text{ K-in}$

$S = 1 \times \frac{0.5^2}{6} = 0.041$

$f_b = \frac{M}{S} = \frac{0.333 \text{ K-in}}{0.041 \text{ in}^3} \Rightarrow f_b = 8.12 \text{ K/si}$

allowable = 9.1 K/si > 8.12 K/si OK

$b = 3^2 \times 3^2$
 $R = 4.24 \text{ in}$

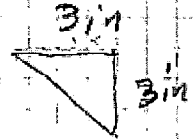

$V_{allow} = \frac{3}{16} \times 9.707 \text{ K/si} = 0.73 \text{ K per in}$

$V_{allow} = 0.73 \text{ K} \times 4.24 \text{ in} = 3.10 \text{ K}$

$\frac{3.15}{4 \text{ plate}} = 0.79 \text{ K per plate}$ $3.10 \text{ K} > 0.79 \text{ K}$

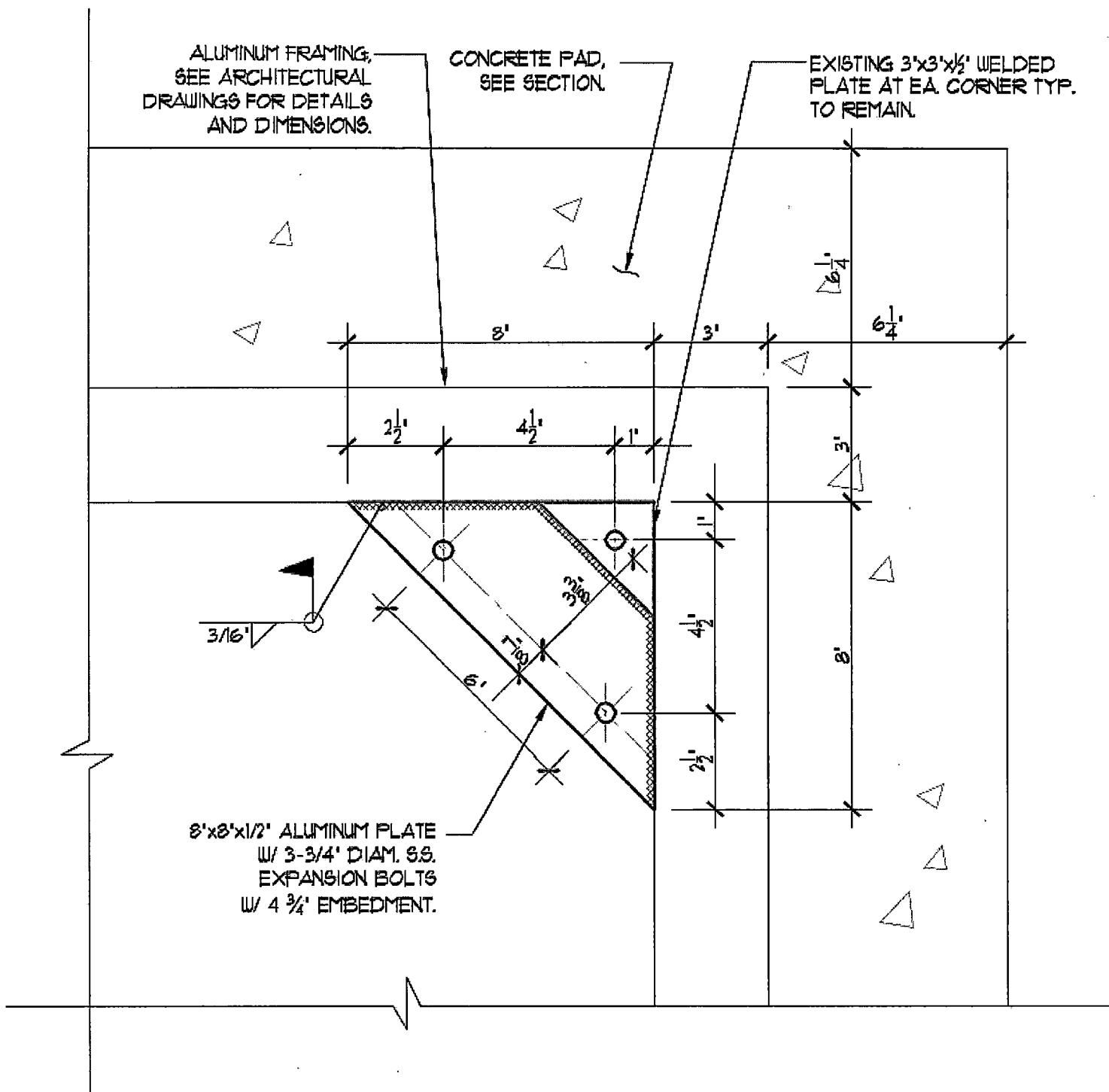

ALUMINUM PLATE DETAIL

SCALE: 3"=1'-0"

1
S-1

Table 2-18W
ALLOWABLE STRESSES F/Ω (k/in^2) FOR BUILDING-TYPE STRUCTURES (WELDED)

Section	F/Ω	6061 - T6	B209 0.010 to 4.000 in. thick
Axial Tension			
axial tension stress on net effective area	D.2b 12.3	6061 - T6	B209 0.010 to 4.000 in. thick
axial tension stress on gross area	D.2a 9.1	6061 - T6	B210 0.025 to 0.500 in. thick
		6061 - T651	B211 0.125 to 8.000 in. thick
		6061 - T651	B211 0.125 to 8.000 in. thick
Shear or torsion		6061 - T6	B632 0.010 to 0.625 in. thick
Shear or torsion rupture	G, H.2 7.4	$F_{tyw} =$	15 k/in^2
Bearing		$F_{cyw} =$	15 k/in^2
bolts or rivets on holes	J.3.6a, J.4.6 24.6	$F_{taw} =$	24 k/in^2
bolts on slots, pins on holes, flat surfaces	J.3.6b, J.6.5, J.8 18.4	$E =$	10,100 k/in^2
screws in holes	J.5.5.1 16.0	$k_t =$	1

when welded with 5356 filler

	λ	F/Ω for $\lambda \leq \lambda_1$	λ_1	F/Ω for $\lambda_1 < \lambda < \lambda_2$	λ_2	F/Ω for $\lambda \geq \lambda_2$
Axial Compression - member buckling	E.2	kL/r 9.1	21.8	$0.00007 \lambda^2 - 0.066\lambda + 10.5$	133	$51,352/\lambda^2$
Flexure - lateral-torsional buckling	F.4	see F.4.2	-	see F.4	133	$60,414/\lambda^2$
Elements - Uniform Compression						
flat elements supported on one edge in columns whose buckling axis is not an axis of symmetry	B.5.4.1	b/t 9.1	9.0	$12.0 - 0.327\lambda$	25	$2,417/\lambda^2$
flat elements supported on one edge in all other columns and all beams	B.5.4.1	b/t 9.1	9.0	$12.0 - 0.327\lambda$	18.4	$111/\lambda$
flat elements supported on both edges	B.5.4.2	b/t 9.1	28.2	$12.0 - 0.105\lambda$	58	$346/\lambda$
flat elements supported on both edges and with an intermediate stiffener	B.5.4.4	λ_p 9.1	21.8	$10.2 - 0.051\lambda$	133	$60,414/\lambda^2$
round hollow elements	B.5.4.5	R_p/t 9.1	46.4	$11.8 - 0.396\lambda^{1/2}$	389	$3,776/(\lambda k_n)^\dagger$
flat elements - direct strength method	B.5.4.6	λ_{eq} 9.1	45.1	$12.0 - 0.065\lambda$	92	$554/\lambda$
Elements - Flexural Compression						
flat elements supported on both edges	B.5.5.1	b/t 13.6	36.2	$16.0 - 0.065\lambda$	123	$982/\lambda$
flat elements supported on tension edge, compression edge free	B.5.5.2	b/t 13.6	6.7	$16.0 - 0.350\lambda$	30	$4,932/\lambda^2$
flat elements supported on both edges and with a longitudinal stiffener	B.5.5.3	b/t 13.6	81.2	$16.0 - 0.029\lambda$	275	$2,201/\lambda$
pipes and round tubes	B.5.5.4	R_p/t $17.7 - 0.933\lambda^{1/2}$	120.8	$11.8 - 0.396\lambda^{1/2}$	389	$3,776/(\lambda k_n)^\dagger$
flat elements - direct strength method	B.5.5.5	λ_{eq} M_{np}/S_{xx}	45.1	see B.5.5.5	123	$554/\lambda$
Elements - Shear						
flat elements supported on both edges	G.2	b/t 5.5	47.5	$7.3 - 0.038\lambda$	126	$38,665/\lambda^2$
flat elements supported on one edge	G.3	b/t 5.5	19.8	$7.3 - 0.092\lambda$	53	$6,713/\lambda^2$
pipes and round or oval tubes	G.4	λ_p^* 5.5	80.0	$9.5 - 0.050\lambda$	126	$50,264/\lambda^2$
Torsion - pipes and round or oval tubes	H.2.1	λ_p^* 5.5	47.5	$7.3 - 0.038\lambda$	126	$38,665/\lambda^2$

$\lambda_p^* = 2.9(R_p/t)^{3/8}(L/R_p)^{1/4}$
 $\dagger k_n = (1 + \lambda^{1/2}/35)^2$

$\lambda_p^* = 0.25$
 $\textcircled{D} k = 0.707 \times 5.5$



Technical Excellence
Practical Experience
Client Responsiveness

27 July 2022

Elizabeth Van Zandt
Fort Lauderdale Downtown Development Authority (DDA)
110 E. Broward Boulevard, Suite 1610
Fort Lauderdale, FL 33301

**Re: Geotechnical Engineering Study
Huizenga Park-Riverwalk Expansion ("the Project")
SE Corner of S. Andrews Ave and E. Las Olas Blvd.
Fort Lauderdale, Florida
Langan Project No. 330101302**

Dear Elizabeth,

Langan Engineering & Environmental Services, Inc. (Langan) has completed a geotechnical engineering study for the proposed Huizenga Park-Riverwalk Expansion development in downtown Fort Lauderdale, Florida ("the Project"). The development will consist of expanding a portion of riverwalk over the existing river.

The purpose of the study was to: 1) perform a site-specific subsurface investigation and engineering inspection at landside close to the proposed riverwalk expansion area, 2) perform a foundation analysis and evaluation for driven pile foundation to support the portion of walkway over the river, and 3) provide preliminary foundation options for the new walkway on the landside. This work was performed in general accordance with our 31 May 2022 proposal which was incorporated into a Letter of Engagement (LOE) between Fort Lauderdale DDA and Langan on 2 June 2022.

All elevations given herein are in feet and refer to the North America Vertical Datum of 1988 (NAVD88).

SITE DESCRIPTION AND PROPOSED CONSTRUCTION

The Huizenga Park is located in the downtown area of Fort Lauderdale, Florida. It is bounded to the west by S. Andrews Ave, to the north by E Las Olas Blvd, to the east by SE 1st Ave, and to the south by the New River. A Site Vicinity Map is provided as Figure 1 in the report. The existing riverwalk is at the southern portion of the Park along the river. Based on furnished survey plan and our site visit, the existing riverwalk is relatively flat with ground surface elevation ranging from about +3.5 to +4.0 for most of the area.

Based on the provided information, we understand that a portion of the proposed Riverwalk will be extended over the river area. Therefore, new piles will be designed and installed in the river to support of the proposed Riverwalk system, which will extend over the existing seawall and into the river. Preliminary unfactored axial loading for a new pile will be 65 tons in compression, as provided by the project structural engineer, Mr. Colin Doyle, P.E. of Silman,

SUBSURFACE INVESTIGATION

Our subsurface investigation was performed on 2 and 3 June 2022. The investigation consisted of drilling two Standard Penetration Test (SPT) test borings (identified as RB1 and RB2) on the land side near the proposed riverwalk expansion areas. The approximate test boring locations are shown on Figure 2. All investigation work was performed by a specialty drilling subcontractor under the direction and supervision of a Langan engineer. Prior to drilling, all of the test locations were verified by a private utility locator.

The two test borings were drilled to depths of 70 and 80 ft below the existing landside grade. The test borings were advanced using mud rotary drilling techniques. Split-spoon sampling was typically performed continuously between 0 and 10 ft depth and at 5 ft intervals thereafter. The soil samples were visually examined and classified by Langan’s geotechnical engineers both in the field and in our office. The soil test boring logs are included in Appendix A.

SUBSURFACE CONDITIONS

Generalized Subsurface Conditions

Based on the test borings performed, the generalized subsurface conditions encountered are summarized in the following table. A generalized subsurface profile is shown on Figure 3.

Stratum Number	Material Description	Approx. Top of Stratum Elevation (ft, NAVD88)	Thickness (ft)	Typical Range of SPT N-values (blows/ft)
1	6 inches of concrete pavement over 3 ft of sand and limerock (Fill) followed by fine Sand, trace to some silt and limestone fragments (typically, medium dense to dense in Fill and very loose in Sand)	+4 (Ground Surface at boring locations)	3 (Fill) & 5 to 6 (Sand)	12 to 37 (Fill) & 0 to 3 (Sand)
2	Upper Limestone (typically, soft)	-4.5 to -5.5	7 to 8	5 to 10
3	Middle fine Sand (typically, medium dense with very loose zone at the bottom portion)	-12.5	17.5 to 20	12 to 17 for upper and middle & 0 to 4 for bottom
4	Middle Limestone (typically, moderately hard)	-30 to -32.5	15 to 17.5	8 to 41 (typ. 16 to 25)
5	Lower fine Sand with some cemented sand fragments (typically, medium dense)	-47.5	5	20 to 22
6	Cemented Sand & Shell, with some sandstone and sand (typically, moderately hard to hard)	-52.5	All borings terminated within stratum	9 to 73 (typ. 18 to 42)

Groundwater

The groundwater level was measured in the test borings during initial drilling. The measured groundwater level was typically around 4.1 to 4.2 ft below the existing grade (approximately el -

0.1 to el -0.2). Based on our knowledge and experience at the project site, the groundwater level should be close to adjacent river water level and should range typically from el +1.5 to el -1.5. The groundwater levels will fluctuate seasonally as a function of rainfall and infiltration into the soil as well as due to the water level fluctuation in the adjacent river, which is eventually connected to Atlantic Ocean.

Based on the Flood Insurance Rate Map (FIRM) number 12011C0557H, effective 18 August 2014, the site is in Zone AH, with a base flood elevation of el +5 (ft, NAVD88).

GEOTECHNICAL EVALUATION AND RECOMMENDATIONS

Driven Piles for New Riverwalk Element at River Side

Nearby river bottom elevation information is limited. A provided draft plan of New River Channel Layout, prepared by Taylor Engineering Inc. and dated 2 February 2009, indicates the river bottom area around where the new proposed piles will be installed is around "-20". This "-20" does not indicate whether this is related to depth or elevation. For conservative purposes, we assume it is related to the NAVD88 datum. In addition, considering boating and current influences, we have used a river scour bottom at el -30, ft NAVD88 for our pile analysis. Please note that official scour analysis was not included in Langan service and evaluation. The el -30, assumed in our analysis, should be conservative as this is the depth of the Stratum 4 limestone material which is resistant to scour.

Based on our interaction with Mr. Doyle, subsurface information from the two landside borings, assumed the river scour bottom at el -30, and our evaluations, we preliminarily recommend 14-inch square prestressed driven piles be used to provide the required 65-ton axial compressive load. The piles should be installed to a pile tip around el -56 ft, NAVD88 to achieve the required load. Due to the upper 30+ ft of pile not having any lateral support, lateral capacity of a vertical pile will be limited. In order to achieve lateral capacity, piles installed on batters will likely be required. Details of the preliminary pile design requirements are presented in the table below.

Pre-stressed Driven Pile Design Parameters	14-inch Square Pile
Compressive/Uplift Design Capacity (factor of safety of at least 2)	65 tons/20 tons
Lateral Capacity	Limited (Piles should be installed with appropriate batter to achieve the required lateral capacity)
Minimum Embedment Requirement	Estimated 2 to 3 ft of penetration into the relatively hard zone of the upper Stratum 6 Cemented Sand materials
Approximate Pile Tip Elevation ¹	Approx. el -56 ft, NAVD88
Minimum Pile Spacing	4.5 ft on centers

1. Tip elevation may vary and will be determined at the time of pile driving.
2. Adequate pile reinforcing must be designed by the Structural Engineer to resist all axial, bending, tensile, and shear stresses.

To verify the driven pile design capacity, we recommend dynamic testing using the Pile Driving Analyzer (PDA) technique, during the pile installation. Further recommendations will be provided in our final report.

Foundation Options at Land Side

Shallow Foundation Options

The simple approach for pavement slabs or light ground features on the land side of the proposed Riverwalk would be at-grade support or shallow foundations, respectively. This assumes there is no conflict with the existing seawall system, such as tie-backs or deadmen. In addition, slabs or small foundations should bear on properly compacted engineered fill (used to raise grade) or the existing Stratum 1 granular fill and native fine sand after proper site preparation and foundation subgrade preparation are complete. Site and subgrade preparation are discussed in our 21 April 2022 geotechnical report for the proposed nearby 1-story buildings within Huizenga Park. Special attention should be made to improve the density of the weaker Stratum 1 sand, as outlined in the aforementioned 21 April 2022 report. In addition, the integrity of the existing seawall should be confirmed to assure that loss of material is not occurring between the vertical structure joints of the seawall.

Assuming the above procedures are performed, shallow foundations could be designed using an allowable design soil bearing pressure of 2,000 pounds per square foot (psf).

Deep Foundation Options

If a shallow foundation option cannot be utilized for the light ground features due to potential conflicts with the existing seawall tie-back system or other utilities, specialty deep foundation options could be considered in design. The following presents several specialty deep foundation options (with limited design criteria) for preliminary consideration.

- 1) 3.5-inch O.D. Schedule 40 driven steel pin piles with a design structural load up to 6 tons in compression and estimated pile tip at around el -32 to el -35;
- 2) Helical pile with a design structural load up to 10 to 20 tons in compression and estimated pile tip at around el -34 to el -38;
- 3) 5.5-inch-diameter Cast-in Drilled Hole (CIDH) micropile for a design structural load up to 10 or 25 tons in compression with estimated pile tip at around el -11 or el -38, respectively; and
- 4) Relatively short 14-inch-diameter augercast pile for a structural load up to 25 tons in compression and estimated pile tip at around el -11.

When the proposed Riverwalk expansion design layout is finalized and structural loads are available, we can work with the design team, including specialty contractors, to narrow down the foundation options for landside support options.

Potential Surcharge Loading on the Existing Seawall

Based on our interaction with Mr. Doyle, we understand that one of the design options was to consider possibly transferring some of load to existing seawall. Currently, there is no design information available for the existing seawall and no engineering firms has not been engaged in that service. We recommend that a specialty seawall designer be engaged to fully investigate

and evaluate the existing seawall structural elements and conditions, including seawall cap, panels, king piles, tie-back system, etc., and to provide recommendations. Until that effort is undertaken, no new loads should be applied and imparted onto the existing seawall.

LIMITATIONS

The evaluations and recommendations given in this report are based on our engineering judgment as to the appropriate foundation support system and required site preparation procedures for the proposed development. They are based on subsurface conditions inferred from the borings, on the available development information, and on the structural loading assumptions described in this report. Recommendations given are contingent upon one another and no recommendation should be followed independent of the others. The report has been prepared to assist the owner, contractor and design team members in their work. It is intended for use with regard to the information provided, and any changes in structures or locations should be brought to our attention so that we may determine how such changes may affect our recommendations.

This report was produced for the proposed riverwalk expansion located at Huizenga Park in downtown Fort Lauderdale, Florida. Langan Engineering and Environmental Services, Inc. cannot assume responsibility for the use of this report to generate foundation design other than for the specific structure addressed in this report.

Information on subsurface strata and groundwater levels shown on the logs represent conditions encountered only at the locations indicated at the time of our investigation. If different conditions are encountered during construction, they should immediately be brought to our attention for evaluation as they may affect our recommendations. Environmental issues, such as potentially contaminated soil and groundwater, are outside the scope of this study and our services.

CLOSING

We appreciate the opportunity to be of service to you during this phase of the project. If you have any questions regarding the information in this report, please contact us at (786) 264-7200.

Very truly yours,
Langan Engineering & Environmental Services, Inc.

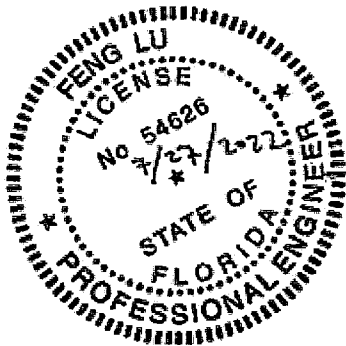

Feng Lu, P.E.
Senior Project Manager
Florida Registration No. 54626

Roger A. Archabal, P.E.
Principal/Vice President
Florida Registration No. 48404

FL/RAA:fl

Enclosures: Figure 1 – Site Vicinity Map
Figure 2 – Geotechnical Exploration Plan
Figure 3 – Generalized Subsurface Profile
Appendix A – Logs of Test Borings

FIGURES

LANGAN



NOT TO SCALE

NOTES:

1. AERIAL IMAGERY WAS ACQUIRED ON NOVEMBER 2019 VIA GOOGLE EARTH PRO.

LANGAN Langan Engineering and Environmental Services, Inc. 55150 NW 78th Court, Suite 200 Miami Lakes, FL 33015 T: 780.264.7280 F: 780.264.7201 www.langan.com FL Certificate of Authorization No. 00000016.00172/L99103	Project	Drawing Title	Project No.	Drawing No.
	HUIZENGA PARK - RIVERWALK EXPANSION	SITE VICINITY MAP	3301D1502	FIG.1
	FORT LAUDERDALE		Date	
	BROWARD COUNTY FLORIDA		JUNE 2022	
			Drawn By	
			FL	
			Checked By	
			RAA	

Filename: \\langan.com\lra\16\2647280\3301D1502\Project Data\CAD\66125-Design\Figures\3301D1502\3301D1502 - Site Vicinity Map and BLP.dwg Date: 7/22/2021 Time: 12:45 User: staccato Style Table: Langan.tbl Layout: 1 - Site Vicinity Map

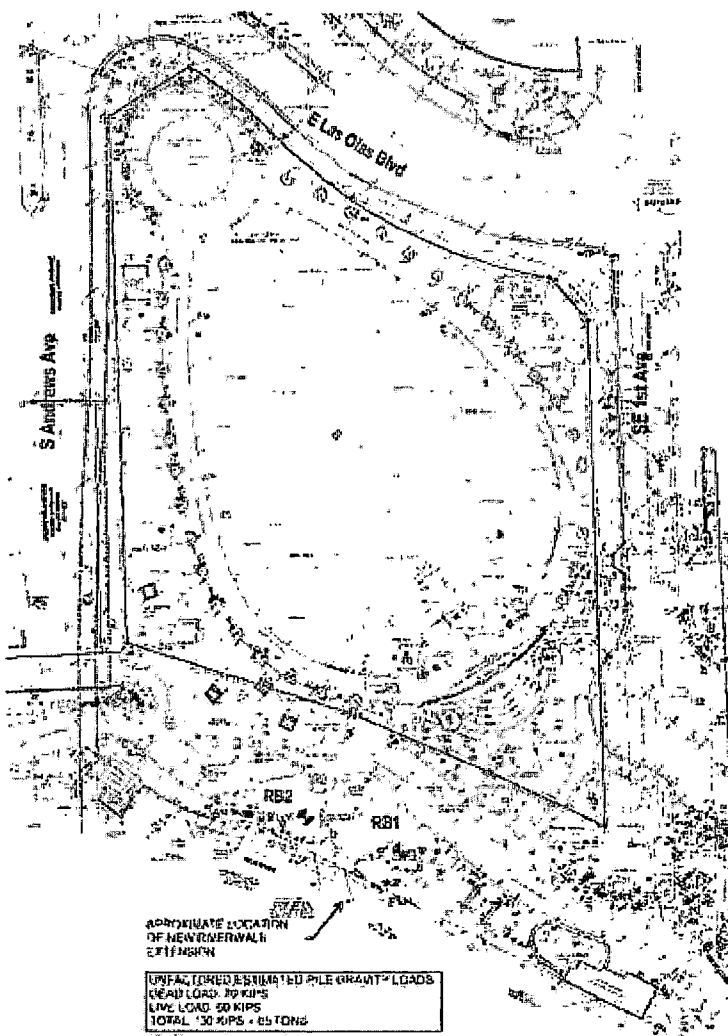

LEGEND:

RB1 & RB2
 APPROXIMATE TEST BORING LOCATION, IDENTIFICATION NUMBER

NOTES:

1. BASE PLAN REPRODUCED FROM BOUNDARY AND TOPOGRAPHIC SURVEY PLANS, PREPARED BY CRAVEN THOMPSON AND ASSOCIATES, INC. WITH LATEST REVISION DATE OF 3/11/2022.
2. ALL TEST LOCATIONS SHOWN ARE APPROXIMATE.

APPROXIMATE LOCATION OF RIVERWALK EXTENSION

UNFACTORED ESTIMATED PILE GRAVITY LOADS
 DEAD LOAD 20 KIPS
 LIVE LOAD 50 KIPS
 TOTAL 130 KIPS = 65 TONS

NOT TO SCALE

LANGAN <small>LANGAN Engineering, Inc. Environmental Services, Inc. 15501 NE 79th Court, Suite 200 Miami, FL 33154 Tel: 305.254.8200 Fax: 305.254.8300 *Licenses of Professional Engineers - State of Florida</small>	Project HUIZENGA PARK - RIVERWALK EXPANSION	Drawing Title BORING LOCATION PLAN	Sheet No. 2 OF 2 Date JUNE 2022 Drawn By RL Checked By PJA	Drawing No. FIG.2
	FORT LAUDERDALE HIGHLAND COUNTY FLORIDA			

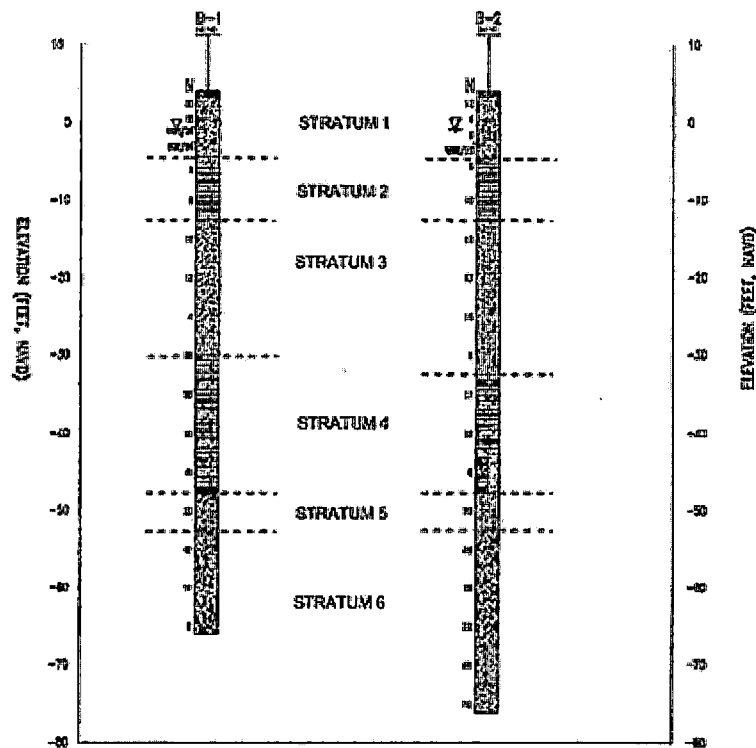

LEGEND:

- N STANDARD PENETRATION RESISTANCE N-VALUE (BLOWS/FT)
- APPROXIMATE GROUND SURFACE ELEVATION AT TIME OF BORING
- APPROXIMATE GROUNDWATER ELEVATION AT TIME OF BORING COMPLETION

NOTES:

1. THE PROFILE SHOWS ONLY GENERALIZED SUBSURFACE CONDITIONS AT THE RESPECTIVE BORING LOCATIONS. VARIATIONS IN SUBSURFACE CONDITIONS SHOULD BE EXPECTED BETWEEN BORINGS. SEE BORING LOGS FOR DETAILED DESCRIPTIONS OF CONDITIONS ENCOUNTERED AT EACH LOCATION.
2. SPT FOR ALL BORINGS WERE PERFORMED USING AN AUTOMATIC HAMMER. SPT N-VALUES SHOWN HAVE NOT BEEN CORRECTED FOR AUTOMATIC HAMMER EFFICIENCY.
3. ALL ELEVATIONS SHOWN ARE IN FEET REFERENCED TO THE NORTH AMERICAN VERTICAL DATUM OF 1988 (NAVD OR NAVD88).

GENERALIZED SUBSURFACE PROFILE

VERTICAL SCALE: 1"=15'
HORIZONTAL SCALE: N.T.S

LANGAN
 CONSULTING ENGINEERS
 10000 W. BOULEVARD, SUITE 200
 FORT LAUDERDALE, FLORIDA 33407
 TEL: (954) 473-1100 FAX: (954) 473-1101
 WWW.LANGAN.COM
 Langan Consulting Engineers, Inc. is an Equal Opportunity Employer. Minorities and women are encouraged to apply. Langan is an Equal Opportunity Employer. Minorities and women are encouraged to apply. Langan is an Equal Opportunity Employer. Minorities and women are encouraged to apply.

Project
HUIZENGA PARK - RIVERWALK EXPANSION
 FORT LAUDERDALE
 BROWARD COUNTY FLORIDA

Drawing Title
GENERALIZED SUBSURFACE PROFILE

Project No.
 330101302
 Date
 JUNE 2022
 Scale
 AS SHOWN
 Drawn By
 CH
 Checked By
 PL

Drawing No.
FIG.3

APPENDIX A

LOGS OF TEST BORINGS

LANGAN

LANGAN

LOG OF BORING **RB-1**
SHEET **1** OF **2**

PROJECT Huizenga Park - Riverwalk Expansion		PROJECT NO. 330101302	
LOCATION Fort Lauderdale, FL		ELEVATION AND DATUM Approx. + 4 ft. NAVD88	
DRILLING EQUIPMENT CME-45		DATE STARTED 6/2/22	DATE FINISHED 6/2/22
SIZE AND TYPE OF BIT 2 3/4" Casing Bit		NUMBER OF SAMPLES 17	COMPLETION DEPTH 70 ft.
CASING DIAMETER (in) 3	CASING DEPTH (ft) 68	WATER LEVEL (ft) 4.1	UNDIST. 24 HR.
SAMPLER 2" OD Split Spoon		DRILLING FOREMAN Alexander Milan	
SAMPLER HAMMER Safety	WEIGHT (lb) 140	DROP (ft) 30	INSPECTING ENGINEER Gabriel Mishan

LANGAN CORP. DATA FILE: 330101301 PROJECT DATA DISCIPLINE: GEOTECHNICAL/GEINTL. 06/05/2022 3:32:59 PM ... 06/24/2022 3:32:59 PM ... Report Log - BORING

ELEV. (ft)	SAMPLE DESCRIPTION	SYMBOL LOG	DEPTH SCALE	SAMPLE DATA					REMARKS (DRILLING FLUID, DEPTH OF CASING, FLUID LOSS, DRILLING RESISTANCE, ETC.)
				NUMBER	TYPE	RECOV. (in)	PENETR. RESIST. (blows)	N-VALUE (blows per ft)	
+4.0	0.5' Concrete Light tan LIMEROCK, some sand [FILL] Dark brown fine SAND, little silt [FILL]	[Symbol]		S-1	SS	19	26 15 22 19	37	Boring located 17" from seawall
+0.5	Light brown to light tan fine SAND Light brown to gray fine SAND, some limestone fragments, trace silt No recovery	[Symbol]	5	S-2	SS	15	13 10 7 8	17	Introduce drilling fluid Advance casing to 4.5'
				S-3	SS	10	WCH124		Advance casing to 6.5'
				S-4	SS	0	WOR124		Advance casing to 8.5'
-5.5	Light tan LIMESTONE, some sand	[Symbol]	10	S-5	SS	15	WCH112	3	Advance casing to 10.5' Advance casing to 13' Easy drilling Poor circulation
	Light tan LIMESTONE, little sand	[Symbol]	15	S-6	SS	10	8 5 3 3	8	Advance casing to 18' Easy drilling Moderate to good circulation
-12.5	Light tan fine SAND	[Symbol]	20	S-7	SS	17	6 5 7 7	12	Advance casing to 23' Easy drilling Good circulation
	Light tan to brown fine SAND	[Symbol]	25	S-8	SS	10	7 6 7 8	13	Advance casing to 28' Easy drilling Good circulation
	Light brown with brown molting fine SAND	[Symbol]	30	S-9	SS	7	3 2 2 2 WOR142	4	Sample went down to 33' with the weight of hammer
-30.0	Light tan fine SAND	[Symbol]	35	S-10	SS	21	2 2 21 20	23	Complete circulation loss at 35' Advance casing to 38' Easy drilling Good circulation
	Light gray LIMESTONE	[Symbol]	40	S-11	SS	13	24 15 10 8	25	Advance casing to 43' Easy to moderate drilling

LANGAN

LOG OF BORING RB-1
SHEET 2 OF 2

PROJECT Huizenga Park - Riverwalk Expansion	PROJECT NO. 330101302
LOCATION Fort Lauderdale, FL	ELEVATION AND DATUM Approx. + 4 [ft. NAVD88]

\LANGAN\COM\DATA\FL\DATA\330101301\PROJECT DATA\ DISCIPLINE\GEO\TECHNICAL\LOGS\SI.6.3.2022-6RIVER EXPANSION\330101302 BORINGS_6.3.2022.OPJ ... 02/02/2022 3:32:13 PM ... Report Log - BORING

ELEV. (ft)	SAMPLE DESCRIPTION	SYMBOL LOG	DEPTH SCALE	SAMPLE DATA					REMARKS (DRILLING FLUID, DEPTH OF CASING, FLUID LOSS, DRILLING RESISTANCE, ETC.)	
				NUMBER	TYPE	RESOV. IN	PENETR. RESIST BLANCH	N-VALUE BLOWS PER FT		
-47.5	Light gray to white LIMESTONE		45	S-12	SS	12	12 8 10	16	Advance casing to 46' Easy to moderate drilling	
	Light gray to tan LIMESTONE		S-13	SS	10	30 15 15	26 15	41	Advance casing to 53' Moderate drilling	
-52.5	Light gray fine SAND		55	S-14	SS	14	18 12 18	22	Advance casing to 58' Moderate drilling	
-57.5	Light gray CEMENTED SAND AND SANDSTONE, some sand		60	S-15	SS	10	14 15 27 50ft	42	Advance casing to 63' Hard drilling	
-66.0	Light gray CEMENTED SAND AND SHELL		65	S-16	SS	11	15 9 18	9	18	Advance casing to 68' Moderate drilling
	Gray CEMENTED SAND AND SHELL		S-17	SS	11	5 5 4	4 4	9		
	Boring terminated at 70'		70							
			75							
			80							
			85							
			90							

LANGAN

LOG OF BORING **RB-2**

SHEET **1** OF **2**

PROJECT Huizenga Park - Riverwalk Expansion			PROJECT NO. 330101302		
LOCATION Fort Lauderdale, FL			ELEVATION AND DATUM Approx. + 4 [ft. NAVD88]		
DRILLING EQUIPMENT CME-45		DATE STARTED 6/2/22		DATE FINISHED 6/3/22	COMPLETION DEPTH 80 ft.
SIZE AND TYPE OF BIT 2 3/4" Casing Bit			NUMBER OF SAMPLES	DIST. 19	URDIST.
CASING DIAMETER (in) 3	CASING DEPTH (ft) 78	WATER LEVEL (ft.)	FIRST 4.2	COMPL.	24 HR.
SAMPLER 2" OD Split Spoon			DRILLING FOREMAN Alexander Milan		
SAMPLER HAMMER Safety	WEIGHT (lbs) 140	DROP (ft) 30	INSPECTING ENGINEER Gabriel Mishaan		

LANGAN:CORR/DATA/FL/DATA/330101301/PROJECT DATA, DISCIPLINE/GEOTECHNICAL/LOGS/S18.3.2022-RIVER EXPANSION/330101302 BORINGS, 6.3.2022.GPJ ... 6/24/2022 3:32:58 PM - Report Log - BORING

ELEV. (ft)	SAMPLE DESCRIPTION	SYMBOL LOG	DEPTH SCALE	SAMPLE DATA						REMARKS (DRILLING FLUID, DEPTH OF CASING, FLUID LOSS, DRILLING RESISTANCE, ETC.)
				NUMBER	TYPE	RECOV. (ft)	RETR. RESIST. (lb)	WCH (ft)	N-VALUE BLOWS PER FT	
+4.0	0.5' Concrete	[Cross-hatch pattern]								Boring located 13' from seawal
	Light tan LIMEROCK (FILL)	[Cross-hatch pattern]		S-1	SS	18	17	7	12	
+0.5	Light tan LIMEROCK and SAND, trace silt (FILL) Dark brown fine SAND, trace silt	[Dotted pattern]		S-2	SS	15	2	2	4	Introduce drilling fluid Advance casing to 6.5'
	Brown to dark brown fine SAND, little silt, trace roots	[Dotted pattern]	5	S-3	SS	20	3	2	3	
-4.5	Brown to dark brown fine SAND, little silt, trace roots	[Dotted pattern]		S-4	SS	9	1	2	2	Advance casing to 8.5'
	Light tan LIMESTONE, some sand	[Horizontal lines pattern]	10	S-5	SS	22	3	2	5	
	Light tan LIMESTONE, some sand	[Horizontal lines pattern]		S-6	SS	8	5	7	10	Advance casing to 10.5' Advance casing to 13' Easy drilling Good circulation
		[Horizontal lines pattern]	15				3	2		
-12.5	Light tan fine SAND	[Dotted pattern]		S-7	SS	17	4	4	12	Advance casing to 18' Easy drilling Moderate to poor circulation
	Light brown fine SAND	[Dotted pattern]	20	S-8	SS	19	5	7	17	
	Brown fine SAND	[Dotted pattern]		S-9	SS	18	6	7	16	Advance casing to 23' Easy drilling Moderate circulation
	Light tan fine SAND Light brown to light tan fine SAND	[Dotted pattern]	25	S-10	SS	17	3	2	4	
-32.5	Light gray LIMESTONE	[Horizontal lines pattern]		S-11	SS	16	7	7	17	Advance casing to 28' Easy drilling Poor circulation
		[Horizontal lines pattern]	30				9	9		
		[Horizontal lines pattern]					3	2	4	Advance casing to 33' Easy drilling Moderate to poor circulation
		[Horizontal lines pattern]	35				2	3		
		[Horizontal lines pattern]					7	7	17	Advance casing to 38' Easy drilling Moderate to poor circulation Complete circulation loss at 38'
		[Horizontal lines pattern]	40				10	5		
		[Horizontal lines pattern]					7	7	17	Advance casing to 43' Easy drilling
		[Horizontal lines pattern]					10	5		

EXHIBIT D

Waiver of 1990 Visual Artists' Rights Act

WAIVER AND LICENSE

In connection with the donation of the Artwork "Ariela" ("Work") created by the Artist, the Artist recognizes the existence of moral rights of artists set forth in the Visual Artists' Rights Act of 1990, as amended, and as codified in Title 17 of United States Code (the "Visual Artists' Rights Act"). **TO THE EXTENT THE WORK IS PROTECTED BY THE VISUAL ARTISTS' RIGHTS ACT AND THE ARTIST IS ENTITLED TO PROTECTION THEREUNDER, THE ARTIST EXPRESSLY WAIVES ANY AND ALL RIGHTS ARISING UNDER THE VISUAL ARTISTS' RIGHTS ACT, AND ANY RIGHTS ARISING UNDER FEDERAL OR STATE LAW OR UNDER THE LAWS OF ANY OTHER COUNTRY THAT CONVEYS RIGHTS OF THE SAME NATURE AS THOSE CONVEYED UNDER THE VISUAL ARTISTS' RIGHTS ACT OR ANY OTHER TYPE OF MORAL RIGHT OR DROIT MORAL WITH RESPECT TO THE WORK FOR ANY AND ALL USES IN WHICH EITHER THE ATTRIBUTION OR THE INTEGRITY RIGHT MAY BE IMPLICATED INCLUDING, WITHOUT LIMITATION, THE REMOVAL, RELOCATION, DESTRUCTION, DISTORTION, MUTILATION OR OTHER MODIFICATION OF ALL OR ANY PORTION OF THE WORK AS DEEMED NECESSARY BY THE CITY. THE ARTIST EXPRESSLY RECOGNIZES AND ACKNOWLEDGES THAT THE NATURE OF THE WORK MAY SUBJECT THE WORK TO DESTRUCTION, DISTORTION, MUTILATION OR OTHER MODIFICATION BY REASON OF REMOVAL OR RELOCATION OF ALL OR ANY PORTION OF THE WORK.**

Artist has no outstanding claims and knows of no outstanding ^{revocable} claims against the Artwork. Artist grants the City of Fort Lauderdale, Florida an ~~irrevocable~~ license to graphically reproduce (through photography, the internet or otherwise) the image of the Artwork for municipal (e.g. education, public information, promotion of the arts, etc.) purposes. Municipal purposes mean reproduction in exhibit catalogues, books, slides, photographs, postcards, the City's web sites, City promotional items, and calendars; in art magazines, art books and art and news sections of newspapers; in general books and magazines not primarily devoted to art but of an educational, historical or critical nature, slides and films not intended for mass audience; and television from stations operated for educational purpose or on programs for educational or informational purposes from all stations.

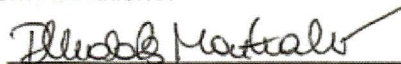

Artist

Regina Valdes Montalva, Authorized Representative
Manolo Valdes Studio, LLC