

LEGEND

- L.A.P.C Area
± 6.2 AC
- Exotic Forest (71%)
- Existing Intermixed Canopy*
(Exotic Tree Canopy Areas
Containing Native Tree Canopy
Intermixed Within)
(29%)
1.8 AC = 79,366 SQFT

*60% = Native Canopy

Data is derived from ongoing site assessments by J.J. Goldasich and Associates, Inc. ("JJGA") From 2019 to 2025, including assessments conducted by JJGA to obtain an Environmental Resource Permit from Broward County to develop the site; JJGA Natural System and Wetland Map (June 11, 2019); and IDG site work (February 19, 2025)

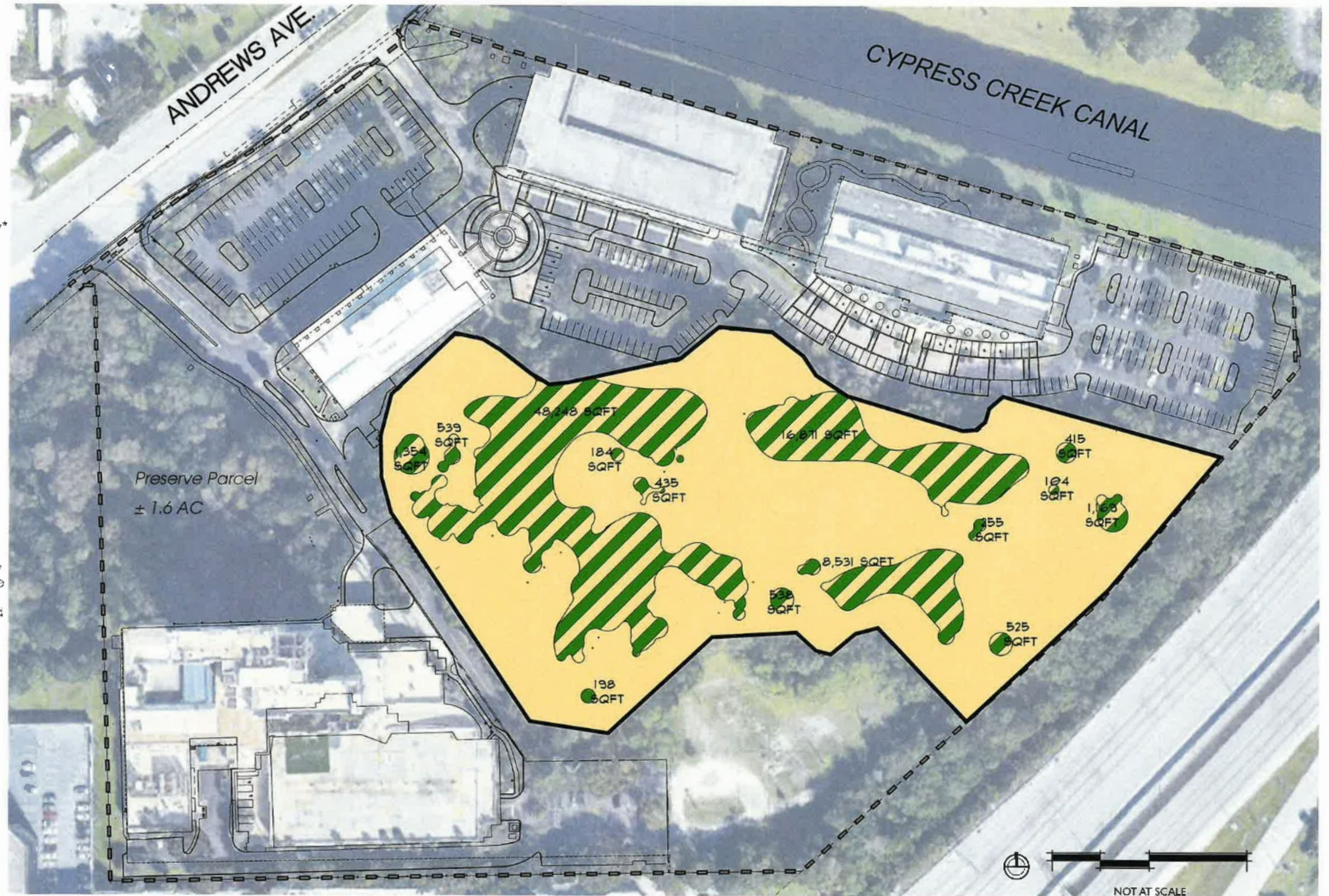

MANOR AT CYPRESS CREEK

Canopy Study - Existing
Project Number: 23023